



VICTORIA GOVERNMENT GAZETTE

Published by Authority.

[Registered at the General Post Office, Melbourne, for transmission by post as a newspaper.]

No. 159.] THURSDAY, NOVEMBER 11. [1915.

NOTICE OF PROPOSED DEDICATION OF AN AREA OF CROWN LANDS AS PERMANENT FORESTS AND TIMBER RESERVES.

NOTICE is hereby given that, after the expiration of one (1) month following the first publication of this notice in the *Victorian Government Gazette*, it is intended, in pursuance of the provisions of Section 20 of the *Forests Act 1907*, to move His Excellency the Governor in Council to dedicate as Permanent Forests and Timber Reserves respectively the area of Crown Lands described in the accompanying Schedule (No. 17).

J. DRYSDALE BROWN,
Minister of Forests.

H. S. W. LAWSON,
Minister of Lands.

State Forests Department,
Melbourne, 25th October, 1915.

SCHEDULE No. 17.

NOTE.—The areas given in the columns and on the diagrams are approximate.

Diagram.	Correspondence Numbers.		Parish.	Plan.	County.	Area in Acres.	
	F.	P.				Permanent Forest.	Timber Reserve.
105	5933	5733	Omeo	374A-B	Benambra	(406)	
106	64014	6017	Mandurang	294	Bendigo	18	
107	61735	3283	Norrington	356	"	735	
108-9	61735	3283	Ellesmere	178	"	690	
110-2	61735	3283	Wellsford	489	"	96	
113	77337	451	Wangaratta North	470B	Bogong		415
114-5	5927	1966	Carlyle	112	"	287	
116-8	2511	5372	Macedon	290A-B	Bourke	875	
119	77350	609	Nayook West	352	Buln Buln	640	
120	3097	6271	Edi	174	Delatite	609	
121	3097	6271	Dueran East	169	"	595	
122	3097	6271	Whitfield South	T7	"	690	
123	5932	346	Barp	31	Gladstone	1020	

SCHEDULE No. 17—continued.

Diagram.	Correspondence Numbers.		Parish.	Plan.	County.	Area in Acres.	
	F.	P.				Permanent Forest.	Timber Reserve.
124-5	5932	346	Bet Bet	44	Gladstone	930	
129-31	5932	346	Dunolly	171	"	3,050	
127	70610	2200	Yalong South	523A	"	560	
132	397	258	Yarroweyah	527	Moirs	136	
133	70655	2454	Angahook	7	Polwarth	280	
128	70610	2200	Langi-kal-kal	270	Ripon	20	
126	70610	2200	Lexton	278i	"	112	
126	70610	2200	"	278i	Talbot	(428)	
124-5	5932	346	Bet Bet	44	"	90	
134	76907	5832	Muckleford	331	"	20	
135	64008	6016	Ravenswood	393	"	165
136-8	1603	3538	Wombat	502A-g	"	888	
						13,175	580

NOTE.—Areas in brackets are conversions from existing Timber Reserve Areas.

Permanent Forest	13,175
Timber Reserve	580
	13,755
Total Area	13,755
Less conversion	834
	12,921
New Reserves	12,921 acres.

First published 4th November, 1915.

PROPOSED ADDITIONS TO STATE FORESTS.—DIAGRAMS TO ACCOMPANY SCHEDULE No. 17.

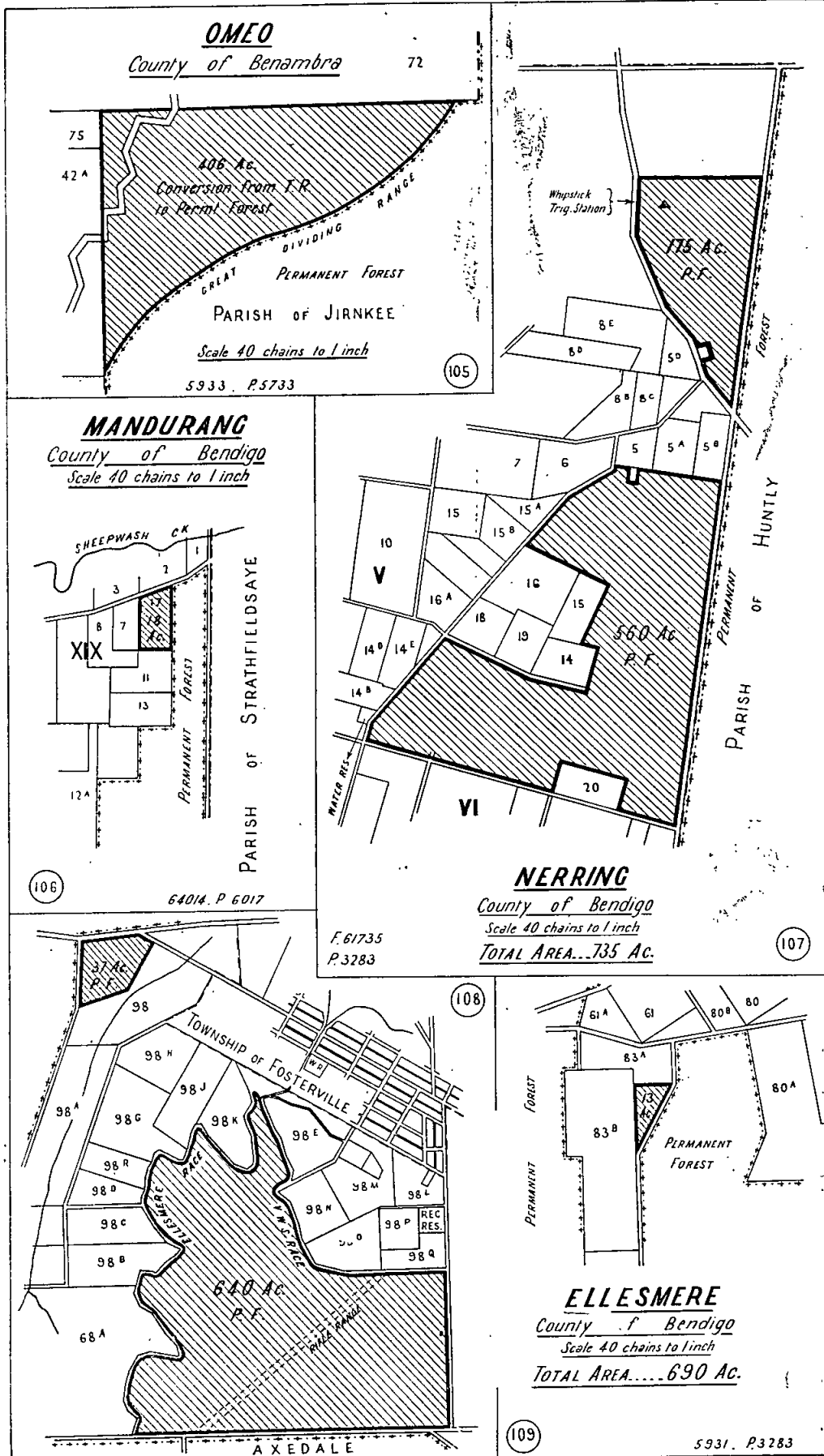

PROPOSED ADDITIONS TO STATE FORESTS.—DIAGRAMS TO ACCOMPANY SCHEDULE No. 17.—continued.

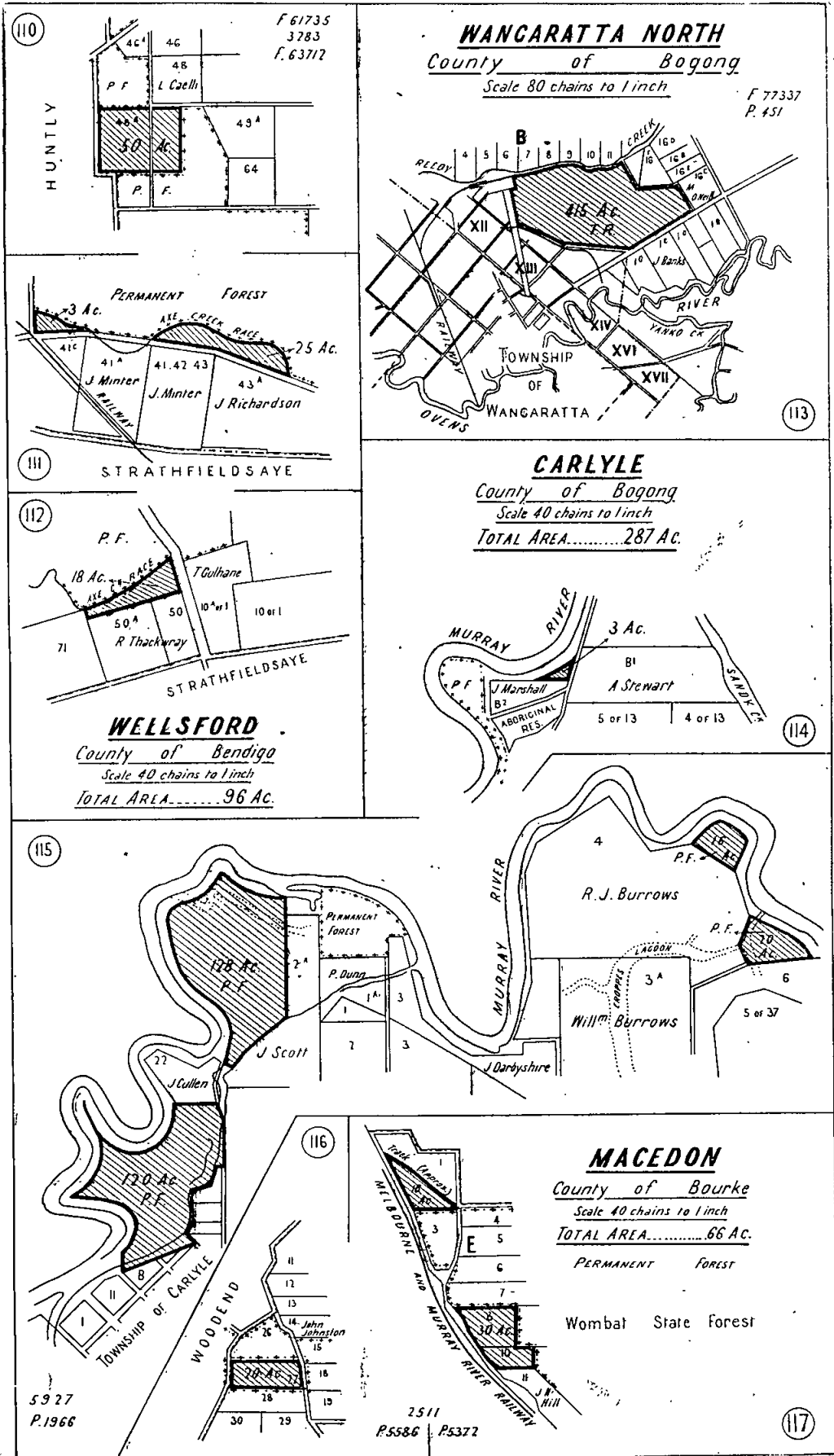

5927
P.1966

2511
P.5586 P.5372

117

PROPOSED ADDITIONS TO STATE FORESTS.—DIAGRAMS TO ACCOMPANY SCHEDULE NO. 17.—continued.

118

MACEDON
County of Bourke
Scale 40 chains to 1 inch
AREA..... 809 Ac.

PERMANENT FOREST

7511 P. 5312 5586

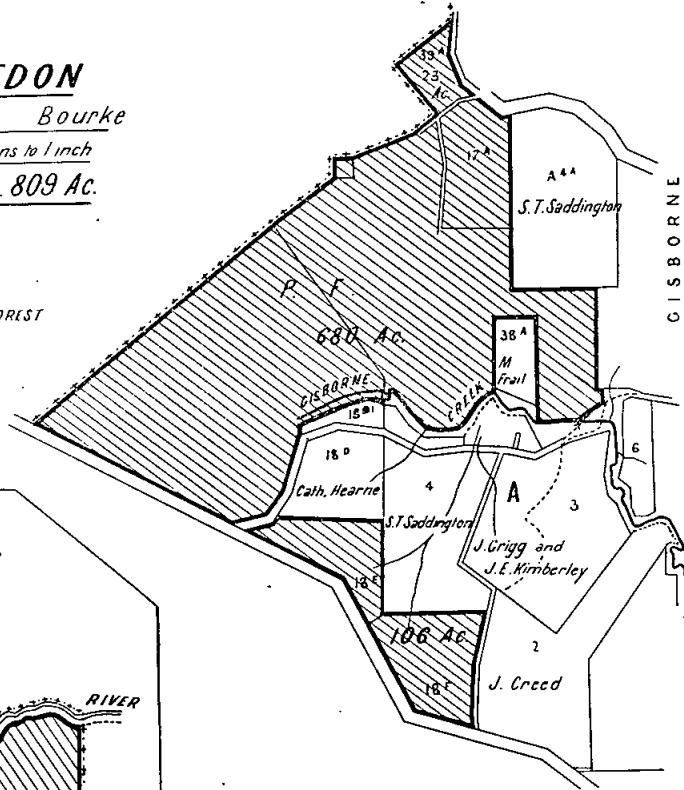

NAYOOK WEST
County of Buln Buln
Scale 40 chains to 1 inch

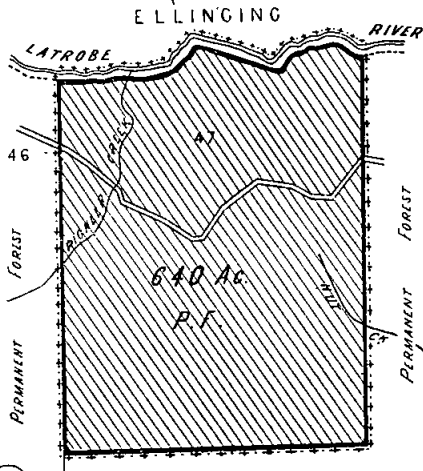

119

F77350. P. 609

EDI
County of Delatite
Scale 80 chains to 1 inch

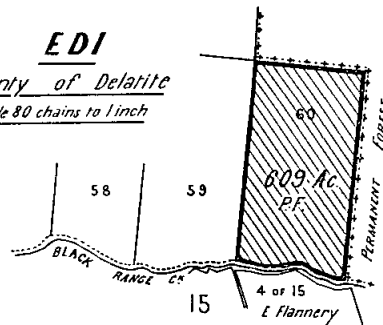

120

3097. P. 6271

DUERAN EAST
County of Delatite
Scale 80 chains to 1 inch
TOTAL AREA..... 595 Ac.

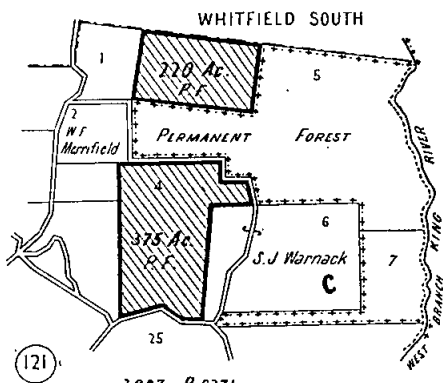

121

3097 P. 6271

WHITFIELD SOUTH
County of Delatite
Scale 80 chains to 1 inch
TOTAL AREA..... 690 Ac.

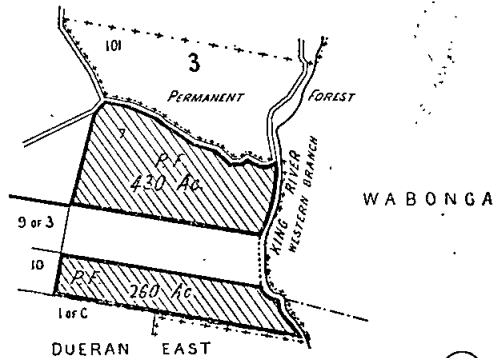

122

3097 P. 6271

PROPOSED ADDITIONS TO STATE FORESTS.—DIAGRAMS TO ACCOMPANY SCHEDULE No. 17.—continued.

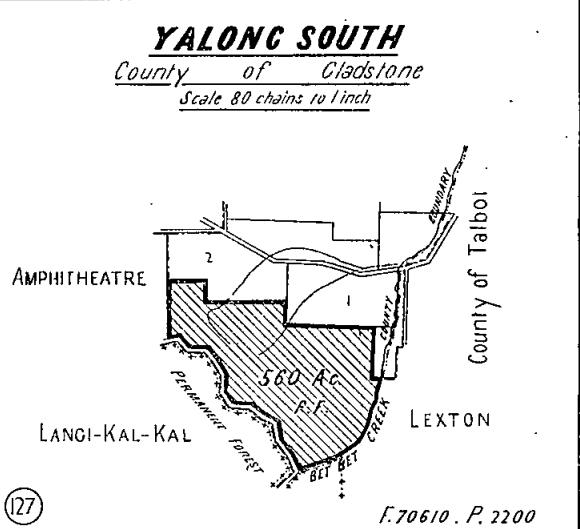
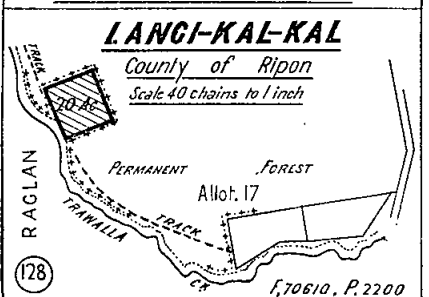
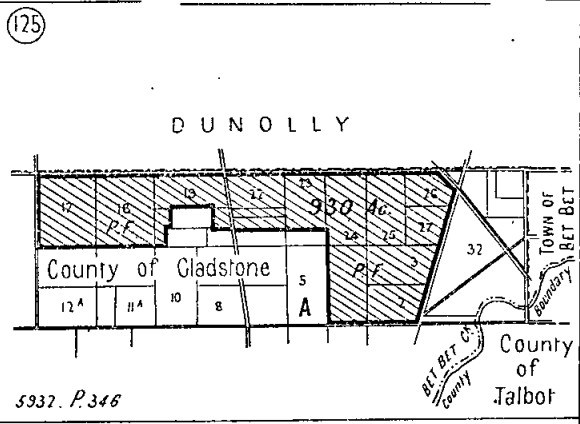
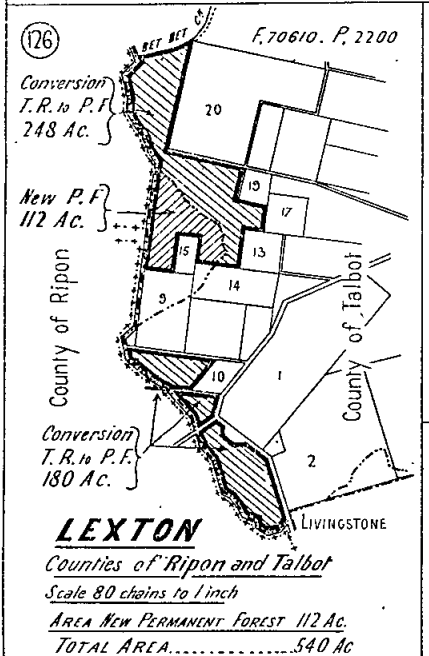
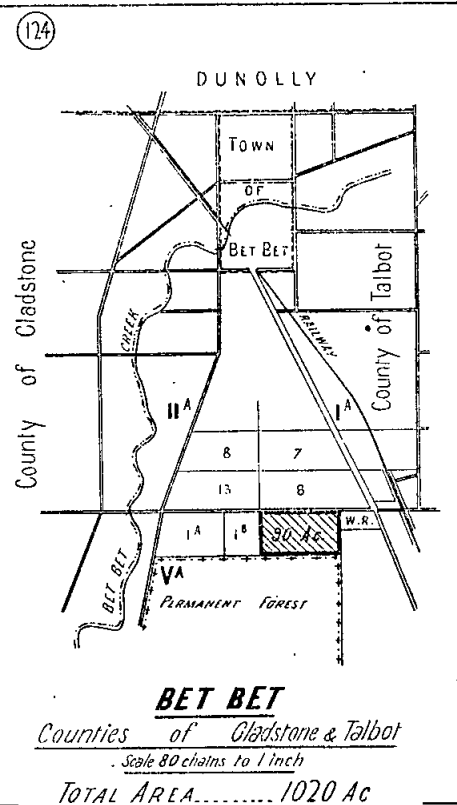
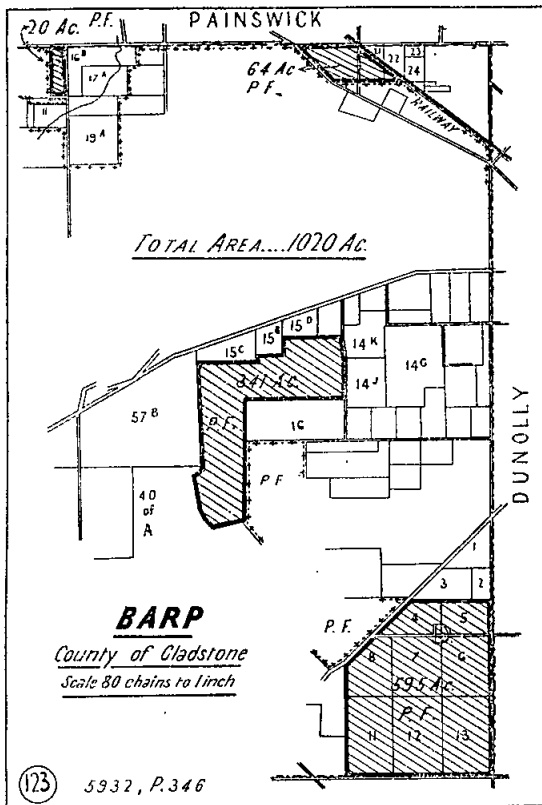

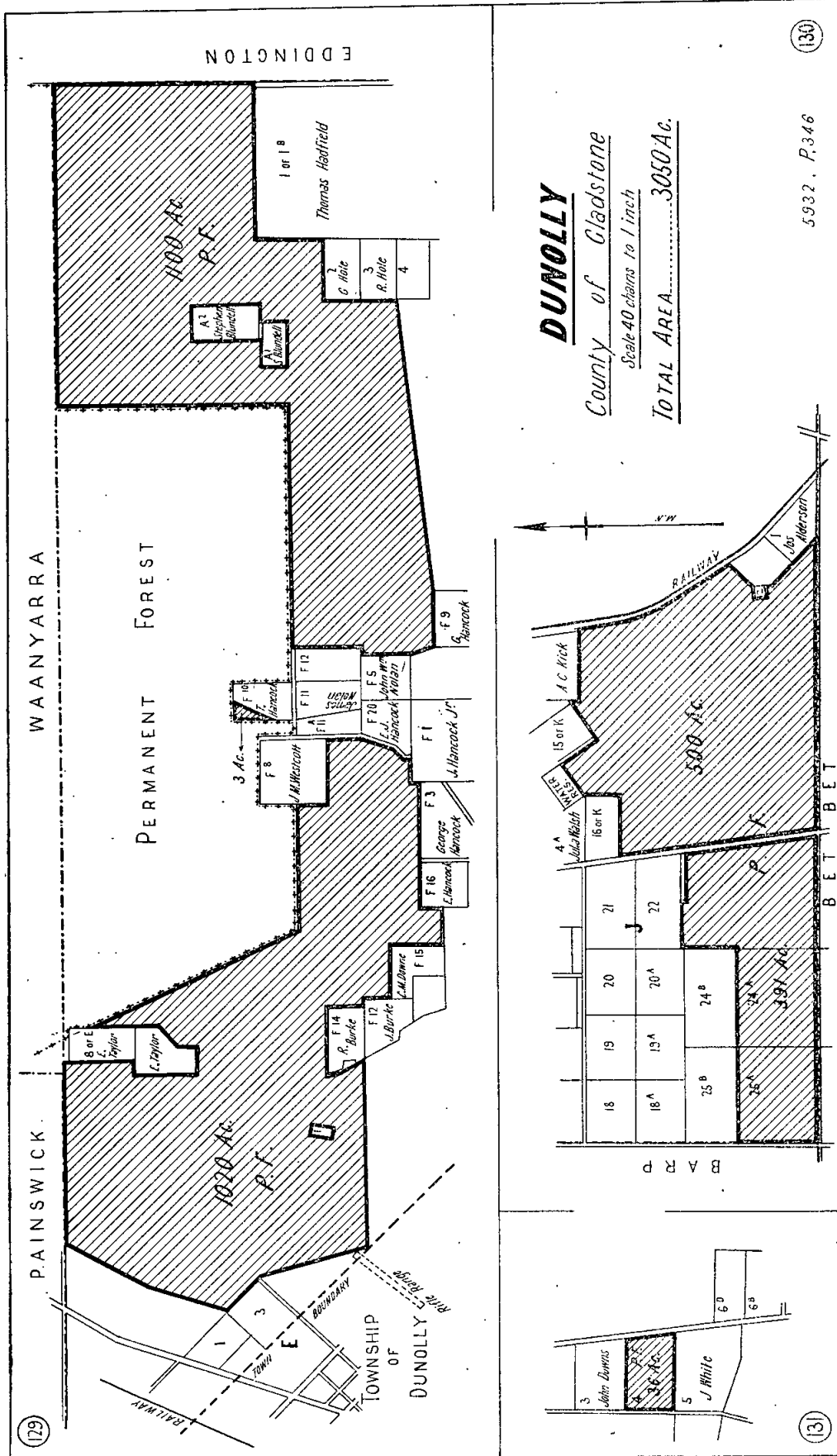

PROPOSED ADDITIONS TO STATE FORESTS.—DIAGRAMS TO ACCOMPANY SCHEDULE NO. 17.—continued.

