



VICTORIA GOVERNMENT GAZETTE.

Published by Authority.

[Registered at the General Post Office, Melbourne, for transmission by post as a newspaper.]

No. 92.]

THURSDAY, APRIL 27.

[1916.]

STATE FORESTS DEPARTMENT. LAND DEDICATED AS PERMANENT FORESTS AND TIMBER RESERVES.

At the Executive Council Chamber, Melbourne, the eighteenth day of April, 1916.

PRESENT:

His Excellency the Governor of Victoria.

Sir A. J. Peacock
Mr. McLeod

Mr. Adamson.

HIS Excellency the Governor of the State of Victoria, with the advice of the Executive Council thereof, in pursuance of the provisions of section 20 of the *Forests Act 1915*, and upon the recommendation of the Minister of Forests, doth by this Order dedicate as Permanent Forests and Timber Reserves respectively the land described hereunder, that is to say:—

SCHEDULE No. 18.

NOTE.—The areas given in the columns and on the diagrams are approximate.

Diagram.	Correspondence Numbers.		Parish.	Plan.	County.	Area in Acres.	
						Permanent Forest.	Timber Reserve.
194	77108	5109	Gobur	209A	Anglesey	657
195	550	1840	Steavenson	R ¹	"	1,175	
196	795	1841	Taggerty	419	"	320	
197-8	70321	135	Eppalock	185	Bendigo	720	
199	77351	608	Ellinging	N ²	Buln Buln	396	
200	77346	606	Noojee	N ²	"	2,571	
202	77228	5851	Dean	158	Grant	66	
203-4	70283	6689	St. Arnaud	400A	Kara Kara	229	117
208	77069	4876	Kentbruck	247B	Normanby	7,258	
207	77414	1149	Napier	346	"	412
205-6	70664	2244	Narrawong	349	"	2,360	
209	77413	1147	Weccurra	486	"	743
210	76915	3803	Drik Drik	166	"	475	
202	77228	5851	Dean	158	Talbot	544	
201	77228	5851	Bullarook	80	"	60	
						16,174	1,929

Permanent Forest..	Acres.
Timber Reserve	16,174
			1,929
Total Area	18,103

And the Honorable T. Livingston, His Majesty's Minister of Forests for the State of Victoria, shall give the necessary directions herein accordingly.

F. W. MABBOTT,
Clerk of the Executive Council.

LAND DEDICATED AS PERMANENT FORESTS AND TIMBER RESERVES.—DIAGRAMS TO ACCOMPANY SCHEDULE No. 18.

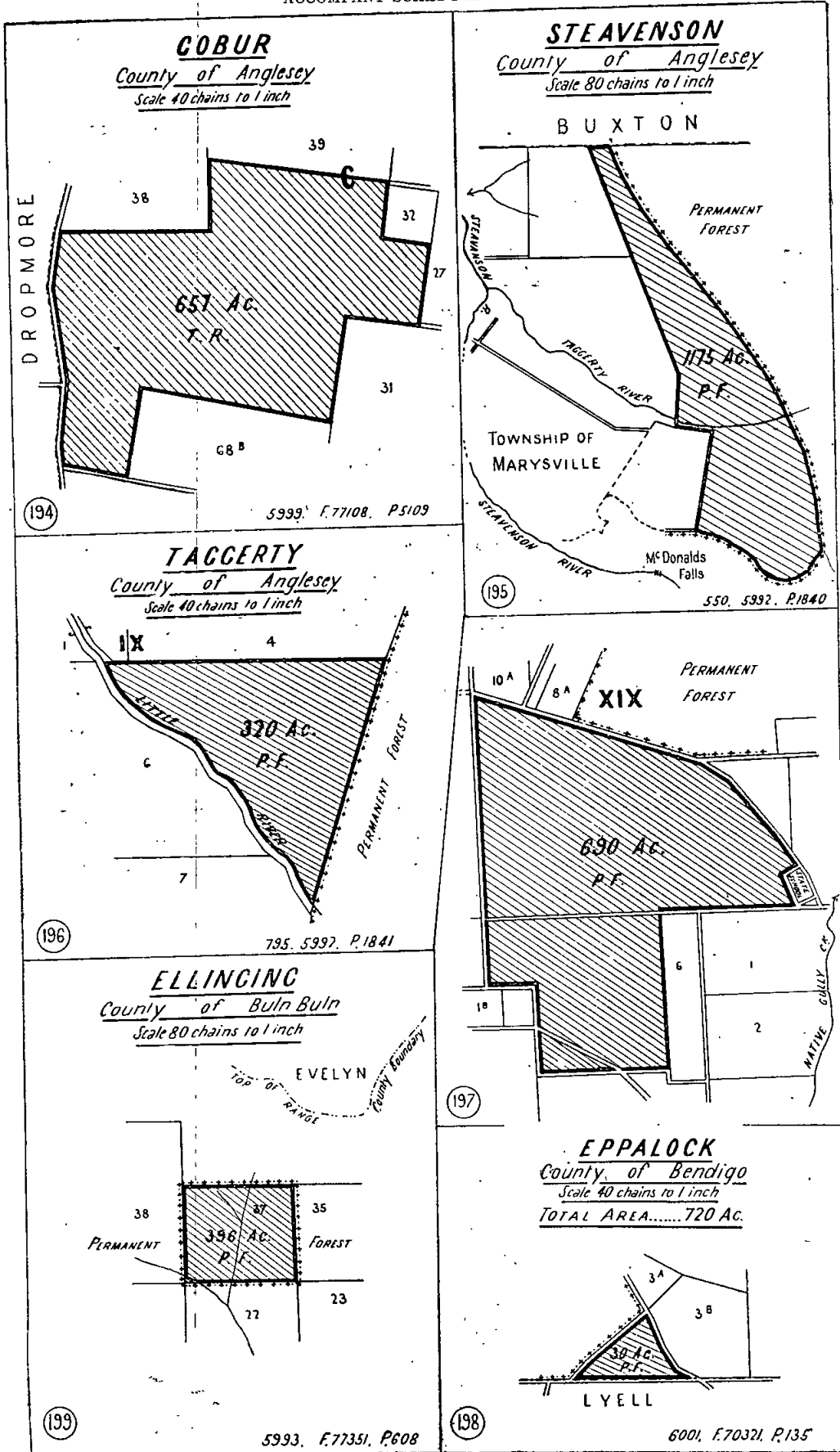

LAND DEDICATED AS PERMANENT FORESTS AND TIMBER RESERVES.—DIAGRAMS TO ACCOMPANY SCHEDULE No. 18—
Continued.

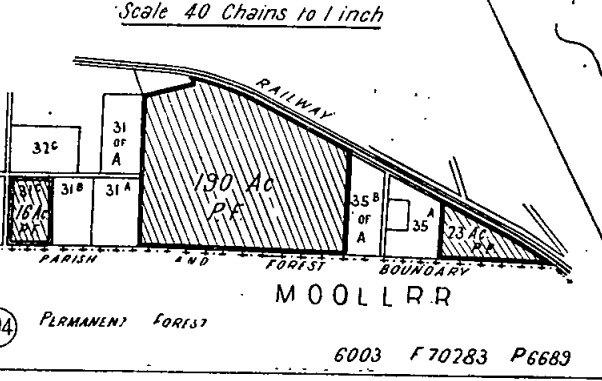
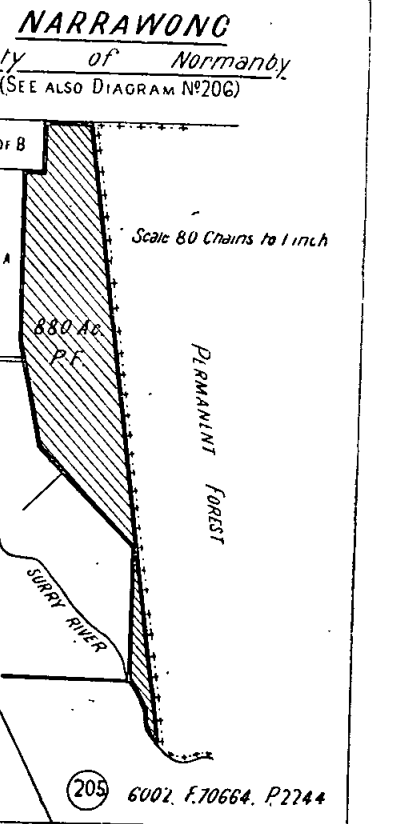
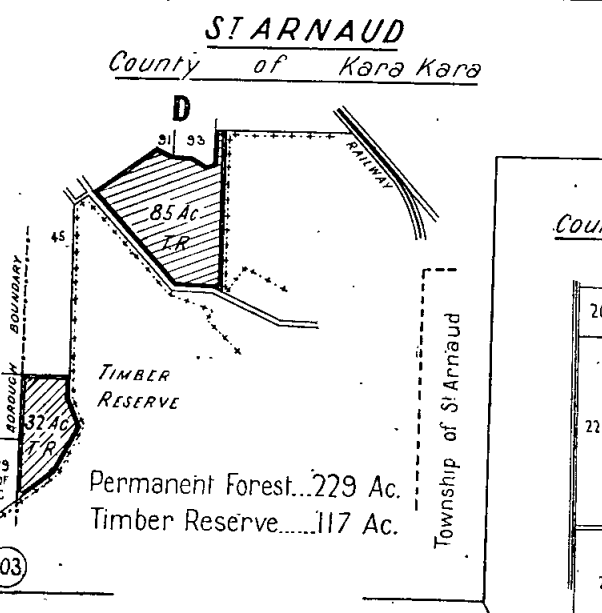
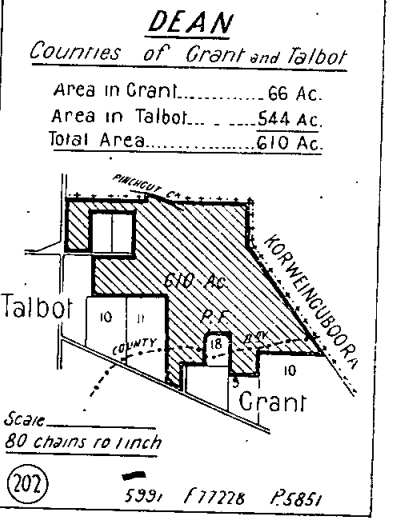
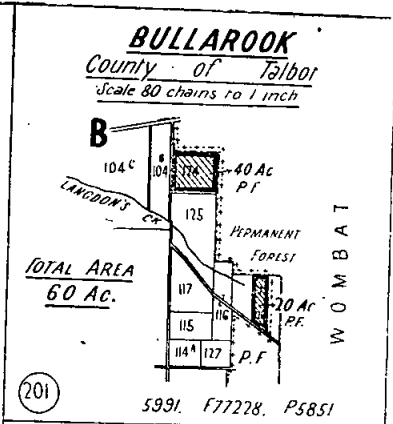
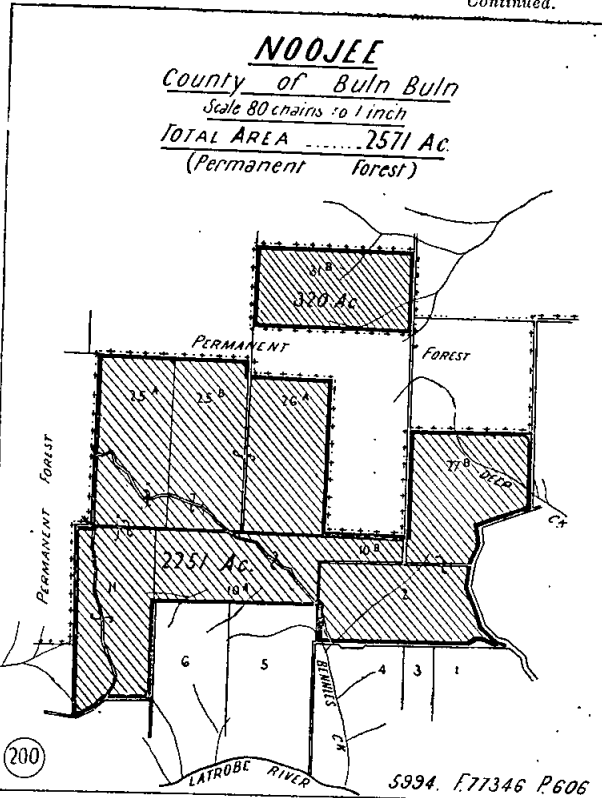

LAND DEDICATED AS PERMANENT FORESTS AND TIMBER RESERVES.—DIAGRAMS TO ACCOMPANY SCHEDULE NO. 18—
Continued.

