

# VICTORIA GOVERNMENT G A Z E T T E

No. G 24 Wednesday 20 June 1990  
By Authority Jean Gordon Government Printer Melbourne

**GENERAL**

## Gazette Services

The *Victoria Government Gazette* (VGG) is published by VGPO for the State of Victoria and is produced in three editions.

**VGG General** is published each Wednesday and provides information regarding Acts of Parliament and their effective date of operation; Government notices; requests for tenders; as well as contracts and contracts accepted. Private notices are also published.

**VGG Special** is published any day when required for urgent or special Government notices. VGG Special is made available automatically to subscribers of VGG General.

**VGG Periodical** is published on Monday when required and includes specialised information eg. Medical, Dental, Pharmacist's Registers, etc.

## Government Advertising

### Publishing Details

The following Guidelines should be followed to ensure publication of Government material in the *Victoria Government Gazette*.

- Duplicate copies should be submitted for use by the Gazette Officer.
- Material submitted to the Executive Council for gazettal will normally be published in the following week's issue.
- Where urgent gazettal is required, contact:  
Gerd Gaspar  
Gazette Officer  
Department of the Premier and Cabinet  
2nd Floor | Treasury Place  
Melbourne 3000  
Telephone Inquiries (03) 651 5153
- Government advertising other than material for the consideration of the Executive Council should be forwarded to the Gazette Office no later than 9.30 am on Tuesday.
- Lengthy or complicated notices should be forwarded several days before publication.
- Proofs will be supplied only when requested or at the direction of the Gazette Officer.
- No additions or amendments to material for publication will be accepted by telephone.
- Double rates for advertising in the Special Gazette will apply.

## Private Advertising

### Publishing Details. Send copy to:

VGPO Coordinator  
Gazette Advertising  
VGPO  
66-112 Macaulay Road  
North Melbourne  
(PO Box 203 North Melbourne 3051)  
Telephone inquiries (03) 320 0100  
Fax No. (03) 328 1657

### Advertising Rates and Payment

Single column x cm/part cm \$4.10  
Double column x cm/part cm \$8.20  
Full page \$171.50

Cheques should be made payable to 'VGPO'.  
These rates apply to advertisements printed on or after 14 February 1990.

### Advertisers should note:

- There are approximately 20 words to each column centimetre depth.
- Signatures (in particular) and proper names must also be in block letters.
- All material should be double spaced.
- Advertisements can be faxed, and a cover sheet should be used, marked to the attention of the Gazette Coordinator.
- Documents not clearly prepared and in the exact format for gazettal will be returned to the sender unpublished.
- Late copy received at VGPO after 11.00 am Tuesday will be placed in the following issue of VGG, irrespective of any date/s mentioned in the copy (unless otherwise advised).

### Copy Deadline

11.00 am Tuesday

## Subscriptions

VGG is available by three subscription services:

General and Special—\$118.00 each year  
General, Special and Periodical—\$136.00 each year  
Periodical—\$71.00 each year

Subscriptions are payable in advance and accepted for a period of one year. All subscriptions are on a firm basis and refunds for cancellations will not be given.

All payments should be made payable to VGPO.

Subscription inquiries: (03) 320 0217  
Bookshop Inquiries: (03) 663 3760

# PROCLAMATIONS

## Bank Holidays Act 1958

### PROCLAMATION BANK HOLIDAYS

I, J. Davis McCaughey, Governor of Victoria acting with the advice of the Executive Council and under section 5 of the *Bank Holidays Act* 1958, appoint the days and dates mentioned hereunder to be observed as Bank Holidays at the places specified.

Friday, 27 July 1990—Throughout the Shire of Warracknabeal;

Wednesday, 22 August 1990—Throughout the Townships of Wedderburn and Korong Vale.

Given under my hand and the seal of  
Victoria on 13 June 1990

(L.S.) J. DAVIS McCaughey

By His Excellency's Command

N. A. POPE  
Minister for Labour

## Public Service Act 1974

### PROCLAMATION

#### PUBLIC HOLIDAY AND HALF-HOLIDAY

I, J. Davis McCaughey, Governor of Victoria, acting with the advice of the Executive Council and under section 71 (2) of the *Public Service Act* 1974, appoint the days and dates mentioned hereunder to be observed as Public Holiday and Public Half-Holiday at the places specified.

#### Public Holiday

Wednesday, 22 August 1990—Throughout the Townships of Wedderburn and Korong Vale.

#### Public Half-Holiday

Friday, 27 July 1990—Throughout the Shire of Warracknabeal.

Given under my hand and the seal of  
Victoria on 13 June 1990

(L.S.) J. DAVIS McCaughey

By His Excellency's Command

N. A. POPE  
Minister for Labour

## Victoria University of Technology Act 1990

### PROCLAMATION OF COMMENCEMENT

I, J. Davis McCaughey, Governor of Victoria, acting with the advice of the Executive Council and under section 2 of the *Victoria University of Technology Act* 1990, and all other enabling powers, fix 1 July 1990 as the day on which the parts and sections of the Act shown in the attached Schedule shall come into operation.

#### Schedule

Parts 1-7 inclusive;

Section 60;  
Section 69 (1);  
Section 70;  
Section 71 (1).

Given under my hand and the seal of  
Victoria on 13 June 1990

(L.S.) J. DAVIS McCaughey

By His Excellency's Command

J. E. KIRNER  
Minister for Education

## Reference Areas Act 1978

### DEPARTMENT OF CONSERVATION AND ENVIRONMENT

#### Proclamation of the Walsh's Creek Reference Area

I, J. Davis McCaughey, Governor of the State of Victoria, acting with the advice of the Executive Council and under section 4 of the *Reference Areas Act* 1978, proclaim the area shown on Plan No. R.A. 4 in the attached Schedule, the original of which is lodged at the Department of Conservation and Environment, 240 Victoria Parade, East Melbourne, 3002, to be the Walsh's Creek Reference Area.

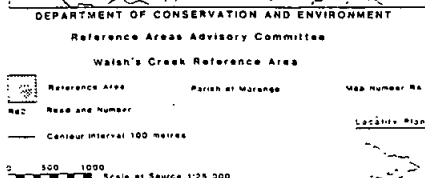
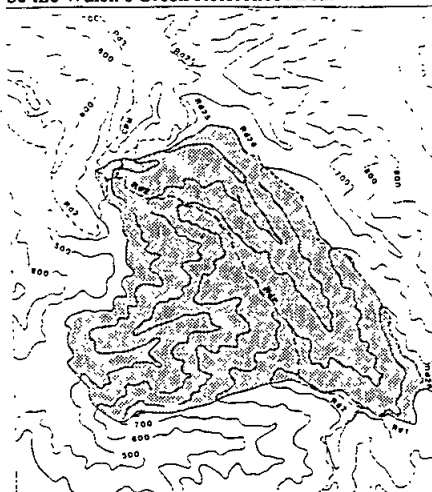

*Victoria Government Gazette*

Given under my hand and the seal of the  
State of Victoria on 13 June 1990

(L.S.) J. DAVIS McCAUGHEY

By His Excellency's Command

S. M. CRABB

Minister for Conservation and Environment

*Reference Areas Act 1978*

DEPARTMENT OF CONSERVATION AND  
ENVIRONMENT

Proclamation of the Mount Gregory Reference  
Area

I, J. Davis McCaughey, Governor of the State  
of Victoria, acting with the advice of the  
Executive Council and under section 4 of the  
*Reference Areas Act 1978*, proclaim the area  
shown on Plan No. R.A. 3 in the attached  
Schedule, the original of which is lodged at the  
Department of Conservation and Environment,  
240 Victoria Parade, East Melbourne, 3002, to  
be the Mount Gregory Reference Area.

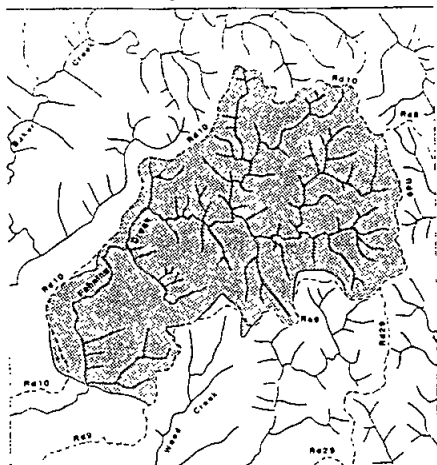

DEPARTMENT OF CONSERVATION AND ENVIRONMENT

Reference Areas Advisory Committee

Mt Gregory Reference Area



Reference Area

Parish of Coburn

Map Number R.A.3

Scale and Number



Scale of Source 1:25 000

Locality Plan



Given under my hand and the seal of the  
State of Victoria on 13 June 1990

(L.S.) J. DAVIS McCAUGHEY

By His Excellency's Command

S. M. CRABB

Minister for Conservation and Environment

G 24 20 June 1990 1863

*Shop Trading (Amendment) Act 1990*

PROCLAMATION OF COMMENCEMENT

I, J. Davis McCaughey, Governor of Victoria,  
acting on the advice of the Executive Council  
and under section 2 of the *Shop Trading  
(Amendment) Act 1990* fix 20 June 1990 as the  
day on which the Act comes into operation.

Given under my hand and the seal of the  
State of Victoria on 19 June 1990

(L.S.) J. DAVIS McCAUGHEY

By His Excellency's Command

B. W. MIER

Minister for Consumer Affairs

*Petroleum (Submerged Lands) (Amendment)  
Act 1990*

PROCLAMATION OF COMMENCEMENT

I, J. Davis McCaughey, Governor of Victoria,  
acting with the advice of the Executive Council  
and under section 2 of the *Petroleum (Submerged  
Lands) (Amendment) Act 1990*, No. 12 fix 1 July  
1990 as the day on which the Act comes into  
operation.

Given under my hand and the seal of  
Victoria on 13 June 1990

(L.S.) J. DAVIS McCAUGHEY

By His Excellency's Command

D. R. WHITE

Minister for Industry and Economic Planning

## GOVERNMENT NOTICES

*Penalties and Sentences Act 1985*APPOINTMENT OF YOUTH  
ATTENDANCE PROJECTS

I, John Pryde Paterson, Director-General of Community Services, under section 58 of the *Penalties and Sentences Act 1985* appoint as Youth Attendance Projects for offenders of or over the age of 15 years who have received a Youth Attendance Order from a Children's Court or a Court hearing an appeal in respect of a Children's Court Order, being employment and/or other activities conducted at the locations shown:

Central Gippsland Youth Attendance Project, located at 81 Buckley Street, Morwell, conducted by the Central Gippsland Regional Centre of Community Services Victoria, located at 81 Buckley Street, Morwell 3840.

Central Highlands Youth Attendance Project, located at Corner Mair and Doveton Streets, Ballarat, conducted by the Central Highlands Regional Centre of Community Services Victoria, located at Corner Mair and Doveton Streets, Ballarat 3350.

East Gippsland Youth Attendance Project, located at 66 McCulloch Street, Bairnsdale, conducted by the East Gippsland Regional Centre of Community Services Victoria, located at 66 McCulloch Street, Bairnsdale 3875.

Glenelg Youth Attendance Project, located at 1 Kerr Street, Warrnambool, conducted by the Glenelg Regional Centre of Community Services Victoria, located at 1 Kerr Street, Warrnambool 3280.

Goulburn Youth Attendance Project, located at Corner Welsford and Vaughan Streets, Shepparton, conducted by Goulburn Regional Centre of Community Services Victoria, located at Corner Welsford and Vaughan Streets, Shepparton 3630.

Loddon-Campaspe Youth Attendance Project, located at Bath Lane, Bendigo, conducted by Loddon-Campaspe Regional Centre of Community Services Victoria, located at Bath Lane, Bendigo 3550.

Mallee Youth Attendance Project, located at 253 Eleventh Street, Mildura, conducted by Mallee Regional Centre of Community Services Victoria, located at 253 Eleventh Street, Mildura 3500.

Upper Murray Youth Attendance Project, located at 106 Hovell Street, Wodonga, conducted by Upper Murray Regional Centre of Community Services Victoria, located at 106 Hovell Street, Wodonga 3690.

Wimmera Youth Attendance Project, located at 48 McLachlan Street, Horsham, conducted by Wimmera Regional Centre of Community Services Victoria, located at 48 McLachlan Street, Horsham 3400.

Dated 12 June 1990

JOHN PRYDE PATERSON  
Director-General  
Community Services Victoria

## State Electoral Office

NOTICE OF APPLICATION FOR  
REGISTRATION OF A POLITICAL PARTY

The following application has been received for registration of a political party under the *The Constitution Act Amendment Act 1958*.

Name of party: Green Alliance.

Abbreviation of name of party: The Greens.

Name and address of proposed registered officer: Chris Spindler, 10 University Street, Carlton 3053, Victoria.

The application is made, and signed by, ten members of the party. The application states their names and addresses as follows:

- A. Bath, 10 Howard Street, Brunswick,
- D. Neal, 20 The Crofts, Richmond,
- B. Machin, 129 Gold Street, Brunswick,
- R. Miller, 43 Wellington Street, Richmond,
- M. McGregor, Lead Lane, Avoca,
- K. McGregor, Lead Lane, Avoca,
- L. Asquini, 63 James Street, Northcote,
- J. Robertson, 8 Summit Crescent, Ringwood,
- J. Campbell, 77 Cecil Street, East Kew,
- J. Cheng, 2 Nareeb Court, Toorak.

In its application the party states that it has or operates under a constitution, a copy of which accompanied the application.

Any persons who believe that this application—

- (i) does not relate to a political party that has at least 500 members;
- (ii) is not in accordance with section 148D of the Act, including that it is not made by ten members of the party;
- (iii) should not be considered by reason of section 148F of the Act; or
- (iv) should be refused under section 148G of the Act, in that the name of the party or the abbreviation of the name that the party wishes to be able to use for the purposes of the Act is too long, is obscene, or is the name (or too closely resembles the name)

of another political party—not being a political party that is related to the party to which the application relates—that is a Parliamentary party or a registered political party;

are invited to submit written particulars of the grounds for that belief to the Electoral Commissioner by 18 July 1990.

Particulars submitted by a person in response to this notice must be signed by, and specify an address of, that person and must be sent to the Electoral Commissioner, State Electoral Office, Sixth Floor, 22 William Street, Melbourne 3000.

This notice is placed as required by section 148K of the *Constitution Act Amendment Act 1958*.

G. P. LYONS  
Electoral Commissioner

*Co-operation Act 1981*

MONTY CO-OPERATIVE SOCIETY  
LIMITED

LUPIN GROWERS ASSOCIATION CO-  
OPERATIVE LIMITED

DINGLEY SCOUT CENTRE CO-  
OPERATIVE LIMITED

ROSEBUD FOOTBALL SOCIAL CLUB CO-  
OPERATIVE LIMITED

Notice is hereby given in pursuance of section 192 (8) of the *Co-operation Act 1981* and section 459 (2) of the *Companies (Victoria) Code*, that, at the expiration of three months from the date hereof, the names of the aforementioned societies will, unless cause is shown to the contrary, be struck off the register and the societies will be dissolved.

Dated at Melbourne 12 May 1990.

D. F. HENRY  
Deputy Registrar of Co-operative Societies

*Transport Act 1983*

ROAD DECLARATIONS AND  
DEDICATIONS

The Roads Corporation, pursuant to the *Transport Act 1983*, upon publication of this notice declares the, or varies the declaration of, roads as described below and on the plans attached and further declares that such roads are fit to be used as a public highway and are now absolutely dedicated to the public for use as public highways within the meaning of any law now or hereafter in force.

Highways

R133/90 Tallangatta-Corryong Road and Corryong Road (as Murray Valley Highway), shown by heavy line on plan numbered GP D-89-92.

R134/90 Murray Valley Highway (part), shown by heavy line on plan numbered GP R-89-92A.

R135/90 Monbulk Road (part) (as Burwood Highway), shown by heavy line on plan numbered GP D-89-48D.

Main Roads

R136/90 Hull Road (part); Mooroolbark Road; York Road; and Clegg Road, shown by heavy line on plan numbered GP D-89-44.

R137/90 Sybella Avenue, shown by heavy line on plan numbered GP D-89-59B.

R138/90 Army Road (as Healesville-Koo-wee-rup Road), shown by heavy line, and excluding Healesville-Koo-wee-rup Road (parts); and Koo-wee-rup North-Nar Nar Goon Road, shown by heavy dotted line on plan numbered GP D-89-60.

R139/90 Arcadia Road; Harrys Creek Road; Euroa-Strathbogie Road; and Merton-Strathbogie Road, shown by heavy line on plan numbered GP R-89-64A.

R140/90 By varying Yarrawonga-Katamatite Road; and Benalla-Yarrawonga Road; and excluding Wangaratta-Yarrawonga Road (part), shown by heavy line and heavy dotted line on plan numbered GP D-89-65, and renaming Wangaratta-Yarrawonga Road (part) as Benalla-Yarrawonga Road, shown by small broken line.

R141/90 Tungamah-Peechelba Road (part); St James Road; and Peechelba Road, shown by heavy line on plan numbered GP R-89-65.

R142/90 Highlands Road; and Molesworth-Dropmore Road, shown by heavy line on plan numbered GP R-89-75A.

R143/90 By varying Buffalo River Road, shown by heavy line and heavy dotted line on plan numbered GP D-89-87B.

R144/90 Buffalo River Road (part), shown by heavy line on plan numbered GP R-89-87B.

R145/90 Barnawartha-Howlong Road (part); Chiltern-Barnawartha Road; and Indigo Creek Road, shown by heavy line on plan numbered GP R-89-89.

R146/90 Stanley Road (part) shown by heavy line on plan numbered GP R-89-91.

R147/90 Allans Flat Road (part) and Lindsay Road (as Lindsay Road), shown by heavy line on plan numbered GP D89-91B.

R148/90 Murray River Road (formerly part Murray Valley Highway), shown by heavy line on plan numbered GP D-89-92A.

R149/90 Upper Murray Road; and Cudgewa Road, shown by heavy line on plan numbered GP R-89-92B.

1866 G 24 20 June 1990

Victoria Government Gazette

ROADS CORPORATION  
STATE HIGHWAY  
MURRAY VALLEY HIGHWAY  
SHIRES OF TALLANGATTA & UPPER MURRAY

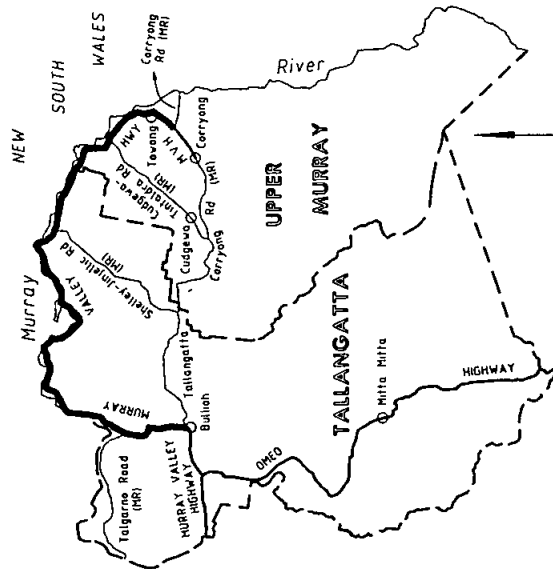

LEGEND: EXCLUDE

GP R\_89\_92A

ROADS CORPORATION  
STATE HIGHWAY  
MURRAY VALLEY HIGHWAY  
SHIRES OF TALLANGATTA  
AND UPPER MURRAY

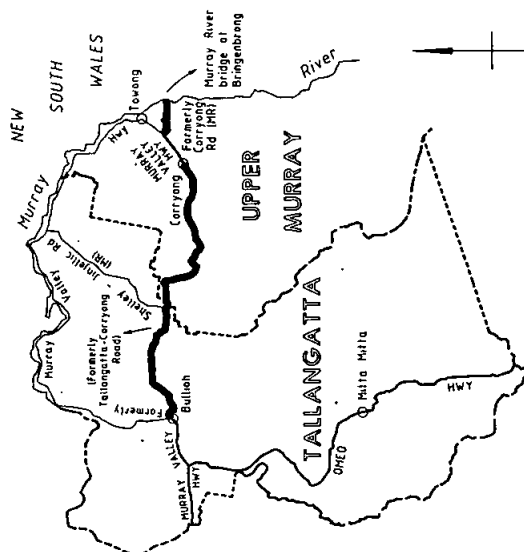

LEGEND: INCLUDE

GP D\_89\_92

ROADS CORPORATION  
STATE HIGHWAY  
BURWOOD HIGHWAY  
SHIRE OF SHERBROOKE

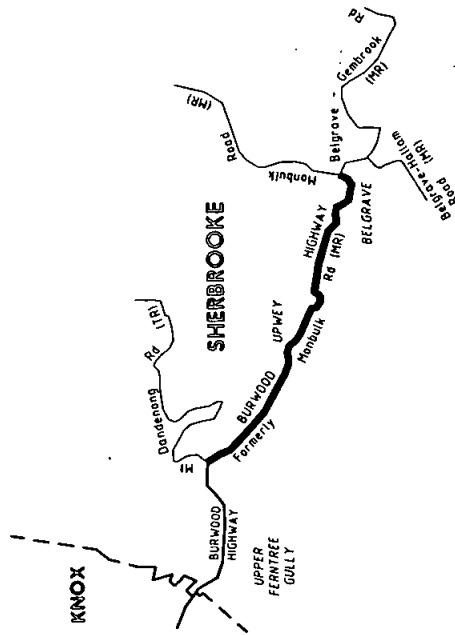

LEGEND: INCLUDE

GP D\_89\_48D

ROADS CORPORATION  
MAIN ROADS  
SHIRE OF LILLYDALE

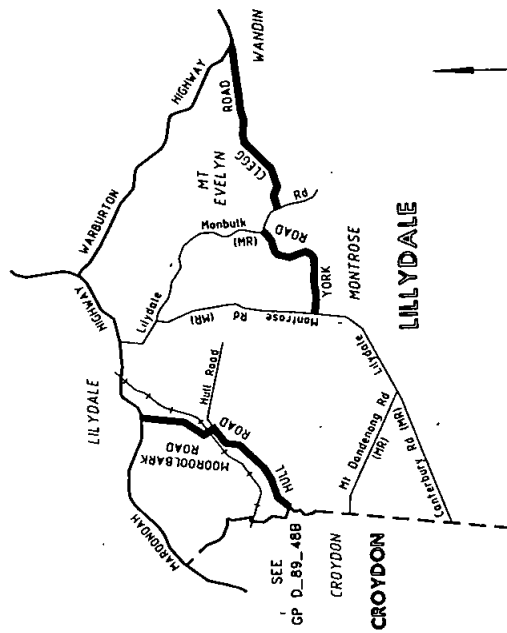

LEGEND: INCLUDE

GP D\_89\_44

1868 G 24 20 June 1990

Victoria Government Gazette

ROADS CORPORATION  
MAIN ROAD  
SYBELLA AVENUE  
SHIRE OF CRANBOURNE

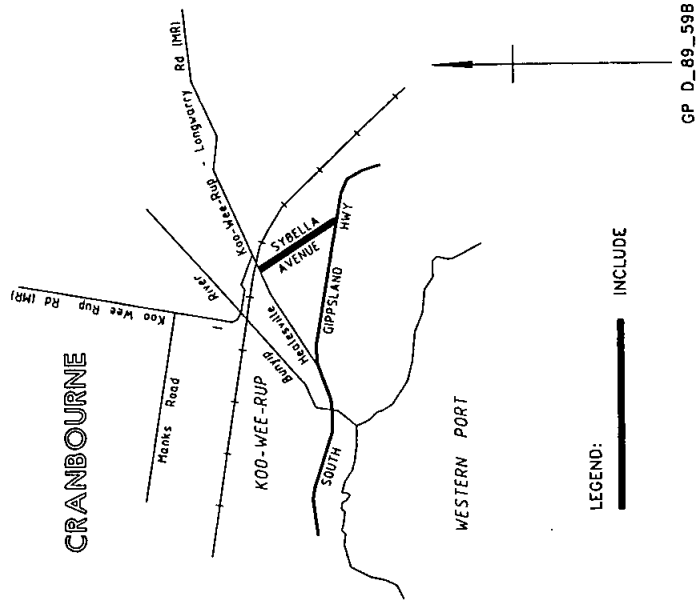

ROADS CORPORATION  
MAIN ROADS  
HEALESVILLE - KOO-WEE-RUP ROAD  
KOO-WEE-RUP NORTH-NAR NAR GOON ROAD  
SHIRES OF PAKENHAM  
& CRANBOURNE

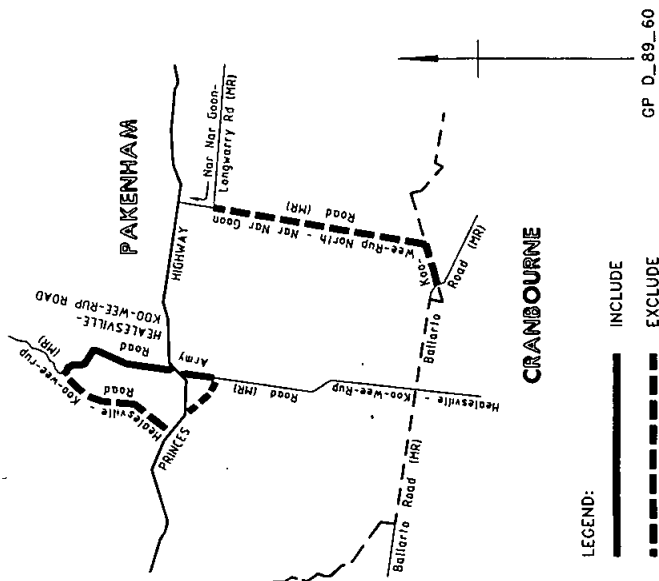



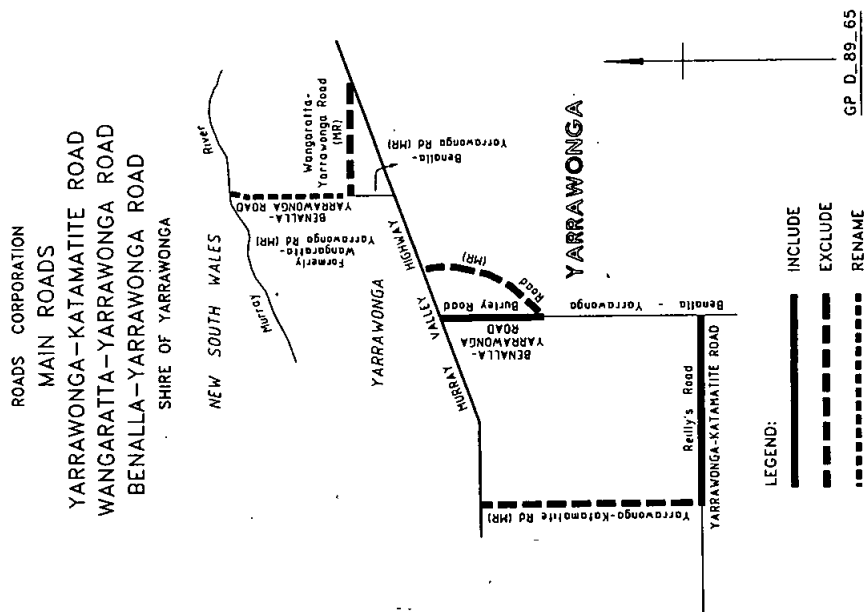
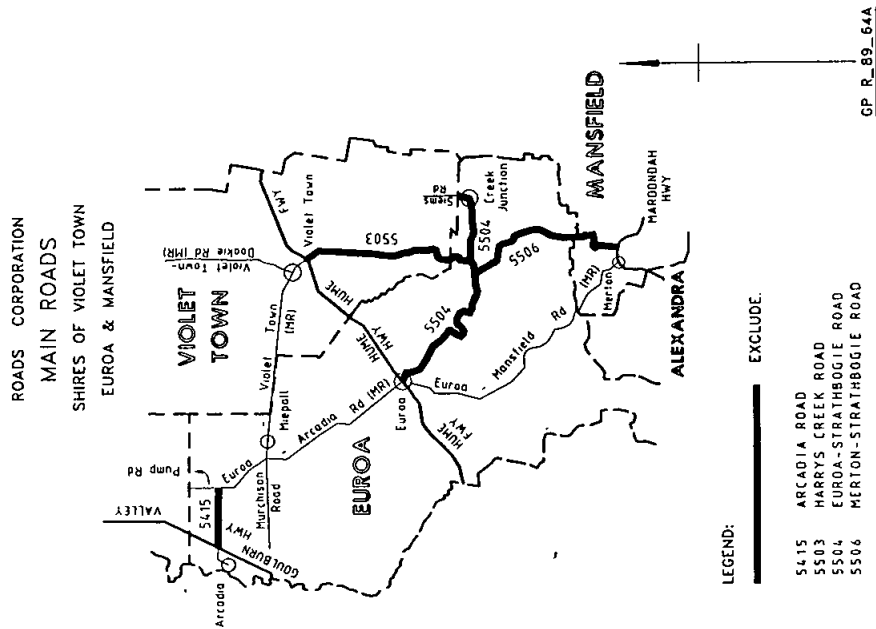

ROADS CORPORATION  
MAIN ROADS  
HIGHLANDS ROAD  
MOLESWORTH-DROPMORE ROAD  
SHIRES OF SEYMOUR & YEA

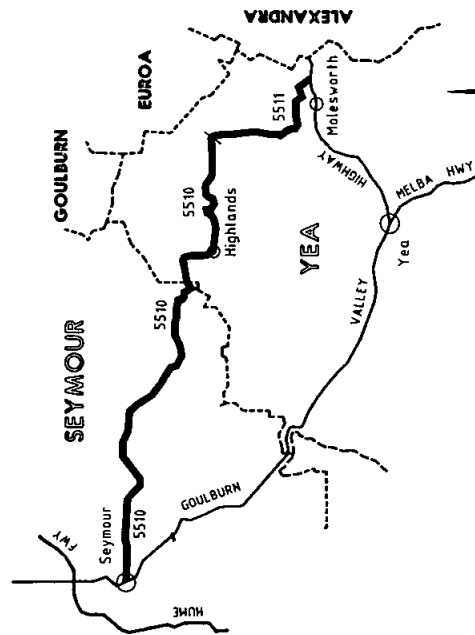

LEGEND:  
EXCLUDE

5510 HIGHLANDS ROAD  
5511 MOLESWORTH-DROPMORE ROAD

GP R\_89\_75A

ROADS CORPORATION  
MAIN ROADS  
SHIRES OF TUNGAMAH  
YARRAWONGA & WANGARATTA

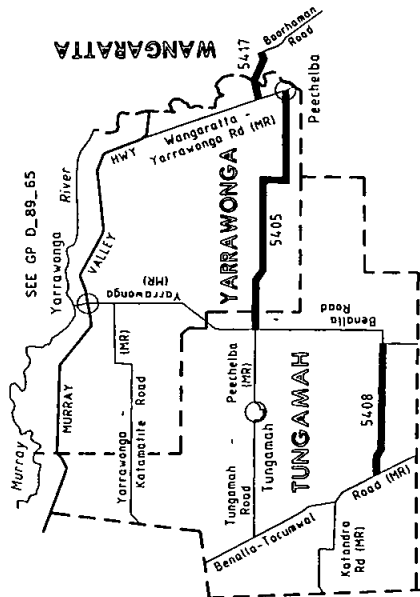

5405 TUNGAMAH-PEECHELBA ROAD (Part)  
5408 ST JAMES ROAD  
5417 PEECELBA ROAD

LEGEND:  
EXCLUDE

GP R\_89\_65

ROADS CORPORATION  
MAIN ROAD  
BUFFALO RIVER ROAD  
SHIRES OF OXLEY & MYRTLEFORD

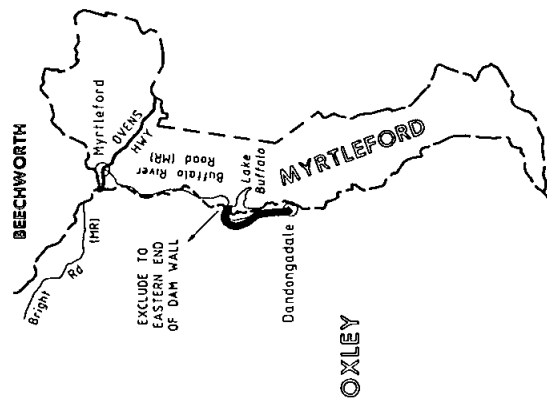

LEGEND:

EXCLUDE

GP R\_89\_87B

ROADS CORPORATION  
MAIN ROAD  
BUFFALO RIVER ROAD  
SHIRE OF MYRTLEFORD

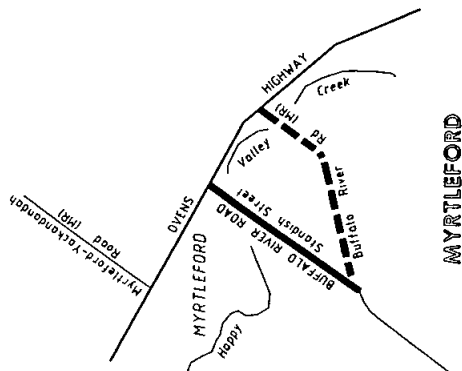

LEGEND:

INCLUDE

EXCLUDE

GP D\_89\_87B

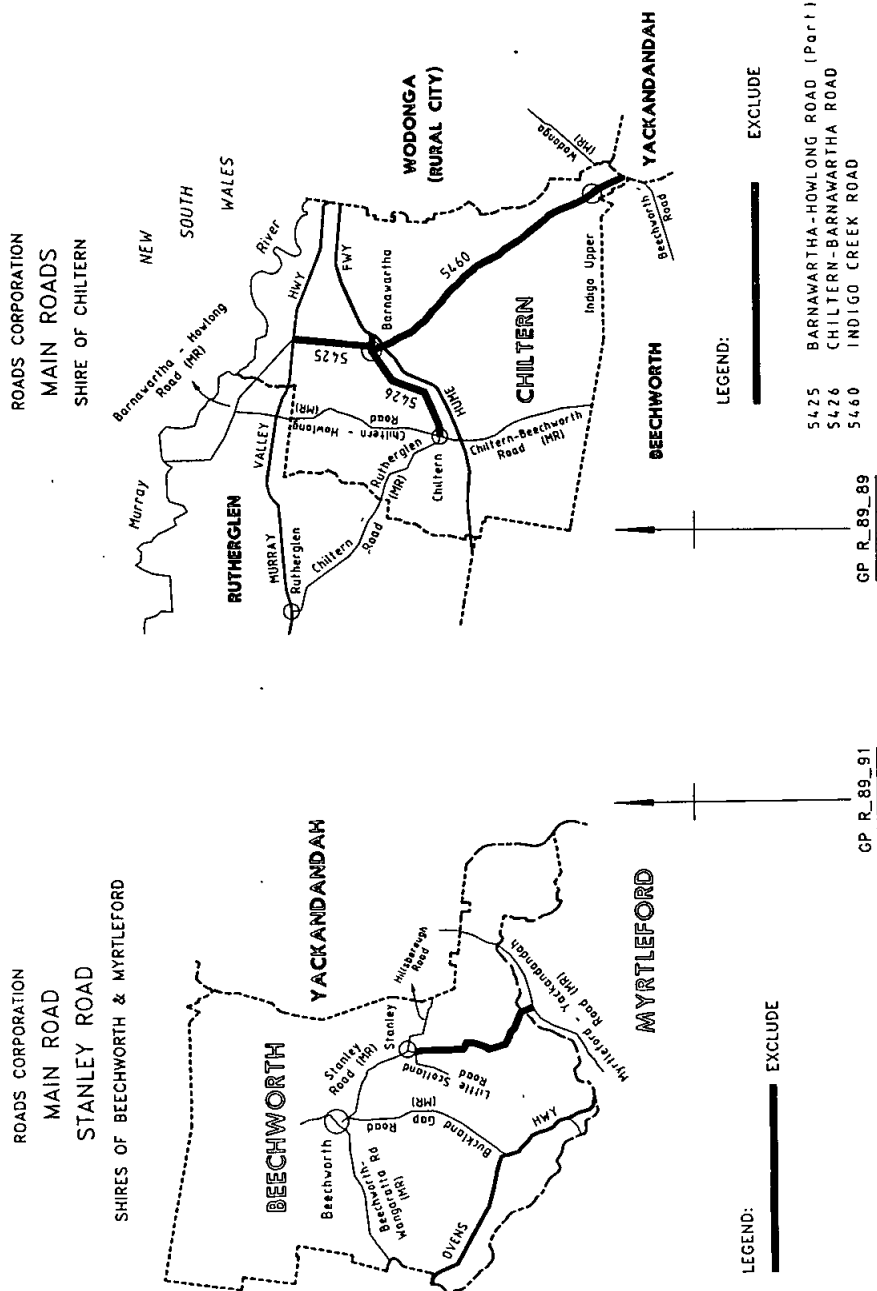

ROADS CORPORATION  
MAIN ROAD  
LINDSAY ROAD  
SHIRE OF YACKANDANDAH

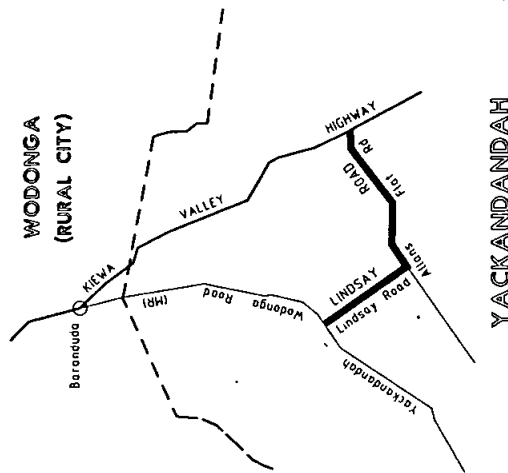

LEGEND: INCLUDE

GP D\_89\_91B

ROADS CORPORATION  
MAIN ROAD  
MURRAY RIVER ROAD  
SHIRES OF TALLANGATTA & UPPER MURRAY

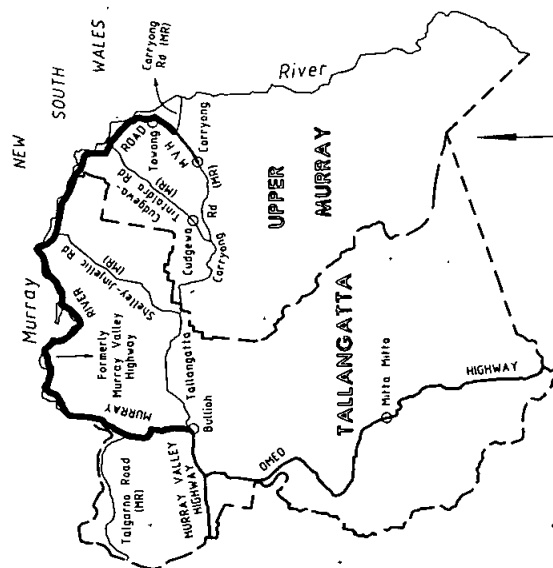

LEGEND: INCLUDE

GP D\_89\_92A

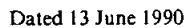

*Transport Act 1983*  
ROADS CORPORATION

Notice is hereby given that the following applications will be considered by the Roads Corporation on 24 July 1990.

It will not be necessary for interested parties to appear on the date specified, unless advised in writing by the Corporation.

**Mee's Bus Lines Pty Ltd, West Heidelberg.**  
Application to license one commercial passenger vehicle in respect of a 1988 Range Rover station wagon with seating capacity for 4 passengers to

R. Scott, Essendon. Application for variation of the conditions of licence SV 325 transferred from Alderay Pty Ltd and not yet taken up, to amend the condition that the licensed vehicle shall be a 1961-1964 Mark 10 Jaguar sedan to a 1968 420 G (updated Mark 10) Jaguar sedan with seating capacity for 4 passengers.

B. T. Witton, Korumburra. Application to license one class I tow truck to be purchased to operate from a depot situated at 40 Commercial Street, Korumburra for the purpose of lifting and carrying or towing damaged or disabled motor cars throughout the State of Victoria excluding the ability to attend the scene of a motor car accident.

**GEOFF S. HUGHES**  
Manager, Vehicle Licensing

# NOTICE OF ACQUISITION

## Compulsory Acquisition of Interest in Land

The Roads Corporation declares that by this notice it acquires the following interests in the land described hereunder:

*Owners' Names:* Messrs E. F. and R. A. Andrews.

*Description of Interest in Land:* being part of Crown Allotments 19A and 19B, section 5 and part of Crown Allotments 19, 34, 27 and 25, section 4 and part of Crown Allotments 18, 17, 16, 13 and 11, section 4, Township of Nerrina, Parish of Ballarat.

*Area:* 14.63 hectares.

*Title Details:* Certificate of Title Volume; Folio

6443	429
8167	783
8167	781
8167	782
8712	014
5825	959
2553	425
8712	012
3382	246
6747	286
5710	822

## Survey Plans:

17790A shown as parcels 3 and 4;

17791 shown as parcels 1 to 6;

17792 shown as parcels 3 to 5, 7 and 10 to 12.

The survey plans referred to in this notice may be viewed at 60 Denmark Street, Kew 3101.

Published with the authority of the Roads Corporation and the Minister for Transport.

TIM HOLDEN  
Manager, Property Acquisition  
Roads Corporation

Land Acquisition and Compensation Act 1986  
Land Acquisition and Compensation  
Regulations 1987

Form 7

S.21  
Reg. 16

# NOTICE OF ACQUISITION

## Compulsory Acquisition of Interest in Land

The Minister for Education declares that by this notice she acquires the following interest in the land described as 1.259 hectares situated on the north side of the Maffra-Briagolong Road,

G 24 20 June 1990 1875

Briagolong described as part Crown Allotment 15A, Parish of Briagolong, more particularly being the land shown hatched on the plan below.

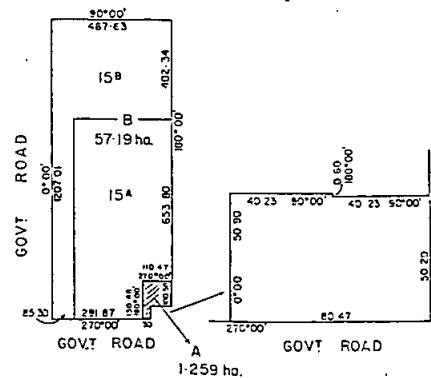

An interest as owner in fee simple of the land.  
Published with the authority of the Minister  
for Education.

J. E. KIRNER  
Minister for Education

## MELBOURNE AND METROPOLITAN BOARD OF WORKS

Notice to the owners of tenements in the undermentioned streets and the private streets, lanes, courts and alleys opening thereto. The main pipe in the said streets being laid down, the owners of all tenements situated as under are hereby required on or before 21 July 1990 to cause a proper pipe line and stop-cocks to be laid so as to supply water within such tenements from the main pipe.

## BROADMEADOWS

Bicentennial Crescent, from Shankland Boulevard, the total street.

Mitta Mitta Way, from Bicentennial Crescent, the total street.

Coorong Court, from Bicentennial Crescent, the total street.

Gunbower Crescent, from Bicentennial Crescent, the total street.

Hopkins Way, from Bicentennial Crescent, the total street.

Tyrell Court, from Hopkins Way, the total street.

Shaba Court, from Bicentennial Crescent, the total street.

Macalister Court, from Bicentennial Crescent, the total street.

Thistle Court, from Bicentennial Crescent, the total street.

1876 G 24 20 June 1990

Nicholson Crescent, from Bicentennial Crescent, southwestwards a distance of 420 metres.

Tarwin Place, from Bicentennial Crescent, the total street.

Green Valley Grove, from Nicholson Crescent, the total street.

Care Close, from Nicholson Crescent, the total street.

Eildon Court, from Nicholson Crescent, the total street.

Jesica Road, from 50 metres east of Adrian Road, 146 metres further eastwards.

Merola Way, from Jesica Road northwards 60 metres.

Sarah Street, from Ari Drive, the total street.

Patrick Street, from Sarah Street northwards a distance of 77 metres.

Ari Drive, from Barry Drive, the total street.

Malcolm Place, from Ari Drive eastwards a distance of 70 metres.

Patrick Street, from Barry Road, the total street.

Barry Road, from Mason Street, 452 metres eastwards.

Fabio Court, from Dynamic Place, the total street.

Hume Highway, from Fabio Court southwards for 241 metres.

#### BULLA

Marleybourne Court, from Piccadilly Court, the total street.

Eden Place, from Piccadilly Court, the total street.

Trafalgar Place, from Piccadilly Court, the total street.

Piccadilly Court, from 32 metres eastward of Hermitage Drive further eastwards and southwards 293 metres.

Normanby Drive, 20 metres southeastwards of Piccadilly Court, further southeastwards 210 metres.

Glenbrook Court, from Normanby Drive, the total street.

Dorset Drive, eastwards from Normanby Drive, 42 metres.

Amesbury Drive, from Edington Way, the total street.

Hothlyn Drive, from Bridgewater Road eastwards 213 metres.

Bridgewater Road, from Hothlyn Drive southwards 333 metres.

Kent Court, from Amesbury Avenue, the total street.

#### Victoria Government Gazette

Dartford Court, from Amesbury Avenue, the total street.

Henley Close, from Amesbury Avenue, the total street.

Lindfield Court, from Manningtree Parade, the total street.

Cameron Court, from Haddington Crescent, the total street.

Haddington Crescent, northwards from Cameron Court 60 metres and southwards from Cameron Court 48 metres.

#### DIAMOND VALLEY

Acheron Crescent, from Manning Road southwestwards 145 metres.

Helwig Avenue, from Manning Road southwards 172 metres.

Cottage Place, from Settlers Way, the total street.

Settlers Way, from Cottage Place southwestwards 168 metres.

#### ELTHAM

Palamino Court, from Bonds Road, the total street.

Sidwell Court, from Harcourt Way, the total street.

Harcourt Way, from Palamino Court southeastwards a distance of 205 metres.

#### WHITTLESEA

Transport Drive, north and south sides from Hume Highway, the total street.

Freight Drive, from Transport Drive eastwards a distance of 130 metres.

Fillo Drive, east and west sides, from Transport Drive southwards 496 metres.

Telopea Crescent, from 56 metres northwards of Mirbelia Crescent, a further 308 metres northwestwards.

Incana Drive, from Telopea Crescent northeastwards 143 metres.

Lutea Court, from Incana Drive, the total street.

Plenty Road, from Centenary Drive southwestwards 370 metres.

Ferraro Close, from Orlit Court, the total street.

Orlit Court, from Longwood Drive, the total street.

Randell Court, from Pindari Avenue, the total street.

Lamina Avenue, from Pindari Avenue westwards, a distance of 34 metres.

Pindari Avenue, 20 metres south of Prince of Wales Avenue, further southwards 251 metres.



Findon Road, south side from Pommel Crescent northwestwards, a distance of 530 metres.

Findon Road, north side from Pommel Crescent northwestwards, a distance of 464 metres.

Cavalier Court, from Findon Road, the total street.

Pommel Crescent, from Findon Road southwestwards, a distance of 205 metres.

Redpath Close, from Pommel Crescent, the total street.

Carousel Court, from Pommel Crescent, the total street.

Dated 13 June 1990

P. R. CALLOW  
Regional Manager  
Northern Region

MELBOURNE AND METROPOLITAN  
BOARD OF WORKS  
General Notice

The Melbourne and Metropolitan Board of Works having made provision for carrying off the sewage of each and every property which or any part of which is situate in the Sewerage Areas hereinafter described doth hereby declare that on and after 20 July 1990 each and every property so situate shall be deemed to be sewered property within the meaning of the *Melbourne and Metropolitan Board of Works Act 1958*.

The Sewerage Areas hereinbefore referred to are:

Sewerage Area No. 8731  
(360/289/0244)

City of Whittlesea—This area comprises all lots Guila Court, lots 2 to 4, 2, 1 and a further lot 1 Cooper Street and a sewerage and drainage reserve at the rear of Guila Court and contains 33 lots.

Sewerage Area No. 8742  
(360/289/0271)

City of Whittlesea—This area comprises lots 2301 to 2304, 2307 to 2317, 2331 to 2320, 2319 and 2318 Network Drive, lots 2201 to 2210 and 2241 to 2235 Lugano Street, lots 2234 to 2223, 2211 to 2221 and 2222 Padstun Avenue, lots 2305 and 2306 Killara Street and contains 72 lots.

Sewerage Area No. 8745  
(360/289/0273)

Shire of Diamond Valley—This area comprises all lots Black Wattle Court, Redbox Close, Banksia Rise, lots 95, 94 to 92, 91, 90 and 84 to 82 Glengully Road and contains 32 lots.

Sewerage Area No. 8757  
(360/289/9006)

Shire of Bulla—This area comprises all lots McCallum Court, Ivanhoe Court, Lochiel Court and Lamond Court, lot 1 Elgin Road, lot 26 Greenvale Drive, lots 81 to 65, 4 to 7 and 31 to 39 Mossgiel Avenue, lots 64 to 62, 56 to 51 and 40 to 42 Normanby Drive and a tree reserve abutting Barrymore Road and contains 82 lots.

Sewerage Area No. 8774  
(360/289/0377)

City of Whittlesea—This area comprises lots 155 and 156 Hume Highway, lots 154 to 152, 151 to 148 and 129 to 133 Transport Drive, lot 157 Freight Drive, lots 134 and 135, 136 to 138 and 139 to 147 Fillo Drive and contains 29 lots.

Sewerage Area No. 8777  
(360/290/0006)

City of Whittlesea—This area comprises all lots Berala Place and Randall Court, lots 317 to 327, 329, 328, 288 to 292, 293, 294 and 314 to 316 Pindari Avenue, lots 401 to 399, 389 to 379, 402 to 412, 416 to 421 and 413 to 415 Romano Avenue and contains 85 lots.

By Order of the Board

P. CALLOW  
Regional Manager Northern

MELBOURNE AND METROPOLITAN  
BOARD OF WORKS  
General Notice

The Melbourne and Metropolitan Board of Works having made provision for carrying off the sewage of each and every property which or any part of which is situate in the Sewerage Area hereinafter described doth hereby declare that on and after 20 July 1990 each and every property so situate shall be deemed to be sewered property within the meaning of the *Melbourne and Metropolitan Board of Works Act 1958*.

The Sewerage Area hereinbefore referred to is:

Sewerage Area No. 6175  
(360/290/0160)

City of Croydon—This area comprises all lots located in Wilton Close and Kylie Place together with following lots in Kempston Avenue lots 28 to 36 lots 48 to 57 also the following lots in Alford Rise together with the following lots 84 to 86 together with the following lots in Barnard Crescent lots 30 to 37 lot 58 and lot 62 to 64. Also lots 65 and 66 Exceter Road and lots 75 to 77 Durham Court and contains 53 lots.

Sewerage Area No. 6179  
(360/290/0158)

City of Croydon—This area comprises all lots located in Waterview Court Hillview Court and

1878 G 24 20 June 1990

Mountainview Close together with the following lots in Eskdale Drive being lots 648 to 651 also lots 623 to 627 and contains 58 lots.

Sewerage Area No. 6172  
(360/290/0163)

City of Knox—This area comprises all lots located in Selwood Court together with lot 9 Brusco Close also lots 1 and 2 10 to 13 with lots 46 to 49 Turramurra Drive also lots 41 to 45 and lot 14 Paratea Drive and contains 42 lots.

Sewerage Area No. 6173  
(360/290/0162)

City of Knox—This area comprises all lots located in Stockdale Close, Kincaid Court (excluding lots 391 to 393) Natalie Court (excluding lots 195 to 196) and the following lots located in Segarta Circuit lots 349 to 363, lots 381 to 384, lots 394 and 395 together with lots 193 and 194 and lots 203 to 205 with lots 207 to 209 Dawes Court and lots 328 to 335 Cutler Close and contains 66 lots.

Sewerage Area No. 6177  
(360/290/0155)

City of Knox—This area comprises the following lot in Minya Court lots 476 to 494 and excluding lot 490 together with lots 541 and 542 Oakdene Court and contains 20 lots.

Sewerage Area No. 6178  
(360/290/0154)

City of Knox—This area comprises all lots located in Adam Close together with the following lots in Lambourne Avenue lots 1 to 4 and 24 also lot 25 to 30 Murrindal Drive and contains 30 lots.

Sewerage Area No. 6181  
(360/290/0156)

City of Knox—This area comprises lots 16 to 43 Bianca Court together with lots 9 to 15 together with lots 1 to 7 including the Reserve Clausan Drive and contains 45 lots.

Sewerage Area No. 6174  
(360/290/0161)

Shire of Lillydale—This area comprises the following lots in Partridge Way lots 184 to 185 together with 319 to 320 also lot 329 to 331 and lot 292. Also the following lots located in Hillidge Lane lot 293 to 311 and lots 316 and 317 Hayrick Lane and contains 24 lots.

Sewerage Area No. 6180  
(360/290/0157)

Shire of Lillydale—This area comprises all lots located in Oliver Court, together with lots 22 to 31 and lots 34 to 42 Chandra Road also lots 1 to 11 together with lots 49 to 50 and lots 71 to 73 and lots 32 and 33 Chamberlain Drive also lots 12 to 21 Collier Road and contains 72 lots.

*Victoria Government Gazette*

Sewerage Area No. 6176  
(360/290/0159)

Shire of Sherbrooke—This area comprises the following lots on Monbulk Road part lot 31 to lot 49 and contains 16 lots.

Further particulars may be ascertained on enquiry at the Boards Eastern Regional Complex.  
By order of the Board

D. G. ROBINSON  
Regional Manager  
Eastern Region

---

*Planning and Environment Act 1987*  
**FOOTSCRAY PLANNING SCHEME**  
Notice of Lapsing of Amendment  
Amendment L4

On 12 June 1990 the Minister for Planning and Urban Growth refused the above amendment.

The amendment proposed the rezoning of land in Somerville Road, Yarraville, from Residential C to Office.

The amendment lapses on the date this notice is published in the *Government Gazette*.

GEOFF CODE  
Manager

Planning Co-ordination Branch

---

*Planning and Environment Act 1987*  
**GEELONG REGIONAL PLANNING SCHEME**

Notice of Lapsing of Amendment  
Amendment R50

On 31 May 1990 the Geelong Regional Commission resolved to abandon the above amendment.

The amendment proposed to allow the Shire of Bannockburn to consider a planning permit application to allow a house on land in Maude Road, Russells Bridge.

The amendment lapses on the date this notice is published in the *Government Gazette*.

GEOFF CODE  
Manager

Planning Co-ordination Branch

---

**ERRATUM**  
**RIPON PLANNING SCHEME**  
Amendment L12

In *Government Gazette* G20 dated 23 May 1990 on page 1615 a notice appeared with the above amendment number in the heading and Amendment L2 in the first paragraph. The correct amendment number is L2 therefore the heading should be changed accordingly.

---

*Planning and Environment Act 1987*  
**CRANBOURNE PLANNING SCHEME**  
Notice of Approval of Amendment  
Amendment L27

The Minister for Planning and Urban Growth has approved Amendment L27 to the Cranbourne Planning Scheme.

The amendment comes into operation on the date this notice is published in the *Government Gazette*.

The amendment rezones approximately 37 hectares of land, being part Lot 2, Lodged Plan No. 77379, Aqueduct Road, Langwarrin from Cranbourne Special Extractive to Reserved Living.

A copy of the amendment can be inspected, free of charge, during office hours, at the offices of the Shire of Cranbourne, Sladen Street, Cranbourne and at the Department of Planning and Urban Growth, 477 Collins Street, Melbourne and 1st Floor, 33-39 High Street, Cranbourne.

GEOFF CODE  
Manager  
Planning Co-ordination Branch

*Planning and Environment Act 1987*  
**DEAKIN PLANNING SCHEME**  
Notice of Approval of Amendment  
Amendment L7

The Minister for Planning and Urban Growth has approved Amendment L7 to the Deakin Planning Scheme.

The amendment comes into operation on the date this notice is published in the *Government Gazette*.

The amendment rezones land in Tongala Township from Rural B to Residential and reserves land as Existing Public Purposes—Rural Water Commission and Existing Public Purposes—Water Reserve.

A copy of the amendment can be inspected, free of charge, during office hours, at the Shire Offices Tongala, and the Department of Planning and Urban Growth, 477 Collins Street, Melbourne.

GEOFF CODE  
Manager  
Planning Co-ordination Branch

*Planning and Environment Act 1987*  
**STAWELL (TOWN) PLANNING SCHEME**  
Notice of Approval of Amendment  
Amendment L14

The Minister for Planning and Urban Growth has approved Amendment L14 to the Stawell (Town) Planning Scheme.

The amendment comes into operation on the date this notice is published in the *Government Gazette*.

The amendment permits the premises at 7 Victoria Street, Stawell to be used for the purpose of offices by the Stawell Water Board.

A copy of the amendment can be inspected, free of charge, during office hours, at the offices of the City of Stawell, Town Hall, Stawell, at the Department of Planning and Urban Growth, 477 Collins Street, Melbourne and at the Department of Planning and Urban Growth, Regional Office, State Government Offices, Ballarat.

GEOFF CODE  
Manager  
Planning Co-ordination Branch

*Planning and Environment Act 1987*  
**MILDURA CITY PLANNING SCHEME**  
Notice of Approval of Amendment  
Amendment L21

The Minister for Planning and Urban Growth has approved Amendment L21 to the Mildura City Planning Scheme.

The amendment comes into operation on the date this notice is published in the *Government Gazette*.

The amendment rezones land in the commercial area of Langtree Avenue, Mildura South from Reserves for Public Purposes—Existing (13—Country Fire Authority) to Commercial "B".

A copy of the amendment can be inspected free of charge, during office hours at the offices of the City of Mildura, 76-84 Deakin Avenue, Mildura and the Department of Planning and Urban Growth, The Oldersfleet Buildings, 477 Collins Street, Melbourne.

GEOFF CODE  
Manager  
Planning Co-ordination Branch

*Planning and Environment Act 1987*  
**PAKENHAM PLANNING SCHEME**  
Notice of Approval of Amendment  
Amendment L28

The Minister for Planning and Urban Growth has approved Amendment L28 to the Pakenham Planning Scheme.

The amendment comes into operation on the date this notice is published in the *Government Gazette*.

The amendment includes 1.184 hectares of land described as part Crown Allotment No. 39D, Parish of Gembrook, Beaconsfield—Emerald Road, Beaconsfield Upper, within a Landscape

1880 G 24 20 June 1990

Zone. The site was previously designated Public Purposes 1 (Municipal Purposes).

A copy of the amendment can be inspected, free of charge, during office hours, at the offices of the Shire of Pakenham, Henty Way, Pakenham and at the Department of Planning and Urban Growth, 477 Collins Street, Melbourne and at the Department's Cranbourne Office, 1st Floor, Cranbourne Court, 33-39 High Street, Cranbourne.

GEOFF CODE

Manager

Planning Co-ordination Branch

*Planning and Environment Act 1987*

KILMORE PLANNING SCHEME

Notice of Approval of Amendment

Amendment L26a

The Minister for Planning and Urban Growth has approved Amendment L26a to the Kilmore Planning Scheme.

The amendment comes into operation on the date this notice is published in the *Government Gazette*.

The amendment rezones approximately 360 hectares of land, located to the south-east of Wallan Township, bounded by the Wallan-Whittlesea Road, the North Eastern Railway Line, Hadfield Road and Hume Freeway from Tourist Transport Zone to part Existing Public Purposes Reservation—Shire of Kilmore and part Tourist Residential Zone which incorporates Wallan Field Estate and Wallan Woolshed precincts.

A copy of the amendment can be inspected, free of charge, during office hours, at the offices of the Shire of Kilmore, Civic Centre, Sydney Road, Kilmore and at the Department of Planning and Urban Growth, 477 Collins Street, Melbourne.

GEOFF CODE

Manager

Planning Co-ordination Branch

*Planning and Environment Act 1987*

WHITTLESEA PLANNING SCHEME

Notice of Approval of Amendment

Amendment L19

The Minister for Planning and Urban Growth has approved Amendment L19 to the Local Section of the Whittlesea Planning Scheme.

The amendment comes into operation on the date this notice is published in the *Government Gazette*.

The amendment rezones land west of Plenty Road and north of the SEC easement, South

*Victoria Government Gazette*

Morang, from Reserved Light Industrial, Reserved Living and Conservation A to Reserved Living B and Stream and Floodway Zones.

A copy of the amendment can be inspected, free of charge, during office hours, at the Department of Planning and Urban Growth, Ground Floor, 477 Collins Street, Melbourne, and at the offices of the City of Whittlesea, High Street, Epping.

GEOFF CODE

Manager

Planning Co-ordination Branch

STATE TENDER BOARD

CONTRACTS ACCEPTED

Amendments

<i>Schedule Number</i>	<i>Item Number</i>	<i>New Rate</i>	<i>Effective Date</i>
		\$	

*Agricultural Chemicals, etc*

1/03	36	112.83*	21.6.90
	37	101.60	
	63	231.70+	
	64	220.11	

\*Delete: 'in 5 litre containers'

Add: '4 x 5 litre containers'

+Delete: 'in 5 litres containers'

Add: 'in 4 x 5 litre containers'

*Hand Tools (General)*

1/56	107	*	14.6.90
------	-----	---	---------

\*Delete: Thomas Warburton Pty Ltd

Add: Apply Tender Board

Delete: 'Kennett'

*Motor Spirit, Kerosene, Fuel Oils and Lubricants*

1/53	1	0.5074	24.5.90
	2	0.5114	
	3	0.5124	
	4	0.5164	
	5	0.5374	
	6	0.5374	
	7	0.5374	
	8	0.5374	
	9	0.5264	
	10	0.5264	
	12	0.5054	
	13	0.5104	
1/53	1	0.5022	6.6.90
	2	0.5062	
	3	0.5072	
	4	0.5112	

Schedule Number	Item Number	New Rate	Effective Date
		\$	
	5	0.5322	
	6	0.5322	
	7	0.5322	
	8	0.5322	
	9	0.5212	
	10	0.5212	
	12	0.5002	
	13	0.5052	
1/53	1	0.4959	12.6.90
	2	0.4999	
	3	0.5009	
	4	0.5049	
	5	0.5259	
	6	0.5259	
	7	0.5259	
	8	0.5259	
	9	0.5149	
	10	0.5149	
	12	0.4939	
	13	0.4989	
1/53	15	0.2621	24.5.90
	16	0.6421	
1/53	15	0.2569	6.6.90
	16	0.6409	
<i>Typewriter Ribbons and Correction Tapes</i>			
1/72	3	3.41	1.5.90

J. M. PAWSON  
Secretary to the Tender Board

CONTRACTS ACCEPTED—1989-90  
VICTORIA POLICE

T.218—*Transport Branch*

Supply of two (2) 15 Tonne Prison Vans.  
Patterson Cheney Pty. Ltd.—\$176 930.00.

P. J. HALE  
Supply Manager and Officer in Charge

CONTRACTS ACCEPTED—1989-90  
VICTORIA POLICE

T.230—*Uniform and Stores Division*

Supply of Recruit Shorts for the period 1 July 1990 to 30 June 1991.

Operor Bianca Nominees Pty. Ltd.—\$6.85 each.

P. J. HALE  
Supply Manager and Officer in Charge

Police Regulation Act 1958

POLICE SERVICE BOARD ELECTIONS

Further to the provisions of the *Police Regulation Act 1958* and the *Police Regulations 1979*, I hereby declare that the elections conducted by me on 4 June 1990, have resulted in Frederick James Leslie and Bernard Damian Gaffney being elected as Members of the Police Service Board and Paul Redmond Mullett being elected as Deputy to such Members.

Dated 8 June 1990

GRAEME KNIGHTS  
Returning Officer

*Crimes (Confiscation of Profits) Act 1986*

SALE OF FORFEITED PROPERTY

On 6 March 1990 an order was made in the County Court at Melbourne that a Mazda Bongo Van, Registered No. DSJ 770 be forfeited to the Crown.

In accordance with a direction from the Attorney-General's Department, pursuant to section 8 (5) of the *Crimes (Confiscation of Profits) Act 1986*, the vehicle will be sold at public auction at 10 a.m. on Wednesday, 18 July 1990 at the Coburg Police Station, 160 Bell Street, Coburg.

K. GLARE  
Chief Commissioner

*Police Regulation Act 1958—Section 122*

SALE OF UNCLAIMED PROPERTY

An owner is required for an unregistered red Honda 90cc motor cycle with engine No. C90E3129336.

This vehicle came into the possession of Police on 3 November 1989, and if not claimed, it will be sold by public auction at 10.00 a.m. on Tuesday, 31 July 1990, at the Mornington Police Station, Main Street, Mornington.

K. GLARE  
Chief Commissioner

*Police Regulation Act 1958—Section 122*

SALE OF UNCLAIMED PROPERTY

An owner is required for a damaged 1975 model Holden sedan, Registered No. DIX 998.

This vehicle came into the possession of Police on 29 April 1989, and if not claimed, it will be sold by public auction at 10.00 a.m. on Tuesday, 31 July 1990, at the Caulfield Police Station, 289 Hawthorn Road, Caulfield.

K. GLARE  
Chief Commissioner

1882 G 24 20 June 1990

## Victoria Government Gazette

Private Agents Act 1966

## NOTICE OF RECEIPT OF APPLICATIONS FOR LICENCES

Any objections to the applications below should be in accordance with the *Private Agents Act 1966* s.12 and *Private Agents Regulations 1988*, reg. 16.

Full Name of Applicant/Nominee	Residential Address	Name of Firm or Corporation	Address for Registration	*Licence Type	Hearing Date and Court
Boak, Robert John	3 Austin Ave, Narre Warren	Estate Security Services P/L	447 Springvale Rd, Glen Waverley	W	13.7.90 Dandenong
Baker, Matthew John	20 Cain Rd, Rye	Peninsula Security Services	1/13 Newington Ave, West Rosebud	"	9.7.90 Dromana
Smith, Donald William Nash	24 Koornalla Cres, Mt Eliza		24 Koornalla Cres, Mt Eliza	P, IA, W, CS	Frankston
Gearing, Graeme Kenneth	105 Hull Road, Croydon	Taylor's Bright Cleaning Service Pty Ltd	13-15 Russell St, Mt Evelyn	W	13.7.90 Lilydale
O'Neal, Gary Richard	8 Le Pedeleure Ave, Mildura		8 Le Pedeleure Ave, Mildura	IA	26.6.90 Mildura
Hollis, Catherine J.	4/47 Osborne Ave, Malvern	Catsilk Pty Ltd.	1st Floor, 86 Mt Eliza Way, Mt Eliza	P	26.6.90 Prahran
Rustom, Sajih Peter	62 Barkly St, East Brunswick	Majestic Security Services P/L	Suite 26, 33 Queens Rd, Melbourne	W	19.7.90
McLaughlin, Alan James Wing, Geoff	25 Mary St, St Kilda West 25 Patricia St, East Keilor	Warro P/L, Trading as Nexus Manpower	6 McIlwrick St, Windsor 7/294 High St, Preston	CA W	20.7.90 12.7.90 Preston
Gray, Daryl Raymond	Lot 20B Extons Rd, Kinglake	ABS Security Services	Cookes Rd, Mernda	"	24.7.90
Persia, Junior Persia Elsheikh, Mahfouz	15 Linsey St, Coburg 74 Rosemary Dve, Lalor		15 Linsey St, Coburg Cooks Road, Mernda	G W	" 30.7.90
Spencer, Brenda Estella	4 Moorabool Crt, Werribee	Paul Frederic Fritsch	28 Orleans Rd, Avondale Heights	"	10.7.90 Sunshine
Cormick, Ian Gray	149 Mossfield Dve, Hoppers Crossing		149 Mossfield Dve, Hoppers Crossing	IA	5.7.90 Werribee
Clark, Kenneth Edward	5 Avenel St, Broadmeadows		35 Fitzroy St, Laverton	W	19.7.90
Jean-Marc, Gerard	23 Pepperell Ave, Sydial	Desmond Job Bahr (Transit Patrols)	151 Boronia Rd, Boronia	W	13.7.90 Ferntree Gully
Cathcart, Andrew Eric	42 Ethle St, Thornbury	" "	" " "	"	"
Duffy, John Eric	17 Kurrajong Ave, Glen Waverley		17 Kurrajong Ave, Glen Waverley	G	19.7.90
Klop, Adrian T.	125 Eley Rd, Blackburn South	Protective Surveillance Services	3/88 Boronia Rd, Boronia	W	13.7.90
Hutchinson, Raymond William	Unit 1, 10 Burgess St, Horsham		"	"	11.7.90 Horsham
Braybrook, Dale Leslie	311 Errard Street South, Ballarat		307B Dana Street, Ballarat	P	12.7.90 Ballarat
Dibranaroo, Joe	16 Maher St, Fawkner		16 Maher St, Fawkner	IA	1.8.90 Broadmeadows
" "	" " "		" " "	G	"
Redpath, Timothy	Lot 3, High St, Learmonth		Lot 13, Taggart Dve, Daisy Hill	P W	" 19.7.90
Steven Mylon, Paul James Anthony	43 Brooks Ave, Shepparton		72D Wyndham St, Shepparton	CS	Maryborough 17.7.90 Shepparton
Palma, Anthony John	15 McEwen St, Shepparton	Metropolitan Security Services	634 Graham St, Port Melbourne	P W	" "
Aksionov, Anthony	16 Research-Warrandyte Rd, Nth Warrandyte		43 Meadow Wood Walk, Narre Warren	W	16.7.90 Dandenong
Agius, John Andrew	18 Collins St, St Albans	North West Security Service	29 Wonganella Dve, East Keilor	"	5.7.90
Gallone, Gregory	7 Sydney St, Avondale Heights		7 Sydney St, Avondale Heights	G	16.7.90 Moonee Ponds
Watt (Snr), William Bromley	Balmattum Rd, Violet Town	Victorian Night Patrol Services	333 Plenty Rd, Preston	"	12.7.90 Preston
Beshel, Joel	143 Beaconsfield Pde, Northcote		"	P	19.7.90
Elms, Brian	5/17 The Avenue, Windsor		24/155 Hyde St, Footscray	W	1.8.90 Williamstown

\*Licence Type: CA—Commercial Agent; CS—Commercial Sub-Agent; P—Process Server; IA—Inquiry Agent; G—Guard Agent; W—Watchman

SHIRE OF GLENELG  
Road Deviation Order

Pursuant to the provisions of sections 522 and 526 of the *Local Government Act 1958* the Council of the Shire of Glenelg hereby directs that the land in the Parish of Wando indicated by hatching on the diagram annexed hereto, which has been purchased taken or acquired by it, shall be a public highway on and from the date of publication of this Order in the *Government Gazette* and declares that such land shall be a public highway in lieu of the land indicated by cross hatching on the said diagram.

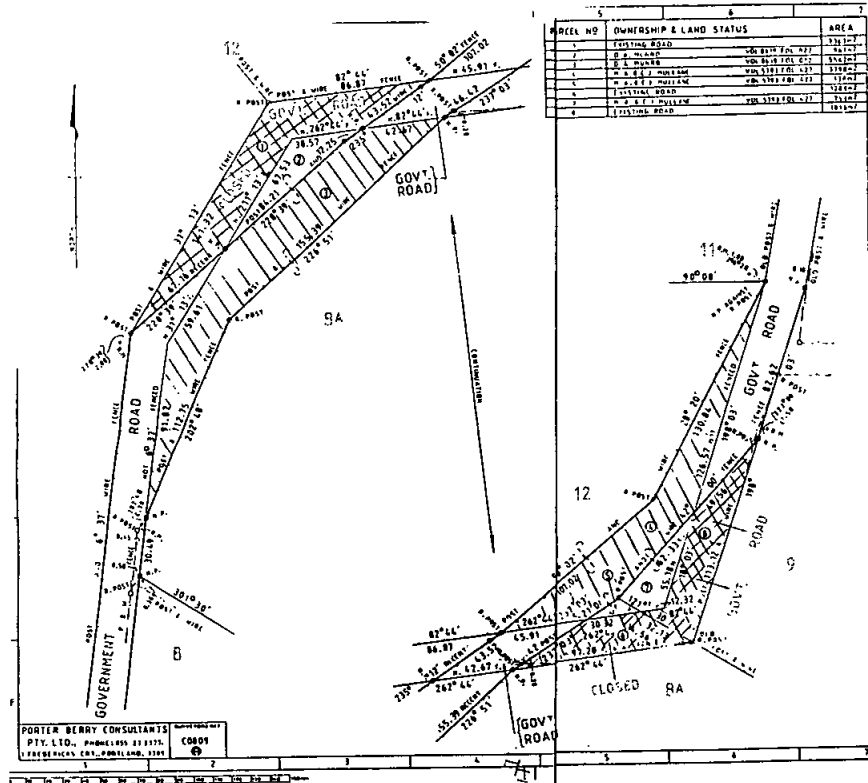

The common seal of the President, Councillors and Ratepayers of the Shire of Glenelg was hereunto affixed 18 December 1989.

JOHN B. NORTHCOTT, President  
KEVIN G. STARK, Councillor  
V. J. SMITH, Secretary

Confirmed by the Governor in Council, 19 June 1990—NEIL MORROW, Clerk of the Executive Council.

#### SHIRE OF MORWELL Road Deviation Order

Pursuant to the provisions of sections 522 and 526 of the *Local Government Act 1958* the Council of the Shire of Morwell hereby directs that the land being part of Crown Allotments 109B, 109G and 110G in the Parish of Narracan South indicated by hachure on the diagram hereunder shall be a Public Highway on and from the date of publication of this Order in the *Government Gazette* in lieu of the land shown by cross hachure.

1884 G 24 20 June 1990

Victoria Government Gazette

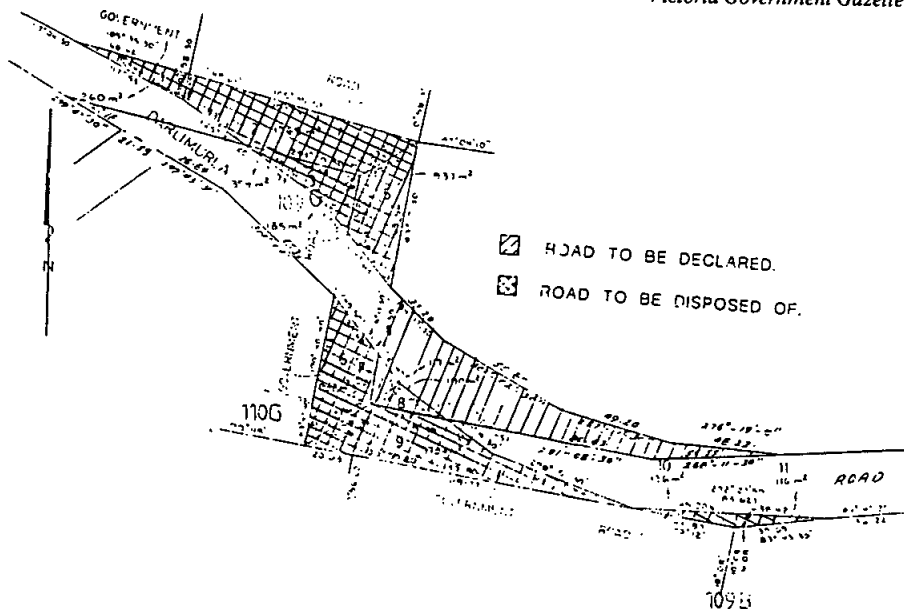

The common seal of the President, Councillors and Ratepayers of the Shire of Morwell was hereunto affixed 7 May 1990 in the presence of:

B. BROADBENT, Shire President  
JOHN GUY, Councillor  
R. H. WATERS, Secretary

Confirmed by the Governor in Council, 19 June 1990—NEIL MORROW, Clerk of the Executive Council.

#### REVOCATION OF APPOINTMENT

The appointment of Jan Louise Simmons as an Assistant Commissioner for Corporate Affairs, pursuant to section 4 of the Companies (Administration) Act is hereby revoked.  
Dated 31 May 1990

RON TREVETHAN  
Commissioner for Corporate Affairs

#### SHIRE OF BAIRNSDALE Road Deviation

Pursuant to the provisions of sections 522 and 526 of the *Local Government Act 1958* the Council of the Shire of Bairnsdale hereby directs that the land in the Parish of Wy Yung indicated by cross hatching on the diagram hereunder, which has been purchased taken or acquired by it, shall be a public highway on and from the date of publication of this order in the *Government Gazette* and declares that such land shall be a public highway in lieu of the land indicated by hatching on the said diagram.

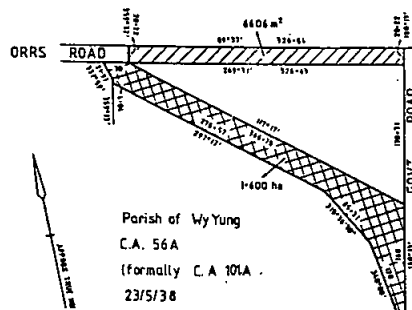

The common seal of the President, Councillors and Ratepayers of the Shire of Bairnsdale was hereunto affixed 11 April 1990.

K. C. HUTTON, President  
R. J. REILLY, Councillor  
T. J. NEWTON, Secretary

Confirmed by the Governor in Council, 19 June 1990—NEIL MORROW, Clerk of the Executive Council.



Victoria Government Gazette

**Local Government Act 1958**  
**DECLARATION PURSUANT TO SS. 522**  
**AND 526 (1)**

By this Order made 1 May 1989 the President, Councillors and Ratepayers of the Shire of Bungaree hereby declare that:

- (a) The land shown hatched and marked "A" on the Plan annexed hereto shall be a public highway; and
- (b) The said land which has been acquired for the purpose of a public highway shall be in lieu of that portion of the existing roadway shown cross-hatched and marked "B" on the said Plan.

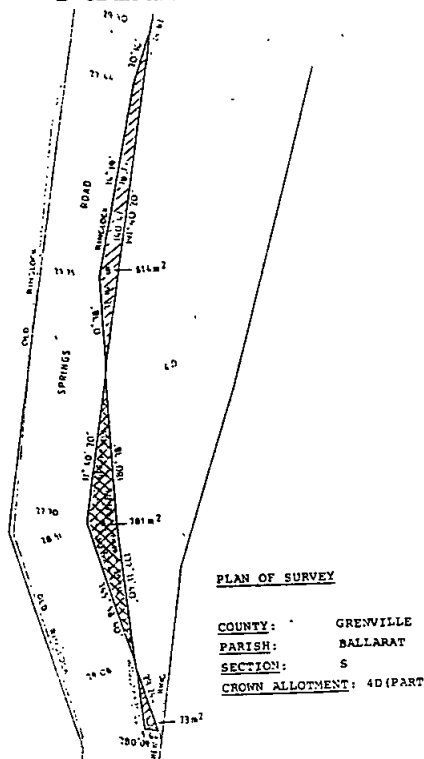

The common seal of the President, Councillors and Ratepayers of the Shire of Bungaree was hereunto affixed in the presence of:

J. V. TOOHEY, President  
I. L. DREW, Councillor  
B. R. JOHNSON, Secretary

Confirmed by the Governor in Council, 19 June 1990—NEIL MORROW, Clerk of the Executive Council.

G 24 20 June 1990 1885

**Local Government Act 1958**

**NOTICE OF INTENTION TO**  
**RECOMMEND THE MAKING OF AN**  
**ORDER FOR THE PROCLAMATION OF**  
**THE SHIRE OF WARRAGUL TO BE A CITY**

Pursuant to the provisions of section 24D (1) (b) (ii) of the *Local Government Act 1958*, the Council of the Shire of Warragul has made a written request under its common seal to give effect to a proposal for the proclamation of the Shire of Warragul to be a City under the title "Rural City of Warragul".

In accordance with the requirements of section 4 (2) of the *Local Government Act 1989* the Council has demonstrated that the Shire of Warragul is partly urban and partly rural in character.

Under section 24F of the Act notice is given that after the expiration of one month from the publication of this notice in the *Government Gazette* and in a newspaper generally circulating in the municipal district of the Shire of Warragul, it is my intention to recommend to the Governor in Council that an Order be made to come into operation on and from 17 August 1990 to give effect to the proposal contained in the request without referring the proposal to a Division of the Local Government Commission.

Any person wishing to make any submissions or other representations about the proposal may do so in writing to the undersigned within one month of the publication of this notice.

MAUREEN LYSTER, Minister for Local Government, 500 Bourke Street, Melbourne

**Water Act 1989**

**MINISTERIAL ORDER PURSUANT TO**  
**CLAUSE 35 OF SCHEDULE 14**

I, Steven Marshall Crabb, Minister for Conservation and Environment, by this Order, specify that the lands shown within the red border on Plan No. 6155 lodged in the Plan Room of the Rural Water Commission, 590 Orrong Road, Armadale, shall be the specified area pursuant to Clause 35 of Schedule 14 of the *Water Act 1989*.

This order shall have effect from the commencement of Division 2 of Part 4 of the Act.

Dated 15 June 1990

STEVE CRABB  
Minister for Conservation and Environment

**Co-operative Housing Societies Act 1958**  
**NOTICE OF AMALGAMATION OF**  
**SOCIETIES**

Notice is hereby given that, pursuant to the provisions of the *Co-operative Housing Societies Act 1958*, Security (No. 47) Co-operative Housing

1886 G 24 20 June 1990

Society Limited, Werribee (No. 19) Co-operative Housing Society Limited, Ripon (No. 15) Co-operative Housing Society Limited, Balgrana No. 8 Co-operative Housing Society Limited, Shepparton & District (No. 24) Co-operative Housing Society Limited, Euroa & District Co-operative Housing Society Limited, Kyabram & District (No. 15) Co-operative Housing Society Limited, Seymour Capil Co-operative Housing Society Limited, Wodonga No. 14 Co-operative Housing Society Limited and Echuca & District (No. 10) Co-operative Housing Society Limited were amalgamated into one society under the name of Security (No. 50) Co-operative Housing Society Limited on 1 June 1990.

Dated at Melbourne, 1 June 1990

DAVID LAFRANCHI

Registrar of Co-operative Housing Societies

*Co-operation Act 1981*

CHANGE OF NAME OF A SOCIETY

Notice is hereby given that Wodonga West High School Co-operative Limited which was incorporated as a Community Advancement Society under the above-named Act on 7 March 1980 has registered a change of its name and is now incorporated under the name of Wodonga West Secondary College Co-operative Society Limited under the said Act.

Dated at Melbourne 6 June 1990.

D. F. HENRY

Deputy Registrar of Co-operative Societies

*Co-operation Act 1981*

CHANGE OF NAME OF A SOCIETY

Notice is hereby given that Axis Credit Co-operative Limited which was incorporated as a Credit Society under the above-named Act on 15 January 1990 has registered a change of its name and is now incorporated under the name of Colonial Credit Co-operative Limited under the said Act.

Dated at Melbourne, 23 May 1990

D. F. HENRY

Deputy Registrar of Co-operative Societies

*Swine Compensation Act 1967 (No. 7614)*

APPROVED AGENT

Notice under section 14

I hereby revoke the declaration made in *Government Gazette* No. 66 of 1 July 1976 of M. J. McNamara Nominees Pty Ltd T/as M. J. McNamara & Co. as an "Approved Agent" (No. CS-89 in the Register) for the purposes of Part II of the *Swine Compensation Act 1967* with effect from 23 April 1990.

*Victoria Government Gazette*

Pursuant to the provisions of Regulation 83 (1) of the Stamps Regulations 1981, I hereby state that the revocation is being made at the request of the Approved Agent.

B. C. EDDY

Deputy Comptroller of Stamps

*Cattle Compensation Act 1967 (No. 7615)*

APPROVED AGENT

Notice under section 14

I hereby revoke the declaration made in *Government Gazette* No. 66 of 1 July 1976 of M. J. McNamara Nominees Pty Ltd T/as M. J. McNamara & Co. (No. CS-89 in the Register) for the purposes of Part II of the *Cattle Compensation Act 1967* with effect from 23 April 1990.

Pursuant to the provisions of Regulation 83 (1) of the Stamps Regulations 1981, I hereby state that the revocation is being made at the request of the Approved Agent.

B. C. EDDY

Deputy Comptroller of Stamps

NOTICE OF AVAILABILITY OF  
STATUTORY RULES

Accident Compensation (Levy Rates and Bonus Fund) Regulations 1990

Notice is given that the above Regulations were made by the Governor in Council on Tuesday, 19 June 1990. The Regulations come into operation on 1 July 1990.

In accordance with the provisions of the *Subordinate Legislation Act 1962*, copies of the above Regulations are available for inspection by any member of the public without charge during normal office hours at the Department of Labour, Library, Level 23, Nauru House, 80 Collins Street, Melbourne.

Dated 19 June 1990

NEIL POPE

Minister for Labour

*Education Act 1958*

NOTICE OF THE MAKING OF ORDERS  
UNDER SECTION 13 (4) OF THE ACT

Pursuant to section 13 of the *Education Act 1958* I hereby give notice that Orders of the Governor in Council were made on 13 June 1990 under sub-section (4) of the said Act amending certain provisions relating to the constitutions of the School Councils listed below:

4851 Westall Primary School Council

8744 Mullauna Secondary College Council

J. E. KIRNER

Minister for Education

*Victoria Government Gazette*

*G 24 20 June 1990 1887*

*State Trust Corporation of Victoria Act 1987*  
**STATE TRUST CORPORATION ELECTION  
REGULATION 1988**

*Incorporation Act 1981*, a Certificate of  
Incorporation was granted to St. Kilda  
Community Health Centre Inc. on 6 June 1990.

A. DUNN

Deputy Registrar of Incorporated Associations

Whereas on the 30 May 1990, written notice  
of the election of a member of staff of the State  
Trust Corporation was given by R. R. Gledhill,  
Managing Director and whereas there was one  
candidate nominated and the election was  
uncontested, I hereby declare, pursuant to  
Regulation 13 that—

Shepherd, Colin Arthur  
is duly elected as a Director of the State Trust  
Corporation.

Dated 18 June 1990

LEONIE CATHERINE NEWNHAM  
Returning Officer

*The Constitution Act Amendment Act 1958*  
**REGISTRATION OF POLITICAL PARTIES**

Notice is hereby given that the political party  
listed hereunder has been registered as a political  
party in accordance with the provisions of  
Division 1A of Part V of *The Constitution Act*  
*Amendment Act 1958*:

*Name of registered political party*—The  
Australian Ethnic Democrats Party.

*Abbreviation of name of party*—AUSED

*Name and address of registered officer*—K. H.  
Gurpinar, 397 Sydney Road, Brunswick, Victoria  
3056.

Dr G. P. LYONS  
Electoral Commissioner

**HOSPITALS AND CHARITIES ACT 1958**

It is notified that the corporate name of  
"Corilong Centre for the Mentally Handicapped"  
has been changed to "Corilong".

Dated 7 June 1990

Dr JOHN PATERSON  
Director-General  
Community Services

**ASSOCIATIONS INCORPORATION ACT  
1981**

Notice is hereby given that in pursuance of  
sub-section 10 (4) of the *Associations*  
*Incorporation Act 1981* a Certificate of  
Incorporation was granted to Irymple Football  
Club Inc. on 13 June 1990.

A. DUNN

Deputy Registrar of Incorporated Associations

**ASSOCIATIONS INCORPORATION ACT  
1981**

Notice is hereby given that in pursuance of  
sub-section 10 (4) of the *Associations*

## ORDERS IN COUNCIL

*Cemeteries Act 1958*

## SCALE OF FEES

Under section 17 of the *Cemeteries Act 1958*, and on the recommendation of the Minister for Health, the Governor in Council consents to the making of the Scale of Fees in respect of the following Public Cemeteries:

*Cemeteries Act 1958*

## SCALE OF FEES OF THE GISBORNE PUBLIC CEMETERY

In pursuance of the powers conferred upon them by the *Cemeteries Act* the trustees of the Gisborne Public Cemetery hereby make the following scale of fees, which shall come into operation upon publication in the *Government Gazette*, and from and after such publication every scale of fees heretofore made by the said trustees shall be and is hereby rescinded to the extent to which it conflicts with this scale.

*Public Graves*

\$

Interment in grave without exclusive right—stillborn child	50.00
Interment in grave without exclusive right—others	75.00

*Private Graves**Memorial Area*

Site 2.44 m × 1.22 m (Selected by Trust)	310.00
--	--------

*Lawn Section*

Site 2.44 m × 1.22 m (Selected by Trust)	310.00
--	--------

Bronze plaque, flower container and concrete surround	340.00
---	--------

<i>Children's Section</i> (under 5 years of age)—cost includes Land, Sinking Fee and provision of small plaque, concrete surround and bronze vase	450.00
---	--------

<i>Interment Fee</i> —including sinking grave 1.83 m deep	230.00
---	--------

Oversize grave (extra width or length)—extra cost	60.00
---	-------

Additional depth—per .5 m or part thereof	50.00
---	-------

*Memorial Wall and Garden*

Wall niche and plaque	210.00
-----------------------	--------

Wall bud vase	30.00
---------------	-------

Ashes in memorial garden with plaque	160.00
--------------------------------------	--------

*Miscellaneous Charges*

Administration Fee—for each interment	60.00
---------------------------------------	-------

Cancellation of order to sink (if commenced)	200.00
--	--------

Late fee (per half hour or part thereof after 15 minutes)	35.00
---	-------

Interment other than between 9 a.m. and 5 p.m. on normal working days or without due notice	175.00
---	--------

Permission to erect a headstone, monument, stone, tile or concrete surround—5% of total cost. Minimum charge	50.00
--	-------

Grave renovations or additional inscriptions	35.00
--	-------

Exhuming the remains of a body (when duly authorised)	750.00
---	--------

Interment of ashes in a private grave	50.00
---------------------------------------	-------

Search Fee (per request)	20.00
--------------------------	-------

G. YOUNG, Trustee

K. GOSSIP, Trustee

A. McKIMM, Trustee

*Cemeteries Act 1958*

## SCALE OF FEES OF THE WARRINGAL PUBLIC CEMETERY

In pursuance of the powers conferred upon them by the *Cemeteries Act* the trustees of the Warringal Public Cemetery hereby make the following scale of fees, which shall come into operation upon publication in the *Government Gazette*, and from and after such publication every scale of fees heretofore made by the said trustees shall be and is hereby rescinded to the extent to which it conflicts with this scale.

*Interment Fees*

\$

Sinking grave to 1.8 m	415.00
------------------------	--------

Sinking grave to 2.2 m (extra)	100.00
--------------------------------	--------

Sinking grave to 2.6 m (extra)	140.00
--------------------------------	--------

American Type Casket (extra)	180.00
------------------------------	--------

Oversized grave (extra)	180.00
-------------------------	--------

*Miscellaneous Charges*

Saturday interments (extra)	345.00
-----------------------------	--------

A charge for permission to erect a monument to a grave—10% of total cost	
--	--

Additional inscription on headstone	44.00
-------------------------------------	-------

For inspection plan or copy of Register	10.00
---	-------

Exhumation of body (when authorised)	615.00
--------------------------------------	--------

Cancellation of order	70.00
-----------------------	-------

Interment of Ashes	100.00
--------------------	--------

The Corporate Seal of the Mayor, Councillors and Citizens of the City of Heidelberg was hereto affixed in the presence of:

COUNCILLORS FOR THE CITY OF  
HEIDELBERG, Trustees

## Cemeteries Act 1958

SCALE OF FEES OF THE GEELONG  
CEMETERIES TRUST

In pursuance of the powers conferred upon them by the Cemeteries Act the Trustees of the Geelong Cemeteries Trust hereby make the following scale of fees, which shall come into operation upon publication in the *Government Gazette*, and from and after such publication every scale of fees heretofore made by the said Trustees shall be and is hereby rescinded to the extent to which it conflicts with this scale.

## 1. Fee for Right of Burial

In graves measuring 2.4 m x 1.2 m \$

## (a) Lawn areas, non-denominational

\*limit of 2 interments per grave

\*cost includes certificate fee

In approved bronze plaque memorial areas 620

In approved headstone memorial areas 620

In preferred position, selected by applicant from those offered by the Trust 670

## (b) Monumental areas, denominational

\*limit of 2 interments per grave

\*cost includes certificate fee

Eastern and Barrabool Hills Cemeteries 425

Western Cemetery 525

## (c) Children's Lawn areas

\*limit of 1 interment per grave

\*cost includes interment and certificate fee

Child to 3 months (incl. stillborn) 200

Child over 3 months and under 11 years 300

## (d) Concrete-lined graves (vaults) 3 000

\*subject to availability, at Eastern Cemetery only

\*limit of 2 interments per vault

\*cost includes certificate fee

\*interment fee and sand are additional

## 2. Interment Fees

## (a) Sinking or reopening to 2.3 m

Weekdays, to 4.00 p.m. 500

Saturday mornings or public holidays (when permissible) 660

## (b) Public area

\*there is no exclusive Right of Burial

\*memorials or other markers are not permitted

Child under 11 years (incl. stillborn) 35

All others 80

## (c) Other charges

Sand or loam for backfilling grave—additional 50

Insufficient notice—additional 70

Late fee: after 4.00 p.m. Monday to Friday—additional 115

Sinking to 2.74 m (if permitted)—additional 60

Removal of ledger—additional 80

Casket fee (or oversize coffin)—additional 75

Interment of cremated remains in a grave 90

Exhumation (if permitted) 900

## 3. Miscellaneous Cemetery Charges

## (a) Replacement copy of Certificate of Right of Burial 20

## (b) Search fee 20

## (c) Monumental Permit Fees:

Headstone up to \$1000 value—10% of cost

Headstone over \$1000 value—7% of cost, minimum 100

Additional inscription 20

## 4. Crematorium

## (a) Cremation Fee:

Weekdays—Adult 460

—Child under 5 years (incl. stillborn) 220

Prepaid cremation fee 480

Saturday mornings and public holidays (subject to special arrangement only) child or adult 620

\*there is no additional charge for use of the chapel at the crematorium

\*there are no concession rates for pensioners and ex-service personnel

## (b) Miscellaneous Charges:

Strewing of cremated remains

\*in an unmarked position at the discretion of the Trustees No charge

\*at a specified location but unmarked position 40

Collection of cremated remains

\*24 hours notice required 30

1890 G 24 20 June 1990

Victoria Government Gazette

Packaging and despatch of cremated remains

\*within Australia 60

\*outside Australia 70

Removal of cremated remains from a memorial for collection or transfer to another position within the cemetery

\*including collection fee 30

date on which application is made for each such position. Positions arranged pre-need are subject to the same tenure period of 50 years, irrespective of the length of time cremated remains occupy a position. The Trust will not accept money for bronze memorial plaques until the time each plaque is ordered.

All memorials are offered subject to availability.

#### 5. Memorialisation of Cremated Remains

All new positions provided by the Trust for the memorialisation of cremated remains are subject to a tenure period of 50 years from the

The existing Niche Walls at the Eastern and Western cemeteries have provision to accept only a token amount of cremated remains in each niche.

Type of Memorial	Cemetery	No. of Positions per Memorial	Cost of Memorial
Niche Wall	Eastern and Western	1	150
Memorial Cross	Western	1	185
Rose, per position:			
Total of 4 positions at each rose	B/Hills, Eastern and Western	1	265
Tree, shrub or boulder	Eastern and Western	By negotiation	
Niche Wall	Memorial Park	1	415
Memorial wall, with ground position adjacent	Memorial Park	1	165
Shrub garden, border position	Memorial Park	1	265
Tree, shrub or boulder	Memorial Park	By negotiation	

#### 6. Other

\*Bronze memorial plaques and stands, Flower containers and Entries in a Book of Remembrance are all available from the Trust at moderate cost.

I. D. MacDONALD, Trustee

G. F. HIGGINS, Trustee

I. F. APTED, Trustee

#### Cemeteries Act 1958

#### SCALE OF FEES OF THE YARRA GLEN PUBLIC CEMETERY

In pursuance of the powers conferred upon them by the Cemeteries Act the trustees of the Yarra Glen Public Cemetery hereby make the following scale of fees, which shall come into operation upon publication in the *Government Gazette*, and from and after such publication every scale of fees heretofore made by the said trustees shall be and is hereby rescinded to the extent to which it conflicts with this scale.

Lawn grave 2.44 m x 1.22 m (including installation of plaque)	400 00
Monumental grave 2.44 m x 1.22 m	350 00
Sinking adult grave	240 00
Sinking grave for child under five years	150.00
Sinking oversize grave	350 00

Re-opening all graves	240 00
Interment of ashes in private grave	80 00
Interment fee (normal hours)	80 00
Interment fee (outside normal hours)	160 00
Duplicate certificate of right of burial	12 00
Permit to construct, erect, repair, alter, extend any fence, kerbing, headstone, monument or memorial—10% of cost with a minimum of	60 00
Exhumation (when authorised)	600 00
Cancellation of order (after digging commenced)	300 00

J. CURRAN, Trustee

G. L. KENNEDY, Trustee

D. MOORE, Trustee

G. R. PEACOCK, Trustee

*Cemeteries Act 1958*  
**SCALE OF FEES OF THE AMHERST  
PUBLIC CEMETERY**

In pursuance of the powers conferred upon them by the Cemeteries Act the trustees of the Amherst Public Cemetery hereby make the following scale of fees, which shall come into operation upon publication of the *Government Gazette*, and from and after such publication every scale of fees heretofore made by the said trustees shall be and is hereby rescinded to the extent to which it conflicts with this scale.

	\$
Land 1.22 m × 2.44 m	100 00
Permission to erect headstone or monument—10% of cost	
Search fee	15 00

B. FLEMING, Trustee  
J. RYAN, Trustee  
D. GREENWOOD, Trustee

*Cemeteries Act 1958*  
**SCALE OF FEES OF THE CATHKIN  
(MOLESWORTH) PUBLIC CEMETERY**

In pursuance of the powers conferred upon them by the Cemeteries Act the trustees of the Cathkin (Molesworth) Public Cemetery hereby make the following scale of fees, which shall come into operation upon publication in the *Government Gazette*, and from and after such publication every scale of fees heretofore made by the said trustees shall be and is hereby rescinded to the extent to which it conflicts with this scale.

	\$
Land 2.44 m × 1.22 m	80 00
Sinking grave 1.83 m deep—Contract price + 10% Admin. charge	
Interment fee	40 00
Re-opening grave (no cover only)	110 00
Permission to erect headstone	40 00
Exhumation charge (when authorised)	400 00
Search fee per request	15 00

M. J. JEFFERY, Trustee  
P. O. MILLER, Trustee  
B. W. JEFFERY, Trustee

*Cemeteries Act 1958*  
**SCALE OF FEES OF THE RYE PUBLIC  
CEMETERY**

In pursuance of the powers conferred upon them by the Cemeteries Act the trustees of the Rye Public Cemetery hereby make the following scale of fees, which shall come into operation

upon publication in the *Government Gazette*, and from and after such publication every scale of fees heretofore made by the said trustees shall be and is hereby rescinded to the extent to which it conflicts with this scale.

*Lawn Section*

	\$
2.44 m × 1.22 m grave site	350 00
Digging fee at time of burial	100 00
2nd interment re-opening fee	150 00
Digging fee	100 00

*Monumental Section*

2.44 m × 1.22 m grave site	270 00
Digging fee at time of burial	100 00
2nd interment re-opening fee	100 00
Digging fee	100 00
Removal of slab or cover and replacement of same	55 00

*Memorial Rose Garden*

Standard Rose, 25 cm × 10 cm plaque insertion of ashes	260 00
2nd interment of ashes, plaque, same rose bush	160 00

*Funerals*

On Sundays—Extra	45 00
Without 24 hours notice—Extra	45 00
Interment of casket (other than coffin)—Extra	30 00

*Niche Walls*

	200 00
<i>Babies Section</i>	
Including land and digging	215.00

G. JARMAN, Trustee  
K. DENNIS, Trustee  
M. TOBIN, Trustee

Dated 13 June 1990  
Responsible Minister:  
CAROLINE HOGG  
Minister for Health

NEIL MORROW  
Clerk of the Executive Council

*Cemeteries Act 1958*  
**APPOINTMENT OF TRUSTEES**

Under section 3 (1) of the *Cemeteries Act 1958*, and on the recommendation of the Minister for Health, the Governor in Council makes the following appointments of Trustees of the following public cemeteries:

Name	Public Cemetery
Michael ROLFE	Pakenham Cemetery
Donald DUFFY	Pakenham Cemetery

1892 G 24 20 June 1990

Edgar TROTTER Pakenham Cemetery  
Jennifer ZAAL Pakenham Cemetery  
Richard LORIMER Pakenham Cemetery  
Brian SOUTAR Pakenham Cemetery  
Marianna EDYVANNE Pakenham Cemetery  
Arthur Albert EDNEY Neerim Cemetery  
Phyllis Irene HAWKER Tongala Cemetery  
Glennister Roy IPSEN Timor Cemetery

Dated 13 June 1990  
Responsible Minister:  
CAROLINE HOGG  
Minister for Health

NEIL MORROW  
Clerk of the Executive Council

*Post-Secondary Education Act 1978*

**AWARDING OF MASTERS DEGREES**

The Governor in Council, under section 38 of the *Post-Secondary Education Act 1978*, confers on the governing body of the institution listed below the power to award the degree specified to the person named.

As required by section 38 of the *Post-Secondary Education Act 1978*, the Victorian Post-Secondary Education Commission has certified that the course of study for the degree specified is comparable in standard to that which leads to the award of a degree at a university.

<i>Institution</i>	<i>Degree</i>	<i>Person to whom the Degree is to be Awarded</i>
Gippsland Institute of Advanced Education	Master of Arts (Visual Arts)	David GATISS

Dated 13 June 1990  
Responsible Minister:  
JOANE KIRNER  
Minister for Education

NEIL MORROW  
Clerk of the Executive Council

*Land Conservation Act 1970*

**MALLEE AREA REVIEW**

**Notice of Recommendations**

Under section 10 (3) the Administrator in Council gives notice to the Government Departments and Public Authorities listed in attachment 1 of recommendations made by the Land Conservation Council under section 5 (1) (a) of the Act and listed in attachment 2 and varied in attachment 3 and it is now the duty of those Government Departments and Public

*Victoria Government Gazette*

Authorities to give effect to the recommendations.

Dated 8 May 1990

Responsible Minister:

ANDREW MCCUTCHEON  
Minister for Planning and Urban Growth

NEIL MORROW  
Clerk of the Executive Council

**AGENCIES AND DEPARTMENTS  
NOTIFIED**

Department of Conservation and Environment  
Department of Property and Services  
Department of Water Resources  
Rural Water Commission  
Department of Agriculture and Rural Affairs  
Department of Industry and Economic Planning  
Local Government Department  
Ministry for Education  
Ministry for Transport  
Public Transport Corporation  
Roads Corporation  
Health Department  
Treasury  
Rural Finance Corporation.

**MALLEE AREA REVIEW**

**Final Recommendations**

The following are the recommendations contained in the report titled 'Mallee Area, Review—Final Recommendations' (copies of which have been supplied to the government departments and public authorities listed in Attachment 1).

**General Recommendations I-XI**

A1-A12 inclusive  
B1-B3 inclusive  
C1-C22 inclusive  
D1, D2, D7-D12, D14-D33 inclusive  
E1  
F1, F2, F3, F4, F5, F6, F7  
G1-G3, G6-G31, G33-G72 inclusive  
H1-H5 inclusive  
I2-I10, I12-I18, I20-I26, I28-I31, I33-I42A, I44, I46-I61, I63-I69, I71-I73, I75-I144, I146-I183, I185, I188-I201, I203-I206, I208-I211 inclusive  
I2X, I3X, I44X, I48X, I55X, I64X, I67X, I69X, I80X, I90X, I92X, I108X, I129X, I130X, I130AX, I136X, I149X, I167X, I171AX, I182X, I212-I300, I301-I394 inclusive  
J1-J5 inclusive



K1-K5 inclusive  
L1, L2, L3, L5, L6-L50 inclusive  
M1  
N1-N5, N6 (only in so far as it applied to the area north of the Manangatang-Piangil Road), N7-N10 inclusive  
O1, O2, O4-O8, O10-O12, O14, O15, O17, O19, O20, O22, O23-O68, O70-O73, O75-O100, O102-O107, O109-O119, O121-O134, O136-O161, O165-O169, O171-O177, O179-O194, O195-O201, O202-O205, O206-O209, O210-O212, O213-O217, O218-O220, O221-O223, O224, O225, O226, O227-O229, O230-O233 inclusive  
P1-P10 inclusive  
Q1-Q3 inclusive  
R1  
S1, S2, S4, S5  
T1-T7 inclusive  
U1, U2  
V1-V5 inclusive

VARIATIONS TO THE FINAL  
RECOMMENDATIONS OF THE LAND  
CONSERVATION COUNCIL FOR THE  
REVIEW OF THE MALLEE AREA

1. Additions to the Proposed Murray-Sunset National Park

(i) Recommendation A6 (a)

That the areas of about 1980 ha shown on the attached maps, being known as the Raak Plain-Rohan Lookout area (1230 ha) and the Red Lake area (750 ha), be added to the Murray-Sunset National Park proposed by the Land Conservation Council.

That these areas be used and reserved as indicated by the Land Conservation Council in Recommendation A6.

That grazing be phased out from the Raak Plain-Rohan Lookout area by 1 July 1991 and from the Red Lake area by 1 July 1995.

2. Other Variations

Parks

(i) Recommendation A9—Ross Lake Addition to Lake Albacutya Regional Park  
Replace the words 'Section 4 of the *Crown Land (Reserves) Act 1978*' with the words 'by its inclusion in Schedule Three of the *National Parks Act 1975*'.

(ii) Recommendation A11—Additions to the Murray-Kulkyne Regional Park.  
Replace the words 'Section 4 of the *Crown Land (Reserves) Act 1978*' with the words 'by their inclusion in Schedule Three of the *National Parks Act 1975*'.

Agriculture

(iii) Recommendation F1

The following land description is included in Table 2 (page 54 of final recommendations):

Mildura (P) CA9, Section 67, Block E 7.5 ha.

(iv) Recommendation F2—Amendment to Table 3 and Map D (pages 66 and 67 of final recommendations)

Table 3 and Map D in the final recommendations are amended to alter the phase-out period for the area of 446 ha on the northern edge of the Sunset Country currently licenced to J. W. and D. H. Sutherland for stock grazing. The phase out is amended from 'expiration of the current licence' to '1 July 1994'.

(v) Recommendation F2 (ix)

That a monitoring committee comprising an independent chairperson, four scientists, a conservation organisation representative, a Victorian Farmers Federation representative and a grazing licensee be established to advise the Minister for Conservation, Forests and Lands on the development of the monitoring program, the assessment of the results of the program and the need for changes to the strategy.

Bushland Reserves

(vi) Recommendation I262 (a)

That an area of about 4 ha in the south-east corner of Allotment 21, Parish of Bumbang, be temporarily excluded from Bushland Reserve I262 for the extraction of stone. Following exhaustion of the stone resource and rehabilitation of the site, the area shall be added to the Bushland Reserve.

Gypsum Mining

(vii) Recommendation N6 (a)

Acceptance of Land Conservation Council Final Recommendation N6, insofar as it refers to Towan Plains, is deferred and referred back to the Rural Affairs, Conservation and Environment Committee of Cabinet following a survey of gypsum resources on public and private land in the eastern mallee, and an evaluation of the impact of proposed gypsum mining on significant flora.

Water Supply and Drainage

(viii) Recommendation O136-I161

Add after Note 4:

1894 G 24 20 June 1990

*Note 5:* Water Reserve 0159 is within Bushland Reserve I183A, not I112 as indicated in the LCC 1977 final recommendations.

(ix) Recommendation 0231 (a)

That means to ensure adequate water enters Wyperfeld National Park from the Wimmera River System be urgently investigated and reported on by 1991, and that recommendations arising from the investigation be considered as a matter of urgency.

Utilities and Survey

(x) Recommendation P4 (a)

That 8.2 ha, including and surrounding the existing Ouyen night soil and rubbish depot adjacent to the north-eastern corner of Allotment 17, Parish of Ouyen, be used for the purposes of municipal landfill.

State Forest—Broombush harvesting

(xi) Recommendation S3

Recommendation S3 is not accepted.

(xii) Recommendation S3 (a)

That broombush harvesting on public land be terminated by the end of June 1991; that requirements for broombush after the end of June 1991 be met from private land; that research be conducted into the economic and technical feasibility of cultivating broombush on private land; that harvesting during the termination period be closely supervised; and that in the interim period to June 1991, licences be transferred to areas outside proposed parks, to those areas recommended by the Land Conservation Council, as soon as practicable.

*Local Government Act 1958*

CITY OF WILLIAMSTOWN

Variation of Separate Rate

The Governor in Council acting under section 290 of the *Local Government Act 1958* varies a separate rate made by the Council of the City of Williamstown on 28 October 1987 for the purpose of providing off-street parking facilities for the Williamstown Shopping Centre by deleting the properties described as 92 Ferguson Street, Williamstown and 106 Douglas Street, Williamstown and inserting the properties described as 7/65 Ferguson Street, Williamstown and 70, 87A, 1/106 and 2/106 Douglas Street, Williamstown.

Dated 19 June 1990

Responsible Minister:

MAUREEN LYSTER

Minister for Local Government

NEIL MORROW

Clerk of the Executive Council

*Victoria Government Gazette*

Local Government Department

SHIRE OF MANSFIELD

Confirmation of Separate Rate

The Governor in Council acting under section 287 of the *Local Government Act 1958* confirms a separate rate made by the Council of the Shire of Mansfield on 20 February 1990 for the purpose of providing electricity reticulation to the Cambatong Road area, Tolmie.

Dated 19 June 1990

Responsible Minister:

MAUREEN LYSTER

Minister for Local Government

NEIL MORROW

Clerk of the Executive Council

*Public Account Act 1958*

APPROVAL OF ISSUE OUT OF  
CONSOLIDATED FUND FOR  
EXPENDITURE ASSOCIATED WITH THE  
NATIONAL WOMEN'S HEALTH  
PROGRAM

The Governor in Council under section 4 (3) of the *Public Account Act 1958*, approves for the purposes of funding expenditure associated with the National Women's Health Program, the issue by the Treasurer out of the Consolidated Fund of \$167 000 being moneys made available for those purposes by the Commonwealth of Australia and required to be expended pursuant to an arrangement between the Commonwealth of Australia and the State of Victoria.

Dated 13 June 1990

Responsible Minister:

T. ROPER

Treasurer

NEIL MORROW

Clerk of the Executive Council

**TENDERS**

**MINISTRY OF HOUSING AND  
CONSTRUCTION—VICTORIA**

Major Works Tenders are invited for the purposes indicated hereunder and must be forwarded in the Ministry's coloured envelope and endorsed "Major Works Tender for \_\_\_\_\_".

The tender must either be—

lodged by hand in the box marked "Tenders" on First Floor, 2 Treasury Place, Melbourne, received by mail.

received by facsimile machine on (03) 651 1738 and immediately confirmed by mail on the Ministry's Tender Form.

No tender will be considered if received later than 2.00 p.m. on the closing date indicated hereunder for that work, or received by any other means.

Note: Telex and telegram tenders are no longer accepted. Tenders received by a mail delivery after the closing date and time are no longer accepted.

Tender documents are available for pick-up from the Contracts Office, Room 44, Ground Floor, 2 Treasury Place, Melbourne between 8.30 a.m.—12.30 p.m. and 1.30 p.m.—4.00 p.m. (posting will only occur outside 32 km from the G.P.O.) and where indicated at the Provincial Works Office.

Enquiries: Telephone (03) 651 2453/4.

**Wednesday, 27 June 1990**

MILDURA—Re-advertised: New roadway, Special Development School. (W.O. Mildura.)

MT. ELIZA—Re-advertised: Upgrade and addition to existing building (construction of kitchen/dining room), Manyung Recreation Camp.

**Wednesday, 11 July 1990**

FITZROY—Installation of fire sprinkler system, Rooming House, 34–36 Nicholson Street, M.H.C. Residence No. 1.

HAWTHORN WEST—External maintenance, Primary School.

**BARRY PULLEN**

Minister for Housing and Construction  
Ministry of Housing and Construction  
Melbourne, 4 June 1990

---

**PRIVATE  
ADVERTISEMENTS**

*Planning and Environment Act 1987*  
**NOTICE OF AMENDMENT TO BERWICK  
PLANNING SCHEME**

**Amendment No. L26**

The City of Berwick has prepared Amendment No. L26 to the Local Section of the Berwick Planning Scheme.

The amendment proposes to reserve three separate parcels of land.

Firstly, it is proposed to reserve the land on the north-west corner of Centre Road and Golf Links Road Deviation for Proposed Public Purposes—Primary School. The site is to be developed for the Berwick South Primary School.

Secondly, it is proposed to reserve the land north of the primary school site for open space. This is proposed to be a major open space area which can be jointly used with the Ministry of Education.

Thirdly, it is proposed to reserve the southern portion of the Golf Links Road Deviation for Proposed Public Purposes 19 (Local Government). The northern portion of this future road has already been acquired by Council and the proposed amendment is the first stage in the process of reserving the balance of the land for its future purpose.

The amendment can be inspected at City of Berwick Municipal Offices, Magid Drive, Fountain Gate; The Department of Planning and Urban Growth, Ground Floor, The Olderfleet Buildings, 477 Collins Street, Melbourne; The Department of Planning and Urban Growth, Metropolitan South and Westernport Region, 33-39 High Street, Cranbourne.

Submissions about the amendment must be sent to The Town Clerk, City of Berwick, P.O. Box 200, Berwick 3806 by 23 July 1990.

10358 P. J. NORTHEAST  
City Manager

*Planning and Environment Act 1987*  
**BERWICK PLANNING SCHEME**  
**Notice of Amendment**  
**Amendment No. L26**

The City of Berwick has prepared Amendment No. L26 to the Local Section of the Berwick Planning Scheme.

The amendment proposes to reserve three separate parcels of land.

Firstly, it is proposed to reserve the land on the north-west corner of Centre Road and Golf Links Road Deviation for Proposed Public

Purposes—Primary School. The site is to be developed for the Berwick South Primary School.

Secondly, it is proposed to reserve the land north of the primary school site for open space. This is proposed to be a major open space area which can be jointly used with the Ministry of Education.

Thirdly, it is proposed to reserve the southern portion of the Golf Links Road Deviation for Proposed Public Purposes 19 (Local Government). The northern portion of this future road has already been acquired by Council and the proposed amendment is the first stage in the process of reserving the balance of the land for its future purpose.

The amendment can be inspected at City of Berwick, Municipal Offices, Magid Drive, Fountain Gate. The Department of Planning and Urban Growth, Ground Floor, The Olderfleet Buildings, 477 Collins Street, Melbourne. The Department of Planning and Urban Growth, Metropolitan South and Westernport Region, 33-39 High Street, Cranbourne.

Submissions about the amendment must be sent to the Town Clerk, City of Berwick, P.O. Box 200, Berwick, 3806, by 23 July 1990.

10387 P. J. NORTHEAST  
City Manager

*Planning and Environment Act*  
**CITY OF CROYDON**  
**Notice of an Amendment to the Croydon  
Planning Scheme**  
**Amendment L19**

The Council of the City of Croydon has prepared Amendment L19 to the Croydon Planning Scheme.

The amendment rezones land situated at 8-12 Turner Street, Lots 10-12 (inclusive), LP 10145; 7-11 Turner Street, Lots 7-9 (inclusive), LP 10145; Lot 25-Lot 27 (inclusive), Norton Road, LP 10145; Part of the Road Reserve, Turner Street, Vol. 9659 Fol. 243; Part of 336 Dorset Road; Part Lot 2 LP 8854; Part Crown Section "A" from Public Purposes 11 (Education Department Use Other than a School) and Public Purposes 13 (State Electricity Commission Use) to Special Use Zone No. 10.

This amendment can be inspected at Municipal Offices, City of Croydon, Civic Square, Croydon 3136; Department for Planning and Urban Growth, The Olderfleet Buildings, 477 Collins Street, Melbourne 3000; Department for

Victoria Government Gazette

Planning and Urban Growth, Regional Office,  
Suite 4, 38-40 Prospect Street, Box Hill 3128.

Submissions about the amendment must be  
sent to City of Croydon, P.O. Box 206, Croydon  
3136 by Friday, 20 July 1990.

Dated 12 June 1990

10324

T. L. MAHER  
Chief Executive Officer

**CITY OF CAULFIELD**  
**Road Discontinuance**

Pursuant to section 528 (2) of the *Local Government Act 1958*, the Council of the City of Caulfield at its ordinary meeting of Council held on 15 May 1990 has resolved as follows:

Whereas the Council, being of the opinion that part of the road shown hatched on the plan below is no longer reasonably required for public use, and having complied with the provisions of section 528 (2) of the *Local Government Act 1958*, hereby resolves and directs that the part of the road shown hatched on the plan below be discontinued and sold by private treaty.

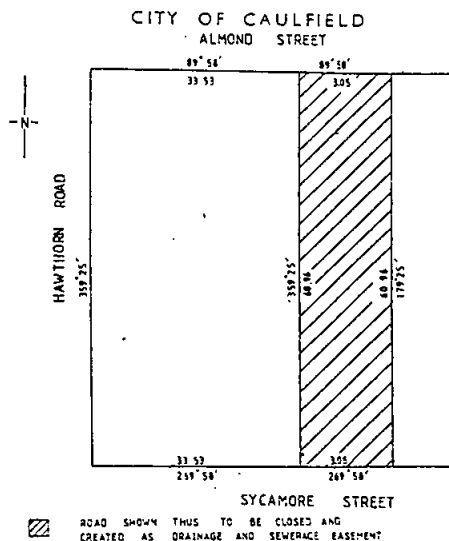

ROAD SHOWN THUS TO BE CLOSED AND  
CREATED AS DRAINAGE AND SEWERAGE EASEMENT

10320

DOUGLAS R. AYLEN  
Chief Executive Officer

**CITY OF CHELSEA**

Continuance of Road Under Section 203 (3) of  
the *Local Government Act 1989*, as amended  
Programme A1/87

Notice is hereby given pursuant to section 203  
(3) of the *Local Government Act 1989*, as

G 24 20 June 1990 1897

amended, that it is the intention of the Council  
of the City of Chelsea to resolve to include the  
section of right of way marked by cross hatching  
on the said plan shown hereunder, as a public  
highway, being part of Patterson Street, Carrum.

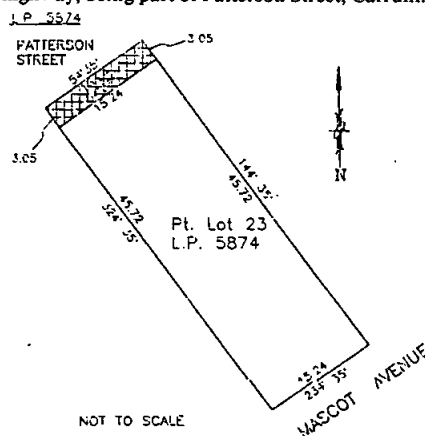

NOT TO SCALE

Dated 20 June 1990

10319

MAX BUTLER  
Chief Executive Officer

*Planning and Environment Act 1987*  
**NOTICE OF AMENDMENT TO A  
PLANNING SCHEME**

The City of Essendon has prepared  
Amendment No. L16 to the local section of the  
Essendon Planning Scheme.

The amendment is part of the on-going review  
and assessment of the planning controls relating  
to the Moonee Ponds District Centre, including  
a review of the Physical Framework Plan, land  
use controls and tables, height controls and  
objectives applicable to each zone in the District  
Centre.

The amendment may be inspected at  
Department for Planning and Urban Growth,  
Ground Floor, The Olderfleet Buildings, 477  
Collins Street, Melbourne 3000. Town Planning  
Department, City of Essendon, corner Pascoe  
Vale Road and Kellaway Avenue, Moonee Ponds  
3039.

Any submissions about the amendment should  
be in writing and must be sent to The City  
Manager, City of Essendon, Attention:  
Manager—Statutory Services, P.O. Box 126,  
Moonee Ponds 3039 by Monday, 23 July 1990.  
Dated Wednesday, 20 June 1990

10401

J. T. HIGGINS  
Manager—Statutory Services  
City of Essendon

1898 G 24 20 June 1990

*Planning and Environment Act 1987*  
**NOTICE OF AMENDMENT TO A  
PLANNING SCHEME**

The City of Essendon has prepared Amendment No. L20 to the local section of the Essendon Planning Scheme.

The amendment continues the on-going assessment and review of the planning controls relating to the Moonee Ponds District Centre, and specifically the area bounded by Margaret, Homer, Eddy and Taylor Streets. It is proposed to review the existing zoning for this area, and include it in a Moonee Ponds District Centre Zone No. 4—Peripheral Office.

It is also proposed to introduce additional conservation-based controls over this area, and over properties in Holmes Road and Norwood Crescent.

The amendment may be inspected at Department for Planning and Urban Growth, Ground Floor, The Olderfleet Buildings, 477 Collins Street, Melbourne 3000. Town Planning Department, City of Essendon, corner Pascoe Vale Road and Kellaway Avenue, Moonee Ponds 3039.

Any submissions about the amendment should be in writing and note the reference Amendment No. L20 and must be sent to The City Manager, City of Essendon, Attention: Manager—Statutory Services, P.O. Box 126, Moonee Ponds 3039 by Monday, 23 July 1990.

Dated Wednesday, 20 June 1990

J. T. HIGGINS  
Manager—Statutory Services  
City of Essendon

10402

**CITY OF GEELONG**  
Loan No. 91

Melbourne and Geelong Debentures  
Inscribed Stock and Mortgages Acts

Notice is hereby given that the Council of the City of Geelong intends to borrow the principal sum of \$600 000 for the purpose of development of a new Works Depot at South Geelong. The period of the loan shall be four years due 30 June 1994. Repayments of the loan will be by equal half yearly instalments (based on a ten year repayment schedule) and a final instalment of principal on the due date for the equivalent of which the lender had undertaken to grant a further loan. The rate of interest payable during the initial four year period will be 15.45 per cent per annum.

T. J. T. NEAL  
Town Clerk

10323 and Chief Administrative Officer

*Victoria Government Gazette*

**CITY OF GEELONG**

Loan No. 93

Melbourne and Geelong Debentures  
Inscribed Stock and Mortgages Acts

Notice is hereby given that the Council of the City of Geelong intends to borrow the principal sum of \$210 000 for the purpose of redeeming the outstanding balance of Loan No. 66 maturing 13 July 1990. The period of the loan shall be four years due 13 July 1994 after which date the term of the loan may be extended for a further two years to a total of six years. Repayments of the loan will be by equal half yearly instalments based on a six year repayment schedule. The rate of interest payable during the initial four year period will be as prescribed by Department of the Treasury in respect of Smaller Authority Loans.

T. J. T. NEAL  
Town Clerk

10323 and Chief Administrative Officer

*Planning and Environment Act 1987*  
**CITY OF HEIDELBERG—HEIDELBERG  
PLANNING SCHEME**

Notice of Amendment to a Planning Scheme  
Amendment No. L18

The City of Heidelberg has prepared Amendment L18 to the Heidelberg Planning Scheme.

The amendment affects land at the Ivanhoe Plaza Shopping Centre, situated on the south side of Livingstone Street, Ivanhoe, west of Waterdale Road.

The intent of the amendment is to improve pedestrian access and links between the existing malls and provide for a small increase in the number of retail premises at the Ivanhoe Plaza Centre.

The amendment can be inspected at the offices of City of Heidelberg, Civic Centre, Upper Heidelberg Road, Ivanhoe, Victoria 3079. The Department of Planning and Urban Growth, Ground Floor, The Olderfleet Buildings, 477 Collins Street, Melbourne, Victoria 3000.

Submissions about the amendment must be sent to the undersigned by 30 July 1990.

G. BRENNAN  
Chief Executive Officer

Civic Centre, Ivanhoe 3079 10383

**CITY OF MORDIALLOC**

Notice of Intention to make a Local Law

Notice is hereby given that the Council of the City of Mordialloc proposes to make and pass Local Law No. 1/90 for the following purposes:

Preliminary provisions;

Regulate the use of the Common Seal;  
Regulate the proceedings for the election of Mayor;

Regulate the proceedings of meetings of Council and Special Committees;

Regulate the use of Council properties and land;

Swimming pool squash courts complex;  
Municipal buildings, reserves and playgrounds;

Provide for the method of obtaining permits;  
Provide for infringement notices.

A copy of the proposed Local Law can be inspected or obtained at the Municipal Offices, Brindisi Street, Mentone during office hours.

Any person affected by the proposed Local Law may make a written submission in accordance with section 223 of the *Local Government Act* 1989.

Submissions should be received within fourteen (14) days of the date of publication of the Public Notice and should be addressed to the Town Clerk and City Manager, City of Mordialloc, P.O. Box 123, Mentone 3194.

Submissions will be considered at a Meeting of Council to be held at 7.00 p.m. on Monday, 16 July 1990.

D. H. CORBEN  
10380 Town Clerk and City Manager

CITY OF MORDIALLOC

Notice of Intention to make a Local Law

Notice is hereby given that the Council of the City of Mordialloc proposes to make and pass Local Law No. 1/90 for the following purposes:

Preliminary provisions;

Regulate the use of the Common Seal;

Regulate the proceedings for the election of Mayor;

Regulate the proceedings of meetings of Council and Special Committees;

Regulate the use of Council properties and land;

Swimming pool squash courts complex;  
Municipal buildings, reserves and playgrounds;

Provide for the method of obtaining permits;  
Provide for infringement notices.

A copy of the proposed Local Law can be inspected or obtained at the Municipal Offices, Brindisi Street, Mentone during office hours.

Any person affected by the proposed Local Law may make a written submission in accordance with section 223 of the *Local Government Act* 1989.

Submissions should be received within fourteen (14) days of the date of publication of the Public Notice and should be addressed to the Town Clerk and City Manager, City of Mordialloc, P.O. Box 123, Mentone 3194.

Submissions will be considered at a meeting of Council to be held at 7.00 p.m. on Monday, 16 July 1990.

D. H. CORBEN  
10342 Town Clerk and City Manager

CITY OF MORDIALLOC

Notice of Intention to make a Local Law

Notice is hereby given that the Council of the City of Mordialloc proposes to make and pass Local Law No. 2/90 for the following purposes:

Amend Local Law 1/90;

Regulate the Use of Council properties and land;

Council halls and rooms;

Council land;

Provide for the protection of Council land;

Provide for the parking of vehicles;

Residents parking scheme;

Disabled persons parking scheme;

Regulate the sale of goods, street selling, collections and distributions.

A copy of the proposed Local Law can be inspected or obtained at the Municipal Offices, Brindisi Street, Mentone during office hours.

Any person affected by the proposed Local Law may make a written submission in accordance with section 223 of the *Local Government Act* 1989.

Submissions should be received within fourteen (14) days of the date of publication of the Public Notice and should be addressed to the Town Clerk and City Manager, City of Mordialloc, P.O. Box 123, Mentone 3194.

Submissions will be considered at a meeting of Council to be held at 7.00 p.m. on 25 June 1990.

D. H. CORBEN  
10341 Town Clerk and City Manager

CITY OF OAKLEIGH

Mid-Block Road Closure

Notice is hereby given that the Council of the City of Oakleigh, pursuant to the provisions of section 205 of the *Local Government Act* 1989, adopted by Order the mid-block closure of Coombs Avenue to through traffic between Jason Street and Alvina Street as shown in the diagram below.

The Order as adopted will take effect from the date of publication of this notice.

1900 G 24 20 June 1990

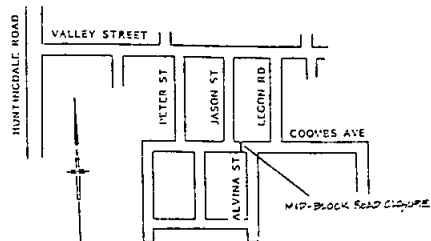

10334  
ADRIAN HALLIDAY  
Chief Executive Officer

**CITY OF OAKLEIGH**  
Roads Closure

Notice is hereby given that the Council of the City of Oakleigh, pursuant to the provisions of section 205 of the *Local Government Act 1989*, adopted by Order the closure of the Right-of-Way between North Road and Hume Street to through traffic at the North Road end as shown in the diagram below.

The Order as adopted will take effect from the date of publication of this notice.

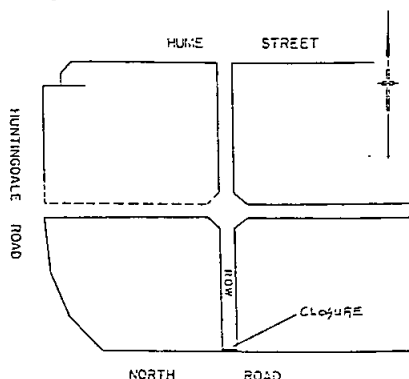

10335  
ADRIAN HALLIDAY  
Chief Executive Officer

*Planning and Environment Act 1987*  
**NOTICE OF AMENDMENT TO A  
PLANNING SCHEME**

The City of Portland has prepared Amendment No. L32 to the Portland City Planning Scheme 1988.

The amendment affects land at Malings Road, Portland.

The amendment proposes to change the Planning Scheme by a map change. Most of the land was previously situated within the Shire of Heywood but has since been annexed to the City of Portland. The proposed zonings accord with adjacent city zonings and use.

*Victoria Government Gazette*

The amendment can be inspected at: The City of Portland, Charles Street, Portland, or the Department of Planning and Urban Growth, State Offices, Cnr Fenwick Street and Little Malop Street, Geelong.

Submissions about the amendment must be sent to Department of Planning and Urban Growth, State Offices, Cnr Fenwick Street and Little Malop Street, Geelong 3220.

Dated 15 June 1990

10357  
R. N. HEAD  
Town Planner

**CITY OF SHEPPARTON**  
Local Law No. 2 and No. 4

Notice is hereby given, that the Council of the City of Shepparton at its meeting on 12 June 1990, made Local Law No. 2 and No. 4 for the purpose of—

- (i) Local Law No. 2—Regulating the Use of the Common Seal;
- (ii) Local Law No. 4—Regulating the proceedings for the election of the Mayor and/or the Deputy Mayor.

A copy of the Local Law is available for inspection during office hours. This Local Law comes into operation on Thursday, 21 June 1990.

10377  
I. L. GILBERT  
City Manager

**CITY OF ST KILDA**  
Local Law No. 1

Notice is given that having previously complied with the relevant provisions of the *Local Government Act 1989* the Council of the City of St Kilda at its meeting of 21 May 1990 made Local Law No. 1—Open Air Burning and Incinerator Local Law.

The purpose and general purport of this Local Law is—

- (a) To provide for the peace, order and good government of the municipal district of the City of St Kilda; and
- (b) To prohibit, regulate and control the lighting of fires and use of incinerators within the municipal district so as to prevent and abate nuisances and prevent detriment to the amenity of the neighbourhood; and
- (c) To control, protect and conserve the environment within the municipal district; and
- (d) To provide for the administration of council powers and functions; and
- (e) To repeal By-law No. 212 of the City of St Kilda.



*Victoria Government Gazette*

A copy of Local Law No. 1 is available from the Council office during working hours.

This Local Law will be effective from 1 June 1990.

JEREMY TATCHELL  
10381 Town Clerk

*Planning and Environment Act 1987*  
NOTICE OF AMENDMENT TO A  
PLANNING SCHEME

The City of Werribee has prepared Amendment No. L10 to the Werribee Planning Scheme.

The amendment proposes to change the Local Section of the Werribee Planning Scheme by rezoning a Drainage, Sewerage and Recreation Reserve on Plan of Subdivision No. 116721 (known as Grouse Court Reserve) located at the ends of Budgie Court, Snipe Court, Grouse Court and Brolga Court, Werribee from Existing Public Open Space Reservaton to Reserved Living Zone (Map No. 18).

The amendment can be inspected by any person, free of charge, during office hours at City of Werribee Civic Centre, 45 Princes Highway, Werribee; Department of Planning and Urban Growth, Ground Floor, The Olderfleet Buildings, 477 Collins Street, Melbourne; Department of Planning and Urban Growth, Western Region Office, 5th Floor, 235 Queen Street, Melbourne.

Submissions about the amendment must be sent to City of Werribee Civic Centre, 45 Princes Highway Werribee 3030. Attention: Mr. Trent Kneebush, by Friday, 27 July 1990.

T. KERR  
10321 Town Clerk

*Planning and Environment Act 1987*  
RURAL CITY OF WODONGA

Notice of Amendment to a Planning Scheme

The Rural City of Wodonga has prepared Amendment No. L17 to the Wodonga Planning Scheme, Local Section.

The amendment affects land at 7 Thomas Mitchell Drive, Wodonga.

The amendment proposes to change the Planning Scheme by rezoning the subject land from Industrial to Commercial Zone.

The amendment can be inspected at Rural City of Wodonga, City Offices, Hovell Street, Wodonga; the Department of Planning and Urban Growth, Ground Floor, The Olderfleet Buildings, 477 Collins Street, Melbourne.

Submissions concerning the amendment must be sent to the Rural City of Wodonga, P.O. Box 923, Wodonga 3690 by 23 July 1990.

R. I. O'TOOLE  
10386 Chief Executive Officer

G 24 20 June 1990 1901

*Planning and Environment Act 1987*

NOTICE OF AMENDMENT TO A  
PLANNING SCHEME

The Albury-Wodonga Development Corporation has prepared Amendment L11 to the Wodonga Development Areas Planning Scheme, Local Section, Chapter 1 (West Wodonga).

The amendment affects land which is zoned Rural A Zone within the West Wodonga area.

The amendment proposes to change the Planning Scheme by providing for the introduction of "Educational Establishment" as a permitted use in the Rural A Zone, subject to the approval of the Responsible Authority.

The amendment can be inspected at the offices of the Albury-Wodonga Development Corporation, Ellis Street, Thurgoona, New South Wales; the Rural City of Wodonga, Hovell Street, Wodonga; the Ministry for Planning and Urban Growth, 1 McKoy Street, Wodonga; and 477 Collins Street, Melbourne.

Submissions about the amendment must be sent to the Albury-Wodonga Development Corporation, P.O. Box 913, Albury, New South Wales 2640 by Monday, 23 July 1990.

M. J. NICHOLSON  
10348 Director Administration

*Planning and Environment Act 1987*  
NOTICE OF AMENDMENT TO A  
PLANNING SCHEME

The Albury-Wodonga Development Corporation has prepared Amendment L12 to the Wodonga Development Areas Planning Scheme, Local Section, Chapter 2 (Baranduda Township).

The amendment affects land at Ebdon Village, Murray Valley Highway, Ebdon.

The amendment proposes to change the Planning Scheme by the introduction of a new zone viz. The Tourist Service Zone which would allow for tourist and recreational related uses and development to be established at Ebdon Village.

The amendment can be inspected at the offices of the Albury-Wodonga Development Corporation, Ellis Street, Thurgoona, New South Wales; the Rural City of Wodonga, Hovell Street, Wodonga; the Ministry for Planning and Urban Growth, 1 McKoy Street, Wodonga; and 477 Collins Street, Melbourne.

Submissions about the amendment must be sent to the Albury-Wodonga Development Corporation, P.O. Box 913, Albury, New South Wales 2640 by Monday, 23 July 1990.

M. J. NICHOLSON  
10349 Director Administration

1902 G 24 20 June 1990

**CORRIGENDUM**

The notice published in the *Government Gazette* G 23 on 13 June 1990, Item No. 10243, page 1841, regarding the Shire of Healesville Amendment L21, requires a correction. The last paragraph date should have read 9 July 1990.

10406

*Planning and Environment Act 1987*

**NOTICE OF AMENDMENT TO A  
PLANNING SCHEME**

The Shire of Alberton has prepared Amendment No. L9 to the Alberton Planning Scheme, Local Section, Chapter 1—Coastal.

The amendment affects land off the Yarram-Port Albert Road, Langsborough and consists of part of Crown Allotment 70, Parish of Alberton East being Lot 2, L.P. 95313 and Lot 25, L.P. 31902.

The amendment proposes the change the Planning Scheme by rezoning the lands from Agricultural and Residential A Zones to Residential B Zone. The amendment will allow the lands to be developed into lots having an average area of 4000 m<sup>2</sup> with a minimum lot size of 3000 m<sup>2</sup>.

The amendment can be inspected at the Alberton Shire Offices, Commercial Road, Yarram; the Regional Office of the Department of Planning and Urban Growth, 71 Hotham Street, Traralgon; the Department of Planning and Urban Growth, The Olderfleet Buildings, 477 Collins Street, Melbourne; and the Latrobe Regional Commission, 43 Grey Street, Traralgon.

Submissions about the amendment must be sent to the Shire Secretary, Shire of Alberton, P.O. Box 1, Yarram 3971, by 20 July 1990.

Dated 8 June 1990

G. J. STEPHENS

10388

Shire Secretary

*Planning and Environment Act 1987*

**NOTICE OF AMENDMENT TO A  
PLANNING SCHEME**

The Shire of Alberton has prepared Amendment No. L11 to the Alberton Planning Scheme, Local Section, Chapter 1—Coastal.

The amendment affects land generally within the area bounded by Commercial Road, Church Road, Devonshire's Lane and Nightingale Street, Yarram.

The amendment proposes to change the Planning Scheme by rezoning the lands from Agricultural Zone to Residential A Zone. The amendment will allow the undeveloped and underdeveloped lands within the area to be developed to their full residential potential with the provisions of full services.

*Victoria Government Gazette*

The amendment can be inspected at the Alberton Shire Offices, Commercial Road, Yarram; the Regional Office of the Department of Planning and Urban Growth, 71 Hotham Street, Traralgon; the Department of Planning and Urban Growth, The Olderfleet Buildings, 477 Collins Street, Melbourne; and the Latrobe Regional Commission, 43 Grey Street, Traralgon.

Submissions about the amendment must be sent to the Shire Secretary, Shire of Alberton, P.O. Box 1, Yarram 3971, by 20 July 1990.

Dated 8 June 1990

G. J. STEPHENS

10389

Shire Secretary

**SHIRE OF BASS**

Notice is hereby given that the Council of the Shire of Bass at its Ordinary Meeting held on 4 June 1990, made the following Local Law pursuant to the *Local Government Act 1989*:

**Local Law No. 1—Common Seal**

This Local Law is for the purpose of regulating the use of the Common Seal of the Municipality and prohibiting unauthorised use of the Common Seal or any device resembling the Common Seal.

**Local Law No. 2—Meeting Procedures**

This Local Law is for the purpose of regulating the proceedings of Council Meetings, Committee Meetings, and other Meetings conducted by the Shire of Bass.

A copy of the Local Laws may be inspected and purchased at the Council office during office hours.

FELICE DE LOSA

10378

Acting Shire Secretary

**UNITED SHIRE OF BEECHWORTH**

**Notice of Intention to make a Local Law**

The Council of the United Shire of Beechworth proposes to make a Local Law No. 1 under Part 5 of the *Local Government Act 1989* for the purpose of preventing nuisances or any condition liable to be dangerous to health or detrimental to the environment arising from the installation or desludging of septic tank systems.

A copy of the proposed Local Law may be inspected at or obtained from the Shire offices, Ford Street, Beechworth, during office hours. Any person affected by the proposed Local Law may make a written submission within 14 days of the publication of this notice. Submissions must be addressed to the Shire Secretary, United Shire of Beechworth, P.O. Box 28, Beechworth 3747. Submissions will be considered at a meeting of Council on Friday, 6 July 1990.

G. T. GRAY

10344

Shire Secretary

Victoria Government Gazette

*Planning and Environment Act 1987*  
**CRANBOURNE PLANNING SCHEME**  
Notice of Amendment  
Amendment L36

The Shire of Cranbourne has prepared Amendment No. L36 to the Cranbourne Planning Scheme.

This amendment affects the following properties: Part Lot 2 LP141206, Lot 1 LP141206, Certificate of Title 9823 Folio 627, Potts Road, Langwarrin.

This amendment proposes to change the Planning Scheme by reserving a 13 hectare area of land in Potts Road, Langwarrin from Reserved Living to Primary School—proposed/Secondary School—proposed. This land has been identified as a future primary and secondary school site in the Shire of Cranbourne's adopted Outline Development Plan for Langwarrin. The amendment has been initiated at the request of the Ministry of Education.

The amendment can be inspected during office hours at: Shire Offices, Shire of Cranbourne, Municipal Offices, Sladen Street, Cranbourne; The Department of Planning and Urban Growth, Metropolitan South and Westernport Region, 1st Floor, 33–39 High Street, Cranbourne; The Department of Planning and Urban Growth, Ground Floor, The Olderfleet Buildings, 477 Collins Street, Melbourne.

Submissions about the amendment must be sent to: The Town Planner, Cranbourne, P.O. Box 4, Cranbourne by 23 July 1990.

Dated 14 June 1990

10385  
SCOTT TAYLOR  
Town Planner

*Planning and Environment Act 1987*  
**CRANBOURNE PLANNING SCHEME**  
Notice of Amendment  
Amendment L32

The Shire of Cranbourne has prepared Amendment No. L32 to the Cranbourne Planning Scheme.

This amendment affects land in McCormicks Road, Carrum Downs at: Lot 13 LP12405, Lots 1 and 2 LP951116 and Lot 11 LP12405, Parish of Lyndhurst.

The amendment proposes to change the Planning Scheme by reserving approximately 10.5 hectares from Reserved Living to Primary School—proposed/Secondary School—proposed. This land has been identified as a future primary and secondary school site in the Shire of Cranbourne's adopted Outline Development Plan for Carrum Downs. The

G 24 20 June 1990 1903

amendment has been initiated at the request of the Ministry of Education.

The amendment can be inspected during office hours at: Shire Offices, Shire of Cranbourne, Sladen Street, Cranbourne; The Department of Planning and Urban Growth, Metropolitan South and Westernport Region, 1st Floor, 33–39 High Street, Cranbourne; The Department of Planning and Urban Growth, Ground Floor, The Olderfleet Buildings, 477 Collins Street, Melbourne.

Submissions about the amendment must be sent to: The Town Planner, Cranbourne, P.O. Box 4, Cranbourne by 23 July 1990.

Dated 14 June 1990

10384  
SCOTT TAYLOR  
Town Planner

**SHIRE OF HASTINGS**  
Making of Local Law No. 3  
(Election of President, Deputy President and Chairperson)

Notice is hereby given that it is the intention of the Council of the Shire of Hastings to make Local Law No. 3 for the purpose stated hereunder.

A copy of the Proposed Local Law can be obtained from the Shire Offices, Marine Parade, Hastings between the hours of 8.15 a.m. and 5.00 p.m. Monday to Friday. Any person affected by the proposed Local Law may make a submission in accordance with section 223 of the *Local Government Act 1989*, after the publication of this notice. Submissions lodged within fourteen (14) days of the date of this publication will be considered by Council at its meeting to be held on Tuesday, 17 July 1990 at 7.00 p.m.

The purpose and general purport of the proposed Local Law No. 3 is to regulate the election of the President, Deputy President and Chairperson.

W. R. FEATHERSTON  
Chief Executive Officer  
Municipal Offices, Marine Parade, Hastings  
10354

**SHIRE OF KILMORE**  
General Notice

The Shire of Kilmore having made provision for carrying off the sewage from each and every property which or any part of which is within the sewerage area hereinafter described hereby declares that on and after 1 July 1990 each and every property which or any part of which is within the said sewerage area shall be deemed to be sewered property within the meaning of the *Sewerage Districts Act 1958*.

1904 G 24 20 June 1990

The boundaries of the sewerage area herein before referred to are: Tootle Street, north side, east of the Kilmore Creek and south of Boyd Street, generally known as the Kilmore Downs Estate. (Lots 1-26 LP 202227, hatched area on plan.)

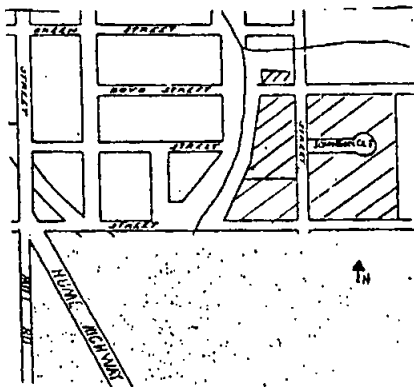

10356

P. ANDERSON  
Chief Executive Officer

**SHIRE OF KILMORE**  
**Discontinuance of Road**

Notice is hereby given that the Council of the Shire of Kilmore after complying with the requirements of section 528 (2) of the *Local Government Act 1958*, has resolved at an ordinary meeting held on 6 June 1990 to close and sell that portion of roadway as shown below.

The land in the said road shall vest in the municipality until it is sold by private treaty.

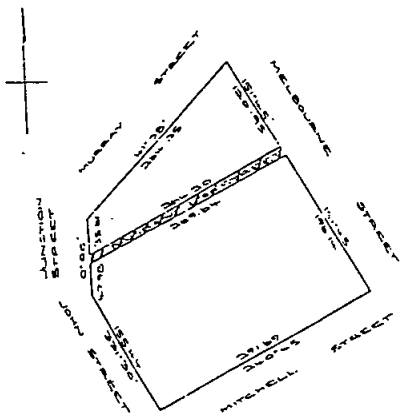

10336

P. ANDERSON  
Chief Executive/Shire Secretary

*Victoria Government Gazette*

**SHIRE OF KILMORE**

**Change of Road Name**

Notice is hereby given that pursuant to section 535 (4) of the *Local Government Act 1958* as amended the Council of the Shire of Kilmore at a meeting held on 6 June 1990 resolved to make the following change to road name:

Old Name: Old Lancefield Road.

New Name: Old Lancefield-Kilmore Road.

The effective date of this road name change is to be the date of this Gazette.

P. ANDERSON  
10337 Chief Executive/Shire Secretary

**SHIRE OF KORUMBURRA**

**Local Law No. 3**

Notice is hereby given that the Council of the Shire of Korumburra at a meeting held on 6 June 1990 made and passed a Local Law pursuant to the *Local Government Act 1989*, *Health Act 1958* for the following purpose:

Regulating the collection, removal and disposal of household refuse.

A copy of the Local Law is available for inspection or purchase at the Shire Office, during office hours.

DAVID ROCHE  
10338 Shire Secretary

**SHIRE OF KORUMBURRA**

**Local Law No. 4**

Notice is hereby given that the Shire of Korumburra at a meeting to be held on 4 July 1990 intends to make a Local Law pursuant to the *Local Government Act 1989* for the following purpose:

Regulating the keeping of animals, birds and bees kept in a residential or populous area within the municipality.

Any person affected by the proposed Local Law may make a written submission to the Council within 14 days of the publication of this notice, in accordance with section 223 (1) of the *Local Government Act 1989*.

Any person who has made a written submission to Council and request that he or she be heard in support of the written submission is entitled to appear in person or by a person acting on his or her behalf before a meeting of this Council or a Committee of the Council.

DAVID ROCHE  
10339 Shire Secretary

**SHIRE OF KORUMBURRA**

**Local Law No. 5**

Notice is hereby given that the Shire of Korumburra at a meeting to be held on 4 July

*Victoria Government Gazette*

1990 intends to make a Local Law pursuant to the *Local Government Act 1989* for the following purposes:

Regulating the fee or charge in respect of collection, removal and disposal of household refuse.

Local Law No. 5 is available for inspection during office hours (8.00 a.m. to 4.30 p.m.) Monday to Friday at the Shire Offices, 165 Commercial Street, Korumburra.

Any person affected by the proposed Local Law may make a written submission to the Council within 14 days of the publication of this notice, in accordance with section 223 (1) of the *Local Government Act 1989*.

Any person who has made a written submission to the Council and requests that he or she be heard in support of the written submission is entitled to appear in person or by a person acting on his or her behalf before a meeting of the Council or a Committee of the Council.

DAVID ROCHE  
Shire Secretary

10340

**SHIRE OF MELTON**

**ERRATUM**

**Discontinuance of Road**

This notice replaces the previous notice which appeared on 21 June 1989, Page 172 which was incorrect, it should have read:

Notice is hereby given pursuant to the provisions of section 528 (2) of the *Local Government Act 1958* (Amended), that the Council of the Shire of Melton resolved at its Ordinary Meeting on 21 October 1985 that all that portion of the land shown by hachure is not reasonably required as a road for public use and therefore be discontinued upon publication of this Resolution in the *Government Gazette* and shall be retained by the Shire of Melton for municipal purposes.

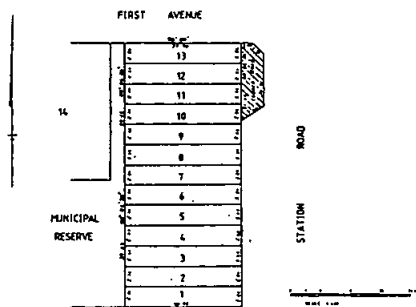

LINDSAY A. MERRITT  
Shire Manager

10374

G 24 20 June 1990 1905

**SHIRE OF MINHAMITE**

**Macarthur Pound**

Notice is hereby given that the Minhamite Shire Council has revoked the appointment of Phillip Milgate and has appointed Russell Timms of Macarthur, as the Macarthur Poundkeeper.

M. K. CHICK  
Shire Secretary

10346

**SHIRE OF MILDURA**

**Local Law No. 1**

**Meeting Procedure and Common Seal**

Notice is hereby given that Mildura Shire Council has prepared Local Law No. 1—The Proceedings of Council and the Use of the Common Seal.

The Local Law prescribes the manner of regulating Council Meeting and provides regulations for using the Common Seal of the Council.

A copy of the Local Law is available for inspection at the Council Office, Fifteenth Street, Irymple, Monday to Friday 8.00 a.m. to 5.00 p.m.

Submissions received by Thursday, 5 July 1990 will be dealt with in accordance with section 223 of the *Local Government Act 1989*.

DAVID McMILLAN  
Shire Secretary

10399

**SHIRE OF MYRTLEFORD**

**Local Law No. 1**

**Council Administration**

Notice is hereby given pursuant to the provisions of section 119 (2) of the *Local Government Act 1989*, that the Council of the Shire of Myrtleford intends at its Ordinary Meeting to be held on Tuesday, 3 July 1990, to make Local Law No. 1—Council Administration.

The purpose of Local Law No. 1 is to provide for the peace, order and good government of the Shire of Myrtleford, provide for matters which require a local law under the *Local Government Act*, regulate the use of the Common Seal, election of Shire President and proceedings of Council and committees of Council, and revoke By-law No. 17 of the Shire of Myrtleford.

A copy of the proposed Local Law can be obtained from the Council Office during normal business hours and any person affected by the proposed Local Law may make a submission which shall be considered by Council in accordance with section 223 of the *Local Government Act 1989*.

MARK HENDERSON  
Shire Secretary

10379

1906 G 24 20 June 1990

**SHIRE OF NEWHAM AND WOODEND**

**Vesting of Reserve**

Notice is given that on Tuesday, June 12 1990, the Council of the Shire of Newham and Woodend resolved that pursuant to the provisions of section 569BA (1) of the *Local Government Act* 1958, the whole of the land comprising the reserve for drainage, sewerage and recreation purposes, contained in lodged plan No. 96052, vest in the Shire of Newham and Woodend.

10355 **DAN DREW**  
Shire Secretary

**SHIRE OF ROMSEY**

**Local Laws**

Notice is hereby given that the Shire of Romsey has made new Local Laws.

These laws are titled "Shire of Romsey Local Laws".

The purpose of these laws is to—

- (i) provide for the peace order and good government of the municipal district of the Shire of Romsey; and
- (ii) provide for those matters which require a local law under the *Local Government Act* 1989 and any other Act; and
- (iii) provide for the administration of Council powers and functions; and
- (iv) prohibit, regulate and control activities, events, practices or behaviour in places so that no detriment is caused to the amenity of the neighbourhood, nor nuisance to a person nor detrimental effect to a person's property.

Council has confirmed these laws at the Ordinary Meeting of Council held on Wednesday, 13 June 1990.

Copies of the Local Laws are available for inspection or purchase at the Shire Offices, Romsey, during normal business hours.

10353 **B. F. CARNE**  
Shire Secretary

**SHIRE OF SOUTH GIPPSLAND**

**Local Law No. 2/1990**

**Meeting Procedures**

Notice is hereby given that the Council of the Shire of South Gippsland has made a Local Law No. 2/1990 outlining Council's Meeting Procedures.

A copy of the Local Law may be inspected at the Council Office, 14–18 Pioneer Street, Foster, during office hours.

10376 **H. R. LOMAX**  
Shire Secretary

*Victoria Government Gazette*

**SEWERING OF LONGWARRY**

Notice is hereby given that the Board has made application to the Minister for Conservation and Environment for the Proclamation of Longwarry Sewerage District and for the appointment of the Mornington Peninsula and District Water Board for the construction, maintenance and continuance of sewerage works within that District under the provisions of the Water and Sewerage Authorities (Restructuring) Act.

A general plan and description of the area to be sewered have been submitted with the application and copies of same may be seen at Board's Central Office, 47 Lawson Avenue, Frankston or at its Pakenham Branch Office, 25 Main Street, Pakenham. Copies may also be seen at the Office of Water Resources Victoria and Department of Health Victoria.

10194 **C. J. CALVERT**  
Secretary

**PAKENHAM WATER BOARD**

**General Notice**

The Pakenham Water Board, having made provision for carrying off the sewage from each and every property which, or any part of which, is within the Sewerage Area hereinbefore described, doth hereby declare that on or after the first day of July 1990 each and every property which, or any part of which, is within the said Sewerage Area shall be deemed to be a sewered property within the meaning of the Sewerage Districts Act.

**Declared Area No. 38**

Comprising Lots 285 to 326 inclusive off Barrington Drive and Harness Place being Stages 12 and 13 of the Bluegrass Subdivision, Pakenham.

**Declared Area No. 39**

Comprising Lots 55 to 101 inclusive together with Lots 166 to 174 inclusive being Stage 2 of the Rangeview Estate in the vicinity of Broadhurst Road, Dunbarton Drive and Nabilla Court, Pakenham.

**Declared Area No. 40**

Comprising Lots 1 to 22 inclusive Nathan Court (off Kennedy Road), Pakenham.

10333 **D. J. BOURKE, Chairman**  
**R. J. PERCY, Secretary**

Notice is hereby given that the Mirboo North Golf Club Incorporated has applied for a lease under section 134 of the *Land Act* 1958 for a term of twenty-one (21) years in respect of allotment 10A, Section 8, Township of Mirboo North for the purpose of Amusement and Recreation (Golf Club)

10345

GEELONG AND DISTRICT WATER  
BOARD

Pursuant to section 60 of the *Geelong Waterworks and Sewerage Act 1958* (No. 6263) the Board has prepared plans to indicate the particulars of sewers and underground works, the construction of which the Board intends to begin at a date not less than one month after publication of the notices, in or adjacent to the following locality within the Drainage Area.

Bailey Street, Belmont—City of South Barwon  
Notice is hereby given that the plans indicated are open for public inspection at the Board's Offices, 61–67 Ryrie Street, Geelong between the hours of 8.10 a.m. and 5.00 p.m. from Monday to Friday (public holidays excepted) by the owners or occupiers of land or premises within the Drainage Area.

R. A. JORDAN  
Secretary

10350

GEELONG AND DISTRICT WATER  
BOARD

The abovementioned Board having made provision for carrying off the sewage from each and every property which or any part of which is within the sewerage area hereinafter described doth hereby declare that on or after the first day of July 1990, each and every property which or any part of which is within the said sewerage area shall be deemed and taken to be seweraged property within the meaning of the said *Geelong Waterworks and Sewerage Act 1958*.

The respective sewerage areas hereinbefore referred to shall be known as Sewerage Area Nos:

- 1100—Plantation Road, Princess Road, Corio;
- 1105—Seventh Avenue, Anglesea;
- 1109—Montpellier Park Estate Stage 7;
- 1112—Plantation Road, Bacchus Marsh Road, Corio;
- 1113—Rosslare Estate, Battersea Rise, Westbury Court, Collendina;
- 1114—Knowl Court, Cotham Hill Road, Avon Court, Devon Court, Collendina;
- 1115—Carbine Drive, Bradford Street, Whittington;
- 1096—New Collendina Estate, Stage 10;
- 1120—Jackson Street, Noble Street, Anglesea;
- 1121—Hygea Court, Ibbotson Road, Indented Head;
- 1122—Domain Road, Sunset Strip, Jan Juc;
- 1123—Strathmore Drive, Jan Juc;
- 1124—Broderick Road, Heales Road, Lara;
- 1125—Grange Crescent, Lochard Drive, Torquay;
- 1126—Grosvenor Drive, The Strand, Highton;

- 1127—Vernon Close, Pendle Court, Domain Road, Jan Juc;
- 1128—Fraser Avenue, River Reserve Road, Anglesea;
- 1129—Wombah Park Estate Stage 13, Torquay;
- 1130—Freesia Court, Schmitt Court, Coppards Road, Whittington;
- 1131—Sharnahan Drive, Malinda Crescent, Ivan Court, Norlane;
- 1132—Leonora Court, Paley Park Estate Stage 6;
- 1133—Pinnacle Close, Barwon Boulevard, Highton;
- 1134—Buckingham Street, Windsor Court, Lara;
- 1135—Roxanne Place, Bellarine Highway, Newcomb;
- 1136—Strathmore Drive, Domain Road, Jan Juc;
- 1137—Bellevue Drive, Chateau Court, Cantal Court, Ocean Grove;
- 1138—Pepperdine Way, Highton;
- 1139—Michelle Court, Richard Drive, Forest Road, Lara;
- 1140—Crayfish Court, Ocean Beach Estate Stage 5, Ocean Grove;
- 1141—Kristy Court (Strathmore Heights Stage 5), Jan Juc;
- 1142—Melaluka Road, Koonangurt Road, Jessica Place, Abigail Court, Leopold;
- 1143—Chiswick Court, Silver Ridge Road, Lakeland Court, Point Lonsdale;
- 1144—Conowindra Place, Ainslie Avenue, Grovedale;
- 1145—Townsend Road, Coppards Road, Moolap;
- 1146—Waurmvale Drive, Waurm Park Court, Belmont;
- 1147—Golden Beach Way, The Esplanade, Torquay;
- 1149—Fairview Street, Drysdale;
- 1150—Ocean Beach Estate, Stage 3, Ocean Grove.

The boundaries of the said sewerage area numbers (as above) are delineated on various plans which may be inspected at the office of the Geelong and District Water Board.

Signed under the seal of the Geelong and District Water Board, 13 June 1990—

R. W. WHITESIDE, Chairman  
R. A. JORDAN, Secretary

10351

Notice is hereby given that the Torquay Bowls Club Inc. has applied for a lease under section 134 of the *Land Act 1958* for a term of (21) years

1908 G 24 20 June 1990

in respect of an area of 1.004 ha situated on allotment twenty-six of section sixty-five in the Parish of Puebla, County of Grant, for the use of amusement and recreation.

J. E. CROSS  
Secretary

10375

GEELONG AND DISTRICT WATER  
BOARD

5 December 1989 to 5 June 1990

Notice to Owners of Tenements in the undermentioned streets, and private streets, lanes, courts and alleys opening thereto:

City of Geelong

Dyson Court.

City of Newtown

Sherbourne Terrace, 140 m to 152 m east of Raith Terrace.

Shire of Bannockburn

Bannockburn—Levy Road, 300 m between Burnside Road and Government Road.

Government Road, 110 m west of Levy Road.

Burnside Road, 115 m west of Levy Road.

Shire of Winchelsea

Birregurra—Sladen Street, 92 m east of Beal Street.

Shire of Barrabool

Waurn Ponds—Princes Highway, 115 m to 150 m west of Marendaz Road.

Anglesea—Murray Street, between Hillcrest Road and Paringa Crescent.

Chatswood Drive, 136 m north west of Murray Street.

Jan Juc—Matlock Court, Delview Drive, 158 m west of Domain Road.

Shire of Corio

Lara—Stephenson Street; Windsor Court; 80 m to 95 m east of Rennie Street.

Richard Drive, 120 m west of Forest Road.

Michelle Court, Forest Road, 145 m north of Richard Drive.

Forest Road, 40 m south of Richard Drive.

North Geelong—Morgan Street, 245 m to 325 m west of Thompson Road.

Corio—Purnell Road, 150 m west of Matthews Road.

Lovely Banks—Cuddihy Court; Goldsworthy Road, 155 m north west of Cuddihy Court.

City of South Barwon

Grovedale—Meadowvale Drive, 167 m west of exist F.P.

Clover Court, Gloucester Street, 50 m north of Hume Street.

Essington Street, 160 m east of Torquay Road.

Victoria Government Gazette

Highton—Pepperdine Way, Denham Court, Bevington Court, Pinnacle Close, 100 m between exist F.P.

Torquay—The Esplanade, Liesbet Close, Shah Court, 175 m north-west of Liesbet Close.

Belmont—Waurn Park Court.

Queens Park—Leilani Court, Highett Road, 70 m west of Leilani Court.

Highett Road, 80 m east of Leilani Court.

Bellarine Rural City Council

Newcomb—Roxanne Place.

Ocean Grove—Bramwell Street, 75 m south of Madeley Street.

Leopold—Jessica Place, Abigail Court, Koonangurt Road, 225 m north of Pine Grove.

Heytesbury Drive, 100 m west of Koonangurt Road.

Dahlhaus Court, Warrawee Road, 210 m to 415 m east of Justin Court.

Luckman Court, Loupe Avenue, 120 m east of Ferguson Road.

Ferguson Road, 154 m north of Loupe Avenue.

Ferguson Road, 25 m south of Loupe Avenue.

Collendina—Fisher Court, Parma Crescent, Somerdale Avenue, 25 m south west of Parma Crescent.

Somerdale Avenue, 40 m north east of Parma Crescent.

Knowle Court, Avon Court, Devon Court, Cotham Hill Road, 30 m to 180 m south west of Eccles Road.

Drysdale—De Burgh Road, 85 m to 250 m north west of Princess Street.

Whittington—Carbine Drive, Grandross Place, Bradford Street, Pinder Street, 20 m west of existing Fire Plug.

The main pipe in the said streets laid down, the owners of all tenements situated above are hereby required on or before 30 June 1990, to cause a proper pipe and stop cocks to be laid so as to supply water within such tenements from the main pipe.

The Common Seal of the board was hereto affixed 13 June 1990, in the presence of:

R. W. WHITESIDE, Chairman  
R. A. JORDAN, Secretary

10352

Take notice that the Partnership previously subsisting between David Graham Kestle of Burnt Store Road, Larnder and Peter David Gibbs formerly of Labertouche Road, Labertouche and lately of Curries Road, Bona Vista in the State of Victoria was dissolved by mutual agreement on 8 September 1989. Thereafter Peter David Gibbs continued to use



*Victoria Government Gazette*

the name of Gistle Contractors and to conduct the business of a fencing contractor.

Take notice that David Graham Kestle will not accept responsibility for any liability incurred under the name of Gistle Contractors after 8 September 1989. 10329

**NOTICE OF DISSOLUTION OF PARTNERSHIP**

Notice is hereby given that the partnership heretofore subsisting between Angelo Giuseffi and Paul Keith White carrying on business at 3 Pearce Street, Crib Point, under the firm of A. P. & Co. Painting and Decorating has been dissolved as from 24 May 1990.

Loel J. Caldwell Pty., of 11 Herring Street, Hastings 10390

G 24 20 June 1990 1909

Ditara Pty. Ltd. has brought a summons in Action No. 788 of 1990 in the Supreme Court of South Australia seeking the winding up of Aura Hotels Pty. Ltd. The summons is listed for hearing on 27 June 1990 at not before 2.15 p.m. Any creditor or contributory of Aura Hotels Pty. Ltd. wishing to be heard on the summons must file and serve a Notice in accordance with Rule 32 of the Companies Rules 1985 at least three (3) business days before the day on which the summons is listed for hearing and must attend at the Supreme Courthouse, Victoria Square, Adelaide at the time set for the hearing of the summons. A copy of the summons and the affidavit in support can be obtained on payment of the proper cost from Corrs. Level 17, State Bank Centre, 91 King William Street, Adelaide 5000. Solicitors for Ditara Pty. Ltd. 10366

*Unclaimed Moneys Act 1962*

**Register of Unclaimed Moneys held by the—**

<i>Name of Owner on Books and Last Known Address</i>	<i>Total Amount Due to Owner</i>	<i>Description of Unclaimed Money</i>	<i>Date when Amount first became Payable</i>
<b>\$</b>			
<b>GORDON AND GOTCH LIMITED</b>			
Cullen, Jocelyn W, 2/3 Almora St, Mosman, NSW	32.00	Dividend	20.10.88
Fitsimmons, Norma A, Unit 10, 110-112 Spit Road, Mosman, NSW	21.20	"	"
Ford, Edna D I, 87 Gladstone Street, West Wyalong, NSW	176.80	"	"
Kennedy, Anthony J, c/o Coopers & Lybrand, 580 George St, Sydney, NSW	13.20	"	"
Maskell, Harold J, Flat 5, 27 Billyard Ave, Elizabeth Bay, NSW	24.40	"	"
Norreys Pty Ltd, 31 Woodville Ave, Wairoonga, NSW	21.60	"	"
Pemberton, Leonard W, 16 Addison St, Shellharbour, NSW	57.60	"	"
Saunders, Desmond, 6 West St, Lithgow, NSW	14.40	"	"
Jackson, Margaret, 18 Marlborough St, College Park, SA	12.80	"	"
Tucker, Edith L (estate of), c/o Tucker & Son, Strathalbyn, SA	10.87	"	8.1.87
Buntine, Carlyle M, 'Belle Vue', Darlington	12.96	"	"
Richardson, Elizabeth H, Box 4603, GPO Melbourne	16.00	"	20.10.88
Rowse, Beverley L, 32 Tooronga Rd, Hawthorn	12.62	"	8.1.87
Slamen, Melba M, 10 Shandford Ave, Brighton	35.60	"	20.10.88

10184  
National Protocol Support Centre Limited was placed in voluntary liquidation by a resolution of members passed 6 June 1990.

Surplus assets have been distributed to:

Osicom Incorporated

Standards Australia

Aterb

To pursue objectives similar to those of the Centre. 10372

Creditors next of kin and others having claims in respect of the estate of Ida Mary Crabb late of 5 Wilton Grove, Elwood in the State of Victoria, deceased who died on 6 December 1989 are

required to send particulars of their claims to the legal personal representatives Pamela Mary Ogle and David Maxwell Crabb care of the undermentioned solicitors on or before 31 August 1990 after which date the legal personal representatives will distribute the estate having regard only to the claims of which they then have notice.

DAVID SONENBERG & ASSOCIATES, 293 Bay Street, Brighton 10316

Creditors, next of kin and others having claims in respect of the estate of Francis Xavier Plumstead late of 24 Yendon Road, Glenhuntly, gentleman deceased, who died on 5 February

1910 G 24 20 June 1990

1990 are required by the executor National Mutual Trustees Limited of 419 Collins Street, Melbourne to send particulars of their claims to the said company by Friday, 24 August 1990 after which date it will convey or distribute the assets, having regard only to the claims of which the company then has notice.

GEOFFREY J. OGGE & CO., solicitors, 537 Malvern Road, Toorak 10318

LEONARD ALBERT LARKIN, late of 10 Arapilles Drive, Lower Templestowe, accountant deceased

Creditors, next of kin and others having claims in respect of the estate of the deceased who died on 13 January 1990 are required by Perpetual Trustees Victoria Limited of 50 Queen Street, Melbourne and Dale McLaughlin of 138 Beach Road, Sandringham, secretary, the applicants for a grant of Probate, to send particulars of their claims to the applicants in the care of the said company by 21 August 1990 after which date they will convey or distribute the assets having regard only to the claims of which they then have notice.

ALAN WAINWRIGHT J. OKNO & CO., solicitors, 213 Lonsdale Street, Melbourne 10315

JOHN THOMAS PETTINGILL late of 12 Pretoria Street, Balwyn in the State of Victoria retired deceased

Creditors next of kin and others having claims in respect of the estate of the abovenamed deceased who died on 10 November 1989 are required to send particulars of their claims in the substitute executor Edward Keith O'Donnell of 4 Halifax Street, Brighton in the State of Victoria, retired by 28 August 1990 after which date they may convey or distribute the assets having regard only to the claims of which they then have notice.

AITKEN, WALKER & STRACHAN, solicitors, 114 William Street, Melbourne 10317

MURIEL DALTON, late of 10 Penny Avenue, Warragul, retired deceased

Creditors, next of kin and others having claims in respect of the estate of the deceased who died on 1 April 1990 are required by the trustees Colin Keith Silcock and Randall Charles Cadby to send particulars of their claims to them care of the undersigned solicitors by 27 August 1990 after which date the trustees may convey or distribute the assets having regard only to the claims of which they then have notice.

GRAY, FRIEND & LONG, solicitors, Warragul 10326

*Victoria Government Gazette*

DESMOND KINDER LAWRENCE late of 57 Valias Street, Warrandyte, retired gentleman, deceased

Creditors, next of kin and others having claims in respect of the estate of the deceased who died on 31 March 1990 are required by the executors Peter Desmond Lawrence of 17 Quality Court, Hastings Crane Operator and Grant Jeffery Neylon formerly of 29 Valias Street, North Warrandyte but now of 11 Hamilton Close, Kilsyth Motor Mechanic to send particulars to the undermentioned firm by 30 August 1990 after which date the said executors may convey or distribute the assets having regard only to the claims of which notice has by then been given.

SEXTON WILLIAMS & SMYTH, solicitors, 900 Main Road, Eltham 10325

Creditors, next of kin and others having claims in respect of the estate of Morris Herbert Roberts late of 5 Lalbert Road, Lake Boga, retired farmer, deceased (who died between 27 and 28 November 1989) are required by the executrix Irene Ella Roberts to send particulars to her care of the undersigned by 6 August 1990, after which date the executrix may convey or distribute the assets having regard only to the claims of which she then has notice.

FINDLAY McGRATH & TOMLINSON, solicitors, 51 McCallum Street, Swan Hill 10327

Creditors, next of kin or others having claims in respect of the estate of Helen Bassett Tresise late of "Willowbrooke" Willow Road, Upper Ferntree Gully, widow, deceased, who died on 20 March 1990 are to send particulars of their claim to the executors care of the undermentioned solicitors by 13 August 1990, after which date the executors will distribute the assets having regard only to the claims of which they then have notice.

ARMSTRONG, SINGER & ROSS, solicitors, 647A Main Street, Belgrave 10328

IVY MARY WAGNER, formerly of Neerim South Road, Jindivick but late of Jacksons Track, Jindivick, widow, deceased

Creditors, next of kin and others having claims in respect of the estate of the deceased who died on 25 March 1990 are required by the trustees Joan Mary Elizabeth Wagner and Allen Geoffrey Wagner to send particulars of their claims to them care of the undersigned solicitors by 20 August 1990 after which date the trustees may convey or distribute the assets having regard only to the claims of which they then have notice.

GRAY, FRIEND & LONG, solicitors, Warragul 10330

**CHARLES HENRY DEAR**, late of 5 Muir Avenue, Kerang in the State of Victoria, farmer, deceased

Creditors, next of kin, and all other persons having claims against the estate of the said deceased are required by National Mutual Trustees Limited of 419 Collins Street, Melbourne in the said State formerly and in the will described as National Mutual Trustees Limited of 46 Queen Street, Bendigo in the State of Victoria and Sylvia Gwendolene Dear of 5 Muir Street, Kerang in the said State, widow the executors of the estate of the said deceased to send particulars of such claims to them direct at the above address on or before 30 August 1990 after which date they will distribute the assets having regard only to the claims of which they then have notice.

**STEWART & SONS PTY**, solicitors, 26 Gillies Street, Rochester 10331

**SALVATORE FARRUGIA**, late of 25 Kodre Street, St Albans, retired, deceased

Creditors, next of kin and others having claims in respect of the estate of the deceased who died on 21 September 1989 are required by Michael Farrugia of 14 Curtain Street, St Albans and Joseph Farrugia of 21 Prospect Drive, Avondale Heights, the executors to whom probate of the will of the said deceased was granted by the Supreme Court of Victoria to send particulars care of the undersigned by 27 August 1990 after which date the said executors may convey or distribute the assets having regard only to the claims of which they then have notice.

**PATRICK J. CANNON COBURN & ASSOCIATES**, solicitors, 205 Hampshire Road, Sunshine 10332

**STANLEY DESMOND McMINN**, late of Unit 1/10 South Audley Street, Brunswick, in the State of Victoria, bar manager, deceased

Creditors, next of kin and others having claims in respect of the estate of the deceased who died on 4 May 1989, are required by the administratrix, Hazel June Reid, care of Arthur J. Dines & Co., Solicitors of 2A Highlands Road, Thomastown, in the said State, to send particulars to her by 20 August 1990, after which date the administratrix may convey or distribute the assets having regard only to claims of which she then has notice.

Dated 13 June 1990

**ARTHUR J. DINES & CO.**, solicitors, 2A Highlands Road, Thomastown 10347

Creditors, next of kin and others having claims in respect of the estate of Roma Cecilia Kent, late of Unit 7, 4 Raith Avenue, Sandringham in

the State of Victoria, spinster, deceased intestate who died on 21 January 1990 are required by the administratrix of the estate Laudes Mary Morgan of 1 Watson Street, Clontarf, in the State of Queensland, widow, to send particulars of their claims in writing care of the undermentioned solicitors by 28 August 1990 after which date she will distribute the assets having regard only to the claims of which she then has notice.

**TRAGEAR & ASSOCIATES**, solicitors, 39 Melrose Street, Sandringham 10361

**VERA ALICE CORNISH**, late of 41 Cotham Road, Kew in the State of Victoria, single woman, deceased

Creditors, next of kin and others having claims in respect of the estate of the abovenamed deceased who died on 12 December 1989 are required by Paul Morris Natoli, solicitor of 24 Cotham Road, Kew in the State of Victoria, Angelo Basilio Natoli, solicitor of 24 Cotham Road, Kew in the said State and Reginald John Baxter accountant of 78 Panoramic Road, North Balwyn in the said State, the executors of the deceased's will, to send particulars of their claims to the said executors care of the undermentioned solicitors by 14 September 1990 after which date they will convey or distribute the assets having regard only to the claims of which they then have notice.

**A. B. NATOLI PTY.**, solicitors, 24 Cotham Road, Kew 10360

**MARGARET MILLAR TAIT**, late of 72 Wyndham Street, Kerang in the State of Victoria, widow, deceased

Creditors, next of kin and all other persons having claims against the estate of the said deceased are required by Elizabeth English of Meran Park, R.S.D., Kerang in the State of Victoria, married woman and Margaret Arnoldt of 72 Wyndham Street, Kerang in the State of Victoria, registered nurse, the executors of the estate of the said deceased to send particulars of such claims to them in care of the undermentioned solicitors on or before 15 August 1990 after which date they will distribute the assets having regard only to the claims to which they then have notice.

**BASILE & CO.**, barristers and solicitors, 46 Wellington Street, Kerang 10359

Creditors, next of kin and others having claims in respect of the estate of Adam Stott, formerly of 38 Kangaroo Avenue, Dromana, in the State of Victoria, taxi driver proprietor, but late of 1272 Centre Road, Clayton in the State of Victoria, retired, deceased, who died on 6 November 1989, are required by the executors of the estate Laura Florence Stott, 1272 Centre

1912 G 24 20 June 1990

Road, Clayton, in the said State, widow, and National Mutual Trustees Limited, 419 Collins Street, Melbourne, in the said State, formerly and in the will described as National Trustees Executors and Agency Company of Australasia Limited, 95 Queen Street, Melbourne, in the said State, to send particulars of their claims in writing to National Mutual Trustees Limited of 419 Collins Street, Melbourne, by 28 August 1990 after which date they will distribute the assets having regard only to the claims of which they then have notice.

TRAGEAR & ASSOCIATES, solicitors, 39  
Melrose Street, Sandringham 10362

Creditors, next of kin and others having claims in respect of the estate of William Frederick James Perkin, late of Lawson Road, Lyonville, Victoria, deceased, who died on 4 December 1989 are required to send particulars of their claims to the executor National Mutual Trustees Limited the Company's registered office, 419 Collins Street, Melbourne, by 20 August 1990, after which date the executor will distribute the assets having regard only to the claims of which it then has notice.

10367

KIMBALL JOHN KEERIE, late of 122 Monbulk Road, Emerald in the State of Victoria, gentleman

Creditors, next of kin and others having claims in respect of the estate of the deceased, who died on Wednesday, 24 January 1990, are required by the trustees, Peter Page of 'Dovelia' Monbulk Road, Emerald, Victoria and Douglas Allison of Butterfield Road, Victoria to send particulars to their solicitor, Edward G. Halse, LL.B., 371 Main Road, Emerald 3782, by 31 August 1990, after which date the trustees may convey or distribute the assets, having regard only to the claims of which they then have notice.

Dated 20 June 1990

EDWARD G. HALSE, solicitor for trustees  
10365

Creditors, next of kin and others having claims in respect of the estate of George Tillet Brewer, late of Unit 8, 23-27 Mernda Avenue, Glenhuntly, in the State of Victoria, retired gentleman, deceased, who died on 1 May 1990, are to send particulars of their claims to the executor, Reginald Charles Butler of 36 Jasper Road, Moorabbin, in the said State Solicitor care of the undermentioned solicitors by 22 August 1990, after which date he will distribute the assets having regard only to the claims to which he then has notice.

REGINALD C. BUTLER & CO., solicitors,  
312 Centre Road, Bentleigh 10363

*Victoria Government Gazette*

Creditors, next of kin and others having claims in respect to the estate of Minnie Eveline McMaster, late of 691 Mount Dandenong Road, Kilsyth in the State of Victoria, widow, deceased, who died on 17 April 1990, are to send particulars of their claims to the executor, Donald Hugh McMaster, of 5 Windsor Avenue, Bentleigh in the said State, retired gentleman, care of the undermentioned solicitors by 22 August 1990 after which date he will distribute the assets having regard only to the claims to which he then has notice.

REGINALD C. BUTLER & CO., solicitors,  
312 Centre Road, Bentleigh 10364

Creditors, next of kin and others having claims in respect of the estate of George Rosenthal late of Unit 8, 696 Inkerman Road, North Caulfield in the State of Victoria, retired, deceased, who died on 14 April 1990 are required to send particulars of their claims to the executor, National Mutual Trustees Limited of 419 Collins Street, Melbourne by 28 August 1990, after which date the executor will distribute the assets having regard only to the claims of which it then has notice.

PETER J. WALSH & JOHN F. CARROLL,  
solicitors, 83 William Street, Melbourne 10368

Creditors, next of kin and others having claims in respect of the estate of Annie White Dodds late of Royal Freemasons Homes of Victoria, 313 Punt Road, Prahran, widow, deceased, who died on 16 April 1990 are required by the executors of her will, Eileen Downes of 85 King Street, Queenscliff, home duties and Alan Robert Davis of 12 Elana Court, Wantirna South, medical scientist, to send particulars to them care of the undermentioned solicitors by 23 August 1990 after which date the executors may convey or distribute the assets having regard only to the claims of which they then have notice.

ANDERSON RICE, solicitors of 51 Queen  
Street, Melbourne 10391

BARBARA ELLEN HALL, late of Nyah West in the State of Victoria, widow, deceased (who died on 25 September 1989)

Creditors, next of kin and other persons having claims against the estate of the deceased are required by the executor of the will, Douglas Lionel Hall and Neville Masterton Hall to send particulars to them care of the undersigned on or before 8 August 1990 after which date they will distribute the assets having regard only to the claims of which they then have notice.

GARDEN & GREEN, solicitors, 4 McCallum  
Street, Swan Hill 10393

IVY MAY HEARD, formerly of 113 Chapman Street, Swan Hill in the State of Victoria, but late of 29 Robb Street, East Bairnsdale in the said State, widow, deceased (who died on 20 September 1989)

Creditors, next of kin and all other persons having claims against the estate of the deceased are required by the executors of the will, Ethel Jean Shawcross and William James Heard to send particulars to them care of the undersigned on or before 8 August 1990 after which date they will distribute the assets having regard only to the claims of which they then have notice.

GARDEN & GREEN, solicitors, 4 McCallum Street, Swan Hill 10394

VERONICA ELLEN NEYLAN, late of 24 Bowen Street, Hawthorn, widow, deceased

Creditors, next of kin and others having claims in respect of the estate of the deceased who died on 24 March 1990 are required by the trustee David Barrett Jones, of 257 Collins Street, Melbourne to send particulars to him within two calendar months of the date of this notice after which date the trustee may convey or distribute the assets, having regard only to the claims of which he then has notice.

Messrs SEPTIMUS JONES & LEE, solicitors, 257 Collins Street, Melbourne 10392

ARCHIBALD LESLIE MOULTON, late of 154 Barkly Street, North Fitzroy, in the State of Victoria, retired

Creditors, next of kin and others having claims in respect of the estate of the deceased who died on 26 March 1990 are required by the Trustee National Mutual Trustees Limited of 419 Collins Street, Melbourne in the State of Victoria to send particulars to them by 17 August 1990 after which the trustee may convey or distribute the assets having regard only to the claim of which they then have notice 10370

Creditors, next of kin and others having claims in respect of the estate of Alexander Lochart Muir, late of 35 Munday Street, Torquay, gentleman deceased, who died on 12 November 1989 are to send the particulars of their claims to ANZ Executors & Trustee Company Limited of 91 William Street, Melbourne by 10 August 1990, after which date it will distribute the assets having regard only to the claims of which it then has notice 10371

Creditors, next of kin and others having claims in respect of the estate of Harold Calvert Williamson, late of 83 Paxton Street, East Malvern, retired deceased, who died on 28 March 1990 are to send the particulars of their claims to ANZ Executors & Trustee Company Limited of

91 William Street, Melbourne by 20 August 1990 after which date it will distribute the assets having regard only to the claims of which it then has notice 10369

Creditors, next of kin and others having claims against the estate of Mary Veronica Withers, late of 155 Holland Road, South Blackburn, widow, deceased (who died on 7 March 1990), are required by Sandra Veronica Baird, the executor of the will of the said deceased to send to her care of the undersigned solicitors particulars thereof by 5 September 1990, after which date she will distribute the assets of the deceased having regard only to the claims of which she shall then have notice.

GAVIN DUFFY & KING, solicitors, 83 William Street, Melbourne 10395

HECTOR VIVIAN McLEAN, formerly of Wrights Road, Warragul, but late of 30 Brandy Road, Warragul, retired, deceased

Creditors, next of kin and others having claims in respect of the estate of the deceased who died on 20 January 1990 are required by the trustee, Mercy Doris McLean, to send particulars of their claims to her care of the undersigned solicitors by 31 August 1990, after which date the trustee may convey or distribute the assets having regard only to the claims of which she then has notice.

GRAY, FRIEND & LONG, solicitors, Warragul 10396

MARY JANE PEACH, late of 1 York Street, Glenroy, in the State of Victoria, widow, deceased

Creditors, next of kin and others having claims in respect of the estate of the deceased who died on 7 November 1989, are required by the personal representatives Robert George Klippel and Elizabeth Mary Houston to send particulars to them in care of G. J. Long & Co., solicitors, P.O. Box 7, Corryong, 3707 by 24 August 1990 after which date the personal representatives may convey or distribute the assets having regard only to the claims of which they then have notice.

Dated 12 June 1990

G. J. LONG & CO., solicitors, P.O. Box 7, Corryong 3707 1039

PHOEBE SARAH MASTERS, late of 34 Towong Road, Corryong, in the State of Victoria, widow, deceased

Creditors, next of kin and others having claims in respect of the estate of the deceased who died on 17 February 1990 are required by the personal representatives Beaumont Sydney Harris and Kenneth Dawson Harris, to send particulars to them in care of G. J. Long & Co., solicitors, P.O. Box 7, Corryong, 3707 by 24 August 1990 after

1914 G 24 20 June 1990

which date the personal representatives may convey or distribute the assets having regard only to the claims of which they then have notice.

Dated 12 June 1990

G. J. LONG & CO., solicitors, P.O. Box 7,  
Corryong 3707 10398

MANYDOTTE, IVY WILSON, formerly of  
1476 Malvern Road, Glen Iris, but late of 400  
Waverley Road, East Malvern, spinster,  
deceased

Creditors, next of kin and others having claims in respect of the estate of the deceased who died on 2 April 1990 are required by the legal personal representative, Jeanette Dorothy Overall Enden, of 257 Collins Street, Melbourne solicitor, to send particulars to her by 1 September 1990, after which date she may convey or distribute the assets having regard only to the claims of which she then has notice.

F. P. JOHNSON & DAVIES, solicitors, 257  
Collins Street, Melbourne 10407

GRACE BESSIE DOROTHEA FOLEY, late of  
77 Parker Street, Williamstown, home duties,  
deceased

Creditors, next of kin and others having claims in respect of the estate of the deceased who died on 9 June 1990 are required by the applicants for Grant of Probate, Andrew Charles Armstrong of 4 St Andrews Drive, Werribee, and Raymond Emilio Agius, of 52 Hornsby Drive, Langwarrin, to send particulars to them by 14 September 1990, after which date they may convey or distribute the assets having regard only to the claims of which they then have notice.

HENDERSON & BALL, solicitors, 722 High  
Street, East Kew 10404

After 14 clear days application will be made to the Supreme Court that Probate of the Will dated 16 September 1960 of George Douglas Duncan, late of "Glencoe" Duncans Lane, Diggers Rest, deceased, be granted to George Gregory Duncan of "Glencoe" Duncans Lane, Diggers Rest, Farmer and Judith Lorraine Hutchinson (in the Will called Judith Lorraine Duncan) of "Camelot", 230 Duncans Lane, Diggers Rest, married woman, two of the executors appointed by the said will, Beryle Elda Duncan, the other executor appointed therein having predeceased the said deceased.

MADDOCK LONIE & CHISHOLM,  
solicitors, 440 Collins Street, Melbourne,  
solicitors for the applicants 10405

Creditors, next of kin and others having claims in respect of the estate of Adrian David Swan, late of 7 Admans Avenue, Seaford, ice skating coach, deceased who died on 29 September 1989 are to send particulars of their claims to the

*Victoria Government Gazette*

Equity Trustees, Executors and Agency Company Limited of 472 Bourke Street, Melbourne by 28 August 1990 after which date it will distribute the assets having regard only to the claims of which it then has notice.

EALES AND MACKENZIE, solicitors, 116  
Main Street, Lilydale, 3140 10410

CARMEN BAJONA, late of No. 11 Erica  
Avenue, St Albans, widow, deceased

Creditors, next of kin and others having claims in respect of the estate of the deceased who died on 7 March 1990 are required by Alfred Micallef-Grimaud of No. 2 Clacton Street, St Albans, the executor appointed by the Supreme Court of Victoria in its Probate Jurisdiction and to whom Probate was granted on 13 June 1990 of the Estate of the deceased to send particulars of their claims to him by 10 August 1990, after which date he will convey or distribute the assets having regard only to the claims of which he then has notice.

ZACCARO & CO., solicitors, of No. 17  
Alfreda Street, St Albans 3021 10408

JEAN EILEEN HUNT, late of 51 Nolan Street,  
Kerang, in the State of Victoria, home duties,  
deceased

Creditors, next of kin and all other persons having claims against the estate of the said deceased are required by Diane Fay Hunt of 9 Taverner Court, Kerang in the State of Victoria, home duties, the executors of the estate of the said deceased, to send particulars of such claims to them in care of the undermentioned solicitors on or before 12 August 1990, after which date they will distribute the assets having regard only to the claims to which they then have notice.

BASILE & CO., barristers and solicitors, 46  
Wellington Street, Kerang, Victoria, 3579 10409

The Supreme Court of the State of Victoria

**SALE BY THE SHERIFF**

On 31 July 1990 at 2.00 p.m. at the police station, Ouyen (unless process be stayed or satisfied)

All the estate and interest (if any) of Edward Arthur Shaddock of RMB Lot 3, Galah, as the proprietor of an estate in fee simple in the land described on Certificate of Title, Volume 8067, Folio 917, upon which is erected a dwelling and a machine shed. This property contains approximately 620 acres.

Registered Mortgage No. M353622 and Caveat M516031Q affect the said estate and interest.

All the estate and interest (if any) of Edward Arthur Shaddock of RMB Lot 3, Galah, as the proprietor of an estate in fee simple in the land described on Certificate of Title Volume 6454, Folio 1290667, known as Allotment 38A and which is vacant land.

Registered Mortgage No. M353622Q and Caveat M5160301Q affect the said estate and interest.

All the estate and interest (if any) of Edward Arthur Shaddock of RMB Lot 3, Galah, as proprietor of an estate in fee simple in the land described on Certificate of Title Volume 8180, Folio 853. This property contains approximately 701 acres in Allotment 24 and approximately 641 acres in Allotment 36. Allotment 24 has a weatherboard dwelling, one grain silo and two small dams, Allotment 36 has one dam, and 3 new stand shearing shed and a steel yard.

Registered Mortgage M353622Q and Caveat M516031Q affect the said estate and interest.

All the estate and interest (if any) of Edward Arthur Shaddock of RMB Lot 3, Galah, as proprietor of an estate in fee simple in the land described on Certificate of Title Volume 7549, Folio 077, known as Allotment 37. The property contains approximately 640 acres and is vacant land.

Registered Mortgage No. M353622Q and Caveat M516031Q affect the estate and interest.

The defendant's properties are located on Corbett Road, Galah, approximately 6.4 kilometres west of the intersection of Corbett Road and Ouyen Highway, Galah.

Terms—Cash only

H. BUETTNER  
Sheriff's Officer

1916 G 24 20 June 1990

NOTICE OF MAKING OF  
STATUTORY RULES  
WHICH ARE NOT YET  
AVAILABLE

Victoria Government Gazette  
Melbourne and  
Metropolitan Board of  
Works Act 1958

125/1990 By-Law No. 266: Trade  
Waste (Amendment)

Notice is given of the making of the following  
Statutory Rules:

- Intellectually Disabled  
Persons' Services Act 1986*
- 117/1990 Intellectually Disabled  
Persons' Services  
(Prescription of Form)  
Regulations 1990
- Melbourne and  
Metropolitan Board of  
Works Act 1958*
- 118/1990 Special By-Law No. 34:  
Water Supply and  
Sewerage Services to  
Non-Rateable Property  
and Cultural and  
Recreational Lands  
(Amendment)
- Public Authorities Marks  
Act 1958*
- 119/1990 By-Law No. 273:  
Approving and  
Stamping of Materials  
(Amendment)
- Health Services Act 1988*
- 120/1990 Hospitals and Charities  
(Fees) (Special Class  
Patients) Regulations  
1990
- Marine Act 1988*
- 121/1990 Marine (Procedures)  
(Blood Samples)  
Regulations 1990
- Road Safety Act 1986*
- 122/1990 Road Safety (Bicycle  
Helmets) Regulations  
1990
- Transport Act 1986*
- 123/1990 Transport Accident  
(Charges)  
(Amendment)  
Regulations 1990
- Supreme Court Act 1986*
- 124/1990 Supreme Court (Chapter  
VI Amendment No. 2)  
Rules 1990



**NOTICE OF MAKING  
AND AVAILABILITY OF  
STATUTORY RULES**

In pursuance of the provisions of the *Subordinate Legislation Act 1962* and the Regulations made thereunder notice is given of the making and availability of the following Statutory Rules:

Note: The date specified after each Statutory Rule is the date it was first obtainable from—  
VGPO Mail and Bulk Order Sales  
66-112 Macaulay Rd, North Melbourne, 3051  
Tel: 320 0201

*Fisheries Act 1968*  
101/1990 Fisheries (Prescribed  
Financial Interest)  
Regulations 1990

15 June 1990 Code 1

*Wildlife Act 1975*  
102/1990 Wildlife (Whale  
Watching) Regulations  
1990

13 June 1990 Code 1

*Alpine Resorts Act 1983*  
103/1990 Alpine Resorts  
(Application Fees)  
Regulations 1990

13 June 1990 Code 1

*Alpine Resorts Act 1983*  
104/1990 Alpine Resorts (Leasing)  
(Amendment)  
Regulations 1990

13 June 1990 Code 1

*Alpine Resorts Act 1983*  
105/1990 Alpine Resorts (Entry)  
(Amendment)  
Regulations 1990

13 June 1990 Code 1

*County Court Act 1958*  
106/1990 County Court (Chapter II  
Amendment No. 1)  
Rules 1990

13 June 1990 Code 1

*Melbourne and  
Metropolitan Board of  
Works Act 1958*

107/1990 By-Law No. 270:  
Metropolitan Parks—  
Charges and Fees  
(Amendment)

13 June 1990 Code 1

*Melbourne and  
Metropolitan Board of  
Works Act 1958*

108/1990 By-Law No. 271:  
Plumbing Code and  
Sewerage Regulations  
(Amendment)

13 June 1990 Code 1

*Melbourne and  
Metropolitan Board of  
Works Act 1958*

109/1990 By-Law No. 272: Water  
Supply (Amendment)

13 June 1990 Code 1

*Melbourne and  
Metropolitan Board of  
Works Act 1958*

110/1990 By-Law No. 274: Fees for  
Restriction or  
Withdrawal and  
Restoration of Water  
Supply (Amendment)

15 June 1990 Code 1

*Melbourne and  
Metropolitan Board of  
Works Act 1958*

111/1990 By-Law No. 275: Special  
Meter Reading Fee  
(Amendment)

15 June 1990 Code 1

*Melbourne and  
Metropolitan Board of  
Works Act 1958*

112/1990 By-Law No. 276: Rate  
Certificate Fee  
(Amendment)

15 June 1990 Code 1

*Melbourne and  
Metropolitan Board of  
Works Act 1958*

113/1990 By-Law No. 277:  
Encumbrance  
Certificate Fee  
(Amendment)

15 June 1990 Code 1

1918 G 24 20 June 1990

*Weights and Measures Act*  
1958

114/1990 *Weights and Measures*  
(Beer Glass  
Amendment)  
Regulations 1990

15 June 1990 Code 1

*Country Fire Authority*  
Act 1958

115/1990 *Country Fire Authority*  
(Fees) Regulations 1990

15 June 1990 Code 1

*Racing Act 1958*

116/1990 *Racing (On-Course*  
*Totalizator)*  
(Amendment)  
Regulations 1990

15 June 1990 Code 1

*Public Service Act 1974*

PSD10/1990 *Public Service*  
*Determinations (No.*  
10) 1990

Code 1

*Public Service Act 1974*

PSD11/1990 *Public Service*  
*Determinations (No.*  
11) 1990

Code 1

Price Code	No. of Pages (Including cover and blank pages)	Price
1	1-4	\$0.45
2	5-8	\$0.80
3	9-12	\$1.10
4	13-16	\$1.60
5	17-24	\$1.90
6	25-32	\$2.40
7	33-40	\$2.70
8	41-48	\$3.00
9	49-56	\$3.40
10	57-64	\$3.70
11	65-72	\$4.00
12	73-80	\$4.25
13	81-88	\$4.70
14	89-96	\$5.10
Each additional 16 pages or part thereof		\$0.67

*Victoria Government Gazette*

*Victoria Government Gazette*

*G 24 20 June 1990 1919*

1920 G 24 20 June 1990

*Victoria Government Gazette*

*Victoria Government Gazette*

*G 24 20 June 1990 1921*

---

1922 G 24 20 June 1990

*Victoria Government Gazette*

---

*Victoria Government Gazette*

*G 24 20 June 1990 1923*

CONTENTS	
----------	--

	Page
Appointments	1891
Bank Holidays	1862
Cemeteries—Scale of Fees	1888
Contracts	1881
Contracts Accepted—Amendments	1880
Government Notices	1864
Melbourne and Metropolitan Board of Works	1875
Notice of Making of Statutory Rules	1916
Orders in Council—	
Acts—Cemeteries; Post-Secondary Education; Public Account; Land Conservation; Local Government	1888
Police Sale	1881
Private Advertisements	1896
Proclamations	1862
Public Half-Holidays	1862
Public Holidays	1862
Tenders	1895

A Victorian Government Publication

Published by VGPO  
Melbourne Victoria Australia  
© State of Victoria 1990

This publication is copyright. No part may be reproduced by any process except in accordance with the provisions of the Copyright Act.

Address all inquiries to the Government Printer  
for the State of Victoria  
PO Box 203 North Melbourne 3051 Victoria Australia  
ISSN 0819—5471

Jean Gordon Government Printer Melbourne

**Counter Sales**

Information Victoria Bookshop  
318 Lt. Bourke Street Melbourne 3000  
Telephone inquiries (03) 663 3760

**Mail and Bulk Order Sales**

VGPO  
PO Box 203 North Melbourne 3051  
66-112 Macaulay Road North Melbourne 3051  
Telephone inquiries (03) 320 0201

**Recommended Retail Price \$1.20**