

# PROCLAMATIONS

## *Administrative Appeals Tribunal (Planning) Act 1990*

### PROCLAMATION OF COMMENCEMENT

I, J. Davis McCaughey, Governor of Victoria, acting with the advice of the Executive Council and under section 2 of the *Administrative Appeals Tribunal (Planning) Act 1990*, fix 5 September 1990 as the day on which the following provisions of the *Administrative Appeals Tribunal (Planning) Act 1990* come into operation:

PART 1;

PART 2 (Except S4, S8 (2);

PART 3 (Except S13 (3), S14, S18 (2).

Given under my hand and the seal of Victoria at Melbourne on 4 September 1990

(L.S.) J. DAVIS McCaughey

By His Excellency's Command

J. H. KENNAN

Attorney-General

20430

## *Second-Hand Dealers and Pawnbrokers Act 1989*

### PROCLAMATION

I, J. Davis McCaughey, Governor of Victoria acting with the advice of the Executive Council and under section 2 of the *Second-Hand Dealers and Pawnbrokers Act 1989*, fix 10 September 1990 as the day on which that Act (except section 35 (6) and (7)) shall come into operation.

Given under my hand and the seal of Victoria at Melbourne on 4 September 1990

(L.S.) J. DAVIS McCaughey

By His Excellency's Command

J. H. KENNAN

Attorney-General

20430

### *Reference Areas Act 1978*

## PROCLAMATION OF CARPENDUIT, TOMAHAWK CREEK, EAST CALEDONIA, WONNANGATTA RIVER AND BLUE RAG REFERENCE AREAS

I, J. Davis McCaughey, Governor of Victoria, acting with the advice of the Executive Council and under section 4 of the *Reference Areas Act 1978*, proclaim the areas shown on plans numbered R.A.5, R.A.6, R.A.8, R.A.9 and R.A.10 in the attached schedule, the originals of which are lodged at the Department of Conservation and Environment, 240 Victoria Parade, East Melbourne 3002 to be the Carpenduit, Tomahawk Creek, East Caledonia, Wonnangatta River and Blue Rag Reference Areas.

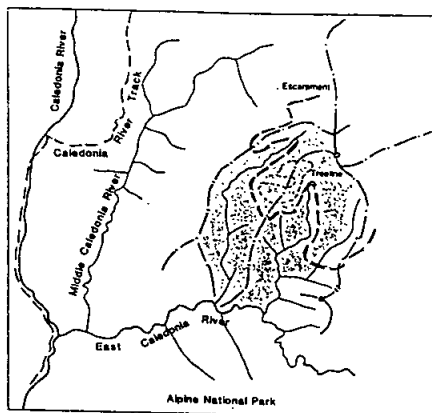

DEPARTMENT OF CONSERVATION AND ENVIRONMENT  
References Areas Advisory Committee  
**East Caledonia Reference Area**

Parish of Reynard

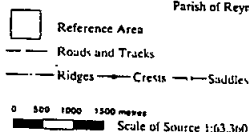

Map Number RA 8

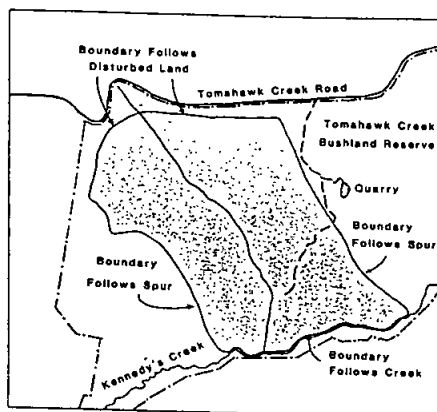
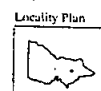

DEPARTMENT OF CONSERVATION AND ENVIRONMENT  
References Areas Advisory Committee  
**Tomahawk Creek Reference Area**

Parish of Coradji

Map Number RA6

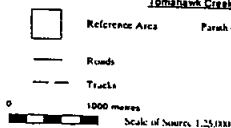

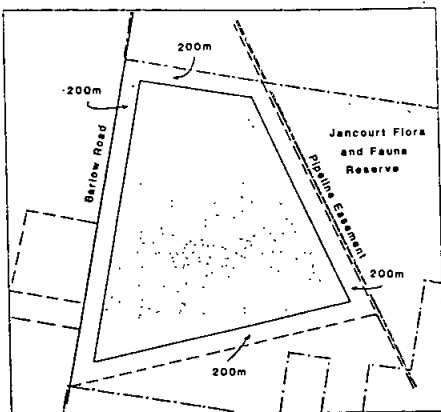

DEPARTMENT OF CONSERVATION AND ENVIRONMENT

References Areas Advisory Committee

Carpendell Reference Area

Reference Area

Parish of Carpendock

Map Number RA5

Roads

Tracks

Pipelines

0 1000 metres  
Scale of Source 1:25,000

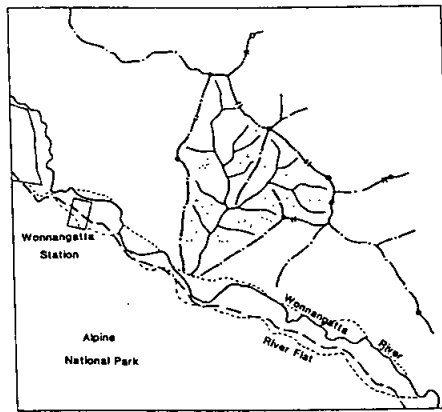

DEPARTMENT OF CONSERVATION AND ENVIRONMENT

References Areas Advisory Committee

Wonnangatta River Reference Area

Reference Area

Parish of Bolaira

Map Number RA 9

Roads and Tracks

Ridges

Crests

Saddles

0 500 1000 1500 metres  
Scale of Source 1:63,360

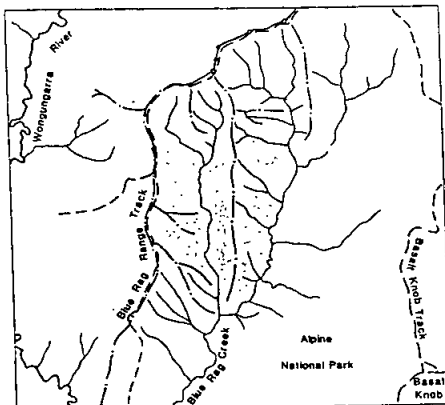
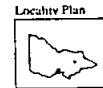

DEPARTMENT OF CONSERVATION AND ENVIRONMENT

References Areas Advisory Committee

Blue Rag Reference Area

Parish of Graham

Reference Area

Roads and Tracks

Ridges

Crests

Saddles

0 500 1000 1500 metres  
Scale of Source 1:63,360

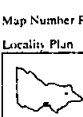

Given under my hand and the seal of  
Victoria on 28 August 1990

(L.S.) J. DAVIS McCAUGHEY

By His Excellency's Command

S. M. GRABB

Minister for Conservation  
and Environment

20090

## GOVERNMENT NOTICES

MELBOURNE AND METROPOLITAN  
BOARD OF WORKS

## Proclamation of Water Mains

Notice to the owners of tenements in the streets and the private streets, lanes, courts and alleys opening thereto. The main pipe in the said streets being laid down, the owners of all tenements situated as under are hereby required on or before 6 October 1990 to cause a proper pipe and cock stops to be laid so as to supply water within such tenements from the main pipe.

## Schedule of streets:

## KEILOR

Steel Court, from Beverage Drive southwards and southwestwards 238 metres.

Beverage Drive (east arm), from Tullamarine Park Road southeastwards, southwestwards and northwestwards 782 metres.

Dairy Close, from Stagecoach Crescent southwestwards 44 metres.

Blacksmith Place, the total street from Stagecoach Crescent northeastwards, northwestwards and southeastwards.

Stables Place, from Stagecoach Crescent southwestwards 43 metres.

Harness Court, the total street from Cobb Junction northwestwards, westwards, northeastwards, northwestwards and southeastwards.

Cobb Junction, the total street from Stagecoach Crescent northeastwards, southeastwards, northeastwards, northwestwards and southeastwards.

Stockyard Close, the total street from Stagecoach Crescent southeastwards, northeastwards and southeastwards.

Stagecoach Crescent from Overton Lea Boulevard southeastwards and southwestwards 270 metres.

Mitchell Court, from Australia Drive southwestwards 26 metres.

Lexon Way, from Australia Drive northwards 32 metres.

Booth Way, from Australia Drive northwestwards 13 metres.

Australia Drive, from 8 metres northwest of Remus Way further northwestwards, westwards and southwestwards 463 metres.

Oats Court, from Australia Drive southwestwards 25 metres.

## SUNSHINE

Wahgunyah Drive, from Currunghi Court northwestwards 29 metres.

Gunyah Mews, the total street from Currunghi Court northwestwards, southwestwards, northwards and southwards.

Currunghi Court, from 52 metres northeast of Penda Close further northeastwards 244 metres.

Carawah Retreat, the total street from Wahgunyah Drive southwestwards, westwards, northwards and southwards.

Paringa Drive, from Wahgunyah Drive northeastwards 33 metres.

Wahgunyah Drive, from 10 metres south of Kiparra Close further southwards and southeastwards 233 metres.

## WERRIBEE

Seabrook Boulevard, from 7 metres northeast of Gundowring Drive further northeastwards 59 metres.

Horne Street, from 39 metres southwest of Richards Road further southwestwards 204 metres.

Horne Street, from Dunlop Road northeastwards 238 metres.

Dunlop Road, from outfall sewer reserve southeastwards 177 metres.

Future Road, from Dunlop Road southwestwards 48 metres.

Labassa Way, from Gowrie Court northwestwards 41 metres.

Gowrie Court, the total street from Bowood Court southwestwards.

Burwood Court, the total street from Gowrie Court northeastwards (through to pipeline easement).

Cyanamid Street, from James Street northeastwards 340 metres.

Kelwin Court, the total street from Sunbird Crescent southwestwards.

Matlock Street, from 28 metres southwest of Sunbird Crescent, from Matlock Street northwestwards 116 metres.

Caper Court, the total street from Daphne Crescent southeastwards.

Willandra Court, the total street from Willowtree Drive northwestwards.

Willowtree Drive, from Wattle Avenue northeastwards and northwestwards 265 metres.

Wattle Avenue, from Edwards Road northwestwards 360 metres.

Wattle Avenue, from Edwards Road northeastwards and southeastwards 186 metres.

Evrah Drive, from Fulham Court northwestwards and northeastwards 111 metres.

Victoria Government Gazette

Lawson Court, from Evrah Drive westwards 163 metres.

Opala Court, the total street from Yaltara Drive eastwards.

Yaltara Drive, from 20 metres southward of Kiandra Way further southwestwards 53 metres.

Bootten Court, the total street from Matlock Street northwards.

Matlock Street, from 34 metres east of Sunbird Crescent further eastwards and northeastwards 261 metres.

Bluebell Court, the total street from Wildflower Crescent southwards.

Ash Court, the total street from Wildflower Crescent southwestwards.

Wildflower Crescent, from 39 metres northeast of Elm Close further southeastwards 134 metres.

Rory Court, the total street from Greaves Street westwards.

Greaves Street, from Bolton-Shaws Road southwards and southeastwards 248 metres.

Riverglen Drive from Greaves Street westwards 38 metres.

Weeden Drive, from Greaves Street eastwards 35 metres.

Seabrook Boulevard, from 8 metres southeast of Caramut Way further southeastwards 63 metres.

Beleura Way, from Seabrook Boulevard southeastwards 67 metres.

Seabrook Boulevard, from 57 metres southeast of Caramut Way further southeastwards and southwestwards 134 metres.

Selwood Place, from 18 metres southwest of Knightsbridge Avenue further southeastwards 95 metres.

Gladhan Close, the total street from Knightsbridge Avenue southwestwards and northwestwards.

Irvine Court, the total street from Knightsbridge Avenue northeastwards and eastwards.

Selwood Place, from Knightsbridge Avenue southwards 20 metres.

Knightsbridge Avenue (southern arm), from Merton Street northwestwards 282 metres.

Merton Street, (east side), from Victoria Street northeastwards 175 metres.

Merton Street, (west side), from 118 metres southwest of Knightsbridge Avenue further southwestwards 56 metres.

Cherry Lane, from 325 metres south and southwest of Dohertys Road further southwestwards 84 metres.

REGIONAL MANAGER  
Western Region

20490-W

G 35 5 September 1990 2683

## MELBOURNE AND METROPOLITAN BOARD OF WORKS

### General Notice

The Melbourne and Metropolitan Board of Works having made provision for carrying off the sewage of each and every property which or any part of which is situate in the Sewerage Areas hereinafter described doth hereby declare that on and after 5 September 1990 each and every property so situate shall be deemed to be sewered property within the meaning of the *Melbourne and Metropolitan Board of Works Act 1958*.

The Sewerage Areas hereinbefore referred to are:

#### Sewerage Area No. 6233

City of Croydon—This Area comprises all lots in Mallory Court, lots 1 to 7, a Drainage Reserve, lots 8 to 10 and lots 14 and 15 Kelvin Road and contains 15 lots.

#### Sewerage Area No. 6234

City of Croydon—This Area comprises all lots in Carol Hancock Place, lot 15 Yarra Road, a Reserve abutting Carol Hancock Place and Yarra Road and the Tree Reserve abutting Yarra Road and contains 15 lots.

#### Sewerage Area No. 6240

City of Croydon—This Area comprises lots 14 and 15 Lanier Crescent and contains 2 lots.

#### Sewerage Area No. 6230

City of Croydon—This Area comprises all lots in Como Close and contains 16 lots.

#### Sewerage Area No. 6231

City of Croydon—This Area comprises lots 1 to 4 Grevillia Drive and lots 5 to 2 Aumann Court and contains 20 lots.

#### Sewerage Area No. 6232

City of Croydon—This Area comprises lots 1 to 3 Holloway Road and contains 3 lots.

#### Sewerage Area No. 6191

City of Doncaster and Templestowe—This Area comprises lots 5 to 7 Mahoneys Court and lots 4 and 5 Kyrenia Court and contains 5 lots.

#### Sewerage Area No. 6195

City of Doncaster and Templestowe—This Area comprises lots 1, 2 and 6 Smiths Road and contains 3 lots.

#### Sewerage Area No. 6194

City of Knox—This Area comprises lots 1 to 6 Wellington Road, lot A bounded by Wellington Road and Corhanwarrabul Creek, lots 8, 9, 17 to 15, 11, 10 and 34 Corporate Avenue and contains 15 lots.

#### Sewerage Area No. 6238

City of Knox—This Area comprises all lots in Krystal Glenn Gardens, lot 15 Ethel Street and lots 19 and 16 Castlewood Drive and contains 17 lots.

2684 G 35 5 September 1990

**Sewerage Area No. 6239**

City of Knox—This Area comprises all lots in Palm Court and lots 1 to 3, 12 to 14 Palmerston Road and contains 14 lots.

**Sewerage Area No. 6196**

Shire of Lillydale—This Area comprises lots 1 to 3 Orchard Street and contains 3 lots.

**Sewerage Area No. 6199**

Shire of Lillydale—This Area comprises lots 2, 11 Banool Avenue, lots 30, 86, 87 Borang Avenue, lots 16 to 24, 5 to 3, 6 to 15 Reserves Road, lots 10, 1, 2, 26, 5 to 3 and 5 to 7 Watkins Crescent and 1 Monbulk Road and contains 37 lots.

**Sewerage Area No. 6229**

Shire of Lillydale—This Area comprises lot 4 Canterbury Road and contains 1 lot.

**Sewerage Area No. 6236**

Shire of Lillydale—This Area comprises all lots in Leeds Drive, Pam Court and Jane Court, and the Reserve abutting Leeds Drive, Pam Court and Jane Court and contains 32 lots.

**Sewerage Area No. 6209**

Shire of Lillydale—This Area comprises lots 125 to 127, 134 to 136, 143, 144, 152 to 160 Alpine Way, 128, 130 to 133 Hammersley Court, 137 to 142 MacDonnell Court and 145 to 151 Cambridge Road and contains 35 lots. (In lieu of the approval given by the Board on 6 August 1990.)

**Sewerage Area No. 6159**

Shire of Sherbrooke—This Area comprises lots 40 to 47 Mast Gully Road together with lots 38 to 39 Woodleigh Avenue, also lots 48 to 57, lot 28 together with lots 1 to 5 and lots 11 to 13 and lots 1 and 2 Florence Avenue, that piece of land described on Plan of Consolidation No. CP 103210, lots 18 to 26, lot 1 and that piece of land known as No. 2 Cecil Court. Lot 2, lots 6 to 9 and lots 3, 2 Simmons Street and contains 49 lots. (In lieu of the approval given by the Board on 21 June 1990.)

**Sewerage Area No. 6202**

Shire of Sherbrooke—This Area comprises lots 11 to 22, 59 to 60 Hughes Street, lots 36, 37, 13, 14, 38 to 49, 51 to 58 and 23 to 25 Earl Street, lots 18 to 20 Baldwin Avenue and lots 85 and 86 Monbulk Road and contains 58 lots.

**Sewerage Area No. 6208**

Shire of Sherbrooke—This Area comprises lots 1, 2 and 1 George Street and lots 44 to 48 and lots 47 to 50 Ropley Grange and contains 12 lots. (In lieu of the approval given by the Board on 6 July 1990.)

*Victoria Government Gazette*

**Sewerage Area No. 6243**

Shire of Sherbrooke—This Area comprises lots 90 to 96, lot 121 and lots 119 to 116 Ferndale Road and contains 12 lots.

Further particulars may be ascertained on inquiry at the Board's Eastern Regional Complex, Lucknow Street, Mitcham 3132.

By Order of the Board

D. G. ROBINSON

Regional Manager

Eastern Region

20490-E

**MELBOURNE AND METROPOLITAN  
BOARD OF WORKS**

**General Notice**

The Melbourne and Metropolitan Board of Works having made provision for carrying off the sewage of each and every property which or any part of which is situate in the Sewerage Areas hereinafter described doth hereby declare that on and after 5 October 1990, each and every property so situate shall be deemed to be sewered property within the meaning of the *Melbourne and Metropolitan Board of Works Act 1958*.

The Sewerage Areas hereinbefore referred to are:

**Sewerage Area No. 8749 (360/289/0279)**

City of Whittlesea—This Area comprises all lots Lionheart Court, Ayers Court, Globe Place, Mark Court and Teresa Court, lots 179 to 200, a Reserve, lots 201 to 215, 70, 71, 92 to 94, 115 to 117, 124 to 134 and 142 to 144 Supply Drive, lots 95 to 105, 80 to 82, 93 to 94 and 132 and 125 Grand Parade and contains 164 lots.

**Sewerage Area No. 8775 (360/289/0381)**

City of Whittlesea—This Area comprises lots 1 to 4 Duffy Street, lot 5 Memorial Drive and contains 5 lots.

**Sewerage Area No. 8776 (360/290/0007)**

City of Whittlesea—This Area comprises all lots Dicello Rise, Egerton Grove, Orlit Court and Ferraro Close, lots 443 to 445, 458 to 461, 475, 476, 484 to 486 and 487 to 494 Longwood Drive, lots 537 to 543, a Reserve abutting Longwood Drive, lots 374 to 379, lot A, lots 301 and 300 Findon Road and contains 89 lots.

**Sewerage Area No. 8780 (360/290/0025)**

City of Whittlesea—This Area comprises all lots Vines Court, Faldo Court, Turtur Close and Windeatt Close, lots 538 to 557, 501, 500, 498 to 493 and 476 to 465 Grenda Drive, lots 576 to 581, 592 to 594, 615 to 617 and 528 to 537 Crampton Crescent and lot 84 Childs Road and contains 109 lots.

**Sewerage Area No. 8784 (360/290/0024)**

City of Whittlesea—This Area comprises lots 1 to 6, a Reserve and lots 182 to 179 Northgate

*Victoria Government Gazette*

Drive, lots 14 to 17, 18, 19, and 13 to 7 Macquarie Road and contains 24 lots.

Sewerage Area No. 8788 (360/290/0033)

City of Whittlesea—This Area comprises all lots Hickey Court, Bremnar Court and Hopper Court, lots 1 to 6, 7, 16, 17, 154 and a Reserve Centenary Drive, lots 22 to 30, 31 to 36, 47 to 50, 51 to 64, 152 and 153 Bradley Drive, lots 65 to 68, 81 to 85, 97 to 105 and 127 to 151 Romeo Crescent and contains 121 lots.

Sewerage Area No. 8799 (360/290/0087)

City of Whittlesea—This Area comprises all lots Dobroyd Court and Claymore Court, lots 2601 to 2609, 2701, 2702, 2630 to 2627 and 2613 to 2610, 2731 and 2730 Benaroon Drive, lots 2703 to 2714, 3012, 2729 to 2726, 2725 to 2722, 2715 and 3013 Mossman Crescent, lots 2825 to 2819, 2826 to 2834 Padstun Avenue, lots 2721 to 2719, 2818 and 2716 to 2718 and 2835 to 2838 Herman Road and contains 109 lots.

Sewerage Area No. 8802 (360/290/0105)

City of Whittlesea—This Area comprises all lots Alba Court, Lutea Court, Villosa Court, Regezia Court, Incana Drive and Truncata Court, lots 89 to 91, a Reserve and lots 88 to 86 Diosma Way, lots 96 to 92, 85 to 80, 61, 60, 32 to 26, 37, 36, 35 to 33, 97 to 111 and 247 Telopea Crescent, lots 233 to 231, 59 to 57, 47, 46, 38 to 45 and a Reserve Mirbelia Crescent and a lot A Blossom Park Drive and contains 189 lots.

Sewerage Area No. 8809 (360/290/0153)

City of Whittlesea—This Area comprises all lots Helm Court, Devon Court, Link Court and Gipps Court, lots 15 to 18, 13 and 14 Cooper Street, lots 19, 26, 27, 33, 34, 41 to 47, a Reserve, lots 48 to 54 and 4 to 12 Yale Drive and contains 57 lots.

By Order of the Board

P. R. CALLOW  
Regional Manager  
Northern Region

20490—N

**ASSOCIATIONS INCORPORATION ACT  
1981, SUB-SECTION 36 (2)**

Notice is hereby given that the incorporation of the associations mentioned below will be cancelled on publication of this notice.

Ballarat Chess Club Inc.  
Bellarine Community Care Inc.  
Castlemaine Amateur Basketball Association Inc.  
Chewton Tennis Club Inc.  
Colbinabbin Tractor Pull Inc.  
Emu Creek Tennis Club Inc.  
Evangelical Alliance (Victoria) Inc.  
Heathcote Gun Club Inc.

G 35 5 September 1990 2685

Horsham Employment Resource Centre Inc.  
Indo-China Ethnic Chinese Association of Victoria Inc.

The Kerang District Cricket Association Inc.

Kurios Christos Inc.

Kyneton Car Club Inc.

The Latin-American Festival Inc.

Latrobe Valley Ethnic Advisory Council Inc.

Leichhardt Ski Club Inc.

Melbourne Crest Pigeon High Flyers Society Inc.

New United Villages of Florina Inc.

Oak Park Community Sports Association Inc.

Palesviaki Enosis Melbourne and Victoria Inc.

Raywood Tennis Club Inc.

Security Practical Pistol Club of Victoria Inc.

Shotokan Shuren-Kai Association Inc.

South Clayton Community Development Group Inc.

Springvale Employment Project Inc.

St. Albans Unemployment Youth Group Inc.

Swan Hill Cricket Club Inc.

U25 Theatre Inc.

Waterloo Cricket Club Inc.

West Footscray Recreational League Football Club Inc.

White Hills Swimming Club Inc.

Dated this 27 August 1990

RON TREVETHAN

20430 Registrar for Incorporated Associations

*Reference Areas Act 1978*

**DEPARTMENT OF CONSERVATION AND  
ENVIRONMENT**

**Directives for Management**

Carpentait Reference Area Plan No. R.A.5

Tomahawk Creek Reference Area Plan No. R.A.6

East Caledonia Reference Area Plan No. R.A.8

Wonnangatta River Reference Area Plan No. R.A.9

Blue Rag Reference Area Plan No. R.A.10

The boundaries of the above Reference Areas are shown in the plans quoted above and are held in the Department of Conservation and Environment, 240 Victoria Parade, East Melbourne.

Carpentait Reference Area, Tomahawk Creek Reference Area, East Caledonia Reference Area, Wonnangatta River Reference Area, and Blue Rag Reference Area were proclaimed by the Governor in Council on 28 August 1990 and

2686 G 35 5 September 1990

published in the *Government Gazette* on 5 September 1990.

The plans for protection, control and management of the Reference Areas have been approved by the Minister for Conservation and Environment and copies of the plans are lodged and are available for inspection at the Department for Conservation and Environment, 240 Victoria Parade, East Melbourne.

The Minister for Conservation and Environment has issued the following directives for management of the Reference Areas:

**Directives:**

1. The managing authorities are to comply with the prescriptions for protection, control and management of each Reference Area contained in the plan which has been approved by the Minister for Conservation and Environment.

2. Entry of persons into the Reference Areas is prohibited, except for authorised research workers, management personnel and others where they have approval of the Minister. All persons entering the Reference Areas will abide by the Minister's "Conditions of Entry" appended in the Plans/Statements.

3. Research work in the Reference Areas is to be carried out in accordance with the Minister's "Conditions of Entry" appended in the Plans/Statements.

4. Grazing, mining, mineral exploration, harvesting of forest produce, quarrying, bee-keeping, educational use, recreation activities, and all forms of harvesting (except water from the areas) are prohibited.

S. M. CRABB

Minister for Conservation  
and Environment

20090

**STATE TRUSTEES**

WARD, Michael Hugh. Would anyone claiming to be or knowing the whereabouts of Michael Hugh Ward who was born in Adelaide on 19 July 1937, a child of Frederick Ward and Angie Sara Ward nee Eldridge, please write to State Trustees of 168 Exhibition Street, Melbourne and quote "Eldridge—136202/5112-446".

20434

**NOTICE OF APPLICATION FOR  
RECOGNITION AS AN ASSOCIATION**

Notice is hereby given that the Victorian Colleges and Universities Staff Association has filed an application to be recognised as an association under the *Industrial Relations Act* 1979, with respect to the trades for which the Higher Education General Staff Conciliation and Arbitration Board has been appointed.

*Victoria Government Gazette*

Pursuant to regulation 33 (5) of the Industrial Relations Regulations any recognised association or person interested may on or before 4 October 1990 file in the Registry (Level 18, Nauru House, 80 Collins Street, Melbourne) an objection to the application.

The objection shall be in, or to the effect of, Form 9 prescribed by the Regulations.

J. TSOUTSOULIS

Acting Deputy Registrar  
Industrial Relations Commission  
of Victoria

21441

**NOTICE OF APPLICATION FOR  
RECOGNITION AS AN ASSOCIATION**

Notice is hereby given that the following associations have filed an application to be recognised as an association under the *Industrial Relations Act* 1979 with respect to the trades for which the following Conciliation and Arbitration Boards have been appointed.

Association	Board
The Federated Miscellaneous Workers Union of Australia	Post-Secondary Education (TAFE) Miscellaneous Workers
Australian Education Industrial Association	Higher Education General Staff

Pursuant to regulation 33 (5) of the Industrial Relations Regulations any recognised association or person interested may on or before 18 October 1990 file in the Registry (Level 18, Nauru House, 80 Collins Street, Melbourne) an objection to the application.

The objection shall be in, or to the effect of, Form 9 prescribed by the Regulations.

J. TSOUTSOULIS

Acting Deputy Registrar  
Industrial Relations Commission  
of Victoria

20430

**NOTICE OF APPLICATION FOR  
RECOGNITION AS AN ASSOCIATION**

Notice is hereby given that the Victorian Public Service Association has filed an application to be recognised as an association under the *Industrial Relations Act* 1979, with respect to the trades for which the higher Education General Staff Conciliation and Arbitration Board has been appointed.

Pursuant to regulation 33 (5) of the Industrial Relations Regulations any recognised association or person interested may on or before 4 October 1990 file in the Registry (Level 18, Nauru House,

*Victoria Government Gazette*

80 Collins Street, Melbourne) an objection to the application.

The objection shall be in, or to the effect of, Form 9 prescribed by the Regulations.

J. TSOUTSOULIS  
Acting Deputy Registrar  
Industrial Relations Commission  
of Victoria

21441

**NOTICE OF APPLICATION FOR  
RECOGNITION AS AN ASSOCIATION**

Notice is hereby given that The Victorian Employers Federation has filed an application to be recognised as an association under the *Industrial Relations Act 1979*, with respect to the trades for which the Draughting, Production Planning and Technical Workers Conciliation and Arbitration Board has been appointed.

Pursuant to regulation 33 (5) of the Industrial Relations Regulations any recognised association or person interested may on or before 4 October 1990 file in the Registry (Level 18, Nauru House, 80 Collins Street, Melbourne) an objection to the application.

The objection shall be in, or to the effect of, Form 9 prescribed by the Regulations.

J. TSOUTSOULIS  
Acting Deputy Registrar  
Industrial Relations Commission  
of Victoria

21441

**CONTRACTS ACCEPTED—Series 90/91  
VICTORIA POLICE**

*T.223—Uniform and Stores Division*

Provision of Auction Services for the Auction/Sale of unclaimed and confiscated property for the period 1 July 1990 to 30 June 1992 on a commission basis of 8-75% of gross sales—Fowles Auction Group.

P. J. HALE  
Supply Manager and Officer in Charge

20610

**EVIDENCE ACT 1958**

Under the power found in section 79 (2) of the *Evidence Act 1958*, I declare the following offices to be those to which section 79 applies:

Principal Registrar of the Magistrates' Court  
of Victoria  
Registrar of the Magistrates' Court  
Deputy Registrar of the Magistrates' Court  
Bail Justice  
Magistrate.

DAVID WOODWARD  
Acting Secretary to the  
Attorney-General's Department

20430

G 35 5 September 1990 2687

*Co-operation Act 1981*

**NOTICE OF DISSOLUTION OF SOCIETIES**

West Sunshine Ethnic Community Child Care  
Co-operative Limited

Rhodes Street Child Care Co-operative Limited

Frankston Yacht Club Co-operative Limited

Tallintyre Road Child Care Co-operative  
Limited

Notice is hereby given that I have this day registered the dissolution of the abovenamed societies and cancelled their registration under the abovenamed Act.

Dated at Melbourne 29 August 1990

D. F. HENRY  
Deputy Registrar of  
Co-operative Societies

20430

*Evidence Act 1958*

**FAMILY MEDIATORS**

I, Elizabeth Proust, Secretary to the Attorney-General's Department, under the power found in section 211 of the *Evidence Act 1958*, declare the following people to be Family Mediators:

Trish ADAMS	Jean LYON
Harry BEECHEY	Freya MCCANN
Kevin BREMNER	Richard MOLONY
Ralph CHURCH	Anna SAGI
Patricia CLUNE	Maree SANTAMARIA
Paul CROWLEY	Ena SHAW
Geoff FAVALORO	Haidir THAMRIN
Francesca FORMOSO	Pat URBAN
Kim FRASER	Sue WALDEN
Marie GARRIC	Richard WHYTE
Judy KEEFE	

Dated 8 August 1990

ELIZABETH PROUST

Secretary to the  
Attorney-General's Department

20430

*Hospitals Superannuation Act 1988*

**ELECTION OF MEMBERS OF THE  
HOSPITALS SUPERANNUATION BOARD**

I am advised by the Hospitals Superannuation Board that the nomination of Patricia Starbuck, previously deemed by the Hospitals Superannuation Board to be eligible as a candidate for election as a member of the Hospitals Superannuation Board, in accordance with Regulation 4 (a) of the Hospitals Superannuation Board Election Regulations 1988, is in fact ineligible.

My notice published in the *Victoria Government Gazette* on 29 August 1990 listing the candidates at this election is therefore incorrect. The revised list of candidates is as follows:



2688 G 35 5 September 1990

One member of the Hospitals Superannuation Board in accordance with Regulation 4 (a) of the Hospitals Superannuation Board Election Regulations 1988.

GERALD WINTER BIRRELL

IVAN HORACEK

EEON DOUGLAS MACAULAY

Two members of the Hospitals Superannuation Board in accordance with Regulation 4 (b) of the Hospitals Superannuation Board Election Regulations 1988:

GERARD ANDREW BRANAGAN

BETTY GRACE COOK

IVAN HORACEK

EEON DOUGLAS MACAULAY

As a number of candidates nominated for each election is greater than the number of vacancies to be filled, a ballot will be taken to decide each election. Ballot papers will be forwarded to all members entitled to vote and these must be returned to reach the Returning Officer not later than 4.00 p.m. on Wednesday, 14 November 1990.

R. J. MILLAR

Returning Officer

20673

*Transport Act 1983*

**ROADS CORPORATION**

**Commercial Passenger Vehicle Applications**

Notice is hereby given that the following applications will be considered by the Roads Corporation on 9 October 1990.

Notice of any objection to the granting of an application should be forwarded to reach the Manager, Vehicle Licensing Branch or any District Office of the Roads Corporation not later than 3 October 1990.

It will not be necessary for interested parties to appear on the date specified, unless advised in writing by the Corporation.

Notification of the date for consideration of applications which are objected to and which require determination by the Road Transport Licensing Tribunal will be published by further notice in this Gazette.

R. R. Butler, Geelong West. Application to license one commercial passenger vehicle in respect of a 1989 Ford Falcon sedan with seating capacity for 4 passengers to operate as a special purpose vehicle from 176 Minerva Road, Geelong West for the carriage of passengers for wedding parties.

T. Franes, Glen Waverley. Application for variation of conditions of licence MH 4278 which authorises the licensed vehicle to operate as a metropolitan hire car in respect of a 1989 Ford

*Victoria Government Gazette*

LTD sedan to change the vehicle to a 1989 Ford LTD stretched limousine with seating capacity for 7 passengers.

K. C. and N. H. Morris, Sorrento. Application for variation of the conditions of licence TS 1529 which authorises a Public Transport Corporation School contract service to include the ability to operate under conditions from within a 20 km pick-up radius of the Rosebud Post Office.

*Note:* The vehicle licensed by TS 1529 holds a 2 star rating for charter purposes.

J. Slater, Orbost. Application to license one commercial passenger vehicle in respect of a 1986 Mitsubishi sedan with seating capacity for 4 passengers to operate as a country hire car from 38 Bowers Street, Orbost.

Dated 5 September 1990

GEOFF S. HUGHES

Manager

Vehicle Licensing

20690

*Transport Act 1983*

**ROADS CORPORATION**

**Commercial Passenger Vehicle Application**

**Amendment to Previous Notice**

This notice corrects a previous notice which appeared in the *Victoria Government Gazette* No. G34 dated 29 August 1990 in the name of Z. Waks. The closing date for objections and the consideration date specified in that notice shall remain the same.

770 Computing (Aust.) Pty. Ltd., East St Kilda. Application to license one commercial passenger vehicle to be purchased in respect of a 1973 or later model Toyota or Mazda bus with seating capacity for 17-24 passengers to operate—

- (i) a service for the carriage of children attending Yeshiva College, East St Kilda to the exclusion of all other passengers excepting duly authorised teachers.

*Timetable:* As and when required.

*Fares:* Will be paid by parents of the children using the service.

*Note:* Children will be picked up from within a 12 km radius of Yeshiva college, and

- (ii) under charter conditions from within a 55 km pick-up radius of the Melbourne G.P.O.

*Note:* The vehicle to be licensed would hold a 2 star rating for charter purposes.

Dated 5 September 1990

GEOFF S. HUGHES

Manager

Vehicle Licensing

20690

## Fisheries Act 1968

## FISHERIES NOTICE No. 3/1990

I, Steven Crabb, Minister for Conservation and Environment, after consultation with the Victorian Fishing Industry Federation, make the following Fisheries Notice:

## FISHERIES (SCALLOP FISHING) NOTICE 1990

## TITLE

1. This Notice may be cited as the Fisheries (Scallop Fishing) Notice 1990.

## OBJECTIVES

2. The objectives of this Notice are to—

- (a) open Victorian waters, other than Port Phillip Bay, to scallop dredging; and
- (b) control the level of exploitation of scallop stocks by fixing a weekly catch limit for the taking of scallops.

## AUTHORISING PROVISION

3. This Notice is made under section 80 of the *Fisheries Act 1968*.

## REVOCATIONS

4. (1) Fisheries Notice No. 2/1990 is revoked.  
(2) Regulations 4A, 6 (2) (d) and (e) and 7 (b) of the Fishing (Scallop) Regulations 1985 are revoked.

## DEFINITIONS

5. "Act" means the *Fisheries Act 1968*.

"Authorised Officer" means an authorised officer appointed under Part 9 of the *Conservation, Forests and Lands Act 1987*.

"Crate" means a wire mesh container with external dimensions not exceeding 100 centimetres by 50 centimetres by 50 centimetres and constructed as specified in the diagrams in Form 1 in the Schedule to this Notice.

"Crate Tag" means a tag as specified in the diagram in Form 2 in the Schedule to this Notice.

## OPEN SEASON

6. Subject to section 15 (1) (h) of the Act the holder of a scallop licence may dredge for or take scallops for sale from Victorian waters, other than Port Phillip Bay, during the period commencing 9 September 1990 and ending on 9 December 1990.

## CATCH LIMITS

7. A master fisherman operating a registered fishing boat for which a scallop licence has been issued must not take from that boat from Victorian waters more than ten crates of scallops during a seven-day period commencing on each Sunday of the open season.

## TAGGING OF CRATES

8. Every holder of a scallop licence permitting the dredging or taking of scallops in any Victorian waters other than Port Phillip Bay may on production of his or her scallop licence make application to an authorised officer for an allocation of the number and colour of crate tags prescribed in the Table to this clause for the period prescribed in the Table to this clause.

TABLE

<i>Period</i>	<i>Number of Tags</i>	<i>Colour of Tags</i>
9.9.90 to 15.9.90	10	Green
16.9.90 to 22.9.90	10	Yellow
23.9.90 to 29.9.90	10	Blue
30.9.90 to 6.10.90	10	Red
7.10.90 to 13.10.90	10	Black
14.10.90 to 20.10.90	10	Royal Blue
21.10.90 to 27.10.90	10	Orange
28.10.90 to 3.11.90	10	White

9. (1) Crate tags are only valid for the period set out against the crate tag colour in the Table to Clause 8 of this Notice.

(2) Crate tags will be serially numbered and may only be used to secure crates on the licensed scallop boat for which the crate tags were allocated by the authorised officer.

## 10. A person in charge of a boat shall ensure that—

- (a) in respect of scallops taken from Victorian waters other than Port Phillip Bay that those scallops are not contained on board or landed in any container other than a crate;
- (b) while a registered fishing boat for which a scallop licence has been issued is on any Victorian waters, other than Port Phillip Bay, not more than one full or partly filled crate of scallops on board the boat may be unsecured with a crate tag in such a manner that the lid of the crate can be opened without cutting or breaking the crate tag;
- (c) when a crate containing scallops is landed that each crate lid is closed and secured with a crate tag so that the crate lid cannot be opened without cutting or breaking the crate tag;
- (d) when a crate containing scallops is landed the crate lid is so closed and secured with a crate tag until the scallops are to be removed from the crate at a fish processing premises specified in a processor's licence;
- (e) crate tags are not transferred to any other person; and
- (f) crate tags are not re-used.

## PENALTY

11. Any person who contravenes this Notice is liable to a penalty of 20 penalty units.

## SCHEDULE

## Form 1

## Construction of Crate

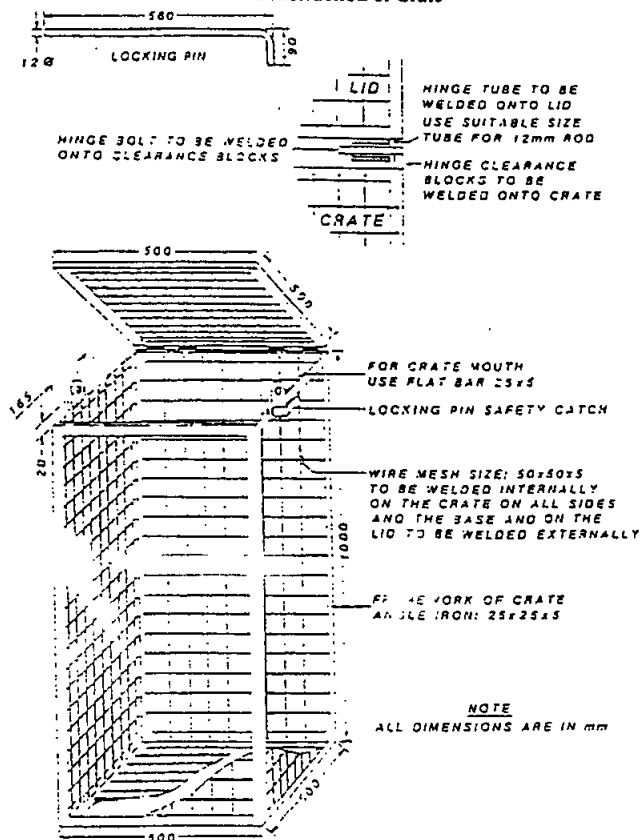

**FISHERIES (SCALLOP FISHING) NOTICE 1990**

**FORM 2**

**CONSTRUCTION OF CRATE TAG**

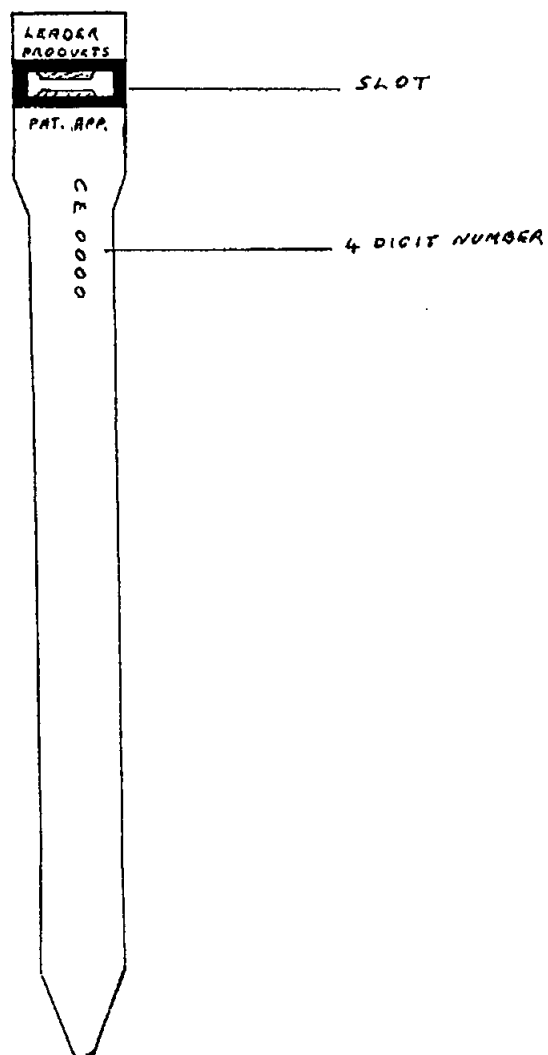

2692 G 35 5 September 1990

*Planning and Environment Act 1987*  
**WHITTLESEA PLANNING SCHEME**  
Notice of Approval of Amendment  
Amendment L21

The Minister for Planning and Urban Growth has approved Amendment L21 to the Local Section of the Whittlesea Planning Scheme.

The amendment comes into operation on the date this notice is published in the *Government Gazette*.

The amendment rezones land on the north side of Craigieburn Road East, Craigieburn, adjacent to the Melbourne-Sydney railway line from Railway Reservation to Reserved Light Industrial zone.

A copy of the amendment can be inspected free of charge during office hours at the Department of Planning and Urban Growth, Ground Floor, 477 Collins Street, Melbourne, and at the offices of the City of Whittlesea, High Street, Epping.

GEOFF CODE  
Manager

20600 Planning Co-ordination Branch

*Planning and Environment Act 1987*  
**ESSENDON PLANNING SCHEME**  
Notice of Approval of Amendment  
Amendment L10

The Minister for Planning and Urban Growth has approved the above amendment.

The amendment comes into operation on the date this notice is published in the *Government Gazette*.

The amendment removes the road reservation applying to land at 141 Puckle Street, Lot 1, PS 2872, Vol. 3540, Folio 820, Moonee Ponds and includes the land in Moonee Ponds District Centre No. 1 zone—Core Retail.

A copy of the amendment can be inspected free of charge during office hours at the office of the City of Essendon, Civic Centre, corner Pascoe Vale Road and Kellaway Avenue, Moonee Ponds and the Department of Planning and Urban Growth, 477 Collins Street, Melbourne.

GEOFF CODE  
Manager

20600 Planning Co-ordination Branch

*Planning and Environment Act 1987*  
**FITZROY PLANNING SCHEME**  
Notice of Approval of Amendment  
Amendment L3

The Minister for Planning and Urban Growth has approved Amendment L3 to the Local Section of the Fitzroy Planning Scheme.

*Victoria Government Gazette*

The amendment comes into operation on the date this notice is published in the *Government Gazette*.

The amendment re-aligns the zone boundary affecting the rear of land at 209 Brunswick Street, Fitzroy, so that it accords with the lot boundary.

A copy of the amendment can be inspected free of charge during office hours at the Department of Planning and Urban Growth, Ground Floor, 477 Collins Street, Melbourne, and at the offices of the City of Fitzroy, 201 Napier Street, Fitzroy.

GEOFF CODE  
Manager

20600 Planning Co-ordination Branch

*Planning and Environment Act 1987*  
**HEIDELBERG PLANNING SCHEME**  
Notice of Approval of Amendment  
Amendment L11

The Minister for Planning and Urban Growth has approved Amendment L11 to the Heidelberg Planning Scheme.

The amendment comes into operation on the date this notice is published in the *Government Gazette*.

The amendment rezones land at 92 Burgundy Street, Heidelberg, situated on the north-east corner of Cape and Burgundy Streets and occupied by the Sir Henry Barkly Hotel, from Light Industrial zone to Heidelberg Secondary Commercial zone.

A copy of the amendment can be inspected free of charge during office hours at the offices of the City of Heidelberg, Upper Heidelberg Road, Ivanhoe and at the Department of Planning and Urban Growth, 477 Collins Street, Melbourne.

GEOFF CODE  
Manager

20600 Planning Co-ordination Branch

*Planning and Environment Act 1987*  
**HEIDELBERG PLANNING SCHEME**  
Notice of Approval of Amendment  
Amendment L13

The Minister for Planning and Urban Growth has approved Amendment L13 to the Heidelberg Planning Scheme.

The amendment comes into operation on the date this notice is published in the *Government Gazette*.

The amendment deletes a Proposed Secondary Road Reservation and Road Widening Reserve located generally along Norman Street and Sherwood Road, Ivanhoe and rezones the affected land to Restricted Business zone and Residential C zone.

*Victoria Government Gazette*

A copy of the amendment can be inspected free of charge during office hours at the offices of the City of Heidelberg, Civic Centre, Upper Heidelberg Road, Ivanhoe and at the Department of Planning and Urban Growth, 477 Collins Street, Melbourne.

GEOFF CODE  
Manager

---

20600      Planning Co-ordination Branch

*Planning and Environment Act 1987*  
**BALLARAT (SHIRE) PLANNING SCHEME**  
Local Section—Chapter 1  
Notice of Approval of Amendment  
Amendment L8

The Minister for the Department of Planning and Urban Growth has approved Amendment L8 to the Ballarat (Shire) Planning Scheme, Local Section—Chapter 1.

The amendment comes into operation on the date this notice is published in the *Government Gazette*.

The amendment is site specific (being part Crown Portion 122, Parish of Burrumbeet) and permits the re-use of an existing building as a shop.

A copy of the amendment can be inspected free of charge during office hours at the offices of the Shire of Ballarat, Gillies Street, Wendouree; at the Department of Planning and Urban Growth, 477 Collins Street, Melbourne, and at the Department of Planning and Urban Growth, Regional Office, State Government Offices, Ballarat.

GEOFF CODE  
Manager

---

20600      Planning Co-ordination Branch

*Planning and Environment Act 1987*  
**SWAN HILL (SHIRE) PLANNING SCHEME**  
Notice of Approval of Amendment  
Amendment L7

The Minister for Planning and Urban Growth has approved Amendment L7 to the Local Section of the Swan Hill (Shire) Planning Scheme.

The amendment comes into operation on the date this notice is published in the *Government Gazette*.

The amendment rezones land on the west side of Dead Horse Lane, between Blackwire Road and the Swan Hill-Sea Lake Road, from part Rural C and Public Purposes (Swan Hill Water Board) to part Public Purposes (City of Swan Hill) and Public Purposes (S.E.C.).

A copy of the amendment can be inspected free of charge during office hours at the

*G 35 5 September 1990 2693*

Department of Planning and Urban Growth, Ground Floor, 477 Collins Street, Melbourne, and at the offices of the Shire of Swan Hill, 45 Splatt Street, Swan Hill.

GEOFF CODE  
Manager

---

20600      Planning Co-ordination Branch

*Planning and Environment Act 1987*  
**ECHUCA PLANNING SCHEME**  
Notice of Approval of Amendment  
Amendment L5

The Minister for Planning and Urban Growth has approved Amendment L5 to the Echuca Planning Scheme.

The amendment comes into operation on the date this notice is published in the *Government Gazette*.

The amendment rezones 11 hectares of land being part of CAs 19 and 20, Parish of Echuca North fronting Snowden Street and Murray Valley Highway from Rural A to Reserved Residential to facilitate residential development.

A copy of the amendment can be inspected free of charge during office hours at the City of Echuca, Heygarth Street, Echuca and the Department of Planning and Urban Growth, The Oldfleet Buildings, 477 Collins Street, Melbourne.

GEOFF CODE  
Manager

---

20600      Planning Co-ordination Branch

*Planning and Environment Act 1987*  
**COBURG PLANNING SCHEME**  
Notice of Approval of Amendment  
Amendment L9

The Minister for Planning and Urban Growth has approved Amendment L9 to the Local Section of the Coburg Planning Scheme.

The amendment comes into operation on the date this notice is published in the *Government Gazette*.

The amendment introduces a new Neighbourhood Business zone and rezones land at 148-158 Bell Street, Coburg, from Residential C to the new zone.

A copy of the amendment can be inspected free of charge during office hours at the Department of Planning and Urban Growth, Ground Floor, 477 Collins Street, Melbourne, and at the offices of the City of Coburg, Bell Street, Coburg.

GEOFF CODE  
Manager

---

20600      Planning Co-ordination Branch

2694 G 35 5 September 1990

*Planning and Environment Act 1987*  
**LILLYDALE PLANNING SCHEME**  
Notice of Approval of Amendment  
Amendment L62

The Minister for Planning and Urban Growth has approved Amendment L62 to the Lillydale Planning Scheme.

The amendment comes into operation on the date this notice is published in the *Government Gazette*.

The amendment rezones an area of land adjacent to the "Gumnut Village" and Australfra Nursery to Restricted Use 17 to enable the land to be used for on-site car parking.

A copy of the amendment can be inspected free of charge during office hours at the offices of the Shire of Lillydale, Anderson Street, Lilydale and at the Department of Planning and Urban Growth, 477 Collins Street, Melbourne.

GEOFF CODE

20600      Manager  
Planning Co-ordination Branch

*Planning and Environment Act 1987*  
**BACCHUS MARSH PLANNING SCHEME**  
Notice of Approval of Amendment  
Amendment L17

The Minister for Planning and Urban Growth has approved the above amendment.

The amendment comes into operation on the date this notice is published in the *Government Gazette*.

The amendment rezones Lot 8 LP218007M near the north-west corner of Gisborne Road and Russells Road from Rural A to Rural (Reserved Extractive Industry).

A copy of the amendment can be inspected free of charge during office hours at the offices of the Shire of Bacchus Marsh, Council Chambers, 197 Main Street, Bacchus Marsh and the Department of Planning and Urban Growth, 477 Collins Street, Melbourne.

GEOFF CODE

20600      Manager  
Planning Co-ordination Branch

*Planning and Environment Act 1987*  
**CRANBOURNE PLANNING SCHEME**  
Notice of Approval of Amendment  
Amendment No. L31

The Minister for Planning and Urban Growth has approved Amendment No. L31 to the Cranbourne Planning Scheme.

The amendment comes into operation on the date this notice is published in the *Government Gazette*.

*Victoria Government Gazette*

The amendment rezones land at the continuation of Tankerton, Station and Cambridge Streets, Lang Lang from Local Service Industry zone to part Township Residential zone and part General Farming B zone.

A copy of the amendment can be inspected free of charge during office hours at the offices of the Shire of Cranbourne, Sladen Street, Cranbourne; at the Department of Planning and Urban Growth, 477 Collins Street, Melbourne, and at the Department's Regional Office, 33-39 High Street, Cranbourne.

GEOFF CODE

20600      Manager  
Planning Co-ordination Branch

*Planning and Environment Act 1987*  
**LILLYDALE PLANNING SCHEME**  
Notice of Approval of Amendment  
Amendment L29

The Minister for Planning and Urban Growth has approved Amendment L29 to the Lillydale Planning Scheme.

The amendment comes into operation on the date this notice is published in the *Government Gazette*.

The amendment rezones land owned by Council in Mooroolbark Road, Mooroolbark from Residential Development to Residential Medium to allow it to be developed for multi-unit housing.

A copy of the amendment can be inspected free of charge during office hours at the offices of the Shire of Lillydale and at the Department of Planning and Urban Growth, 477 Collins Street, Melbourne.

GEOFF CODE

20600      Manager  
Planning Co-ordination Branch

*Planning and Environment Act 1987*  
**GEELONG REGIONAL PLANNING SCHEME**

Notice of Approval of Amendment  
Amendment R48

The Minister for Planning and Urban Growth has approved Amendment R48 to the Geelong Regional Planning Scheme.

The amendment comes into operation on the date this notice is published in the *Government Gazette*.

The amendment varies the Regional Section of the Scheme to ensure it is consistent with the State Section as it relates to Shore Housing.

A copy of the amendment can be inspected free of charge during office hours at Bellarine Rural City Council; Shire of Bannockburn; Shire

**GEOFF CODE**  
**Manager**

### Amendment L40

A copy of the amendment can be inspected free of charge during office hours at the offices of the Shire of Hastings, Marine Parade, Hastings and at the Department of Planning and Urban Growth, 477 Collins Street, Melbourne.

**GEOFF CODE**  
Manager

## Amendments

**\$**

†Delete: 'in 3 × A10 tins (per ctn)'

**S**

2/01

†Delete: 'Apply Tender Board'

**\*Delete: 'Apply Tender Board'**

‡Delete: 'Apply Tender Board'  
Add: 'Kevin Rose Wholesalers—"Ardmona"  
brand'

175	18.00#
190	16.20>
191	16.20>
192	13.25>
193	13.50~
194	13.50~

#Delete: 'Apply Tender Board'

~Delete 'Apply Tender Board'

195                      76.63 <

196	76.63 <
197	94.85 <
198	76.63 <
199	76.63 <
200	76.63 <
201	76.63 <
202	76.63 <
203	,
204	76.63 <
205	76.63 <
206	76.63 <
207	76.63 <
208	76.63 <

< Delete: 'Apply Tender Board'

Add: 'COMAY Pty Ltd T/as Ballantyne Five Star Food Services—"Continental" brand'



2696 G 35 5 September 1990

'Delete: 'Apply Tender Board'

Add: 'No Contract—Purchase (Regulation 84)'  
20790

Department of Industry and Economic  
Planning

APPLICATION FOR MINING LEASE  
GRANTED

No. 1868; Bendigo Gold Associates P/L; 1649  
ha, Parishes of Axedale and Ellesmere.

APPLICATION FOR MINING LEASE  
REFUSED

No. 1994; Ausminde P/L; 166 ha, Parish of  
Queenstown.

APPLICATION FOR DEVELOPMENT  
LEASE REFUSED

No. 728; Ausminde P/L; 45 ha, Parish of  
Healesville.

APPLICATION FOR DEVELOPMENT  
LEASE WITHDRAWN

No. 1147; Noble Resources NL; 101.8 ha, Parish  
of Barp.

No. 1166; Macquarie Resources Ltd; 9645 ha,  
Omeo.

INTENTION TO GRANT A PROSPECTING  
AREA LICENCE

No. 807; Compass Resources NL; 140 ha, Parish  
of St Arnaud.

No. 813; Kinex Mining P/L; 140 ha, Parish of  
Moolerr.

No. 815; T. Burrowes and B. Phillips; 90 ha,  
Parish of Stanley.

APPLICATION FOR PROSPECTING AREA  
LICENCE GRANTED

No. 683; Bet Bet Mining Co; 58 ha, Parishes of  
Dunolly and Bet Bet.

APPLICATION FOR PROSPECTING AREA  
LICENCE DECLARED ABANDONED

Nos. 698, 699, 700 and 701; Bendigo Mining  
NL; 250, 250, 220, 200 ha, Parishes of  
Wellsford and Axedale.

APPLICATION FOR PROSPECTING AREA  
LICENCE WITHDRAWN

No. 149; Golden Shamrock Mines Ltd; 210 ha,  
Axedale.

INTENTION TO RENEW A PROSPECTING  
AREA LICENCE

No. 209-1; Kinex P/L; 256 ha, Parish of Craigie.

No. 243-1 and 244-1; New Holland Mining NL  
and Sons of Gwalia NL; 22 and 22 ha, Parish  
of Heathcote.

APPLICATION FOR RENEWAL OF  
PROSPECTING AREA LICENCE REFUSED

No. 33-3; Takoradi Gold NL; 96 ha, Parish of  
Gobur.

*Victoria Government Gazette*

APPLICATION FOR RENEWAL OF  
PROSPECTING AREA LICENCE  
WITHDRAWN

113-1; A. R. Fraser; 34.5 ha, parish of Moora.

PROSPECTING AREA LICENCE EXPIRED

No. 649; M. Clancy; 39.5 ha, Parish of  
Wedderburn.

APPLICATION FOR MINING AREA  
LICENCE GRANTED

No. 60; Gaffney's Creek Gold Mine NL; 66.43  
ha, Parish of Lauraville.

APPLICATION FOR TAILINGS REMOVAL  
LICENCE GRANTED

No. 5381; Bendigo Gold Associates P/L,  
Parishes of Sandhurst and Nerring.

No. 5382; A. and J. Rozinszky, Parish of  
Redcastle.

No. 5475; Newmont Australia Ltd., Parish of  
Fryers.

APPLICATION FOR TAILINGS REMOVAL  
LICENCE TRANSFERRED

No. 5381; From Eaglehawk Gold P/L to Bendigo  
Gold Associates P/L.

APPLICATION FOR TAILINGS REMOVAL  
LICENCE REFUSED

No. 5375; T. Guy, Parish of Haddon.

APPLICATION FOR TAILINGS  
TREATMENT LICENCE REFUSED

Nos. 229 and 251; Balgold Nominees P/L and  
Coemo Kirsten P/L; Nerring and  
Sandhurst.

TAILINGS TREATMENT LICENCE  
TRANSFERRED

No. 300; From P. and G. Clarke, A. Campbell  
and Automake P/L to Bendigo Gold  
Associates P/L, Parish of Sandhurst.

INTENTION TO GRANT AN  
EXPLORATION LICENCE

No. 1929-1; T. and J. Dawes, Honeydew P/L  
and Tallangalook P/L; 133.5 km<sup>2</sup>,  
Castlemaine.

INTENTION FOR EXPLORATION  
LICENCE GRANTED

Nos. 2531, 2532 and 2533; Fidunu P/L, 491.5,  
498 and 500 km<sup>2</sup>, Dimboola.

Nos. 2593, 2594, 2595, 2597, 2598 and 2599;  
Renison Ltd; 398, 405, 495, 309, 397 and  
427.5, Charlton, Kowree and Korong.

APPLICATION FOR EXTENSION OF  
EXPLORATION LICENCE REFUSED

No. 1534-3, 1603-2 and 1603-3; Ausminde  
P/L; 11 and 46.5 km<sup>2</sup>, Yea and Reedy Creek.

APPLICATION FOR EXPLORATION  
LICENCE WITHDRAWN

No. 1839; Sheraton Pines P/L, Colbinabbin.  
Nos. 2395, 2398 and 2399; New Holland Mining  
NL, 500, 75.5 and 54 km<sup>2</sup>, Woodend,  
Waranga and McIvor.

INTENTION TO EXTEND EXPLORATION  
LICENCE

Nos. 757, 799-9, 798, 800, 809-9, 1261, 1264,  
1266, 1424, 774, 787, 789, 790, 791, 793,  
999, 1255, 1256, 1257, 1258, 1260, 1298,  
1315, 1344, 1362, 1364, 1917; Wimmera  
Industrial Minerals P/L, 4728.25 km<sup>2</sup>,  
Kerang and Horsham.

No. 1810-1; Mumbil Mines NL; 90 km<sup>2</sup>,  
Alexandra.

No. 1886-2; BHP Minerals; 127 km<sup>2</sup>, Horsham  
and Ouyen.

No. 1971-2; Adroit Exploration NL; 26 km<sup>2</sup>,  
Bogong.

Nos. 2316-1; 2317-1, 2318-1, 2320-1, 2321-1,  
2322-1, 2323-1 and 2326-1; Renison Ltd;  
294, 291, 486.5, 455.5, 180, 481.75, 141.5,  
280.25 km<sup>2</sup>, Swan Hill.

EXPLORATION LICENCE EXTENDED

No. 1630-2; Compass Resources NL; 18.25 km<sup>2</sup>,  
Kara Kara and St Arnaud.

Nos. 2304-1, 2305-1, 2306-1 and 2307-1;  
Euraust Mineral Exploration Ltd; 490, 444,  
127 and 93 km<sup>2</sup>, Lowan, Dimboola,  
Arapiles and Kowree.

APPLICATION FOR EXTENSION OF  
EXPLORATION LICENCE WITHDRAWN

No. 2042-1; Dalrymple Resources NL; 25.5 km<sup>2</sup>,  
Bright.

No. 2079-1; P. & G. Forwood; 20.25 km<sup>2</sup>,  
Ararat.

EXPLORATION LICENCE EXPIRED

No. 2006; Norgold Ltd.; 50 km<sup>2</sup>, Omeo.

The above expired area will become available  
again for Exploration Licence on 22 February  
1991.

No. 2042; Dalrymple Resources NL; 63.75 km<sup>2</sup>,  
Bright.

The above expired area will become available  
again for Exploration Licence on 20 November  
1990.

No. 2063; Village Mines NL; 9.5 km<sup>2</sup>, Orbost.

The above expired area will become available  
again for Exploration Licence on 12 February  
1991.

No. 2079; P. and G. Forwood; 27.25 km<sup>2</sup>, Ararat.  
The above expired area will become available  
again for Exploration Licence on 5 February  
1991.

No. 2280; BHP Gold Mines Ltd.; 3.5 km<sup>2</sup>, Bet  
Bet.

The above expired area will become available  
again for Exploration Licence on 23 January  
1991.

No. 2319; Renison Ltd.; 70 km<sup>2</sup>, Swan Hill.

The above expired area will become available  
again for Exploration Licence on 12 February  
1991.

APPLICATION FOR EXTRACTIVE  
INDUSTRIES LICENCE GRANTED

No. 1405; Lake Cooper Quarries P/L; 26.27 ha;  
Burramboot.

EXTRACTIVE INDUSTRY LICENCE  
VARIATION TO CONDITIONS

No. 111-1; Boral Resources (Vic.) P/L; 89.5,  
Parish of Pine Lodge.

No. 1126-1; Boral Resources (Vic.) P/L; 2.7946  
ha, Parish of Pine Lodge.

APPLICATION FOR EXTRACTIVE  
INDUSTRY LEASE GRANTED

No. 341; McCorkells Sand Supplies P/L; 27.26  
ha, Gherang Gherang.

D. R. WHITE

Minister for Industry and Economic Planning

ADDENDA

The notice which appeared in the *Government Gazette* dated 22 August 1990, relating to Extractive Industry Leases Nos. 380 and 382 under the heading Extractive Industry Lease Assigned, should have appeared under the heading Application for Extractive Industry Lease Assigned.

Creditors, next of kin and others having claims against the estate of any of the under-mentioned deceased persons are required to send particulars of their claims to the State Trust Corporation of Victoria, 168 Exhibition Street, Melbourne, Vic. 3000, the personal representative, on or before 6 November 1990, after which date the State Trust Corporation may convey or distribute the assets having regard only to the claims of which the State Trust Corporation then has notice.

Bradbury, Edna May, formerly of 58 Albert Street, Windsor, late of 241 Highbury Road, Burwood, married woman, died 4 June 1990.

Crompton, Walter, formerly of 284 Plenty Road, Preston, late of Unit 12/30 Strathallan Road, Macleod, retired, died 11 June 1990.

Henwood, Olive May, late of 37 Keith Street, Alphington, pensioner, died 6 June 1990.

McIlroy, Malcolm Charles, late of Flat 8/28 Broadway, Chelsea, Telecom employee, died 29 March 1990.

2698 G 35 5 September 1990

Roberts, Peter John Pierce, also known as Peter John Roberts, late of 1 Kirep Road, Balwyn, retired public servant, died 22 July 1990.

Sniadala, Zenon, late of 38 Belgrave-Gembrook Road, Belgrave, fitter, died 26 March 1990.

Dated at Melbourne, 28 August 1990

B. F. CARMODY  
Managing Director  
State Trust Corporation

20434

*Victoria Government Gazette*

Watt, Myrtle Irene, late of "Mimosa", 126 Cuthberts Road, Ballarat, pensioner, died 17 June 1990.

Dated at Melbourne 30 August 1990.

B. F. CARMODY  
Managing Director  
State Trust Corporation

20434

Creditors, next of kin and others having claims against the estate of any of the under-mentioned deceased persons are required to send particulars of their claims to the State Trust Corporation of Victoria, 168 Exhibition Street, Melbourne, Vic. 3000, the personal representative, on or before 8 November 1990, after which date the State Trust Corporation may convey or distribute the assets having regard only to the claims of which the State Trust Corporation then has notice:

Bird, Desmond Carruthers, late of 43 Parkers Road, Parkdale, retired public servant, died 14 May 1990.

Doran, Eileen Mary, formerly of 2 Belmont Avenue, North Dandenong, late of Kingston Centre, Warrigal Road, Cheltenham, pensioner, died 21 December 1989.

Ferguson, Sydney Richard, late of 6 Prentice Street, Nagambie, gardener, died 27 February 1990.

Greenwood, Alfred, late of Millewa Hall, 214 High Street, Kangaroo Flat, pensioner, died 17 April 1989.

Hamilton, Royce Edward, late of 278 Raleigh Street, Thornbury, owner driver, died 3 June 1989.

Harris, Patricia Muriel, late of Caritas Christi, 104 Studley Park Road, Kew, gentlewoman, died 17 February 1990.

Hayes, Myra Grace, formerly of 10 Beach Parade, Drumcondra, late of Clyde Private Nursing Home, 21 Skene Street, Newtown, pensioner, died 20 May 1990.

Nunn, Rita, late of 57 Mannish Road, Wattle Glen, widow, died 13 September 1987.

Trebilcock, Harry, formerly of 17 Curlew (in the will called Kurlaw) Avenue, Altona, late of Western Suburbs Nursing Home, 44 Stephen Street, Yarraville, gentleman, died 4 June 1990.

Vincent, Sylvia, late of Mayday Hills Hospital, Beechworth, pensioner, died 4 July 1990.

Wade, Kevin Albert, late of Ararat, pensioner, died 7 July 1990.

## ORDERS IN COUNCIL

*Historic Buildings Act 1981 (No. 9667)*AMENDMENT OF REGISTER OF  
HISTORIC BUILDINGS

Under section 14 of the *Historic Buildings Act 1981* the Governor in Council amends the Register by adding Historic Building No. 810:

Deanside Woolshed Complex, Reed Court, Rockbank.

(To the extent of all the buildings and all the land shown hatched on the attached map, being Lot 38 and part of Lot 40 on Plan of Subdivision No. 204422c, Parish of Maribyrnong, County of Bourke, which is included in the Register Books Certificates of Title Volume 9724 Folio 873 and Volume 9724 Folio 875.)

Dated 4 September 1990

Responsible Minister:

ANDREW McCUTCHEON

Minister for Planning and Urban Growth

NEIL MORROW

20600 Clerk of the Executive Council

*Historic Buildings Act 1981 (No. 9667)*AMENDMENT OF REGISTER OF  
HISTORIC BUILDINGS

Under section 14 of the *Historic Buildings Act 1981* the Governor in Council amends the Register by adding Historic Building No. 819:

Former Edward Willis House, 242 Ryrie Street, Geelong.

(The whole of the land shown hatched in the attached map of Memorial No. 607 in the Register Book 876 and the whole of the building excluding the c. 1956 additions.)

Dated 4 September 1990

Responsible Minister:

ANDREW McCUTCHEON

Minister for Planning and Urban Growth

NEIL MORROW

20600 Clerk of the Executive Council

*Historic Buildings Act 1981 (No. 9667)*AMENDMENT OF REGISTER OF  
HISTORIC BUILDINGS

Under section 14 of the *Historic Buildings Act 1981* the Governor in Council amends the Register by adding Historic Building No. 818:

The Former Wesleyan Methodist Church and 1889 Manse, 167 Fitzroy Street, St Kilda.

(The whole of the land in Certificate of Title Vol. 9521 Fol. 193 and the buildings shown hatched on the site plan in Appendix A.)

Dated 4 September 1990

Responsible Minister:

ANDREW McCUTCHEON

Minister for Planning and Urban Growth

NEIL MORROW

20600 Clerk of the Executive Council

*Historic Buildings Act 1981 (No. 9667)*AMENDMENT OF REGISTER OF  
HISTORIC BUILDINGS

Under section 14 of the *Historic Buildings Act 1981* the Governor in Council amends the Register by adding Historic Building No. 815:

Former Denton Hat Mills, 48-60 Nicholson Street, Abbotsford.

(The whole of the land and the buildings shown hatched in Appendix A within Certificate of Title Volume 8600 Folio 954.)

Dated 4 September 1990

Responsible Minister:

ANDREW McCUTCHEON

Minister for Planning and Urban Growth

NEIL MORROW

20600 Clerk of the Executive Council

*Historic Buildings Act 1981 (No. 9667)*AMENDMENT OF REGISTER OF  
HISTORIC BUILDINGS

Under section 14 of the *Historic Buildings Act 1981* the Governor in Council amends the Register by adding Historic Building No. 816:

Eastern Hill Hotel, 77 Victoria Parade (Cnr. Brunswick Street), Fitzroy.

(The whole of the land shown hatched in map, in Certificate of Title Volume 9884 Folio 383 and the buildings shown hatched in Appendix A.)

Dated 4 September 1990

Responsible Minister:

ANDREW McCUTCHEON

Minister for Planning and Urban Growth

NEIL MORROW

20600 Clerk of the Executive Council

*Historic Buildings Act 1981 (No. 9667)*AMENDMENT OF REGISTER OF  
HISTORIC BUILDINGS

Under section 14 of the *Historic Buildings Act 1981* the Governor in Council amends the Register by adding Historic Building No. 814:

Stokesay, 288 Nepean Highway, Seaford.

2700 G 35 5 September 1990

(All land contained in Certificate of Title Volume 9399 Folio 701 and three Knitlock concrete buildings shown hatched in map.)

Dated 4 September 1990

Responsible Minister:

ANDREW McCUTCHEON

Minister for Planning and Urban Growth

NEIL MORROW  
20600 Clerk of the Executive Council

*Historic Buildings Act 1981 (No. 9667)*

AMENDMENT OF REGISTER OF  
HISTORIC BUILDINGS

Under section 14 of the *Historic Buildings Act 1981* the Governor in Council amends the Register by adding Historic Building No. 820.

Hotel Victoria, 123 Beaconsfield Parade, Albert Park.

Dated 4 September 1990

Responsible Minister:

ANDREW McCUTCHEON

Minister for Planning and Urban Growth

NEIL MORROW  
20600 Clerk of the Executive Council

*Water Act 1958*

RURAL WATER COMMISSION OF  
VICTORIA

Goulburn-Murray Irrigation District

Kerang Irrigation Area

Portion Excised

The Governor in Council under the provisions of section 62B(6) of the *Water Act 1958* approves of the excision of the land shown by the green colour on the accompanying plan (Corr. No. 90/07067) from the Kerang Irrigation Area of the Goulburn-Murray Irrigation District as on and from 31 October 1990.

Dated 28 August 1990

Responsible Minister:

S. M. CRABB

Minister for Conservation and Environment

NEIL MORROW  
20720 Clerk of the Executive Council

*Water Act 1978*

RURAL WATER COMMISSION OF  
VICTORIA

Macalister Irrigation District

Portion Excised

The Governor in Council under the provisions of section 62B(6) of the *Water Act 1958* approves of the excision of the land shown by the green colour on the accompanying plan (Corr. No. 87/07537) from the Macalister Irrigation District as on and from 31 October 1990.

*Victoria Government Gazette*

Dated 28 August 1990

Responsible Minister:

S. M. CRABB

Minister for Conservation and Environment

NEIL MORROW  
20720 Clerk of the Executive Council

*Crown Land (Reserves) Act 1978*

NOTICE OF INTENTION

The Governor in Council under section 10 of the *Crown Land (Reserves) Act 1978* gives notice of intention to revoke the following temporary reservation.

BENALLA—The temporary reservation by Order in Council of 23 November 1868 of the Crown lands comprised within the limits of deviation of the surveyed line of railway from Melbourne to Belvoir so far only as the portion containing 231 square metres shown as Crown Allotment 5A, Section T, Township of Benalla, Parish of Benalla on Certified Plan No. 110145 lodged in the Central Plan Office—(GL/12853).

Dated 28 August 1990

Responsible Minister:

S. M. CRABB

Minister for Conservation and Environment

NEIL MORROW  
20090 Clerk of the Executive Council

*Crown Land (Reserves) Act 1978*

APPOINTMENT OF TRUSTEE—KILMORE  
RACECOURSE AND RECREATION  
RESERVE

The Governor in Council under section 12 of the *Crown Land (Reserves) Act 1978* and in accordance with the provisions of Crown Grant Volume 1989, Folio 650 appoints Harvey Alan Liebmann as a Trustee in place of Charles George Meier (resigned) of the land in the Parish of Glenburnie, at Kilmore, permanently reserved for a Racecourse and other Purposes of Public Recreation by Order in Council of 8 August 1887—(Rs. 1423).

Dated 28 August 1990

Responsible Minister:

S. M. CRABB

Minister for Conservation and Environment

NEIL MORROW  
20090 Clerk of the Executive Council

*Crown Land (Reserves) Act 1978*

CROWN LANDS TEMPORARILY  
RESERVED

The Governor in Council under sections 4 and 7 of the *Crown Land (Reserves) Act 1978*

*Victoria Government Gazette*

temporarily reserves for the purposes mentioned and also excepts from prospecting or from occupation for mining purposes under any miners right the following Crown lands.

**MUNICIPAL DISTRICT OF THE SHIRE OF BANNOCKBURN**

**BANNOCKBURN**—Water Supply, 3.189 hectares, being Crown Allotment 1B, Section G, Township of Bannockburn, Parish of Wabdallah as shown on Certified Plan No. 106001 lodged in the Central Plan Office—(Rs. 7779).

**MUNICIPAL DISTRICT OF THE SHIRE OF BANNOCKBURN**

**FYANSFORD**—Public Park, 1.400 hectares, being Crown Allotment 21A, Township of Fyansford, Parish of Gherineghap as indicated by hatching on plan hereunder—(F 93(2)) (Rs. 14163).

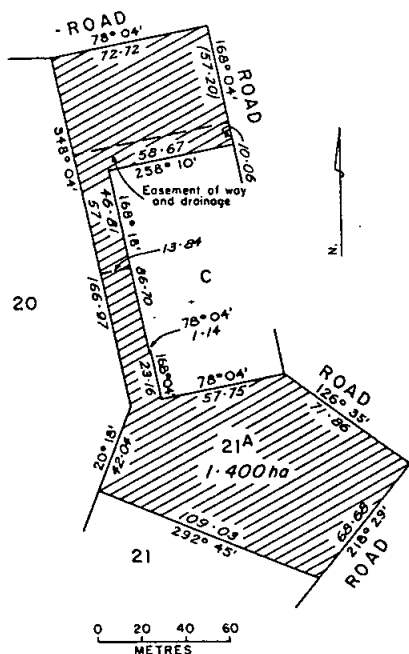

**MUNICIPAL DISTRICT OF THE CITY OF GEELONG**

**GEELONG**—Public Purposes, 3000 square metres, more or less, being Crown Allotment A1, City of Geelong, Parish of Corio as indicated by hatching on plan hereunder—(5311(1)) (Rs. 8107).

G 35 5 September 1990 2701

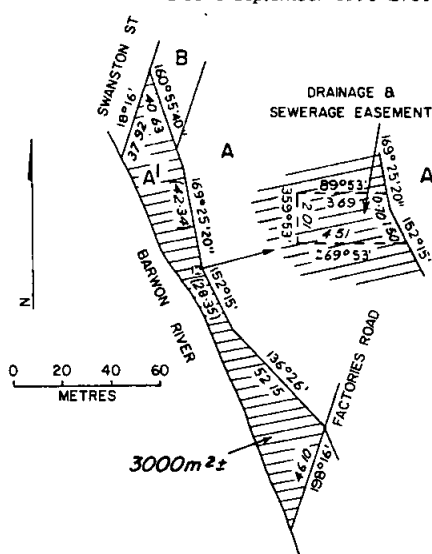

**MUNICIPAL DISTRICT OF THE SHIRE OF HUNTLY**

**GOORNONG**—Water Supply, 1615 square metres, being Crown Allotment 1P, Section 5, Parish of Goornong as indicated by hatching on plan hereunder—G 98(5)) (Rs. 1048).

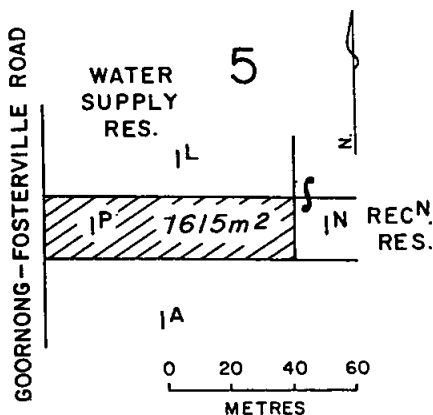

Dated 28 August 1990

Responsible Minister:

S. M. CRABB

Minister for Conservation and Environment

NEIL MORROW

20090

Clerk of the Executive Council

2702 G 35 5 September 1990

*Crown Land (Reserves) Act 1978*  
CROWN LANDS PERMANENTLY  
RESERVED

The Governor in Council under sections 4 and 7 of the *Crown Land (Reserves) Act 1978* permanently reserves for the purposes mentioned and also excepts from prospecting or from occupation for mining purposes under any miners right the following Crown lands.

MUNICIPAL DISTRICT OF THE SHIRE OF  
TALBOT AND CLUNES

AMHERST—Conservation of an Area of Natural Interest, 13.19 hectares being Crown Allotment A26, Section 11, Parish of Amherst as indicated by hatching on plan hereunder—(A 28(17)) (Rs. 13429).

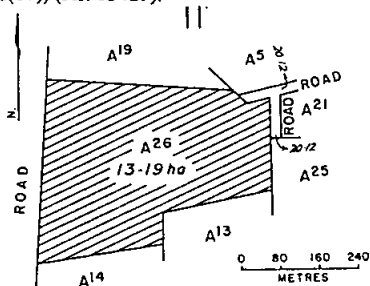

MUNICIPAL DISTRICT OF THE SHIRE OF  
BANNOCKBURN

BANNOCKBURN—Conservation of an Area of Natural Interest, 5.372 hectares, being Crown Allotments 1A and 1D, Section G, Township of Bannockburn, Parish of Waddallah as shown on Certified Plan No. 106001 lodged in the Central Plan Office—(Rs. 12168).

MUNICIPAL DISTRICT OF THE SHIRE OF  
KANIVA

DINYARRAK—Conservation of an Area of Natural Interest, 13.5 hectares, more or less, being Crown Allotments 9A and 10C, Parish of Dinyarrak as indicated by hatching on plan hereunder—(D 176(4)) (Rs. 14140).

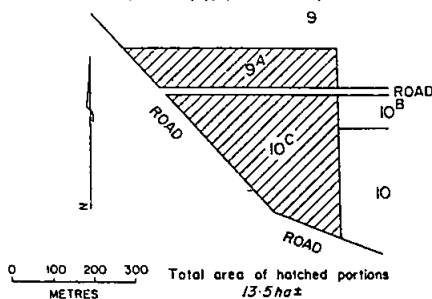

*Victoria Government Gazette*

MUNICIPAL DISTRICT OF THE SHIRE OF  
KOWREE

KADNOOK—Conservation of an Area of Natural Interest, 11 hectares, more or less, being Crown Allotment 63B, Parish of Kadnook as indicated by hatching on plan hereunder—(K 128(3)) (Rs. 13759).

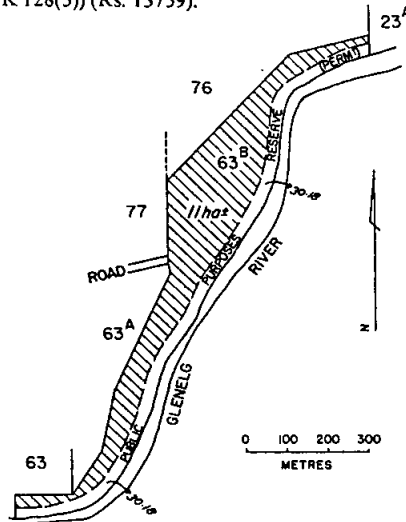

MUNICIPAL DISTRICT OF THE SHIRE OF  
LOWAN

KINIMAKATKA—Conservation of an Area of Natural Interest, 5.4 hectares, more or less, being Crown Allotment 32E, Parish of Kinimakatka as indicated by hatching on plan hereunder—(K 164(2)) (Rs. 14095).

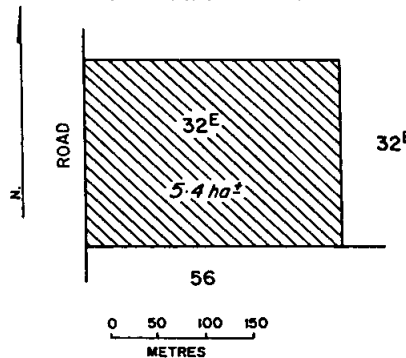

MUNICIPAL DISTRICT OF THE SHIRE OF  
KOWREE

MORTAT—Conservation of an Area of Natural Interest, 16.19 hectares, being Crown

Victoria Government Gazette

G 35 5 September 1990 2703

Allotment 28B, Parish of Mortat as indicated by hatching on plan hereunder—(M 464(3)) (Rs. 13985).

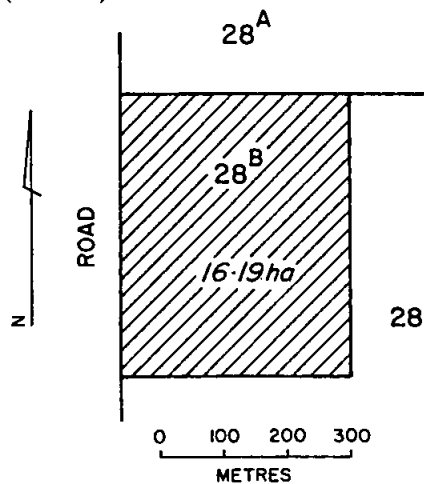

MUNICIPAL DISTRICT OF THE SHIRE OF YARRAWONGA

PEECHELBA—Conservation of an Area of Natural Interest, 7.7 hectares, more or less, being Crown Allotment 3, Section 9, Township of Peechelba, Parish of Peechelba as indicated by hatching on plan hereunder—(P 137(7)) (Rs. 3058).

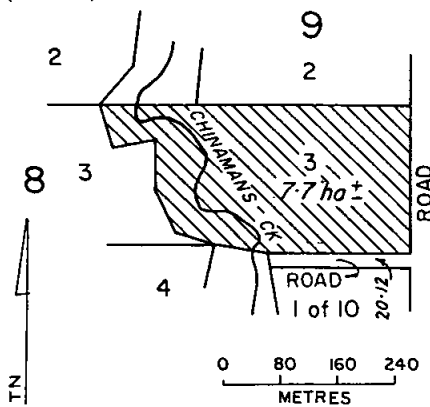

Dated 28 August 1990

Responsible Minister:

S. M. CRABB

Minister for Conservation and Environment

NEIL MORROW

20090

Clerk of the Executive Council



**TENDERS****MINISTRY OF HOUSING AND  
CONSTRUCTION—VICTORIA**

Major Works Tenders are invited for the purposes indicated hereunder and must be forwarded in the Ministry's coloured envelope and endorsed "Major Works Tender for".

The tender must either be—

lodged by hand in the box marked "Tenders" on First Floor, 2 Treasury Place, Melbourne, received by mail.

received by facsimile machine on (03) 651 1738 and immediately confirmed by mail on the Ministry's Tender Form.

No tender will be considered if received later than 2.00 p.m. on the closing date indicated hereunder for that work, or received by any other means.

Note: Telex and telegram tenders are no longer accepted. Tenders received by a mail delivery after the closing date and time are no longer accepted.

Tender documents are available for pick-up from the Contracts Office, Room 44, Ground Floor, 2 Treasury Place, Melbourne between 8.30 a.m.—12.30 p.m. and 1.30 p.m.—4.00 p.m. (posting will only occur outside 32 km from the G.P.O.)

and where indicated at the Provincial Works Office.

Enquiries: Telephone (03) 651 2453/4.

**Wednesday, 19 September 1990**

CASTLEMAINE—Construction of office and kennels, Dog Squad Office, Loddon Regional Prison. (W.O. Bendigo.)

CORAL PARK—Construction of car parks, Primary School.

RICHMOND—Removal of asbestos roofing and replacement, College of T.A.F.E.

**Wednesday, 26 September 1990**

CORAL PARK—Light duty paving, Primary School.

CORAL PARK—Hard landscaping—retaining walls, Primary School.

CORAL PARK—Manufacture of joinery fittings, Primary School.

**TONY SHEEHAN**

Minister for Housing and Construction

Ministry of Housing and Construction

Melbourne, 27 August 1990 20390

**State Tender Board, Victoria**

**TENDERS FOR THE SERVICE 1991–1992**

Tenders will be received until 8.30 a.m. on Friday, 21 September 1990 from persons willing to supply the following items in such quantities as may be ordered by the Victorian Government for the periods specified.

<i>Schedule No.</i>	<i>Description</i>	<i>Period</i>
1/03	Chemicals, Agricultural, Etc.	1 January 1991 to 31 December 1992
1/56	Tools (General)	1 January 1991 to 31 December 1992
1/81	Facsimile Equipment and Consumables	1 January 1991 to 31 December 1991

Tender documents may be obtained from the Secretary to the Tender Board, 3rd Floor, 49 Spring Street, Melbourne, Vic. 3000; Telephone No. 651 3266.

Tenders enclosed in the envelope provided, must be deposited in the tender box at the Tender Board Offices, 3rd Floor, 49 Spring Street, Melbourne 3000 or, if sent by post, postage must be prepaid and the tenders addressed to the Chairman of the Tender Board, Tender Board Office, 49 Spring Street, Melbourne 3000, which office they must reach not later than by first post on the date of closing of tenders. Under no circumstances will tender details be accepted by telephone.

**J. W. PAWSON**

Secretary to the Tender Board

PRIVATE  
ADVERTISEMENTS



CITY OF DONCASTER  
& TEMPLESTOWE

**PLANNING AND  
ENVIRONMENT ACT 1987  
NOTICE OF AMENDMENT  
TO THE DONCASTER AND  
TEMPLESTOWE PLANNING  
SCHEME AMENDMENT L30**

The City of Doncaster and Templestowe has prepared Amendment L30 to the Doncaster and Templestowe Planning Scheme.

The amendment proposes to change the Planning Scheme by: rezoning land at:

- (i) 85-96 Husseys Lane, Warrandyte South (Vol. 9101 Fol. 878)
- (ii) 100-110 Husseys Lane, Warrandyte South (Vol. 9271 Fol. 247)
- (iii) 112 Husseys Lane, Warrandyte South (Vol. 9271 Fol. 530)
- (iv) Rear of 506-514 Warrandyte-Ringwood Rd, Warrandyte South (Vol. 8769 Fol. 124)

From Proposed Public Purposes - Board of Works to Landscape Interest A.

The amendment can be inspected at:

- Doncaster and Templestowe Municipal Offices, 699 Doncaster Road, Doncaster
- The Department of Planning & Urban Growth, Ground Floor, The Oldfleet Buildings, 477 Collins Street, Melbourne
- Eastern Regional Office, The Department of Planning & Urban Growth, Suite 4/38-42 Prospect Street, Box Hill 3128

Submissions about the amendment must be sent to:  
City of Doncaster and Templestowe, by: 5 October, 1990.  
Box 1, PO Doncaster 3108

ATTENTION: Manager - Strategic Planning

D. O. McLEAN  
Chief Executive Officer

The City of Doncaster and Templestowe operates with a smoke free workplace and is an Equal Opportunity Employer.

11488/30020

*Local Government Act 1958*

CITY OF BRIGHTON

Road Discontinuance Resolution

Whereas it is provided in section 528 (2) of the above Act (as amended) that where a road whether or not a public highway is not required as a road for public use the Council of the municipality in which such road is situated may not less than one month after publishing a public notice in a newspaper generally circulated in the municipal district and giving written notice to the registered proprietor (if any) of any land abutting or immediately adjacent to the road of its intention to make a Resolution published in the *Government Gazette* direct that such road or part of the road shall be discontinued accordingly.

And whereas the Council of the above municipality hereby resolves that the land at the rear of 2-6 Thomson Street be discontinued and

not less than one month previously has published a public notice in a newspaper generally circulated in the municipal district and has given written notice to the last registered owner of the land in the roads and to the owners and occupiers of land abutting or immediately adjacent to the lane of its intention to make this Resolution and has considered all objections received within 14 days of the publication of the public notice aforesaid.

Now therefore the Council of the City of Brighton hereby directs:

- (a) that the section of the lane shown hatched on the enclosed plan herewith shall be discontinued upon publication of this Resolution in the *Government Gazette*;
- (b) that the land in the said roads shall vest in the municipality to be retained by it until it is sold by private treaty;
- (c) that notwithstanding such discontinuance the Melbourne and Metropolitan Board of Works shall continue to have and possess the same right, title, power, authority or interest in or in relation to the whole of the land shown by hachure on the said plan as it had or possessed prior to such discontinuance with respect to or in connection with any drains or pipes laid or erected in or over such land.

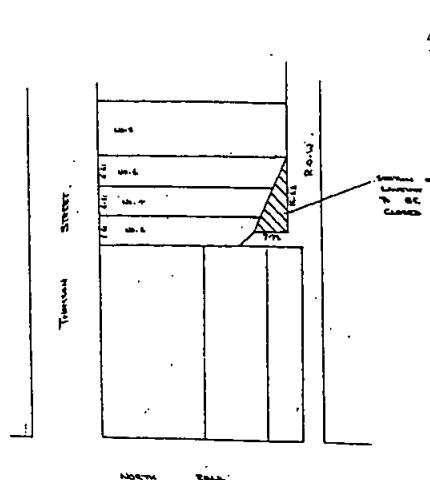

11495/50062

R. J. COBAIN  
Town Clerk

2706 G 35 5 September 1990

**CITY OF FRANKSTON**  
Local Law No. 4

**Conduct of Meetings of Council (Amendment)**

Notice is hereby given that Council intends to introduce Local Law No. 4 to amend Local Law No. 2 to alter the closing time of meetings held under that Local Law. A copy of the proposed Local Law can be obtained from the Civic Centre, Davey Street, Frankston during office hours.

Persons may make written submissions in respect of this Local Law within fourteen (14) days of the date of this notice. Any submissions will be considered by Council in accordance with section 223 of the *Local Government Act 1989*.

Any person lodging a written submission may request to be heard in support of the submission and shall be entitled to appear in person or by a person acting on his or her behalf before a meeting of the Council. Notice of the meeting date and time will be given to all persons lodging submissions.

A. H. BUTLER  
11444/30025 Chief Executive Officer

*Planning and Environment Act 1987*  
**NOTICE OF AMENDMENT TO A  
PLANNING SCHEME**

The City of Moe has prepared Amendment No. L16 to the Moe Planning Scheme, Local Section.

The amendment affects land at the corner of John Field Drive and Monash Road, being Nos. 1-11 Monash Road, Lots 2-7, LP 26540, Parish of Narracan and the abutting Tree Reserve along John Field Drive.

The amendment proposed to change the Planning Scheme by—

- (i) altering the provisions of the Residential 'A' zone to permit the development and use of Lots 2-7, LP 26540, Parish of Narracan, Nos. 1-11 Monash Road, Moe for a restaurant, reception room, licensed premises or plant nursery subject to the grant of a permit by the Responsible Authority;
- (ii) altering the provisions of Clause 22 (5) Restricted Use of Reserved Lands to allow access to Lot 2, LP 26540.

The amendment can be inspected at the Municipal Offices, Albert Street, Moe; the Regional Office of the Ministry for Planning and Urban Growth, The Olderfleet Buildings, 477 Collins Street, Melbourne.

Submissions about the amendment must be sent to the Manager Technical Services, City of

*Victoria Government Gazette*

Moe Municipal Offices, Albert Street, Moe 3825 by 5 October 1990.

Dated 5 September 1990

B. PEACH  
11423/30039 Manager Technical Services

**CITY OF NUNAWADING**

**Notice of Intention to Make a Local Law**

Notice is hereby given that the Council of the City of Nunawading pursuant to section 119 of the *Local Government Act 1989* proposes to make a Local Law for the following purpose—

1. To regulate roadside vendors.

A copy of the proposed Local Law can be obtained from the Local Laws Department, Civic Centre, 379 Whitehorse Road, Nunawading during normal office hours.

Any persons affected by the proposed Local Law may make written submissions pursuant to section 223 of the *Local Government Act 1989*.

The Council will consider any written submissions received within 14 days after the publication of this notice.

Any person who has made a written submission to the Council may request that he/she be heard in support of the written submission by the Council or a Committee of the Council nominated for that purpose, at a time and date to be fixed by the Council.

W. J. DILLEY  
11422/30044 City Manager

**CITY OF PORT MELBOURNE**

**Notice of Proposed Local Law**

The Council of the City of Port Melbourne proposes to make a Local Law for the following purposes:

1. Regulating proceedings at meetings of Council and Committees.
2. Regulating proceedings for the election of the Mayor.
3. Regulating usage of the Common Seal of Council.

A copy of the proposed Local Law can be obtained from the Council Offices, 33 Bay Street, Port Melbourne, during office hours.

Any affected person may, within fourteen (14) days after publication of this notice, make to Council a submission which will be considered in accordance with section 223 of the *Local Government Act 1989* by the Whole Council Committee, at its meeting to be held on 2 October 1990.

D. GRAHAM  
11431/30046 Town Clerk

Victoria Government Gazette

Planning and Environment Act 1987  
RINGWOOD PLANNING SCHEME

Notice of Amendment

The City of Ringwood has prepared Amendment No. L8 to the Ringwood Planning Scheme.

The amendment affects land known as 45-47 Maroondah Highway, Ringwood, being situated on the north side of Maroondah Highway between New Street and Sherbrook Avenue.

The amendment proposes to change the Planning Scheme by rezoning the land from Light Industrial and Residential C to Ringwood District Centre—Commercial Boulevard.

The amendment can be inspected at the office of the City of Ringwood, Civic Centre, Braeside Avenue, Ringwood; Department of Planning and Urban Growth, The Olderfleet Buildings, 477 Collins Street, Melbourne and the Regional Office of the Department, Suite 4, 38 Prospect Street, Box Hill.

Submissions relating to the amendment must be sent to the City of Ringwood, PO Box 156, Ringwood by 15 October 1990.

Dated 5 September 1990

11487 J. PAECH, Chief Executive

CITY OF SUNSHINE

Road Closure

Notice is hereby given that in accordance with the provisions of section 528 (2) (a) of the *Local Government Act 1958* the Council of the City of Sunshine on 31 July 1990 resolved as follows:

- (a) That the whole of the road shown hatched on the plan hereunder is not reasonably required as a road for public use.
- (b) That the said portion of the road be discontinued upon publication of this resolution in the *Government Gazette*.
- (c) That the land in the said road shall vest in the City of Sunshine until sold by private treaty to the abutting property owner(s).
- (d) That notwithstanding such discontinuance, the Melbourne and Metropolitan Board of Works shall continue to have and possess the same right, title, power, authority or interest in, or in relation to, the whole of the road (whether by virtue of any easement or grant or by force of any Act) with respect to or in connection with any drains or pipes laid or erected in, on or over the road for the purpose of drainage or sewerage or for the supply of water or other like purpose.

G 35 5 September 1990 2707

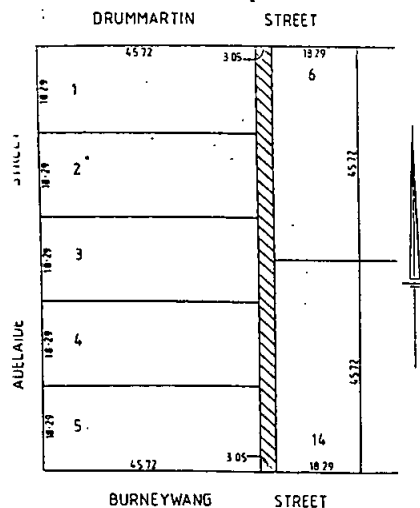

JOHN JAMES  
Chief Executive Officer/Town Clerk  
11439/30058

CITY OF WERRIBEE

Proposed Local Law

Notice is given that the Council of the City of Werribee has resolved to commence procedure to make a Local Law pursuant to section 119 of the *Local Government Act 1989* for the following purposes:

The purposes of this Local Law are to—

- (a) provide for the peace order and good government of the municipal district of the City of Werribee; and
- (b) provide for the administration of the Council's powers and functions in relation to the supply of water to the Werribee South Water Supply area including the imposition of fees and charges;
- (c) to apply, adopt and incorporate relevant matters contained in By-laws operated by the Melbourne and Metropolitan Board of Works in adjacent parts of the City of Werribee; and
- (d) to provide so far as possible for consistency in the administration and regulation of water supply within the municipality; and
- (e) to prohibit, regulate, control and provide for offences and penalties in relation to activities, events, practices or behaviour connected with the supply of water to the Werribee South Water Supply area.

2708 G 35 5 September 1990

Copies of the proposed Local Law are available from the Civic Centre, 45 Princes Highway between the hours of 8.00 a.m. and 4.56 p.m., Monday to Friday.

Any person affected by the proposed Local Law may make a written submission relating thereto within 14 days of the date of publication of this notice.

Submissions should be addressed to the Town Clerk, City of Werribee, PO Box 197, Werribee 3030.

Any person making a submission should do so in writing, and may request to be heard in support thereof, either in person or by a person acting on his or her behalf, by the Council or a Committee of the Council nominated for that purpose.

J. T. KERR  
Town Clerk

11496/30226

*Planning and Environment Act 1987*  
**NOTICE OF AMENDMENT TO A  
PLANNING SCHEME**

The City of Whittlesea has prepared Amendment No. L28 to the Whittlesea Planning Scheme.

The amendment affects land at:

1. Lots 3 and 4, L.P. 205629, Jones and Nathan Court, Bundoora.
2. Lot 1, L.P. 212120, Appletree Drive and Lots 4, 5, 6, 7, 8, 9, 10, 11, 12, 13, L.P. 212120, Tenderden Place, Mill Park.

The amendment proposes to change the Planning Scheme by:

1. Rezoning land currently zoned Reserved Living to Neighbourhood Business.
2. Rezoning land currently zoned Part Stream and Floodway to Reserved Living.

The amendment can be inspected at the City of Whittlesea Municipal Offices, High Street, Epping, and the Ministry for Planning and Environment, Ground Floor, 477 Collins Street, Melbourne.

Submissions about the amendment must be sent to the City of Whittlesea, Private Bag 1, Epping, 3076 by 8 October 1990.

L. G. ESMONDE  
Chief Executive

11419/30227

**CITY OF WILLIAMSTOWN**  
**Road Closure**

Whereas the Council of the City of Williamstown has done all those things required by section 528 (2) of the *Local Government Act 1958* (as amended) to be done prior to the making of this resolution and has formed the opinion that the road hereinafter mentioned is not reasonably required as a road for public use.

*Victoria Government Gazette*

Now the said Council of the City Williamstown pursuant to the power given to it by section 528 (2) of the said Act hereby resolves and directs:

- (a) that the unnamed road running easterly from the south-west corner of 49 Farm Street to the south-west corner of 15 Farm Street, and more particularly shown cross-hatched on the attached plan whether or not a public highway (but not being a road set out on Crown land) shall be discontinued;
- (b) that notwithstanding such discontinuance the Melbourne and Metropolitan Board of Works shall continue to have and possess the same right, title, power, authority or interest in or in relation to the whole of the said land as it had or possessed prior to such discontinuance with respect to any drains or pipes laid or constructed in, on or over such land for the purpose of drainage or sewerage;
- (c) that notwithstanding such discontinuance, the State Electricity Commission shall continue to have and possess the same right, title, power, authority or interest in or in relation to the whole of the said land as it had or possessed prior to such discontinuance with respect to any cables or pipes laid or constructed in, on or over such land for the purpose of television reception; and
- (d) that subject to the right, title, power, authority or interest of such Authority, the land in the said road shall vest in the municipality to be retained by it until it is sold by private treaty and when sold will be encumbered as an easement for drainage.



R. A. McCLEAN  
Chief Executive Officer

11497/30064

*Planning and Environment Act 1987*  
**RURAL CITY OF WODONGA**

Notice of Amendment to a Planning Scheme

The Rural City of Wodonga has prepared Amendment No. L14 to the Wodonga Planning Scheme, Local Section.

The amendment affects land being Crown Allotments 5, 7, 10, 11, 15, 16 and 17 of Sections 6A and 1A, part 2 and 3 of Section 6, Parish of Belvoir West. The land is located to the north-west of the Rural City of Wodonga between the

*Victoria Government Gazette*

Hume Freeway and the River Murray and forms that area of land annexed to the Shire of Chiltern from the Rural City of Wodonga.

The amendment proposes to change the Planning Scheme by changing Scheme Map Sheet No. 1 to remove the subject land from the area of application of the Wodonga Planning Scheme.

The amendment can be inspected at Rural City of Wodonga, City Offices, Hovell Street, Wodonga; the Department of Planning and Urban Growth, Ground Floor, The Olderfleet Buildings, 477 Collins Street, Melbourne.

Submissions concerning the amendment must be sent to the Rural City of Wodonga, PO Box 923, Wodonga 3690 by 12 October 1990.

R. I. O'TOOLE  
11489/30065 Chief Executive Officer

**RURAL CITY OF WODONGA**  
Notice of Intention to Make Local Laws  
Local Law No. 1  
Local Law No. 2  
Local Law No. 3

Notice is hereby given that the Council of the Rural City of Wodonga on 27 August 1990 made the following Local Laws in accordance with section 119 of the Local Government Act for the following purposes.

**Local Law No. 1**

A. To regulate the use of the Common Seal of the Rural City of Wodonga and prohibit unauthorised use of the Common Seal or any device resembling the Common Seal as required by section 5 (2) (B) of the *Local Government Act* 1989.

**Local Law No. 2**

A. To regulate the proceedings for election of the Mayor and Deputy Mayor.

**Local Law No. 3**

A. To regulate proceedings at meetings of Council and Special Committees as required by section 91 (2) of the *Local Government Act* 1989.

B. To repeal By-Law No. 82.

Copies of the Local Laws are available for inspection at the Municipal Offices, Hovell Street, Wodonga during office hours.

B. W. POOLEY  
11443/30065 Acting Chief Executive Officer

**BOROUGH OF QUEENSCLIFFE**  
Local Law No. 2

Notice is hereby given that the Council of the Borough of Queenscliffe proposes to make a Local Law which will be applicable to the whole of the municipal district of the Borough of Queenscliffe.

*G 35 5 September 1990 2709*

The purpose and general purport of the Local Law is to—

- (1) Regulate proceedings for the election of Mayor;
- (2) Govern the conduct of meetings of Council and its Committees.

A copy of the proposed Local Law can be inspected or obtained from the Municipal Offices, 50 Learmouth Street, Queenscliff during normal office hours.

Any persons affected by the proposed Local Law may make written submission relating to the proposed Local Law under the provisions of the Local Government Act within fourteen (14) days of this notice.

Submissions should be addressed to the Town Clerk, Borough of Queenscliffe, P.O. Box 93, Queenscliff, 3225.

Dated 31 August 1990

B. A. McCARTHY  
11498/30079 Town Clerk

**BOROUGH OF SEBASTOPOL**

**Local Law Nos. 1 and 2**

Notice is hereby given that the Council of the Borough of Sebastopol at an Ordinary Meeting held on 22 August 1990 made and passed the following Local Laws under the provisions of the *Local Government Act* 1989.

Local Law No. 1 is for the following purposes—

- (i) to regulate the use of the Common Seal;
- (ii) to regulate the way in which the Mayor and Deputy Mayor will be elected and the time that this is done;
- (iii) to determine the appointment or election of a chairperson for the Committees;
- (iv) to determine a newspaper for giving a public notice;
- (v) to regulate the procedures at meetings of Council and Special Committees;
- (vi) to repeal By-Law No. 29 by Council pursuant to the provisions of the *Local Government Act* 1958.

Local Law No. 2 is for the following purposes—

- (i) to promote a physical and social environment free of hazards to health;
- (ii) to maintain the municipal district at all times in clean and sanitary condition;
- (iii) to prevent and remedy all nuisances or conditions liable to be dangerous to health or offensive to people;
- (iv) repeal existing Council By-Law 30 made by Council pursuant to the provisions of the *Local Government Act* 1958.

11424/30164 Chief Executive Officer

Planning and Environment Act 1987  
NOTICE OF AMENDMENT TO A  
PLANNING SCHEME

The Shire of Lillydale has prepared Amendment No. L75 to the Lillydale Planning Scheme.

The amendment affects land described as part CA 14A, Parish of Mooroolbark, 1391 Mount Dandenong Tourist Road, and part of the disused Warburton Railway reservation in Clancy Road, Mount Evelyn.

The amendment proposes to change the Planning Scheme by:

- (a) Rezoning the Churinga Tearooms Mount Dandenong to Restricted Use 6—Restaurant; and
- (b) Rezoning land owned by the Public Transport Corporation (MET) in Clancy Road, Mount Evelyn for light industrial purposes.

The amendment can be inspected at Upper Yarra Valley and Dandenong Ranges Authority, John Street, Lilydale; Shire of Lillydale, Anderson Street, Lilydale; Ministry for Planning and Urban Growth, The Olderfleet Buildings, 477 Collins Street, Melbourne and Suite 4, 38-40 Prospect Street, Box Hill.

Submissions about the amendment must be sent to the Shire of Lillydale, Shire Offices, Anderson Street, Lilydale, P.O. Box 105, Lilydale 3140 by 12 October 1990.

Submissions should state whether the author wishes to be heard by an independent panel if the submission is rejected by Council.

W. I. HEINE  
11420/30167 Chief Executive Officer

SHIRE OF MANSFIELD  
Local Law No. 90/2

Notice is hereby given that the Council of the Shire of Mansfield, at an ordinary meeting held on 28 August 1990, made Local Law No. 90/2 for the following purposes:

- (a) regulating the proceedings at the meetings of the Council or of Special Committees of the Council;
- (b) repealing By-Law No. 64.

A copy of Local Law No. 90/2 may be inspected at the Shire Offices, Highett Street, Mansfield.

PETER SMITH  
11428/30172 Shire Secretary

SHIRE OF MORNINGTON

Notice is hereby given that the Shire of Mornington being of the opinion that part of Pentecost Road, Mornington shown on Lodged Plan 82548, shown hatched on the plan below is not required for public use, resolved on 24 October 1988:

That part of Pentecost Road, Mornington, on Lodged Plan No. 82548 shown hatched on Plan No. 729/CW/1 be discontinued and that the land comprising such discontinued road shall vest in Council.

and further resolved on 6 March 1989:

That Council adopt Plan No. 792/CW/1A as the Plan showing that part of Pentecost Road, Mornington, hatched, to be discontinued as resolved on 24 October 1988 (Clause AN36).

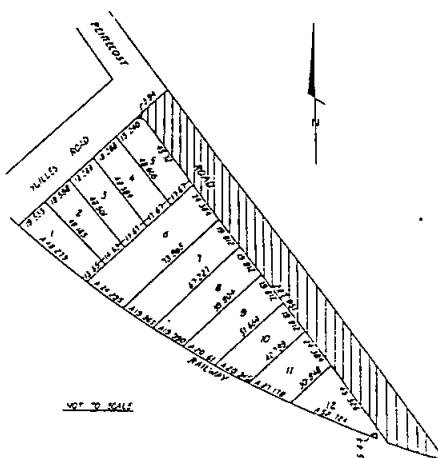

JOHN E. ROSS  
11506/30179 Chief Executive Officer

SHIRE OF PAKENHAM  
Local Law No. 1

Notice is hereby given pursuant to section 119 (3) of the Local Government Act 1989 that the Council of the Shire of Pakenham has made a Local Law titled "Council Meeting Procedure and the Common Seal".

The purpose and general purport of the Local Law is:

- (a) To provide for the peace, order and good government of the Municipal District of the Shire of Pakenham; and
- (b) To provide for those matters which require a Local Law under the Local Government Act 1989 and any other Act; and



2712 G 35 5 September 1990

- (c) To provide for the administration of Council powers and functions; and
- (d) To regulate the proceedings at meetings of the Council and special advisory committees of the Council; and
- (e) To regulate the use of the Common Seal or any device resembling the Common Seal as required by section 5 (3) (c) of the *Local Government Act 1989*.

A copy of the Local Law may be inspected or purchased from the Municipal Offices, Henty Way, Pakenham during office hours.

11493/30193

RAY CANOBIE  
Shire Secretary

*Land Acquisition and Compensation Act 1986*

SHIRE OF ROSEDALE

Compulsory Acquisition of Interest in Land  
Notice of Acquisition

The Shire of Rosedale declares that by this notice it acquires the following interest(s) in the land described as:

Lot 60 Bondi Street, Golden Beach, more particularly described in Certificate of Title Vol. 8459 Folio 510 as Lot 60 on Plan of Subdivision No. 50576, Parish of Dulungalong.

The interest acquired is the whole of the property.

11442/30201

P. L. TATTERSON  
Shire Secretary

*Planning and Environment Act 1987*

SHERBROOKE PLANNING SCHEME

Notice of Amendment to a Planning Scheme  
Amendment L38

The Shire of Sherbrooke has prepared Amendment No. L38 to the Sherbrooke Planning Scheme.

The amendment affects land at Crown Allotment Part 106E, being 10.35 hectares of land on Wellington Road, Clematis.

The amendment proposes to rezone part of the land from "Rural (Conservation)" to "Restricted Use 10—Plant Nursery (Retail)".

The amendment can be inspected at the Shire of Sherbrooke, Glenfern Road, Upwey; the Upper Yarra Valley and Dandenong Ranges Authority, 7-9 John Street, Lilydale; Department of Planning and Urban Growth, Eastern Regional Office, Suite 4, 38-40 Prospect Street, Box Hill; Department of Planning and Urban Growth, 477 Collins Street, Melbourne.

*Victoria Government Gazette*

Submissions about the amendment must be sent to the Shire of Sherbrooke, Glenfern Road, Upwey, 3158 by 5.00 p.m. Friday, 5 October 1990.

Dated 5 September 1990

IAN GIBB  
Manager

11437/30205

Environmental Planning

SHIRE OF WARRACKNABEAL

Local Law No. 4, 1990

Notice is hereby given that the Council of the Shire of Warracknabeal proposes to make a Local Law for the purposes of:

- (a) To regulate the droving of cattle through or to a location within the municipal district.
- (b) To regulate the droving of cattle through or to a location in the municipal district to certain streets or roads within the municipal district.
- (c) To regulate the droving of cattle along certain streets or roads within the municipal district for purposes of—
  - (i) preventing damage to roadside vegetation;
  - (ii) preventing damage to properties adjoining certain streets or roads within the municipal district;
  - (iii) preventing the spread of disease in the municipal district;
  - (iv) preventing the spread of noxious weeds in the municipal district.
- (d) To control the manner in which cattle are driven to provide, as far as possible, for the safety of users of streets and roads within the municipal district.
- (e) To prescribe the fees to be paid for any permits issued under this Local Law; and
- (f) To prescribe the penalties to be imposed for contravention of certain provisions of this Local Law.

It is the intent of this Local Law to limit the number of type of cattle, which may be driven by a person in charge, that may travel through the municipal district at any one time, to 2000 head.

A copy of the proposed Local Law No. 4 may be inspected at the Shire Offices, Scott Street, Warracknabeal, during office hours.

Any person affected by the proposed Local Law may make a submission in accordance with section 223 of the *Local Government Act 1989* within 14 days of the publication of this notice, which will be considered by Council at its meeting on Friday, 21 September 1990.

Written submissions should be addressed to the Shire Secretary, Shire of Warracknabeal, P.O. Box 243, Warracknabeal 3393.

K. V. SHADE  
Shire Secretary  
11485/30224

*Planning and Environment Act 1987*  
**NOTICE OF AMENDMENT TO A  
PLANNING SCHEME**

The Shire of Yackandandah has prepared Amendment No. L6 (re-exhibited) to the Yackandandah Planning Scheme.

The amendment affects Industrial zoned land within Chapter 1 of the Planning Scheme.

The amendment deletes Clause 27 (4) (d) and inserts a new sub-clause within Clause 27 (4) (b) of Chapter 1 of the Planning Scheme Ordinance which gives the Responsible Authority the discretion to allow buildings to be constructed to a height of more than 7.5 metres.

The amendment can be inspected at the offices of Shire of Yackandandah, High Street, Yackandandah; Department of Planning and Urban Growth, 477 Collins Street, Melbourne; and the Department of Planning and Urban Growth, 1 McKoy Street, Wodonga.

Submissions about the amendment must be sent to the Shire of Yackandandah, P.O. Box 75, Yackandandah 3749 by 5 October 1990.

Dated 30 August 1990

A. MITCHELL  
Acting Manager of Technical Services  
11490/30232

**AUCTION**

Dandenong, 14 September 1990

Under Livery and Livestock Act. Brown Thoroughbred Stallion 5 Y.O. Registration available.

Inquiries: (056) 29 2438 11425/52086

*Land Acquisition and Compensation Act 1986*  
**COMPULSORY ACQUISITION OF  
INTEREST IN LAND**

**Notice of Acquisition**

Riddells Creek Water Board declares that by this notice it acquires the following interest(s) in the land described as:

The land shown hatched on the plan below being part of JWT Clarke's Crown Special Survey, Parish of Kerrie, County of Bourke and more particularly described as being part of Certificate of Title Volume 8679 Folio 354.

*Interest Acquired:* Estate in fee simple from Rupert Clarke and Co. Proprietary Limited.

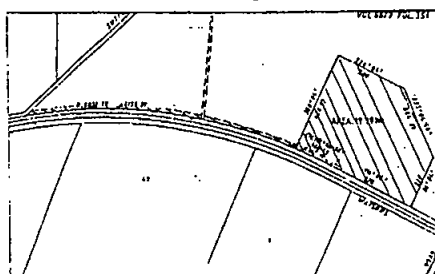

Published with the authority of the Riddells Creek Water Board.

Dated 31 August 1990

STEVEN EVANS, Secretary  
11441/51989 Riddells Creek Water Board

**THE ROYAL HUMANE SOCIETY OF  
AUSTRALASIA**

Announces the following awards to residents of Victoria for the year ended 1989/90:

Kenneth Bruce Woodward, Silver Medal  
Geoffrey Lewis Turner, Certificate of Merit  
Kenneth Frank Gardam, Certificate of Merit  
Graham John Bassett, Recorded in Archives  
Kevin John Brew, Certificate of Merit  
Phillip John Schier, Bronze Medal  
Paul Francis, Certificate of Merit  
Mathew John Byford, Certificate of Merit  
Paul Conway, Bronze Medal  
Stephen Troy Hodges, Certificate of Merit  
Tania Redfern, Certificate of Merit  
Kaye Adrienne Pyke, Certificate of Merit  
John Anton Ariens, Certificate of Merit  
Robert Joseph Barton, Certificate of Merit  
Valentine Bertram Townsend, Certificate of Merit  
Mathew Anthony Brown, Bronze Medal  
Scott Thomas Greer, Bronze Medal  
Ronald Hayden Robinson, Bronze Medal  
Darren Peter Topham, Certificate of Merit

T. C. BANNISTER  
11507 Secretary

**UPPER KIEWA WATER BOARD**

The Board advises that Rates and Charges for the year ending 30 June 1991 have been fixed by resolution passed 17 July and confirmed 21 August 1990, as summarised below:

*Water Rates*

Urban District—a Rate of 5.025 cents in the dollar of Net Annual Valuation of properties,

2714 G 35 5 September 1990

subject to a minimum Building Rate of \$167.00 and a minimum Vacant Land Rate of \$150.30.

Rural District—a Dwelling Rate of \$162.00 plus and Area Rate of \$3.50 per hectare of a holding.

#### *Water Charges*

All Consumers—a charge of 32 cents per kilolitre for the first 300 kilolitres used and 43 cents per kilolitre thereafter. Allowance Water will be calculated at these rates based upon the amount of Water Rate/Annual Charge levied.

#### *Wastewater (Sewerage) Rates*

Sewerage District—a Rate of 5-60 cents in the dollar of Net Annual Valuation of properties, subject to a minimum Building Rate of \$173.00 and minimum Vacant Land Rate of \$155.70.

#### *Cistern Charges*

Cistern Charges applied to sewerage, non-rateable properties will be \$145.00 per Cistern.

Due date for payment of Rates and Cistern Charges is 1 October 1990.

11492/30379 J. B. O'BRIEN, Manager

Notice is hereby given that the partnership hereto subsisting between Ruth Robinson and Frances Estelle Nayler carrying on the business of retail school and leisure wear at 56A Watsons Road, Newcomb in the State of Victoria under the style or firm name of "Geelong School and Leisure Wear" has been dissolved from 30 April 1990 and as from the said date the said Frances Estelle Nayler and Geoffrey Alexander Nayler have continued to carry on the said business.

Dated 29 August 1990

JOHN C. FITZGERALD & CO., solicitors, 15 Fenwick Street, Geelong 11433/50684

#### NOTICE OF DISSOLUTION OF PARTNERSHIP

Notice is hereby given that the partnership heretofore subsisting between Mark Wieselmann of 13 Redan Road, Caulfield in the State of Victoria and Mark Reginald Iversen of 77 Northernhay Road, Reservoir in the said State has been dissolved as from 22 June 1990.

Dated 22 August 1990

MARK WIESELMANN  
11436/50968 MARK REGINALD IVERSEN

#### W. N. ANDERSON NOMINEES PTY. LTD.

Brian Edward Warming has brought a summons in action number 2008 of 1990 in the Supreme Court of South Australia seeking the winding up of W. N. Anderson Nominees Pty. Ltd. The summons is listed for hearing on 26

#### *Victoria Government Gazette*

September 1990 at not before 2.15 p.m. Any creditor or contributory of W. N. Anderson Nominees Pty. Ltd. wishing to be heard on the summons must file and serve a Notice in accordance with Rule 32 of the Companies Rules 1985 at least three business days before the day on which the summons is listed for hearing and must attend the Supreme Courthouse, Victoria Square, Adelaide at the time set for the hearing of the summons. A copy of the summons and the affidavit in support can be obtained on the payment of the proper cost from Esau, Meister & Associates of 49 Wright Street, Adelaide, S.A. 5000.

Dated 29 August 1990

11445/52086

#### COMPANIES (VICTORIA) CODE

##### S.338 (2) (b)

Superior Electronic Developments Pty. Ltd. of 131 Station Street, Fairfield was placed under official management for a period of six (6) months by special resolution of a meeting of creditors on 23 August 1990.

The official manager is Graham John Clark.

11516

PETER ALAN FORD, late of 9 Moore Street, Elwood deceased

Creditors, next of kin and others having claims in respect of the estate of the deceased who died on 26 May 1989 are required by Harold Ford of 110 Randwick Park Road, Pymstock, Plymouth, Devon, England to send particulars of their claims to Mallesons Stephens Jaques of Level 28, North Tower, Rialto, 525 Collins Street, Melbourne by 29 September 1990, after which date it will convey or distribute the assets having regard only to the claims of which the company has notice.

MALLESONS STEPHENS JAQUES,  
solicitors, Level 28, North Tower, Rialto, 525 Collins Street, Melbourne 11455/51141

Creditors, next of kin and others having claims in respect of the estate of Ronald George Shepherd late of Unit 1, 42 Eramosa Road East, Somerville, orchardist deceased who died on 27 April 1990 are required to send particulars of their claims to the executors, William McKenzie Cleland and Malcolm James Russell Taylor both of 108-120 Young Street, Frankston on or before 5 November 1990, after which date they will distribute the assets having regard only to the claims of which they then have notice.

WHITE CLELAND, solicitors, 108 Young Street, Frankston 11456/51141

Creditors, next of kin and others having claims in respect of the estate of Edward Frederick James Calcraft late of Unit 5, 121-123 Mount Eliza Way, Mount Eliza, retired deceased who died on 17 March 1990 are required to send particulars of their claims to the executors, Christine Mary Creaser and Neville Howard Creaser both of 179 Overport Road, Frankston and Charles Edward Calcraft of 8 Appletree Drive, Glen Waverley on or before 5 November 1990, after which date they will distribute the assets having regard only to the claims of which they then have notice.

WHITE CLELAND, solicitors, 108 Young Street, Frankston 11457/51141

Creditors, next of kin and others having claims in respect of the estate of Mavis Ruddell late of 37 Petrie Street, Frankston, widow deceased who died on 30 May 1990 are required to send particulars of their claims to the executors, Diana Rees and William David Rees both of 29 Delunga Street, Broadbeach Waters, Queensland on or before 5 November 1990, after which date they will distribute the assets having regard only to the claims of which they then have notice.

WHITE CLELAND, solicitors, 108 Young Street, Frankston 11458/51141

Creditors, next of kin and others having claims in respect of the estate of Walter Chippindale, late of 36 Pennyroyal Crescent, Melton, fitter who died on 28 September 1989 are to send particulars of their claims to Doreen Henderson the executrix care of the undersigned by 6 November 1990, after which date she will commence to distribute the assets having regard only to the claims of which she then has notice.

RENNICK & GAYNOR, solicitors of 431 Riversdale Road, Hawthorn East 11459/51141

Creditors, next of kin and others having claims in respect of the estate of Warren Murray White, late of 63 Atkinson Street, Templestowe, medical practitioner, deceased who died on 20 August 1990 are requested to send particulars of their claims to the executors Isabel Rachel White, Geoffrey Arthur Park and Robert John Hjorth, care of the undermentioned solicitors on or before 6 November 1990 after which date they will distribute the assets having regard only to the claims of which they then have notice.

McKEAN & PARK, solicitors, 405 Little Bourke Street, Melbourne 11460/51141

Creditors, next of kin and others having claims in respect of the estate of John Comlin late of 1 Nestor Grove, Blackburn in the State of Victoria, librarian deceased, who died on 16 June 1990 are required to send particulars of their claim to the Equity Trustees Executors and Agency Company Limited by 7 November 1990, after

which date it will distribute the assets having regard only to the claims of which it then has notice. 11461/51141

Creditors, next of kin and others having claims in respect of the estate of Dorothy Jean Horstman, late of 6 Beverley Crescent, Blackburn, deceased who died on 26 February 1990 are to send particulars of their claims to The Equity Trustees Executors and Agency Co. Ltd. of 472 Bourke Street, Melbourne by 10 November 1990, after which date it will distribute the assets having regard only to the claims of which it then has notice. 11462/51141

Creditors, next of kin and others having claims in respect of the estate of Dorothy Madsen (also known as Doris Lena May Madsen) late of 17 Park Road, Noble Park in the State of Victoria, widow, deceased, who died on 19 July 1990, are required to send particulars of their claims to the executor care of the undermentioned solicitors by 8 November 1990, after which date the executor will distribute the assets having regard only to the claims for which notice has been received.

BORCHARD & MOORE, solicitors of 44 Douglas Street, Noble Park 11471/50200

Creditors, next of kin and others having claims in respect of the estate of Sidney George East, late of 37 Tarnagulla Road, Inglewood, retired deceased, who died on 10 May 1990, are required to send particulars of their claims to the executors, National Mutual Trustees Limited, of 46 Queen Street, Bendigo and Arthur William East, of 52 Market Street, Inglewood, care of the said Trustee Company on or before 12 November 1990, after which date it and he will distribute the assets having regard only to the claims of which it and he then have notice.

ROGERS & EVERY, solicitors, 71 Bull Street, Bendigo 11472/51557

FRANCIS ALBERT KAY, late of 11 Danson Avenue, Kangaroo Flat, office equipment proprietor, deceased

Creditors, next of kin and others having claims in respect of the estate of the abovenamed deceased who died on 3 May 1990, are required by the executor National Mutual Trustees Limited of 46 Queen Street, Bendigo and Gwendolene May Kay of 11 Danson Avenue, Kangaroo Flat, widow, to send particulars to them at National Mutual Trustees Limited of 46 Queen Street, Bendigo by 16 November 1990, after which date the executors will distribute the assets having regard only to the claims of which they then have notice.

COHEN KIRBY & ISER, solicitors, 94 Pall Mall, Bendigo 11473

Creditors, next of kin and others having claims in respect of the estate of Dorothy Edith Beeston, late of Inala Nursing Home East, 220 Middleborough Road, South Blackburn, widow, deceased who died on 23 June 1990, are to send particulars of their claim to Richard James Mackenzie, care of Eales & Mackenzie, solicitors of 116 Main Street, Lilydale by 13 November 1990, after which date he will distribute the assets having regard only to the claims of which he then has notice.

EALES & MACKENZIE, solicitors, 116 Main Street, Lilydale 11474/50606

ELSIE McKERROW, formerly of 774 Station Street, Box Hill, but late of Cooina Lodge, West Gippsland Hospital, Warragul, widow, deceased

Creditors, next of kin and others having claims in respect of the estate of the deceased who died on 30 June 1990 are required by the trustee Lilian Beatrice Decker to send particulars of their claims to her, care of the undersigned solicitors by 9 November 1990, after which date the trustee may convey or distribute the assets having regard only to the claims of which she then has notice.

GRAY, FRIEND & LONG, solicitors, Warragul 11479/50757

Creditors, next of kin and others having claims in respect of the will of Verdun Denzil Rathjens, late of 27 Westbourne Road, Kensington, retired deceased who died on 16 May 1990 are requested to send particulars of their claims to the executor Lorna May Rathjens, care of the undermentioned solicitor by 14 November 1990, after which date she will distribute the assets having regard only as to the claims of which she then has notice.

JOHN STEWART, solicitor of 290 Racecourse Road, Newmarket 11480/51763

Creditors, next of kin and others having claims in respect of the estate of Winifred Muriel Lynch, late of 8 Tunbridge Street, Flemington, widow deceased intestate who died on 20 July 1990 are requested to send particulars of their claims to the administrator Jean Lillian Lynch, care of the undermentioned solicitor by 14 November 1990, after which date she will distribute the assets having regard only as to the claims of which she then has notice.

JOHN STEWART, solicitor, 290 Racecourse Road, Newmarket 11481/51763

Creditors, next of kin and others having claims in respect of the estate of Thomas Albert Hudson formerly of 12 Ormond Street, Pascoe Vale but late of 4-6 Dundas Street, Avoca, retired deceased intestate who died on 25 April 1990 are requested to send particulars of their claims to the administratrix Elsie Wilma Hudson, care of the

undermentioned solicitor by 14 November 1990, after which date she will distribute the assets having regard only as to the claims of which she then has notice.

JOHN STEWART, solicitor, 290 Racecourse Road, Newmarket 11482/51763

VERONICA LUCY FOWLER, late of 27 Havelock Street, Bendigo, widow, deceased

Creditors, next of kin and others having claims in respect of the estate of the deceased who died on 15 April 1990 are required by William Francis Dole of 22 Graeme Street, Mooroopna and Patricia Margaret Hayes of 27 Havelock Street, Bendigo to send particulars to them by 12 November 1990, after which date the executors may convey or distribute the assets having regard only to the claims of which they then have noticed.

Dated 30 August 1990

O'FARRELL WALTERS & ROBERTSON, solicitors, 74 Pall Mall, Bendigo 11483/51354

Creditors, next of kin and others having claims in respect of the estate of Robert Edward Webster (the Senior), late of 12 Taverner Street, Bacchus Marsh, gentleman, deceased, who died on 11 June 1990 and probate of whose will has been granted to Robert Edward Webster (the Junior) of Werribee Vale Road, Bacchus Marsh, market gardener; Margaret Elizabeth Leith of 10 Stanton Court, Bacchus Marsh and Alice Diane Curtis of Midland Highway, Harcourt, married women, are required to send particulars of their claims to the said executors care of the undermentioned solicitors by 1 October 1990, after which date they will distribute the assets having regard only to the claims of which they then have notice.

PEARCE & WEBSTER, solicitors, 51 Queen Street, Melbourne 11484/52892

LINDEN INA MORSE, late of 1/40 Chaucer Street, St Kilda

Creditors, next of kin and others having claims in respect of the estate of the deceased, who died on 16 May 1990, are required by Perpetual Trustees Victoria Limited of 50 Queen Street, Melbourne, to send particulars of their claims to the said company by 29 October 1990, after which date it will convey or distribute the assets, having regard only to the claims of which the company then has notice.

11494

Creditors, next of kin and other persons having claims against the estate of Alice Irene Dalziel, formerly of 41 Barrington Avenue, Kew in the State of Victoria, but late of Rosden Private Nursing Home, 1 Royton Street, East Burwood in the said State, widow, who died on 31 July 1990 are required by the executors, Robert Arthur Dalziel of 31 Tyrell Street, Box Hill North in the

said State, cabinetmaker and Lindsay John Dalziel of 2 Chessel Street, Box Hill North in the said State, cabinetmaker to send particulars of their claims to them care of the undersigned by 5 November 1990, after which date they may convey or distribute the estate having regard only to the claims of which they then have notice.

JOHN D. MUSTOW & Co., solicitors, 105 Queen Street, Melbourne 11499/51141

Creditors, next of kin and other persons having claims against the estate of Sybil Mary Dawson, formerly of 6 Mackay Avenue, Glenhuntly in the State of Victoria but late of Denbies Private Nursing Home, 1083 Glenhuntly Road, Glenhuntly in the said State, widow who died on 3 August 1990, are required by the executors, Geoffrey John Mustow of 105 Queen Street, Melbourne in the said State, solicitor and Janet Barbara Taylor of 6 Northern Avenue, East Brighton in the said State, teacher to send particulars of their claims to them care of the undersigned by 5 November 1990, after which date they may convey or distribute the estate having regard only to the claims of which they then have notice.

JOHN D. MUSTOW & Co., solicitors, 105 Queen Street, Melbourne 11501/51141

Creditors, next of kin and other persons having claims against the estate of Stoianka Stoicoff, formerly of 54 Wellington Street, Richmond in the State of Victoria but late of 29 Burton Street, Lalor in the said State, widow who died on 12 April 1990, are required by the executrix Spasia Christidis of 29 Burton Street, Lalor in the said State, married woman to send particulars of their claims to her care of the undersigned by 5 November 1990, after which date she may convey or distribute the estate having regard only to the claims of which she then has notice.

JOHN D. MUSTOW & Co., solicitors, 105 Queen Street, Melbourne 11500/51141

KENNETH HAROLD JOHN ALEXANDER, late of 13 Beauville Avenue, Murrumbena, in the State of Victoria, Telecom Linesman, deceased

Creditors, next of kin and others having claims in respect of the estate of the abovenamed deceased who died on 29 January 1990 are to send particulars of their claims to the executrix Frances Elizabeth Scott of 56 Blackwood Street, Carnegie in the said State, married woman, care of the undermentioned solicitors by 30 November 1990, after which date she may convey or distribute the assets of the estate having regard only for the claim of which she then has notice.

BRENNAN & GEORGIU, solicitors, 75 Rosstown Road, Carnegie 11504/52657

Creditors, next of kin and others having claims in respect of the estate of Joan Marian Allen, late of 65 Lisson Grove, Hawthorn, in the State of Victoria, gentlewoman, deceased are required to send particulars of their claims to Judith Evelyn Allen of 18 Plant Street, Malvern and George Huntly Gordon of 140 William Street, Melbourne by 19 November 1990, after which date the executors will distribute the assets of the estate having regard only to the claims of which they shall then have had notice.

BLAKE DAWSON WALDRON, solicitors of 140 William Street Melbourne 11502/51141

HERBERT HENRY LOCK (in the will referred to as Herbert Henry Lock), late of 18 Julius Street, Coburg, retired deceased

Creditors, next of kin and others having claims in respect of the estate of the abovenamed deceased who died on 12 April 1990, are required by the executrix Lucille Lock of 18 Julius Street, Coburg to send particulars to the undermentioned firm by 27 November 1990, after which date the said executrix may convey and distribute the assets having regard only to the claims of which notice has by then been given.

O'HAIRE & O'HAIRE, solicitors of 139 Franklin street, Melbourne 11503/53142

RONALD THOMAS RUSSELL, late of Unit 2, 136 Anderson Street, South Yarra in the State of Victoria, company director, deceased

Creditors, next of kin and others having claims in respect of the estate of the deceased who died on 3 November 1989 are required by the executrix Gwenneth Joy Russell of Unit 2, 136 Anderson Street, South Yarra in the State of Victoria, company director, to send particulars of their claims to her care of the undermentioned solicitor by 7 November 1990, after which date she will distribute the assets having regard only to the claims for which notice has been received.

Dated 28 August 1990

V. F. KIESSLING, solicitor, 125 Swanston Street, Melbourne 11415/50962

JOSEPH DANIEL O'REILLY, late of 318A Buckley Street, Essendon, gentleman, deceased

Creditors, next of kin and others having claims in respect of the estate of the abovenamed deceased who died on 27 June 1990 are to send particulars of their claims to the executor Kevin Joseph O'Reilly, care of the undermentioned solicitors by 9 November 1990, after which date the said executor will distribute the assets having regard only to the claims of which he then has notice.

O'BRIEN & GALANTE, solicitors, 27 Norwood Crescent, Moonee Ponds 11417/51349

2718 G 35 5 September 1990

OLIVER COMERFORD DEMPSEY, late of 48 Through Road, Burwood in the State of Victoria, pensioner, deceased

Creditors, next of kin and others having claims in respect of the estate of the abovenamed deceased (who died on 8 June 1990) are required to send particulars of their claims to the Executor, National Mutual Trustees Limited of 419 Collins Street, Melbourne (formerly and in the will described as National Trustees Executors and Agency Company of Australasia Limited of 95 Queen Street, Melbourne) on or before 8 November 1990, after which date the executor National Mutual Trustees Limited will distribute the assets of the said deceased having regard only to the claims of which it shall then have had notice.

PETER HASSETT & CO., solicitors of 1156 Toorak Road, Hartwell 11416/52086

Creditors, next of kin and others having claims in respect of the estate of Gordon Kirkpatrick Cornish late of Flat 9, 13 Elm Grove, McKinnon in the State of Victoria, retired gentleman deceased who died on 19 February 1990, are to send particulars of their claims to Shirley Elizabeth Maroney of 72 River Road, Greenwich in the State of New South Wales and Julie Doquile of 13 Dendy Street, Brighton in the State of Victoria care of the undermentioned solicitors by 5 November 1990, after which date they will distribute the assets having regard only to the claims to which they then have notice.

REGINALD C. BUTLER & CO., barristers and solicitors, 312 Centre Road, Bentleigh 11418/50272

PHYLLIS MARY RITTER, late of 3 Canyon Street, Balwyn in the State of Victoria, home duties, deceased

Creditors, next of kin and others having claims in respect of the estate of the deceased (who died on 3 July 1990) are required by the executor Werner Kurt Ritter of 2 Canyon Street, Balwyn, company director, to send particulars to him care of the undersigned on or before 15 November 1990, after which date he will distribute the assets having regard only to the claims of which he then has notice.

BAYLOR & CO., solicitors, 1 Walkers Road, Nunawading 11430/52086

Creditors, next of kin and others having claims in respect of the estate of Eric Raymond Grellis, late of Bethlehem Home for the Aged, Taylor Street, Golden Square, retired chartered accountant deceased who died on 9 April 1990 are required to send particulars of their claims to the executor National Mutual Trustees Limited of 46 Queen Street, Bendigo by 31 October 1990,

*Victoria Government Gazette*

after which date the company will distribute the assets having regard only to the claims of which the company has notice.

COHEN JOHANSON ROBERTSON of Victoria Chambers, Pall Mall, Bendigo, solicitors to the estate 11435/51384

CHARLES KENNETH MORRIS, late of 24-26 Dellas Road, Templestowe in the State of Victoria, retired, deceased

Creditors, next of kin and others having claims in respect of the estate of the deceased who died on 16 May 1990 are requested to send particulars of their claims to the executrix Merlyn June (also known as Merle Linda) Morris c/- the undersigned solicitors by 7 November 1990, after which date the said executrix will proceed to distribute the estate having regard only to the claims of which she then has notice.

READ KELLY, solicitors, 555 Lonsdale Street, Melbourne 11434/52270

MARIE THERESE RITA MONNIER (also known as Rita Monnier), late of 1162 Toorak Road, Hartwell in the State of Victoria, clerk, deceased intestate

Creditors, next of kin and others having claims in respect of the estate of the abovenamed deceased (who died on 1 October 1987) are required by the administrator of the estate National Mutual Trustees Limited of 419 Collins Street, Melbourne in the said State to send particulars of their claims to the said National Mutual Trustees Limited of 419 Collins Street, Melbourne on or before 11 November 1990, after which date the said administrator will distribute the assets of the said deceased having regard only to the claims of which it shall then have had notice. 11463/51141

JESSIE BAIRD SIMPSON-BILBEREISEN, late of 423 Camberwell Road, Camberwell in the State of Victoria, retired medical practitioner, deceased

Creditors, next of kin and others having claims in respect of the estate of the deceased who died on 9 June 1990 are required by the personal representatives, Donald Ledingham Cooper and Kenneth David James Barry, both of 385 Bourke Street, Melbourne to send particulars to them by 5 November 1990 after which date the personal representatives may convey or distribute the assets having regard only to the claims of which they then have notice.

SLY & WEIGALL, of 385 Bourke Street, Melbourne, solicitors for the estate 11464/51141

Creditors, next of kin and others having claims in respect of the estate of Alexander Lewis, late of 44 Beaconsfield Parade, Croxton, retired fitter, who died on 29 November 1989, are to send the

particulars of their claims to The Equity Trustees Executors and Agency Company Limited of 472 Bourke Street, Melbourne within two (2) months of the publication of this notice, after which date it will distribute the assets having regard only to the claims of which it then has notice.

HUNT & HUNT, solicitors of 459 Collins Street, Melbourne 11466/51141

GEORGE WILLIS, late of Flat 15, 330 Riversdale Road, East Hawthorn, in the State of Victoria, retired farmer, deceased

Creditors, next of kin and others having claims in respect of the estate of the abovenamed deceased (who died on 28 June 1990), are required by the executor, Robert Ernest James, of 8 Seach Street, South Caulfield in the said State, bank manager, to send particulars to him care of the undermentioned solicitors by 7 November 1990, after which date the executor may convey or distribute the assets having regard only to the claims of which he then has notice.

M. V. FERN & ASSOCIATES, solicitors, 503 Hampton Street, Hampton 11465/51141

Creditors, next of kin and others having claims in respect of the estate of Bernard Payne late of 29 Heathfield Road, Brighton East in the State of Victoria, Catholic Priest, deceased who died on 22 May 1990 are requested to send particulars of their claims to the executors, National Mutual Trustees Limited and Kevin Francis Mackin, care of the company's registered office, 419 Collins Street, Melbourne by 7 November 1990, after which date the executors will distribute the assets having regard only to the claims of which they then have notice.

PETER J. WALSH & JOHN F. CARROLL, solicitors, 83 William Street, Melbourne

11467/51141

Creditors, next of kin and others having claims in respect of the estate of June Hall, late of 2 Gascoyne Street, Canterbury, widow who died on 27 June 1990 are to send particulars of their claims to Douglas Newton Hall the executor care of the undersigned by 7 November 1990, after which date he will commence to distribute the assets having regard only to the claims of which he then has notice.

RENNICK & GAYNOR, solicitors of 431 Riversdale Road, Hawthorn East 11468/51141

Creditors, next of kin and others having claims in respect of the estate of Hazel May Ponton, late of 69 Thames Promenade, Chelsea, widow deceased who died on 5 July 1990 are requested to send particulars of their claims to the executor Kenneth Richard Dingle care of the undermentioned solicitors on or before 6 November 1990, after which date he will

distribute the assets having regard only to the claims of which he then has notice.

McKEAN & PARK, solicitors of 405 Little Bourke Street, Melbourne 11469/51141

Creditors, next of kin and others having claims in respect of the will of Marianna Spataro (also known as Anna Spataro) late of 31 Huxtable Avenue, Brooklyn, widow deceased who died on 9 May 1990 are requested to send particulars of their claims to the executor Gaetano Spataro care of the undermentioned solicitor by 20 November 1990, after which date he will distribute the assets having regard only to the claims of which he then has notice.

EDWARD CURMI, solicitor, 440 Victoria Street, North Melbourne 11470/50434

Creditors, next of kin and others having claims in respect of the estate of Sylvia Irene Swan, late of 7 Admans Avenue, Seaford, widow, deceased, who died on 23 March 1986 are to send particulars of their claims to The Equity Trustees Executors and Agency Company Limited of 472 Bourke Street, Melbourne by 13 November 1990, after which date it will distribute the assets having regard only to the claims of which it then has notice.

EALES & MACKENZIE, solicitors, 114-116 Main Street, Lilydale 11475/50606

Creditors, next of kin and others having claims in respect of the estate of Kathleen O'Halloran, late of "Marymeade", Bellarine Highway, Moolap, home duties, deceased, who died on 22 May 1990 are required to send particulars of their claims to the executrix Sibina Mary O'Halloran, care of the undersigned solicitors before 7 November 1990, after which date the assets of the estate will be distributed having regard only to the claims of which the executrix then has notice.

HARWOOD & PINCOTT, solicitors, 83 Moorabool Street, Geelong 11476/50808

OLIVE JANET SPRING, formerly of 20 Millicent Avenue, North Balwyn in the State of Victoria, but late of Ward 3, Swan Hill and District Hospital Nursing Home, Splatt Street, Swan Hill in the said State, widow, deceased, who died on 21 June 1990

Creditors, next of kin and all other persons having claims against the estate of the deceased are required by the executor of the will, Eric John Spring to send particulars to him care of the undersigned on or before 31 October 1990, after which date he will distribute the assets having regard only to the claims of which he then has notice.

GARDEN & GREEN, solicitors, 4 McCallum Street, Swan Hill 11477/50699



2720 G 35 5 September 1990

RONALD LESLIE ANDREWS, formerly of 134 High Street, Glen Iris, but late of 2 Thomas Street, Drouin, retired, deceased

Creditors, next of kin and others having claims in respect of the estate of the deceased, who died on 18 May 1990 are required by the trustee Marion Grace Genoni to send particulars of their claims to her care of the undersigned solicitors by 9 November 1990, after which date the trustee may convey or distribute the assets having regard only to the claims of which she then has notice.

GRAY, FRIEND & LONG, solicitors,  
Warragul 11478/50757

The Supreme Court of the State of Victoria  
SALE BY THE SHERIFF

On 18 October 1990 at 2.30 p.m. at the Sheriff's Office, 287 Springvale Road, Glen Waverley (unless process be stayed or satisfied).

All the estate and interest (if any) of Austin Shirreff of Lot 34, No. 90 Palmers Road, Sunbury shown on Certificate of Title as Austin Douglas Shirreff as joint proprietor with Esther Mary Shirreff of an estate in fee simple in the land described on Certificate of Title Volume 8865 Folio 806 upon which is erected a brick dwelling and comprises approximately 22 acres and is situated 10.5 kms north west of the Sunbury township and known as Lot 34, No. 90 Palmers Road, Sunbury.

Registered Mortgages Nos. N252269C and P292375F affect the said estate and interest.

Terms—Cash only

11450/51141 H. BUETTNER  
Sheriff's Officer

The Supreme Court of the State of Victoria  
SALE BY THE SHERIFF

On 11 October 1990 at 2.30 p.m. at the Sheriff's Office, 287 Springvale Road, Glen Waverley (unless process be stayed or satisfied).

All the estate and interest (if any) of Jeffrey Daft of 69 Liston Avenue, Keon Park shown on Certificate of Title as Jeffrey Alan Daft as joint proprietor with Nicola Denise Daft of an estate in fee simple in the land described on Certificate of Title Volume 6987 Folio 204 upon which is erected a dwelling known as 69 Liston Avenue, Keon Park.

Registered Mortgages Nos. N543628B and P389983D affect the said estate and interest.

Terms—Cash only

11451/51141 H. BUETTNER  
Sheriff's Officer

Victoria Government Gazette

The County Court of the State of Victoria  
SALE BY THE SHERIFF

On 19 October 1990 at 2.30 p.m. at the Court House, Mildura (unless process be stayed or satisfied).

All the estate and interest (if any) of Graeme Bernard Muir and Kay Marlene Muir, both of 12 Wolverton Avenue, Chipping Norton, N.S.W. shown on Certificate of Title as Graham Bernard Muir and Kaye Marlene Muir as the joint proprietors of an estate in fee simple in the land described on Certificate of Title Volume 8755 Folio 564 upon which is erected a conite dwelling known as 2000 Fourteenth Street, Irymple.

Registered Mortgages Nos. H429304 and N264521J affect the said estate and interest.

Terms—Cash only

11452/51141 H. BUETTNER  
Sheriff's Officer

The Supreme Court of the State of Victoria  
SALE BY THE SHERIFF

On 16 October 1990 at 2.30 p.m. at the Police Station, Colac (unless process be stayed or satisfied).

All the estate and interest (if any) of Peter Papafotis of Beech Forest Road, Barongarook as joint proprietor with Viki Papafotis of an estate in fee simple in the land described on Certificate of Title Volume 8550 Folio 984 upon which is erected a dwelling. The said property is situated 7 to 8 miles south of Colac, on the Beech Forest Road.

Registered Mortgages Nos. K552960 and N808403J affect the said estate and interest.

Terms—Cash only

Dated 5 September 1990

11453/51141 H. BUETTNER  
Sheriff's Officer

The Supreme Court of the State of Victoria  
SALE BY THE SHERIFF

On 18 October 1990 at 2.30 p.m. at the Sheriff's Office, 287 Springvale Rd, Glen Waverley (unless process be stayed or satisfied).

All the estate and interest (if any) of Donald Beggs of Unit 3, 29 Muir Street, Hawthorn as proprietor of an estate in fee simple in the land described in Certificate of Title Volume 9222 Folio 300 upon which is erected a double-storey brick unit known as Unit 3, 29 Muir Street, Hawthorn.

Registered Mortgages Nos. N90163C and M142594Q affect the said estate and interest.

Terms—Cash only

11446/51141 H. BUETTNER  
Sheriff's Officer

*Victoria Government Gazette*

The Supreme Court of the State of Victoria  
SALE BY THE SHERIFF

On 17 October 1990 at 2.30 p.m. at the Sheriff's Office, Ballarat Court Annex, Camp Street, Ballarat (unless process be stayed or satisfied).

All the estate and interest (if any) of Noel Hayes and Yvonne Hayes of RMB 372 Main Road, Ross Creek, shown on Certificate of Title as Noel Rodger Hayes and Yvonne Maree Hayes as joint proprietors of an estate in fee simple in the land described on Certificate of Title Volume 8353 Folio 065 upon which is erected a weatherboard dwelling and sheds. The said property is situated 500 metres west from the corner of Nicols and Buninyong Roads, Ross Creek.

Registered Mortgages Nos. N116785S and P568021P affect the said estate and interest.

Terms—Cash only

11454/51141

H. BUETTNER  
Sheriff's Officer

*G 35 5 September 1990 2721*

The land described has a width of 2.74 metres and a depth of 100.58 metres in a northerly direction.

Terms—Cash only

11449/51141

H. BUETTNER  
Sheriff's Officer

The Supreme Court of the State of Victoria  
SALE BY THE SHERIFF

On 18 October 1990 at 2.30 p.m. at the Sheriff's Office, 287 Springvale Road, Glen Waverley (unless process be stayed or satisfied).

All the estate and interest (if any) of Paul Niebling and Donna Crawley of 7 Geraldine Street, Rye, shown on Certificate of Title as Paul Andrew Niebling and Donna Lyn Niebling as joint proprietors of an estate in fee simple in the land described on Certificate of Title Volume 9185 Folio 770 upon which is erected a dwelling known as 7 Geraldine Street, Rye.

Registered Mortgages Nos. P337724N and P337725K and Caveat No. P572538R affect the said estate and interest.

Terms—Cash only

11447/51141

H. BUETTNER  
Sheriff's Officer

The Supreme Court of the State of Victoria  
SALE BY THE SHERIFF

On 18 October 1990 at 2.30 p.m. at the Police Station, Tatura (unless process be stayed or satisfied).

All the estate and interest (if any) of Meryem Anil of 15 Hunter Street, Tatura as joint proprietor with Musa Anil (A Bankrupt) and the Official Trustee in Bankruptcy of an estate in fee simple in the land described on Certificate of Title Volume 9345 Folio 361 known as 249 Hogan Street, Tatura. The only improvement upon the land is the neighbouring dwelling encroaches upon the land.

2722 G 35 5 September 1990

**NOTICE OF MAKING OF  
STATUTORY RULES  
WHICH ARE NOT YET  
AVAILABLE**

Notice is given of the making of the following  
Statutory Rules:

232/1990 *Supreme Court Act 1986*  
Solicitors' Remuneration  
Order (No. 2) 1990

233/1990 *Road Safety Act 1986*  
Road Safety (Registration  
Fees) Regulations 1990

234/1990 *Dried Fruits Act 1958*  
Dried Fruits  
(Amendment)  
Regulations 1990

235/1990 *Barley Marketing Act 1958*  
Barley Marketing  
(Elections)  
(Amendment)  
Regulations 1990

236/1990 *Wheat Marketing Act 1989*  
Wheat Marketing  
(Prescribed Provisions)  
Regulations 1990

237/1990 *Wildlife Act 1975*  
Wildlife (General)  
(Amendment)  
Regulations 1990

238/1990 *Fisheries Act 1968*  
Commercial Fishing  
Licences (Amendment)  
Regulations 1990

239/1990 *Pharmacists Act 1974*  
Pharmacists (Members'  
Fees) (No. 2)  
Regulations 1990

240/1990 *Health Act 1958*  
Health (Proprietary  
Medicines) (Members'  
Fees) (No.2)  
Regulations 1990

*Victoria Government Gazette*

*Professional Boxing  
Control Act 1985*

241/1990 Professional Boxing  
Control (Amendment)  
Regulations 1990

*Nurses Act 1958*

242/1990 Nursing Council  
(Examiners' Fees)  
Regulations 1990

**NOTICE OF MAKING  
AND AVAILABILITY OF  
STATUTORY RULES**

In pursuance of the provisions of the *Subordinate Legislation Act 1962* and the Regulations made thereunder notice is given of the making and availability of the following Statutory Rules:

Note: The date specified after each Statutory Rule is the date it was first obtainable from—  
VGPO Mail and Bulk Order Sales  
66-112 Macaulay Rd, North Melbourne, 3051  
Tel: 320 0201

	<i>Administrative Appeals Tribunal Act 1984</i>				
	<i>Planning Appeals Act 1980</i>				
	<i>Planning and Environment Act 1987</i>				
216/1990	Administrative Appeals Tribunal (Planning Appeals) (Amendment) Regulations 1990				
3 September 1990		Code 1			
	<i>Medical Practitioners Act 1970</i>				
217/1990	Medical Practitioners (Members' Fees) (No. 2) Regulations 1990				
3 September 1990		Code 1			
	<i>Health Act 1958</i>				
218/1990	Radiation Advisory Committee and Radiographers and Radiation Technologists Registration Board (Members' Fees) (Amendment No. 2) Regulations 1990				
3 September 1990		Code 1			
	<i>Physiotherapists Act 1978</i>				
219/1990	Physiotherapists (Members' Fees) Regulations 1990				
3 September 1990		Code 1			
	<i>Dentists Act 1972</i>				
220/1990	Dentists (Members' Fees) Regulations 1990				
3 September 1990		Code 1			
	<i>Dental Technicians Act 1972</i>				
221/1990	Dental Technicians (Members' Fees) Regulations 1990				
3 September 1990		Code 1			
	<i>Health Services Act 1988</i>				
222/1990	Health Services (Community Health Centre Elections) (Amendment) Regulations 1990				
3 September 1990		Code 1			
	<i>Racing Act 1958</i>				
223/1990	Racing (Bookmakers, Bookmakers' Clerks and Bookmakers' Course Agents Registration) (Fees Amendment) Regulations 1990				
3 September 1990		Code 1			
	<i>Lotteries Gaming and Betting Act 1966</i>				
224/1990	Lotteries Gaming and Betting (Raffles and Bingo Permits) (Fees Amendment) Regulations 1990				
3 September 1990		Code 1			
	<i>Racing Act 1958</i>				
225/1990	Racing (Greyhound Racing Control Board) (Fees Amendment) Regulations 1990				
3 September 1990		Code 1			
	<i>Racing Act 1958</i>				
226/1990	Racing (Greyhound Racing Grounds Development Board) (Fees) (Amendment) Regulations 1990				
3 September 1990		Code 1			
	<i>Racing Act 1958</i>				
227/1990	Racing (Harness Racing Board) (Fees Amendment) Regulations 1990				
3 September 1990		Code 1			

2724 G 35 5 September 1990

*Racing Act 1958*

228/1990 Racing (Racecourses  
Licences Board) (Fees)  
(Amendment)  
Regulations 1990

3 September 1990 Code 1

*Racing Act 1958*

229/1990 Racing (Racing Appeals  
Tribunal) (Fees)  
Amendment)  
Regulations 1990

3 September 1990 Code 1

*Racing Act 1958*

230/1990 Racing (Totalizator  
Agency Board) (Fees)  
(Amendment)  
Regulations 1990

30 August 1990 Code 1

*Public Service Act 1974*

PSD 26/1990 Public Service  
Determinations (No.  
26) 1990

Code 1

*Public Service Act 1974*

PSD 27/1990 Public Service  
Determinations (No.  
27) 1990

Code 2

Price Code	No. of Pages (Including cover and blank pages)	Price
1	1-4	\$0.45
2	5-8	\$0.80
3	9-12	\$1.10
4	13-16	\$1.60
5	17-24	\$1.90
6	25-32	\$2.40
7	33-40	\$2.70
8	41-48	\$3.00
9	49-56	\$3.40
10	57-64	\$3.70
11	65-72	\$4.00
12	73-80	\$4.25
13	81-88	\$4.70
14	89-96	\$5.10
Each additional 16 pages or part thereof		\$0.67

Victoria Government Gazette

*Victoria Government Gazette*

*G 35 5 September 1990 2725*

**CONTENTS**

	Page
Contracts	2687
Contracts Accepted—Amendments	2695
Estates of Deceased Persons	2697
Government Notices	2682
Melbourne and Metropolitan Board of Works	2682
Notice of Making of Statutory Rules	2722
Orders in Council— Acts—Historic Buildings; Water; Crown Land (Reserves)	2699
Private Advertisements	2705
Proclamations	2680
Rural Water Commission	2700
Tenders	2704

A Victorian Government Publication

Published by VGPO  
Melbourne Victoria Australia  
© State of Victoria 1990

This publication is copyright. No part may be reproduced  
by any process except in accordance with the provisions  
of the Copyright Act.

Address all inquiries to the Government Printer  
for the State of Victoria  
PO Box 203 North Melbourne 3051 Victoria Australia  
ISSN 0819—5471

Jean Gordon Government Printer Melbourne

**Counter Sales**

Information Victoria Bookshop  
318 Lt. Bourke Street Melbourne 3000  
Telephone inquiries (03) 651 4100  
Fax (03) 651 4111

**Mail and Bulk Order Sales**

VGPO  
PO Box 203 North Melbourne 3051  
66–112 Macaulay Road North Melbourne 3051  
Telephone inquiries (03) 320 0201

**Recommended Retail Price \$1.20**

# VICTORIA GOVERNMENT G A Z E T T E

No. G 36 Wednesday 12 September 1990

By Authority Jean Gordon Government Printer Melbourne

**GENERAL**

## Gazette Services

The *Victoria Government Gazette* (VGG) is published by VGPO for the State of Victoria and is produced in three editions.

**VGG General** is published each Wednesday and provides information regarding Acts of Parliament and their effective date of operation; Government notices; requests for tenders; as well as contracts and contracts accepted. Private notices are also published.

**VGG Special** is published any day when required for urgent or special Government notices. VGG Special is made available automatically to subscribers of VGG General.

**VGG Periodical** is published on Monday when required and includes specialised information eg. Medical, Dental, Pharmacist's Registers, etc.

## Government Advertising

### Publishing Details

The following Guidelines should be followed to ensure publication of Government material in the *Victoria Government Gazette*.

- Duplicate copies should be submitted for use by the Gazette Officer.
- Material submitted to the Executive Council for gazettal will normally be published in the following week's issue.
- Where urgent gazettal is required, contact:  
Gerd Gaspar  
Gazette Officer  
Department of the Premier and Cabinet  
Ground Floor 1 Treasury Place  
Melbourne 3000  
Telephone Inquiries (03) 651 5153
- Government advertising other than material for the consideration of the Executive Council should be forwarded to the Gazette Office no later than 9.30 am on Tuesday.
- Lengthy or complicated notices should be forwarded several days before publication.
- Proofs will be supplied only when requested or at the direction of the Gazette Officer.
- No additions or amendments to material for publication will be accepted by telephone.
- Double rates for advertising in the Special Gazette will apply.

## Private Advertising

### Publishing Details. Send copy to:

VGG Coordinator  
Gazette Advertising  
VGPO  
66-112 Macaulay Road  
North Melbourne  
(PO Box 203 North Melbourne 3051)  
Telephone inquiries (03) 320 0100  
Fax No. (03) 328 1657

### Advertising Rates and Payment

Single column × cm/part cm \$4.10  
Double column × cm/part cm \$8.20  
Full page \$171.50

Cheques should be made payable to 'VGPO'.  
These rates apply to advertisements printed on or after 14 February 1990.

### Advertisers should note:

- There are approximately 20 words to each column centimetre depth.
- Signatures (in particular) and proper names must also be in block letters.
- All material should be double spaced.
- Advertisements can be faxed, and a cover sheet should be used, marked to the attention of the Gazette Coordinator.
- Documents not clearly prepared and in the exact format for gazettal will be returned to the sender unpublished.
- Late copy received at VGPO after 11.00 am Tuesday will be placed in the following issue of VGG, irrespective of any date/s mentioned in the copy (unless otherwise advised).

### Copy Deadline

11.00 am Tuesday

## Subscriptions

VGG is available by three subscription services:

General and Special—\$118.00 each year

General, Special and Periodical—\$136.00 each year

Periodical—\$71.00 each year

Subscriptions are payable in advance and accepted for a period of one year. All subscriptions are on a firm basis and refunds for cancellations will not be given.

All payments should be made payable to VGPO.

Subscription inquiries (03) 320 0217

Bookshop inquiries (03) 651 4100

Fax (03) 651 4111