



Victoria Government Gazette

No. G 47 Thursday 24 November 1994

GENERAL

PUBLICATION OF THE "VICTORIA GOVERNMENT GAZETTE"

Christmas/New Year Period

The Victoria Government Gazette for the remainder of 1994 will be published on Thursdays as usual except for the period between Christmas and New Year's Day.

There will not be a Government Gazette published on 29 December 1994 and 5 January 1995. The first issue of the Gazette for 1995 will be published on Thursday, 12 January 1995, and thereafter on each Thursday.

Where urgent Gazettal is required on days other than those mentioned above, special arrangements should be made with Kathy Wilson, Acting Clerk of the Executive Council, Department of the Premier and Cabinet, Level 13, West Tower, 55 Collins Street, Melbourne 3000. Telephone: (03) 651 5149.

KAREN GUST
Gazette Officer

P.P.S.V.
The Law Printer
South Melbourne
24 November 1994

PLEASE NOTE

The last Gazette for 1994, dated 22 December 1994, will be closing on Monday, 19 December 1994, at 9.30 a.m.

GENERAL GAZETTE

Copy to: Karen Gust, Government Gazette Officer
THE LAW PRINTER
 28 Queensbridge Street, South Melbourne
 (PO Box 292 South Melbourne 3205)
 DX19, Melbourne
 Telephone inquiries (03) 242 4605
 Fax No. (03) 242 4630 only.

Advertising Rates and Payment**Private Notices**

Payment must be received in advance with advertisement details.

30 cents per word—Full page \$180.00

An additional cost must be included in prepayment if a copy of the gazette is required. Cheques should be made payable to The Law Printer.

Government and Outer Budget Sector Notices

Not required to pre-pay

Advertisements must be faxed, and a cover sheet should be used, marked to the attention of the Gazette Coordinator.

Single column x cm/part cm \$2.65

Double column x cm/part cm \$5.30

Full page \$111.00

Copy Deadline: 11.00 a.m. Monday—(Private)

9.30 a.m. Tuesday—(Government and Outer Budget Sector)

Copy Prices—Page

—Certified	\$1.50
—Gazette	\$3.50
	\$3.20

(All prices include Postage)

Advertisers should note:

- Late copy received at **THE LAW PRINTER** after deadlines will be placed in the following issue of VGG, irrespective of any date/s mentioned in the copy (unless otherwise advised).

- Proofs will be supplied only when requested or at the direction of the Gazette Officer.

- No additions or amendments to material for publication will be accepted by telephone.

- Departments are requested not to lodge Executive Council papers for gazette unless a copy is provided with the Governor or Clerks signature on the relevant document.

- Government and Outer Budget Sector Agencies Please note:

To ensure that material received can be reproduced, and that errors are minimised, the following guidelines are to be observed when submitting material by fax.

Fax Number (03) 242 4630

Use this fax number only for material for the Government Gazette.

Fax resolution

Material sent by fax should be transmitted using Fine resolution (200 dots per inch by 200 dpi). Normal resolution is unacceptable.

Font Size

Use 12 point (10 pitch) or larger.

Font Style

Clear plain font styles, such as Helvetica, should be used.

Graphics

Line drawings should be transmitted as large as possible to ensure clarity. Drawings up to A4 size sent by fax using Fine resolution provide a good quality for reproduction.

Avoid

Italics, underlining, and full justification.

Ensure document is square when sending

Documents that are sent skewed are difficult to read and process.

If material does not meet above requirements your advertisement may not be published.

PERIODICAL AND SPECIAL GAZETTES

Copy to: Juanita Frantz, Legislative Officer
THE LAW PRINTER
 28 Queensbridge Street, South Melbourne
 (PO Box 292 South Melbourne 3205)
 DX19, Melbourne
 Telephone inquiries (03) 242 4610
 Fax No. (03) 242 4630 only.

Advertising Rates and Payment**Private Notices**

Periodical Gazette	Special Gazette
Full page \$180.00	Full page \$360.00

Payment must be received in advance with notice details.

Government and Outer Budget Sector

Periodical Gazette	Special Gazette
Full page \$115.50	Full page \$233.00

RETAIL SALES AND SUBSCRIPTIONS

Copies of the Victorian Government Gazette can be purchased from the **THE LAW PRINTER** over the counter, by mail or via subscription.

Over the counter sales can be made at 28 Queensbridge Street, South Melbourne. Mail orders with accompanying payment can be directed to PO Box 292, South Melbourne 3205.

VGG is available by three subscription services:

General and Special—\$165.00 each year

General, Special and Periodical—\$220.00 each year

Periodical—\$110.00 each year

Subscriptions are payable in advance and accepted for a period of one year. All subscriptions are on a firm basis and refunds for cancellations will not be given.

All payments should be made payable to **THE LAW PRINTER**. Subscription inquiries (03) 242 4600, Mail Order inquiries (03) 242 4600, Fax (03) 242 4699.

INDEX TO PRIVATE ADVERTISERS

A		W	
A. B. Natoli Pty	3088	White Cleland Pty.	3091
A. E. Ellinghaus & S. L. Weill	3092	Whyte Just & Moore	3088
Aitken Walker & Strachan	3088	Wright Smiths	3087
Alan P. Burnes	3090		
Armstrong Collins and Delacy	3088		
Arthur Robinson & Hedderwicks	3090		
B		Y	
B. M. Caulfield	3089	Young Hubbard & Co.	3089
Beck Sheahan Quinn & Kirkham	3089, 3090		
Belbridge Hague	3092		
Bowman Knox & Payne	3088, 3090		
C			
Corrs Chambers Westgarth	3091		
D			
De Marco & Co	3087		
Dunhill Madden Butler	3091		
F			
Fredk. Shillabeer Indovino & Co.	3092		
G			
Gordon P. Jacobs	3088, 3090		
Gray, Friend & Long	3092		
H			
H. S. W. Lawson & Co.	3092		
Henderson & Ball	3090		
J			
John D. Mustow & Co.	3091		
John Stewart	3089, 3090		
K			
Kelsen Sierakowski	3089		
M			
McKay Willis	3087		
Morrison & Sawyers	3089		
N			
National Mutual Trustees Limited	3091		
Nicholas Diamantopoulos	3087		
P			
Peter Anthony Wynne	3087		
Peter J. Walsh & John F. Carroll	3091		
Phillip James Ward	3087		
Political Reference Service	3087		
S			
Septimus Jones & Lee	3092		
Sly & Weigall	3091		
Sunraysia Water Board	3086		
Swan Hill Water Board	3086		

PRIVATE ADVERTISEMENTS

SUNRAYSIA WATER BOARD

Notice of Declaration of Served Properties

Take notice that under section 144 of the **Water Act 1989**, the Sunraysia Water Board declares that the lands as described below are declared to be serviced properties for the purposes of the **Water Act 1989**.

The service available to the land is water reticulation.

The respective water reticulation areas herein referred to shall be known—

Water Reticulation Area Numbers

- | | | |
|-----------|---|--|
| 30.02.411 | Sheridan Crescent, Nursery Ridge Road | P.S. 3299080R Lots 1 to 4 Lots 11 and 12 |
| 30.02.430 | Twelfth Street | P.S. 333490W Lots 1 to 28 |
| 30.02.432 | Mahogany Drive, Ashwood Court, Ascot Court, Walnut Avenue | P.S. 330727H Lots 1 to 37 |
| 30.02.433 | Explorer Drive, San Mateo Avenue | P.S. 338780K Lots 5 to 9 and Lots 69 to 75 |
| 30.02.434 | Eleventh Street, Flora Avenue | P.S. 336697G Lots 2, 3, 4 and 5 |

The boundaries of the said water reticulation area number (as shown) is delineated on a plan which may be inspected at the Office of the Sunraysia Water Board.

Signed under the seal of the Sunraysia Water Board.

Dated 16 November 1994

B. J. GROGAN, Secretary
R. F. McKENDRICK, Member
S. DICHIERA, Member

SWAN HILL WATER BOARD

Extension of the Lake Boga Urban Water District of the Swan Hill Water Board

In accordance with section 96 (2) (b) of the **Water Act 1989**, the Swan Hill Water Board is proposing to extend the Lake Boga Urban Water District in order to service the area up to and including Hayes Road, Lake Boga.

Submissions on the proposal are invited and further information can be obtained from the Engineering Department at the Municipal Offices, Nyah Road, Swan Hill.

Submissions should set out grounds for any objection raised in it and must be received by the Authority, within one (1) month after the publication of the notice in the Government Gazette, being 28 December 1994.

FRANK D. SMITH
Engineer

within the sewerage area hereinafter described doth hereby declare that on or after 1 November 1994, each and every property which or any part of which is within the said sewerage area shall be deemed and taken to be sewered property under the provisions of section 144 of the **Water Act 1989**.

The respective sewerage area hereinbefore referred to shall be known as:

Sewerage Area Numbers

- 30.02.423S Mildura Dunning Drive, Renee Court, Kane Drive

The boundaries of the said sewerage area numbers (as above) are delineated on various plans which may be inspected at the Office of the Sunraysia Water Board.

Signed under the seal of the Sunraysia Water Board.

Dated 16 November 1994

B. J. GROGAN, Secretary
R. F. McKENDRICK, Member
S. DICHIERA, Member

SUNRAYSIA WATER BOARD

Notice of Declaration of Sewered Properties

The abovementioned Board having made provision for carrying off the sewage from each and every property which or any part of which is

POLITICAL REFERENCE SERVICE

For a complimentary copy of PRS' VICTORIA BILL TRACKER which summarises progress of all State legislation—and details of PRS' comprehensive and same day coverage of the Victorian Parliamentary and political scene—contact our office phone (03) 654 8177 fax (03) 654 8902.

**NOTICE OF DISSOLUTION OF
PARTNERSHIP**

Notice is hereby given that the partnership previously subsisting between Nicholas Diamantopoulos, Peter Anthony Wynne and Phillip James Ward carrying on business as garlic shoot producers at 16 Cawkwell Street, Malvern in the State of Victoria, Koraleigh in the State of New South Wales and Swanpool in the State of Victoria, under the firm name Spring Garlic Shoots and the registered business names Australian Garlic Products and Green Garlic Shoots has been dissolved as from 31 August 1994.

Dated 14 November 1994

NICHOLAS DIAMANTOPOULOS

ELSIE BEATRICE SHEILA PHELAN, late of Unit 1, 198 Bluff Road, Sandringham, Victoria, widow, deceased

Creditors, next of kin and others having claims in respect of the estate of the deceased, who died on 19 August 1994, are required by The Equity Trustees Executors and Agency Company Limited of 472 Bourke Street, Melbourne to send particulars of their claim to the said company by 26 January 1995, after which date it will convey or distribute the assets having regard only to the claims of which the company then has notice.

McKAY WILLIS, solicitors, 25 North Concourse, Beaumaris

FLORENCE ADAH BRYANT, late of Sherbrooke Private Nursing Home, 18 Torana Avenue, Upper Ferntree Gully, home duties, deceased

Creditors, next of kin and others having claims in respect of the deceased, who died on 25 August 1994, are required by the personal representative Harry Frank Wellington of 18 Somers Avenue, McCrae to send particulars to him care of the undermentioned solicitors by 18

January 1995, after which date the personal representatives may convey or distribute the assets having regard only to the claims of which they then have notice.

WRIGHT SMITHS, solicitors, 2 Seventh Avenue, Rosebud

JOHN HENRY CASEY, late of Dromana Private Nursing Home, Nepean Highway, Dromana, retired, deceased

Creditors, next of kin and others having claims in respect of the deceased, who died on 28 October 1994, are required by the personal representatives Kim Syme Price and Geoffrey Robert Nicholson of 2 Seventh Avenue, Rosebud to send particulars to them care of the undermentioned solicitors by 15 January 1995, after which date the personal representatives may convey or distribute the assets having regard only to the claims of which they then have notice.

WRIGHT SMITHS, solicitors, 2 Seventh Avenue, Rosebud

Creditors, next of kin and others having claims in respect of the estate of Henry Thomson, late of 41 The Esplanade, Bargara, Queensland, welder, deceased, who died on 15 August 1994, are required by the executrix Mary Helena Thomson, widow of 41 The Esplanade, Bargara, Queensland to send particulars of their claims to the said executrix care of the undermentioned solicitors by 11 January 1995, after which date the said executrix will convey or distribute the assets of the deceased having regard only to the claims of which the said executrix then has notice.

DE MARCO & CO, solicitors, 209 Glenroy Road, Glenroy

ANNIE LILLIAN SCOTT, late of 18 Gordon Street, Clifton Hill, Victoria, pensioner, deceased

Creditors, next of kin and others having claims in respect of the estate of the abovenamed deceased, who died on 15 August 1994, are required by Richard Henry McDonald, Deputy Director of Nursing, 35 Liverpool Street, North Fitzroy, Victoria the executor of the deceased's will, to send particulars of their claim to the said

3088 G 47 24 November 1994

executor care of the undermentioned solicitors by 11 February 1995, after which date they will convey or distribute the assets having regard only to the claims which they then have notice.

A. B. NATOLI PTY., solicitors, 24 Cotham Road, Kew

DAVID JOHN FRANCIS KELLY, late of Unit 10, 57 Caroline Street, Clifton Hill, Victoria, gentleman, deceased

Creditors, next of kin and others having claims in respect of the estate of the abovenamed deceased, who died on 21 July 1994, are required by Trevor Walter Hammond, sheetmetal worker of 30 Keelan Street, MacKay, Queensland the executor of the deceased's will, to send particulars of their claim to the said executor care of the undermentioned solicitors by 11 February 1995, after which date they will convey or distribute the assets having regard only to the claims which they then have notice.

A. B. NATOLI PTY., solicitors, 24 Cotham Road, Kew

JEAN WINIFRED HIGGINS, late of 25 St. Albans Road, East Geelong, Victoria, spinster, deceased, intestate

Creditors, next of kin and others having claims in respect of the estate of the deceased, who died on 15 August 1994, are required by Margaret Judith Young of Coast Road, Baffle Creek via Rosedale, Queensland, home duties the applicant for a grant of administration to send particulars of their claims to the said applicant care of the undermentioned solicitors by 25 January 1995, after which date the applicant will convey or distribute the assets having regard only to the claims of which she then has notice.

WHYTE JUST & MOORE, solicitors, 27 Malop Street, Geelong

GWYNNETH MARY ALICE TITHERADGE, late of flat 1, 45 Spray Street, Elwood, retired, deceased

Creditors, next of kin and others having claims in respect of the estate of the abovenamed deceased, who died on 28 August 1994, are required by the executrices Barbara Diane Wood of 17 Fairbank Avenue, Heathmont and Marion Lyla Shanahan of Flat 2, 9 Wilton Grove, Elwood to send particulars thereof to them care of the office of Mr Gordon P. Jacobs of 109

Victoria Government Gazette

Bedford Road, Ringwood East, within sixty days from the date of publication of this notice after which the executrices will distribute the estate having regard only to the claims of which they have notice.

GORDON P. JACOBS, solicitor, 109 Bedford Road, Ringwood East

FRANCIS WILLIAM BOWYER, late of Bowyers Road, Woodend, retired farmer, deceased

Creditors, next of kin and others having claims in respect of the estate of the deceased, who died on 19 June 1994, are required by the applicants for grant of representation John Anthony Hawkins and Janet MacGregor Hawkins of "Glen Osmond", Lancefield Road, Woodend to send particulars to them by 17 January 1995, after which date they may convey or distribute the assets having regard only to the claims of which they then have notice.

ARMSTRONG COLLINS AND DELACY, solicitors, 2 Jennings Street, Kyneton

RONALD CHARLES BAILEY JACK, late of 1 Marion Court, Traralgon, but formerly of Unit 2, 41 St. Andrews Street, Brighton, retired company director, deceased

Creditors, next of kin and others having claims in respect of the estate of the deceased, who died on 14 June 1994, are required by the executor ANZ Executors and Trustee Company Limited (A.C.N. 006 132 332) of 530 Collins Street, Melbourne to send particulars to them care of the undermentioned solicitors by 25 January 1995, after which date the executor may convey or distribute the assets having regard only to the claims of which it then has notice.

AITKEN WALKER & STRACHAN, solicitors, 114 William Street, Melbourne

Creditors, next of kin and others having claims in respect of the intestate estate of Margaret Sullivan Sims, formerly of 85 Anderson Road, Sunshine, Victoria, married woman, late of Pineville Private Nursing Home, 2 Gertrude Street, Geelong West, Victoria, widow, deceased, who died on 17 July 1994, are required by Elsie May McIntosh of 4 Skene Street, Newtown to whom letters of administration with the will annexed of the estate of the deceased were granted, to send particulars to Elsie May McIntosh, care of Messrs. Bowman Knox & Payne, solicitors, 32

Fenwick Street, Geelong by 31 January 1995, after which date she may convey or distribute the assets, having regard only to the claims of which she then has notice.

Dated 17 November 1994

BOWMAN KNOX & PAYNE, solicitors, 32 Fenwick Street, Geelong

Creditors, next of kin and others having claims in respect of the will and estate of Elsie May Thackray, late of North West Hospital, Poplar Road, Parkville, spinster, deceased, who died on 12 September 1994, are requested to send particulars of their claims to the administrator Trevor John Thackray Neal, care of the undermentioned solicitor by 25 January 1995, after which date he will distribute the assets having regard only as to the claims of which he then has notice.

JOHN STEWART, solicitor, 290 Racecourse Road, Newmarket

Creditors, next of kin and others having claims in respect of the estate of Herbert Noel Dawson, late of 16 Wright Street, Heathcote, retired, deceased, who died on 15 September 1994, are required by the trustee to send particulars of their claims to the trustee care of the undermentioned solicitors by 23 January 1995, after which date the trustee may convey or distribute the assets having regard only to the claims of which the trustee then has notice.

BECK SHEAHAN QUINN & KIRKHAM, 110 Pall Mall, Bendigo

Creditors, next of kin or others having claims in respect of the estate of James Donlevy Fitzpatrick, late of 125 Sycamore Street, South Caulfield, pensioner, deceased, who died on 3 January 1994, are to send particulars of their claims to the executor care of the undermentioned solicitors by 26 January 1995, after which date the executor will distribute the assets having regard only to the claims of which the executor then has notice.

B. M. CAULFIELD, solicitors, 596A Main Street, Mordialloc

Creditors, next of kin and others having claims in respect of the estate of John Ignatius Moran, late of Camberlea, 629 Riversdale Road, Camberwell, Victoria, retired hotel keeper, who died on 11 May 1994, are to send particulars of their claim to the executrix, Frances Mary

Moran, care of the undermentioned solicitors by 1 February 1995, after which date she will distribute the assets having regard only to the claims of which she then has notice.

YOUNG HUBBARD & CO., solicitors, 825 Burke Road, Camberwell

Creditors, next of kin and others having claims in respect of the estate of Kathleen May Atkinson, late of Kambermere Private Nursing Home, 23 Derby Street, Camberwell, Victoria, widow, who died on 3 August 1994, are to send particulars of their claim to the executors, Barrie John Young and Graeme Leslie Hubbard, care of the undermentioned solicitors by 1 February 1995, after which date they will distribute the assets having regard only to the claims of which they then have notice.

YOUNG HUBBARD & CO., solicitors, 825 Burke Road, Camberwell

Creditors, next of kin or others having claims in respect of the estate of Frederick Oliver Godden, late of 62 Kerford Street, Rochester, Victoria, gentleman, deceased, who died on 24 February 1994, are to send particulars of their claims to the executors care of the undermentioned solicitors by 31 January 1995, after which date the executors will distribute the assets having regard only to the claims of which they then have notice.

MORRISON & SAWERS, solicitors, 52 Mackay Street, Rochester

Creditors, next of kin and others having claims in respect of the estate of Joseph Dennis Moore, late of 31 Darling Street, South Yarra, Victoria, company director, deceased, who died on 7 February 1994, are required to send particulars of their claims to the executor care of the undermentioned solicitors by 24 January 1995, after which date the executor will distribute the assets having regard only to the claims for which notice has been received.

KELSEN SIERAKOWSKI, solicitors, 1st Floor, 245 Springvale Road, Glen Waverley

Creditors, next of kin and others having claims in respect of the estate of Dorothy Janet Hamilton, late of Inverleigh, Victoria, spinster, deceased, who died on 25 July 1994, are required by Roderick Allan Leigh of 50 Ondit Road, Winchelsea, Victoria, farmer, David Sholto Terrier of 595 Barwon Park Road, Winchelsea, Victoria, farmer and Helen Marie

Hamilton Carter of Bruce Street, Teesdale, Victoria, teacher, to whom probate of the deceased's will has been granted, to send particulars to Roderick Allan Leigh, David Sholto Terrier and Helen Marie Hamilton Carter, care of Messrs. Bowman Knox & Payne, solicitors, 32 Fenwick Street, Geelong by 31 January 1995, after which date they may convey or distribute the assets, having regard only to the claims of which they then have notice.

Dated 17 November 1994

BOWMAN KNOX & PAYNE, solicitors, 32 Fenwick Street, Geelong

Creditors, next of kin and others having claims in respect of the will of Ronald William Murray, late of 60 Kensington Road, Kensington, retired gentleman, deceased, who died on 19 October 1994, are requested to send particulars of their claims to the executors Maureen Anne Taylor and Stanley Thomas Taylor, care of the undermentioned solicitor by 25 January 1995, after which date they will distribute the assets having regard only as to the claims of which they then have notice.

JOHN STEWART, solicitor, 290 Racecourse Road, Newmarket

Creditors, next of kin and others having claims in respect of the estate of Irene Nellie Hannan, late of 75A Maple Street, Golden Square, retired, deceased, who died on 15 September 1994, are required by the trustee to send particulars of their claims to the trustee care of the undermentioned solicitors by 30 January 1995, after which date the trustee may convey or distribute the assets having regard only to the claims of which the trustee then has notice.

BECK SHEAHAN QUINN & KIRKHAM, 110 Pall Mall, Bendigo

BARRY ANTHONY FRAWLEY, late of 24 Lawanna Drive, Templestowe, Victoria, industrial chemist, deceased

Creditors, next of kin and others have claims against the estate of the said deceased, who died on 8 October 1994, are to send particulars of their claims to Leonie Nell Frawley, care of Alan P. Burnes, P.O. Box 138, Bundoora by 18 January 1995, after which date she will distribute the assets having regard only to the claims of which she then has notice.

ALAN P. BURNES, solicitor, 591 Grimshaw Street, Bundoora

MARY CATHERINE DONEGAN, late of 50 Trafalgar Street, Mont Albert, retired, deceased

Creditors, next of kin and others having claims in respect of the estate of the abovenamed deceased who died on 1 October 1994, are required by the executor Robert Leo Leffanue of 21 Scarborough Drive, Greensborough to send particulars thereof to him care of the office of Mr Gordon P. Jacobs of 109 Bedford Road, Ringwood East within sixty days from the date of publication of this notice after which the executor will distribute the estate having regard only to the claims of which he has notice.

GORDON P. JACOBS, solicitor, 109 Bedford Road, Ringwood East

ARCHIBALD ATHERTON DAY, deceased

Creditors, next of kin or others having claims in respect of the estate of Archibald Atherton Day, late of 2 Garden Street, Reservoir, Victoria, gentleman, deceased, who died on 10 September 1994, are to send particulars of their claims to the executors care of the undermentioned solicitors by 1 February 1995, after which date the executors will distribute the assets having regard only to the claims of which the executors then have notice.

HENDERSON & BALL, solicitors, 722 High Street, East Kew

ANNE KILLOUGH STEWART, late of 1 Kenley Court, Toorak, Victoria, widow, deceased

Creditors, next of kin and others having claims in respect of the estate of the deceased, who died on 26 August 1994, are required by the executors, John Malcolm Stewart of 312 Glenfern Road, Upwey, Victoria and ANZ Executors & Trustee Company Limited of 530 Collins Street, Melbourne, Victoria to send particulars to them by 31 January 1995, after which date the executors may convey or distribute the assets having regard only to the claims of which they then have notice.

ARTHUR ROBINSON & HEDDERWICKS, solicitors, 530 Collins Street, Melbourne

NORMA MARY NAVADA NICKSON, late of 18 St Andries Street, Camberwell, Victoria, widow, deceased

Creditors, next of kin and others having claims in respect of the estate of the deceased, who died on 24 August 1994, are required by the

personal representative, Kenneth David James Barry of 385 Bourke Street, Melbourne, Victoria, to send particulars to him care of the below mentioned solicitors by 24 January 1995, after which date the personal representatives may convey or distribute the assets having regard only to the claims of which he then has notice.

SLY & WEIGALL, solicitors, 385 Bourke Street, Melbourne

COLIN JOHN SMITH, late of Unit 53, Salford Park, 100 Harold Street, Wantirna, Victoria, public relations manager, deceased

Creditors, next of kin and others having claims in respect of the estate of the deceased, who died on 8 September 1994, are required by Perpetual Trustees Victoria Limited of 50 Queen Street, Melbourne, Victoria to send particulars of their claims to the said company by 1 February 1995, after which date it will convey or distribute the assets, having regard only to the claims of which the company then has notice.

CORRS CHAMBERS WESTGARTH, solicitors, Bourke Place, 600 Bourke Street, Melbourne

Creditors, next of kin or others having claims in respect of the estate of Evelyn June Gillon, late of 15 Cherry Grove, Mitcham, Victoria, retired, deceased, who died on 6 September 1994, are to send particulars of their claims to the executors Perpetual Trustees Victoria Limited of 50 Queen Street, Melbourne, Victoria and Cyril Sparks of 73 Elanora Avenue, Pottsville, New South Wales by 3 March 1995, after which date the executors will distribute the assets having regard only to the claims of which the executors then have notice.

DUNHILL MADDEN BUTLER, solicitors, 575 Bourke Street, Melbourne

Creditors, next of kin and others having claim in respect of the estate of Arthur Roe, late of 17 Marland Road, Boronia, Victoria, retired toolmaker, deceased, who died on 20 August 1994, are requested to send particulars of their claims to the executor National Mutual Trustees Limited of 65 Southbank Boulevard, South Melbourne, Victoria, formerly and in the will described as National Trustees Executors and Agency Company of Australasia Limited of 95

Queen Street, Melbourne in the said State by 27 January 1995, after which date the executor will distribute the assets having regard only to the claims of which it then has notice,

PETER J. WALSH & JOHN F. CARROLL, solicitors, 83 William Street, Melbourne

Creditors, next of kin and others having claims in respect of the estate of Edna Marie Lucy Holt, late of 5A Valerie Street, Boronia in the State of Victoria, gentlewoman, deceased, who died on 2 August 1994, are required to send particulars of such claims to the executor National Mutual Trustees Limited at its registered office at 65 Southbank Boulevard, South Melbourne by 25 January 1995, after which date the executor will distribute the estate having regard only to the claims of which it then has notice.

HELEN JOYCE CLARKE, late of Flat 11, 1 Monaro Road, Kooyong, Victoria, married woman, deceased

Creditors, next of kin and other persons having claims against the estate of Helen Joyce Clarke, late of Flat 11, 1 Monaro Road, Kooyong, Victoria, married woman, who died on 4 February 1994, are required by the executor of her estate The Equity Trustees Executors and Agency Company Limited of 472 Bourke Street, Melbourne, Victoria to send particulars of their claims to it care of the undersigned by 24 January 1995, after which date it may convey or distribute the estate having regard only to the claims of which it then has notice.

JOHN D. MUSTOW & CO., solicitors, 105 Queen Street, Melbourne

Creditors, next of kin and others having claims in respect of the estate of Clarice Doreen Watson-Smyth, late of Camberlea Private Nursing Home, 629 Riversdale Road, Camberwell, widow, deceased, who died on 17 July 1994, are required to send particulars of their claims to the executors Julie Christine Druitt of 328 Wattletree Road, East Malvern and William McKenzie Cleland of 454 Nepean Highway, Frankston on or before 24 January 1995, after which date they will distribute the assets having regard only to the claims of which they then had notice.

WHITE CLELAND PTY., solicitors, 454 Nepean Highway, Frankston

Creditors, next of kin and others having claims in respect of the estate of Mary Patricia Whittam, usually known as Pat Whittam, late of 20 Harold Street, Middle Park in the State of Victoria, retired milliner, deceased, who died on 7 August 1994, and probate of whose will was granted by the Supreme Court of the said State in its probate jurisdiction on 8 November 1994, to National Mutual Trustees Limited of 65 Southbank Boulevard, South Melbourne are required to send particulars of their claims to the said National Mutual Trustees Limited at its abovementioned address by 24 January 1995, after which date the said National Mutual Trustees Limited will distribute assets having regard only to the claims of which it then has notice.

FREDK. SHILLABEER INDOVINO & CO., solicitors, 3 Victoria Avenue, Albert Park

RHENA BREHAUT MIDDLETON, late of Unit 2, 4 Somerset Drive, Warragul, Victoria, widow, deceased

Creditors, next of kin and others having claims in respect to the estate of the deceased, who died on 21 August 1994, are required by the trustees Avon Rhena Ballantyne and Ian Maurice Ballantyne to send particulars of their claims to them care of the undersigned Solicitors by 27 January 1995, after which date the trustees may convey or distribute the assets having regard only to the claims of which they then have notice.

GRAY, FRIEND & LONG, solicitors, Warragul

Creditors, next of kin or others having claims in respect of the estate of Pietro De Paola, late of St Francis of Assisi Hostel, 230 Rosanna Road, Rosanna, Victoria, but formerly of 22 Spry Street, North Coburg, Victoria, pensioner, who died on 6 July 1994, are to send particulars of their claims to the executor Hector Cama, care of the undermentioned solicitors by 15 February 1995, after which date the executor will distribute the assets having regard only to the claims of which the executor then has notice.

SEPTIMUS JONES & LEE, solicitors, 257 Collins Street, Melbourne

MALCOLM JOHN APTED, late of 1054 Burrows Road, Albury in the State of New South Wales, diesel mechanic, deceased

Creditors, next of kin and others having claims in respect of the estate of the deceased, who died on 10 January 1994, are required by the trustee Anne Elizabeth Apted, care of Belbridge Hague, solicitors, 4/91 Hume Street, Wodonga to send particulars to her by the expiration of two (2) months from the date of this publication, after which date the trustee may convey or distribute the assets having regard only to the claims of which she then has notice.

Dated on 18 November 1994

Creditors, next of kin and others having claims in respect of the estate of Penelope Wynn Hall, formerly of 4 Wheeler Street, Castlemaine, but late of Mt. Alexander Hospital, Cornish Street, Castlemaine, gentlewoman, deceased, who died on 19 September 1994, are required to send particulars of their claims to the trustee Lawrence Ernest Muir of 157 Barker Street, Castlemaine by 28 February 1995, after which date the trustee will distribute the assets of the estate having regard only to the claims of which he then has notice.

H. S. W. LAWSON & CO., solicitors, 157 Barker Street, Castlemaine

MARY MARGARET BELL DEEBLE, late of 108 St. Aidans Road, Bendigo, home duties, deceased

Creditors, next of kin and others having claims in respect of the estate of the deceased, who died on 3 February 1994, are required by the executors Margaret Yvonne Broadbent and Keith Broadbent, both of 50 Manzeene Avenue, Lara to send particulars to them care of the below mentioned solicitors by 1 February 1995, after which date the executors may convey or distribute the assets of the deceased having regard only to the claims of which they then have notice.

Dated 21 November 1994

A. E. ELLINGHAUS & S. L. WEILL, solicitors, 129 Drummond Street, Carlton South

Unclaimed Moneys Act 1962

Register of Unclaimed Moneys held by the—

Name of Owner on Books and Last Known Address	Total Amount Due to Owner	Description of Unclaimed Money	Date when Amount first became Payable
	\$		
GEO G. AUSTIN			
Dart, Kenneth, 43A Hastings Rd, Frankston	347.00	Bond	17.8.89
Gibson, M and L, 41 Hastings Rd, Frankston 94100	480.00	"	10.7.89

PROCLAMATIONS

ACTS OF PARLIAMENT

Proclamation

I, Richard E. McGarvie, Governor of Victoria declare that I have today assented in Her Majesty's name to the following Bills:

No. 73/1994 Agricultural and Veterinary Chemicals (Victoria) Act 1994;

No. 74/1994 Como Project Act 1994;

No. 75/1994 Financial Management (Amendment) Act 1994;

No. 76/1994 Intellectually Disabled Persons' Services (Amendment) Act 1994;

No. 77/1994 Lotteries Gaming and Betting (Betting) Act 1994;

No. 78/1994 Road Safety (Further Amendment) Act 1994;

No. 79/1994 Therapeutic Goods (Victoria) Act 1994.

Given under my hand and the seal of Victoria at Melbourne on 22 November 1994

(L.S.) R. E. McGARVIE
By His Excellency's Command

J. KENNETT
Premier

No. 73/1994 (1) Part 1 comes into operation on the day on which this Act receives the Royal Assent.

(2) Subject to sub-section (3), the remaining provisions of this Act come into operation on a day or days to be proclaimed.

(3) If a provision referred to in sub-section (2) does not come into operation within the period of 12 months beginning on, and including, the day on which this Act receives the Royal Assent, it comes into operation on the first day after the end of that period.

No. 74/1994 This Act comes into operation on the day on which it receives the Royal Assent.

No. 75/1994 (1) Section 7 (6) is deemed to have come into operation on 10 May 1994.

(2) The remaining provisions of this Act come into operation on 1 January 1995.

No. 76/1994 (1) Section 1 and this section come into operation on the day on which this Act receives the Royal Assent.

(2) Section 9 is deemed to have come into operation on 1 October 1987.

(3) Subject to sub-section (4), the remaining provisions of this Act come into operation on a day or days to be proclaimed.

(4) If a provision referred to in sub-section (3) does not come into operation before 1 June 1995, it comes into operation on that day.

No. 77/1994 (1) Section 1 and this section come into operation on the day on which this Act receives the Royal Assent.

(2) Subject to sub-section (3), the remaining provisions of this Act come into operation on a day or days to be proclaimed.

(3) If a provision referred to in sub-section (2) does not come into operation before 1 January 1995, it comes into operation on that day.

No. 78/1994 (1) Section 1 and this section come into operation on the day on which this Act receives the Royal Assent.

(2) Subject to sub-section (3), the remaining provisions of this Act come into operation on a day or days to be proclaimed.

(3) If a provision referred to in sub-section (2) does not come into operation within the period of 6 months beginning on, and including, the day on which this Act receives the Royal Assent, it comes into operation on the first day after the end of that period.

No. 79/1994 (1) Section 1 and this section come into operation on the day on which this Act receives the Royal Assent.

(2) Subject to sub-sections (3) and (4), the remaining provisions of this Act come into operation on a day or days to be proclaimed.

(3) If a provision referred to in sub-section (2) (other than section 16, 17 or Part 5) does not come into operation within the period of six months beginning on, and including, the day on which this Act receives the Royal Assent, it comes into operation on the first day after the end of that period.

(4) If section 16, 17 or Part 5 of this Act do not come into operation within the period of 12 months beginning on, and including, the day on which this Act receives the Royal Assent, those provisions come into operation on the first day after the end of that period.

**Royal Agricultural Show-grounds
(Amendment) Act 1994**

PROCLAMATION OF COMMENCEMENT

I, Richard E. McGarvie, Governor of Victoria, acting with the advice of the Executive Council and under section 2 (2) of the **Royal Agricultural Show-grounds (Amendment) Act 1994**, fix 1 December 1994 as the day on which sections 3 to 6 inclusive, of the Act come into operation.

Given under my hand and the seal of
Victoria on 22 November 1994

(L.S.) R. E. McGARVIE
By His Excellency's Command

BILL McGRATH
Minister for Agriculture

**MUNICIPAL DISTRICT OF THE SHIRE
OF BENALLA**

SAMARIA—Crown Allotment 152H1,
Parish of Samaria as shown on Certified Plan
No. 113295 lodged in the Central Plan Office—
(Rs 0804517).

Given under my hand and the seal of
Victoria on 22 November 1994

(L.S.) R. E. McGARVIE
By His Excellency's Command

M. A. BIRRELL
Minister for Conservation and Environment

**Agriculture (Registered Occupations)
Act 1994**

PROCLAMATION OF COMMENCEMENT

I, Richard E. McGarvie, Governor of Victoria, acting with the advice of the Executive Council and under section 2 of the **Agriculture (Registered Occupations) Act 1994**, fix 1 December 1994 as the day on which sections 3 to 6 inclusive, of the Act come into operation.

Given under my hand and the seal of
Victoria on 22 November 1994

(L.S.) R. E. McGARVIE
By His Excellency's Command

BILL McGRATH
Minister for Agriculture

**Land Act 1958
PROCLAMATION OF ROADS**

I, Richard E. McGarvie, Administrator of Victoria acting with the advice of the Executive Council and under Section 25 (3) (c) of the **Land Act 1958** proclaim as roads the following lands:

**MUNICIPAL DISTRICT OF THE SHIRE
OF DUNMUNKLE**

ASHENS and MURTOA—Crown Allotment 163P, Parish of Ashens and Crown Allotment 14, Section 27, Township of Murtoa as shown on Certified Plan No. 112437 lodged in the Central Plan Office—(Rs 2627).

**GOVERNMENT AND OUTER BUDGET SECTOR
AGENCIES NOTICES**

**Planning and Environment Act 1987
BERWICK PLANNING SCHEME
Notice of Amendment
Amendment L82**

The City of Berwick has prepared Amendment L82 to the Local Section of the Berwick Planning Scheme.

The amendment proposes to rezone the following:

- (i) A strip of land along the northern side of the proposed a'Beckett Road deviation from a Landscape Interest A Zone to a Township A Zone. The amendment proposes to introduce a site specific control for this strip of land which incorporates the minimum lot sizes as outlined in the Narre Warren North Township Strategy.
- (ii) A parcel of land north of the existing alignment of a'Beckett Road from a part Township A and a part Landscape Interest A to a Proposed Public Purpose—Local Government Reservation for the purpose of the deviation of a'Beckett Road.
- (iii) A parcel of land from a part Landscape Interest A Zone and a part Stream and Floodway Zone to an Existing Public Purpose—Local Government Reservation for the purpose of an equestrian trail.

The amendment also proposes to alter the reference to Victoria Building Regulations 1983 to Building Regulations 1994 in Clause 123-2 of the Berwick Planning Scheme. This administrative change will accurately reflect the document which contains the minimum siting requirements for land in a Township A Zone.

The amendment can be inspected at the City of Berwick, Municipal Offices, Magid Drive, Fountain Gate or at the Department of Planning and Development, Ground Floor, The Olderfleet Buildings, 477 Collins Street, Melbourne.

Submissions about the amendment must be sent to the Chief Executive, City of Berwick, PO Box 1000, Narre Warren 3805 by Wednesday, 28 December 1994.

NEIL B. LUCAS
Chief Executive/Town Clerk

**Planning and Environment Act 1987
NOTICE OF AMENDMENT TO A
PLANNING SCHEME**

The City of Essendon has prepared Amendment L165 to the local section of the Melbourne Planning Scheme. The amendment was previously identified as Amendment L53 but will now be listed as Amendment L165 to the Melbourne Planning Scheme

The amendment proposes to rezone part of the site at 88 Mount Alexander Road, Flemington to have a single zone only applicable to the land. The site is currently zoned part 1R2 (Melbourne Residential Zone No. 2) and part Light Industrial. It is proposed that the residential portion be rezoned to Light Industrial.

The amendment may be inspected at the Department of Planning and Housing, Ground Floor, The Olderfleet Buildings, Melbourne or at the Town Planning Department, City of Essendon, corner Pascoe Vale Road and Kellaway Avenue, Moonee Ponds.

Any submissions about the amendment should be in writing and must be sent to the City Planner, City of Essendon, Attention: Strategic Planner, PO Box 126, Moonee Ponds 3039 by 24 December 1994.

Dated 24 November 1994

RUSSELL HOCKING
City Planner
City of Essendon

SHIRE OF CHILTERN

Notice of Declaration of Public Highway

Notice is hereby given that the Council of the Shire of Chiltern in accordance with the requirements of section 204 (1) of the Local Government Act 1989, has declared the following roads to be public highways for the purpose of the Act:

1. Annika Place, Barnawartha, as shown on Plan of Subdivision No. 213059.
2. Whitehead Court and Tara Drive, Barnawartha, as shown on Plan of Subdivision No. 221551T.

T. M. SMITH
Authorised Chief Executive Officer

SHIRE OF GOULBURN
Declaration of Public Highways

Pursuant to powers granted under section 204 (1) of the Local Government Act 1989, the Shire of Goulburn by this notice, declares that McGregor Avenue, Kean Road, Barwon, Murray, Park, Boyd, Prentice, Marie, Glass, Vine and Filson Streets being roads in its municipal district shown on the plans hereunder, are public highways for the purposes of the said Act.

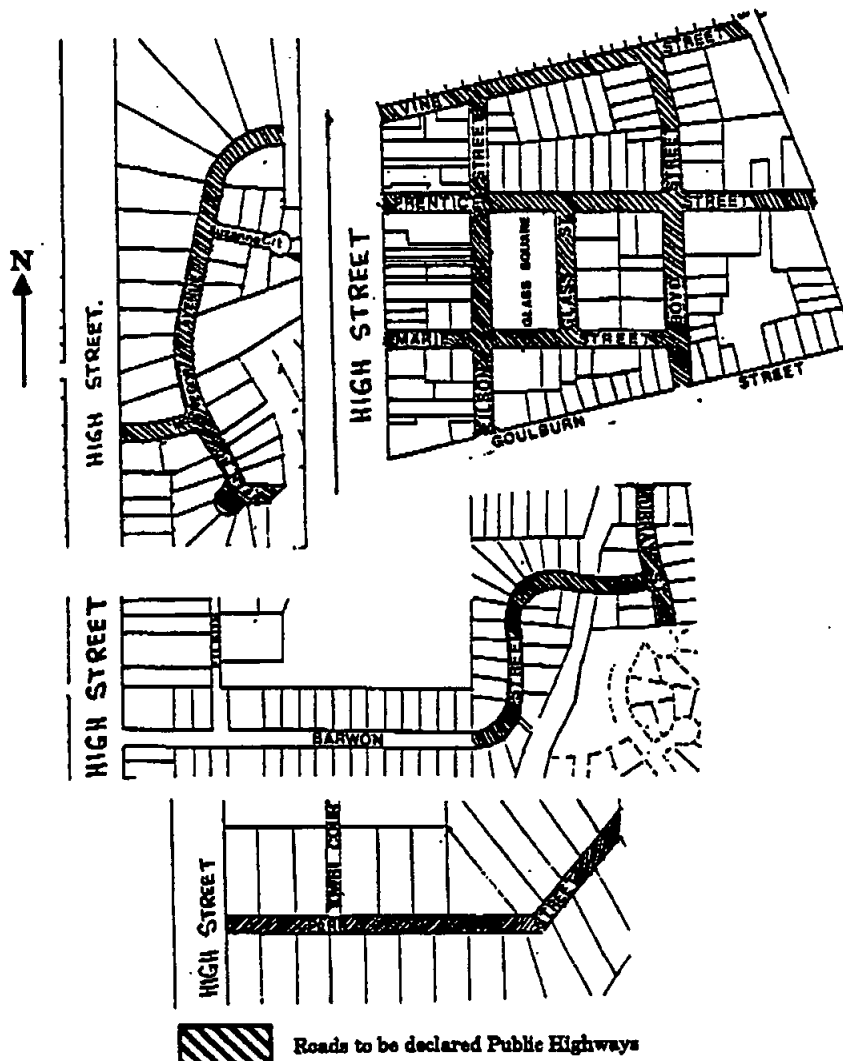

D. H. SAUNDERS
Shire Engineer

3098 G 47 24 November 1994

SHIRE OF PAKENHAM
Road Discontinuance
Kilbaha Road (Part), Cockatoo

That the Shire of Pakenham having advertised and served Notices regarding the proposed discontinuance of part of Kilbaha Road (which is not Crown Land), Cockatoo, shown hatched on the plan hereunder and the submissions having been considered under section 223 of the Local Government Act, 1989, orders that the said part of Kilbaha Road, Cockatoo (containing 3033 square metres approximately) be discontinued pursuant to Schedule 10, Clause 3 (a) of the said Act, and the land of the discontinued road vest in the Council pursuant to section 207B of the said Act to be transferred and/or incorporated into a resubdivided configuration in accordance with the Restructure Plan under the Pakenham Planning Scheme.

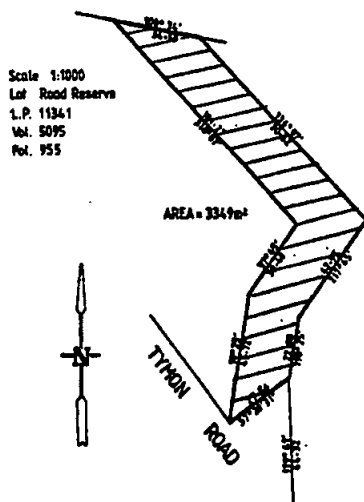

Published with the Authority of the Shire of Pakenham.

DAVID ROFF
Acting Chief Executive

Planning and Environment Act 1987
FRANKSTON PLANNING SCHEME
Notice of Amendment
Amendment L59

The City of Frankston has prepared Amendment L59 to the Local Section of the Frankston Planning Scheme.

Victoria Government Gazette

This amendment proposes to alter the existing site specific control at Clause 118-5 of the Frankston Planning Scheme. This applies to Part Crown Allotment 32E McClelland Drive, Frankston.

The amendment can be inspected at the City of Frankston, Town Planning Department, Civic Centre, Davey Street, Frankston or at the Department of Planning, Ground Floor, Olderfleet Buildings, 477 Collins Street, Melbourne.

Submissions about the amendment must be sent to the Chief Executive Officer, City of Frankston, PO Box 490, Frankston, Victoria 3199 by Friday, 23 December 1994. Attention: Town Planner.

GEOFF BARROW
Acting Chief Executive Officer

Planning and Environment Act 1987
RODNEY PLANNING SCHEME
Notice of Amendment to a Planning Scheme
Amendment L77

The Shire of Rodney has prepared Amendment L77 to the Rodney Planning Scheme.

The amendment affects land described as Lot 6 PS 329243 P Pt CA 17 Section B Parish of Undera, Tatura-Undera Road, Undera.

The amendment proposes to change the Rodney Planning Scheme by rezoning the subject land from Rural B to Village zone to allow subdivision and the development of low density lots.

The amendment can be inspected at the Shire of Rodney, Shire Office, Casey Street, Tatura; North East/Goulburn Region, Ministry for Planning and Development, North Eastern Office, State Offices, 1 McKoy Street, West Wodonga or at the Ministry for Planning and Development, The Olderfleet Building, 477 Collins Street, Melbourne.

You may make a submission for or against any item of the amendment by writing to Mr R. L. James, General Manager, Shire of Rodney, Shire Offices, Casey Street, Tatura 3616 by 29 December 1994.

W. L. STOCKDALE
Manager, Technical Services

Planning and Environment Act 1987
GREATER GEELONG PLANNING SCHEME
Notice of Amendment
Amendment R109

The City of Greater Geelong has prepared Amendment R109 to the Greater Geelong Planning Scheme.

The amendment proposes to re-align the Residential A/Reserved Residential and Rural Floodland zone boundaries, east of Forest Road, Lara.

The amendment can be inspected at the City of Greater Geelong, Osborne House, Swinburne Street, North Geelong or at the Department of Planning and Development, Olderfleet Buildings, 477 Collins Street, Melbourne.

Submissions about the amendment must be sent to the Planning Department, City of Greater Geelong, PO Box 104, Geelong by 24 December 1994.

CHUBB FADGYAS
Planning Scheme Manager

SHIRE OF BROADFORD

Local Law No. 17

Droving of Livestock and Roadside Grazing

Notice is hereby given that the Council of the Shire of Broadford has made Local Law No. 17 for the purpose of:

- (a) Protecting the amenity of the municipal district;
- (b) Ensuring the safety of road users;
- (c) Controlling the movement of livestock within the municipality.

A copy of the local law may be inspected at the Shire Office, Broadford, during normal office hours.

BARRY J. THOMAS
Shire Manager

Planning and Environment Act 1987
ROMSEY PLANNING SCHEME
Notice of Amendment to a Planning Scheme
Amendment L42

The Shire of Romsey has prepared Amendment L42 to the local section of the Romsey Planning Scheme.

The amendment affects Council owned land at Lot 135 LP 148751R, fronting Metcalfe Drive and Desmond Crescent, Romsey.

The amendment changes the zoning of part of the land, fronting Desmond Crescent, to Public Use—Open Space—Parkland. The balance of the land is retained in its current zoning of Township Residential B.

The amendment can be inspected at the office of the Shire of Romsey, Main Street, Romsey and the Department of Planning, 477 Collins Street, Melbourne.

Submissions about the amendment must be sent to the Chief Executive Officer, Shire of Romsey, PO Box 14, Romsey 3434 by 23 December 1994.

P. R. JOHNSTON
Chief Executive Officer

DAYLESFORD AND GLENLYON
PLANNING SCHEME
Local Section—Chapter One
Amendment L14

The Planning Authority for this Amendment is the Shire of Daylesford and Glenlyon.

Local Section

The Local Section of the Daylesford and Glenlyon Planning Scheme—Chapter One is amended as follows:

(1) After Clause 12 (3) (h) insert the following:

“Specific Site Control—Removal of Restrictive Covenant—

(4) Land:

Lots 19, 20 and 21 on Plan of Subdivision Number 13118, Township of Hepburn, Parish of Wombat; generally situated on the south-east corner of Clubhouse Drive and The Centreway, Hepburn Springs.

The covenant contained in Transfer 1461653 in the Register Book is directed to be removed”.

This amendment was exhibited by the Shire of Daylesford and Glenlyon on 17 November 1994.

IAN STEWART
Shire Engineer

3100 G 47 24 November 1994

**Planning and Environment Act 1987
DAYLESFORD AND GLENLYON
PLANNING SCHEME**

**Local Section—Chapter One
Notice of Amendment to a Planning Scheme
Amendment L14**

The Shire of Daylesford and Glenlyon has prepared Amendment L14 to the Daylesford and Glenlyon Planning Scheme Local Section—Chapter One.

The amendment proposes to remove a restrictive covenant from Lots 19, 20 and 21 on Plan of Subdivision Number 13118, Township of Hepburn, Parish of Wombat, generally situated on the south-east corner of Clubhouse Drive and The Centreway, Hepburn Springs.

The covenant amongst other matters provides for no more than one dwelling house to be erected on any one lot. The amendment proposes to remove such restrictiveness of the covenant.

A copy of the amendment can be inspected free of charge during office hours at the offices of the Shire of Daylesford and Glenlyon, 76 Vincent Street, Daylesford; at the Department of Planning and Development, 477 Collins Street, Melbourne and at the Department of Planning and Development, Regional Office, State Government Offices, corner Mair and Doveton Streets, Ballarat.

Submissions about the amendment must be sent to the Engineer, Shire of Daylesford and Glenlyon, 76 Vincent Street, Daylesford by 17 December 1994.

Dated 16 November 1994

IAN G. STEWART
Shire Engineer
Shire of Daylesford and Glenlyon

**CITY OF STONNINGTON
Road Discontinuance**

Pursuant to section 206 of the **Local Government Act 1989** the City of Stonnington resolved at a meeting held on 31 August 1994, that the road shown on Plan 7226 REV.A (below), being no longer reasonably required for public use, be discontinued and the land be retained for Municipal purposes.

Notwithstanding such discontinuance Melbourne Water Corporation shall continue to have and possess the same right title, power or authority or interest in or in relation to the land shown on the said plan and marked E-1 and E-3 as it had or possessed prior to such discontinuance

Victoria Government Gazette

with respect or in connection with any drains or pipes laid or erected in on or over such land for the purposes of drainage.

Notwithstanding such discontinuance State Electricity Commission—CitiPower Limited shall continue to have and possess the same right, title, power or authority or interest in or in relation to the land shown on the said plan and marked E2 and E3 as it had or possessed prior to such discontinuance with respect or in connection with any cables laid or erected in such land for underground powerline purposes.

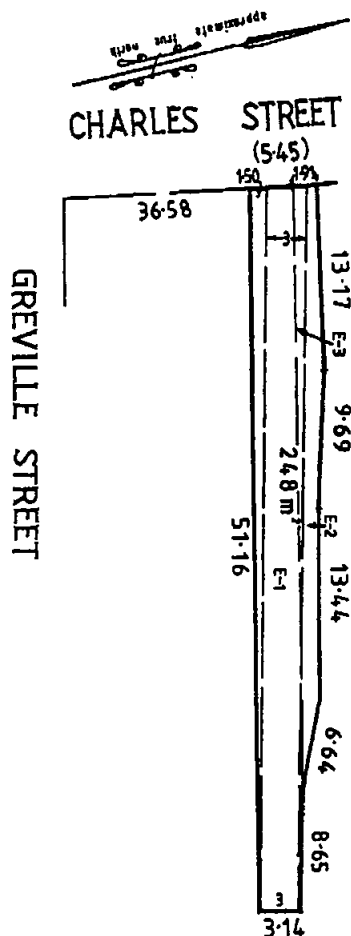

GREG N. MADDOCK
Chief Executive Officer

SHIRE OF EUROA
Local Law No. 10
Control of Saleyards

The Council of the Shire of Euroa gives Notice that at its meeting on 17 October 1994 it made Local Law No. 10 for the following purpose:

- (a) To provide for the welfare of livestock in the Saleyards.
- (b) To provide conditions for the hire of the Saleyards.
- (c) To provide for the removal of livestock from the Saleyards following a sale.
- (d) To provide for the setting of fees by Council from time to time.

A copy of the Local Law is available from the Council office in Binney Street, Euroa during normal office hours.

JOANNE ANDERSON
Acting Chief Executive Officer

SHIRE OF EUROA
Local Law No. 11
Euroa Memorial Swimming Pool

The Council of the Shire of Euroa gives Notice that at its meeting on 17 October 1994 it made Local Law No. 11 for the following purpose:

To regulate the use of the Euroa Memorial Swimming Pool.

A copy of the Local Law is available from the Council office in Binney Street, Euroa during normal office hours.

JOANNE ANDERSON
Acting Chief Executive Officer

SHIRE OF MAFFRA
Streets and Roads Local Law
Local Law No. 4

Notice is hereby given that the Council of the Shire of Maffra at its Ordinary Meeting held on 15 November 1994, pursuant to the provisions of the Local Government Act, made Local Law No. 4—Streets and Roads. The Local Law will come into effect on 1 December 1994.

A copy of this Local Law can be inspected or purchased during office hours at the Shire of Maffra, 88 Johnson Street, Maffra.

M. R. COLLINGS
Acting Chief Executive Officer

Planning and Environment Act 1987
RINGWOOD PLANNING SCHEME
Notice of Amendment
Amendment L36

The City of Ringwood has prepared Amendment L36 to the Local Section of the Ringwood Planning Scheme.

The amendment seeks to rezone part of land at No. 10–24 Bond Street from Residential C to Road—Proposed widening, part No. 33–41 Bond Street from Ringwood District Centre—The Entertainment Zone to Road—Proposed Widening and part No. 61–65 Bond Street from Ringwood District Centre—Restricted Light Industrial Zone to Road—Proposed Widening. Rezoning of these portions of land will enable acquisition for the widening of Bond Street.

A copy of the amendment can be inspected free of charge during office hours at the offices of the City of Ringwood, Building, Planning and Local Laws Services, City Offices, Braeside Avenue, Ringwood or at the Department of Planning and Development, Olderfleet Buildings, 477 Collins Street, Melbourne.

Submissions concerning the amendment must be sent to the City of Ringwood, care of Service Manager Building, Planning and Local Laws Services, PO Box 156, Ringwood 3134 by 31 December 1994.

Planning and Environment Act 1987
GISBORNE PLANNING SCHEME
Notice of Amendment
Extension of Submission Date
Amendment L24

The Shire of Gisborne has prepared Amendment L24 to the Local Section of the Gisborne Planning Scheme.

The amendment proposes to:

- (i) Insert several new definitions.
- (ii) Insert additional referral provisions.
- (iii) Substitute the existing Non Urban Zone provisions with new provisions for two Rural Zones—Rural and Rural Farmlet.
- (iv) Insert new Special Provisions to cover additional uses and development.
- (v) Insert additions to the list of Incorporated Documents
- (vi) Delete Clause 50A—Time Share Resort Development—Nolan Road.

3102 G 47 24 November 1994

- (vii) Clarify setback provisions for outbuildings in all zones.

Copies of the amendment can be inspected free of charge during office hours at the offices of the Shire of Gisborne, Civic Centre, Robertson Street, Gisborne or at the Department of Planning and Development, The Olderfleet Buildings, Ground Floor, 477 Collins Street, Melbourne.

Submissions about the amendment should be in writing and must be sent to: Attention: Peter Gaschk, Shire of Gisborne, PO Box 63, Gisborne 3437 by Wednesday, 7 December 1994.

T. H. LARKINS
Chief Executive

Planning and Environment Act 1987
TRARALGON (CITY) PLANNING SCHEME
Notice of Amendment
Amendment L55

The City of Traralgon has prepared Amendment L55 to the Traralgon (City) Planning Scheme.

The amendment affects land at Hickox Street, Rose Avenue and Dunbar Road, Traralgon being lot 2 on Plan of Subdivision 326645 in the Township and Parish of Traralgon, County of Buln Buln.

The amendment can be inspected at either the City of Traralgon, Municipal Offices, Kay Street, Traralgon; the office of the Latrobe Regional Commission, 42 Grey Street, Traralgon; the Regional Office of the Department of Planning and Housing, 11 Hazelwood Road, Traralgon or at the Department of Planning and Housing, the Olderfleet Buildings, 477 Collins Street, Melbourne. Inspect during office hours of the amendment at these places will be free of charge to any person.

Submissions regarding the amendment must be in writing and sent to the Chief Executive Officer, City of Traralgon, Municipal Offices, Kay Street, Traralgon by 23 December 1994. Should you have any enquiries please contact Elaine Wood, Town Planner on (051) 73 1400.

JOHN MITCHELL
Chief Executive

Victoria Government Gazette

Planning and Environment Act 1987
RODNEY PLANNING SCHEME
Notice of Amendment to a Planning Scheme
Amendment L79

The Shire of Rodney has prepared Amendment L79 to the Rodney Planning Scheme.

The amendment affects land having an area of 2376 m², described as "road" being that part of Homewood Drive located inside the entrance to Homewood Park, on the north boundary of Homewood Drive adjacent to Mooroopna Secondary College.

The amendment proposes to change the Rodney Planning Scheme by rezoning 2376 m² of land road to Existing Public Purposes 7—Education Department.

The amendment can be inspected at the Shire of Rodney, Shire Office, Casey Street, Tatura; North East/Goulburn Region, Ministry for Planning and Development, North Eastern Office, State Offices, 1 McKoy Street, West Wodonga or at the Ministry for Planning and Development, The Olderfleet Building, 477 Collins Street, Melbourne.

You may make a submission for or against any item of the amendment by writing to Mr R. L. James, General Manager, Shire of Rodney, Shire Offices, Casey Street, Tatura 3616 by 29 December 1994.

W. L. STOCKDALE
Manager, Technical Services

Planning and Environment Act 1987
RODNEY PLANNING SCHEME
Notice of Amendment to a Planning Scheme
Amendment L70

The Shire of Rodney has prepared Amendment L70 to the Rodney Planning Scheme.

The amendment affects land described as road being part of Mactier Street, Tatura adjacent to the Tatura Milk Industries Ltd site.

The amendment proposes to close that part of the road shown on the map forming part of Amendment L70 and rezone the area to Industrial zone.

The amendment can be inspected at the Shire of Rodney, Shire Office, Casey Street, Tatura; North East/Goulburn Region, Ministry for Planning and Development, North Eastern

Office, State Offices, 1 McKoy Street, West Wodonga or at the Ministry for Planning and Development, The Olderfleet Building, 477 Collins Street, Melbourne.

You may make a submission for or against any item of the amendment by writing to Mr R. L. James, General Manager, Shire of Rodney, Shire Offices, Casey Street, Tatura 3616 by 29 December 1994.

Dated 16 November 1994

W. L. STOCKDALE
Manager, Technical Services

Planning and Environment Act 1987
RODNEY PLANNING SCHEME
Notice of Amendment to a Planning Scheme
Amendment L83

The Shire of Rodney has prepared Amendment L83 to the Rodney Planning Scheme.

The amendment affects land described as road being part of Archer Street, Mooroopna adjacent to Ardmona Foods Limited.

The amendment proposes to close that part of the road shown on the map forming part of the Amendment L83 and rezone the area to Industrial.

The amendment can be inspected at the Shire of Rodney, Shire Office, Casey Street, Tatura; North East/Goulburn Region, Ministry for Planning and Development, North Eastern Office, State Offices, 1 McKoy Street, West Wodonga or at the Ministry for Planning and Development, The Olderfleet Building, 477 Collins Street, Melbourne.

You may make a submission for or against any item of the amendment by writing to Mr R. L. James, General Manager, Shire of Rodney, Shire Offices, Casey Street, Tatura 3616 by 29 December 1994.

W. L. STOCKDALE
Manager, Technical Services

Planning and Environment Act 1987
BASS PLANNING SCHEME, LOCAL
SECTION
Notice of Amendment
Amendment L33

The Shire of Bass has prepared Amendment L33 to the Bass Planning Scheme.

The amendment affects land at Lots 5 and 6 PS 331198D Gurdies-St. Helier Road, The Gurdies.

The amendment proposes to change the Planning Scheme by altering the provisions of Schedule 16 to the Bass Planning Scheme which affects land known as the Seaview Estate, The Gurdies.

It is proposed to:

1. Delete the existing subclause 5 (a) of the Schedule which requires that vehicle access to lots 5 and 6 must be obtained from a shared driveway not exceeding 3 metres in width, and to substitute a new subclause 5 (a) which requires for access to be provided in a manner which minimises vegetation removal to the satisfaction of the Responsible Authority.

2. Alter the building setback shown on the development plan in Schedule 16 from the existing 40 metres, to 18 metres in order to allow an existing clearing on lot 5 to be utilised for a house site.

The amendment can be inspected at the Shire of Bass, Main Road, Archies Creek or at the Department of Planning and Development, 477 Collins Street, Melbourne.

Submissions about the amendment must be in writing and sent to the Manager, Planning and Development, Shire of Bass, Main Road, Archies Creek, Victoria 3992 by 6 January 1995.

JEFF BENNETT
Manager, Planning and Development

Planning and Environment Act 1987
NOTICE OF AMENDMENT TO A
PLANNING SCHEME

The Golden Plains Shire Council has prepared Amendment R23 to the Bannockburn Planning Scheme.

The amendment affects land at Common Road, Inverleigh, being Part Crown Portion 15A Parish of Carrah, County of Grant.

The amendment proposes to change the Planning Scheme by:

- * Rezoning the land from Rural General Farming to Rural Residential.

The amendment can be inspected at the Golden Plains Shire Council, 2 Pope Street, Bannockburn; Ministry for Planning and Environment, State Offices, corner Little Malop

3104 G 47 24 November 1994

Victoria Government Gazette

and Fenwick Streets, Geelong or at the Ministry for Planning and Environment, 1st Floor Olderfleet Building, 477 Collins Street, Melbourne.

Submissions about the amendment must be sent to the Golden Plains Shire Council, 2 Pope Street, Bannockburn by not later than 30 December 1994.

Dated 16 November 1994

K. T. MIDDLETON
Town Planning Officer

STATE TENDER BOARD
CONTRACTS ACCEPTED
Amendments

Schedule Number	Item Number	New Rate	Effective Date
		\$	
<i>Motor Spirit, Fuel Oils, etc</i>			
1/53	1.0	0.6180	19.11.94
	2.0	0.6220	
	3.0	0.6381	
	4.0	0.6421	
	5.0	0.6385	
	6.0	0.6485	
	7.0	0.6586	
	8.0	0.6686	
<i>Motor Vehicles (Passenger)—General Motors-Holden's Automotive</i>			
1/58	13.1	17 845.00	22.11.94
	14.1	18 286.00	
Options Available (Item Nos 13.1 and 14.1)—			
	Airconditioning	867.00	
	Limited Slip Diff.	286.00	
	Country Pack Suspension	214.00	
	Metallic Paint	146.00	
	14.3	19 097.00	
Options Available (Item No. 14.3)—			
	Independent Rear Suspension	678.00	
	Antilock Brakes	735.00	
	Air Bag	678.00	
	15.1	19 190.00	
	16.1	19 630.00	
Options Available (Item Nos 15.1 and 16.1)—			
	Airconditioning	867.00	
	Limited Slip Diff.	286.00	
	Country Pack Suspension	214.00	
	Metallic Paint	146.00	
	16.4	21 723.00	
Options Available (Item No. 16.4)—			
	Airconditioning	867.00	
	Limited Slip Diff.	286.00	
	Power Windows/A/C Pack	1 438.00	
	17.2	21 089.00	
Options Available (Item No. 17.2)—			

Schedule Number	Item Number	New Rate	Effective Date
		\$	
<i>Airconditioning</i>			
		867.00	
<i>Limited Slip Diff.</i>			
		286.00	
<i>Country Pack Suspension</i>			
		214.00	
<i>Metallic Paint</i>			
		146.00	
	17.4	22 663.00	
Options Available (Item No. 17.4)—			
	Limited Slip Diff.	286.00	
	Country Pack Suspension	214.00	
	Metallic Paint	146.00	
	IRS	733.00	
	ABS	735.00	
	18.2	27 528.00	
Options Available (Item No. 18.2)—			
	Limited Slip Diff.	291.00	
<i>Leather Trim</i>			
		1 214.00	
	19.2	20 245.00	
	20.1	20 686.00	
Options Available (Item Nos 19.2 and 20.1)—			
	ABS	735.00	
	IRS	678.00	
	Air Bag	678.00	
<i>Motor Vehicles (Light Commercial)—General Motors-Holden's Automotive</i>			
1/59	1.1	15 143.00	22.11.94
	1.2	15 739.00	
Options Available (Item Nos 1.1 and 1.2)—			
	Limited Slip Diff.	286.00	
<i>Airconditioning</i>			
		867.00	
<i>Ford Motor Company of Aust Ltd</i>			
1/59	1.1	14 564.00	26.11.94
	1.2	15 520.00	
	2.2	15 848.00	
Options Available (Item Nos 1.1, 1.2 and 2.2)—			
	Airconditioning	861.00	
	3.1	14 540.00	
	4.1	18 258.00	
	8.1	16 588.00	
	9.1	21 007.00	
	12.1	13 911.00	
	13.1	17 519.00	
	17.1	16 525.00	
	17.2	17 498.00	
Options Available (Item Nos 3.1, 4.1, 8.1, 9.1, 12.1, 13.1, 17.1 and 17.2)—			
	Airconditioning	861.00	

N. L. JORDAN
Secretary to the Tender Board

Private Agents Act 1966
NOTICE OF RECEIPT OF APPLICATIONS FOR LICENCES

Any objections to the applications below should be in accordance with the *Private Agents Act 1966* s. 12 and *Private Agents Regulations 1988* reg. 16

Full name of Applicant/Nominee	Residential Address	Name of Firm or Corporation	Address for Registration	Licence Type	Hearing Date and Court
Wearing, John Herbert	15 Grevillea Drive, Enfield		15 Grevillea Drive, Enfield	CA	12.12.94 Ballarat

*Licence Type: CA—Commercial Agent; CS—Commercial Sub-Agent; P—Process Server; IA—Inquiry Agent; G—Guard Agent; W—Watchman

DEPARTMENT OF ENERGY AND MINERALS

All titles are located on the 1:100,000 mapsheet listed with each title.

EXPLORATION LICENCE REFUSED

No. 3712; Ausminde P/L; 140 grats, Alexandra and Yea.

EXPLORATION LICENCE RENEWED

No. 3193; Osprey Gold NL; 35 grats, Nagambie.

No. 3196; Osprey Gold NL; 70 grats, Ballarat.

No. 3253; Glenburn Manor Pty Ltd and International Mineral Resources NL; 15 grats, St Arnaud.

No. 3306; Renison Ltd; 90 grats, Kerang.

No. 3309; CRA Exploration Pty Ltd; 106 grats, Bairnsdale and Orbost.

No. 3366; CRA Exploration P/L; 472 grats, Beaufort and St Arnaud.

No. 3489; CRA Exploration P/L; 2 grats, Beaufort.

EXPLORATION LICENCE

AMALGAMATED/CANCELLED

No. 3489 and 3677; CRA Exploration P/L; 30 grats, Beaufort and St Arnaud. Upon amalgamation into No. 3677, No. 3489 was cancelled.

No. 3677 and 3366; CRA Exploration P/L; 502 grats, St Arnaud and Beaufort. Upon amalgamation into No. 3366, No. 3677 was cancelled.

EXPLORATION LICENCE VARIED

No. 3431; Continent Resources P/L; 38 grats, Castlemaine.

No. 3626; Highlake Exploration Ltd; 10 grats, Creswick.

EXPLORATION LICENCE SURRENDERED

No. 3137; Janmex P/L; 20 grats, Heathcote.

No. 3219; Stawell Gold Mines P/L; 32 grats, Ararat.

No. 3443; Stawell Gold Mines P/L; 22 grats, Ararat

No. 3511; Stawell Gold Mines P/L; 188 grats, Casterton, Coleraine and Edenhope.

No. 3526; Stawell Gold Mines P/L; 175 grats, Ballarat, Beaufort, Creswick and Skipton.

No. 3527; Stawell Gold Mines P/L; 407 grats, Ballarat and Creswick.

No. 3559; Stawell Gold Mines P/L; 495 grats, Willaura.

No. 3560; Stawell Gold Mines P/L; 314 grats, Willaura.

EXPLORATION LICENCE EXPIRED

No. 3035; Hardrock Exploration P/L; 260 ha, Orbost.

MINING LICENCE GRANTED

No. 4249; A. R. Fraser and R. Sargent; 127.4 ha, Wedderburn.

No. 4572; S. W. Pearson and J. A. Farkas; 15.02 ha, Creswick.

No. 4862; M. McQuade and S. Beer; 5 ha, Wangaratta.

MINING LICENCE RENEWED

No. 4865; Williams Mines P/L; 1.27 ha, Buffalo.

MINING LICENCE

AMALGAMATED/CANCELLED

No. 4004 and 4865; Williams Mines P/L; 8.69 ha, Buffalo. Upon amalgamation into No. 4004, No. 4865 was cancelled.

MINING LICENCE CANCELLED

No. 4020; R. N. Icely; 17.49 ha, Buffalo, Bogong.

MINING LEASE VARIED

No. 1904; Janmex P/L; 32.35 ha, Heathcote.

MINER'S RIGHT CLAIM EXPIRED

No. 3069; J. Mustard, W. Jamieson and K. Hepburn; 1 ha, Bendoc.

3106 G 47 24 November 1994

**EXTRACTIVE INDUSTRIES LICENCE
ASSIGNED**

No. 584; D. G. Addinsall; 1·3099 ha,
Macarthur.

No. 1148; D. G. Addinsall; 4·3859 ha,
Macarthur.

**EXTRACTIVE INDUSTRIES LICENCE
RENEWED**

No. 873; J. M. Kilpatrick; 2·52 ha, Werribee.

**EXTRACTIVE INDUSTRIES LEASE
RENEWED**

No. 184; Brick and Pipe Industries Ltd;
134·6962 ha, Kalkallo.

No. 185; Brick and Pipe Industries Ltd;
144·2324 ha, Kalkallo.

**MURRAY VALLEY (VICTORIA) WINE
GRAPE INDUSTRY MARKETING ORDER
1994**

Citation

1. This Order may be cited as the Murray
Valley (Victoria) Wine Grape Industry
Marketing Order 1994.

*Order made under the Agricultural Industry
Development Act 1990*

2. This Order is made under Part 2 of the
Agricultural Industry Development Act 1990.

Purposes of Order

3. The purposes of this Order are—

- (a) to set up a Committee:
 - (i) to recommend prices to be paid by wineries to producers for wine grapes grown in the Victorian production area;
 - (ii) to analyse and report on the market outlook for the wine grape and wine industry; and
 - (iii) to fix the minimum terms of payment for wine grapes grown in the Victorian production area;
- (b) to provide for the Committee to be functionally set up as either—
 - (i) a single interstate Committee if New South Wales legislation provides for a similar organisation having similar functions in relation to the New South Wales production area of the Murray Valley, or

Victoria Government Gazette

- (ii) an independent intra-state Committee having functions and powers that relate solely to the Victorian production area; and
- (c) to empower the Committee to liaise and meet with any other organisations that have similar purposes.

Definitions

4. In this Order:

“Act” means the **Agricultural Industry Development Act 1990**.

“Committee” means the Murray Valley Wine Grape Industry Negotiating Committee.

“Victorian production area” means the areas within the Cities of Mildura and Swan Hill and the Shires of Mildura, Swan Hill and Kerang in Victoria.

“New South Wales production area” means that area within the Local Government Areas of Wentworth, Balranald and Wakool.

“Producer” means a person, including a partnership, share farming agreement or company, who grows or produces wine grapes in the Victorian production area for delivery to wineries in either the current or preceding year, but excluding:

- (a) wineries;
- (b) non-profit institutions, charitable organisations and community groups; and
- (c) employees of producers.

“Recommended prices” are specific prices or price ranges which, in the Committee’s collective judgment, are the best available forecast of prices that are likely to prevail for wine grapes in the Victorian and NSW production areas at an identified future time.

“Wine grapes” means any variety of grapes grown in the production area and used or intended to be used for processing into wine, must, juice or wine spirit.

“Wineries” means all wineries which accept wine grapes from producers in the production areas, for use in wine, must, juice or wine spirit production. For the purpose of this Order, the definition of wineries is inclusive of persons who purchase wine grapes from producers for resale to wineries.

Term of Order

5. This Order commences on the date of its publication in the Government Gazette and remains in force for four years from that date. It

is renewable for a further period not exceeding four years, subject to a poll in accordance with the Act.

Establishment of Committee

6. There shall be a "Murray Valley Wine Grape Industry Negotiating Committee."

Members

7. (a) (i) The Committee shall consist of either seven or fourteen members, depending on whether it is formed independently of, or jointly with, any Committee that may be established under New South Wales legislation and having similar functions to those of this Committee.

(ii) The option to form a seven member intra-State Committee will be exercised only if there is no provision under New South Wales legislation for the formation of a jointly formed negotiating committee.

(b) If the Committee is established as an independent intra-State Committee, it will comprise seven members appointed by the Minister, being—

(i) three persons appointed from a panel of at least five persons nominated by the Victorian and Murray Valley Wine Grape Growers' Council or any other relevant body that in the opinion of the Minister has replaced that body;

(ii) three persons appointed from a panel of at least five persons nominated by wineries to whom wine grapes are supplied from the Victorian production area and whose nomination to the Minister is supported by the Winemakers Federation of Australia; and

(iii) an independent non-voting Chairperson who is an employee of the Department of Agriculture, Victoria.

(c) If the Committee is established as a jointly formed Victorian/NSW Committee with responsibility for administering the relevant arrangement in both States, the Committee will consist of up to fourteen members appointed jointly by the Victorian Minister for Agriculture and the NSW Minister for Agriculture and Fisheries on the following basis—

(i) six persons appointed from a panel of at least eight persons nominated by the Victorian and Murray Valley Wine

Grape Growers' Council or any other relevant body that in the opinion of the Ministers has replaced that body;

(ii) six persons appointed from a panel of at least eight persons nominated by wineries to whom wine grapes are supplied from the production areas and whose nomination to the Ministers is supported by the Winemakers Federation of Australia;

(iii) up to two independent non-voting persons, jointly appointed by the Victorian Minister for Agriculture and the NSW Minister for Agriculture and Fisheries, will share the responsibility for acting as Chairperson of the Committee.

Function to Analyse and Report on Market

8. (a) The Committee must prepare a report on the market outlook for the industry at least once in every year and must prepare such a report whenever a recommendation is made about prices or terms of payment.

(b) The Committee must publish any report prepared on the market outlook and any recommended prices or terms of payment at the same time and in the same manner being in a newspaper or other publication which circulates throughout the production area.

Function to Recommend Prices

9. (a) The Committee may recommend prices for wine grapes delivered to a winery.

(b) The Committee may recommend different prices for wine grapes according to the variety of wine grape.

(c) The Committee may adjust a recommended price if it is of the opinion that it is appropriate to do so because of changed circumstances.

Function to Fix Terms of Payment

10. (a) The Committee may fix the minimum terms of payment by wineries for wine grapes.

(b) The terms of payment fixed by the Committee may include—

(i) times of payment;

(ii) interest penalties for non-compliance with times of payment.

(c) When fixing minimum terms of payment, the Committee may determine alternative arrangements with regard to the industry's needs on both a seasonal and longer term basis.

11. (a) If the Committee is unable to agree, the minimum terms of payment for the previous year will apply for the current year.

(b) If the Committee is unable to agree in its first year, the minimum terms of payment last fixed by the Wine Grape Industry Negotiating Committee established under the Wine Grape Industry Development Order 1990 will apply.

Meetings

12. (a) The Committee must meet in a timely manner to enable it to determine recommended prices for wine grapes and to fix terms of payment prior to harvest and no later than 15 December.

(b) A Special meeting of the Committee may be convened by notice in writing given to the Chairperson by all producer members or all processor members. Such notice must be given to all other members at least seven days before the proposed meeting.

Financial Year

13. The financial year of the Committee is the period from 1 July to 31 June.

Voting

14. (a) For the purposes of voting at a future poll on the renewal or remaking of this Marketing Order, a producer in the Victorian production area who delivered grapes to at least one winery in either the current or preceding year is eligible to vote.

Penalty for Contravening Order

15. A person who fails to comply with the terms of payment fixed by the Committee under the clause 10 and published under clause 8 contravenes this Order and is liable to a penalty not exceeding twenty penalty units. One penalty unit is currently \$100.

BILL McGRATH
Minister for Agriculture

Department of Finance
SALE OF CROWN LAND BY PUBLIC
TENDER

Reference P041436

Tenders close 2.00 p.m., Thursday, 16 February 1995.

Property Address: Penshurst-Port Fairy Road, Warrong.

Crown Description: Allotment 3D, Section B, Parish of Warrong.

Area: 1.897 hectares.

Term of Sale: 10% deposit—balance 60 days.

Tenders: addressed to—Crown Land Sales, Tender Box, Department of Conservation and Natural Resources, 17 Thompson Street, Hamilton 3300.

Tender Deposit: 10% of tendered amount to be lodged with tender.

Application Form: Available on request.

Co-ordinating Officer: Stewart Beaton, Land Sales Officer, Department of Conservation and Natural Resources, Hamilton. Telephone (055) 72 3033.

IAN SMITH
Minister for Finance

Department of Finance
SALE OF CROWN LAND BY PUBLIC
AUCTION

Reference: GL.18708, 94/01829.

Address of Property: 63A Hunter Street, Brunswick West 3055 (corner of Daly Street).

Crown Description: Crown Allotment 103^A Parish of Jika Jika.

Area: 738 m².

Terms of Sale: 10% deposit, balance 60 days.

Auction: Saturday, 17 December 1994 at 2.15 p.m. on site.

Officer Co-ordinating Sale: Michael Thompson, Property Consultant, 4th Floor, 35 Spring Street, Melbourne 3000. Telephone: 651-3500, Facsimile 651-3634.

Selling Agent: Mr David Sowersby, Walshe & Whitelock, 701 Sydney Road, Brunswick 3056. Telephone: 386 5241, Facsimile: 383 6439.

IAN SMITH
Minister for Finance

Department of Finance
SALE OF CROWN LAND BY PUBLIC
TENDER

Reference: P140410

Tenders close 2.00 p.m. Tuesday, 29 November 1994.

Property Address: Corner Windle and Steiglitz Street, Ballan.

Crown Description: Allotment 1A Section 16 Township of Ballan, 1014 m²; Allotment 1B Section 16 Township of Ballan, 1018 m².

Terms of Sale: 10% deposit—balance 60 days.

Tenders: to be address to: Sale Tender Box 94/B, Department of Conservation and Natural Resources, PO Box 103, Geelong 3220.

Tender Deposit: 10% of tendered amount to be lodged with tender.

Application Form: Available on request.

Co-ordinating Officer: Kate Astall—Land Sales Officer, Department of Conservation and Natural Resources, Port Phillip Area, Geelong. Tel: (052) 26 4667.

IAN SMITH
Minister for Finance

Transport Act 1983 ROADS CORPORATION

Commercial Passenger Vehicle and Tow Truck Applications

Notice is hereby given that the following applications will be considered by the Roads Corporation after 28 December 1994.

Notice of any objection to the granting of an application should be forwarded to reach the Section Leader, Vehicle Licensing or any District Office of the Roads Corporation not later than 22 December 1994.

It will not be necessary for interested parties to appear on the date specified, unless advised in writing by the Corporation.

The Chauffeur (Aust) Pty Ltd, Endeavour Hills. Application to license three commercial passenger vehicles in respect of 1992 or later model Ford LTD's or sedans or similar vehicles each with seating capacity for 4 passengers to operate as special purpose vehicles from 3 Belsize Court, Endeavour Hills for the carriage of passengers for wedding parties, tourist activities, social events and special occasions.

C. M. A. Holdings Pty Ltd, Kensington. Application for variation of the conditions of tow truck licence number 079 which authorises the licensed vehicle to be controlled and operated from a depot situated at 40 Stubbs Street, Kensington to change the depot address to 169 City Road, South Melbourne.

Note: The licence is currently under consideration for transfer to F. Truccolo, 169 City Road, South Melbourne.

L. E. Farrar, Caulfield. Application to license one commercial passenger vehicle in respect of a 1965 or later model Pontiac convertible or similar vehicle with seating capacity for 5 passengers to operate as a special purpose vehicle from 9 Booran Road, Caulfield for the carriage of passengers for wedding parties.

Imbiss Pty Ltd, Seaford. Application to license one commercial passenger vehicle in respect of a 1976 or later model Bedford domino-hedges bus or similar vehicle with seating capacity for 45 passengers to operate a service for the carriage of students attending Flinders Christian Community College, corner Boes and Mornington-Tyabb Roads, Tyabb to the exclusion of all other passengers excepting duly authorised teachers between Bardia Avenue, Seaford via Klauer Street, Frankston-Dandenong Road, Skye Road, McClelland Drive, Cranbourne Road, Dandenong-Hastings Road, Eramosa Road, Jones Road and Flinders Christian Community College, Tyabb under contract to the school.

Fares: As per contract with the school.

Timetable: As and when required.

Note: School charter rights are being sought in this application.

L. H. Lowen, Benalla. Application for variation of the conditions of tow truck licence number 217 which authorises the licensed vehicle to be controlled and operated from a depot situated at 162 Bridge Street, Benalla to change the depot address to Lowens Lane, Benalla.

Note: The license is currently under consideration for transfer to H. J. Arnold, Lowens Lane, Benalla.

S. Paterno, East Bentleigh. Application to license one commercial passenger vehicle in respect of a 1966 or later model Pontiac convertible or similar vehicle with seating capacity for 5 passengers to operate as a special purpose vehicle from 7 Brian Street, East Bentleigh for the carriage of passengers for wedding parties.

Spencer Panels Pty Ltd, West Melbourne. Application for variation of the conditions of tow truck licence numbers 087, 691, 547, 689, 685 and 672 which authorises the licensed vehicles to be controlled and operated from a depot situated at 127-135 Stanley Street, West Melbourne to change the depot address to 169 City Road, South Melbourne.

3110 G 47 24 November 1994

F. Truccolo, West Melbourne. Application for variation of the conditions of tow truck licence numbers 442, 586, 650, 649 and 561 which authorises the licensed vehicles to be controlled and operated from a depot situated at 127-135 Stanley Street, West Melbourne to change the depot address to 169 City Road, South Melbourne.

Dated 24 November 1994

JEFF DALMAN
Section Leader—Vehicle Licensing

**Transport Act 1983
ROADS CORPORATION**

Commercial Passenger Vehicle Application

Notice is hereby given that the following application(s) will be considered by the Roads Corporation after 28 December 1994.

Notice of any objection to the granting of an application should be forwarded to reach the Manager, Morwell Registration and Licensing Office, PO Box 558, Morwell 3840, or any District Office of the Roads Corporation not later than 22 December 1994.

It will not be necessary for interested parties to appear on the date specified unless advised in writing by the Corporation.

Applications which are objected to will be determined by the Roads Corporation.

P. J. Redmond, Yarragon. Application for variation of the conditions of licences SV 133 and SV 323 which authorises the licensed vehicles to operate as a commercial passenger vehicle along the following routes:

- (a) Between Yarragon Railway Station and the licence holder's guest house/holiday farm at Allambie Reserve;
- (b) On Excursions to points of interest within an 80 km radius of the said guest house;

to vary the conditions as follows:

To Delete: Yarragon Railway Station.

To Add: Trafalgar and Yarragon Railway Stations.

Dated 18 November 1994

NORM BUTLER
Regional Manager
Eastern Region

Victoria Government Gazette

**Transport Act 1983
ROADS CORPORATION**

Commercial Passenger Vehicle Applications

Notice is hereby given that the following applications will be considered by the Roads Corporation after 28 December 1994.

Notice of any objection to the granting of an application should be forwarded to reach the Manager, Registration and Licensing Office, Fyans Street, South Geelong 3220 or any District Office of the Roads Corporation not later than 22 December 1994.

It will not be necessary for interested parties to appear on the date specified, unless advised in writing by the Corporation.

L. C. and J. M. Trevaskis, Marshall. Application for variation of the conditions of licences SV 1034 and SV 1049 which authorise the licensed vehicles to operate as special purpose vehicles for the carriage of passengers for wedding parties from within a radius of 50 km of the Geelong Post Office to include the ability to operate for the carriage of passengers for weddings throughout the State of Victoria, social events and tourist activities.

Dated 24 November 1994

COLIN KOSKY
Regional Manager—South Western Region

**Planning and Environment Act 1987
ALBERTON PLANNING SCHEME
Notice of Approval of Amendment
Amendment L38**

The Minister for Planning has approved Amendment L38 to the Alberton Planning Scheme.

The amendment comes into operation on the date this notice is published in the Government Gazette.

The site specific amendment permits the development and use of 0.695 hectares of land zoned 'Agricultural' as a dwelling.

A copy of the amendment can be inspected free of charge during office hours at the offices of the Shire of Alberton, 156 Grant Street Yarram and at the Department of Planning and Development, 477 Collins Street, Melbourne.

GEOFF CODE
Manager
Planning Co-ordination Branch
Department of Planning and Development

Planning and Environment Act 1987
BAIRNSDALE (CITY) PLANNING SCHEME
Notice of Approval of Amendment
Amendment L39

The Minister for Planning has approved Amendment L39 to the Bairnsdale (City) Planning Scheme.

The amendment comes into operation on the date this notice is published in the Government Gazette.

The amendment removes the Public Purposes 6 (Road Construction Authority) reservation from 0.5286 hectares of land in Main Street, Bairnsdale and rezones the land to Residential A.

A copy of the amendment can be inspected free of charge during office hours at the offices of the City of Bairnsdale, 273 Main Street, Bairnsdale and at the Department of Planning and Development, 477 Collins Street, Melbourne.

GEOFF CODE
Manager
Planning Co-ordination Branch
Department of Planning and Development

Planning and Environment Act 1987
BAIRNSDALE (SHIRE) PLANNING SCHEME
Notice of Approval of Amendment
Amendment L49

The Minister for Planning has approved Amendment L49 to the Bairnsdale (Shire) Planning Scheme.

The amendment comes into operation on the date this notice is published in the Government Gazette.

The amendment introduces the use 'Bed and Breakfast' into the scheme as a use not subject to a permit provided it complies with the provisions of Clause 9-1.

A copy of the amendment can be inspected free of charge during office hours at the offices of the Shire of Bairnsdale, 49 McCulloch Street, Bairnsdale and at the Department of Planning and Development, 477 Collins Street, Melbourne.

GEOFF CODE
Manager
Planning Co-ordination Branch
Department of Planning and Development

Planning and Environment Act 1987
OXLEY PLANNING SCHEME
Notice of Approval of Amendment
Amendment L11

The Minister for Planning has approved Amendment L11 to the Local Section of the Oxley Planning Scheme.

The amendment comes into operation on the date this notice is published in the Government Gazette.

The amendment rezones 0.2 hectares of land at the intersection of the Wangaratta-Whitfield Road and Boggy Creek Road to the south of Moyhu from Public Use Zone No. 2 to Rural 1 (General Farming).

A copy of the amendment can be inspected free of charge during office hours at the Department of Planning and Development, Ground Floor, 477 Collins Street, Melbourne and at the offices of the Shire of Oxley, 22 Rowan Street, Wangaratta.

GEOFF CODE
Manager
Planning Co-ordination Branch
Department of Planning and Development

Planning and Environment Act 1987
ROCHESTER PLANNING SCHEME
Notice of Approval of Amendment
Amendment L12

The Minister for Planning has approved Amendment L12 to the Local Section of the Rochester Planning Scheme.

The amendment comes into operation on the date this notice is published in the Government Gazette.

The amendment rezones approximately 0.16 hectares of land from Residential Zone to Business Zone.

A copy of the amendment can be inspected free of charge during office hours at the Department of Planning and Development, Ground Floor, 477 Collins Street, Melbourne; Department of Planning and Development, 426 Hargreaves Street, Bendigo and at the offices of the Shire of Rochester, Mackay Street, Rochester.

GEOFF CODE
Manager
Planning Co-ordination Branch
Department of Planning and Development

3112 G 47 24 November 1994

Planning and Environment Act 1987
RUTHERGLEN PLANNING SCHEME
Notice of Approval of Amendment
Amendment L6

The Minister for Planning has approved Amendment L6 to the Local Section of the Rutherglen Planning Scheme.

The amendment comes into operation on the date this notice is published in the Government Gazette.

The amendment rezones an area of 29.1 hectares at the south-east corner of Sheridans Bridge Road and Herrin Street, Rutherglen from Rural to Rural Residential.

A copy of the amendment can be inspected free of charge during office hours at the Department of Planning and Development, Ground Floor, 477 Collins Street, Melbourne and at the offices of the Shire of Rutherglen, Shire Offices, Rutherglen.

GEOFF CODE
Manager

Planning Co-ordination Branch
Department of Planning and Development

Planning and Environment Act 1987
HASTINGS PLANNING SCHEME
Notice of Approval of Amendment
Amendment L21

The Minister for Planning has approved Amendment L21 to the Hastings Planning Scheme.

The amendment comes into operation on the date this notice is published in the Government Gazette.

The amendment will remove the LPG Tanker loading limit imposed on Esso's LPG tanker loading facility.

A copy of the amendment can be inspected free of charge during the office hours at the offices of the Shire of Hastings, Marine Parade, Hastings and at the Department of Planning and Development, 477 Collins Street, Melbourne.

GEOFF CODE
Manager

Planning Co-ordination Branch
Department of Planning and Development

Victoria Government Gazette

Planning and Environment Act 1987
SHEPPARTON CITY PLANNING SCHEME
Notice of Approval of Amendment
Amendment L53

The Minister for Planning has approved Amendment L53 to the Local Section of the Shepparton City Planning Scheme.

The amendment comes into operation on the date this notice is published in the Government Gazette.

The amendment rezones land in Nixon and Maude Streets to extend the Residential A1 Zone and to correct a mapping error. Ordinance corrections are also carried out to remove anomalies in the Residential A1 Zone, the provisions relating to advertising signs in that zone and in respect to professional consulting rooms.

A copy of the amendment can be inspected free of charge during office hours at the Department of Planning and Development, Ground Floor, 477 Collins Street, Melbourne and at the offices of the City of Shepparton, Welsford Street, Shepparton.

GEOFF CODE
Manager

Planning Co-ordination Branch
Department of Planning and Development

Planning and Environment Act 1987
TAMBO PLANNING SCHEME
Notice of Approval of Amendment
Amendment L63

The Minister for Planning has approved Amendment L63 to the Tambo Planning Scheme.

The amendment comes into operation on the date this notice is published in the Government Gazette.

The site specific amendment allows the existing dining room at the Bancroft Bay Boatel to be used as a restaurant. The amendment also clarifies the permit requirements for shops in the Tourist Zone and flats in the Commercial Zone in Lakes Entrance.

A copy of the amendment can be inspected free of charge during office hours at the offices of the Shire of Tambo, 55 Palmers Road, Lakes Entrance and at the Department of Planning and Development, 477 Collins Street, Melbourne.

GEOFF CODE
Manager

Planning Co-ordination Branch
Department of Planning and Development

Planning and Environment Act 1987
WHITTLESEA PLANNING SCHEME
Notice of Amendment
Amendment L108

The Minister for Planning has prepared Amendment L108 to the Local Section of the Whittlesea Planning Scheme.

The amendment rezones approximately 30 hectares of land east of Development Boulevard, South Morang, and adjacent to the Plenty Gorge Metropolitan Park, from a Latrobe Research and Development Zone to a Reserved Living Zone. The amendment also introduces an overlay control, "Plenty River Precinct", at Clause 140A to ensure the integrated residential development of the land. The overlay control provides for an overall development plan to be approved before the land can be residentially subdivided.

A copy of the amendment can be inspected free of charge during office hours, at the offices of the Department of Planning and Development, Ground Floor, 477 Collins Street, Melbourne and the City of Whittlesea, Civic Centre, Ferres Boulevard, South Morang.

Submissions about the amendment must be sent to the Minister for Planning, Attention: Planning Co-ordination Branch, PO Box 2240T, Melbourne 3001 (or fax 628 5132) by 23 December 1994.

GEOFF CODE
Manager
Planning Co-ordination Branch
Department of Planning and Development

Planning and Environment Act 1987
BOX HILL PLANNING SCHEME
Notice of Approval of Amendment
Amendment L21

The Minister for Planning has approved Amendment L21 to the Local Section of the Box Hill Planning Scheme.

The amendment comes into operation on the date this notice is published in the Government Gazette.

The amendment rezones 1.88 hectare of land, being the former Box Hill Primary School site, described as Lot 16A, Parish of Nunawading, Station Street, Box Hill from the existing Public Purposes Reservation to a Residential C zone.

A copy of the amendment can be inspected free of charge during office hours at the Department of Planning and Development, Ground Floor, 477 Collins Street, Melbourne and the office of the City of Box Hill, 1022 Whitehorse Road, Box Hill.

GEOFF CODE
Manager
Planning Co-ordination Branch
Department of Planning and Development

Planning and Environment Act 1987
SOUTH MELBOURNE PLANNING SCHEME
Notice of Approval of Amendment
Amendment L93

The Minister for Planning has approved Amendment L93 to the Local Section of the South Melbourne Planning Scheme.

The amendment comes into operation on the date this notice is published in the Government Gazette.

It includes land bounded by Whiteman Street, Clarke Street, Haig Street and Kings Way, and land in Kings Way between Kavanagh Street and Miles Street, South Melbourne in the Melbourne Casino zone.

A copy of the amendment can be inspected free of charge during office hours at the Department of Planning and Development, Ground Floor, 477 Collins Street, Melbourne and at the offices of the City of Melbourne, 7th Floor, Council House, 200 Little Collins Street, Melbourne.

GEOFF CODE
Manager
Planning Co-ordination Branch
Department of Planning and Development

Planning and Environment Act 1987
MELBOURNE PLANNING SCHEME
Notice of Approval of Amendment
Amendment L150

The Minister for Planning has approved Amendment L150 to the Local Section of the Melbourne Planning Scheme.

The amendment comes into operation on the date this notice is published in the Government Gazette.

The amendment amends the arrangements for administering and enforcing the scheme.

3114 G 47 24 November 1994

Victoria Government Gazette

A copy of the amendment can be inspected free of charge during office hours at the Department of Planning and Development, Ground Floor, 477 Collins Street, Melbourne; the offices of the City of Melbourne, 7th Floor, Council House, 200 Little Collins Street, Melbourne; the offices of the City of Essendon, corner of Kellaway Avenue and Pascoe Vale Road, Moonee Ponds and the offices of the City of Yarra, 140 Hoddle Street, Abbotsford.

GEOFF CODE

Manager

Planning Co-ordination Branch

Department of Planning and Development

**Planning and Environment Act 1987
SOUTH MELBOURNE PLANNING
SCHEME**

**Notice of Approval of Amendment
Amendment L80**

The Minister for Planning has approved Amendment L80 to the Local Section of the South Melbourne Planning Scheme.

The amendment comes into operation on the date this notice is published in the Government Gazette

The amendment amends the arrangements for administering and enforcing the scheme.

A copy of the amendment can be inspected free of charge during office hours at the Department of Planning and Development, Ground Floor, 477 Collins Street, Melbourne; the offices of the City of Port Phillip, corner of Brighton Road and Carlisle Street, St Kilda and at the offices of the City of Melbourne, 7th Floor, Council House, 200 Little Collins Street, Melbourne.

GEOFF CODE

Manager

Planning Co-ordination Branch

Department of Planning and Development

**Planning and Environment Act 1987
PORT MELBOURNE PLANNING SCHEME**

**Notice of Approval of Amendment
Amendment L10**

The Minister for Planning has approved Amendment L10 to the Local Section of the Port Melbourne Planning Scheme.

The amendment comes into operation on the date this notice is published in the Government Gazette.

The amendment amends the arrangements for administering and enforcing the scheme.

A copy of the amendment can be inspected free of charge during office hours at the Department of Planning and Development, Ground Floor, 477 Collins Street, Melbourne; the offices of the City of Port Phillip, corner of Brighton Road and Carlisle Street, St Kilda and the offices of the City of Melbourne, 7th Floor, Council House, 200 Little Collins Street, Melbourne.

GEOFF CODE

Manager

Planning Co-ordination Branch

Department of Planning and Development

**Planning and Environment Act 1987
ESSENDON PLANNING SCHEME
Notice of Approval of Amendment
Amendment L49**

The Minister for Planning has approved Amendment L49 to the Local Section of the Essendon Planning Scheme.

The amendment comes into operation on the date this notice is published in the Government Gazette.

The amendment amends the arrangements for administering and enforcing the scheme.

A copy of the amendment can be inspected free of charge during office hours at the Department of Planning and Development, Ground Floor, 477 Collins Street, Melbourne; the offices of the City of Essendon, corner of Kellaway Avenue and Pascoe Vale Road, Moonee Ponds and the offices of the City of Melbourne, 7th Floor, Council House, 200 Little Collins Street, Melbourne.

GEOFF CODE

Manager

Planning Co-ordination Branch

Department of Planning and Development

**Mineral Resources Development
(Amendment) Act 1993
ALL PLANNING SCHEMES IN VICTORIA
Notice of Approval of Amendment
Amendment S26**

The Minister for Planning has approved the above amendment.

The amendment comes into operation on the date this notice is published in the Government Gazette.

The amendment has been approved by the Minister for Planning under sections 22 and 23 of the **Mineral Resources Development (Amendment) Act 1993** and amends the State section of all planning schemes.

The amendment follows the introduction of the **Mineral Resources Development (Amendment) Act 1993** and:

- * Replaces the existing State section definitions related to mineral exploration and mining with new definitions specified in the **Mineral Resources Development Act 1990**. The new definitions will prevail over any other definition regarding these activities specified in regional or local sections of all planning schemes.
- * Introduces a policy statement which provides a positive basis for encouragement of exploration and mining in Victoria.
- * Incorporates provisions of the **Mineral Resources Development (Amendment) Act 1993** so that:
 - mineral exploration is not subject to planning controls;
 - mining is not a prohibited land use in any zone; and
 - a planning permit is not required where a mining project has been subject to an environmental assessment in accordance with the provisions of the **Environment Effects Act 1978**.

A copy of the amendment can be inspected free of charge during office hours at the Department of Planning and Development, Ground Floor, 477 Collins Street, Melbourne; the Upper Yarra Valley and Dandenong Ranges Authority, 5 John Street, Lilydale; the Loddon-Campaspe Regional Planning Authority, 391 Hargreaves Street, Bendigo; the Alpine Resorts Commission, Level 4, AMEV House, 1013 Whitehorse Road, Box Hill; the Latrobe Regional Commission, 43 Grey Street, Traralgon and at the office of each municipal Council in Victoria.

GEOFF CODE
Manager
Planning Co-ordination Branch
Department of Planning and Development

Planning and Environment Act 1987
METROPOLITAN REGION PLANNING
SCHEMES

Notice of Approval of Amendment
Amendment RL155

The Minister for Planning has approved Amendment RL155 to the Regional and Local Sections of all planning schemes in the Metropolitan Region.

The amendment comes into operation on the date this notice is published in the Government Gazette.

The amendment affects the status of cafe, restaurant and take-away food premises in a variety of zones.

It specifies take-away food premises as a use which requires a permit in many residential zones subject to a condition requiring a main or secondary road location. A new clause requires responsible authorities to consider specified matters directed to ensuring that the use is appropriate for a particular site.

It also specifies a cafe and a restaurant as permitted uses in most business zones.

A copy of the amendment can be inspected free of charge during office hours at the Department of Planning and Development, Ground Floor, 477 Collins Street, Melbourne and the offices of each Council in the Metropolitan Region.

GEOFF CODE
Manager
Planning Co-ordination Branch
Department of Planning and Development

Planning and Environment Act 1987
METROPOLITAN REGION PLANNING
SCHEMES

Notice of Approval of Amendment
Amendment R119

The Minister for Planning has approved Amendment R119 to the Local Sections of most planning schemes in the Metropolitan Region.

The amendment comes into operation on the date this notice is published in the Government Gazette.

The amendment repeals controls over shop trading hours.

A copy of the amendment can be inspected free of charge during office hours at the offices of the Department of Planning and Development, Ground Floor, 477 Collins Street, Melbourne and at the offices of each Council in the Metropolitan Region.

GEOFF CODE
Manager
Planning Co-ordination Branch
Department of Planning and Development

Country Fire Authority Act 1958 DECLARATION OF FIRE DANGER PERIOD

In pursuance of the powers conferred by section 4 of the Country Fire Authority Act 1958, I, Leonard Raymond Foster, Chairman of the Country Fire Authority, after consultation with the Secretary of Conservation and Natural Resources, hereby declare the following periods to be the Fire Danger Period in the areas that, at the time of declaration, comprise or comprised the municipal districts of the municipalities listed below, or where part of a municipality is listed below, the area that, at the time of declaration, comprised part of that municipality, the Fire Danger Period commencing on the relevant date shown and ending on 0100 hours on Friday, 1 May 1995, unless varied by subsequent declaration.

The Fire Danger Period in all areas specified below commences at 0100 hours on Monday, 28 November 1994.

Shire of Mitchell

The Fire Danger Period in all areas specified below commences at 0100 hours on Monday, 5 December 1994.

Shire of Murrindindi

Shire of Dimboola (Southern Part): That part South of the wire netting fence

Shire of Wimmera

Shire of Warracknabeal

City of Horsham

In pursuance of the powers conferred by section 4 of the Country Fire Authority Act 1958, I, Leonard Raymond Foster, Chairman of the Country Fire Authority, after consultation with the Secretary of Conservation and Natural Resources, hereby declare the following periods to be the Fire Danger Period in the areas that, as at 14 November 1994, comprise or comprised the municipal districts of the municipalities listed below, or where part of a municipality is

listed below, the area that, as at 14 November 1994, comprised part of that municipality, the Fire Danger Period commencing on the relevant date shown below and ending on 0100 hours on Friday, 1 May 1995, unless varied by subsequent declaration.

The Fire Danger Period in all the areas specified below commences on 0100 hours on Monday, 28 November 1994.

City of Mildura

Shire of Mildura

Shire of McIvor

City of Swan Hill

Shire of Swan Hill

Shire of Karkarooc

Shire of Dimboola (Northern Part) That part North of the wire netting fence.

Shire of Wycheproof (Northern Part): That part North of the boundary commencing at the Wycheproof Shire boundary at the intersection of Broads Road and Hopetoun-Sea Lake Road, thence north-easterly and easterly by Hopetoun-Sea Lake Road to the intersection of Boigbeat West Road, thence easterly by Boigbeat East Road and Boigbeat West Road to the intersection of Sea Lake-Springfield Road, thence northerly by Sea Lake-Springfield Road the intersection of Ryans Road, thence easterly by Ryans Road to the intersection of Culgoa-Ultima Road, and thence north easterly Culgoa-Ultima Road to the Shire boundary.

L. R. FOSTER
Chairman

Water Act 1989

I, Charles Geoffrey Coleman, as Minister administering the Water Act 1989, make the following Order:

CONSTITUTION OF THE LOWER GOULBURN WATERWAY MANAGEMENT AUTHORITY ORDER 1994

1. This Order is called the Constitution of the Lower Goulburn Waterway Management Authority Order 1994.

2. This Order is made under the powers conferred by Division 2 of Part 6 of the Water Act 1989 and all other available powers.

3. This Order takes effect on the date on which it is published in the Government Gazette.

4. In this Order, "Act" means the Water Act 1989.

5. On and from the date on which this Order takes effect:

- (a) A new waterway management authority is constituted;
- (b) The corporate name of the new waterway management authority is the Lower Goulburn Water Management Authority;
- (c) The Lower Goulburn Waterway Management Authority takes over all property, rights, liabilities, obligations, powers and functions of the Shire of Rodney under the Act in relation to the Lower Goulburn Waterway Management District;
- (d) The Shire of Rodney is abolished as an Authority under the Act.

6. The Membership of the Lower Goulburn Waterway Management Authority is:

1 member elected by the Shire of Deakin	} or the appropriate successor body
1 member elected by the Shire of Nathalia	
1 member elected by the Shire of Rodney	
1 member elected by the Shire of Shepparton	
1 member elected by the City of Shepparton	
and	
5 members appointed by the Minister	

7. (a) This is an Order referred to in section 98 (2) (a) of the Act.

(b) Under section 100 (2) (a) of the Act, the affected Authority, the Shire of Rodney, has applied to me for this Order to be made.

(c) Under section 98 (2) (a) of the Act, I have agreed the terms and conditions with the affected Authority, the Shire of Rodney.

(d) Under section 100 (2) (b) (i) of the Act, I have consulted with the Minister administering the Local Government Act 1989.

Dated 15 November 1994

GEOFF COLEMAN
Minister administering the Water Act 1989

Water Act 1989

I, Charles Geoffrey Coleman, as Minister administering the Water Act 1989, make the following Order:

ORDER AMENDING THE "MID-GOULBURN RIVER MANAGEMENT BOARD CHANGE OF CORPORATE NAME ORDER 1993"

1. This Order is called the Order amending the "Mid-Goulburn River Management Board Change of Corporate Name Order 1993".

2. This Order is made under the powers conferred by Division 2 of Part 6 of the Water Act 1989 and all other available powers.

3. This Order takes effect on the date on which it is published in the Government Gazette.

4. On and from the date on which this Order takes effect, Section 5 of the Mid-Goulburn River Management Board Change of Corporate Name Order 1993, published in the Government Gazette on 22 July 1993, is rescinded and is replaced by the following:

"5. The name of the Mid-Goulburn River Management District is changed to the North Central Waterways Management District and is under the management and control of the North Central Waterways Management Board."

5. This is an Order referred to in section 99 of the Act.

Dated 17 November 1994

GEOFF COLEMAN
Minister administering the Water Act 1989

Adoption Act 1984 RENEWAL OF APPROVAL AS AN ADOPTION AGENCY Section 26

Under the provisions of section 10 (2) of the Community Services Act 1970 I have been assigned the functions and powers of the Secretary of Health and Community Services under section 26 of the Adoption Act 1984.

After considering applications from the following welfare organisations who wish to continue as "approved agencies" for the purpose of conducting negotiations and making arrangements for the adoption of children, I, Robin Clark, renew their approval as adoption agencies in accordance with section 26 of the Adoption Act 1984.

Catholic Family Welfare Bureau, CFWB Adoption Services, 576 Victoria Parade, East Melbourne. Principal Officer: Mary Ellen Ralph, Deputy Principal Officer: Janet Allen.

3118 G 47 24 November 1994

Western Family Services, Mission of St James and St John, Western Family Services Permanent Care Program, 41 Somerville Road, Yarraville. Principal Officer: Julie Raunik, Deputy Principal Officer: Melissa Watts.

Copelen Child and Family Services of the Uniting Church, Copelen Child and Family Services, Adoption and Permanent Care Program, 12 Copelen Street, South Yarra. Principal Officer: Chris Kealy, Deputy Principal Officer: Jill Wain.

Gippsland Family Services, Mission of St James and St John, 65 Church Street, Morwell. Principal Officer: Julie Hardy, Deputy Principal Officer: Georgina Lazaris.

Jewish Welfare Society Incorporated, Jewish Welfare Society, 26 Alma Road, St Kilda. Principal Officer: Miriam Suss, Deputy Principal Officer: Jodie Beizer.

LDS Social Services Corporation, LDS Social Services, 331 Jasper Road, Ormond. Principal Officer: Peter Le Roy Howell, Deputy Principal Officer: Vincent Meisner.

These approvals have effect for a period of three years from the date of this notice unless suspended or revoked at an earlier date.

ROBIN CLARK
Acting Director
Child, Adolescent and Family Welfare Division

**Land Acquisition and Compensation
Act 1986**

**Transport Act 1983
NOTICE OF ACQUISITION**

Compulsory Acquisition of Interest in Land

The Roads Corporation declares that by this notice it acquires the following interests in the land described hereunder:

Interested Parties: Andrew Milonas and George Papadopoulos (Freehold), Australia and New Zealand Banking Group Limited (Mortgagee in Possession) and Steve Lucas (Lessee).

Description of Land: Lot 309 on Plan of Subdivision No. 13021, Parish of Doutta Galla.

Area: 577 square metres.

Title Details: Certificate of Title Volume 8998 Folio 052.

Survey Plan No.: 18858.

Victoria Government Gazette

The survey plan referred to in this notice may be viewed at Property Services Department, Vic Roads, 4th Floor, Materials Building, 60 Denmark Street, Kew.

Published with the authority of the Roads Corporation and the Minister for Roads and Ports.

T. H. HOLDEN
Manager, Property Services
Roads Corporation

Cattle Compensation Act 1967 (No. 7615)

APPROVED AGENT

Notice under Section 14

I hereby declare David Richard Goldby, Jan Kaye Goldby and Michael John Goldby, trading as South West Farmers, (No. C.S. 222 in the Register) being a person carrying on business as a Stock and Station Agent, to be an "Approved Agent" for the purposes of Part II of the Cattle Compensation Act 1967 with effect from 1 September 1994.

B. R. WILKES
Delegate of Commissioner of State Revenue

Co-operation Act 1981

**BACCHUS MARSH WORKERS CO-
OPERATIVE LTD**

CARRUM CO-OPERATIVE LIMITED

**McEWAN RESERVE NETBALL CO-
OPERATIVE LIMITED**

**SCALLOP FISHERMEN'S CO-OPERATIVE
LIMITED**

Notice is hereby given in pursuance of section 192 (8) of the Co-operation Act 1981 and section 572 (2) of the Corporations Act 1989 that, at the expiration of three months from the date hereof, the names of the aforementioned societies will, unless cause is shown to the contrary, be struck off the register and the societies will be dissolved.

Dated at Melbourne on 17 November 1994.

K. N. FLOWERS
Acting Deputy Registrar of Co-operatives

Friendly Societies Act 1986

ERRATUM

Notice of Approval of Investment

The second paragraph of the notice that appeared in Gazette No. 46 dated 17 November 1994, page 3051, reads "The Corporation has at all times during the two years prior to making

the investment has a paid up share capital of not less than \$25,000" should have read "The Corporation has at all times during the two years prior to making the investment has a paid up share capital of not less than \$25,000,000."

Education Act 1958
CONSTITUTION OF A SCHOOL COUNCIL
FOR THE BRENTWOOD PARK PRIMARY
SCHOOL

Pursuant to section 13 (1) of the **Education Act 1958**, I give notice that an Order of the Governor in Council was made on 22 November 1994 to constitute a school council for the Brentwood Park Primary School.

DON HAYWARD
Minister for Education

Education Act 1958
CONSTITUTION OF A SCHOOL COUNCIL
FOR THE COURTENAY GARDENS
PRIMARY SCHOOL

Pursuant to section 13 (1) of the **Education Act 1958**, I give notice that an Order of the Governor in Council was made on 22 November 1994 to constitute a school council for the Courtenay Gardens Primary School.

DON HAYWARD
Minister for Education

Education Act 1958
CONSTITUTION OF A SCHOOL COUNCIL
FOR THE PAKENHAM EAST PRIMARY
SCHOOL

Pursuant to section 13 (1) of the **Education Act 1958**, I give notice that an Order of the Governor in Council was made on 22 November 1994 to constitute a school council for the Pakenham East Primary School.

DON HAYWARD
Minister for Education

Education Act 1958
CONSTITUTION OF A SCHOOL COUNCIL
FOR THE SOMERVILLE WEST PRIMARY
SCHOOL

Pursuant to section 13 (1) of the **Education Act 1958**, I give notice that an Order of the Governor in Council was made on 22 November 1994 to constitute a school council for the Somerville West Primary School.

DON HAYWARD
Minister for Education

Subordinate Legislation Act 1962
Control of Weapons Act 1990
PROPOSED CONTROL OF WEAPONS
(KNIVES) REGULATIONS 1994

I, Patrick McNamara, Minister for Police and Emergency Services give notice under the **Subordinate Legislation Act 1962** that I have decided that the proposed Control of Weapons (Knives) Regulations 1994 be made without amendment.

A Regulatory Impact Statement was prepared and advertised inviting public comment and submissions. No comment or submissions were received.

PATRICK McNAMARA
Minister for Police and Emergency Services

ORDERS IN COUNCIL

**Historic Buildings Act 1981 (No. 9667)
AMENDMENT OF REGISTER OF
HISTORIC BUILDINGS**

Under section 14 of the **Historic Buildings Act 1981** the Governor in Council amends the Register by adding Historic Building No. 1021: "Coliban Water Supply System", commencing at the Upper Coliban Reservoir, 8 km south west of Kyneton, and concluding at Kangaroo Flat, 8 km south of Bendigo.

(To the extent of:

1. The buildings works and structures known as the Coliban Water Supply system including:

Upper Coliban Reservoir Outlet Tower, a brick and concrete structure at the upstream end of the outlet conduit. C-1 on Plan 605361(A)/1, AMG Co-ordinates 2-69-000 E, 58-70-155 N, Photograph 605361(B)/1 and Coliban Water Authority Storages and Main Channel Heritage Asset No. 1.

Upper Coliban Reservoir Bye-wash from downstream of the Ogee spillway apron constructed in 1993 to the final drop north of the road bridge (including the large drop structure, cascade steps, grouted bluestone pitchers in the Bye-wash floor, brick training walls with bluestone coping and arched brick road bridge). C-2 on Plan 605361(A)/1, AMG Co-ordinates 2-69-160 E, 58-70-160 N, Photograph 605361(B)/2 and Coliban Region Water Authority Storages and Main Channel Heritage Asset No. 2.

Malmsbury Reservoir Eastern Bye-wash from immediately downstream of the spillway gates to the end of the bluestone lined bye-wash, including the bluestone bye-wash floor, training walls, drop structure, cascades, and rendered transverse buttress wall with bluestone coping on the west side. But excluding the spillway gates, piers and steel superstructure. C-3 on Plan 605361(A)/2, AMG Co-ordinates 2-67-520 E, 58-79-900 N, Photograph 605361(B)/3 and Coliban Region Water Authority Storages and Main Channel Heritage Asset No. 3.

Malmsbury Reservoir Outlet Tunnel and Channel including the bluestone lined tunnel, the bluestone lined outlet channel to both the Coliban Main Channel and to the Coliban River, and the remnants of the cast iron regulating gates for controlling flows to the Coliban River and

the Main Channel. But excluding the concrete invert placed inside the bluestone channel in 1989. CA on Plan 605361(A)/3, AMG Co-ordinates 2-67-000 E, 58-80-100 N, Photograph 605361(B)/4 and Coliban Region Water Authority Storages and Main Channel Heritage Asset No. 4.

Malmsbury Reservoir Outlet Tower and Cast Iron Access Bridge. C-5 on Plan 605361(A)/3, AMG Co-ordinates 2-67-000 E, 58-80-000 N, Photograph 605361(B)/5 and Region Water Authority Storages and Main Channel Heritage Asset No. 5.

Malmsbury Reservoir Embankment, an earth fill dam with a puddle clay core. C-6 on Plan 605361(A)/2, AMG Co-ordinates 2-67-250 E, 58-80-050 N, Photograph 605361(B)/6 and Coliban Regional Water Authority Storages and Main Channel Heritage Asset No. 6.

Arched Brick Culvert under the Calder Highway including the brick head walls and the curved brick transition walls with bluestone copings. C-7 on Plan 605361(A)/2, AMG Co-ordinates 2-67-130 E, 58-80-890 N, Main channel running distance 0.9 km, Photograph 605361(B)/7 and Coliban Region Water Authority Storages and Main Channel Heritage Asset No. 7.

No. 1 Tunnel which is brick lined and has bluestone portals. C-8 on Plan 605361(A)/4, AMG Co-ordinates 2-65-200 E, 58-82-900 N, Main Channel Running Distance of 5.378 km, Photograph 605361(B)/8 and Coliban Region Water Authority Storages and Main Channel Heritage Asset No. 8.

Back Creek Syphon Inlet Structure including the bluestone structures, cast iron sluice gates and brick lined inlet channel. But excluding the galvanised steel walkways, trash racks and safety girds, mesh security fence, concrete diaphragm walls and drop bar slots. C-9 on Plan 605361(A)/4, AMG Co-ordinates 2-63-560 E, 58-82-760 N, Main Channel Running Distance of 5.735 km, Photograph 605361(B)/9 and Coliban Region Water Authority Storages and Main Channel Heritage Asset No. 9.

Back Creek Syphon Outlet Structure including the bluestone structures but excluding the steel grid-mesh flooring and its angle iron frame. C-10 on Plan 605361(A)/4, AMG Co-

ordinates 2-64-020 E, 58-82-850 N, Main Channel Running Distance of 6-344 km, Photograph 605361(B)/10 and Coliban Region Water Authority Storages and Main Channel Heritage Asset No. 10.

Stone In-chute erosion control structure where surface water run-off enters the Main Channel. C-11 on Plan 605361(A)/4, AMG Co-ordinates 2-62-420 E, 58-83-100 N, Main Channel Running Distance of 9-33 km, Photograph 605361(B)/11 and Coliban Region Water Authority Storages and Main Channel Heritage Asset No. 11.

Brick Abutments of old flume which took the Coliban Main Channel over a creek. C-12 on Plan 605361(A)/4, AMG Co-ordinates 2-62-320 E, 58-83-050 N, Main Channel Running Distance of 9-434 km, Photograph 605361(B)/12 and Coliban Region Water Authority Storages and Main Channel Heritage Asset No. 12.

Arched brick lined tunnel 42 m long with brick portals topped with bluestone copings. C-13 on Plan 605361(A)/4, AMG Co-ordinates 2-62-240 E, 58-84-240 N, Main Channel Running Distance from 12-073 to 12-115 km, Photograph 605361(B)/13 and Coliban Region Water Authority Storages and Main Channel Heritage Asset No. 13.

Brick, bluestone and concrete creek over-chute. An arched brick culvert takes the channel under a creek, the bed of which is lined with bluestone immediately down stream of the channel. The upper sections of the transition walls are made of concrete. C-14 on Plan 605361(A)/4, AMG Co-ordinates 2-62-580 E, 58-86-060 N, Main Channel Running Distance of 15-395 km, Photograph 605361(B)/14 and Coliban Region Water Authority Storages and Main Channel Heritage Asset No. 14.

Box Section Brick flume, 1-8 m wide by 1-5 m deep. A concrete addition raised the height of each wall. Includes a 0-75 m, brick drainage conduit with brick head walls and stone copings, and brick transitions between the trapezoidal section of the channel and the box section of the flume. C-15 on Plan 605361(A)/5, AMG Co-ordinates 2-63-620 E, 58-88-830 N, Main Channel Running Distance of 19-64 km, Photograph 605361(B)/15 and Coliban Region Water Authority Storages and Main Channel Heritage Asset No. 15.

Harcourt Main Channel Tunnel which is brick lined and includes four brick lined

air/access shafts each with a bluestone coping. C-16 on Plan 605361(A)/5, AMG Co-ordinates 2-59-940 E, 58-94-160 N, approximately 600 metres of the junction of the Main and Harcourt channels, Photographs 605361(B)/16 and 16a and Coliban Region Water Authority Storages and Main Channel Heritage Asset No. 16.

Expedition Pass Reservoir Embankment, an earth fill dam with puddle clay core. C-17 on Plan 605361(A)/6, AMG Co-ordinates 2-57-500 E, 58-95-700 N, Photograph 605361(B)/17 and 17a and Coliban Region Water Authority Storages and Main Channel Heritage Asset No. 17.

Expedition Pass Reservoir Outlet Tower, a cast iron structure bolted together positioned above the upstream guard valve of the outlet conduit. C-18 on Plan 605361(A)/6, AMG Co-ordinates 2-57-560 E, 58-95-680 N, Photograph 605361(B)/18 and Coliban Region Water Authority Storages and Main Channel Heritage Asset No. 18.

Expedition Pass Reservoir Outlet Conduit, Regulating Valve, and Outlet Portal. C-19 on Plan 605361(A)/7, AMG Co-ordinates 2-57-500 E, 58-95-650 N, Photograph 605361(B)/19 and Coliban Region Water Authority Storages and Main Channel Heritage Asset No. 19.

Expedition Pass Reservoir Bye-wash, which is excavated through rock at the north end of the reservoir embankment and includes a granite block training wall with bluestone coping along its southern side. C-20 on Plan 605361(A)/6, AMG Co-ordinates 2-57-450 E, 58-95-800 N, Photograph 605361(B)/20 and Coliban Region Water Authority Storages and Main Channel Heritage Asset No. 20.

Sandy Creek Flume abutments and Support Piers including granite ashlar masonry abutments, trapezoidal transitions and six piers, plus the remnants of the upstream timber pier and timber stringers from the first two spans. These structures are set at a skew from the line of the channel. C-21 on Plan 605361(A)/6, AMG Co-ordinates 2-61-520 E, 58-95-650 N, Main Channel Running Distance of 29-98 km at an offset of 15 m east of the channel, Photograph 605361(B)/21 and 21a and 21b and Coliban Region Water Authority Storages and Main Channel Heritage Asset No. 21.

Granite Ashlar Masonry Wall, 110 m long on the east side of the Main Channel, constructed of granite blocks with granite coping. C-22 on Plan 605361(A)/6, AMG Co-ordinates 2-61-800 E,

58-98-800 N, Main Channel Running Distance from 34-275 to 34-385 km, Photograph 605361(B)/22 and Coliban Region Water Authority Storages and Main Channel Heritage Asset No. 22.

Granite Ashlar Masonry Flume Abutments and Granite. C-23 on Plan 605361(A)/6, AMG Co-ordinates 2-61-800 E, 58-98-900 N, Main Channel Running Distance of 34-4 km, Photograph 605361(B)/23 and Coliban Region Water Authority Storages and Main Channel Heritage Asset No. 23.

Granite Ashlar Masonry Wall, 112 m long on the west side of the Main Channel, constructed of granite blocks with granite coping. C-24 on Plan 605361(A)/6, AMG Co-ordinates 2-62-050 E, 58-99-820 N, Main Channel Running Distance from 35-565 to 35-677 km at an offset of 4 m from the Main, Photograph 605361(B)/24 and Coliban Region Water Authority Storages and Main Channel Heritage Asset No. 24.

Whiskey Gully Syphon Inlet Structure. C-25 on Plan 605361(A)/6 AMG Co-ordinates 2-61-950 E, 58-99-980 N, Main Channel Running Distance of 35-78 km at an offset of 4 m west of the Main Channel, Photograph 605361(B)/25 and Coliban Region Water Authority Storages and Main Channel Heritage Asset No. 25.

Upstream Granite Ashlar Masonry Flume Abutment. C-26 on Plan 605361(A)/6, AMG Co-ordinates 2-61-960 E, 59-00-680 N, Main Channel Running Distance of 37-168 km at an offset of 2 m east of the Main Channel, Photograph 605361(B)/26 and Coliban Region Water Authority Storages and Main Channel Heritage Asset No. 26.

Granite Ashlar Masonry Flume Foundation Wall, 85 m long, and Downstream Abutment. The downstream end of the wall terminates at the flume abutment. C-27 on Plan 605361(A)/6, AMG Co-ordinates 2-62-060 E, 59-00-700 N, Main Channel Running Distance from 37-240 to 37-325 km at an offset of 1 m east of the Main Channel, Photograph 605361(B)/27 and Coliban Region Water Authority Storages and Main Channel Heritage Asset No. 27.

Granite Ashlar Masonry Wall, 140 m long, Flume Abutments and Piers. The down stream end of the wall terminates at the upstream flume abutment. C-28 on Plan 605361(A)/6, AMG Co-ordinates 2-62-190 E, 59-01-250 N, Main Channel Running Distance from 37-87 to 38-08 km, Photograph 605361(B)/28 and Coliban

Region Water Authority Storages and Main Channel Heritage Asset No. 28.

Granite Ashlar Masonry Wall, 280 m long along the east side of the Main Channel. C-29 on Plan 605361(A)/6, AMG Co-ordinates 2-62-020 E, 59-01-750 N, Main Channel Running Distance from 38-58 to 38-86 km, Photograph 605361(B)/29 and Coliban Region Water Authority Storages and Main Channel Heritage Asset No. 29.

Byrnes Tunnel, an unlined tunnel 217 m long with granite portals. C-30 on Plan 605361(A)/7, AMG Co-ordinates 2-61-950 E, 58-02-750 N, Main Channel Running Distance from 39-603 to 39-82 km, Photograph 605361(B)/30 and Coliban Region Water Authority Storages and Main Channel Heritage Asset No. 30.

Granite Ashlar Masonry Flume Abutments and 8 Piers. C-31 on Plan 605361(A)/7, AMG Co-ordinates 2-61-540 E, 59-2-860 N, Main Channel Running Distance from 40-2 to 40-32 km, Photographs 605361(B)/31 and 31a and Coliban Region Water Authority Storages and Main Channel Heritage Asset No. 31.

Granite Ashlar Masonry Flume Abutments and 7 Piers. C-32 on Plan 605361(A)/7, AMG Co-ordinates 2-59-750 E, 59-06-650 N, Main Channel Running Distance from 45-325 to 45-41 km, Photograph 605361(B)/32 and Coliban Region Water Authority Storages and Main Channel Heritage Asset No. 32.

Wirths tunnel, 623 m long is partially lined and has granite portals. C-33 on Plan 605361(A)/7, AMG Co-ordinates 2-59-200 E, 59-08-400 N, Main Channel Running Distance from 47-072 to 47-895 km, Photograph 605361(B)/33 and Coliban Region Water Authority Storages and Main Channel Heritage Asset No. 33.

Granite Ashlar Masonry and Brick Flume Abutments and 2 Piers. C-34 on Plan 605361(A)/8, AMG Co-ordinates 2-59-000 E, 59-09-280 N, Main Channel Running Distance of 48-425 km, Photograph 605361(B)/34 and Coliban Region Water Authority Storages and Main Channel Heritage Asset No. 34.

Brennans Tunnel is unlined and 511 m long. C-35 on Plan 605361(A)/8, AMG Co-ordinates 2-59-000 E, 59-11-250 N, Main Channel Running Distance from 50-78 to 51-291 km, Photograph 605361(B)/35 and Coliban Region Water Authority Storages and Main Channel Heritage Asset No. 35.

Drop Structure, Chute and Energy Dissapater, and Upstream Brick Flume Abutment. C-36 on Plan 605361(A)/8, AMG Co-ordinates 2-58-880 E, 59-11-800 N, Main Channel Running Distance of 51.7 km, Photograph 605361(B)/36 and 36a and Coliban Region Water Authority Storages and Main Channel Heritage Asset No. 36.

Drop Structure, Chute and Energy Dissapater. C-37 on Plan 605361(A)/8, AMG Co-ordinates 2-58-650 E, 59-12-250 N, Main Channel Running Distance of 52.3 km, Photograph 605361(B)/37 and 37a and Coliban Region Water Authority Storages and Main Channel Heritage Asset No. 37.

Concrete Chute topped with granite blocks, Brick Energy Dissapater with granite coping, Brick Flume Abutments with granite coping and Granite Piers. The chute leads into the energy dissipater which adjoins the upstream flume abutment. C-38 on Plan 605361(A)/8, AMG Co-ordinates 2-58-600 E, 59-12-300 N, Main Channel Running Distance of 52.41 km, Photograph 605361(B)/38 and Coliban Region Water Authority Storages and Main Channel Heritage Asset No. 38.

Stone In-chute erosion control structure where surface run-off water enters the Main Channel. C-39 on Plan 605361(A)/9, AMG Co-ordinates 2-57-090 E, 59-15-680 N, Main Channel Running Distance of 58.646 km, Photograph 605361(B)/39 and Coliban Region Water Authority Storages and Main Channel Heritage Asset No. 39.

Stone In-chute erosion control structure where surface run-off water from a gully enters the Main Channel. C-40 on Plan 605361(A)/9, AMG Co-ordinates 2-56-000 E, 59-16-540 N, Main Channel Running Distance of 60.908 km, Photograph 605361(B)/40 and Coliban Region Water Authority Storages and Main Channel Heritage Asset No. 40.

Flow Regulator on Main Channel and Offtake Structure to the Spring Gully Channel. This structure is made of brick with granite coping and cast iron. C-41 on Plan 605361(A)/10, AMG Co-ordinates 2-54-400 E, 59-18-100 N, Main Channel Running Distance of 64.331 km, Photograph 605361(B)/41 and Coliban Region Water Authority Storages and Main Channel Heritage Asset No. 41.

Cascade of 4 steps constructed of sandstone blocks, the channel of which has been render with cement mortar, includes an In-chute at the

downstream end. C-42 on Plan 605361(A)/10, AMG Co-ordinates 2-54-300 E, 59-18-080 N, Main Channel Running Distance of 64.481 km, Photograph 605361(B)/42 and Coliban Region Water Authority Storages and Main Channel Heritage Asset No. 42.

Cascade of 7 steps and 110 m long, constructed of sandstone blocks. C-43 on Plan 605361(A)/10, AMG Co-ordinates 2-53-580 E, 59-18-400 N, Main Channel Running Distance from 65.297 to 65.407 km, Photograph 605361(B)/43 and Coliban Region Water Authority Storages and Main Channel Heritage Asset No. 43.

Granite Culvert 2.1 m high by 1.9 m wide by 21 m long under the Melbourne to Bendigo Railway with drainage in-chutes from both north and south of the Main Channel and on both the upstream and downstream sides of the culvert. C-44 on Plan 605361(A)/10, AMG Co-ordinates 2-53-480 E, 59-18-450 N, Main Channel Running Distance of 65.423 km, Photograph 605361(B)/44 and Coliban Region Water Authority Storages and Main Channel Heritage Asset No. 44.

Sluice Gate Flow Regulating Structure, brick structure with two pair of cast iron sluice gates which are rack and pinion operated. C-45 on Plan 605361(A)/10, AMG Co-ordinates 2-53-160 E, 59-19-900 N, Main Channel Running Distance of 67.778 km, Photograph 605361(B)/45 and Coliban Region Water Authority Storages and Main Channel Heritage Asset No. 45.

Sandstone section of the Coliban Main Channel from a concrete flow-measuring flume to a concrete access bridge, a length of 87 m. C-46 on Plan 605361(A)/10, AMG Co-ordinates 2-53-165 E, 59-19-980 N, Main Channel Running Distance from 67.817 to 67.904 km, Photograph 605361(B)/46 and Coliban Region Water Authority Storages and Main Channel Heritage Asset No. 46.

Barkers Creek Reservoir Embankment, an earth fill dam with puddle clay core. C-47 on Plan 605361(A)/7, AMG Co-ordinates 2-57-630 E, 59-04-940 N, Photograph 605361(B)/47 and Coliban Region Water Authority Storages and Main Channel Heritage Asset No. 47.

Barkers Creek Reservoir Outlet Tower, a cast iron structure held together by bolts. C-48 on Plan 605361(A)/7, AMG Co-ordinates 2-57-460 E, 59-05-000 N, Photograph 605361(B)/48 and

3124 G 47 24 November 1994

Coliban Region Water Authority Storages and Main Channel Heritage Asset No. 48.

2. All of that land which represents the footprint of the above structures and works shown marked on Plan 605361(A)/1-605361(A)/10 inclusive, endorsed by the Chairperson and held by the Director, Historic Buildings Council.)

Dated 22 November 1994

Responsible Minister:
ROBERT MACLELLAN
Minister for Planning

KATHY WILSON
Acting Clerk of the Executive Council

Historic Buildings Act 1981 (No. 9667)
AMENDMENT OF REGISTER OF
HISTORIC BUILDINGS

Under section 14 of the **Historic Buildings Act 1981** the Governor in Council amends the Register by adding Historic Building No. 1058:

Gelliondale Briquette Plant, corner of Coal Pit Road, South Gippsland Highway, Gelliondale.

(1. All the objects, structures and works known as the Gelliondale Briquette Plant and marked on Plan No. 600803A including the dam/open cut mine (B1), the mullock heap (B2), the trolley line (B3), the trolley line (B4), the boiler mountings (B5), the 6x6 m depression (B6), the drying system structure (B7), the concrete drying floor (B8), the steam engine mountings (B9), the concrete machinery mount (B10), the 4 m diameter circular depression (B11), the coal bunker (B12), the coal bunker (B13), the belt drive roller and mounts (B14), the briquette press (B15), the concrete post collars (B16), and the concrete footing (B17).

2. The portion of land contained in Crown Allotment 60 within a rectangle bounded on the north by the South Gippsland Highway for a distance of 180 metres, and on the west by the government road reserve for a distance of 265 metres, and marked L1 on Plan 600803B, signed by the Chairperson of the Historic Buildings Council and held by the Director, Historic Buildings Council.)

Dated 22 November 1994

Responsible Minister:
ROBERT MACLELLAN
Minister for Planning

KATHY WILSON
Acting Clerk of the Executive Council

Victoria Government Gazette

Historic Buildings Act 1981 (No. 9667)
AMENDMENT OF REGISTER OF
HISTORIC BUILDINGS

Under section 14 of the **Historic Buildings Act 1981** the Governor in Council amends the Register by amending the extent of designation of Historic Building No. 667:

Massey Ferguson Complex, Devonshire Road, Sunshine.

(From the extent of:

The whole of the site and all of the buildings shown hatched on the plan held by the Department of Planning and Development on the land comprising all of (a) Lot 2 and (b) Lot 12 on the plan of subdivision prepared by the licensed surveyor D. C. Hann (Ref 862 B/6A), Certificates of Title Volume 9644 Folio 028 and 029.

To the extent of:

1. All of the buildings known as the Massey Ferguson Complex including (B-1) clock tower, (B-2) front gates, (B-3) power station and (B-4) bulk store building marked on Plan 600502 endorsed by the Chairperson, Historic Buildings Council and held by the Director, Historic Buildings Council.

2. All of the land marked L-1 on Plan 600502 being part of the land described in Certificate of Title Volume 9644 Folios 028 and 029, excluding Lot 1 on plan of subdivision No. PS 334790D, endorsed by the Chairperson, Historic Buildings Council and held by the Director, Historic Buildings Council.)

Dated 22 November 1994

Responsible Minister:
ROBERT MACLELLAN
Minister for Planning

KATHY WILSON
Acting Clerk of the Executive Council

National Parks Act 1975
DECLARATION OF VODAFONE
PROPRIETARY LIMITED AS A PUBLIC
AUTHORITY

The Governor in Council, under section 3 (2) of the **National Parks Act 1975**, declares Vodafone Proprietary Limited to be a public authority for the purposes of that Act.

Dated 15 November 1994

Responsible Minister:
M. A. BIRRELL
Minister for Conservation and Environment

KATHY WILSON
Acting Clerk of the Executive Council

Public Sector Management Act 1992
AMENDMENT TO SCHEDULE 2 TO THE ACT

The Governor in Council, under sections 89 (2) and 89 (3) of the **Public Sector Management Act 1992**, by this Order amends Schedule 2 by making the following insertions:

DECLARED AUTHORITIES

<i>Column 1</i>	<i>Column 2</i>	<i>Column 3</i>
<i>Authority</i>	<i>Position having functions of Department Head</i>	<i>Provisions of Act or Regulations to apply to Authority</i>
Executive Director, Greyhound Racing Control Board	Minister for Sport, Recreation and Racing	All of Part 4 of the Act

Dated 15 November 1994

Responsible Minister:

J. G. KENNETT

Premier

KATHY WILSON

Acting Clerk of the Executive Council

Crown Land (Reserves) Act 1978
NOTICE OF INTENTION

The Governor in Council under section 10 of the **Crown Land (Reserves) Act 1978** gives notice of intention to revoke the following temporary reservations:

KATAMATITE—The temporary reservation by Order in Council of 18 March 1878 of an area of 2.023 hectares of land in the Township of Katamatite as a site for Public purposes (State School) so far only as the portion containing 790 square metres shown as Crown Allotment 1A, Section 24, Township of Katamatite on Certified Plan No. 113368 lodged in the Central Plan Office—(Rs 804569).

KYABRAM—The temporary reservation by Order in Council of 27 May 1909 of an area of 2279 square metres of land in the Township of Kyabram, Parish of Kyabram East as a site for Police purposes, so far only as the portion containing 809 square metres shown as Crown Allotment 3A, Section 7, Township of Kyabram on Certified Plan No. 113379 lodged in the Central Plan Office—(Rs 1196).

PENSHURST—The temporary reservation by Order in Council of 10 November 1863 of 6070 square metres of land in the Township of Peshurst as a site for Police purposes, revoked as to part by various Orders, so far only as the portion containing 1781 square metres shown as Crown Allotment 2E, Section 18, Township of Peshurst on Certified Plan No. 113284 lodged in the Central Plan Office—(C 92424).

PORTLAND—The temporary reservation by Order in Council of 22 June 1976 of 725 square metres of land being Crown Allotment 56B, Section D, Township of Portland as a site for Public purposes (Ministry for Conservation purposes)—(Rs 10154).

YANGERY—The temporary reservation by Order in Council of 18 July 1967 of 3585 square metres of land adjoining Crown Allotment 1A, Parish of Yangery as a site for State School purposes—(Rs 8681).

Dated 22 November 1994

Responsible Minister:

M. A. BIRRELL

Minister for Conservation and Environment

KATHY WILSON

Acting Clerk of the Executive Council

Crown Land (Reserves) Act 1978
REVOCATION OF TEMPORARY
RESERVATIONS

The Governor in Council under section 10 of the **Crown Land (Reserves) Act 1978** revokes the following temporary reservations:

ASHENS—The temporary reservation by Order in Council of 14 May 1895 of 6.09 hectares of land in the Parish of Ashens (formerly part of Allotment 163) as a site for Show Yards, so far only as the portion

containing 4329 square metres shown as Crown Allotments 163N and 163P, Parish of Ashens on Certified Plan No. 112437 lodged in the Central Plan Office—(Rs 2627).

BARWO—The temporary reservation by Order in Council of 15 May 1956 of 6677 square metres of land in the Parish of Barwo as a site for Police Purposes, revoked as to part by various Orders, so far only as the portion containing 986 square metres shown as Crown Allotment 8J, Section E, Parish of Barwo on Certified Plan No. 113292 lodged in the Central Plan Office—(Rs 7449).

FRAMLINGHAM—The temporary reservation by Order in Council of 28 May 1877 of 9080 square metres of land in Section 6, Township of Framlingham as a site for Public purposes (State School) in addition to and adjoining the site permanently reserved for State School purposes by Order in Council of 2 June 1873—(PO 43257).

FRAMLINGHAM—The temporary reservation by Order in Council of 18 July 1989 of 9207 square metres of land being Crown Allotment 5A, Section 6, Township of Framlingham as a site for a State School Forest Plantation—(Rs 14077).

MURTOA—The temporary reservation by Order in Council of 10 December 1889 of 25.11 hectares of land in the Township of Murtoa as a site for a Public Park and Garden so far only as the portions containing 1.7043 hectares shown as Crown Allotments 14 and 17, Section 27, Township of Murtoa on Certified Plan No. 112437 lodged in the Central Plan Office—(Rs 1646).

SAMARIA—The temporary reservation by Order in Council of 11 November 1873 of 2.02 hectares of land in the Parish of Samaria (formerly part of Allotment 152) as a site for State School purposes, so far only as the portion containing 1583 square metres shown as Crown Allotments 152H and 152H1, Parish of Samaria on Certified Plan No. 113295 lodged in the Central Plan Office—(Rs 0804517).

SARFIELD—The temporary reservation by Order in Council of 1 October 1918 of an area of 1214 square metres of land in the Township of Sarsfield (formerly Allotment 6, Section 12) as a site for a Mechanic's Institute—(Rs 1846).

WOOLAMAI—The temporary reservation by Order in Council of 10 August 1914 of 2.023 hectares of land in the Township of Woolamai (formerly Township of Marrooing) as a site for

a State School so far only as the portion containing 698 square metres as indicated by hatching on plan published in the Victoria Government Gazette on 3 November 1994—page 2968—(Rs 3911).

Dated 22 November 1994

Responsible Minister:

M. A. BIRRELL

Minister for Conservation and Environment

KATHY WILSON

Acting Clerk of the Executive Council

Crown Land (Reserves) Act 1978
INCORPORATION OF COMMITTEE OF
MANAGEMENT OF BERRY'S CREEK
PUBLIC HALL RESERVE

The Governor in Council, under section 14A (1) of the **Crown Land (Reserves) Act 1978**, being satisfied that it is in the public interests to declare to be a corporation the Committee of Management appointed under section 14 (2) of the Act of the lands described in the schedule hereunder:

- (a) declares that the Committee of Management shall be a corporation;
 - (b) assigns the name "Berry's Creek Hall Incorporated" to the corporation; and
- under section 14B (3) of the Act, appoints Donald Andrew Paterson to be Chairperson of the corporation.

SCHEDULE

The land in the Parish of Mardan temporarily reserved as a site for Public Hall Purposes by Order in Council of 12 November 1946—(Rs 5896).

Dated 22 November 1994

Responsible Minister:

M. A. BIRRELL

Minister for Conservation and Environment

KATHY WILSON

Acting Clerk of the Executive Council

Crown Land (Reserves) Act 1978
INCORPORATION OF COMMITTEE OF
MANAGEMENT OF KATUNGA
RECREATION RESERVE

The Governor in Council, under section 14A (1) of the **Crown Land (Reserves) Act 1978**, being satisfied that it is in the public interests to declare to be a corporation the Committee of

Management appointed under section 14 (2) of the Act of the lands described in the schedule hereunder:

- (a) declares that the Committee of Management shall be a corporation;
 - (b) assigns the name "Katunga Grounds Committee Incorporated" to the corporation; and
- under section 14B (3) of the Act, appoints Bruce Richardson to be Chairperson of the corporation.

SCHEDULE

The lands in the Parish of Strathmerton temporarily reserved as a site for Public Recreation by Orders in Council of 19 February 1953 and 14 September 1954—(Rs 7059).

Dated 22 November 1994

Responsible Minister:

M. A. BIRRELL

Minister for Conservation and Environment

KATHY WILSON

Acting Clerk of the Executive Council

**Crown Land (Reserves) Act 1978
CROWN LANDS TEMPORARILY
RESERVED**

The Governor in Council under section 4 of the Crown Land (Reserves) Act 1978 temporarily reserves the following Crown lands for the purposes mentioned:

**MUNICIPAL DISTRICT OF THE SHIRE
OF DUNMUNKLE**

ASHENS and MURTOA—Public Park and Gardens, 7440 square metres being Crown Allotment 163N, Parish of Ashens and Crown Allotment 15, Section 27, Township of Murtoa as shown on Certified Plan No. 112437 lodged in the Central Plan Office—(Rs 1646).

**MUNICIPAL DISTRICT OF THE SHIRE
OF DUNMUNKLE**

ASHENS and MURTOA—Show Yards, 1:3485 hectares being Crown Allotment 163L, Parish of Ashens and Crown Allotment 17, Section 27, Township of Murtoa as shown on Certified Plan No. 112437 lodged in the Central Plan Office—(Rs 2627).

**MUNICIPAL DISTRICT OF THE SHIRE
OF DUNMUNKLE**

MURTOA—Racecourse and Recreation, 1488 square metres being Crown Allotment 16, Section 27, Township of Murtoa as shown on Certified Plan No. 112436 lodged in the Central Plan Office—(Rs 1766).

Dated 22 November 1994

Responsible Minister:

M. A. BIRRELL

Minister for Conservation and Environment

KATHY WILSON

Acting Clerk of the Executive Council

**Crown Land (Reserves) Act 1978
NOTICE OF INTENTION**

The Governor in Council under section 10 of the Crown Land (Reserves) Act 1978 gives notice of intention to revoke the following temporary reservation:

CLUNES—The temporary reservation by Order in Council of 22 December 1862 of an area of 12.14 hectares of land in the Township of Clunes as a site for Public Gardens—(Rs 9945).

Dated 22 November 1994

Responsible Minister:

M. A. BIRRELL

Minister for Conservation and Environment

KATHY WILSON

Acting Clerk of the Executive Council

**Crown Land (Reserves) Act 1978
REVOCATION OF TEMPORARY
RESERVATIONS**

The Governor in Council under section 10 of the Crown Land (Reserves) Act 1978 revokes the following temporary reservations:

CONEWARRE—The temporary reservation by Order in Council of 23 March 1949 of 1341 square metres of land in the Parish of Conewarre as a site for Police Purposes, revoked as to part by Order in Council of 7 July 1993, so far as the balance remaining containing 418 square metres—(Rs 6331).

CONEWARRE—The temporary reservation by Order in Council of 8 March 1983 of 568 square metres of land being Crown Allotment 4B, Parish of Conewarre as a site for Police purposes—(Rs 12196).

CHILTERN—The road in the Township of Chiltern, Parish of Chiltern shown as Crown Allotment 2A, Section P on Certified Plan No. 114443 lodged in the Central Plan Office—(L8/4837).

**MUNICIPAL DISTRICT OF THE SHIRE
OF ROMSEY**

HAVELOCK—The road in the Parish of Havelock shown as Crown Allotment 32B, Section A on Certified Plan No. 114402 lodged in the Central Plan Office—(L1-4343).

Dated 22 November 1994

Responsible Minister:

M. A. BIRRELL

Minister for Conservation and Environment

KATHY WILSON

Acting Clerk of the Executive Council

**State Owned Enterprises Act 1992
DECLARATION UNDER DIVISION 1 OF
PART 2 IN RELATION TO THE GRAIN
ELEVATORS BOARD**

The Governor in Council under section 7 of the **State Owned Enterprises Act 1992** declares the Grain Elevators Board to be a reorganising body.

Dated 15 November 1994

Responsible Minister:

ALAN ROBERT STOCKDALE

Treasurer

KATHY WILSON

Acting Clerk of the Executive Council

**NOTICE OF MAKING AND AVAILABILITY
OF STATUTORY RULES**

In pursuance of the provisions of the Subordinate Legislation Act 1962 and the Regulations made thereunder notice is given of the making and availability of the following Statutory Rules:

Note: The date specified after each Statutory Rule is the date it was first obtainable from—

The Law Printer
28 Queensbridge Street, South Melbourne, 3205
Tel: 242 4600

	Veterinary Surgeons Act 1958	
180/1994	Veterinary Surgeons (Fees) Regulations 1994	
23 November 1994		Code A
	Magistrates' Court Act 1989	
181/1994	Magistrates' Court General (Further Amendment) Regulations 1994	
23 November 1994		Code A
	Transport Act 1983	
182/1994	Transport (Tow Truck) Regulations 1994	
23 November 1994		Code B
	Optometrists Registration Act 1958	
183/1994	Optometrists (Fees) Regulations 1994	
23 November 1994		Code A
	Supreme Court Act 1986	
	Corporations (Victoria) Act 1990	
170/1994	Supreme Court (Chapter V Amendment No. 4) Rules 1994	
21 November 1994		Code A
	Supreme Court Act 1986	
171/1994	Supreme Court (Chapter I Amendment No. 33) Rules 1994	
21 November 1994		Code A
	State Electricity Commission Act 1958	
173/1994	Electrical Approval Regulations 1994	
21 November 1994		Code A
	Metropolitan Fire Brigades Act 1958	
174/1994	Metropolitan Fire Brigades (General) Regulations 1994	
21 November 1994		Code A
	Alpine Resorts Act 1983	
176/1994	Alpine Resorts (Register of Interests) Regulations 1994	
21 November 1994		Code A
	Transport Act 1983	
177/1994	Transport (Railway and Tramway Safety— Alcohol Controls) Regulations 1994	
21 November 1994		Code A

The retail prices and price codes below will apply from 2 August 1993 to the following products: Acts (New, Reissue and Reprint), Statutory Rules (New, Reissue and Reprint), Parliamentary Papers, Bills and Reports, Special and Periodical Gazettes, and Industrial Awards.

<i>Price Code</i>	<i>No. of Pages (Including cover and blank pages)</i>	<i>Price</i>
A	1-16	\$2.70
B	17-32	\$4.00
C	33-48	\$5.50
D	49-96	\$8.50
E	97-144	\$11.00
F	145-192	\$13.00
G	193-240	\$15.00
H	241-288	\$16.00
I	289-352	\$18.00
J	353-416	\$21.00
K	417-480	\$24.00
L	481-544	\$28.00

A set retail price per issue will apply from 2 August 1993 to:

Government Gazette (General) \$1.65 per issue
Hansard (Weekly) \$2.70 per issue

ADVERTISERS PLEASE NOTE

As from 24 November 1994

The last Special Gazette was No. 89
Dated 22 November 1994

The last Periodical Gazette was No. 12
Dated 21 November 1994

3132 G 47 24 November 1994

Victoria Government Gazette

CONTENTS

	Page
Acts of Parliament	3094
Contracts Accepted—Amendments	3104
Estates of Deceased Persons	3087
Government and Outer Budget	
Sector Agencies Notices	3096
Notice of Making of Statutory Rules	3130
Orders in Council—	
Acts—Historic Buildings; National Parks; Public Sector Management; Crown Land (Reserves); Land; State Owned Enterprises	3120
Private Advertisements	3086
Proclamations	3094

A Victorian Government Publication

Published by

THE LAW PRINTER

a business unit of

Printing and Publishing Services Victoria (PPSV)

Melbourne Victoria Australia

© State of Victoria 1994

This publication is copyright. No parts may be reproduced
by any process except in accordance with the provisions
of the Copyright Act.

Address all inquiries to the Government Printer
for the State of Victoria

PO Box 292 South Melbourne 3205 Victoria Australia

ISSN 0819—5471

L. V. North, Government Printer Melbourne

Mail and Bulk Order Sales

The Law Printer

PO Box 292 South Melbourne 3205

28 Queensbridge Street, South Melbourne

Telephone inquiries (03) 242 4600

Fax (03) 242 4699

Counter Sales

The Law Printer Bookshop

28 Queensbridge Street, South Melbourne

Information Victoria Bookshop

318 Lt. Bourke Street Melbourne 3000

Telephone inquiries (03) 651 4100

Recommended Retail Price \$1.65