



Victoria Government Gazette

No. 41 Thursday 17 October 1996

GENERAL

GENERAL AND PERIODICAL GAZETTE

All copy to be sent to:

Government Gazette Officer
AGPS Victorian Operations
PO Box 263
60 Fallon Street, Brunswick 3056
Telephone (03) 9387 8135
Fax (03) 9387 3404

Advertising Rates and Payment

Private Notices

Payment must be received in advance with advertisement details.

30 cents per word - Full page \$180.00.

An additional cost must be included in prepayment if a copy of the gazette is required. Cheques should be made payable to AGPS Victorian Operations.

Government and Outer Budget Sector Notices

Not required to pre-pay.

Advertisements must be faxed, and a cover sheet should be used, marked to the attention of the Gazette Coordinator.

Per Line	Camera Ready	Typeset
Single column	\$0.50	\$1.50
Double column	\$1.00	\$3.00
Full page	\$20.00	\$63.00

Copy Deadline for General Gazette:

9.30 a.m. Monday - (Private)

9.30 a.m. Tuesday - (Government and Outer Budget Sector)

Copy Prices - Page	\$1.50
- Certified	\$3.50
- Gazette	\$3.20

(All prices include Postage)

Advertisers should note:

- Late copy received at AGPS Victorian Operations after deadlines will be placed in the following issue of VGG, irrespective of any date/s mentioned in the copy (unless otherwise advised).
- Proofs will be supplied only when requested or at the direction of the Gazette Officer.
- No additions or amendments to material for publications will be accepted by telephone.
- Departments are requested not to lodge Executive Council papers for gazette unless a copy is provided with the Governor or Clerk's signature on the relevant document.
- Government and Outer Budget Sector Agencies Please note:
To ensure that material received can be reproduced, and that errors are minimised, the following guidelines are to be observed when submitting material by fax.
Fax resolution
Material sent by fax should be transmitted using Fine resolution (200 dots per inch by 200 dpi). Normal resolution is unacceptable.
Font Size
Use 12 point (10 pitch) or larger.

Font Style

Clear plain font styles, such as Helvetica, should be used.

Graphics

Line drawings should be transmitted as large as possible to ensure clarity. Drawings up to A4 size sent by fax using Fine resolution provide a good quality for reproduction.

Avoid

Italics, underlining, and full justification.

Ensure document is square when sending

Documents that are sent skewed are difficult to read and process.

If material does not meet above requirements your advertisement may not be published.

SPECIAL GAZETTES

Copy to: Julia Saad

AGPS Victorian Operations
60 Fallon Street,
Brunswick 3056
Telephone inquiries (03) 9387 8135
Fax No. (03) 9387 3404.

Advertising Rates and Payment

Private Notices

Full page \$360.00

Payment must be received in advance with notice details.

Government and Outer Budget Sector

	Camera Ready	Typeset
Full page	\$27.00	\$85.05

Note:

The after hours contact number for Special Gazettes is:

Telephone 0412 243 123
014 693 550

SUBSCRIPTIONS AND RETAIL SALES

Copies of the Victoria Government Gazette can be purchased from AGPS Victorian Operations by subscription.

The Victoria Government Gazette

General and Special - \$165.00 each year
General, Special and Periodical - \$220.00 each year
Periodical - \$110.00 each year

Subscriptions are payable in advance and accepted for a period of one year. All subscriptions are on a firm basis and refunds for cancellations will not be given.

All payments should be made payable to AGPS Victorian Operations.

Subscription inquiries
AGPS Victorian Operations
PO Box 263
Brunswick Vic 3056
Telephone 13 2447
Fax (06) 295 4888

INDEX TO PRIVATE ADVERTISERS

A

Akehurst, Friend & Allaway 2678
 Apted & Williamson 2678

B

Beck Sheahan Quinn & Kirkham 2677
 Burke & Associates Solicitors 2676

D

David Sonenberg & Associates 2677
 Deacons Graham & James 2677
 Dunhill Madden Butler 2678

G

Garden & Green 2676
 Geoffrey Benson Burns 2675
 Gordon P. Jacobs 2675
 Graeme Steinfort & Co 2675

H

Harwood Andrews 2678

I

Ingpen & Bent 2676

M

Mills Oakley Lawyers 2675
 Moores 2677

N

National Mutual Trustees Limited 2678

P

Paul Gee 2675
 Peter J. Walsh & John F. Carroll 2677-2678
 Phillip Taylor 2675

R

Rennick & Gaynor 2678
 Rigby Cooke 2675

S

Sale by the Sheriff 2679
 Septimus Jones & Lee 2675
 Still & Co 2676

PRIVATE ADVERTISEMENTS

DISSOLUTION OF PARTNERSHIP

Take notice that on 4 June 1996, the partnership between Gregory Robert Burrows and Geoffrey Benson Burns who carried on business under the name Railway Club Hotel—Port Melbourne at 107 Raglan Street, Port Melbourne was dissolved.

Dated 18 September 1996

GEOFFREY BENSON BURNS

The partnership of Paul Gee and Phillip Taylor trading as Empire Cycles has been wound up under Section 14 of the Partnership Act on 8 September 1996. Any enquires should be forwarded to P.O. Box 1187, Windsor 3181.

BRUCE ARTHUR PEIPER, late of Unit 8, 13 Payne Street, Caulfield, Victoria, public servant, deceased

Creditors, next of kin and others having claims in respect of the estate of the deceased who died on 26 September 1995 are required by Esther Doris Irene Peiper the administratrix of the estate of the deceased to send particulars of their claims to her care of the undermentioned solicitor by 20 December 1996, after which date she will convey or distribute the assets having regard only to the claims of which she then has notice.

GRAEME STEINFORT & CO, solicitors, P.O. Box 520, Heidelberg

JOHN ALEXANDER STRANGER, deceased

Creditors, next of kin or others having claims in respect of the estate of John Alexander Stranger late of Culroy Private Home, 59 Southernhay Street, Reservoir, but formerly of 18 Southernhay Street, Reservoir, Victorian Railway employee, deceased who died on 25 March 1996 are to send particulars of their claims to the executor care of the undermentioned solicitors within two calendar months after the publication of this notice, after which date the executor will distribute the assets having regard only to the claims of which the executor then has notice.

SEPTIMUS JONES & LEE, solicitors, 257 Collins Street, Melbourne

MARY DOROTHEA PARRINGTON, late of Unit 12, 5-11 Orion Street, Vermont, Victoria, deceased

Creditors, next of kin and others having claims in respect of the estate of the deceased who died on 15 July 1996 are required by the executors and trustees to send particulars to them care of the undermentioned solicitors by 25 December 1996, after which date the executors and trustees may convey or distribute the assets having regard only to the claims of which they have notice.

RIGBY COOKE, solicitors, 246 Glenferrie Road, Malvern

KENNETH DAVID JOHN JENKINS, late of 8 Morcom Avenue, Ringwood East, retired policeman, deceased

Creditors, next of kin and others having claims in respect of the estate of the abovenamed deceased who died on 24 July 1996 are required by the executors Kristine Dianne Flynn of 38 Cantala Crescent, Ringwood, Helen Lorraine Barnes of 3 Armstrong Grove, Yarra Glen and Kenneth Stephen Jenkins of 38 Cantala Crescent, Ringwood to send particulars thereof to them care of the office of Mr Gordon P. Jacobs of 109 Bedford Road, Ringwood East within sixty days from the date of publication of this notice, after which the executors will distribute the estate having regard only to the claims of which they have notice.

GORDON P. JACOBS, solicitor, 109 Bedford Road, Ringwood East

Creditors, next of kin and others having claims in respect of the estate of Dorothy Florence Batchelder late of Unit 2, 41 Alfred Street, Beaumaris, Victoria, home duties, deceased (who died on 20 July 1996) are required by the executor ANZ Executors & Trustee Company Limited (A.C.N. 006 132 332) of 530 Collins Street, Melbourne to send particulars to it by 17 December 1996, after which date it may convey or distribute the estate having regard only to the claims of which it then has notice.

MILLS OAKLEY LAWYERS, 131 Queen Street, Melbourne

MAUD HARMAN CRUIKSHANK, late of "Murray Hostel", 7 Spring Street, Belmont, spinster, deceased

Creditors, next of kin and others having claims in respect of the estate of the abovenamed deceased who died on 30 June 1996 are required by the trustee Maxwell Ross of 27 Elliott Street, Cheltenham to send particulars of their claims to the trustees care of the undermentioned solicitors by 31 December 1996, after which date the trustees may convey or distribute the assets having regard only to the claims of which they then have notice.

INGPEN & BENT, solicitors, 95 Yarra Street, Geelong, solicitors for the trustees

JAMES HENRY INGRAM, deceased

Creditors, next of kin or others having claims in respect of the estate of James Henry Ingram late of Ingram Road, Ultima, Victoria, farmer, deceased who died on 1 June 1995 are to send particulars of their claims to the executors Elsie Mavis Ingram, Athol Leonard Ingram and Murray Kenneth Ingram, care of the undermentioned solicitors by 11 December 1996, after which date the executors will distribute the assets having regard only to the claims of which they then have notice.

GARDEN & GREEN, solicitors, 4 McCallum Street, Swan Hill

EDNA DOROTHY HEATH, deceased

Creditors, next of kin or others having claims in respect of the estate of Edna Dorothy Heath late of Alcheringa Hostel, 44 Rutherford Street, Swan Hill, Victoria, widow, deceased who died on 25 July 1996 are to send particulars of their claims to the executor Donald Henry Heath care of the undermentioned solicitors by 11 December 1996, after which date the executor will distribute the assets having regard only to the claims of which he then has notice.

GARDEN & GREEN, solicitors, 4 McCallum Street, Swan Hill

JOHN REYNOLDS, deceased

Creditors, next of kin or others having claims in respect of the estate of John Reynolds late of Glenarm Nursing Home, Burgoyne Street, Kerang, Victoria, retired property investor, deceased who died on 5 May 1996 are to send particulars of their

claims to the administrator Mark William Reynolds care of the undermentioned solicitors by 11 December 1996, after which date the administrator will distribute the assets having regard only to the claims of which he then has notice.

GARDEN & GREEN, solicitors, 4 McCallum Street, Swan Hill

LINDA GRACE JOBLING, deceased

Creditors, next of kin or others having claims in respect of the estate of Linda Grace Jobling late of Swan Hill Nursing Home, Splatt Street, Swan Hill, Victoria, home duties, deceased who died on 3 July 1996 are to send particulars of their claims to the executor Phyllis Verna Braybrook care of the undermentioned solicitors by 11 December 1996, after which date the executor will distribute the assets having regard only to the claims of which she then has notice.

GARDEN & GREEN, solicitors, 4 McCallum Street, Swan Hill

RICHARD ROBINSON BELSHAW, deceased

Creditors, next of kin or others having claims in respect of the estate of Richard Robinson Belshaw late of 1336 High Street, Malvern, deceased who died on 6 December 1996 are to send particulars of their claims to the executor care of the undermentioned solicitors by 30 November 1996, after which date the executor will distribute the assets having regard only to the claims of which the executor then has notice.

BURKE & ASSOCIATES SOLICITORS, 1113-1121 High Street, Armadale

MARION JUNE NEIL, late of High Street, Pyalong, Victoria, widow, deceased

Creditors, next of kin or others having claims in respect of the abovenamed deceased who died on 25 August 1996 are required by Ian Bentley Still of 32 Sydney Street, Kilmore, Victoria, solicitor the executor of the deceased's will to send particulars of their claims to the executor care of the undermentioned solicitors by 31 December 1996, after which date the executor will distribute the assets having regard only to the claims of which the executor then has notice.

STILL & CO., solicitors, 32 Sydney Street, Kilmore

AGNES CECILIA SMITH (also known as Agnes Smith) late of 10 Colorado Street, Pascoe Vale, Victoria, farmer, deceased

Creditors, next of kin or others having claims in respect of the abovenamed deceased who died on 15 August 1996 are required by Dawn Cornelia Cutler of 12 Colorado Street, Pascoe Vale, Victoria, home duties and Ian Bentley Still of 32 Sydney Street, Kilmore, Victoria, solicitor, the executors of the deceased's Will to send particulars of their claims to the executors care of the undermentioned solicitors by 31 December 1996, after which date they will convey or distribute the assets having regard only to the claims of which they then have notice.

STILL & CO., solicitors, 32 Sydney Street, Kilmore

Creditors, next of kin and others having claims in respect of the estate of Jean Fry late of 134 Lockwood Road, Lockwood, Victoria, deceased who died on 15 August 1996 are required by the trustee to send particulars of their claims to the trustee care of the undermentioned solicitors by 2 December 1996, after which date the trustee may convey or distribute the assets having regard only to the claims of which the trustee then has notice.

BECK SHEAHAN QUINN & KIRKHAM, 110 Pall Mall, Bendigo

Creditors, next of kin and others having claims in respect of the estate of Verna Eileen Roberts late of 28 Asling Street, Brighton North in the State of Victoria, retired, deceased who died on 29 July 1996 are required to send particulars of claims to the administrator Harry Ernest Roberts care of the undermentioned solicitors in the said state, on or before 18 December 1996, after which date the administrator will distribute the estate having regard only to the claims of which he then has notice.

DAVID SONENBERG & ASSOCIATES, solicitors, 293 Bay Street, Brighton

GEORGE DUNCAN, late of 18 Magnolia Drive, Lower Templestowe in the State of Victoria, medical practitioner, deceased

Creditors, next of kin and others having claims in respect of the estate of the deceased who died on 24 April 1996 are required by the

trustees Christine Duncan, Alison Duncan-Marr and Iain Norman Duncan to send particulars thereof to them care of the undermentioned solicitors by 25 December 1996, after which date the trustees may convey or distribute the assets having regard only to the claims of which they then have notice.

MOORES, solicitors, 9 Prospect Street, Box Hill

WINIFRED MARGARET COLLINS late of 23 Sinclair Avenue, Glen Iris in the State of Victoria, retired secretary, deceased

Creditors, next of kin and others having claims in respect of the estate of the deceased who died on 20 June 1996 are required by the trustee Murray Philip Baird to send particulars thereof to him care of the undermentioned solicitors by 25 December 1996, after which date the trustee may convey or distribute the assets having regard only to the claims of which he then has notice.

MOORES, solicitors, 9 Prospect Street, Box Hill

LINDSAY GORDON QUINN late of 24 Fordholm Road, Hawthorn, Victoria, company director, deceased

Creditors, next of kin and others having claims in respect of the estate of the deceased who died on 6 May 1996 are required by the personal representatives Michael Shayne Quinn, Peter Ashleigh Quinn, William Kefford Fulton and Donald Ledingham Cooper to send particulars to them care of Deacons Graham & James, solicitors, 385 Bourke Street, Melbourne by 24 December 1996, after which date the personal representatives may convey or distribute the assets having regard only to the claims of which they then have notice.

DEACONS GRAHAM & JAMES, 385 Bourke Street, Melbourne, solicitors for the estate

Creditors, next of kin and others having claim in respect of the estate of Arthur Allan Reed Cousins late of 16 Isabella Grove, Hawthorn, Victoria, retired gentleman, deceased who died on 19 July 1993 are requested to send particulars of their claims to the substituted executrix Sarie Merrilyn Lowdon of 5 Carnarvon Avenue, Jan Juc,

Victoria care of the undermentioned solicitors by 18 December 1996, after which date the executrix will distribute the assets having regard only to the claims of which she then has notice.

PETER J. WALSH & JOHN F. CARROLL,
solicitors, 83 William Street, Melbourne

Creditors, next of kin and others having claim in respect of the estate of Lloyd George Haack late of 11 Wakefield Court, Cranbourne, retired, deceased who died on 15 August 1996 are required by John Lloyd Haack of 11 Wakefield Court, Cranbourne and David Russell Haack of 67 Kidderminster Drive, Wantirna to send particulars of their claim to the said John Lloyd Haack and David Russell Haack by 17 December 1996, after which date they will convey or distribute the assets having had regard only to the claims of which they then have notice.

AKEHURST, FRIEND & ALLAWAY,
solicitors, Suite 1102, 10 Queen Street,
Melbourne

LYSBETH HUNN, deceased

Creditors, next of kin or others having claims in respect of the estate of Lysbeth Hunn late of Flat 3, 1 Molesworth Street, Kew, Victoria, retired, deceased who died on 31 July 1996 are to send particulars of their claims to the executor ANZ Executors & Trustee Company Limited (A.C.N. 006 132 332) of 530 Collins Street, Melbourne, Victoria by 24 December 1996, after which date the executor will distribute the assets having regard only to the claims of which the executor then has notice.

DUNHILL MADDEN BUTLER, solicitors,
575 Bourke Street, Melbourne

SARAH ELLEN McKEEGAN, deceased, late
of Grace McKellar Centre, 45-95 Ballarat
Road, North Geelong, Victoria, home
duties, deceased

Creditors, next of kin and others having claims in respect of the estate of the deceased who died on 28 July 1996 are required by Ian Ferguson Apted of 63 Yarra Street, Geelong, Victoria, solicitor, the Applicant for Grant of Probate of the Will dated 1 June 1987 of the

deceased to send particulars to him care of the undermentioned solicitors by 19 December 1996, after which date the said applicant may convey and distribute the assets having regard only to the claims of which he then has notice.

APTED & WILLIAMSON, solicitors, 63
Yarra Street, Geelong

Creditors, next of kin and others having claims in respect of the estate of Robert Secker late of 21 Oberon Avenue, East Hawthorn, electrician, deceased who died on 14 July 1996 are to send particulars of their claims to Dorothy McCulley the executrix appointed by the said Will care of the undersigned by 17 December 1996, after which date she will commence to distribute the assets having regard only to the claims of which she then has notice.

RENNICK & GAYNOR, solicitors, 431
Riversdale Road, Hawthorn East

JAMES HUTTON, late of 281 Kooyong
Road, Elsternwick, electrician, deceased

Creditors, next of kin and others having claims in respect of the estate of the deceased (who died on 23 May 1996) are required by Perpetual Trustees Victoria Limited A.C.N. 004 027 258 of 50 Queen Street, Melbourne to send particulars of their claims to the said Company by 22 December 1996, after which date it will convey or distribute the assets, having regard only to the claims of which the Company then has notice.

HARWOOD ANDREWS, solicitors, 70
Gheringhap Street, Geelong

Creditors, next of kin and others having claims in respect to the estate of Christine Owen late of 73/330 Springvale Road, Donvale in the state of Victoria, widow, deceased who died on 19 July 1996 are required to send particulars of such claims to the executor National Mutual Trustees Limited at its registered office 65 Southbank Boulevard, Southbank by 20 December 1996, after which date the executor will distribute the estate having regard only to the claims of which it then has notice.

In the Supreme Court of the State of Victoria
SALE BY THE SHERIFF

On 21 November 1996 at 2.30 p.m. at the Sheriff's Office, 8-20 King Street, Oakleigh (unless process be stayed or satisfied).

All the estate and interest (if any) of John Khano of 77 Ashleigh Crescent, Coolaroo joint proprietor with Layla Khano of an estate in fee simple in the land described on Certificate of Title Volume 9770, Folio 430 upon which is erected a house known as 77 Ashleigh Crescent, Coolaroo.

Registered Mortgage No. T723581S and Covenant N759877H affect the said estate and interest.

Terms—Cash Only

R. MARTIN
Sheriff's Officer

In the Supreme Court of the State of Victoria
SALE BY THE SHERIFF

On 21 November 1996 at 2.30 p.m. at the Sheriff's Office, 8-20 King Street, Oakleigh (unless process be stayed or satisfied).

All the estate and interest (if any) of Oguz Ciloglu of 426 Camp Road, Broadmeadows joint proprietor with Yurdagul Ciloglu of an estate in fee simple in the land described on Certificate of Title Volume 8728, Folio 790 upon which is erected a dwelling known as 426 Camp Road, Broadmeadows.

Registered Mortgage No. M615373X and Caveat No. R416817V affect the said estate and interest.

Terms—Cash Only

R. MARTIN
Sheriff's Officer

Unclaimed Moneys Act 1962

Register of Unclaimed Moneys held by the—

Name of Owner on Books and Last Known Address	Total Amount Due to Owner	Description of Unclaimed Money	Date when Amount first became Payable
§			
NORTH KALGURLIE MINES LTD			
George, J. E., C/- Midland Bank Ltd, 29 High St, Camberley, Surrey	106.28	Dividend 1	7.11.86
Heritable Nominees Ltd, 52 Berkley Sq, London	147.62	"	"
Waterson, A., 37 Catherine St, Darlington, Co Durham	111.86	"	"
Munden, D. H., C/- Lloyds Bank PLC, PO Box 109 Broad St, St Helier Jersey Channel Islands	147.62	"	"
Moge, N., PO Box 4857, Riyadh, Saudi Arabia	346.87	"	"
Ciechanowski, A. D. J., Court Hill Stables, Letcombe Regis, Wantage, Oxon	135.79	Dividend 2	16.3.87
De Haverland, T. H. P., Little Ballands, The Street, Fetcham, Surrey	135.79	"	"
Medland, T. S., 32 Lady Margaret Rd, London	101.84	"	"
Mullis, L., Manor Leat, Worships Hill, Riverhead, Sevenoaks, Kent	332.08	"	"
Waterson, A., Retain	102.89	"	"
Munden, D. H., Retain	133.87	"	"
Bray, J. C., 45 Chiswick Village, London	119.77	Dividend 3	12.5.87
Cattan, A., 17 Bloom St, Manchester	218.83	"	"
Four Yards Nominees Ltd, 76 Cross St, Manchester	294.56	"	"
Four Yards Nominees Ltd, SBN Acct., 76 Cross St, Manchester	249.26	"	"
Atalla, M. H. and Atalla, C/- 8A Hyde Park Gate, Kensington London	317.71	Dividend 4	15.1.88
Cattan, A., Retain	201.19	"	"
Ferro, A., 15 Pembroke Mews, London	102.98	"	"
Hauschildt, M., 160 Finborough Rd, London	119.06	"	"
Wright, G. M., Brook Farm, Great Bentley, Nr Colchester, Essex	226.17	"	"

96145

CONTACT: SANNDRA BOX, PHONE: (08) 232 0003

Unclaimed Moneys Act 1962

Register of Unclaimed Moneys held by the—

<i>Name of Owner on Books and Last Known Address</i>	<i>Total Amount Due to Owner</i>	<i>Description of Unclaimed Money</i>	<i>Date when Amount first became Payable</i>
\$			
CADBURY SCHWEPPE PTY LTD			
BP Border Service Station	270.00	Cheque	11.3.94
Steven Horg Coburg	112.50	"	14.3.94
Boudoulon Milk Bar Altona	112.50	"	"
Solo Mermaid Beach	112.50	"	"
Woddy Yeppoon	300.00	"	"
Sundry Accounts-CL	383.75	"	17.3.94
Cheap Foods City Beach	165.72	"	18.3.94
F/N W/Sales Cairns	100.00	"	26.3.94
Normanton Stop Stop Normanton	112.00	"	"
Cornetts Taigum 1579/Q4T10148171	500.00	"	"
Australian Inst. of Food	158.00	"	31.3.94
Kiama Downs Supermarket	155.00	"	10.4.94
Power House	319.08	"	15.4.94
Munno Para Deli	100.00	"	17.4.94
MCS Take Away Wodonga	187.50	"	"
Stationers Supply P/L	200.00	"	"
Hoopers Foodstore Emerald	377.00	"	"
Mt Gravatt Group Practice	210.00	"	19.4.94
Parry's Milk Bar Caringbah	368.00	"	23.4.94
Greenway St Johns Park	364.00	"	8.5.94
Jamals Mixed Business Bondi	380.00	"	"
Calmont Holdings, Gosford	1,150.00	"	"
Venn Brown's RMG	463.04	"	17.5.94
Clyne & Symeou Fam	107.00	"	21.5.94
B McCreadie Roseberry	150.00	"	"
B McCreadie Queenstown	250.00	"	"
Foodfare Prospect	250.00	"	"
B McCreadie Roseberry	270.00	"	"
B McCreadie Queenstown	400.00	"	"
Payless Mossvale	280.00	"	1.6.94
Tom The Cheap Plympton South	104.00	"	3.6.94
Foodtown Salisbury North	104.00	"	"
Bilgomen Pool Kiosk	178.84	"	"
Hennesy Clinic	135.00	"	7.6.94
Q Superstore Woodridge	120.00	"	10.6.94
Q Superstore Mermaid Waters	180.00	"	"
Southern Airlines	175.80	"	"
Mobil Pooraka	100.00	"	17.6.94
Paradise Terminus Deli	120.00	"	"
Shell D/ton MO33 Circle K	120.00	"	"
Safeway Mulgrave	107.69	"	18.6.94
Na's Bookstall	155.08	"	21.6.94
Manual Promotional	438.00	"	23.6.94
Shell Pooraka	158.40	"	1.7.94
Albert Logan Hotel	126.00	"	"
Beaudesert RSL	216.00	"	"
Brisbane Polo Club	276.00	"	"
Cnungra Hotel	360.00	"	"
Fortune Restaurant'	120.00	"	"
Gazebo Ramda Hotel	708.00	"	"
Jimbooba Country Tavern	960.00	"	"

Victoria Government Gazette

G 41 17 October 1996 2681

Kam Koon Restaurant	120.00	"	"
Samfood Restaurant	108.00	"	"
Waterfords Arms	213.60	"	"
Yeronga Bowls Club	180.00	"	"
DJ Deli Bunbury	100.00	"	3,7.94
Carey Park News Bunbury	150.00	"	"
Musscropps Deli Bunbury	150.00	"	"
Wolliston Deli Bunbury	175.00	"	"
Centrepoint News Bunbury	200.00	"	"
Plains Video Bunbury	225.00	"	"
Edwilham Dee Why	388.00	"	"
Australian Liquor Marketers	650.00	"	8,7.94
St Bernards Hotel	213.60	"	"
Berserker Smkt Rockhampton	120.00	"	10,7.94
Warana Fruit Market Kawana	150.00	"	"
Ampol Punchbowl	243.60	"	"
Gemini Hotel Griffith	612.00	"	22,7.94
Newspower	124.00	"	24,7.94
Airhost Mascot	300.00	"	1,8.94
G & S Electra Stack P/L Ferntree Gully	819.45	"	13,8.94
Shell Mistreal P/L Chernside	315.00	"	21,8.94
Super C Mt Gravatt	325.00	"	4,9.94
Pennys Pty Ltd Head Office	166.50	"	6,9.94
Uni NSW Union N200 10417	144.00	"	18,9.94
Gourmet Basket Maddington	192.00	"	"
Big Tomato Mareeba	450.00	"	"
TNT Express Worldwide	185.60	"	27,9.94
QLD Independent Merch Serv.	645.00	"	"
G & L Ransley	3,363.00	"	"
Le Croissant Pagewood	210.90	"	30,9.94
RJ Sandwich Works Chadstone	117.00	"	"
Lickhart River	100.00	"	5,11.94
Wendys Florist Woodridge	102.00	"	"
Best of British Loganholme	106.00	"	"
Morgans Supermarket Melton	145.00	"	"
Nambucca Co-op Macksville	406.00	"	"
Mr Candyman Mrs D McLaughlin	159.00	"	14,11.94
Greenways Corrimal	140.00	"	27,11.94
Greenways Wollongong	170.00	"	3,12.94
Keith Kidd Chemist Nedlands	100.00	"	"
Greenways Wollongong	170.00	"	20,12.94
Telecom Aust	649.00	"	31,12.94
Staging Connections	130.00	"	3,1.95
Blacktown City Guardian	140.00	"	10,1.95
Weller Hills Bowls Club	168.00	"	13,1.95
Rathowney Hotel	203.52	"	"
Tamborine Golf Club	165.36	"	17,1.95
Logan Albert Hotel	222.00	"	"
Marche Club	492.00	"	"
Mercury Cinema	193.20	"	"
Veneto Club	263.70	"	"
Versedale Hotel	162.00	"	22,1.95
H & N Zeban Chadstone	100.00	"	"
Ferntree Gully Milkbar	100.00	"	"
The Chocolate Shop Monbulk	100.00	"	"
J & A Tsiokas Glen Waverley	100.00	"	"
McAdam Square M/Bar Croydon	100.00	"	"
Sams S M/Bar Croydon	100.00	"	"
Sams S M/Bar Mooroolbark	100.00	"	"
Hassan Chehade Carrum	100.00	"	"
Graham & Lee Cahill Mornington	100.00	"	"
Himbarra Store Narre Warren	100.00	"	"
Lousie Punso Kealba	100.00	"	"
DO	100.00	"	"
G & B Lane Warmambool	100.00	"	"
Harold Nelson Port Campbell	100.00	"	"

2682 G 41 17 October 1996

Victoria Government Gazette

Sowan Milk Bar Cairo	100.00	"	"
Gwelrup Deli	100.00	"	"
Lynne's Deli South Perth	100.00	"	"
Strathy N/Agent Strathmerton	200.00	"	"
Sams S M/Bar Montrose	200.00	"	"
Carrum Downs Newsagency	200.00	"	"
Helou M/Bar Montrose	200.00	"	"
Sams S Mini Mart Yange Bup	200.00	"	"
Continental Deli Coolbellup	200.00	"	"
Federation Inn	160.60	"	27.1.95
Tuckerbag Alexandria	142.00	"	"
Western Suburbs Indoor	782.00	"	"
Village Store Geraldton	100.00	"	28.1.95
City Fresh Fruit Northbridge	100.00	"	"
Hawthorn Supa Deli	100.00	"	"
Frankston General Store	100.00	"	"
Langwarren General Store	100.00	"	"
Pearcedale M/Bar V Clarkeson	100.00	"	"
Linda Sparks Milkbar Watsonia	100.00	"	"
F Mohand Milkbar Watsonia	100.00	"	"
Wassouf Milkbar Heidelberg	100.00	"	"
A & M El Moramed Eltham Nth	100.00	"	"
Big Shoppe Nth Balwyn	100.00	"	"
Lilburne Deli Duncraig	104.00	"	"
Smart Road Supa Deli St Agnes	150.00	"	"
Licola Store	180.00	"	"
Carol Kerbase Seaford	200.00	"	"
G & K Hanna Nth Dandenong	200.00	"	"
Rosella Ave Conv Store	200.00	"	"
Abdul Yassine Spotswood	200.00	"	"
S Sawah & D Dadah Braybrook	200.00	"	"
Zelna Milkbar Keilor	200.00	"	"
E & J Elkhoury Melton	200.00	"	"
Willetton Supermarket	200.00	"	"
Blueberich Fresh Gourmet	200.00	"	"
Cloister Sq Milkbar Perth	200.00	"	"
Floreat Supa Deli	200.00	"	"
Spalding Deli Geraldton	200.00	"	"
Bell Aire Shell Preston	200.00	"	"
Khazaal Milkbar Watsonia	200.00	"	"
Susan Sexton (Shell Select) Burwood	200.00	"	"
Heaths Warrandyte	250.00	"	"
Heaths Croydon	250.00	"	"
Heaths Balwyn	250.00	"	"
Honesty Snax Richmond	735.00	"	"
Victoria Racing Club	200.00	"	30.1.95
L Bowditch	308.25	"	3.2.95
Anthony Horley	291.00	"	"
Barwon Club Hotel	249.60	"	10.2.95
MFC Bondi	100.00	"	12.2.95
Newslink-Town Hall Sydney	100.00	"	"
Newstown-Town Hall Sydney	100.00	"	"
Newslink Mascot	100.00	"	"
Sussex Newsagent Sydney	100.00	"	"
MFC Albion Park Rail	100.00	"	"
NASA Petroleum Corrimal	100.00	"	"
Roys Fruit & Veg Helenburgh	100.00	"	"
West End Woolongong	100.00	"	"
Marina Bukerly	100.00	"	"
Berridale Store Berridale	100.00	"	"
Auckland Store Tathra	100.00	"	"
L Nguyen Jamboree Heights	200.00	"	"
727 Boondall	100.00	"	"
Anderson Fruit Market Biloela	200.00	"	"
Richardson Rd S/Mkt Rocky	100.00	"	"
Amlon Burmah Blacktown	102.00	"	"

*Victoria Government Gazette**G 41 17 October 1996 2683*

Newslink-Martin Place	104.00	"	"
Newslink-Sydney	104.00	"	"
Woolongong Union University	105.00	"	"
ACM/Gate 10 Mascott	216.00	"	"
Blacktown Railway Kiosk	118.00	"	"
Country Platford Newslink Sydney	156.00	"	"
Grey Cormick Little Buy	160.00	"	"
Roys Fruit & Veg Helensburgh	172.00	"	"
Corner Milk Business Hurstville	200.00	"	"
Woolongong Rail Station Woolongong	200.00	"	"
Tathra Newsagent Tathra	200.00	"	"
MFC St Marys	200.00	"	"
Matilda Truck	200.00	"	"
Matilda Truck Stop Kybung	200.00	"	"
B & K Simply Snacks Healesville	200.00	"	"
Greenways Corrmal	250.00	"	"
Shop Ezy Narrabundah	264.00	"	"
CAI Services Pty Ltd Sydney	400.00	"	"
Star Supplies Mitchel	442.50	"	"
727 New Farm	100.00	"	20.2.95
Nightowl South S/Paradise	100.00	"	"
Broadway News Brisbane	104.00	"	"
Nightowl Surfers Paradise	208.00	"	"
Sams Milk Bar Mooroolbark	105.60	"	"
Jim Risk Doncaster	105.60	"	"
Stirling Geraldton	112.00	"	"
Nyah West Milk Bar	123.75	"	"
UTS Kuringgai Campus Lindfield	130.00	"	"
Select Sweets Carlando Parks	134.00	"	"
Alfred Hosp Kiosk Prahran	142.80	"	"
Port Douglas Foodstore	157.00	"	"
Kaumatna Foodstore Woodridge	200.00	"	"
McCarthy Fair Conv Marsden	200.00	"	"
Melville & Bailey Foodstore	200.00	"	"
One Stop Ship Rochedale	226.00	"	"
Sth Yarra Convenience	229.00	"	"
RBH Canteen Herston	640.00	"	"
Burleighmarr Dist	340.00	"	"
Sweets Etc Prahran	463.50	"	"
Newslink Newsagent Tullamarine	139.20	"	25.2.95
Mr B McCreadie Queenstown	224.00	"	"
Mr B McCreadie Roseberry	285.00	"	"
Cobram Barooga Golf	318.00	"	"
Bensons Trading	171.50	"	27.2.95

96172

CONTACT: CHUAN GOH, PHONE: (03) 9520 7330

Unclaimed Moneys Act 1962

Register of Unclaimed Moneys held by the—

Name of Owner on Books and Last Known Address	Total Amount Due to Owner	Description of Unclaimed Money	Date when Amount first became Payable
§			
MOWLA PTY LTD T/A THE REGENT HOTEL			
Arrow Head International, 3-2-1 Tsurumi Chuo, Tsurumi-Ku, Kanagawa, Japan	168.00	T/A Commission	5.3.93
Bayview Travel, PO Box 132, Claremont WA	116.00	"	6.10.93
Cairmillar Institute, 993 Burke Rd, Camberwell	250.00	Training Course	15.10.90
Co. Design, 97 Lewisham Rd, Prahran	230.91	Chairs Repair	6.12.91
DBK Enterprises, 133 Wilson St, Brunswick	132.00	Glass Trays	11.3.94
Fesq Dorado & Co, Lv 1/600 Nicholson St, Nth Fitzroy	324.00	Wine Supplied	25.11.91
Harrison, G., 9/18 Normanby St, Brighton	173.00	Ref'd Payment	6.12.94
Green, Vern, 250 Glebe Point Rd, Glebe NSW	109.00	Ref'd Deposit	30.1.91
Holland International, Postbus 30350, 6803 AJ Arnhem, Netherlands	114.00	T/A Commission	1.9.93
HSMA, 566 St Kilda Rd, Melbourne	120.00	Membership	19.7.91
H.I.S., South Gate Shinjuku Bldg. 1F., 5-33 Sendagaya, Shibuya-ku, Tokyo, Japan	100.50	T/A Commission ITOA	9.11.93
I T O A, Lv1/80 William St, Woolloomooloo NSW	690.00	Simposium	29.4.91
Innovative Agencies, 25/16 Mcquarie Pl, Boronia	178.71	Souvenirs	25.3.94
James, Amy Elizabeth	207.04	Wages	28.9.95
Kirikian, D., 63 Brenan St, Fairfield NSW	206.90	Ref'd Deposit	11.4.91
Millcroft Travel Services, 1505 Guelph Line, Burlington, Ontario, Canada	190.00	T/A Commission	4.8.93
Molnar, John, 7 Harvy St, Mount Evelyn	100.00	Refund	30.11.92
Nippon Express Co, Saimanouchi Sakaisuji Bldg, 1-22-22 Shimanouchi Chuo-ku, Osaka 542, Japan	112.00	T/A Commission	8.4.93
Occupational Health & Safety Authorities, PO Box 414, Melbourne	100.00	Regist. Fee	15.12.94
Protocol Inquiry Agency, 79-81 Bridge St West, Benalla	1,801.80	Refund	11.3.94
Quantas Airways, Bwld B-203 Coward St, Mascot, NSW	177.00	T/A Commission	19.12.95
RGF Kempe Australia Pty Ltd, PO Box 693, Cleveland QLD	133.00	Supplies	14.10.92
Gray, Roseanne, 17 Glen St, Double Bay NSW	179.20	Refund	3.1.95
San Cosme Viajes SA	156.00	T/A Commission	6.10.93
St Huberts Vineyard, St. Huberts Rd, Coldstream	163.30	Beverage	11.93
Thomas Cook Pty Ltd, (Hotel Publicity International-Auckland NZ)	400.00	Advertising	28.10.91
Thornbury & Northcote Physio, 663 High St, Thornbury	136.00	Consultation	3.7.92
Trans World Finance Corp Ltd., C/- Arms, Ground FL., 11 Bank Pl, Melbourne	270.00	Wage Garnishee	13.5.94
Travel Salon, 3-1-1 Ichidan-Cho, Matsuyama-Shi, Ehime-Ken 790, Tokyo, Japan	558.00	T/A Commission	8.4.93
WPA Supply Co., 144 Moray St, South Melbourne	128.90	Toner Cartridge	15.9.94

96159

CONTACT: RICK HILL, PHONE: (03) 9653 0000

PROCLAMATION

**Land Act 1958
PROCLAMATION OF ROAD**

I, Richard E. McGarvie, Governor of Victoria acting with the advice of the Executive Council and under Section 25 (3) (c) of the **Land Act 1958** proclaim as road the following land:

**MUNICIPAL DISTRICT OF THE SWAN
HILL RURAL CITY COUNCIL**

CHINANGIN—Crown Allotment 6G, Parish of Chinangin as shown on Certified Plan No. 112644 lodged in the Central Plan Office—(Rs 14386).

Given under my hand and the seal of Victoria on 15 October 1996.

(L.S.) R. E. McGARVIE
By His Excellency's Command

MARIE TEHAN
Minister for Conservation and
Land Management

**GOVERNMENT AND OUTER BUDGET SECTOR
AGENCIES NOTICES**

**YARRA RANGES SHIRE COUNCIL
Road Discontinuance**

Under Section 206 and Schedule 10, Clause 3 of the Local Government Act 1989 the Yarra Ranges Shire Council, at its meeting held on 8 October 1996 formed the opinion that the road adjacent to Lot 1, Plan of Subdivision 120724 (372 Warburton Highway, Wandin North) as shown on the Plan below is not reasonably required as a road for public use and resolved to discontinue the road and to sell the land from the road to the abutting owner.

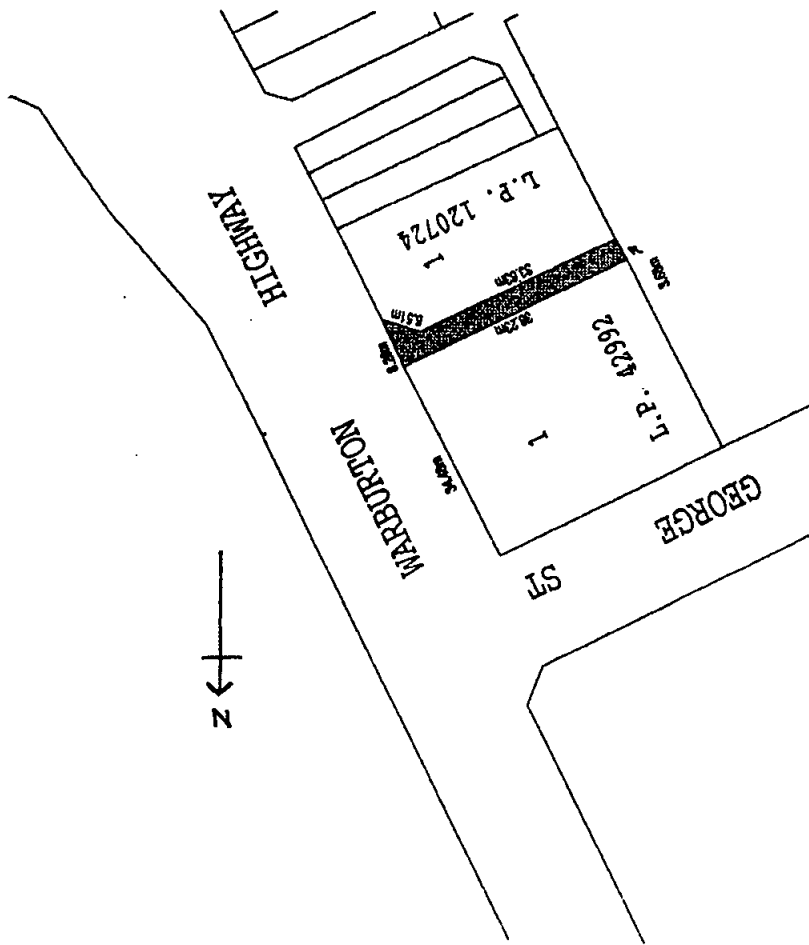

ERIC HOWARD
Chief Executive Officer

BASS COAST SHIRE COUNCIL
Notice of Proposed Local Law No. 5
Use of Common Seal Local Law 1996

The Council of the Bass Coast Shire has drafted a use of the Common Seal Local Law.

This Local Law is made for the purpose of:

- regulating the use of the Common Seal;
- prohibiting the unauthorised use of the Common Seal or any device resembling the Common Seal.

Subject to the provision of the Local Law, a person must not misuse the Common Seal.

A copy of the proposed Local Law can be obtained from Customer Service Centres in Inverloch, Wonthaggi, Cowes and Grantville or at the Bass Coast Civic Centre.

Any person affected by the proposed Local Law may make a submission relating to the proposed Local Law, in accordance with Section 223 of the Local Government Act 1989 within 14 days of the publication of this notice.

Any person requesting to be heard in support of the written submission is entitled to appear before a meeting of the Council (or Committee).

Submissions must be received by the Chief Executive Officer by 5.00 p.m. on 31 October 1996 and must be addressed to The Chief Executive Officer, Bass Coast Shire Council, P.O. Box 118, Wonthaggi, Victoria 3995.

ALLAN BAWDEN
Chief Executive Officer

WYNDHAM CITY COUNCIL
Notice of Intention to Amend Local Law
No. 6—General

Notice is hereby given that at a meeting of Wyndham City Council on 9 September 1996, Council resolved its intention to amend Local Law No. 6, General Local Law, pursuant to the Local Government Act 1989.

The purpose of the amendment to Local Law No. 6 is to provide for the regulation of parking of vehicles greater than 4.5 tonnes on any premises in Residential Zones.

The purport of the amendment to Local Law No. 6 is to replace Clause 3.7 with a Code of Practice which states that "unless in accordance with a permit, a person must not allow a vehicle weighing more than 4.5 tonnes (whether when loaded or not) to be parked, kept or repaired on any premises in an area zoned primarily for residential purposes under the Planning Scheme".

A copy of the intended amendment to Local Law No. 6 can be obtained from the Customer Service Office, Civic Centre, 45 Princes Highway, Werribee during business hours.

Any person affected by this amendment to Local Law No. 6 may, within fourteen (14) days after publication of this notice, make a submission to it which will be considered in accordance with Section 223 of the Local Government Act 1989.

Submissions about the amendment should be forwarded to the Chief Executive Officer, P.O. Box 197, Werribee 3030 and indicate whether the submitters wish to be heard in support of the submission.

IAN ROBINS
Chief Executive Officer

BANYULE CITY COUNCIL

Local Law No 1 provides that
Clause 206: Council may by resolution prohibit certain activities or behaviour on a Road.

Council may by resolution prohibit or regulate any activity including the use of Toy Vehicles or the drinking of alcohol or being in possession of an opened container of alcohol in or on a specified Road or in a specified portion of the municipal district subject to such conditions as Council thinks fit.

Whereas Council at its meeting on 23 September 1996 resolved to prohibit the drinking of alcohol and being in possession of an open container of alcohol in the Mall and notice of this resolution has been published in the Government Gazette.

Notice is now given that any member of the Victorian Police may enforce that prohibition.

12406

HORSHAM RURAL CITY COUNCIL
Local Law No. 4
(Amendment No. 1) Local Law

The Horsham Rural City Council proposes to make a Local Law entitled Horsham Rural City Council's Streets and Roads Local Law No. 4 (Amendment No. 1) Local Law to provide for the regulation of activities within the municipal district of the Council.

The purposes (objectives) of the proposed Local Law are specifically to:

amend the Council's Streets and Roads Local Law No. 4 (the principal Local Law) for the purpose of more adequately regulating the

use for trading purposes of public places (other than those already dealt with in the principal Local Law), vacant land and land not ordinarily occupied by the trader with a view to ensuring that the activities of itinerant traders can be regulated effectively under the municipal Local Law and for purposes of correcting, expanding and clarifying the wording of the principal Local Law.

The general purport of the proposed Local Law includes specification of the form of regulation with a view to achieving the stated objectives. Its aim is to clarify expected standards of conduct within the municipal district to address the welfare of the whole community. In attempting to achieve this aim, it also addresses an extension of the purposes of the municipal Local Law to include the purposes stated above; a clarification of some clause headings by substitution; a new definition of commencement date; a substituted Sub-clause 56 (1) to make it clear that an itinerant trader may not trade in the municipal district without a permit and the penalty which will apply if he or she does so; the penalties for infringement notice purposes applying to any such trading contrary to the amended Local Law; the inclusion of specific permit conditions relevant to the placement of advertising signs and eating facilities on roads and the inclusion of the sale of raffle tickets as a collection on roads requiring a permit.

A copy of the proposed Local Law may be inspected at or obtained from the Council's Horsham or Natimuk office.

Any person affected by the proposed Local Law may make a written submission to Council under Section 223 of the **Local Government Act 1989**. Submissions received by the Council within 14 days of the publication of this notice will be considered in accordance with Section 223. Any person requesting that he or she be heard in support of his or her submission is entitled to appear before a meeting of the Council or a Council committee either personally or by a person acting on his or her behalf and will be notified of the time and date of the hearing.

Submissions should be lodged at the Council's office at the Civic Centre, Roberts Avenue, Horsham 3400 or posted to the Council at the following address so as to arrive within 14 days of this publication: P.O. Box 511, Horsham 3402.

All interested residents and ratepayers are encouraged to acquaint themselves with the proposed Local Law.

K. V. SHADE
Chief Executive Officer

BALLARAT CITY COUNCIL
Notice of Local Law

Ballarat City Council has made a Local Law No. 4 titled Meeting Procedure (Amendment) Local Law for the purpose of:

- (a) Amending the provisions in Council's Meeting Procedure Local Law relating to the handling of debate in Council and committee meetings on amendments to motions.
- (b) Confirming the adoption of the Council's Meeting Procedure Local Law as amended.

Copies of the Local Law can be obtained from the Council Offices, Arrandale House, Bath Lane, Ballarat during normal office hours.

JANET DORE
Chief Executive Officer

MILDURA RURAL CITY COUNCIL
Notice that any Police Officer May Enforce
Provision of Local Law

The Mildura Rural City Council has made Local Law No. 4 for the purpose of regulating the behaviour of people in municipal places which affects the enjoyment of others in such places. Part seven (7) of the Local Law restricts the possession of alcohol in unsealed containers, or the consumption of alcohol in specific areas of the municipality at specific times, without first obtaining a permit.

The specific provision is contained in Clause L7.1 which reads:

- (a) No person may consume any liquor, have in their possession or under their control, any liquor other than in a sealed container, in or on any municipal place which is located or contained within the area shown on the maps attached to Schedule one (1) of the Local Law, unless the municipal place is a licensed premises under the **Liquor Control Act 1987**.
- (b) No person may consume any liquor in any public place or have in possession or under control any liquor other than liquor in a sealed container between the

hours of 10.00 p.m. and 10.00 a.m. within the area shown on the map in Schedule No. 1A of this Local Law, being the area known as the "Riverfront" area including the Rowing Club lawns, Ornamental Lakes Park and Jaycee Park, without first obtaining a permit, unless within the abovementioned hours, the public place is or is part of licensed premises or authorised premises under the Liquor Control Act 1987.

Penalty: five (5) penalty units.

Infringement Notice: one (1) penalty unit.

L7.2 Exemptions

Despite Clause L7.1 the Council may grant a permit for the consumption of any liquor or for the possession of liquor in unsealed containers in any municipal place identified in the maps in Schedule one (1) or 1A of the Local Law.

Section 224A of the Local Government Act 1989, provides for the enforcement of these provisions by any Police Officer and will take effect from the date of publication of this notice. Enforcement may also be undertaken by any authorised officer of Council. The Local Law also provides for the issue of an infringement notice for an amount of \$100.00 to any person failing to comply with the provisions of the Local Law (as an alternative to prosecution in the Courts).

GRAEME DAVY
Chief Executive Officer

**Planning and Environment Act 1987
GREATER BENDIGO PLANNING
SCHEME**

Notice of Amendment to a Planning Scheme
Amendment L54

The City of Greater Bendigo has prepared Amendment L54 to Chapter 2 of the Greater Bendigo Planning Scheme. The amendment applies to land currently occupied by the Bendigo Regional Saleyards described as CA 307E, 307F, 307K, 307L, 307M, 307N, Section O, Parish of Sandhurst (CP116472-A and CP117203) as shown on the map forming part of this amendment.

The amendment proposes to change Map 6 of the Greater Bendigo Planning Scheme (Chapter 2) by rezoning the subject land to

Public Purposes Reservation (Education Department) and Special Use (Private Recreation) Zone.

The amendment can be inspected at The City of Greater Bendigo, Planning and Business Unit, 34 Mundy Street, Bendigo 3550; The Office of Planning and Heritage, Ground Floor, 477 Collins Street, Melbourne 3000 or The Office of Planning and Heritage, 426 Hargreaves Street, Bendigo 3550.

You may make a submission for or against the amendment by writing to Chief Executive Officer, P.O. Box 477, Bendigo 3550.

Submissions must be received by Monday, 18 November 1996.

**Planning and Environment Act 1987
YARRA PLANNING SCHEME
Notice of Amendment
Amendment L25**

The City of Yarra has prepared Amendment L25 to the Yarra Planning Scheme.

The amendment affects the land bound by Rose, Kerr, Napier and George Streets, Fitzroy. The amendment proposes to change the zoning from General Industrial to Residential C and incorporates a development plan.

This amendment is available for public inspection free of charge during office hours at Yarra City Council, Richmond Town Hall, 333 Bridge Road, Richmond; Yarra City Council, Collingwood Town Hall, 140 Hoddle Street, Abbotsford and the Department of Planning, Ground Floor, Olderfleet Buildings, 477 Collins Street, Melbourne.

Submissions about the amendment must be sent to Chief Executive Officer, Yarra City Council, P.O. Box 140, Abbotsford, Victoria 3067 to be received no later than 4.00 p.m. 12 November 1996.

PRUE DIGBY
Chief Executive Officer

**Planning and Environment Act 1987
FRANKSTON PLANNING SCHEME
Notice of Amendment
Amendment L84**

The Frankston City Council has prepared Amendment L84 to the Local Section of the Frankston Planning Scheme.

This amendment proposes to rezone land at 18R Karina Street, Frankston; Part of 32R Sycamore Road, Frankston and 12R Macrosty Court, Frankston from Public Use Zone—Open Space to the residential zone that applies to surrounding land.

It also proposes to introduce controls to protect indigenous vegetation adjoining the watercourse that crosses 18R Karina Street and to remove the reserve notation from the titles of 32R Sycamore Road and 12R Macrosty Court.

These sites have been found to be surplus to Council's needs as part of a systematic review of Frankston City's real estate assets.

The amendment can be inspected at Frankston City Council, Town Planning Department, Civic Centre, Davey Street, Frankston, Victoria 3199 and the Office of Planning and Heritage, Ground Floor, Olderfleet Buildings, 477 Collins Street, Melbourne, Victoria 3000.

Submissions about the amendment must be sent to Development Manager, Frankston City Council, P.O. Box 490, Frankston, Victoria 3199, Attention: John Eichler by 19 November 1996.

Dated 10 October 1996

JON EDWARDS
Chief Executive Officer

Planning and Environment Act 1987
CRANBOURNE PLANNING SCHEME—
Notice of Amendment
Amendment L179

The Frankston City Council has prepared Amendment L179 to the Local Section of the Cranbourne Planning Scheme.

This amendment proposes to rezone land at 106R Yarralumla Drive, Langwarrin and part of 17R Dion Drive, Carrum Downs from Public Use Zone—Open Space to Residential (Urban). It also proposes to remove the reserve notation from both titles.

These sites have been found to be surplus to Council's needs as part of a systematic review of Frankston City's real estate assets.

The amendment can be inspected at Frankston City Council, Town Planning Department, Civic Centre, Davey Street, Frankston, Victoria 3199 and the Office of

Planning and Heritage, Ground Floor, Olderfleet Buildings, 477 Collins Street, Melbourne, Victoria 3000.

Submissions about the amendment must be sent to Development Manager, Frankston City Council, P.O. Box 490, Frankston, Victoria 3199, Attention: John Eichler by 19 November 1996.

Dated 10 October 1996

JON EDWARDS
Chief Executive Officer

Planning and Environment Act 1987
YARRA RANGES PLANNING SCHEME—
LOCAL SECTION
CHAPTER 2 (LILYDALE DISTRICT)
Notice of Amendment
Amendment L42

The Council of the Shire of Yarra Ranges has prepared an amendment, Amendment L42, to the Yarra Ranges Planning Scheme—Local Section—Chapter 2 (Lilydale District).

The amendment proposes to introduce discretion into the Lilydale Chapter of the Yarra Ranges Planning Scheme to allow land at Lot 11LP 9303, 19 Leggett Drive, Mt Evelyn to be subdivided into two lots. Specifically, the proposal is to excise approximately 4000 m² from the 3.5 hectare property, with an existing house to be contained within each allotment.

SUBMISSIONS

The amendment can be inspected free of charge during normal office hours at the following Service Centres of the Shire of Yarra Ranges: Lilydale, Anderson Street, Lilydale; Monbulk, 94 Main Street, Monbulk; Healesville, 276 Maroondah Highway, Healesville; Upwey, 40 Main Street, Upwey; Yarra Junction, Warburton Highway/Hoddle Street, Yarra Junction and at Department of Infrastructure, Office of Planning and Heritage, Ground Floor, Olderfleet Building, 477 Collins Street, Melbourne.

Any submissions about the amendment must:

- be made in writing, giving the submitter's name, address and, if practicable, a phone number for contact during office hours;
- set out the views on the amendment, that the submitter wishes to put before Council and indicate what changes (if any) the submitter wishes made to the amendment; and

- state whether the person/s making the submission wishes to be heard in support of their submission.

Submissions must be sent to Mr Eric Howard, Chief Executive Officer, Shire of Yarra Ranges, P.O. Box 105, Lilydale 3140 and must reach the Shire at the above address by 14 November 1996.

Enquiries about the amendment can either be made by calling at the Land Use Strategy Unit, Lilydale District Office, Anderson Street, Lilydale during normal office hours or by telephoning Emma Wakeham on either 1300 368 333 or directly on 9735 8378.

GRAHAM WHITT
Manager Land Use Strategy

Planning and Environment Act 1987
YARRA RANGES PLANNING SCHEME—
LOCAL SECTION
CHAPTER 5 (UPPER YARRA DISTRICT)
Notice of Amendment
Amendment L43

The Council of the Shire of Yarra Ranges has prepared an amendment, Amendment L43, to the Yarra Ranges Planning Scheme—Local Section—Chapter 5 (Upper Yarra District).

The amendment proposes to introduce discretion into the Upper Yarra Chapter of the Yarra Ranges Planning Scheme to allow the land at Lot 2 PS 128420, 1760 Warburton Highway, Woori Yallock to be subdivided into two lots with an existing house to be contained on each allotment.

SUBMISSIONS

The amendment can be inspected free of charge during normal office hours at the following Service Centres of the Shire of Yarra Ranges: Lilydale, Anderson Street, Lilydale; Monbulk, 94 Main Street, Monbulk; Healesville, 276 Maroondah Highway, Healesville; Upwey, 40 Main Street, Upwey; Yarra Junction, Warburton Highway/Hoddle Street, Yarra Junction and at Department of Infrastructure, Office of Planning and Heritage, Ground Floor, Olderfleet Building, 477 Collins Street, Melbourne.

Any submissions about the amendment must:

- be made in writing, giving the submitter's name, address and, if practicable, a phone number for contact during office hours;

- set out the views on the amendment, that the submitter wishes to put before Council and indicate what changes (if any) the submitter wishes made to the amendment; and
- state whether the person/s making the submission wishes to be heard in support of their submission.

Submissions must be sent to Mr Eric Howard, Chief Executive Officer, Shire of Yarra Ranges, P.O. Box 105, Lilydale 3140 and must reach the Shire at the above address by 14 November 1996.

Enquiries about the amendment can either be made by calling at the Land Use Strategy Unit, Lilydale District Office, Anderson Street, Lilydale during normal office hours or by telephoning Emma Wakeham, on either 1300 368 333 or directly on 9735 8378.

GRAHAM WHITT
Manager Land Use Strategy

Planning and Environment Act 1987
DIMBOOLA PLANNING SCHEME
Notice of Amendment
Amendment L6

The Hindmarsh Shire Council has prepared Amendment L6 to the Dimboola Planning Scheme.

The amendment proposes the following alterations to the Scheme.

- (a) To delete "SHOP" as a Section 3 (prohibited use) in the Rural Zone.
- (b) To change the zoning from Rural (RU) to Township (T) of that part of C.A. 7, Parish of Jeparit extending from the eastern boundary of Tullyvea Street along Charles Street for a distance of 100 metres and extending from Charles Street to the railway land on the north side, and as shown on the attached plan.

The amendment can be inspected at the Hindmarsh Shire Offices at 92 Nelson Street, Nhill; 10 Roy Street, Jeparit; Lloyd Street, Dimboola; Federal Street, Rainbow and the Offices of the Department of Infrastructure, State Government Offices, corner of Doveton and Main Streets, Ballarat and the Olderfleet Building, 477 Collins Street, Melbourne.

Submissions about the amendment must be in writing and forwarded to the Hindmarsh Shire, P.O. Box 250, Nhill 3418 by 20 November 1996.

PETER WIGNALL
Chief Executive Officer

Planning and Environment Act 1987
BANYULE PLANNING SCHEME
Notice of Amendment to Planning Scheme
Amendment L7

The City of Banyule has proposed Amendment L7 to the Local Section of the Banyule Planning Scheme. The amendment affects land at 420 Grimshaw Street, Bundoora.

The amendment proposes to introduce the following site specific provision within the Residential C (Diamond Valley/Eltham) Zone to allow the use and development of land at 420 Grimshaw Street, Bundoora for "Motor Vehicle Sales".

After Clause 127-4.1 insert the following new Clause:

Specific Site Control

Land known as No. 420 Grimshaw Street, Bundoora and described as Lot 5 on Plan of Subdivision 83539 (Certificate of Title Volume 8770, Folio 264).

A permit is not required to use and develop the land for the purposes of Motor Vehicle Sales provided that:

- The use is in accordance with the plan drawn by Michael Iacuone (Architect) dated 3 May 1996 Reference No. 419A.
- Motor Vehicle Repairs other than car detailing and minor repairs of vehicles for sale at the premises shall not be carried out on the land.
- The signage is in accordance with the plan drawn by Michael Iacuone (Architect) dated 3 May 1996 Reference No. 419A.

Vehicular and pedestrian access circulation and carparking is provided to the satisfaction of the Responsible Authority.

- The perimeter of the site on the northern and eastern boundary to a depth of 3 metres is set aside for landscaping, in accordance with a landscape plan to be approved by the Responsible Authority.

- The hours of operation are restricted to the following—

Monday to Sunday 8.00 a.m.—6.00 p.m.

- All lighting is contained within the site to the satisfaction of the Responsible Authority.
- The use and development of the land does not adversely affect the amenity of the locality by the appearance of any building, works or materials, the transporting of goods to or from the premises, emissions from the site or in any other way.
- Any proposed car wash facilities to be contained within the site shall be for the sole purpose of washing cars which are for display at the site and such facility enclosed to the satisfaction of the Responsible Authority and comply with the requirements of the Environment Protection Authority.

A permit may be granted to vary any of these requirements.

The amendment can be inspected free of charge during office hours at City of Banyule, Customer Services Centres: Rosanna Service Centre, 44 Turnham Avenue, Rosanna 3084; Ivanhoe Service Centre, 275 Upper Heidelberg Road, Ivanhoe 3079; Greensborough Service Centre, 9-13 Flintoff Street, Greensborough 3088 and the Office of Planning and Heritage, Ground Floor, Olderfleet Building, 477 Collins Street, Melbourne 3000.

Any submissions about the amendment must be sent to Mr Tim Fallaw, Manager Development Planning Co-ordinator, Banyule City Council, P.O. Box 51, Ivanhoe 3079 by 16 November 1996.

Dated 16 October 1996

TIM FALLAW
Development Planning Co-ordinator

Planning and Environment Act 1987
WARRNAMBOOL PLANNING SCHEME
CHAPTER 2
Notice of Amendment to a Planning Scheme
Amendment L22

The Warrnambool City Council has prepared Amendment L22 to the Warrnambool Planning Scheme.

The amendment affects land at:

The land is generally located south of the Merri River Cutting from Swinton Street to O'Brien Street, land south of Younger Street from O'Brien Street to Denman Drive and south-west of McGennan Street and in the area currently occupied by the Rifle Range generally described as Crown Allotments 1, 2, 3, 4, 5A, 6, 6A, 7, 7A, 9, 9A, 10, 12 and 13, Section 74, Parish of Wangoom. A permanent reserve for the prevention of the irruption of sand (Gaz 73.910), Part Rifle Range permissive occupancy (C66043), Part reserve for Public Purposes (Gaz 99.2525, RS291) and a reserve for Public Purposes (RS285).

The amendment proposes to change the Planning Scheme by:

Rezoning the land from Special Investigation, Public Open Space 1 (Foreshore Reserve), Public Open Space 7 (Golf Club), Public Open Space 6 (Rifle Range), Public Purposes 10 (Department of Army), Public Purposes 6 (Municipal Purposes) to Special Use 19 (Golf Course) to provide for the development of a 27 hole golf course, residential development, tourist facilities, coastal park and other works ancillary to the golf course in accordance with Plan TW01.

A copy of the amendment can be inspected free of charge during office hours at Warrnambool City Council, Municipal Offices, 25 Liebig Street, Warrnambool 3280 and The Department of Infrastructure, Planning Division, Olderfleet Buildings, 477 Collins Street, Melbourne 3000.

Submissions about the amendment must be sent to the Town Planning Department, Warrnambool City Council, P.O. Box 198, Warrnambool 3280 by 12 noon on Monday, 4 November 1996.

Dated 17 October 1996

RUSSELL GUEST
Town Planner

Planning and Environment Act 1987
KINGSTON PLANNING SCHEME
Notice of Amendment
Amendment L18

The City of Kingston has prepared Amendment L18 to the Local Section of the Kingston Planning Scheme.

The amendment proposes to rezone Council owned land at Lots 1 to 8 and Part Lot 9, Plan of Subdivision 8882, Beardsworth Avenue,

Part Chelsea Road, and Part Lots 191, 192, 193 and 194, Plan of Subdivision 5524, Thames Promenade, Chelsea from Local Government Purposes Reservation to a Residential C Zone.

The purpose of the amendment is to enable the establishment of residential uses compatible with the surrounding area, subject to appropriate environmental standards.

The amendment can be inspected at City of Kingston, Mentone Office, Cnr Brindisi Street and Mentone Parade, Mentone 3194 and Department of Planning and Development, Ground Floor, Olderfleet Buildings, 477 Collins Street, Melbourne 3000.

Submissions about the amendment must be sent to Chief Executive Officer, City of Kingston, P.O. Box 21, Moorabbin 3189, Attention: Ian Nice, Team Leader—Statutory Approvals by 17 November 1996.

SCOTT TAYLOR
Development Approvals Co-ordinator

Planning and Environment Act 1987
KINGSTON PLANNING SCHEME
Notice of Amendment
Amendment L19

The City of Kingston has prepared Amendment L19 to the Local Section of the Kingston Planning Scheme.

The amendment proposes to rezone Council owned land at 95-103 Collins Street, Mentone from a part Light Industrial Zone and part Public Purposes Local Government Reservation to a Residential C Zone.

The purpose of the amendment is to enable the establishment of residential uses compatible with the surrounding area subject to appropriate environmental standards.

The amendment can be inspected at City of Kingston, Mentone Office, Cnr Brindisi Street and Mentone Parade, Mentone 3194 and Department of Planning and Development, Ground Floor, Olderfleet Buildings, 477 Collins Street, Melbourne 3000.

Submissions about the amendment must be sent to Chief Executive Officer, City of Kingston, P.O. Box 21, Moorabbin 3189, Attention: Ian Nice, Team Leader—Statutory Approvals by 17 November 1996.

SCOTT TAYLOR
Development Approvals Co-ordinator

**Survey Co-ordination Act 1958
PLACE NAMES COMMITTEE**

1. Notice of Assignment of Place Names

The Place Names Committee hereby gives notice that it has assigned the undermentioned place names in respect of which no objections to the previously published proposals were received.

<i>File No.</i>	<i>Place Name</i>	<i>Proposer and Location</i>
1270	Terang College	Directorate of School Education, as a result of a merger between Terang High and Primary Schools, to take away those names and assign the name as shown.
1576	Arthur W. Peterson Reserve	Mornington Peninsula Shire Council. That part of the Railway Reserve situated at the corner of Crib Point Road and Park Road, Crib Point.
1577	Jim Willis Reserve	Bayside City Council. That part of the Brighton foreshore between Were Street and Keith Court on the west side of The Esplanade, Brighton.
1580	Woodlands Primary School	Directorate of School Education. A new school located off Gumnut Drive, Langwarrin.
1581	Oatlands Primary School	Directorate of School Education. A new school located off Kurrajong Road, Berwick.

2. Notice of Alteration of Place Names

The Place Names Committee hereby gives notice that it has altered the undermentioned place names in the manner indicated and in respect of which no objections to the previously published proposals were received.

<i>File No.</i>	<i>New Name</i>	<i>Former Name</i>
1270	Gilmore College for Girls	Footscray Girls Secondary College
1270	Elwood College	Elwood Secondary College
1560	Hume Dam	Hume Weir
1578	Foster Primary School	Foster Consolidated School

CORRIGENDUM

The Victoria Government Gazette No. G35 dated 5 September 1996, Page 2345, under Notice of Assignment, the name Sale College—Macalister Campus was omitted; and on Page 2346, under Notice of Proposal to Assign, the name Wycheproof P-12 College was omitted.

Place Names Committee, care of Office of Surveyor-General, 5th Floor, 436 Lonsdale Street, Melbourne 3000.

RON McLEOD
Secretary

**County Court Act 1958
COUNTY COURT SITTINGS 1997**

The Governor in Council having directed that the County Court be held at each of the undermentioned places, I hereby appoint the following days of each months as the days upon which the Court shall commence sittings at such places during the year 1997.

BAIRNSDALE

MARCH	Monday 3 March	to	Friday 4 April
OCTOBER	Monday 29 September	to	Friday 24 October

BALLARAT

FEBRUARY	Monday 3 February	to	Friday 28 February (2 Judges)
MARCH	Monday 3 March	to	Friday 4 April
	Monday 3 March	to	Friday 14 March (WorkCover)
APRIL	Monday 7 April	to	Friday 2 May (2 Judges)
MAY	Monday 5 May	to	Friday 30 May
	Monday 5 May	to	Friday 16 May (WorkCover)
JUNE	Monday 2 June	to	Friday 27 June
JULY	Monday 14 July	to	Friday 25 July (WorkCover)
AUGUST	Monday 28 July	to	Friday 29 August
OCTOBER	Monday 29 September	to	Friday 24 October
	Monday 13 October	to	Friday 24 October (WorkCover)
NOVEMBER	Monday 27 October	to	Friday 21 November (2 Judges)
DECEMBER	Monday 24 November	to	Friday 19 December

BENDIGO

FEBRUARY	Monday 3 February	to	Friday 28 February
MARCH	Monday 3 March	to	Friday 4 April
APRIL	Monday 21 April	to	Friday 2 May (WorkCover)
MAY	Monday 5 May	to	Friday 30 May (Civil)
JUNE	Monday 2 June	to	Friday 27 June
JULY	Monday 30 June	to	Friday 11 July
AUGUST	Monday 28 July	to	Friday 29 August
	Monday 28 July	to	Friday 8 August (WorkCover)
OCTOBER	Monday 29 September	to	Friday 24 October (Civil)
	Monday 29 September	to	Friday 10 October (WorkCover)
NOVEMBER	Monday 27 October	to	Friday 21 November
DECEMBER	Monday 24 November	to	Friday 19 December

GEE LONG

FEBRUARY	Monday 3 February	to	Friday 28 February
	Monday 3 February	to	Friday 14 February (WorkCover)
MARCH	Monday 3 March	to	Friday 4 April
APRIL	Monday 7 April	to	Friday 2 May (2 Judges)
MAY	Monday 5 May	to	Friday 30 May
JUNE	Monday 2 June	to	Friday 27 June
	Monday 16 June	to	Friday 27 June (WorkCover)
AUGUST	Monday 28 July	to	Friday 29 August (2 Judges)
SEPTEMBER	Monday 1 September	to	Friday 26 September
OCTOBER	Monday 29 September	to	Friday 24 October (Civil)
NOVEMBER	Monday 27 October	to	Friday 21 November
DECEMBER	Monday 24 November	to	Friday 19 December (Civil)
	Monday 8 December	to	Friday 19 December (WorkCover)

HAMILTON

APRIL	Monday 7 April	to	Friday 18 April (WorkCover)
MAY	Monday 5 May	to	Friday 30 May
JUNE	Monday 2 June	to	Friday 13 June (WorkCover)
AUGUST	Monday 11 August	to	Friday 22 August (WorkCover)
OCTOBER	Monday 29 September	to	Friday 24 October
NOVEMBER	Monday 10 November	to	Friday 21 November (WorkCover)

HORSHAM

APRIL	Monday 7 April	to	Friday 2 May
SEPTEMBER	Monday 1 September	to	Friday 26 September

KERANG

APRIL	Monday 7 April	to	Friday 2 May
SEPTEMBER	Monday 1 September	to	Friday 26 September

MELBOURNE

JANUARY	Monday 20 January	to	Friday 31 January
FEBRUARY	Monday 3 February	to	Friday 28 February
MARCH	Monday 3 March	to	Friday 4 April

(Easter Thursday 27 March to Tuesday 1 April)

APRIL	Monday 7 April	to	Friday 2 May
MAY	Monday 5 May	to	Friday 30 May
JUNE	Monday 2 June	to	Friday 27 June
JULY	Monday 30 June	to	Friday 25 July
AUGUST	Monday 28 July	to	Friday 29 August
SEPTEMBER	Monday 1 September	to	Friday 26 September
OCTOBER	Monday 29 September	to	Friday 24 October
NOVEMBER	Monday 27 October	to	Friday 21 November
DECEMBER	Monday 24 November	to	Friday 19 December

MILDURA

FEBRUARY	Monday 3 February	to	Friday 28 February
JUNE	Monday 2 June	to	Friday 27 June (Civil)
SEPTEMBER	Monday 1 September	to	Friday 26 September
NOVEMBER	Monday 27 October	to	Friday 7 November (WorkCover)

MORWELL

FEBRUARY	Monday 3 February	to	Friday 28 February
MARCH	Monday 3 March	to	Friday 4 April (Civil)
APRIL	Monday 7 April	to	Friday 2 May
MAY	Monday 5 May	to	Friday 30 May
JUNE	Monday 2 June	to	Friday 27 June (Civil)
AUGUST	Monday 28 July	to	Friday 29 August
SEPTEMBER	Monday 1 September	to	Friday 26 September
OCTOBER	Monday 29 September	to	Friday 24 October (Civil)
NOVEMBER	Monday 27 October	to	Friday 21 November
DECEMBER	Monday 24 November	to	Friday 19 December

SALE

MARCH	Monday 17 March	to	Wednesday 26 March (WorkCover)
MAY	Monday 19 May	to	Friday 30 May
JUNE	Monday 2 June	to	Friday 27 June (Civil)
NOVEMBER	Monday 27 October	to	Friday 21 November

SHEPPARTON

FEBRUARY	Monday 3 February	to	Friday 28 February
JUNE	Monday 2 June	to	Friday 27 June (Civil)
AUGUST	Monday 28 July	to	Friday 29 August
SEPTEMBER	Monday 1 September	to	Friday 26 September
DECEMBER	Monday 24 November	to	Friday 19 December (Civil)

TRARALGON

MARCH	Monday 3 March	to	Friday 4 April (Civil)
MAY	Monday 19 May	to	Friday 30 May
SEPTEMBER	Monday 1 September	to	Friday 12 September
DECEMBER	Monday 24 November	to	Friday 15 December

WANGARATTA

FEBRUARY	Monday 17 February	to	Friday 28 February (WorkCover)
MARCH	Monday 3 March	to	Friday 4 April
MAY	Monday 5 May	to	Friday 30 May
AUGUST	Monday 28 July	to	Friday 29 August
SEPTEMBER	Monday 15 September	to	Friday 26 September (WorkCover)
OCTOBER	Monday 29 September	to	Friday 24 October (Civil)
DECEMBER	Monday 24 November	to	Friday 19 December

WARRNAMBOOL

MARCH	Monday 3 March	to	Friday 4 April
JUNE	Monday 2 June	to	Friday 27 June (Civil)
SEPTEMBER	Monday 1 September	to	Friday 26 September
NOVEMBER	Monday 27 October	to	Friday 21 November (Civil)
DECEMBER	Monday 24 November	to	Friday 19 December

EXEMPTION FROM NOTIFICATION OF
VACANCY UNDER SECTION 29 (2) OF THE
PUBLIC SECTOR MANAGEMENT ACT
1992

Position Nos 70/61/3345/0, 70/01/5570/1,
70/01/5569/7, 70/68/3365/5, 70/68/1917/7,
70/68/4529/0, 70/68/0960/6, 70/68/0939/9,
70/68/4576/7 and 33/38/0790/0 Western
Metropolitan Region, Department of Human
Services.

Reasons for exemption

The positions have identical duties and qualifications to the ten positions that were recently advertised in the VPSN and the press and the persons applied for the vacancies and were assessed as meeting the requirements of the positions.

Dated 25 September 1996

W. J. McCANN
Secretary
Department of Human Services

EXEMPTION FROM NOTIFICATION OF
VACANCY UNDER SECTION 29 (2) OF THE
PUBLIC SECTOR MANAGEMENT ACT
1992

Position No. 70/01/5049/0, VPS-2/Ranger
Grade 3, Aboriginal Heritage Officer,
Heritage Services Branch, Aboriginal Affairs
Victoria.

Reasons for exemption

The position is to be filled by the employment of a person from a disadvantaged group and this person is considered to meet the key selection criteria.

Dated 25 September 1996

W. J. McCANN
Secretary
Department of Human Services

EXEMPTION FROM NOTIFICATION OF
VACANCY UNDER SECTION 29 (2) OF THE
PUBLIC SECTOR MANAGEMENT ACT
1992

Position No. 35/01/2711/8, Project/CADD
Manager, VPS-4, Property Services Branch,
Housing Services Division, Department of
Human Services.

Reasons for exemption

The position has been reclassified in a specialised area of work and the officer is recognised as satisfactorily discharging all the requirements of the position and it is considered unlikely that advertising the position would attract a more suitable candidate.

Dated 19 September 1996

W. J. McCANN
Secretary
Department of Human Services

**EXEMPTION FROM NOTIFICATION OF
VACANCY UNDER SECTION 29 (2) OF THE
PUBLIC SECTOR MANAGEMENT ACT
1992**

Position No. 35/01/2662/5, Project
Manager, VPS-4, Property Services Branch,
Housing Services Division, Department of
Human Services.

Reasons for exemption

The position has been reclassified in a
specialised area of work and the officer is
recognised as satisfactorily discharging all the
requirements of the position and it is
considered unlikely that advertising the
position would attract a more suitable
candidate.

Dated 19 September 1996

W. J. McCANN
Secretary
Department of Human Services

Department of Treasury and Finance
**SALE OF CROWN LAND BY PUBLIC
AUCTION**
Reference No. GL/19251

Auction Date: 23 November 1996 at 10.30
a.m. on site.

Address of Property: 1 Crawford Road,
Chiltern.

Crown Description: CA 29B, Section 6,
Parish of Chiltern.

Area: 1405 m².

Terms of Sale: 10% Deposit, Settlement
60 Days.

Agent: Diffey Real Estate Pty Ltd, 75
Main Street, Rutherglen, Victoria 3685,
telephone (060) 32 8655.

Officer Co-ordinating Sale: Anna
Brockhurst, Project Manager, Victorian
Government Property Group, Department of
Treasury and Finance.

ROGER M. HALLAM
Minister for Finance

Department of Treasury and Finance
**SALE OF CROWN LAND BY PUBLIC
AUCTION**

On Saturday, 9 November 1996 at 12.30
p.m. on site.

Address of Property: Corner of Dairtnunk
and Montana Avenues, Cardross.

Crown Description: Crown Allotment
588^B, Section B, Parish of Mildura.

Terms of Sale: Deposit 10%, Balance 90
days.

Area: 817 m².

Officer Co-ordinating Sale: Sue Muller,
Victorian Government Property Group,
Department of Treasury and Finance, 10/1
Macarthur Street, Melbourne, Victoria 3002.

Selling Agent: Elders Real Estate, 74
Madden Avenue, Mildura, Victoria 3500.

ROGER M. HALLAM
Minister for Finance

Department of Treasury and Finance
**SALE OF CROWN LAND BY PUBLIC
AUCTION**

On Saturday, 9 November 1996 at 10.30
a.m. on site.

Address of Property: Benetook Avenue,
Koorlong.

Crown Description: Crown Allotment
14^B, Section 133, Block F at Redcliffs in the
Parish of Mildura.

Terms of Sale: Deposit 10%, Balance 90
days.

Area: 776 m².

Officer Co-ordinating Sale: Sue Muller,
Victorian Government Property Group,
Department of Treasury and Finance, 10/1
Macarthur Street, Melbourne, Victoria 3002.

Selling Agent: Elders Real Estate, 74
Madden Avenue, Mildura, Victoria 3500.

ROGER M. HALLAM
Minister for Finance

Department of Treasury and Finance
**SALE OF CROWN LAND BY PUBLIC
AUCTION**

On Friday, 8 November 1996 at 2.30 p.m.
on site.

Address of Property: Millewa Road,
Meringur.

Crown Description: Crown Allotment 1^D,
Section A, Township and Parish of Meringur.

Terms of Sale: Deposit 10%, Balance 90
days.

Area: 828 m².

Officer Co-ordinating Sale: Sue Muller, Victorian Government Property Group, Department of Treasury and Finance, 10/1 Macarthur Street, Melbourne, Victoria 3002.

Selling Agent: Elders Real Estate, 74 Madden Avenue, Mildura, Victoria 3500.

ROGER M. HALLAM
Minister for Finance

Department of Treasury and Finance
SALE OF CROWN LAND BY PUBLIC
AUCTION

Saturday, 25 January 1997 at 11.00 a.m. on site.

Property Address: Cnr Great Ocean Road and Old Coach Road, Skenes Creek.

Crown Description: Allotment 17, Section 3A, Township of Skenes Creek.

Area: 2.022 ha.

Reference: 05/12067

Terms of Sale: 10% deposit—balance 60 days.

Co-ordinating Officer: Graeme Barnes, Sales Officer, Department of Natural Resources and Environment, Ballarat.

Selling Agent: Noel Tanis, Smyth Real Estate, 149 Great Ocean Road, Apollo Bay 3233, telephone (052) 377377.

ROGER M. HALLAM
Minister for Finance

Department of Treasury and Finance
SALE OF CROWN LAND BY PUBLIC
AUCTION

Friday, 7 February 1997.

Lot 1: 12.00 noon on site.

Property Address: George Road, Ararat.

Crown Description: Allotment 2A, Section 113, Township of Ararat.

Area: 1.429 ha.

Reference: 90-1163.

Lot 2: 12.30 p.m. on site.

Property Address: Cnr McDonald and Hucker Streets, Ararat.

Crown Description: Allotment 10L, Section M, Township of Ararat.

Area: 1.312 ha.

Reference: P109487.

Terms of Sale: 10% deposit—balance 60 days.

Co-ordinating Officer: Graeme Barnes, Sales Officer, Department of Natural Resources and Environment, Ballarat.

Selling Agent: Brian McCutcheon, Spalding McCutcheon Pty Ltd, 179 Barkly Street, Ararat 3377, telephone (053) 522303.

ROGER M. HALLAM
Minister for Finance

NURSES BOARD OF VICTORIA

On 26 August 1996, a panel appointed by the Nurses Board of Victoria, found that the ability to practise of Moira Patricia Park of 13 Lawson Road, Mooroolbark, identification number 155997, registered in division 1, is affected because:

- (a) of her mental health; and
- (b) she is a drug dependent person.

The panel determines that:

1. The following conditions, limitations and restrictions be imposed on the nurse's registration, until removed pursuant to Paragraph 2.

- (a) The nurse must attend a medical practitioner acceptable to the Board on at least eight occasions over the next 12 months on random dates nominated at short notice by the practitioner.
- (b) The nurse must undergo drug screenings on which the practitioner must provide reports to the Board which are satisfactory to the Board.
- (c) The nurse must consult as soon as possible a psychiatrist or drug counsellor (a "counsellor") acceptable to the Board, and to continue to consult with that counsellor at least once a month, or more often if the counsellor recommends.
- (d) In December 1996 and June 1997 the nurse must provide the Board with written reports from the counsellor which are satisfactory to the Board.
- (e) The nurse must continue to attend Narcotics Anonymous.
- (f) The nurse must not have access to, nor administer, drugs referred to in Schedule 8 of the **Drugs Poisons and Controlled Substances Act 1981**.

2. After 26 August 1997, the conditions, restrictions and limitations imposed by Paragraph 1 of this determination may be removed on written application by the nurse, accompanied or preceded by:

- (a) the reports referred to in Sub-paragraphs 1 (b) and (d) of this determination;
- (b) a report from Narcotics Anonymous containing the frequency of her attendance;
- (c) a report from (an "employer") at least 6 months since the date of this determination, which report must be satisfactory to the Board.

3. After the conditions, limitations and restriction referred to in Paragraph 1 have been removed pursuant to Paragraph 2, the following condition, limitation or restriction shall be imposed on the nurse's registration.

- (a) She must provide a professional report from an employer by whom she has been employed as a registered nurse in division 1 for at least six months after the conditions, limitations or restrictions referred to in Paragraph 1 have been removed.

4. The condition, limitation or restriction imposed by Paragraph 3 may be removed on written application by the nurse accompanied by a copy of the report as required in the condition, which must be satisfactory to the Board.

LEANNE RAVEN
Chief Executive Officer
Nurses Board of Victoria

Gas Industry Act 1994
RELEVANT DATE FOR PURPOSES OF AN
ALLOCATION STATEMENT

I, Alan R. Stockdale, Treasurer, State of Victoria, and Minister responsible for the Gas Industry Act 1994, pursuant to Sub-section 63 (2) of the Gas Industry Act 1994, fix 1 November 1996 as the relevant date for the purposes of an allocation statement to be made in respect of the Gas Transmission Corporation, under Section 68 of the Gas Industry Act 1994.

Dated 14 October 1996

ALAN R. STOCKDALE
Treasurer and Minister responsible
for the Gas Industry Act 1994

Gas and Fuel Corporation (Repeal) Act
1995

RELEVANT DATE FOR PURPOSES OF AN
ALLOCATION STATEMENT

I, Alan R. Stockdale, Treasurer, State of Victoria, and Minister responsible for the Gas and Fuel Corporation (Repeal) Act 1995, pursuant to Sub-section 16 (2) of the Gas and Fuel Corporation (Repeal) Act 1995, fix 1 November 1996 as the relevant date for the purposes of an allocation statement to be made in respect of the State Electricity Commission of Victoria, under Section 18 of the Gas and Fuel Corporation (Repeal) Act 1995.

Dated 14 October 1996

ALAN R. STOCKDALE
Treasurer and Minister responsible
for the Gas and Fuel Corporation (Repeal)
Act 1995

Dangerous Goods Act 1985
VICTORIAN WORKCOVER AUTHORITY
Public Discussion Paper on the Review of the
Dangerous Goods Act 1985

In 1995 work began on a review of the Dangerous Goods Act 1985. A public discussion paper has now been produced and comments on the paper are invited.

A review of the Dangerous Goods Act 1985 is considered necessary for three reasons: the requirements of the Act are expressed in a way which is dated and lacking flexibility; there are inconsistencies with the Occupational Health and Safety Act 1985 which is dealing with related topics to the Dangerous Goods Act; and there is a growing imperative to ensure consistency with legislation in other Australian jurisdictions. The detailed reasons for the review are set out in the discussion paper.

The Dangerous Goods Act 1985 was proclaimed on 1 October 1985. The main objectives of the Act are to promote the safety of persons and property, to minimise the incidence of accidents involving dangerous goods and to mitigate the impact of any such accidents which may occur. The Act applies to all dangerous goods and all associated activities, viz. manufacture, storage, handling, transport, transfer, use and sale.

The Victorian WorkCover Authority's discussion paper presents a number of key issues for public comment. The discussion paper aims to:

- (a) review the types and styles of legislation that could be adopted by any new Act;
- (b) examine appropriate ways to provide for harmonisation of dangerous goods legislation with the **Occupational Health and Safety Act 1985** and associated Federal legislation;
- (c) identify who should have legislative duties, powers and rights under new legislation;
- (d) establish criteria for assessing the appropriateness and scope of different forms of government intervention; and
- (e) consider issues relevant to the administration and enforcement of a new Act.

Public comment is being sought on the above key issues and on the preferred approach for any new legislation. Copies of the discussion paper may be obtained by telephoning (03) 9628 8524 or by writing to Dangerous Goods Act Review, Manager, Standards Development and Coordination Unit, Victorian WorkCover Authority, P.O. Box 414, Melbourne, Victoria 3005.

Public comment and submissions on the discussion paper should be directed to the above address by no later than 60 days from the date of publication of this advertisement.

To assist the Victorian WorkCover Authority in its consideration of comments, it is requested that comments be divided into general comments and specific comments. Ideally, any specific comments would correspond to those headings used in the discussion paper. In addition, it would be of great assistance if submissions were typed. All submissions received will be treated as public documents.

ROGER M. HALLAM
Minister for Finance

Pipelines Act 1967

No. 7541

DEPARTMENT OF NATURAL
RESOURCES AND ENVIRONMENT
Application for a Permit to Own and Use a
Pipeline

1. In accordance with the provisions of Section 11 (1) of the Pipelines Act 1967, notice is given that an application has been

received by me from Gascor for a Permit to Own and Use a Pipeline for the purpose of owning and using a pipeline to convey gaseous hydrocarbons from Chiltern to Rutherglen.

2. An Environmental Effects Report (EER) and an Archaeological Report have been prepared for the Project and copies may be inspected at the same locations as the plans of the proposed route of the pipeline and which are listed in Point 4 of this Notice.

Additional copies may be obtained from Gas and Fuel, Building B, 1136 Nepean Highway, Highett, Victoria 3190.

3. The proposed route of the pipeline is as follows—

A steel pipeline approximately 14.3 km in length with a nominal bore of 200 mm and commencing at a branch valve on the Keon Park to Wodonga and Shepparton system of pipelines (Authorised under Permit No. 101) located on Part Allot 4, Sec C2, Parish of Chiltern West, adjacent to the south side of the intersection of Back Springhurst Road with Peakes Road, thence proceeding in a generally north westerly direction to cross Part Allot 4, Sec C2, to enter and cross Lots 1 and 2, LP128490, Part Allot 6, Sec C, Allots 5, 4, 3, 2 and 1, Sec C, Part Allot A, Allots 38, 37, 36, 35, 2, 32, 29A, 30, 3A, 3, 11 and 9, Sec U1, Shire of Chiltern West to the eastern side of Great Southern Road, crossing Back Springhurst Road, Marengos Road, Taylors Lane, Withers Road, two Government Roads, Rocky Creek Road, Black Dog Creek and its streamside Reserves and a Government Road en route, thence crossing Great Southern Road to enter and cross Allots 1 and 1A, Sec U, Allot 2, Sec M, Allot 2B, Sec L, Allots 4B1 and 4A, Sec L, Allots 3B1, 3A1, 3A2, 4B2, 4A3 and 1B, Sec K, and Lots 2 and 1, LP308394, Parish of Lilliput, to the eastern boundary of Lot 1, LP116268, Parish of Lilliput, crossing Springhurst to Wahgunyah Railway, Rutherglen to Springhurst Road, Lilliput Norong Road, Slaughterhouse Road, Chandlers Road and Sheridans Bridge Road en route, thence entering Lot 1, LP116268, Parish of Lilliput and continuing to a point located in the north western corner of such Lot, adjacent to the intersection of Kings Road and Jacks Road, and terminate at a line valve which will be known as the Rutherglen City Gate.

4. Plans of the proposed route of the pipeline may be inspected between the hours of 9.00 a.m. and 4.00 p.m. Mondays to Fridays (excluding public holidays) at Department of Natural Resources and Environment, Library, 5th Floor, 115 Victoria Parade, Fitzroy, Victoria 3065; Department of Infrastructure, Information Centre, Ground Floor, 477 Collins Street, Melbourne, Victoria 3000 and Indigo Shire Offices, Jolimont Centre, 13-27 Drummond Street, Rutherglen, Victoria 3685.

5. Any objections to the proposed route of the pipeline must be addressed to David Lea, Executive Director, Minerals and Petroleum, Department of Natural Resources and Environment at P.O. Box 2145 MDC, Fitzroy, Victoria 3065 no later than Friday, 15 November 1996.

Dated 8 October 1996

MICHAEL TAYLOR
Secretary for the Department of Natural
Resources and Environment
pursuant to instrument of delegation
by the Minister dated 9 May 1996

Pipelines Act 1967
No. 7541

**DEPARTMENT OF NATURAL
RESOURCES AND ENVIRONMENT**

I, Patrick McNamara, Minister for Agriculture and Resources for the State of Victoria, hereby give notice in accordance with the provisions of Section 12 of the Pipelines Act 1967, No. 7541, that the route of the pipeline for which Permit No. 15 to own and use, has been granted by me to the Gas Transmission Corporation, is varied as follows:

Deletion of the expression—

“a 12” internal diameter steel pipeline, 8.3 miles in length, commencing at Petroleum Refineries (Australia) Proprietary Limited at Altona and continuing east along Ross Road as far as Mills Street, thence dividing into two branches, one turning south for one third of a mile and terminating at the Gas and Fuel Corporation of Victoria’s heatane gas filling plant at Altona; the other continuing” and

Substituting in lieu the expression—

“a 300 mm nominal bore steel pipeline, 13.92 kms in length, commencing at Mobil Refining Australia Pty Ltd’s. Refinery at

Altona and continuing east along Ross Road as far as Mills Street, and then turning”, and as more particularly shown on the Gas and Fuel Corporation of Victoria’s Plan No. R-4611 Rev H, a copy of which is held in the office of the Department of Natural Resources and Environment.

Dated 8 October 1996

MICHAEL TAYLOR
Secretary for the Department of Natural
Resources and Environment
pursuant to instrument of delegation by the
Minister dated 9 May 1996

Pipelines Act 1967
No. 7541

**DEPARTMENT OF NATURAL
RESOURCES AND ENVIRONMENT**

I, Patrick McNamara, Minister for Agriculture and Resources for the State of Victoria, hereby give notice in accordance with the provisions of Section 12 of the Pipelines Act 1967, No. 7541, that the route of the pipeline for which Permit No. 16 to own and use, has been granted by me to the Gas Transmission Corporation, is varied as follows:

Deletion of the expression—

“a 4” internal diameter steel pipeline, 4.98 miles in length, commencing at the Gas and Fuel Corporation of Victoria’s heatane gas filling plant at Altona, thence extending in a generally northerly and westerly direction to the Gas and Fuel Corporation of Victoria’s” and

Substituting in lieu the expression—

“a 100 mm nominal bore steel pipeline, 6.44 kms in length, commencing at a field regulator in Ross Road, Altona, thence extending in a generally northerly and westerly direction to the Gas Transmission Corporation” and as more particularly shown on the Gas and Fuel Corporation of Victoria’s Plan No. R-4560 Rev K, a copy of which is held in the office of the Department of Natural Resources and Environment.

Dated 8 October 1996

MICHAEL TAYLOR
Secretary for the Department of Natural
Resources and Environment
pursuant to instrument of delegation by the
Minister dated 9 May 1996

Pipelines Act 1967
No. 7541
DEPARTMENT OF NATURAL
RESOURCES AND ENVIRONMENT
Notice of Variation of Conditions of a
Pipeline Licence

Whereas Sub-section (1) of Section 28A of the **Pipelines Act 1967** provides that the Minister may by notice published in the Government Gazette amend, vary, add to or revoke a term or condition stated or included in a licence, I, Patrick McNamara, Minister for Agriculture and Resources do now hereby vary the conditions of Pipeline Licence No. 15 in the manner indicated in the Schedule hereto:

Schedule

1. In Specification I (A) (iii) delete "13.36 kilometres" and substitute "13.92 kilometres".
2. In Specification I (C) (i) delete "in Gas and Fuel Corporation of Victoria's Heatane Gas Depot at Altona and".

Dated 8 October 1996

MICHAEL TAYLOR
Secretary for the Department of Natural
Resources and Environment
pursuant to instrument of delegation by the
Minister dated 9 May 1996

Pipelines Act 1967
No. 7541
DEPARTMENT OF NATURAL
RESOURCES AND ENVIRONMENT
Notice of Variation of Conditions of a
Pipeline Licence

Whereas Sub-section (1) of Section 28A of the **Pipelines Act 1967** provides that the Minister may by notice published in the Government Gazette amend, vary, add to or revoke a term or condition stated or included in a licence, I, Patrick McNamara, Minister for Agriculture and Resources do now hereby vary the conditions of Pipeline Licence No. 16 in the manner indicated in the Schedule hereto:

Schedule

1. In Specification I (A) (iii) delete "8.02 kilometres" and substitute "6.44 kilometres".
2. In Specification I (C) (i) delete "in Gas and Fuel Corporation of Victoria's Heatane Gas Depot at Altona and".

Dated 8 October 1996

MICHAEL TAYLOR
Secretary for the Department of Natural
Resources and Environment
pursuant to instrument of delegation by the
Minister dated 9 May 1996

Health Services Act 1988
DECLARATION OF APPROVED
QUALITY ASSURANCE BODY

I declare the Continuous Service Improvement Committee, established by The Avenue Hospital, is an approved quality assurance body under Section 139 for the purposes of Part 7 of the **Health Services Act 1988**

Dated 9 October 1996

ROB KNOWLES
Minister for Health

Subordinate Legislation Act 1994
DEPARTMENT OF JUSTICE VICTORIA
Supreme Court (Sheriff's Fees) Regulations
Notice of Intention to Proceed to Make
Regulations

A Regulatory Impact Statement was published in relation to the proposed Supreme Court (Sheriff's Fees) Regulations 1996.

The major objective of the proposed Regulations is to ensure that litigants using the services of the Supreme Court Sheriff to enforce civil judgements make an equitable contribution to the costs of provision of the service.

The regulations establish fees that are identical with those for executing similar types of warrants from other Court jurisdictions, thus providing a level of consistency that reduces costs of administration and compliance.

No submissions were received in respect of these proposed Regulations and I now give notice of my intention to proceed with the making of the proposed Regulations.

JANE WADE
Attorney General

Docklands Authority Act 1991
DIRECTION

I, Robert Maclellan, Minister for Planning and Local Government of the State of Victoria and Minister responsible for the administration of the **Docklands Authority Act 1991** (the "Act"), give the following directions to the Docklands Authority (the "Authority") under Section 12 of the Act:

1. To finance the development of Melbourne Docklands in accordance with the Authority's approved financial plan by

borrowing under facilities to be established with Treasury Corporation of Victoria, to the extent that funds are required in excess of moneys otherwise receivable by the Authority.

2. To borrow from Treasury Corporation of Victoria in the first instance, as per Paragraph 1 above, such amounts not exceeding the sum of \$8.3 million as are required to enable the Authority to carry out the measures set out in its approved financial plan in respect of the 1996-7 financial year, after allowing for moneys to be received from the Department of Treasury and Finance by way of appropriation.

3. To do all such acts and things as may be necessary to establish the necessary borrowing facilities with Treasury Corporation of Victoria.

Dated 2 October 1996

ROBERT MACLELLAN
Minister for Planning and Local Government

Local Government Act 1989
GREATER DANDENONG CITY COUNCIL
Amendments to Local Law No. 3

Notice is hereby given that Greater Dandenong City Council, at its meeting held on Monday, 23 September 1996 made the following amendments to Road Management And Protection Of Physical Assets Local Law No. 3 effective from 1 October 1996 as follows:

1. Definition of "Heavy Vehicles" means a vehicle of a kind referred to in Part 2 of the National Schedule with an MRC exceeding 4.5 tonnes.

2. Definition of "Large Vehicles" means a bus; or a rigid or articulated truck which exceed 15 tonnes gross vehicle mass.

3. Clause 31.1:

"A person must not, in any area which Council resolves that this clause applies to, without first obtaining a permit nor otherwise than in accordance with the condition of such a permit:

(a) on a road; or

(b) in or at a public place

display, handout or distribute handbills, notices, papers or other documents."

4. Clause 31.2:

"A person must not commit any nuisance on a road or in a public place."

5. Clause 40 (c) (i):

"is unregistered or does not have a current VicRoads Permit affixed to the windscreen or"

The purpose and general purport of the respective clauses of these amendments are to:

(a) regulate the use of roads by heavy vehicles;

(b) regulate the keeping of heavy and large vehicles;

(c) regulate the distribution of handbills and other materials in various locations;

(d) regulate nuisance behaviour in various locations;

(e) prohibit the abandoning of vehicles, and provide for the impounding of abandoned and derelict vehicles.

Copies of this and all other Local Laws are available for inspection and purchase at all Council customer service centres during business hours: Springvale Offices, 397-405 Springvale Road, Springvale; Dandenong Offices, 39 Clow Street, Dandenong; Parkmore Customer Service Centre, Shop A7, Parkmore Shopping Centre; and Business Development Centre, Suite 1, 31-33 Robinson Street, Dandenong.

Water Act 1989

I, Peter Donald Sutherland, Executive Director, Catchment Management and Sustainable Agriculture, Department of Natural Resources and Environment, as delegate of the Minister administering the Water Act 1989, make the following Order:

CORPORATE NAME CHANGE OF THE
OVENS RIVER MANAGEMENT BOARD
ORDER 1996

1. This Order is called the Corporate Name Change of the Owens River Management Board Order 1996.

2. This Order is made under the powers conferred by Division 2 of Part 6 of the Water Act 1989 and all other available powers.

3. This Order takes effect on the date on which it is published in the Government Gazette.

4. The corporate name of the Ovens River Management Board is changed to North East Waterways.

Dated 10 July 1996

PETER D. SUTHERLAND
Executive Director

Water Act 1989
GLENELG REGION WATER AUTHORITY
Notice of Application for Conversion of
Existing Entitlements to Bulk Entitlements
Pursuant to Section 38 (2) (a)

Notice is hereby given pursuant to Section 38 (2) (a) of the **Water Act 1989** that the Glenelg Region Water Authority has made application to the Minister for Agriculture and Resources under Section 47 of the Act for the conversion of existing entitlement to take water to a bulk entitlement.

The application relates to the Authority's total entitlement to take water for the Hamilton Water Supply System from Browns Creek (north and south sites), Chimney Pot Creek, Gap Creek, Headworks Creek, No. 1 Creek, No. 2 Creek and No. 3 Creek.

Water Act 1989
OTWAY REGION WATER AUTHORITY
Notice of Application for Conversion of
Existing Entitlements to Bulk Entitlements
Pursuant to Section 38 (2) (a)

Notice is hereby given pursuant to Section 38 (2) (a) of the **Water Act 1989** that the Otway Region Water Authority has made application to the Minister for Agriculture and Resources under Section 47 of the Act for the conversion of existing entitlements to bulk entitlements.

The applications relate to the Authority's total entitlements to take water for the following water supply systems:

(1) in the extraction of water for the Aireys Inlet water supply system from the Painkalac Creek Reservoir located on the Painkalac Creek;

(2) in the extraction of water for the Gellibrand water supply system from Lardner Creek; and

(3) in the extraction of water for the Skenes Creek water supply system from Skenes Creek.

Water Act 1989
WESTERNPORT REGION WATER
AUTHORITY

Application for Conversion of Existing
Entitlement to Bulk Entitlement Pursuant to
Section 38 (2) (a)

Notice is hereby given pursuant to Section 38 (2) (a) of the **Water Act 1989** that the Westernport Region Water Authority has made application to the Minister for Agriculture and Resources under Section 47 of the Act for the conversion of existing entitlement into a bulk entitlement.

The application relates to the Authority's total entitlement to take water from the Candowie Reservoir located on Tennent Creek for the Westernport Water Supply System.

Legal Profession Practice Act 1958
SOLICITORS' (PROFESSIONAL
CONDUCT AND PRACTICE)
(AMENDMENT NO. 2) RULES 1996

In the pursuance of the powers conferred by the **Legal Profession Practice Act 1958** and all other powers thereunto enabling the Council of the Law Institute of Victoria hereby makes the following Rules:

1. These Rules may be cited as the Solicitors' (Professional Conduct and Practice) (Amendment No. 2) Rules 1996 and shall come into operation on the date of their publication in the Victoria Government Gazette.

2. The Solicitors' (Professional Conduct and Practice) Rules 1984 are in these Rules referred to as the Principal Rules.

3. Rule 8 of the Principal Rules is repealed and the following substituted for it:

"(1) A solicitor shall not—

(a) directly or indirectly borrow money from the solicitor's client; or

(b) knowingly arrange for or permit the solicitor's client to lend money to—

(i) any member of the immediate family of that solicitor;

(ii) any partner, employer or employee of that solicitor;

- (iii) any member of the immediate family of a partner, employer or employee of that solicitor; or
 - (iv) any corporation, partnership or trust in which that solicitor, or a partner, employer or employee of that solicitor, or a member of the immediate family of any of them has directly or indirectly, a material interest,
unless the client is—
 - (i) a bank;
 - (ii) a trustee company as defined in the *Trustee Companies Act 1984*;
 - (iii) a solicitors' mortgage investment company other than a company in which the solicitor or any of the other persons referred to in paragraph (b) of Sub-rule (1) is a director or member or has a beneficial interest;
 - (iv) a building society;
 - (v) a credit union;
 - (vi) a credit co-operative;
 - (vii) a housing co-operative; or
 - (viii) a member of the immediate family of the solicitor and that solicitor is able to discharge the onus of proving that full written disclosure was made to the client and that the client's interests were fully protected in the circumstances of the case whether by legal representation or otherwise.
- (2) Nothing in this rule shall prevent a solicitor arranging or permitting a client to deposit funds with a registered solicitors' mortgage investment company in the normal course of business of the solicitors' mortgage investment company."
- (3) In this rule, unless inconsistent with the context or subject matter—
"client", includes—
- (a) a person between whom and that solicitor or the solicitors' partner, employer or employee the relationship of solicitor and client exists;

- (b) a person seeking to lend or invest moneys who for that purpose consults the solicitor or the solicitor's partner, employer or employee; and
- (c) a person who in the circumstances, either because that person has been a client of the solicitor or the solicitor's partner, employer or employee or otherwise, is entitled to look to that solicitor for guidance and advice in respect of a proposed loan or investment.

"member of the immediate family" includes a spouse, child, grandchild, sibling, parent, grandparent or a spouse or de facto spouse of any of those persons.

4. Sub-rule 10 (5) of the Principal Rules is repealed.

Dated 19 August 1996

Signed for and on behalf of the Council of the Law Institute of Victoria.

JAMES SYME
President

GERARD P. GLENNEN
Acting Secretary

I approve the above Rules.

Dated 7 October 1996

JOHN HARBER PHILLIPS
Chief Justice

**Legal Profession Practice Act 1958
MORTGAGE REGISTER AND NOMINEE
COMPANY RULES 1977**

In the pursuance of the powers conferred by the *Legal Profession Practice Act 1958* and all other powers thereunto enabling the Council of the Law Institute of Victoria hereby makes the following Rules:

1. These Rules may be cited as the *Mortgage Register and Nominee Company (Amendment No. 1) Rules 1996* and shall come into force on the date of their publication in the *Victoria Government Gazette*.

2. The *Mortgage Register and Nominee Company Rules 1977* are in these Rules referred to as the *Principal Rules*.

3. Rule 2 of the Principal Rules is amended as follows:

After the definition of "contributory mortgage" insert:

"Direct Mortgage" has the same meaning as contained in the Act."

After Rule 13 of the Principal Rules insert:

" 14 A solicitor shall not after 1 April 1996 arrange any new mortgage or extend or vary any existing mortgage other than a direct mortgage unless the solicitor or any member of the solicitor's firm is a registered member of the Law Institute's Solicitors' Mortgage Practice Section and the loan is made, extended or varied in accordance with the rules of the Solicitors' Mortgage Practice Section, or the solicitor complies with the fund raising provisions of the Corporations Law."

Dated 18 September 1996

Signed for and on behalf of the Council of the Law Institute of Victoria.

JAMES SYME
President

GERARD P. GLENNEN
Acting Secretary

I approve the above Rules.

Dated 7 October 1996

JOHN HARBER PHILLIPS
Chief Justice

ROAD SAFETY (TRAFFIC)
REGULATIONS 1988
Regulation 1604

Exemption to Permit a Vehicle to be Driven
on a Footway

I, Geoff Kloot, delegate of the Roads Corporation, under Regulation 1604 (2) (h) of the Road Safety (Traffic) Regulations 1988 specify a golf car which is being operated as part of the Melbourne Festival in October 1996 in the vicinity of the Victorian Arts Centre, Concert Hall, Southgate Promenade, St Kilda Road, Swanston Walk, City Square and Bourke Street Mall as a vehicle to which Regulation 1604 (1) of those Regulations does not apply.

Dated 8 October 1996

GEOFF KLOOT
Regional Manager
Metropolitan North West

Land Acquisition and Compensation Act
1986

Melbourne City Link Act 1995
NOTICE OF ACQUISITION

Compulsory Acquisition of Interest in Land

The Melbourne City Link Authority declares that by this notice it acquires all interests in the land described hereunder:

Description of Land: Land known as 174 Turner Street, Port Melbourne being part of Lot 2 on Plan of Subdivision No. 327198C, Parish of Melbourne South, shown as Parcel 699A on Survey Plan No. 18806.

Area: 3031 square metres.

Title Details: Certificate of Title Volume 10180, Folio 609.

Published with the authority of the Melbourne City Link Authority.

T. H. HOLDEN
Manager—Property Services
Roads Corporation
(appointed as agent for the
Melbourne City Link Authority)

Transport Act 1983
ROADS CORPORATION
Commercial Passenger Vehicle Application

Notice is hereby given that the following application will be considered by the Roads Corporation after 20 November 1996.

Notice of any objection to the granting of an application should be forwarded to reach the Office Manager, Wodonga or any District Office of the Roads Corporation not later than 14 November 1996.

It will not be necessary for interested parties to appear on the date specified, unless advised in writing by the Corporation.

Applications which are objected to will be determined by the Roads Corporation.

Geoffrey A. Hoare, Albury. Application to licence one commercial passenger vehicle in respect of a 1994 or later Denning coach or similar vehicle with seating capacity for 45 passengers to operate as a country special service omnibus from within a 20 km pick-up radius of the Wodonga Post Office.

Note: The vehicle to be licensed would hold a 5 star rating for charter purposes.

Gilbert W. Wallace, Kergunyah.
Application to licence one commercial passenger vehicle in respect of a 1985 or later

Austral coach or similar vehicle with seating capacity for 46 passengers to operate as a country special service omnibus from within a 20 km pick-up radius of the Wodonga Post Office.

Note: The vehicle to be licensed would hold a 5 star rating for charter purposes.

Dated 15 October 1996

W. B. PEYTON
Regional Manager—North East Region

**Transport Act 1983
ROADS CORPORATION**

Commercial Passenger Vehicle Applications

Notice is hereby given that the following applications will be considered by the Roads Corporation after 20 November 1996.

Notice of any objection to the granting of an application should be sent to the Manager, Commercial Vehicle Operations, Level 2, Denmark Street, Kew 3101 not later than 14 November 1996.

It will not be necessary for interested parties to appear on the date specified, unless advised in writing by the Corporation.

J. F. Findlay, Berwick. Application to license one commercial passenger vehicle to be purchased in respect of a 1977 Volvo bus with seating capacity for 32 passengers to operate as a metropolitan special service omnibus from within a 55 km pick-up radius of the Melbourne G.P.O.

Dated 17 October 1996

ROBERT FREEMANTLE
Manager
Commercial Vehicle Operations

**Transport Act 1983
VICTORIAN TAXI DIRECTORATE**
Department of Infrastructure
Commercial Passenger Vehicle Applications

Notice is hereby given that the following applications will be considered by the Victorian Taxi Directorate, a division of the Department of Infrastructure after 20 November 1996.

Notice of any objection to the granting of an application should be forwarded to reach the Manager, Licensing and Certification, Victorian Taxi Directorate, 598 Lygon Street, Carlton (P.O. Box 666, Carlton South 3053) not later than 14 November 1996.

It will not be necessary for interested parties to appear on the date specified, unless advised in writing by the Department.

K. Bailey and M. H. Dougherty, Parkville. Application to license one commercial passenger vehicle to be purchased in respect of a 1994 Toyota Hi-ace commuter van with seating capacity for 11 passengers to operate a service for the carriage of backpackers between backpacker accommodation hostels situated in Melbourne, Lorne, Ballarat, Halls Gap, Bendigo, Echuca, Mansfield, Marysville and Healesville.

A. Grech, Forest Hill. Application to license one commercial passenger vehicle in respect of a 1971 Mercedes Benz sedan with seating capacity for 4 passengers to operate a service from 2 Wendy Street, Forest Hill for the carriage of passengers for wedding parties, debutante balls and school formals.

A. Mandarano, Lalor. Application to license one commercial passenger vehicle in respect of a 1984 Jaguar sedan with seating capacity for 4 passengers to operate a service from 32 Elizabeth Drive, Lalor for the carriage of passengers for wedding parties, debutante balls and school socials.

Note: This application is made subject to the cancellation of licence MH 4564 in the name of the applicant.

Togoto Australia Pty Ltd, Coburg. Application to license two commercial passenger vehicles to be purchased in respect of 1993-1996 Toyota Hi-Ace vans each with seating capacity for 10 passengers to operate a service for the carriage of overseas students studying in Victoria between Melbourne Airport, Tullamarine, their place of accommodation and educational institutions situated throughout the State of Victoria.

Dated 17 October 1996

ROBERT STONEHAM
Manager—Licensing and Certification
Victorian Taxi Directorate

**Planning and Environment Act 1987
DANDENONG PLANNING SCHEME**
Notice of Lapsing of Amendment
Amendment L43

The City of Greater Dandenong has resolved to abandon Amendment L43 to the Dandenong Planning Scheme.

The amendment proposed to change Clause 117 (Special Use Zone No. 16) of the Dandenong Planning Scheme by introducing a site specific control affecting land at 8 Greens Road, Keysborough which would enable the land to be used as a neighbourhood commercial centre with ancillary car parking without the need for a further planning permit.

The amendment lapsed on 3 October 1996.

ADRIAN SALMON
Co-ordinator, Amendment Services
Local Government, Planning and Market
Services Division
Department of Infrastructure

Planning and Environment Act 1987
DANDENONG PLANNING SCHEME
Notice of Lapsing of Amendment
Amendment L44

The City of Greater Dandenong has resolved to abandon Amendment L44 to the Dandenong Planning Scheme.

The amendment proposed to change the Local Section of the Dandenong Planning Scheme by rezoning land at Nos 219-321 Perry Road, Keysborough from its existing Special Use 16 Zone to an Industrial 3 Zone.

The amendment lapsed on 3 October 1996.

ADRIAN SALMON
Co-ordinator, Amendment Services
Local Government, Planning and Market
Services Division
Department of Infrastructure

Planning and Environment Act 1987
DANDENONG AND SPRINGVALE
PLANNING SCHEMES
Notice of Lapsing of Amendment
Amendment RL166

The City of Greater Dandenong has resolved to abandon Amendment RL166 to the Dandenong and Springvale Planning Schemes.

The amendment proposed to rezone various parcels of land within the area bounded by Springvale Road, Cheltenham Road, the Dingley By-Pass Reservation, the Scoresby Freeway Reservation, Dandenong Creek and Mordialloc Creek Drain from Special Use No. 2, 16 and 16A and Proposed Public Open

Space Reservation to Urban Residential 1 Zone, Mixed Use Zone and Industrial 3 Zone and impose local overlay controls.

The amendment lapsed on 3 October 1996.

ADRIAN SALMON
Co-ordinator, Amendment Services
Local Government, Planning and Market
Services Division
Department of Infrastructure

Planning and Environment Act 1987
EUROA PLANNING SCHEME
Notice of Lapsing of Amendment
Amendment L23

Pursuant to Section 30 (1) (a) of the Planning and Environment Act 1987, Amendment L23 to the Euroa Planning Scheme has lapsed.

The amendment proposed to rezone Lots 1-3, PS314075, Hume Highway, Euroa from Highway Commercial to Residential A.

The amendment lapsed on 17 March 1996.

ADRIAN SALMON
Co-ordinator, Amendment Services
Local Government, Planning and Market
Services Division
Department of Infrastructure

Planning and Environment Act 1987
HASTINGS PLANNING SCHEME
Notice of Lapsing of Amendment
Amendment L53

The Minister for Planning and Local Government has resolved to refuse Amendment L53 to the Hastings Planning Scheme.

The amendment proposed to:

- rezone land in the Hastings Gateway area to the Special Urban Industrial Zone;
- introduce a new overlay policy to control the siting and appearance of buildings and landscaping and to prohibit potentially offensive uses; and
- introduce a restructure plan for small or irregularly shaped lots.

The amendment lapsed on 17 October 1996.

ADRIAN SALMON
Co-ordinator, Amendment Services
Local Government, Planning and Market
Services Division
Department of Infrastructure

Planning and Environment Act 1987
SHEPPARTON SHIRE PLANNING
SCHEME
Notice of Lapsing of Amendment
Amendment L71

Pursuant to Section 30 (1) (a) of the Planning and Environment Act 1987, Amendment L71 to the Shepparton Shire Planning Scheme has lapsed.

The amendment proposed to rezone land known as C.A. 130, and C.A. 6, Section A from Rural C to Proposed Public Purpose—Rural Water Board.

The amendment lapsed on 6 October 1996.

ADRIAN SALMON
Co-ordinator, Amendment Services
Local Government, Planning and Market
Information Division
Department of Infrastructure

Planning and Environment Act 1987
STAWELL (CITY) PLANNING SCHEME
Notice of Lapsing of Amendment
Amendment L28

The Northern Grampians Shire Council has resolved to abandon Amendment L28 to the Stawell (City) Planning Scheme.

The amendment proposed to:

(1) change the Planning Scheme by reserving CA's 14B and 14C, Section 34, 24 Sloane Street, Stawell for Proposed Public Purposes—10A—Municipal Purposes—Car Park, and to add to Schedule 5 of the Scheme the above Reservation;

(2) to reserve CA 7A, Section 25 and Lot 1, LP72420, 55 Main Street, Stawell for Proposed Public Purposes—1—Municipal Purposes—Town Hall. The land is currently zoned Commercial (Central Business);

(3) to reserve CA 7 and 8B, Section 25, 59-61 Main Street, Stawell and also including Joyce Lane and the land adjacent to the Anglican Church giving access to Scallan Street, Stawell to Public Purposes—1—Municipal Purposes—Town Hall.

The amendment lapsed on 7 October 1996.

ADRIAN SALMON
Co-ordinator, Amendment Services
Local Government, Planning and Market
Information Division
Department of Infrastructure

Planning and Environment Act 1987
YARRAWONGA PLANNING SCHEME
Notice of Lapsing of Amendment
Amendment L19

Pursuant to Section 30 (1) (a) of the Planning and Environment Act 1987, Amendment L19 to the Yarrowonga Planning Scheme has lapsed.

The amendment proposed three minor changes to the planning scheme relating to piggeries, rural houses and set-backs to bring it into line with Government and Council policy and to correct an anomaly in the present scheme.

The amendment lapsed on 7 October 1995.

ADRIAN SALMON
Co-ordinator, Amendment Services
Local Government, Planning and Market
Information Division
Department of Infrastructure

Planning and Environment Act 1987
MELBOURNE PLANNING SCHEME
Notice of Amendment
Amendment L230

The Minister for Planning and Local Government has prepared Amendment L230 to the Melbourne Planning Scheme.

The amendment inserts an incorporated document in the Schedule of Specific Site Controls to Clause 314A-9 of the Scheme to enable the first floor of the premises at 193-197 Nicholson Street, Carlton to be used for reception rooms in accordance with conditions contained in the document.

A copy of the amendment can be inspected free of charge during office hours at the Department of Infrastructure, Ground Floor, 477 Collins Street, Melbourne and at the offices of the Melbourne City Council, 6th Floor, 200 Little Collins Street, Melbourne.

Submissions about the amendment must be sent to Minister for Planning and Local Government, Attention: Panels Branch, Department of Infrastructure, P.O. Box 2240T, Melbourne 3001 (or Fax 9628 5429) by 19 November 1996.

ADRIAN SALMON
Co-ordinator, Amendment Services
Local Government, Planning and Market
Services Division
Department of Infrastructure

Planning and Environment Act 1987
ALTONA PLANNING SCHEME
Notice of Approval of Amendment
Amendment L106

The Minister for Planning and Local Government has approved Amendment L106 to the Altona Planning Scheme.

The amendment comes into operation on the date this notice is published in the Government Gazette.

The amendment introduces a site specific clause into the scheme to enable the development of a rail-freight centre on 17.17 hectares of land extending south-east from the corner of Burns Road and Harcourt Road, to the main Melbourne-Geelong railway line, together with the unused section of the existing Railway reserve between Kayes Drain and the Merton Street overpass, Altona.

A copy of the amendment can be inspected free of charge during office hours at the Department of Infrastructure, Ground Floor, 477 Collins Street, Melbourne and at the offices of the Hobsons Bay City Council, Corporate Centre, 115 Civic Parade, Altona.

ADRIAN SALMON
Co-ordinator, Amendment Services
Local Government, Planning and Market
Information Division
Department of Infrastructure

Planning and Environment Act 1987
BACCHUS MARSH PLANNING SCHEME
Notice of Approval of Amendment
Amendment L54

The Minister for Planning and Local Government has approved Amendment L54 to the Bacchus Marsh Planning Scheme.

The amendment comes into operation on the date this notice is published in the Government Gazette.

The amendment zones 196 Main Street and land fronting Young Street, Bacchus Marsh to Commercial Central Zone from Existing Public Purpose Reservation No. 4 (State Electricity Commission). A site specific control nominating the land as potentially contaminated land is introduced.

A copy of the amendment can be inspected free of charge during office hours at the Department of Infrastructure, Ground Floor, 477 Collins Street, Melbourne; Office of

Planning and Heritage, State Government Offices, corner of Mair and Doveton Streets, Ballarat and at the offices of the Moorabool City Council.

ADRIAN SALMON
Co-ordinator, Amendment Services
Local Government, Planning and Market
Information Division
Department of Infrastructure

Planning and Environment Act 1987
BANYULE PLANNING SCHEME
Notice of Approval of Amendment
Amendment L3

The Minister for Planning and Local Government has approved Amendment L3 to the Banyule Planning Scheme.

The amendment comes into operation on the date this notice is published in the Government Gazette.

The amendment inserts 44 Carlsberg Road House after 141 Cape Street House in the Table to Clause 136-6.

A copy of the amendment can be inspected free of charge during office hours at the Department of Infrastructure, Ground Floor, 477 Collins Street, Melbourne and at the offices of the Banyule City Council, 44 Turnham Street, Rosanna.

ADRIAN SALMON
Co-ordinator, Amendment Services
Local Government, Planning and Market
Information Division
Department of Infrastructure

Planning and Environment Act 1987
CAMPASPE PLANNING SCHEME
Notice of Approval of Amendment
Amendment L15

The Minister for Planning and Local Government has approved Amendment L15 to the Campaspe Planning Scheme.

The amendment comes into operation on the date this notice is published in the Government Gazette.

The amendment rezones CA 5, 6, 7, 8, 13, 14, 15, 16, Section 22, Township of Echuca being the Echuca Primary School site between High and Hare Streets, Echuca from Public Use (school) to Business Zone.

A copy of the amendment can be inspected free of charge during office hours at the Department of Infrastructure, Ground Floor,

477 Collins Street, Melbourne; 426 Hargreaves Street, Bendigo and at the Offices of the Campaspe Shire Council, Heygarth Street, Echuca.

ADRIAN SALMON
Co-ordinator, Amendment Services
Local Government, Planning and Market
Information Division
Department of Infrastructure

Planning and Environment Act 1987
GREATER GEELONG PLANNING SCHEME
Notice of Approval of Amendment
Amendment R174

The Minister for Planning and Local Government has approved Amendment R174 to the Greater Geelong Planning Scheme.

The amendment comes into operation on the date this notice is published in the Government Gazette.

The amendment changes the Regional Section of the Planning Scheme and inserts a new provision in Clauses 35-5.1 and 35-5.4 of the Point Lillias Special Industrial Zone to allow land and marine geotechnical site investigation works to be carried out without a Development Plan, but subject to the approval of the Minister for Planning and Local Government.

A copy of the amendment can be inspected free of charge during office hours at the Department of Infrastructure, Ground Floor, 477 Collins Street, Melbourne; Department of Infrastructure, Planning Group, 5th Floor, State Offices, Cnr Fenwick and Lt Malop Streets, Geelong and at the offices of the Greater Geelong City Council, 103 Corio Street, Geelong.

ADRIAN SALMON
Co-ordinator, Amendment Services
Local Government, Planning and Market
Information Division
Department of Infrastructure

Planning and Environment Act 1987
GREATER GEELONG PLANNING SCHEME
Notice of Approval of Amendment
Amendment L156

The Minister for Planning and Local Government has approved Amendment L156 to the Greater Geelong Planning Scheme.

The amendment comes into operation on the date this notice is published in the Government Gazette.

The amendment applies to approximately 4.3 ha of land at 2-20 Calder Street, Moolap.

The amendment is to make it possible for the Responsible Authority to grant a permit for a two lot subdivision of the land in accordance with the Rural Residential Zone subdivision provisions.

A copy of the amendment can be inspected free of charge during office hours at the Department of Infrastructure, Ground Floor, 477 Collins Street, Melbourne and at the offices of the Greater Geelong City Council, 103 Corio Street, Geelong.

ADRIAN SALMON
Co-ordinator, Amendment Services
Local Government, Planning and Market
Information Division
Department of Infrastructure

Planning and Environment Act 1987
HUME PLANNING SCHEME
Notice of Approval of Amendment
Amendment L6

The Minister for Planning and Local Government has approved Amendment L6 to the Hume Planning Scheme.

The amendment comes into operation on the date this notice is published in the Government Gazette.

The amendment introduces a site specific clause into the Scheme to facilitate the development of a Highway Service Centre on the south west corner of the Hume Freeway and Donnybrook Road, Donnybrook.

A copy of the amendment can be inspected free of charge during office hours at the Department of Infrastructure, Ground Floor, 477 Collins Street, Melbourne and at the offices of the Hume City Council, 36 Macedon Street, Sunbury.

ADRIAN SALMON
Co-ordinator, Amendment Services
Local Government, Planning and Market
Services Division
Department of Infrastructure

Planning and Environment Act 1987
MAROONDAH PLANNING SCHEME
Notice of Approval of Amendment
Amendment L3

The Minister for Planning and Local Government has approved Amendment L3 to the Maroondah Planning Scheme.

The amendment comes into operation on the date this notice is published in the Government Gazette.

The amendment seeks to rezone land around Ruthven Way and Angus Avenue, Ringwood East from Residential C to Environmental Living Zone—Part A.

A copy of the amendment can be inspected free of charge during office hours at the Department of Infrastructure, Ground Floor, 477 Collins Street, Melbourne and at the offices of the Maroondah City Council, Braeside Avenue, Ringwood.

ADRIAN SALMON
Co-ordinator, Amendment Services
Local Government, Planning and Market
Information Division
Department of Infrastructure

Planning and Environment Act 1987
MILAWA PLANNING SCHEME
Notice of Approval of Amendment
Amendment L12

The Minister for Planning and Local Government has approved Amendment L12 to the Milawa Planning Scheme.

The amendment comes into operation on the date this notice is published in the Government Gazette.

The amendment rezones 3,300 square metres of land being that part of Dixon Street between Cusack and Docker Streets, Wangaratta from Residential to Public Use 11—Hospital, and to close this section of Dixon Street.

A copy of the amendment can be inspected free of charge during office hours at the Department of Infrastructure, Ground Floor, 477 Collins Street, Melbourne and at the offices of the Rural City of Wangaratta, 64-68 Ovens Street, Wangaratta.

ADRIAN SALMON
Co-ordinator, Amendment Services
Local Government, Planning and Market
Information Division
Department of Infrastructure

Planning and Environment Act 1987
MITCHELL PLANNING SCHEME
(CHAPTER 4)
Notice of Approval of Amendment
Amendment L11

The Minister for Planning and Local Government has approved Amendment L11 to the Mitchell Planning Scheme (Chapter 4).

The amendment comes into operation on the date this notice is published in the Government Gazette.

The amendment introduces site specific provisions into the Bushland Zone to allow land located at Lot 3, LP 79767, Spur Road, Clonbinane to be used for the breeding of quality working dogs.

A copy of the amendment can be inspected free of charge during office hours at the Department of Infrastructure, Ground Floor, 477 Collins Street, Melbourne and at the offices of the Mitchell Shire Council, 113 High Street, Broadford.

ADRIAN SALMON
Co-ordinator, Amendment Services
Local Government, Planning and Market
Information Division
Department of Infrastructure

Planning and Environment Act 1987
MOIRA PLANNING SCHEME
Notice of Approval of Amendment
Amendment L3 Part 1

The Minister for Planning and Local Government has approved Amendment L3 Part 1 to the Moira Planning Scheme.

The amendment comes into operation on the date this notice is published in the Government Gazette.

The amendment rezones two parcels of land:

(1) 2.186 hectares of vacant land in Cemetary Road, Cobram from Rural 1 to Public Uses Cemetary; and

(2) 6.5 hectares of vacant land in Campbells Road, Cobram described as Lot 1 of PS310890J from Future Urban to Residential 1.

A copy of the amendment can be inspected free of charge during office hours at the Department of Infrastructure, Ground Floor, 477 Collins Street, Melbourne and at the offices of the Moira Shire Council, Melville Street, Numurkah.

ADRIAN SALMON
Co-ordinator, Amendment Services
Local Government, Planning and Market
Information Division
Department of Infrastructure

Planning and Environment Act 1987
MOIRA PLANNING SCHEME
Notice of Approval of Amendment
Amendment L7 Part 1

The Minister for Planning and Local Government has approved Amendment L7 Part 1 to the Moira Planning Scheme.

The amendment comes into operation on the date this notice is published in the Government Gazette.

The amendment rezones a 1728 square metre parcel of land described as Part Crown Allotment 6, Section 4, Parish of Katunga, on the southwest corner of Melville and Quinn Streets, Numurkah from Public Purpose Post Office to Central Commercial, and a 6037 square metre parcel of land described as Lot 2 PS334387 in Piper Street, Yarrawonga from Residential Low Density to Public Purpose Water Supply.

A copy of the amendment can be inspected free of charge during office hours at the Department of Infrastructure, Ground Floor, 477 Collins Street, Melbourne and at the offices of the Moira Shire Council, Melville Street, Numurkah.

ADRIAN SALMON
Co-ordinator, Amendment Services
Local Government, Planning and Market
Information Division
Department of Infrastructure

Planning and Environment Act 1987
MOIRA PLANNING SCHEME
Notice of Approval of Amendment
Amendment L11

The Minister for Planning and Local Government has approved Amendment L11 to the Moira Planning Scheme.

The amendment comes into operation on the date this notice is published in the Government Gazette.

The amendment rezones approximately 1197 square metres of land on the north east corner of Hay Avenue and High Street, Cobram from Residential 1 to Business 5.

A copy of the amendment can be inspected free of charge during office hours at the Department of Infrastructure, Ground Floor, 477 Collins Street, Melbourne and at the offices of the Moira Shire Council, Numurkah district office, Melville Street, Numurkah.

ADRIAN SALMON
Co-ordinator, Amendment Services
Local Government, Planning and Market
Information Division
Department of Infrastructure

Planning and Environment Act 1987
MOIRA PLANNING SCHEME
Notice of Approval of Amendment
Amendment L12

The Minister for Planning and Local Government has approved Amendment L12 to the Moira Planning Scheme.

The amendment comes into operation on the date this notice is published in the Government Gazette.

The amendment rezones 1176 square metres of land on the north west corner of High and Market Streets, Cobram being part of Lot 194 and 195 of LP 1834 from Residential 1 to Business 5.

A copy of the amendment can be inspected free of charge during office hours at the Department of Infrastructure, Ground Floor, 477 Collins Street, Melbourne and at the offices of the Moira Shire Council, Melville Street, Numurkah.

ADRIAN SALMON
Co-ordinator, Amendment Services
Local Government, Planning and Market
Information Division
Department of Infrastructure

Planning and Environment Act 1987
MORELAND PLANNING SCHEME
Notice of Approval of Amendment
Amendment L10

The Minister for Planning and Local Government has approved Amendment L10 to the Moreland Planning Scheme.

The amendment comes into operation on the date this notice is published in the Government Gazette.

The amendment rezones land at 23 The Avenue, Coburg from Residential C to Light Industrial Zone and inserts a new site specific control clause (Clause 112-3B) in the Local Section of the Moreland Planning Scheme.

A copy of the amendment can be inspected free of charge during office hours at the Department of Infrastructure, Ground Floor, 477 Collins Street, Melbourne and at the offices of the Moreland City Council, 233 Sydney Road, Brunswick.

ADRIAN SALMON
Co-ordinator, Amendment Services
Office of Planning and Heritage
Department of Infrastructure

**Planning and Environment Act 1987
SHEPPARTON SHIRE PLANNING
SCHEME**

**Notice of Approval of Amendment
Amendment L79**

The Minister for Planning and Local Government has approved Amendment L79 to the Shepparton Shire Planning Scheme.

The amendment comes into operation on the date this notice is published in the Government Gazette.

The amendment proposes to rezone the 2.345 ha former abattoir site in New Dookie Road, Shepparton described as Lot 2, LP 79169 from Industrial C (Offensive Industry) to Public Purposes 3—Municipal Purposes.

A copy of the amendment can be inspected free of charge during office hours at the Department of Infrastructure, Ground Floor, 477 Collins Street, Melbourne and at the offices of the Greater Shepparton City Council, Welsford Street, Shepparton.

ADRIAN SALMON
Co-ordinator, Amendment Services
Local Government, Planning and Market
Information Division
Department of Infrastructure

**Planning and Environment Act 1987
SURF COAST PLANNING SCHEME**
**Notice of Approval of Amendment
Amendment R39**

The Minister for Planning and Local Government has approved Amendment R39 to the Surf Coast Planning Scheme.

The amendment comes into operation on the date this notice is published in the Government Gazette.

The amendment inserts "institutional home" as a use which may be permitted in the Rural General Farming Zone.

A copy of the amendment can be inspected free of charge during office hours at the Department of Infrastructure, Ground Floor, 477 Collins Street, Melbourne and at the offices of the Surf Coast Shire Council, 25 Grossmans Road, Torquay.

ADRIAN SALMON
Co-ordinator, Amendment Services
Local Government, Planning and Market
Information Division
Department of Infrastructure

**Planning and Environment Act 1987
TRARALGON (SHIRE) PLANNING
SCHEME**

**Notice of Approval of Amendment
Amendment L56**

The Minister for Planning and Local Government has approved Amendment L56 to the Traralgon (Shire) Planning Scheme.

The amendment comes into operation on the date this notice is published in the Government Gazette.

The amendment rezones land located on the north east corner of Princes Highway and Village Avenue, Traralgon West being Lot 1, Plan of Subdivision 67584 and Lot 10, Plan of Subdivision 67735, Parish of Traralgon, County of Buln Buln to a new Special Use Hospital Zone.

A copy of the amendment can be inspected free of charge during office hours at the Department of Infrastructure, Ground Floor, 477 Collins Street, Melbourne and at the offices of the La Trobe Shire Council, 28-38 Kay Street, Traralgon.

ADRIAN SALMON
Co-ordinator, Amendment Services
Local Government, Planning and Market
Information Division
Department of Infrastructure

**Planning and Environment Act 1987
YEA PLANNING SCHEME**
**Notice of Approval of Amendment
Amendment L11**

The Minister for Planning and Local Government has approved Amendment L11 to the Yea Planning Scheme.

The amendment comes into operation on the date this notice is published in the Government Gazette.

The amendment introduces ordinance changes to the Rural Zone to allow the subdivision and erection of houses of a 154 ha property in the area generally bounded by Orchard Road, Glenburn Road and Jones Streets, Kinglake.

A copy of the amendment can be inspected free of charge during office hours at the Department of Infrastructure, Ground Floor, 477 Collins Street, Melbourne and at the offices of the Murrindindi Shire Council, Alexandra.

ADRIAN SALMON
Co-ordinator, Amendment Services
Office of Planning and Heritage
Department of Infrastructure

**Planning and Environment Act 1987
YARRA RANGES PLANNING SCHEME
Notice of Approval of Amendment
Amendment L26**

The Minister for Planning and Local Government has approved Amendment L26 to the Yarra Ranges Planning Scheme.

The amendment comes into operation on the date this notice is published in the Government Gazette.

The amendment removes a restrictive covenant which applies to No. 11 Akarana Road, being Lot 30, LP 26169, Chirnside Park to facilitate the construction of a second detached on the property in accordance with existing permits.

A copy of the amendment can be inspected free of charge during office hours at the Department of Infrastructure, Ground Floor, 477 Collins Street, Melbourne and at the offices of the Shire of Yarra Ranges, Anderson Street, Lilydale.

ADRIAN SALMON
Co-ordinator, Amendment Services
Local Government, Planning and Market
Information Division
Department of Infrastructure

**Planning and Environment Act 1987
WHITEHORSE PLANNING SCHEME
Notice of Approval of Amendment
Amendment L5**

The Minister for Planning and Local Government has approved Amendment L5 to the Whitehorse Planning Scheme.

The amendment comes into operation on the date this notice is published in the Government Gazette.

The amendment changes various sub-clauses of Clause 122 of the Local Section of the Whitehorse Planning Scheme and introduces an Incorporated Document to help facilitate the further development of the Retirement Village at Tally Ho, East Burwood.

A copy of the amendment can be inspected free of charge during office hours at the Department of Infrastructure, Ground Floor, 477 Collins Street, Melbourne and at the offices of the Whitehorse City Council, 379-397 Whitehorse Road, Nunawading.

ADRIAN SALMON
Co-ordinator, Amendment Services
Local Government, Planning and Market
Information Division
Department of Infrastructure

**Planning and Environment Act 1987
WHITEHORSE PLANNING SCHEME
Notice of Approval of Amendment
Amendment L6**

The Minister for Planning and Local Government has approved Amendment L6 to the Whitehorse Planning Scheme.

The amendment comes into operation on the date this notice is published in the Government Gazette.

The amendment changes various sub-clauses of Clause 122 of the Local Section of the Whitehorse Planning Scheme and introduces an Incorporated Document to help facilitate the further development of the Retirement Village at Tally Ho, East Burwood.

A copy of the amendment can be inspected free of charge during office hours at the Department of Infrastructure, Ground Floor, 477 Collins Street, Melbourne and at the offices of the Whitehorse City Council, 379-397 Whitehorse Road, Nunawading.

ADRIAN SALMON
Co-ordinator, Amendment Services
Local Government, Planning and Market
Information Division
Department of Infrastructure

**Planning and Environment Act 1987
WHITEHORSE PLANNING SCHEME
Notice of Approval of Amendment
Amendment L11**

The Minister for Planning and Local Government has approved Amendment L11 to the Whitehorse Planning Scheme.

The amendment comes into operation on the date this notice is published in the Government Gazette.

The amendment reserves land at the rear of Padgham Court, Box Hill and Conrad Court, Blackburn North for Proposed Main Road purposes for the Eastern Freeway Extension.

A copy of the amendment can be inspected free of charge during office hours at the Department of Infrastructure, Ground Floor, 477 Collins Street, Melbourne and at the offices of the Whitehorse City Council, 379-397 Whitehorse Road, Nunawading.

ADRIAN SALMON
Co-ordinator, Amendment Services
Local Government, Planning and Market
Information Division
Department of Infrastructure

APPOINTMENT

**Children and Young Persons Act 1989
APPOINTMENT OF HONORARY
PROBATION OFFICERS**

I, Brian Joyce, Regional Director of Southern Metropolitan Region of Human Services, under Section 34 (4) of the Children and Young Persons Act 1989 appoint the undermentioned persons as Honorary Probation Officers for the Children's Court in the State of Victoria for the period ending 31 December 1998.

Cross, Wendy
Dore, Ainslie
Douglas, Tracy
Johnson, Graeme
Lewis, Rebecca
Mather, Wendy
Milne, Lindy
Mountain, Penny
Pakcha, Alex
Papadontas, Maria
Patsiaouras, Kristalia
Pereira, Charlene
Pyke, Susan
Reardon, Karla
Sinclair-Findlay, Laura
Singh, Bhavna
Smith, Sharelle
Thompson, Robyn
Trinh, Vi Thi Tuong
Veltman, Peter
Walton, Julie Louise
Warren, Robyn
Wright, Judith
Zamora, Alexandra

Dated 3 October 1996

BRIAN JOYCE
Regional Director

ORDERS IN COUNCIL

ERRATUM

In the Order in Council entitled "Frankston City Council Ward Boundaries" and published in the Government Gazette G32 on 15 August 1996, on Page 2172 the name "McClland Ward" should read "McClelland Ward".

**Local Government Act 1989
MITCHELL SHIRE COUNCIL**

Number Of Councillors To Be Appointed

The Governor in Council acting under Part 10C of the Local Government Act 1989, Orders that:

1. This Order comes into operation on the day it is published in the Government Gazette.
2. The number of councillors assigned to the Mitchell Shire Council shall be seven (7).
3. The municipal district of Mitchell Shire Council shall be divided into six (6) wards.
4. The number of councillors assigned to each ward will be one (1) each for Panyule, Piper, Willowmavin, Glenburnie and Pretty Sally wards; and two (2) for New Crossing Place ward.
5. On the day this Order comes into operation the boundaries of each ward shall be fixed as described in the Schedules to this Order.

Schedule 1

NEW CROSSING PLACE WARD

Commencing on the northern boundary of the Shire, at the Goulburn River, at a point in line with the southern boundary of allotment 30^A, Parish of Mangalore; thence southerly by the Goulburn River to the Hume Freeway; thence generally southerly by that freeway to the road forming the northern boundary of the Parish of Broadford; thence easterly by the parish boundary to the Dabyminga Creek; thence southerly by that creek to the road forming the northern boundary of allotment 6^A, section D, Parish of Kerrisdale; thence generally north-easterly and generally south-easterly by that road to the road forming the northern boundary of allotment 6^C; thence easterly and south-easterly by that road to the eastern boundary of allotment 3; thence

southerly by that boundary to the northern boundary of allotment 7^B; thence easterly by that boundary to the eastern boundary of the Shire, and thence generally north-easterly, generally north-westerly, south-westerly and westerly by the shire boundary to the point of commencement.

Schedule 2

PANYULE WARD

Commencing on the northern boundary of the Shire, at the Goulburn River, at a point in line with the southern boundary of allotment 30^A, Parish of Mangalore; thence southerly by the Goulburn River to the Hume Freeway; thence generally southerly by that freeway to the northern boundary of the Parish of Broadford; thence westerly by that boundary to the Pyalong-Broadford Road; thence westerly and north-westerly by that road to the south-eastern angle of allotment 19, Parish of Glenaroua; thence south-westerly by the south-eastern boundary of that allotment to Kurkuruc Creek; thence generally south-westerly by that creek to the south-western boundary of the parish; thence north-westerly by that boundary to the most eastern angle of Lot 1 on Plan of Subdivision 110860; thence south-westerly by the south-eastern boundaries of that lot and Lots 1 and 2 on Plan of Subdivision 149546 to the north-eastern boundary of Lot 1 on Plan of Subdivision 319494; thence south-easterly by that boundary to the Kurkuruc Creek; thence generally westerly by that creek to the south-eastern boundary of Lot 2; thence south-westerly by that boundary and westerly by the southern boundary of that lot to the most eastern angle of Lot 5; thence south-westerly by the south-eastern boundary of that lot to the Northern Highway, at the most eastern angle of allotment 62^A, Parish of Moranding; thence south-westerly by the south-eastern boundaries of allotments 62^A and 62^D to Back Creek Road; thence southerly by that road and the Forbes-Moranding Road to the most eastern angle of allotment 9^C, Parish of Goldie, being a point on the eastern boundary of the parish; thence generally westerly and southerly by that boundary to Back Creek; thence north-westerly by that creek to the northern boundary of allotment 9^{A1}; thence westerly and south-westerly by the northern and western boundaries of that allotment to the northern boundary of allotment B¹⁶;

thence westerly by that boundary and the northern boundaries of allotment B¹⁵ and 20 to the eastern boundary of allotment 21; thence northerly and westerly by the eastern and northern boundaries of that allotment to Boland Road; thence southerly by that road to the south-western boundary of the Shire, and thence westerly, northerly, again westerly, again northerly, generally north-easterly and generally south-easterly by the shire boundary to the point of commencement.

Schedule 3
PIPER WARD

Commencing on Horans Track, at the north-eastern angle of allotment 7^B, section D, Parish of Kerrisdale, being a point on the eastern boundary of the Shire; thence westerly by the northern boundary of allotment 7^B to the eastern boundary of allotment 3; thence northerly by that boundary to the road forming the north-eastern boundary of that allotment; thence north-westerly and south-westerly by that road to the Dabyminga Creek; thence generally northerly by that creek to the northern boundary of the Parish of Broadford; thence westerly by that boundary to the Pyalong-Broadford Road; thence westerly and north-westerly by that road to the south-eastern angle of allotment 19, Parish of Glenaroua; thence south-westerly by the south-eastern boundary of that allotment to Kurkuruc Creek; thence generally south-westerly by that creek to the south-western boundary of the parish; thence north-westerly by that boundary to the most eastern angle of Lot 1 on Plan of Subdivision 110860; thence south-westerly by the south-eastern boundaries of that lot and Lots 1 and 2 on Plan of Subdivision 149549 to the north-eastern boundary of Lot 1 on Plan of Subdivision 319494; thence south-easterly by that boundary to the Kurkuruc Creek; thence generally westerly by that creek to the south-eastern boundary of Lot 2; thence south-westerly by that boundary and westerly by the southern boundary of that lot to the most eastern angle of Lot 5; thence south-westerly by the south-eastern boundary of that lot to the Northern Highway; thence south-easterly by that highway to Schoolhouse Lane; thence north-easterly and easterly by that lane and further easterly by the northern boundary of allotment 110, Parish of Moranding to Three Chain Road; thence north-easterly by that

road to Jeffrey's Lane; thence south-easterly by that lane and the road forming the south-western boundaries of allotments 74^H and 74^F, Parish of Broadford to the North Eastern Railway; thence north-easterly by that railway to the southern boundary of allotment 100^C; thence easterly by that boundary to the western boundary of allotment 100^B; thence southerly by that boundary, easterly by the southern boundaries of that allotment and Lot 3 on Plan of Subdivision 125940 and further easterly by the northern boundary of allotment 103^C and a line in continuation to the most western angle of allotment 103^D; thence south-easterly by the south-western and southern boundaries of that allotment to Sunday Creek Road; thence northerly by that road to McDonalds Road; thence easterly and southerly by that road to the road forming the southern boundary of allotment 165^B; thence generally easterly by that road to the road forming the western boundary of allotment 169^D; thence generally northerly by that road to the road forming the southern boundary of allotment 169^A; thence easterly, northerly, again easterly and north-easterly by that road to the road forming the south-western boundary of allotment 173; thence generally south-easterly by that road to the eastern boundary of allotment 180; thence southerly by the eastern boundaries of that allotment and allotment 184 and further southerly by the western boundary of allotment 8^B, Parish of Clonbinane to the road forming the south-eastern boundary of allotment 22; thence south-westerly by that road to the southern boundary of Lot 1 on Plan of Subdivision 112177; thence easterly by that boundary and southerly by the western boundary of Lot 6 to the northern boundary of allotment 10, section B; thence westerly by that boundary, southerly by the western boundaries of allotments 10, 10^A and Lots 1 and 2 on Plan of Subdivision 122391 and easterly by the southern boundary of Lot 2 to the road forming the western boundary of allotment 11; thence southerly, easterly, and north-easterly by that road and further north-easterly by Reedy Creek Road to Blackman Road; thence generally south-easterly by that road to the western boundary of allotment 16, Parish of Derril; thence southerly by that boundary, easterly by the southern boundaries of allotments 16 and 17, and northerly by the eastern boundary of allotment 17 to the

southern boundary of the Parish of Kerrisdale; thence north-easterly by that boundary to the most southern angle of allotment 9^C, being a point on the eastern boundary of the Shire, and thence generally northerly by the shire boundary to the point of commencement.

Schedule 4
WILLOWMAVIN WARD

Commencing on the south-western boundary of the Shire, on the Kilmore-Lancefield Road; thence north-easterly and easterly by the Kilmore-Lancefield Road to Butlers Road; thence southerly by that road to Curry Lane; thence easterly by that lane, a line in continuation and McIvors Road to Quinns Road; thence northerly by that road to the south-western angle of allotment 61^Q, Parish of Bylands; thence further northerly by the western boundaries of allotments 61^Q, 61^F and 61^J to the northern boundary of allotment 61^I; thence easterly by that boundary to the road forming the western boundary of allotment 61^I; thence northerly by that road and north-westerly by Monument Road to the southern boundary of allotment 13^W, Parish of Glenburnie; thence easterly by that boundary and northerly by the western boundary of allotment 13^K to Kilmore East Road; thence westerly by that road to the south-western angle of allotment 13^X; thence northerly by the western boundary of that allotment to the southern boundary of Lot 2 on Plan of Subdivision 78504; thence easterly by that boundary and northerly by the eastern boundaries of Lot 2 and allotment B¹³ to the southern boundary of allotment B¹²; thence easterly, northerly and westerly by the southern, eastern and northern boundaries of that allotment to the south-eastern angle of allotment B¹⁴; thence northerly and westerly by the eastern and northern boundaries of that allotment to south-western angle of allotment B⁷; thence northerly by the western boundaries of allotment B⁷ and B⁸ to the north-eastern angle of Lot 8 on Plan of Subdivision 114428; thence westerly by the northern boundary of that lot and Lot 7 and further westerly by the road forming the northern boundary of Parish Willowmavin to the Northern Highway; thence north-westerly by that highway to the south-eastern angle of allotment 62^A, Parish of Moranding; thence south-westerly by the south-eastern boundaries of allotments 62^A and 62^D to Back Creek Road; thence southerly by that road and

the Forbes-Moranding Road to the most eastern angle of allotment 9^C, Parish of Goldie, being a point on the eastern boundary of the parish; thence generally westerly and southerly by that boundary to Back Creek; thence north-westerly by that creek to the northern boundary of allotment 9^{A1}; thence westerly and south-westerly by the northern and western boundaries of that allotment to the northern boundary of allotment B¹⁶; thence westerly by that boundary and the northern boundaries of allotment B¹⁵ and 20 to the eastern boundary of allotment 21; thence northerly and westerly by the eastern and northern boundaries of that allotment to Boland Road; thence southerly by that road to the south-western boundary of the Shire, and thence generally southerly, easterly and again southerly by the shire boundary to the point of commencement.

Schedule 5
GLENBURNIE WARD

Commencing on the south-western boundary of the Shire, on the Kilmore-Lancefield Road; thence north-easterly and easterly by the Kilmore-Lancefield Road to Butlers Road; thence southerly by that road to Curry Lane; thence easterly by that lane, a line in continuation and McIvors Road to Quinns Road; thence northerly by that road to the south-western angle of allotment 61^Q, Parish of Bylands; thence further northerly by the western boundaries of allotments 61^Q, 61^F and 61^J to the northern boundary of allotment 61^I; thence easterly by that boundary to the road forming the western boundary of allotment 61^I; thence northerly by that road and north-westerly by Monument Road to the southern boundary of allotment 13^W, Parish of Glenburnie; thence easterly by that boundary and northerly by the western boundary of allotment 13^K to Kilmore East Road; thence westerly by that road to the south-western angle of allotment 13^X; thence northerly by the western boundary of that allotment to the southern boundary of Lot 2 on Plan of Subdivision 78504; thence easterly by that boundary and northerly by the eastern boundaries of Lot 2 and B¹³ to the southern boundary of allotment B¹²; thence easterly, northerly and westerly by the southern, eastern and northern boundaries of that allotment to the south-eastern angle of allotment B¹⁴; thence northerly and westerly by the eastern and northern boundaries of that allotment to south-western angle of allotment B⁷; thence northerly by the western

boundaries of allotment B⁷ and B⁸ to the north-eastern angle of Lot 8 on Plan of Subdivision 114428; thence westerly by the northern boundary of that lot and Lot 7 and further westerly by the road forming the northern boundary of Parish Willomavin to the Northern Highway; thence north-westerly by that highway to Schoolhouse Lane; thence north-easterly and easterly by that lane and further easterly by the northern boundary of allotment 110, Parish of Moranding to Three Chain Road; thence north-easterly by that road to Jeffrey's Lane; thence south-easterly by that lane and the road forming the south-western boundaries of allotments 74^H and 74^F, Parish of Broadford to the North Eastern Railway; thence north-easterly by that railway to the southern boundary of allotment 100^C; thence easterly by that boundary to the western boundary of allotment 100^B; thence southerly by that boundary, easterly by the southern boundaries of that allotment and Lot 3 on Plan of Subdivision 125940 and further easterly by the northern boundary of allotment 103^C and a line in continuation to the most western angle of allotment 103^D; thence south-easterly by the south-western and southern boundaries of that allotment to Sunday Creek Road; thence northerly by that road to McDonalds Road; thence easterly and southerly by that road to the road forming the southern boundary of allotment 165^B; thence generally easterly by that road to the road forming the western boundary of allotment 169^B; thence generally northerly by that road to the road forming the southern boundary of allotment 169^A; thence easterly, northerly, again easterly and north-easterly by that road to the road forming the south-western boundary of allotment 173; thence generally south-easterly by that road to the eastern boundary of allotment 180; thence southerly by the eastern boundaries of that allotment and allotment 184 and further southerly by the western boundary of allotment 8^B, Parish of Clonbinane to the road forming the south-eastern boundary of allotment 22; thence south-westerly by that road to the southern boundary of Lot 1 on Plan of Subdivision 112177; thence easterly by that boundary and southerly by the western boundary of Lot 6 to the northern boundary of allotment 10, section B; thence westerly by that boundary, southerly by the western boundaries of allotments 10, 10^A and Lots 1 and 2 on Plan of Subdivision 122391 and easterly by the southern boundary of Lot 2 to the road forming the western boundary of allotment 11; thence southerly, easterly, and north-

easterly by that road and further north-easterly by Reedy Creek Road to Blackman Road; thence generally south-easterly by that road to the western boundary of allotment 16, Parish of Derril; thence southerly by that boundary, easterly by the southern boundaries of allotments 16 and 17, and northerly by the eastern boundary of allotment 17 to the southern boundary of the Parish of Kerrisdale; thence north-easterly by that boundary to the most southern angle of allotment 9^C, being a point on the eastern boundary of the Shire; thence north-easterly, generally south-easterly, southerly, north-westerly, south-westerly and westerly by the shire boundary to the Broadford-Epping Road; thence northerly by that road to the road forming the northern boundary of the Parish of Wallan Wallan; thence westerly by that road to the Hume Freeway; thence northerly by that freeway to Arkells Road; thence westerly by that road to the Northern Highway and further westerly by the road forming the northern boundaries of allotments 100B, 95, and 96, Parish of Bylands and Arkells Lane to the southern boundary of allotment 111; thence westerly by that boundary to the south-western boundary of the Shire, and thence generally north-westerly by the shire boundary to the point of commencement.

Schedule 6

PRETTY SALLY WARD

Commencing on the southern boundary of the Shire, at the Broadford-Epping Road; thence northerly by the Broadford-Epping Road to the road forming the northern boundary of the Parish of Wallan Wallan; thence westerly by that road to the Hume Freeway; thence northerly by that freeway to Arkells Road; thence westerly by that road to the Northern Highway and further westerly by the road forming the northern boundaries of allotments 100B, 95, and 96, Parish of Bylands and Arkells Lane to the southern boundary of allotment 111; thence westerly by that boundary to the south-western boundary of the Shire, and thence southerly, easterly, generally northerly and easterly by the shire boundary to the point of commencement.

Dated 15 October 1996

Responsible Minister:
ROBERT MACLELLAN
Minister for Planning and
Local Government

ANNETTE WILTSHIRE
Acting Clerk of the Executive Council

Local Government Act 1989
SOUTH GIPPSLAND SHIRE COUNCIL
Number Of Councillors To Be Appointed

The Governor in Council acting under Part 10C of the Local Government Act 1989, Orders that:

1. This Order comes into operation on the day it is published in the Government Gazette.
2. The number of councillors assigned to the South Gippsland Shire Council shall be nine (9).
3. The municipal district of South Gippsland Shire Council shall be divided into nine (9) wards.
4. The number of councillors assigned to each ward will be one (1).
5. On the day this Order comes into operation the boundaries of each ward shall be fixed as described in the Schedules to this Order.

Schedule 1
CORNER INLET WARD

Commencing on the shore of Corner Inlet at the mouth of the Franklin River; thence north-westerly by the Franklin River to a point in line with South Street; thence westerly by a line and South Street to the south-eastern angle of allotment 4, section E, Parish of Toora; thence northerly by the eastern boundary of that allotment and north-easterly by the south-eastern boundary of allotment 3 to Tramway Street; thence north-westerly by that street to Port Franklin Road; thence easterly by that road to Reserve Street; thence northerly by that street and a line in continuation to the Franklin River; thence generally north-westerly by that river to the Leongatha to Toora Railway; thence westerly by that railway to a point in line with the north-eastern boundary of allotment 3A, section B, Parish of Wonga Wonga South; thence north-westerly by a line and the north-eastern boundary of that allotment to the most southern angle of allotment 1F, section B; thence north-westerly, north-easterly and north-westerly by the western boundary of that allotment and further northerly by the eastern boundaries of allotment 1, section 5, Township of Foster and allotment 4, section 4 to Wilson Road; thence easterly by that road to the South Gippsland Highway at Ameys Track Road; thence generally northerly and

generally westerly by Ameys Track Road to the Foster North-Mirboo South Road; thence northerly by that road to the north-western angle of allotment 57, Parish of Mirboo South; thence easterly by the northern boundaries of that allotment, allotment 57C, Lot 1 on Plan of Subdivision 126028 and a line in continuation, allotment 24, section A and a line in continuation to the Boolarra-Foster Road; thence north-easterly by that road to the north-eastern boundary of the Shire, and thence north-easterly, generally south-easterly, easterly, southerly and generally westerly by the shire boundary to the point of commencement.

Schedule 2
PROMONTORY WARD

Commencing on the shore of Corner Inlet at the mouth of the Franklin River; thence north-westerly by the Franklin River to a point in line with South Street; thence westerly by a line and South Street to the south-eastern angle of allotment 4, section E, Parish of Toora; thence northerly by the eastern boundary of that allotment and north-easterly by the south-eastern boundary of allotment 3 to Tramway Street; thence north-westerly by that street to Port Franklin Road; thence easterly by that road to Reserve Street; thence northerly by that street and a line in continuation to the Franklin River; thence generally north-westerly by that river to the Leongatha to Toora Railway; thence westerly by that railway to a point in line with the north-eastern boundary of allotment 3A, section B, Parish of Wongi Wongi South; thence north-westerly by a line and the north-eastern boundary of that allotment to the most southern angle of allotment 1F, section B; thence north-westerly, north-easterly and north-westerly by the western boundary of that allotment and further northerly by the eastern boundaries of allotment 1, section 5, Township of Foster and allotment 4, section 4 to Wilson Road; thence easterly by that road to the South Gippsland Highway; thence westerly and north-westerly by that highway to the south-eastern angle of allotment 18A, section C, Parish of Wonga Wonga South; thence westerly by the southern boundary of that allotment to the eastern boundary of Lot 1 on Plan of Subdivision 122498; thence southerly by that boundary to the northern boundary of allotment 18E; thence easterly and southerly by the northern and eastern boundaries of that allotment to the north-

eastern angle of Lot 5 on Plan of Subdivision 139290; thence southerly and westerly by the eastern and southern boundaries of that lot and further westerly by the southern boundary of Lot 4 to a point in line with the eastern boundary of allotment 1A; thence southerly by a line and southerly and westerly by the eastern and southern boundaries of allotment 1A to the eastern boundary of allotment 18J; thence southerly by that boundary to Coopers Road; thence north-westerly by that road to the north-western angle of Lot 2 on Plan of Subdivision 216233; thence southerly by the western boundaries of that lot and Lots 2 and 1 on Plan of Subdivision 209053 to Davis Road; thence easterly by that road to the north-western boundary of Lot 2 on Plan of Subdivision 68258; thence southerly and south-easterly by the western and south-western boundaries of that lot to Hoddle Road; thence southerly by that road to the northern boundary of Lot 3 on Plan of Subdivision 222146; thence easterly by the northern boundaries of that lot, Lots 4 to 11 and Lots 12 and 13 on Plan of subdivision 222147 to the most northern angle of Lot 5 on Plan of Subdivision 127369; thence generally south-easterly by the eastern boundary of that lot and a line in continuation to the Leongatha to Toora Railway; thence south-westerly and westerly by that railway to a point north of the junction of the Fish Creek-Foster Road with the Meeniyah-Promontory Road; thence south by a line and southerly by the Meeniyah-Promontory Road to the north-western angle of Lot 2 on Plan of Subdivision 129160; thence easterly and southerly by the northern and eastern boundaries of that lot and further southerly by the eastern boundaries of Lots 2,3,4 and 5 on that plan of subdivision, Lots 1,2 and 3 on Plan of Subdivision 148850 and Lots 1 and 2 on Plan of Subdivision 210891 to the most northern angle of Lot 2 on Plan of Subdivision 213729; thence south-westerly by the north-western boundary of that lot to the Meeniyah-Promontory Road; thence south-easterly by that road to the Foster-Waratah Road; thence south-westerly by that road to Waratah Road; thence north-westerly by that road to the Fish Creek-Walkerville Road; thence south-westerly by that road to Kerrs Road; thence north-westerly by that road to Stamp Road; thence south-westerly by that road and the south-eastern boundary of the Parish of Tarwin South to the north-eastern angle of

allotment 20, Parish of Waratah; thence south-easterly by the north-eastern boundary of that allotment to the Buffalo-Waratah Road, being a point on the north-eastern boundary of that parish; thence south-easterly by that boundary to the shore of Bass Strait, being a point on the southern boundary of the Shire, and thence south-easterly, northerly, south-westerly and generally northerly by the shire boundary to the point of commencement.

Schedule 3 COASTAL WARD

Commencing on the shore of Anderson Inlet at Pound Creek, being a point on the south-western boundary of the Shire; thence south-easterly by the eastern shore of Anderson Inlet to the Tarwin River; thence generally easterly by that river to the north-western angle of Lot 2 on Plan of Subdivision 311596; thence easterly and south-easterly by the northern and north-eastern boundaries of that lot and easterly by the northern boundary of Lot 1 on Plan of Subdivision 69569 to the road forming the western boundary of allotment 18F, Parish of Tarwin South; thence northerly by that road to Breens Road; thence easterly and northerly by that road to the Buffalo-Tullaree Road; thence easterly, northerly and easterly by that road to the Buffalo-Waratah Road; thence northerly by that road to Setfords Road; thence easterly by that road to the road forming the eastern boundary of Lot 1 on Plan of Subdivision 62581; thence south-westerly by that road to Fish Creek; thence south-easterly by that creek to the most northern angle of allotment 41, Parish of Doomburrim; thence south-westerly and southerly by the north-western and western boundaries of that allotment and further southerly by the western boundaries of allotments 93D, 93E and allotment 32, Parish of Waratah North to Summers Road; thence south-easterly by that road to Stamp Road; thence south-westerly by that road and the south-eastern boundary of the Parish of Tarwin South to the north-eastern angle of allotment 20, Parish of Waratah; thence south-easterly by the north-eastern boundary of that allotment to the Buffalo-Waratah Road, being a point on the north-eastern boundary of that parish; thence south-easterly by that boundary to the shore of Bass Strait, being a point on the southern boundary of the Shire, and thence south-westerly, north-westerly and easterly by the shire boundary to the point of commencement.

Schedule 4
DRUMDLEMARA WARD

Commencing on the shore of Anderson Inlet at Pound Creek, being a point on the south-western boundary of the Shire; thence south-easterly by the eastern shore of Anderson Inlet to the Tarwin River; thence generally easterly by that river to the north-western angle of Lot 2 on Plan of Subdivision 311596; thence easterly and south-easterly by the northern and north-eastern boundaries of that lot and easterly by the northern boundary of Lot 1 on Plan of Subdivision 69569 to the road forming the western boundary of allotment 18F, Parish of Tarwin South; thence northerly by that road to Breens Road; thence easterly and northerly by that road to the Buffalo-Tullaree Road; thence easterly, northerly and easterly by that road to the Buffalo-Waratah Road; thence northerly by that road to Setfords Road; thence easterly by that road to the road forming the eastern boundary of Lot 1 on Plan of Subdivision 62581; thence south-westerly by that road to Fish Creek; thence south-easterly by that creek to a point in line with the western boundary of Lot 4 on Plan of Subdivision 206452; thence northerly by a line, the western boundaries of that lot and Lot 3 on that plan of subdivision, Lots 2 and 1 on Plan of Subdivision 205536, Lot 2 on Plan of Subdivision 147396, allotment 90A, Parish of Doomburrim and a line in continuation to the Leongatha to Toora Railway; thence generally northerly by that railway to the Meeniyam-Mirboo North Road; thence north-easterly by that road to Geales Road; thence north-westerly by that road to the Tarwin River East Branch; thence south-westerly by that river and the Tarwin River to the South Gippsland Highway; thence north-westerly and northerly by that highway to Steele Street; thence northerly by that street to Parr Street; thence westerly by that street, a line in continuation and Hanlon Street to McCartin Street; thence northerly by that street to Begg Street; thence westerly by that street and northerly by Gibson Street to Shingler Street; thence easterly by that street to the south-eastern boundary of Lot 1 on Plan of Subdivision 124080; thence northerly by the eastern boundary of that lot and the western boundary of allotment 1, section 11, Township of Leongatha to the South Gippsland Highway; thence north-westerly and westerly by that highway to the road forming the northern

boundary of Lot 28, section 1 on Plan of Subdivision 3887; thence westerly by that road to Shellcotts Road; thence northerly by that road to the south-eastern angle of Lot 1 on Plan of Subdivision 203972; thence westerly by the southern boundaries of that lot and Lot 1 on Plan of Subdivision 204462 to its south-western angle; thence westerly by a line to the north-eastern angle of Lot 1 on Plan of Subdivision 129552; thence westerly by the northern boundary of that lot and the southern boundary of Lot 2 on Plan of Subdivision 221397 and further westerly by a line to the south-eastern angle of Lot 6 on Plan of Subdivision 50580; thence westerly by the southern boundaries of that lot and Lot 1 on Plan of Subdivision 92703 and northerly by the western boundary of lot 1 and Swanson Street to the southern boundary of Lot 110 on Plan of Subdivision 50568; thence westerly by that boundary and the southern boundary of Lot 4 on Plan of Subdivision 126152 and northerly by its western boundary and the western boundaries of Lot 3 and further northerly by the western boundaries of Lot 1 on Plan of Subdivision 126152 to Bena Road; thence westerly by that road to the south-western angle of Lot 31 on Plan of Subdivision 3717; thence northerly and easterly by the western and northern boundaries of that lot and further easterly by the northern boundaries of Lots 30 to 25 to the south-eastern angle of Lot 9 on Plan of Subdivision 6688; thence northerly and westerly by the eastern and northern boundaries of that lot to the south-eastern angle of Lot A on Plan of Subdivision 116539; thence northerly by the eastern boundary of that lot to the South Gippsland Freeway; thence north-westerly by that freeway and the South Gippsland Highway to the Bena-Kongwak Road; thence generally southerly by that road to Jeetho West Road; thence north-westerly and westerly by that road to Loch-Wonthaggi Road; thence north-westerly by that road to the western boundary of the Shire, and thence southerly and generally south-easterly by the shire boundary to the point of commencement.

Schedule 5
TARWIN VALLEY WARD

Commencing on the north-eastern boundary of the Shire at the junction of the Boolarra-Foster Road with the Grand Ridge Road; thence south-westerly by the Boolarra-Foster Road to a point in line with the

northern boundary of allotment 24, section A, Parish of Mirboo South; thence westerly by a line, the northern boundary of that allotment and a line in continuation, the northern boundaries of Lot 1 on Plan of Subdivision 126028 and allotment 57C and 57 to the Foster North-Mirboo South Road; thence generally southerly by that road to Ameys Track Road; thence easterly and generally southerly by Ameys Track Road to the South Gippsland Highway; thence westerly and north-westerly by that highway to the south-eastern angle of allotment 18A, section C, Parish of Wonga Wonga South; thence westerly by the southern boundary of that allotment to the eastern boundary of Lot 1 on Plan of Subdivision 122498; thence southerly by that boundary to the northern boundary of allotment 18E; thence easterly and southerly by the northern and eastern boundaries of that allotment to the north-eastern angle of Lot 5 on Plan of Subdivision 139290; thence southerly and westerly by the eastern and southern boundaries of that lot and further westerly by the southern boundary of Lot 4 to a point in line with the eastern boundary of allotment 1A; thence southerly by a line and southerly and westerly by the eastern and southern boundaries of allotment 1A to the eastern boundary of allotment 18J; thence southerly by that boundary to Coopers Road; thence north-westerly by that road to the north-western angle of Lot 2 on Plan of Subdivision 216233; thence southerly by the western boundaries of that lot and Lots 2 and 1 on Plan of Subdivision 209053 to Davis Road; thence easterly by that road to the north-western boundary of Lot 2 on Plan of Subdivision 68258; thence southerly and south-easterly by the western and south-western boundaries of that lot to Hoddle Road; thence southerly by that road to the northern boundary of Lot 3 on Plan of Subdivision 222146; thence easterly by the northern boundaries of that lot, Lots 4 to 11 and Lots 12 and 13 on Plan of subdivision 222147 to the most northern angle of Lot 5 on Plan of Subdivision 127369; thence generally south-easterly by the eastern boundary of that lot and a line in continuation to the Leongatha to Toora Railway; thence south-westerly and westerly by that railway to a point north of the junction of the Fish Creek-Foster Road with the Meeniyah-Promontory Road; thence south by a line and southerly by the Meeniyah-Promontory Road to the north-

western angle of Lot 2 on Plan of Subdivision 129160; thence easterly and southerly by the northern and eastern boundaries of that lot and further southerly by the eastern boundaries of Lots 2,3,4 and 5 on that plan of subdivision, Lots 1,2 and 3 on Plan of Subdivision 148850 and Lots 1 and 2 on Plan of Subdivision 210891 to the most northern angle of Lot 2 on Plan of Subdivision 213729; thence south-westerly by the north-western boundary of that lot to the Meeniyah-Promontory Road; thence south-easterly by that road to the Foster-Waratah Road; thence south-westerly by that road to Waratah Road; thence north-westerly by that road to the Fish Creek-Walkerville Road; thence south-westerly by that road to Kerrs Road; thence north-westerly by that road and Summers Road to the south-western angle of allotment 32, Parish of Waratah North; thence northerly by the western boundaries of that allotment and allotments 93E and 93D and northerly and north-easterly by the western and north-western boundaries of allotment 41 to Fish Creek; thence south-easterly by that creek to a point in line with the western boundary of Lot 4 on Plan of Subdivision 206452; thence northerly by a line, the western boundaries of that lot and Lot 3 on that plan of subdivision, Lots 2 and 1 on Plan of Subdivision 205536, Lot 2 on Plan of Subdivision 147396, allotment 90A, Parish of Doomburrum and a line in continuation to the Leongatha to Toora Railway; thence generally northerly by that railway to the Meeniyah-Mirboo North Road; thence north-easterly by that road to Geales Road; thence north-westerly by that road to the Tarwin River East Branch; thence south-westerly by that river and the Tarwin River to the South Gippsland Highway; thence north-westerly and northerly by that highway to Steele Street; thence northerly by that street to Parr Street; thence easterly by that street to MacDonald Street; thence northerly by that street and easterly by Ogilvy Street and Nerrena Road to Coalition Creek; thence generally northerly by that creek to the Strzelecki Highway; thence north-easterly by that highway to Crightons Road; thence south-westerly by that road to the road forming the south-western boundary of allotment 17, Parish of Koorooman; thence south-easterly by that road to Mardan Road; thence generally easterly by that road to the Meeniyah-Mirboo North-Road; thence southerly by that road to a point in line with

the south-western boundary of Lot 2 on Plan of Subdivision 64549; thence south-easterly by a line, the south-western boundary of that lot and a line in continuation to the Tarwin River East Branch; thence north-easterly by that river to the south-western angle of allotment 4B, Parish of Dumbalk; thence northerly and easterly by the western and northern boundaries of that allotment to the western boundary of allotment 6; thence northerly and easterly by the western and northern boundaries of that allotment to the Tarwin River East Branch; thence north-easterly by that river to a point in line with the southern boundary of Lot 8 on Plan of Subdivision 5481; thence easterly by a line and easterly and north-easterly by the southern and south-eastern boundaries of that lot to the most western boundary of allotment 9B, Parish of Mirboo South; thence south-easterly by the south-western boundary of that allotment to Farmers Road; thence north-easterly by that road to a point in line with the northern boundary of Lot 2 on Plan of Subdivision 220288; thence easterly by a line and the northern boundaries of that lot and Lot 1 to the western boundary of allotment 12A; thence northerly by that boundary and south-easterly by the north-eastern boundaries of that allotment, allotment 12B and Lot 2 on Plan of Subdivision 307379 to the road forming the northern boundary of allotment 7; thence easterly by that road, a line in continuation and the road forming the southern boundaries of allotments 5, 4 and 22A to the north-eastern boundary of the Shire, and thence easterly and southerly by the shire boundary to the point of commencement.

Schedule 6
GRAND RIDGE WARD

Commencing on the northern boundary of the Shire at the south-western angle of allotment 71B, Parish of Allambce; thence easterly by the southern boundary of that allotment and southerly by the eastern boundaries of allotments 74B, 75C, 83C, 84B, 84C and 86B to the road forming the southern boundary of that allotment; thence westerly by that road to the road forming the eastern boundary of allotment 78, Parish of Korumburra; thence southerly by that road to the northern boundary of Lot 2 on Plan of Subdivision 206013; thence easterly by the that boundary and easterly and southerly by

the northern and eastern boundaries of allotment 80B to the Wilkur Creek, being a point on the eastern boundary of the Parish of Korumburra; thence southerly by that boundary to the most eastern angle of allotment 58C; thence westerly and north-westerly by the northern boundary of that allotment and further north-westerly by Fairbank Road to a point in line with the eastern boundary of allotment 60; thence southerly by a line and that boundary and the eastern boundary of allotment 60A to the northern boundary of Lot 2 on Plan of Subdivision 205146; thence easterly by that boundary and the northern boundary of allotment 57E to north-western angle of allotment 57C; thence south-westerly by the north-western boundary of that allotment to the Ruby-Arawata Road; thence easterly by that road to the north-western angle of Lot 1 on Plan of Subdivision 303282; thence south-westerly by the western boundaries of that lot, Lot 3 and a line in continuation to the northern boundary of allotment 51A; thence westerly and southerly by the northern and western boundaries of that allotment and further southerly by the western boundaries of allotments 51B, 52A, 52B, 52C and 68A to the South Gippsland Highway; thence easterly and south-easterly by that highway to the most western angle of allotment 12A; thence north-easterly by the north-western boundary of that allotment and further north-easterly by a line to the south-western angle of the Recreation, Convenience and Amusement Reserve (allotment 7A, section 29, Township of Leongatha); thence northerly and easterly by the western and northern boundaries of that reserve and northerly and easterly by the western and northern boundaries of the Recreation, Convenience and Amusement Reserve (allotment 7C) to Wild Dog Valley Road; thence southerly by that road to the north-western angle of allotment 1, section 30; thence north-easterly by the north-western boundaries of that allotment, allotments 2, 3 and 4 and further north-easterly by a line to the south-western angle of allotment 18; thence north-easterly and south-easterly by the north-western and north-eastern boundaries of that allotment and further south-easterly by the north-eastern boundary of Lot 2 on Plan of Subdivision 330327 to the Strzelecki Highway; thence north-easterly by that highway to Crightons Road; thence south-westerly by that road to the road

forming the south-western boundary of allotment 17, Parish of Koorooman; thence south-easterly by that road to Mardan Road; thence generally easterly by that road to the Meeniyah-Mirboo North-Road; thence southerly by that road to a point in line with the south-western boundary of Lot 2 on Plan of Subdivision 64549; thence south-easterly by a line, the south-western boundary of that lot and a line in continuation to the Tarwin River East Branch; thence north-easterly by that river to the south-western angle of allotment 4B, Parish of Dumbalk; thence northerly and easterly by the western and northern boundaries of that allotment to the western boundary of allotment 6; thence northerly and easterly by the western and northern boundaries of that allotment to the Tarwin River East Branch; thence north-easterly by that river to a point in line with the southern boundary of Lot 8 on Plan of Subdivision 5481; thence easterly by a line and easterly and north-easterly by the southern and south-eastern boundaries of that lot to the most western boundary of allotment 9B, Parish of Mirboo South; thence south-easterly by the south-western boundary of that allotment to Farmers Road; thence north-easterly by that road to a point in line with the northern boundary of Lot 2 on Plan of Subdivision 220288; thence easterly by a line and the northern boundaries of that lot and Lot 1 to the western boundary of allotment 12A; thence northerly by that boundary and south-easterly by the north-eastern boundaries of that allotment, allotment 12B and Lot 2 on Plan of Subdivision 307379 to the road forming the northern boundary of allotment 7; thence easterly by that road, a line in continuation and the road forming the southern boundaries of allotments 5 and 4 to the south-western angle of allotment 22A, being a point on the north-eastern boundary of the Shire, and thence generally northerly and generally westerly by the shire boundary to the point of commencement.

Schedule 7
LEONGATHA WARD

Commencing at the junction of Steele Street with Parr Street; thence westerly by Parr Street, a line in continuation and Hanlon Street to McCartin Street; thence northerly by that street to Begg Street; thence westerly by that street and northerly by Gibson Street to Shingler Street; thence easterly by that street

to the south-eastern boundary of Lot 1 on Plan of Subdivision 124080; thence northerly by the eastern boundary of that lot and the western boundary of allotment 1, section 11, Township of Leongatha to the South Gippsland Highway; thence south-easterly by that highway to the most western angle of allotment 12A; thence north-easterly by the north-western boundary of that allotment and further north-easterly by a line to the south-western angle of Recreation, Convenience and Amusement Reserve (allotment 7A, section 29, Township of Leongatha); thence northerly and easterly by the western and northern boundaries of that reserve and northerly and easterly by the western and northern boundaries of the Recreation, Convenience and Amusement Reserve (allotment 7C) to Wild Dog Valley Road; thence southerly by that road to the north-western angle of allotment 1, section 30; thence north-easterly by the north-western boundaries of that allotment, allotments 2, 3 and 4 and further north-easterly by a line to the south-western angle of allotment 18; thence north-easterly and south-easterly by the north-western and north-eastern boundaries of that allotment and further south-easterly by the north-eastern boundary of Lot 2 on Plan of Subdivision 330327 to the Strzelecki Highway; thence north-easterly by that highway to Coalition Creek; thence generally southerly by that creek to Nerrena Road; thence westerly by that road and Ogilvy Street to MacDonal Street; thence southerly by that street to Parr Street, and thence westerly by that street to the point of commencement.

Schedule 8
STRZELECKI WARD

Commencing on the northern boundary of the Shire at the south-western angle of allotment 71B, Parish of Allambec; thence easterly by the southern boundary of that allotment and southerly by the eastern boundaries of allotments 74B, 75C, 83C, 84B, 84C and 86B to the road forming the southern boundary of that allotment; thence westerly by that road to the road forming the eastern boundary of allotment 78, Parish of Korumburra; thence southerly by that road to the northern boundary of Lot 2 on Plan of Subdivision 206013; thence easterly by the that boundary and easterly and southerly by the northern and eastern boundaries of allotment 80B to the Wilkur Creek, being a

point on the eastern boundary of the Parish of Korumburra; thence southerly by that boundary to the most eastern angle of allotment 58C; thence westerly and north-westerly by the northern boundary of that allotment and further north-westerly by Fairbank Road to a point in line with the eastern boundary of allotment 60; thence southerly by a line and that boundary and the eastern boundary of allotment 60A to the northern boundary of Lot 2 on Plan of Subdivision 205146; thence easterly by that boundary and the northern boundary of allotment 57E to north-western angle of allotment 57C; thence south-westerly by the north-western boundary of that allotment to the Ruby-Arawata Road; thence easterly by that road to the north-western angle of Lot 1 on Plan of Subdivision 303282; thence south-westerly by the western boundaries of that lot, Lot 3 and a line in continuation to the northern boundary of allotment 51A; thence westerly and southerly by the northern and western boundaries of that allotment and further southerly by the western boundaries of allotments 51B, 52A, 52B, 52C and 68A to the South Gippsland Highway; thence generally westerly by that highway to the north-eastern angle of Lot 28, section 1 on Plan of Subdivision 3887; thence easterly by a line in continuation of the northern boundary of Lot 28 to Silkstone Road; thence south-easterly by that road to Coal Creek; thence easterly by that creek to a point in line with the eastern boundary of allotment 3, section S, Township of Korumburra; thence northerly by a line and that boundary to road forming the northern boundary of allotment 4; thence easterly by that road to the western boundary of allotment 5; thence northerly by that boundary to Inches Road; thence easterly by that road to the eastern boundary of allotment 21, section G; thence northerly by that boundary to the road forming the northern boundary of that allotment; thence westerly by that road to the eastern boundary of allotment 11; thence northerly by that boundary to Nason Street; thence easterly by that road to Elmore Road; thence north-westerly by that road and a line in continuation to the road forming the western boundary of allotment 22, section E; thence northerly by that road to Amiets Road; thence westerly by that road to the road forming the western boundary of allotment 1A; thence northerly by that road to the northern boundary of the Township of

Korumburra; thence westerly by that boundary and Stuart Street to the Korumburra-Warragul Road; thence further westerly and southerly by the northern and western boundaries of the Township of Korumburra to the South Gippsland Highway; thence north-westerly by that highway and further north-westerly by the South Gippsland Freeway and again the South Gippsland Highway to the Bena-Kongwak Road; thence generally southerly by that road to Jeetho West Road; thence north-westerly and westerly by that road to Loch-Wonthaggi Road; thence north-westerly by that road to the western boundary of the Shire, and thence generally north-westerly and generally easterly by the shire boundary to the point of commencement.

Schedule 9

KORUMBURRA WARD

Commencing on the Korumburra-Warragul Road at Stuart Street; thence easterly by Stuart Street and further easterly by the northern boundary of the Township of Korumburra to the road forming the western boundary of allotment 1A, section E, Township of Korumburra; thence southerly by that road to Amiets Road; thence easterly by that road to the road forming the eastern boundary of allotment 4; thence southerly by that road to the most southern angle of allotment 22; thence southerly by a line to Elmore Road; thence south-easterly by that road to Nason Street; thence westerly by that street to the eastern boundary of allotment 11, section G; thence southerly by that boundary to the road forming the northern boundary of allotment 22; thence easterly by that road to the eastern boundary of allotment 21; thence southerly by that boundary to Inches Road; thence westerly by that road to the western boundary of allotment 5, section S; thence southerly by that boundary to the road forming the northern boundary of allotment 4; thence south-westerly by that road to the eastern boundary of allotment 3; thence southerly by that boundary and a line in continuation to Coal Creek; thence westerly by that creek to Silkstone Road; thence north-westerly by that road to a point in line with the road forming the northern boundary of Lot 28, section 1 on Plan of Subdivision 3887; thence westerly by a line and that road to Shellcotts Road; thence northerly by that road to the south-eastern angle of Lot 1 on Plan of Subdivision 203972; thence westerly by the southern boundaries of that lot and Lot 1 on

Plan of Subdivision 204462 to its south-western angle; thence westerly by a line to the north-eastern angle of Lot 1 on Plan of Subdivision 129552; thence westerly by the northern boundary of that lot and the southern boundary of Lot 2 on Plan of Subdivision 221397 and further westerly by a line to the south-eastern angle of Lot 6 on Plan of Subdivision 50580; thence westerly by the southern boundaries of that lot and Lot 1 on Plan of Subdivision 92703 and northerly by the western boundary of lot 1 and Swanson Street to the southern boundary of Lot 110 on Plan of Subdivision 50568; thence westerly by that boundary and the southern boundary of Lot 4 on Plan of Subdivision 126152 and northerly by its western boundary and the western boundary of Lot 3 and further northerly by the western boundary of Lot 1 on Plan of Subdivision 126152 to Bena Road; thence westerly by that road to the south-western angle of Lot 31 on Plan of Subdivision 3717; thence northerly and easterly by the western and northern boundaries of that lot and further easterly by the northern boundaries of Lots 30 to 25, to the south-eastern angle of Lot 9 on Plan of Subdivision 6688; thence northerly and westerly by the eastern and northern boundaries of that lot to the south-eastern angle of Lot A on Plan of Subdivision 116539; thence northerly by the eastern boundary of that lot to the South Gippsland Freeway; thence south-easterly by that freeway and the South Gippsland Highway to the western boundary of the Township of Korumburra, and thence northerly and easterly by the western and northern boundaries of that township to the point of commencement.

Dated 15 October 1996

Responsible Minister:
ROBERT MACLELLAN
Minister for Planning and
Local Government

ANNETTE WILTSHIRE
Acting Clerk of the Executive Council

Shop Trading Act 1987
ORDER MADE PURSUANT TO SECTION
8 (3) (d) EXEMPTING SHOPS IN A
TOURIST PRECINCT FROM THE
PROVISIONS OF SECTION 7

Whereas the City of Greater Geelong, a municipal council, has made application to the Minister administering the *Shop Trading Act 1987* for an Order under Section 8 (3) (d)

of the Act exempting shops in a tourist precinct in its municipal district from the provisions of Section 7.

And whereas the Minister has recommended, in accordance with Section 8 (3), that such an Order be made by the Governor in Council.

Now therefore by this Order the Governor of the State of Victoria, acting with the advice of the Executive Council therefore, hereby exempts shops in the tourist precinct being Drysdale; bounded by and fronting High Street, Eversley Street, Palmerston Street and the "Wyndham Street Mall"; Hancock Street and Clifton Springs Road between Murradoc Road and the "Village Walk" inclusive; and the area bounded by and including Murradoc Road, Sproat Street, McKenzie Street and Collins Street, from the provisions of Section 7 of the *Shop Trading Act 1987* (other than the requirement that such shops be closed and kept closed at all times on Good Friday and Anzac Day).

Opening times are to be 1.00 p.m. to 6.00 p.m. Saturdays and 10.00 a.m. to 5.00 p.m. Sundays and Public Holidays.

Dated 15 October 1996

Responsible Minister:
MARK BIRRELL
Minister for Industry, Science and
Technology

ANNETTE WILTSHIRE
Acting Clerk of the Executive Council

Shop Trading Act 1987
ORDER MADE PURSUANT TO SECTION
8 (3) (d) EXEMPTING SHOPS IN A
TOURIST PRECINCT FROM THE
PROVISIONS OF SECTION 7

Whereas the City of Greater Geelong, a municipal council, has made application to the Minister administering the *Shop Trading Act 1987* for an Order under Section 8 (3) (d) of the Act exempting shops in a tourist precinct in its municipal district from the provisions of Section 7.

And whereas the Minister has recommended, in accordance with Section 8 (3), that such an Order be made by the Governor in Council.

Now therefore by this Order the Governor of the State of Victoria, acting with the advice of the Executive Council therefore, hereby

exempts shops in the tourist precinct being Portarlington; includes the area bounded by and fronting Newcombe Street, High Street, Fenwick Street and Fisher Street; and the Geelong-Portarlington Road between Sproat Street and Lincoln Drive, in the City of Greater Geelong from the provisions of Section 7 of the Shop Trading Act 1987 (other than the requirement that such shops be closed and kept closed at all times on Good Friday and Anzac Day).

Opening times are to be 1.00 p.m. to 6.00 p.m. Saturdays and 10.00 a.m. to 5.00 p.m. Sundays and Public Holidays.

Dated 15 October 1996

Responsible Minister:

MARK BIRRELL

Minister for Industry, Science and Technology

ANNETTE WILTSHIRE
Acting Clerk of the Executive Council

Shop Trading Act 1987
ORDER MADE PURSUANT TO SECTION
8 (3) (d) EXEMPTING SHOPS IN A
TOURIST PRECINCT FROM THE
PROVISIONS OF SECTION 7

Whereas the City of Greater Geelong, a municipal council, has made application to the Minister administering the Shop Trading Act 1987 for an Order under Section 8 (3) (d) of the Act exempting shops in a tourist precinct in its municipal district from the provisions of Section 7.

And whereas the Minister has recommended, in accordance with Section 8 (3), that such an Order be made by the Governor in Council.

Now therefore by this Order the Governor of the State of Victoria, acting with the advice of the Executive Council therefore, hereby exempts shops in the tourist precinct being Ocean Grove; the area bounded by and fronting Presidents Avenue, The Parade, Eggleston Street, and Dare Street; Grubb Road between Shell Road and Adco Grove; and the area bounded by and fronting Grubb Road, Sinclair Street, Everist Road, Smithton Grove, Smithton Court and Adco Grove in the City of Greater Geelong from the provisions of Section 7 of the Shop Trading Act 1987 (other than the requirement that such shops be closed and kept closed at all times on Good Friday and Anzac Day).

Opening times are to be 1.00 p.m. to 6.00 p.m. Saturdays and 10.00 a.m. to 5.00 p.m. Sundays and Public Holidays.

Dated 15 October 1996

Responsible Minister:

MARK BIRRELL

Minister for Industry, Science and Technology

ANNETTE WILTSHIRE
Acting Clerk of the Executive Council

Shop Trading Act 1987
ORDER MADE PURSUANT TO SECTION
8 (3) (d) EXEMPTING SHOPS IN A
TOURIST PRECINCT FROM THE
PROVISIONS OF SECTION 7

Whereas the City of Greater Geelong, a municipal council, has made application to the Minister administering the Shop Trading Act 1987 for an Order under Section 8 (3) (d) of the Act exempting shops in a tourist precinct in its municipal district from the provisions of Section 7.

And whereas the Minister has recommended, in accordance with Section 8 (3), that such an Order be made by the Governor in Council.

Now therefore by this Order the Governor of the State of Victoria, acting with the advice of the Executive Council therefore, hereby exempts shops in the tourist precinct being St Leonards; includes The Esplanade between Harvey Road and Murradoc Road; and Murradoc Road between The Esplanade and Wattletree Avenue, in the City of Greater Geelong from the provisions of Section 7 of the Shop Trading Act 1987 (other than the requirement that such shops be closed and kept closed at all times on Good Friday and Anzac Day).

Opening times are to be 1.00 p.m. to 6.00 p.m. Saturdays and 10.00 a.m. to 5.00 p.m. Sundays and Public Holidays.

Dated 15 October 1996

Responsible Minister:

MARK BIRRELL

Minister for Industry, Science and Technology

ANNETTE WILTSHIRE
Acting Clerk of the Executive Council

**Shop Trading Act 1987
ORDER MADE PURSUANT TO SECTION
8 (3) (d) EXEMPTING SHOPS IN A
TOURIST PRECINCT FROM THE
PROVISIONS OF SECTION 7**

Whereas the City of Greater Geelong, a municipal council, has made application to the Minister administering the Shop Trading Act 1987 for an Order under Section 8 (3) (d) of the Act exempting shops in a tourist precinct in its municipal district from the provisions of Section 7.

And whereas the Minister has recommended, in accordance with Section 8 (3), that such an Order be made by the Governor in Council.

Now therefore by this Order the Governor of the State of Victoria, acting with the advice of the Executive Council therefore, hereby exempts shops in the tourist precinct being Indented Head; includes The Esplanade between Batman Road and Helen Street; and The Esplanade between Walpole Street and Jubilee Avenue in the City of Greater Geelong, from the provisions of Section 7 of the Shop Trading Act 1987 (other than the requirement that such shops be closed and kept closed at all times on Good Friday and Anzac Day).

Opening times are to be 1.00 p.m. to 6.00 p.m. Saturdays and 10.00 a.m. to 5.00 p.m. Sundays and Public Holidays.

Dated 15 October 1996

Responsible Minister:
MARK BIRRELL
Minister for Industry, Science and
Technology

ANNETTE WILTSHIRE
Acting Clerk of the Executive Council

**Shop Trading Act 1987
ORDER MADE PURSUANT TO SECTION
8 (3) (d) EXEMPTING SHOPS IN A
TOURIST PRECINCT FROM THE
PROVISIONS OF SECTION 7**

Whereas the City of Greater Geelong, a municipal council, has made application to the Minister administering the Shop Trading Act 1987 for an Order under Section 8 (3) (d) of the Act exempting shops in a tourist precinct in its municipal district from the provisions of Section 7.

And whereas the Minister has recommended, in accordance with Section 8 (3), that such an Order be made by the Governor in Council.

Now therefore by this Order the Governor of the State of Victoria, acting with the advice of the Executive Council therefore, hereby exempts shops in the tourist precinct being Barwon Heads; includes Hitchcock Avenue between Ozone Road and Bridge Road; Bridge Road between Hitchcock Avenue and Flinders Parade, and Golightly Street, in the City of Greater Geelong, from the provisions of Section 7 of the Shop Trading Act 1987 (other than the requirement that such shops be closed and kept closed at all times on Good Friday and Anzac Day).

Opening times are to be 1.00 p.m. to 6.00 p.m. Saturdays and 10.00 a.m. to 5.00 p.m. Sundays and Public Holidays.

Dated 15 October 1996

Responsible Minister:
MARK BIRRELL
Minister for Industry, Science and
Technology

ANNETTE WILTSHIRE
Acting Clerk of the Executive Council

**Shop Trading Act 1987
EXEMPTION FROM CLOSING HOURS
PROVISIONS FESTIVALS**

The Governor in Council under Section 8 (3) (b) of the Shop Trading Act 1987 exempts all shops located in the Stud Park Shopping Centre within the municipal district of the Knox City Council, during The Stringy Bark Festival, from any part of the provisions of Section 7 of the Shop Trading Act on the following day:

Sunday, 20 October 1996 between the hours of 10.00 a.m. and 5.00 p.m.

Dated 8 October 1996

Responsible Minister:
MARK BIRRELL
Minister for Industry, Science and
Technology

ANNETTE WILTSHIRE
Acting Clerk of the Executive Council

**Shop Trading Act 1987
EXEMPTION FROM CLOSING HOURS
PROVISIONS FESTIVALS**

The Governor in Council under Section 8 (3) (b) of the Shop Trading Act 1987 exempts all shops located in the Frankston

Central Business District, being the area bounded by Kananook Creek Boulevard South, Kananook Creek Boulevard, Beach Street, Nepean Highway, Fletcher Road, Cranbourne Road, Baxter Street and Davey Street in the Municipal District of the Frankston City Council, during The Dolphin City Festival, from any part of the provisions of Section 7 of the Shop Trading Act on the following day:

Sunday, 1 December 1996 between the hours of 10.00 a.m. and 5.00 p.m.

Dated 8 October 1996

Responsible Minister:

MARK BIRRELL

Minister for Industry, Science and Technology

ANNETTE WILTSHIRE

Acting Clerk of the Executive Council

**Shop Trading Act 1987
EXEMPTION FROM CLOSING HOURS
PROVISIONS FESTIVALS**

The Governor in Council under Section 8 (3) (b) of the Shop Trading Act 1987 exempts all shops located in Curdie Street between Walker Street and Adams Street and Victoria Street between Tarrant Street and Silvester Street Cobden in the Corangamite Shire, during The Cobden Flowers, Food and Fun for Everyone Festival from any part of the provisions of Section 7 of the Shop Trading Act on the following days:

Saturday, 19 October between 1.00 p.m. and 4.00 p.m.; and

Sunday, 20 October 1996 between the hours of 10.00 a.m. and 4.00 p.m.

Dated 15 October 1996

Responsible Minister:

MARK BIRRELL

Minister for Industry, Science and Technology

ANNETTE WILTSHIRE

Acting Clerk of the Executive Council

**Melbourne City Link Act 1995
DECREASING THE PROJECT AREA**

The Governor in Council, on the recommendation of the Minister for Planning and Local Government (being the Minister administering the Melbourne City Link Act

1995 and the Minister administering the Planning and Environment Act 1987), under Section 8 (1) of the Melbourne City Link Act 1995 varies the Project area by decreasing the Project area as shown by pink hatching on the plan numbered LEGL./96-245 lodged in the Central Plan Office.

Dated 15 October 1996

Responsible Minister:

ROBERT MACLELLAN

Minister for Planning and Local Government

ANNETTE WILTSHIRE

Acting Clerk of the Executive Council

**Melbourne City Link Act 1995
REVOCATION OF PART OF
RESERVATION**

The Governor in Council, on the recommendation of the Minister for Planning and Local Government (being the Minister administering the Melbourne City Link Act 1995), under Section 29 (2) of the Melbourne City Link Act 1995 revokes:

(a) the Order in Council of 13 October 1873 (vide Government Gazette 1873 p. 2004) permanently reserving land at Richmond as a Site for Public Park and Recreation Reserve;

(b) the Crown Grant Volume 1902 Folio 326—

in so far as the Order and the Crown Grant relate to the land shown hatched on plan numbered LEGL./96-420 lodged in the Central Plan Office.

Dated 15 October 1996

Responsible Minister:

ROBERT MACLELLAN

Minister for Planning and Local Government

ANNETTE WILTSHIRE

Acting Clerk of the Executive Council

**Melbourne City Link Act 1995
SURRENDER OF INTERESTS IN
UNRESERVED CROWN LAND**

The Governor in Council, on the recommendation of the Minister for Planning and Local Government (being the Minister administering the Melbourne City Link Act 1995), under Section 26 (2) of the Melbourne

City Link Act 1995 declares that the interests (if any) in the land shown hatched on the plan referred to in the Schedule are surrendered to the Crown.

Schedule

The land shown hatched on plan numbered LEGL./96-419 lodged in the Central Plan Office.

Dated 15 October 1996

Responsible Minister:

ROBERT MACLELLAN
Minister for Planning and
Local Government

ANNETTE WILTSHIRE
Acting Clerk of the Executive Council

Crown Land (Reserves) Act 1978
NOTICE OF INTENTION

The Governor in Council under Section 10 of the **Crown Land (Reserves) Act 1978** gives notice of intention to revoke the following temporary reservations:

BALLARAT EAST—The temporary reservation by Order in Council of 3 February 1891 of an area of 4351 square metres of land in the Township of Ballarat East, Parish of Ballarat (formerly Town of Ballarat) as a site for Railway purposes—(P101502).

(The above notice in the Township of Ballarat East relates to a railway reservation over land that is not used by the Public Transport Corporation for operational purposes. The reservation needs to be revoked to enable its addition to the adjoining Eureka Stockade Reserve.)

BALROOTAN—The temporary reservation by Order in Council of 4 September 1896 of an area of 3.44 hectares of land in the Parish of Balrootan (formerly being part of Allotment 53) as a site for a Manure Depot—(Rs 2563).

BALROOTAN—The temporary reservation by Order in Council of 4 July 1950 of an area of 18.211 hectares, more or less, of land in the Parish of Balrootan as a site for a Rubbish Depot—(Rs 6555).

EDENHOPE—The temporary reservation by Order in Council of 19 June 1951 of an area of 1518 square metres, more or less, of land in Section 33, Township of Edenhope, Parish of Edenhope as a site for a Municipal Depot—(Rs 6667).

EDENHOPE—The temporary reservation by Order in Council of 25 November 1953 of an area of 4553 square metres, more or less, of land in Section 33, Township of Edenhope, Parish of Edenhope as a site for a Municipal Depot—(Rs 7183).

EDENHOPE—The temporary reservation by Order in Council of 11 September 1894 of an area of 4.047 hectares of land in Section 24, Township of Edenhope, Parish of Edenhope (formerly being part of Crown Allotment 29, Parish of Edenhope) as a site for a Manure and Night-Soil depot—(Rs 14260).

GERANG GERUNG—The temporary reservation by Order in Council of 14 December 1922 of an area of 1.212 hectares of land in Section 6, Township of Gerang Gerung, Parish of Gerang Gerung as site for a State School, in addition to and adjoining the site temporarily reserved therefor by Order in Council of 25 August 1890—(Rs 2622).

HARROW—The temporary reservation by Order in Council of 26 August 1969 of an area of 5.57 hectares of land in the Parish of Harrow as a site for Public Purposes (Sanitary Depot)—(Rs 9205).

KANIVA—The temporary reservation by Order in Council of 9 April 1968 of an area of 7613 square metres of land in Section 19, Township of Kaniva, Parish of Kaniva as a site for Public Purposes (Municipal Depot)—(Rs 8981).

KANIVA—The temporary reservation by Order in Council of 26 January 1982 of an area of 4011 square metres of land being Crown Allotment 8C, Section 3, Township of Kaniva, Parish of Kaniva as a site for Camping purposes—(Rs 12004).

LEEOR—The temporary reservation by Order in Council of 9 June 1914 of an area of 1.295 hectares of land in Section 6, Parish of Leeor (formerly being part of Crown Allotment 17) as a site for a Night Soil depot—(Rs 240).

LILLIMUR—The temporary reservation by Order in Council of 2 November 1891 of an area of 8094 square metres of land adjoining Crown Allotment 2, Parish of Lillimur as a site for a Manure Depot—(Rs 9796).

NORADJUHA—The temporary reservation by Order in Council of 30 May 1892 of an area of 2023 square metres of land in Section 7, Township of Noradjuha, Parish of Darragan as a site for a Rubbish Depot—(Rs 14259).

STRANGWAYS—The temporary reservation by Order in Council of 13 April 1874 of an area of 8094 square metres of land in the Parish of Strangways as a site for State School purposes—(Rs 7106).

YANIPY—The temporary reservation by Order in Council of 28 September 1948 of an area of 6475 square metres of land adjoining Crown Allotment 79D, Parish of Yanipy as a site for a Rubbish Depot—(Rs 6250).

Dated 15 October 1996

Responsible Minister:

MARIE TEHAN
Minister for Conservation and
Land Management

ANNETTE WILTSHIRE
Acting Clerk of the Executive Council

Crown Land (Reserves) Act 1978
NOTICE OF INTENTION

The Governor in Council under Section 10 of the **Crown Land (Reserves) Act 1978** gives notice of intention to revoke the following temporary reservation:

JIKA JIKA—The temporary reservation by Order in Council of 26 August 1975 of an area of 3.397 hectares of land being Crown Allotment 146A, Parish of Jika Jika as a site for Public Purposes (Alcoholism and Drug Dependent Persons Services Branch purposes) so far only as the portion containing 2.570 hectares shown as Crown Allotment 146H on Certified Plan No. 117344, Crown Allotment 146J on Certified Plan No. 117345, Crown Allotment 146K on Certified Plan No. 117346, Crown Allotments 146L and 146M on Certified Plan No. 117347, Crown Allotment 146N on Certified Plan No. 117348 and Crown Allotment 146P on Certified Plan No. 117349 (all in the Parish of Jika Jika) lodged in the Central Plan Office—(Rs 7573).

Dated 15 October 1996

Responsible Minister:

MARIE TEHAN
Minister for Conservation and
Land Management

ANNETTE WILTSHIRE
Acting Clerk of the Executive Council

Crown Land (Reserves) Act 1978
REVOCATION OF TEMPORARY
RESERVATION

The Governor in Council under Section 10 of the **Crown Land (Reserves) Act 1978** revokes the following temporary reservation:

AT BENDIGO—The temporary reservation by Order in Council of 18 December 1973 of an area of 200 square metres, more or less, of land being Crown Allotment 6, Section 24C, at Bendigo, Parish of Sandhurst as a site for Public Purposes (Historic Building)—(Rs 9836).

Dated 15 October 1996

Responsible Minister:

MARIE TEHAN
Minister for Conservation and
Land Management

ANNETTE WILTSHIRE
Acting Clerk of the Executive Council

Crown Land (Reserves) Act 1978
REVOCATION OF TEMPORARY
RESERVATION

The Governor in Council under Section 10 of the **Crown Land (Reserves) Act 1978** revokes the following temporary reservation:

MORTLAKE—The temporary reservation by Order in Council of 1 October 1968 of an area of 2276 square metres of land in Section 19, Township of Mortlake, Parish of Mortlake as a site for public purposes (Police purposes), revoked as to part by Order in Council of 20 August 1985 so far only as the portion containing 613 square metres shown as Crown Allotment 24, Section 19, Township of Mortlake, Parish of Mortlake, on Certified Plan No. 116850 lodged in the Central Plan Office—(Rs 9068).

Dated 15 October 1996

Responsible Minister:

MARIE TEHAN
Minister for Conservation and
Land Management

ANNETTE WILTSHIRE
Acting Clerk of the Executive Council

Crown Land (Reserves) Act 1978
CROWN LANDS TEMPORARILY
RESERVED

The Governor in Council under Section 4 of the **Crown Land (Reserves) Act 1978** temporarily reserves the following Crown lands for the purposes mentioned:

MUNICIPAL DISTRICT OF THE
GREATER BENDIGO CITY COUNCIL

AT BENDIGO—Public Purposes (Public Garden), 4345 square metres being Crown Allotment 8, Section 24C, at Bendigo, Parish of Sandhurst as shown on Certified Plan No. 117229 lodged in the Central Plan Office—(06/17714).

MUNICIPAL DISTRICT OF THE GREATER BENDIGO CITY COUNCIL
AT BENDIGO—Public Recreation, 4722 square metres being Crown Allotments 307M and 307N, Section O, at Bendigo, Parish of Sandhurst as shown on Certified Plan No. 117203 lodged in the Central Plan Office—(Rs 11315).

MUNICIPAL DISTRICT OF THE GOLDEN PLAINS SHIRE COUNCIL

HADDON—Conservation of an area of natural interest, 150 hectares, more or less, being Crown Allotment 20C, Section 19, Parish of Haddon as indicated by hatching on plan hereunder—(2740) (Rs 5275).

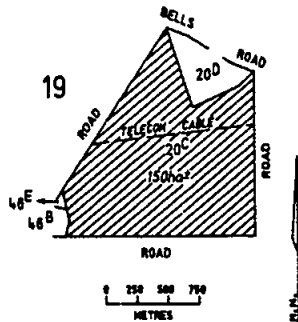

MUNICIPAL DISTRICT OF THE HEPBURN SHIRE COUNCIL
SPRING HILL—Conservation of an area of historic interest, 3.678 hectares being Crown Allotment 81A, Parish of Spring Hill as indicated by hatching on plan hereunder—(S311[7]) (Rs 12605).

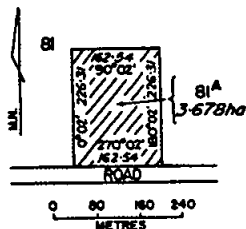

Dated 15 October 1996
 Responsible Minister:
MARIE TEHAN
 Minister for Conservation and Land Management
ANNETTE WILTSHIRE
 Acting Clerk of the Executive Council

Crown Land (Reserves) Act 1978
CROWN LANDS PERMANENTLY RESERVED

The Governor in Council under Section 4 of the Crown Land (Reserves) Act 1978 permanently reserves the following Crown lands for the purposes mentioned:

MUNICIPAL DISTRICT OF THE SWAN HILL RURAL CITY COUNCIL

CHINANGIN—Conservation of an area of natural interest, 5.272 hectares being Crown Allotment 6F, Parish of Chinangin, as shown on Certified Plan No. 112644 lodged in the Central Plan Office—(Rs 14386).

MUNICIPAL DISTRICT OF THE BULOKE SHIRE COUNCIL

WILKUR—Conservation of an area of natural interest, 2.428 hectares, being Crown Allotment 57B, Parish of Wilkur as indicated by hatching on plan hereunder—(W381[3]) (Rs 14388).

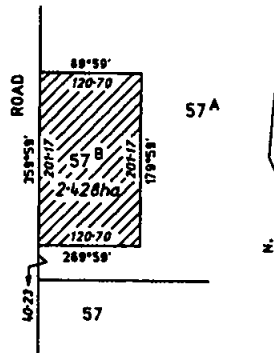

Dated 15 October 1996
 Responsible Minister:
MARIE TEHAN
 Minister for Conservation and Land Management
ANNETTE WILTSHIRE
 Acting Clerk of the Executive Council

Crown Land (Reserves) Act 1978
INCORPORATION OF COMMITTEE OF MANAGEMENT OF THE EUROA ARBORETUM AND PUBLIC PURPOSES RESERVE

The Governor in Council under Section 14 A (1) of the Crown Land (Reserves) Act 1978, being satisfied that it is in the public

interests to declare to be a corporation the Committee of Management appointed under Section 14 (2) of the Act of the land described in the schedule hereunder:

- (a) declares that the Committee of Management shall be a corporation;
- (b) assigns the name "Euroa Arboretum Committee Of Management Incorporated" to the corporation; and

under Section 14 B (3) of the Act, appoints Frank Pierce to be Chairperson of the corporation.

SCHEDULE

The land in the Parish of Branjee temporarily reserved as a site for Public purposes by Order in Council of 1 February 1994—(Rs 804168).

Dated 15 October 1996

Responsible Minister:
MARIE TEHAN
Minister for Conservation and Land Management

ANNETTE WILTSHIRE
Acting Clerk of the Executive Council

**Land Act 1958
UNUSED ROADS CLOSED**

The Governor in Council under Section 349 of the Land Act 1958 and with the consents in writing of the municipalities concerned and the adjoining owners closes the following unused roads:

**MUNICIPAL DISTRICT OF THE
MURRINDINDI SHIRE COUNCIL**

BUXTON—The road in the Parish of Buxton shown as Crown Allotment 9A on Certified Plan No. 117200 lodged in the Central Plan Office—(L7-5094).

**MUNICIPAL DISTRICT OF THE
MOORABOOL SHIRE COUNCIL**

GORDON—The road in the Township of Gordon, Parish Kerrit Bareet shown as Crown Allotment 6, Section 37, on Certified Plan No. 117111 lodged in the Central Plan Office—(L1-4557).

**MUNICIPAL DISTRICT OF THE
CENTRAL GOLDFIELDS SHIRE COUNCIL**

MARYBOROUGH—The road in the Parish of Maryborough shown as Crown Allotment 27B, Section 5 on Certified Plan No. 117325 lodged in the Central Plan Office—(87-0611).

**MUNICIPAL DISTRICT OF THE
MACEDON RANGES SHIRE COUNCIL**

WOODEND—The road in the Parish of Woodend shown as Crown Allotment 5B, Section 14 on Certified Plan No. 117277 lodged in the Central Plan Office—(L1-4003).

Dated 15 October 1996

Responsible Minister:
MARIE TEHAN
Minister for Conservation and Land Management

ANNETTE WILTSHIRE
Acting Clerk of the Executive Council

**Credit Act 1984
CREDIT (CREDIT UNION FEES) ORDER
NO. 4**

The Governor in Council under Section 19 of the Credit Act 1984 makes the following Order:

Citation

1. This Order may be cited as the Credit (Credit Union Fees) Order No. 4.

Commencement and Duration

2. This Order takes effect on and from 1 November 1996.

Application

3. This order applies to a regulated loan contract under which the credit provider is a credit union within the meaning of the Financial Institutions (Victoria) Code or a corresponding law of another State or Territory.

Order

4. Notwithstanding anything in the Credit Act 1984 or any Order in Council made pursuant to Section 19 of the Credit Act 1984, a regulated loan contract does not fail to comply with the Credit Act 1984 by reason only that an amount is payable under the contract with respect to a fee that arises where a cheque or payment order drawn by the debtor is dishonoured.

Dated 15 October 1996

Responsible Minister:
JAN WADE
Minister for Fair Trading

ANNETTE WILTSHIRE
Acting Clerk of the Executive Council

Credit Act 1984
CREDIT (CREDIT SOCIETY GENERAL
EXEMPTIONS) (AMENDMENT) ORDER
1996

The Governor in Council under Section 19 of the Credit Act 1984 makes the following Order:

Citation

1. This Order may be cited as the Credit (Credit Society General Exemptions) (Amendment) Order 1996.

Commencement and Duration

2. This Order takes effect on and from 1 November 1996.

Order

3. The Credit (Credit Society General Exemptions) Order No. 2 (as amended) is further amended as follows:

- (a) Insert "(1)" immediately before Sub-paragraph "8 (a)".
- (b) Insert "; or" at the end of Sub-paragraph "8 (e)".
- (c) Insert a new Sub-clause "8 (2)" as follows:

"(2) the credit society complies with the requirements of Division 1 of Part 4 of the Consumer Credit (Victoria) Code in so far as they relate to notification of interest rate changes."

Dated 15 October 1996

Responsible Minister:
JAN WADE
Minister for Fair Trading

ANNETTE WILTSHIRE
Acting Clerk of the Executive Council

State Owned Enterprises Act 1992
REAPPOINTMENT OF MEMBERS OF THE
URBAN LAND AUTHORITY

The Governor in Council under Section 8 (3) of the State Owned Enterprises Act 1992 reappoints the following persons as members of the Urban Land Authority from 21 October 1996 to 20 January 1997 (both dates inclusive):

Mr John Bernard Lawson, as Chairman;
Ms Angelika Dickschen, as a Member,
Mr Owen Stuart Lennie, as a Member,
Ms Susan Leslie Holmes, as a Member; and
Mr Jack William Beattie Reilly, as a Member.

Dated 15 October 1996

Responsible Minister:
ALAN R. STOCKDALE
Treasurer

ANNETTE WILTSHIRE
Acting Clerk of the Executive Council

**SUBORDINATE LEGISLATION ACT 1994
NOTICE THAT STATUTORY RULES ARE
OBTAINABLE**

Notice is given under Section 17 (3) of the Subordinate Legislation Act 1994 that the following Statutory Rules were first obtainable from Information Victoria, 318 Little Bourke Street, Melbourne on the date specified:

105. *Statutory Rule:* Financial Institutions Duty (Bill of Exchange Exemption) Regulations 1996

Authorising Act: Financial Institutions Duty Act 1982

Date first obtainable: 17 October 1996

Code A

106. *Statutory Rule:* Business Franchise (Tobacco and Petroleum Products) (Further Amendment) Regulations 1996

Authorising Act: Business Franchise (Tobacco) Act 1974

Date first obtainable: 17 October 1996

Code B

107. *Statutory Rule:* Physiotherapists (Qualifications) Regulations 1996

Authorising Act: Physiotherapists Act 1978

Date first obtainable: 17 October 1996

Code A

Retail price will vary according to the number of pages in each special or periodical gazette. The table below sets out the prices that apply.

<i>Price Code</i>	<i>No. of Pages (Including cover and blank pages)</i>	<i>Price</i>
A	1-16	\$2.70
B	17-32	\$4.00
C	33-48	\$5.50
D	49-96	\$8.50
E	97-144	\$11.00
F	145-192	\$13.00
G	193-240	\$15.00
H	241-288	\$16.00
I	289-352	\$18.00
J	353-416	\$21.00
K	417-480	\$24.00
L	481-544	\$28.00

ADVERTISERS PLEASE NOTE

As from 17 October 1996

The last Special Gazette was No. 117
Dated 10 October 1996

The last Periodical Gazette was No. 2
Dated 2 September 1996



2740 G 41 17 October 1996

Victoria Government Gazette





2742 G 41 17 October 1996

Victoria Government Gazette





CONTENTS

	Page
Appointment	2717
Estates of Deceased Persons	2675
Government and Outer Budget Sector Agencies Notices	2686
Notice that Statutory Rules are Obtainable	2783
Orders in Council—	
Acts— Local Government; Shop Trading; Melbourne City Link; Crown Land (Reserves); Land; Credit; State Owned Enterprises	2718
Private Advertisements	2675
Proclamation	2685

The Victoria Government Gazette is published by the Australian Government Publishing Service with the authority of the Government Printer for the State of Victoria
© State of Victoria 1996
ISSN 0819-5471

This publication is copyright. No parts may be reproduced by any process except in accordance with the provisions of the Copyright Act.

Products and services advertised in this publication are not endorsed by AGPS or the State of Victoria and neither of them accepts any responsibility for the content or the quality of reproduction. AGPS reserves the right to reject any advertising material it considers unsuitable for government publication.

Address all inquiries to the Government Printer for the State of Victoria

1 Macarthur Street
Melbourne 3002 Victoria Australia

Subscriptions

AGPS Victorian Operations

PO Box 263

Brunswick 3056

Telephone enquiries (03) 9387 8135

Fax (03) 9387 3404

Retail Sales

Information Victoria Bookshop

318 Little Bourke Street Melbourne 3000

Telephone enquiries (03) 9651 4100

Recommended Retail Price \$1.65



9 780644 457088