



Victoria Government Gazette

No. G 13 Thursday 3 April 1997

GENERAL

GENERAL AND PERIODICAL GAZETTE

All copy to be sent to:

Government Gazette Officer
AGPS Victorian Operations
PO Box 263
60 Fallon Street, Brunswick 3056
Telephone (03) 9387 8135
Fax (03) 9387 3404

Advertising Rates and Payment

Private Notices

Payment must be received in advance with advertisement details.

30 cents per word - Full page \$180.00.

An additional cost must be included in prepayment if a copy of the gazette is required. Cheques should be made payable to AGPS Victorian Operations.

Government and Outer Budget Sector Notices

Not required to pre-pay.

Advertisements must be faxed, and a cover sheet should be used, marked to the attention of the Gazette Coordinator.

Per Line	Camera Ready	Typeset
Single column	\$0.50	\$1.50
Double column	\$1.00	\$3.00
Full page	\$20.00	\$63.00

Copy Deadline for General Gazette:

9.30 a.m. Monday - (Private)

9.30 a.m. Tuesday - (Government and Outer Budget Sector)

Copy Prices - Page	\$1.50
- Certified	\$3.50
- Gazette	\$3.20

(All prices include Postage)

Advertisers should note:

- Late copy received at AGPS Victorian Operations after deadlines will be placed in the following issue of VGG, irrespective of any date/s mentioned in the copy (unless otherwise advised).
- Proofs will be supplied only when requested or at the direction of the Gazette Officer.
- No additions or amendments to material for publications will be accepted by telephone.
- Departments are requested not to lodge Executive Council papers for gazette unless a copy is provided with the Governor or Clerk's signature on the relevant document.
- Government and Outer Budget Sector Agencies Please note:

To ensure that material received can be reproduced, and that errors are minimised, the following guidelines are to be observed when submitting material by fax.

Fax resolution

Material sent by fax should be transmitted using Fine resolution (200 dots per inch by 200 dpi). Normal resolution is unacceptable.

Font Size

Use 12 point (10 pitch) or larger.

Font Style

Clear plain font styles, such as Helvetica, should be used.

Graphics

Line drawings should be transmitted as large as possible to ensure clarity. Drawings up to A4 size sent by fax using Fine resolution provide a good quality for reproduction.

Avoid

Italics, underlining, and full justification.

Ensure document is square when sending

Documents that are sent skewed are difficult to read and process.

If material does not meet above requirements your advertisement may not be published.

SPECIAL GAZETTES

Copy to: Julia Saad

AGPS Victorian Operations
60 Fallon Street,
Brunswick 3056
Telephone inquiries (03) 9387 8135
Fax No. (03) 9387 3404.

Advertising Rates and Payment

Private Notices

Full page \$360.00

Payment must be received in advance with notice details.

Government and Outer Budget Sector

Full page	Camera Ready	Typeset
\$27.00		\$85.05

Note:

The after hours contact number for Special Gazettes is:

Telephone 0412 243 123
014 693 550

SUBSCRIPTIONS AND RETAIL SALES

Copies of the Victoria Government Gazette can be purchased from AGPS Victorian Operations by subscription.

The Victoria Government Gazette

General and Special - \$165.00 each year

General, Special and Periodical - \$220.00 each year

Periodical - \$110.00 each year

Subscriptions are payable in advance and accepted for a period of one year. All subscriptions are on a firm basis and refunds for cancellations will not be given.

All payments should be made payable to AGPS Victorian Operations.

Subscription inquiries

AGPS Victorian Operations

PO Box 263

Brunswick Vic 3056

Telephone 13 2447

Fax (06) 295 4888

INDEX TO PRIVATE ADVERTISERS

A

A. B. Natoli Pty 732

B

Brian B. Keogh 731
B. T. B. Hill-Douglas 733

D

De Marco & Co 731

G

Garden & Green 732-733

H

Holding Redlich 731
Hunt & Hunt 733

J

John Stewart 731

N

National Mutual Trustees Limited 733
Nicholas O'Donohue & Co 732

P

Pearce Webster Dugdales 732

S

Sale by Sheriff 733-734

T

The Equity Trustees Executors and
Agency Company Limited 733
Thomas A. Cash 731

PRIVATE ADVERTISEMENTS

**NOTICE OF DISSOLUTION OF
PARTNERSHIP**

Take notice that the partnership between Deanna Long and Joanne Howard carrying on business as Eccentrica at 12 Morval Court, Deer Park was dissolved on 28 March 1997.

HOLDING REDLICH, solicitors, 350 William Street, Melbourne

Creditors, next of kin and others having claims in respect of the Will of Michael Mifsud late of 60 Roden Street, West Melbourne, Victoria, retired, deceased who died on 26 February 1997 are requested to send particulars of their claims to the executor Saviour Galea care of the undermentioned legal practitioner by 6 June 1997, after which date he will distribute the assets having regard only as to the claims of which he then has notice.

JOHN STEWART, legal practitioner, 290 Racecourse Road, Newmarket

Creditors, next of kin and others having claims in respect of the Will of Alwyn Lawrence Joseph Casey late of 24 Dermot Street, South Oakleigh, Victoria, retired, deceased who died on 20 February 1997 are requested to send particulars of their claims to the executor Elizabeth Ann de Hochepped-Larpent care of the undermentioned legal practitioner by 10 June 1997, after which date she will distribute the assets having regard only as to the claims of which she then has notice.

JOHN STEWART, legal practitioner, 290 Racecourse Road, Newmarket

Creditors, next of kin and others having claims in respect of the Will of Muriel Edna Cowper late of 32 Addison Street, Moonee Ponds, Victoria, widow, deceased who died on 21 January 1997 are requested to send particulars of their claims to the executor Derek Alan Cowper care of the undermentioned legal practitioner by 10 June 1997, after which date he will distribute the assets having regard only as to the claims of which he then has notice.

JOHN STEWART, legal practitioner, 290 Racecourse Road, Newmarket

Trustees Act 1958

SAVERIA MIGLIARDI, late of 11 Iris Court, Blackburn in the State of Victoria, widow, deceased

Creditors, next of kin and others having claims in respect of the estate of the deceased who died on 18 September 1996 are required by the trustees Antonio Migliardi, concretor of Lot 14 Foch Road, Silvan and Silvana Corda, hairdresser of 17 Dellwood Court, Templestowe, to send to them particulars by 4 June 1997, after which date the trustees may convey or distribute the assets having regard only to the claims of which they have notice.

Dated 3 April 1997

THOMAS A. CASH, solicitor, 6 Calvin Street, Hawthorn, Victoria, telephone 9818-6343

Creditors, next of kin and others having claims in respect of the estate of Dorothy Ridley late of 5 Moama Crescent, Pascoe Vale South, Victoria, pensioner, deceased who died on 24 January 1997 are required by the executor Joseph Muscat, pensioner of 5 Moama Crescent, Pascoe Vale South, Victoria, to send particulars of their claims to the said executor care of the undermentioned solicitors by 28 May 1997, after which date the said executor will convey or distribute the assets of the deceased having regard only to the claims of which the said executor then has notice.

DE MARCO & CO., solicitors, 209 Glenroy Road, Glenroy

Creditors, next of kin and other persons having claims against the estate of Alice Vera Taylor late of Taylor's Road, Kotupna, Victoria, farmer, deceased who died on 16 December 1996 are required by William Thomas Taylor and Mavis Louisa Job, the executors of the Will of the deceased to send particulars of their claims to the undermentioned solicitor by 20 June 1997, after which date they will distribute the estate having regard only to the claims of which they then have notice.

BRIAN B. KEOGH, solicitor, 22 Blake Street, Nathalia

MARY BRIDGET LANGRIDGE, late of Lilydale Nursing Home, Anderson Street, Lilydale, Victoria, widow, deceased

Creditors, next of kin and others having claims in respect of the estate of the abovenamed deceased who died on 11 November 1996 are required by Julian Gerard Langridge of 43 Roseman Road, Chirnside Park, Victoria, Catholic priest and Adrian Gerard Langridge of 4 Kinarra Court, Mooroolbark, Victoria, systems consultant, the executors of the deceased's Will to send particulars of their claim to the said executors care of the undermentioned solicitor by 15 June 1997, after which date they will convey or distribute the assets having regard only to the claims which they then have notice.

A. B. NATOLI PTY, solicitors, 24 Cotham Road, Kew

ROBERT GRAHAM BROWN, late of 110 Harrap Road, Osborne, Victoria, retired gentleman, deceased

Creditors, next of kin and others having claims in respect of the estate of the abovenamed deceased who died on 13 December 1996 are required by John Francis Natoli and Angelo James Natoli, solicitors, both of 24 Cotham Road, Kew and Donald Bruce Brown, retired mowing contractor of 175 Eastfield Road, Croydon, Victoria and Evelyn May Georgaras, home duties of 13 Jubilee Avenue, Frankston North, Victoria, the executors of the deceased's Will to send particulars of their claim to the said executors care of the undermentioned solicitor by 15 June 1997, after which date they will convey or distribute the assets having regard only to the claims which they then have notice.

A. B. NATOLI PTY, solicitors, 24 Cotham Road, Kew

KATHLEEN STILLMAN BUTTERY, deceased

Creditors, next of kin or others having claims in respect of the estate of Kathleen Stillman Buttery late of 15 Gowar Avenue, Camberwell, Victoria, widow, deceased who died on 12 November 1996 and Probate of whose Will has been granted to Jan Maree Coss of 18 Sassafras Drive, Lower Templestowe, Victoria, reservations clerk and Alan James Gilbert of 51 Queen Street, Melbourne, Victoria, solicitor are to send

particulars of their claims to the executors care of the undermentioned solicitors by 10 June 1997, after which date the executors will distribute the assets having regard only to the claims of which they then have notice.

PEARCE WEBSTER DUGDALES, lawyers, 51 Queen Street, Melbourne

DOROTHY LLOYD PEARCE, deceased

Creditors, next of kin or others having claims in respect of the estate of Dorothy Lloyd Pearce late of 21 Wandsworth Road, Surrey Hills, Victoria, widow, deceased who died on 27 June 1996 and Probate of whose Will has been granted to David Russell Ford of Unit 2, 3 Barton Street, Surrey Hills, Victoria, solicitor are to send particulars of their claims to the executor care of the undermentioned solicitors by 23 June 1997, after which date the executor will distribute the assets having regard only to the claims of which they then have notice.

PEARCE WEBSTER DUGDALES, lawyers, 51 Queen Street, Melbourne

JOYCE VERA HOWARD, formerly of 8 Hampden Street, Finley, New South Wales but late of Unit 5, 26-46 Rutherford Road, Rosanna, Victoria, retired machinist, deceased

Creditors, next of kin and others having claims in respect of the estate of the deceased who died on 26 January 1997 are required by the executor Maureen Mary Mitchell of care of 180 Queen Street, Melbourne, Victoria to send particulars to her by 4 June 1997, after which date she may convey or distribute the assets having regard only to the claims of which she then has notice.

NICHOLAS O'DONOHUE & CO., solicitors, 180 Queen Street, Melbourne, telephone (03) 9602 5777, Reference CL.970955

MURIEL MAY LEWIS, deceased

Creditors, next of kin or others having claims in respect of the estate of Muriel May Lewis late of 18 Splatt Street, Swan Hill, Victoria, married woman, deceased who died on 29 December 1996 are to send particulars of their claims to the executors George Roy Lewis, Elizabeth Olive Teelow and Owen Nalder Lewis care of the undermentioned

solicitors by 27 May 1997, after which date the executors will distribute the assets having regard only to the claims of which they then have notice.

GARDEN & GREEN, lawyers, 4
McCallum Street, Swan Hill

JOHN SYDNEY ROBINSON, deceased

Creditors, next of kin or others having claims in respect of the estate of John Sydney Robinson late of 13 Salisbury Street, Quambatook, Victoria, shire employee, deceased who died on 4 December 1996 are to send particulars of their claims to the executors Mary Maxine Robinson, Kim Maree Gillingham and Simon John Robinson care of the undermentioned solicitors by 27 May 1997, after which date the executors will distribute the assets having regard only to the claims of which they then have notice.

GARDEN & GREEN, lawyers, 4
McCallum Street, Swan Hill

Creditors, next of kin and others having claims in respect to the estate of Kathleen Mary McLoughlin late of 16 Carroll Street, North Melbourne in the State of Victoria, married woman, deceased who died on 17 November 1996 are required to send particulars of such claims to the executor National Mutual Trustees Limited at its registered office 65 Southbank Boulevard, Southbank by 4 June 1997, after which date the executor will distribute the estate having regard only to the claims of which it then has notice.

Creditors, next of kin and others having claims in respect to the estate of Hilda Fall late of 42 Alpine Boulevard, Launching Place in the State of Victoria, widow, deceased who died on 14 January 1997 are required to send particulars of such claims to the executor National Mutual Trustees Limited at its registered office 65 Southbank Boulevard, Southbank by 4 June 1997, after which date the executor will distribute the estate having regard only to the claims of which it then has notice.

JOHN DALLAS SCOTT, late of 87 Hannan Street, Williamstown in Victoria, artist, deceased

Creditors, next of kin and others having claims in respect of the estate of the abovenamed deceased who died on 4 December 1995 are required by the executor

Bruce Talbot Boswell Hill-Douglas of 7 Cleeve Court, Toorak in the said State to send particulars of their claims to the said executor by 4 May 1997, after which date he will convey or distribute the assets having regard only to the claims of which he then has notice.

B. T. B. HILL-DOUGLAS, 7 Cleeve Court,
Toorak

Creditors, next of kin and others having claims in respect of the estate of Kenneth James McKee formerly of 34 Clay Street, Moorabbin, but late of Elanora Home, 7 Mair Street, Brighton Beach, retired instrument maker, deceased who died on 14 February 1997 are to send particulars of their claims to The Equity Trustees Executors and Agency Company Limited of 472 Bourke Street, Melbourne by 10 June 1997, after which date it will distribute the assets having regard only to the claims of which it then has notice.

Creditors, next of kin and others having claimed in respect of the estate of Walter Neil Bladen late of 7 Severn Street, Yarraville, who died on 10 November 1996 are to send particulars of their claim to The Equity Trustees Executors and Agency Company Limited of 472 Bourke Street, Melbourne, by 5 May 1997, after which date it will distribute the assets having regard only to the claims of which it then has notice.

HUNT & HUNT, solicitors, 459 Collins
Street, Melbourne

In the Supreme Court of the State of Victoria
SALE BY THE SHERIFF

On 15 May 1997 at 2.30 p.m. at the Sheriff's Office, 8-20 King Street, Oakleigh (unless process be stayed or satisfied).

All the estate and interest (if any) of Emine Orhan of 18 Pilain Crescent, Keilor Downs, as shown on Certificate of Title as Emine Orhan joint proprietor with Ergin Orhan of an estate in fee simple in the land described on Certificate of Title Volume 9616, Folio 731 upon which is erected a brick house known as 18 Pilain Crescent, Keilor Downs.

Registered Mortgage Nos R971892V, S688231V and Caveat No. T251903H and the Covenant contained in Transfer M508135R affect the said estate and interest.

Terms—Cash Only.

S. BLOXIDGE
Sheriff's Officer

In the Supreme Court of the State of Victoria
SALE BY THE SHERIFF

On 15 May 1997 at 2.30 p.m. at the Sheriff's Office, 8-20 King Street, Oakleigh (unless process be stayed or satisfied).

All the estate and interest (if any) of Dennis Kastanis of 133 Henty Street, Reservoir, as shown on Certificate of Title as Dionisios Kastanis joint proprietor with Dimitra Kastanis of an estate in fee simple in the land described on Certificate of Title Volume 6217, Folio 320 upon which is erected a home known as 133 Henty Street, Reservoir.

Registered Mortgage No. U589514L affects the said estate and interest.

Terms—Cash Only.

S. BLOXIDGE
Sheriff's Officer

In the Supreme Court of the State of Victoria
SALE BY THE SHERIFF

On 15 May 1997 at 2.30 p.m. at the Sheriff's Office, 8-20 King Street, Oakleigh (unless process be stayed or satisfied).

All the estate and interest (if any) of Lorryn Rushton of 15 Marriott Parade, Glen Waverley, as shown on Certificate of Title as Lorryn Jeanette Rushton proprietor of an estate in fee simple in the land described on Certificate of Title Volume 9399, Folio 089 upon which is erected a dwelling known as 15 Marriott Parade, Glen Waverley.

Registered Mortgage No. U430086G and the Covenant in Transfer B924316 affect the said estate and interest.

Terms—Cash Only.

S. BLOXIDGE
Sheriff's Officer

Unclaimed Moneys Act 1962

Register of Unclaimed Moneys held by the—

Name of Owner on Books and Last Known Address	Total Amount Due to Owner	Description of Unclaimed Money	Date when Amount first became Payable
\$			
SANDHURST TRUSTEES LTD			
		Distribution to investors-Burke and Wills Film	
Clarke, D.E., 49 Malop St, Geelong	535.20	Trust	13.10.95
Francis, D., 558 Victoria Pde, East Melbourne	133.80	"	"
The Manager, Greg Wells Enterprises Pty, 6 Levenswell Rd, Moorabbin	223.00	"	"
Laurie, R.D., 13 Venetta Rd, Glenorie	120.42	"	"
Mayall, P.R., 82 McKillop St, Geelong	267.60	"	"
Morgan, V.C., 23A St Georges Rd, Toorak	446.00	"	"
Nottle, P.D., 11 Hawksburn Rd, South Yarra	214.08	"	"
Pribaz, J.J., No. 1 Chestnut St, Wellesley, Ma USA	245.30	"	"
Smyth, S.T., PO Box 160, Sunbury	178.40	"	"
Victoria Investments Pty Ltd, GPO Box 1669, Hobart TAS	111.50	"	"
Williams, E.A., 1 Churchill Ct, East Brighton	133.80	"	"
		Distribution to investors-The Man from Snowy River II	
Anderson, Kevin D., 13 Hartwell Pl, Cheltenham	137.55	Film Trust	6.10.95
CE Nominees Pty Ltd, c/- Mr Ed Davis, 5 Whernside Ave, Toorak	458.50	"	"
Chin, Bernard M., 13 Pawlett Way, Karrinyup WA	458.50	"	"
The Manager, Clark Leith Associates Pty Ltd, 177 Toorak Rd, Sth Yarra	229.25	"	"

Crawford, Nancy J., c/- E.L. Garrott, Group Services, PO Box 1130 Launceston TAS	458.50	"	"
Creswick, Henry P., PO Box 47, Hughes ACT	229.25	"	"
Denahy, Francis J., 13 Pepperdine Way, Highton	687.75	"	"
De Silva, L., 8/30 Morton St, Wollstonecraft	366.80	"	"
Dowling, Brian, 70 Winnalee Rd, Balwyn	458.50	"	"
Drover, Donald P., 39 Alice St, Turramurra NSW	137.55	"	"
Giles, Geoffrey O., 29 Hurtle Sq, Adelaide SA	229.25	"	"
Gillard, Bruce W., 15 Egan Rd, Dandenong	229.25	"	"
Gleeson, Paul A., 2265 Nepean Hwy, Rye	275.10	"	"
Grocott, Robert A., 2 McKinley Ave, Bonnet Bay	412.65	"	"
Hanton, Rodney J., 1 Boorook St, Mortlake	229.25	"	"
Harkness, John L., 19A Buckingham Rd, Killara NSW	229.25	"	"
Hill, Geraldine, 7/27 Anderson St, Kingsford NSW	229.25	"	"
The Manager, Horsey & Irvies Pty Ltd, PO Box 79, Sandgate QLD	229.25	"	"
Landers, Heather Cynthia, 59 Lt Palmerston St, Carlton	137.55	"	"
Landers, Joseph G., 59 Lt Palmerston St, Carlton	229.25	"	"
Levy, Norman E., c/-Mrs S.A. Blashki, 105 Balaclava Rd, North Caulfield	458.50	"	"
Linfoot, Murray, 17 Indra Ct, Sale	458.50	"	"
Lobel, Herbert, 352 Alma Rd, Caulfield	2,292.50	"	"
Mansfield, Robert, 8/46 St Albans St, Abbotsford	458.50	"	"
Mayall, Peter, 82 McKillop, Geelong	1,375.50	"	"
Mayne, Keith, 7 Norfolk St, Paddington NSW	917.00	"	"
McDonald, Andrew, 16 Elmie St, Hawthorn	2,292.50	"	"
Nettleton, R., 90 Mt Pleasant Rd, Eltham	458.50	"	"
Nettleton, Dr. J.P. Nettleton, 90 Mt Pleasant Rd, Eltham	458.50	"	"
Newman, Dr. R.W., 62 Greythorn Rd, North Balwyn	458.50	"	"
Nicholson, R.D., PO Box 653, Runaway Bay QLD	229.25	"	"
Peters, James W., 10/7 Coombs Ave, Oakleigh Sth	229.25	"	"
Polkinghorn, John R., 43 Jacaranda Pl, Wickham WA	137.55	"	"
Ralcuth Pty Ltd, c/- Mrs I.R. Collingwood, 3/1 Monaro Rd, Kooyong	458.50	"	"
Riordan, John A., 17 Coolgardie Ave, East Malvern	458.50	"	"
Rush, Peter A., 29 Belmont Ave, Kew	550.20	"	"
Senior, P., 15 Swanston St, Mentone	458.50	"	"
Shellshear, Dr. S., 37 Brigalow Ave, Kensington Gardens SA	687.75	"	"
Stanley, Roger G., 6 Creda Pl, Baulkham Hills NSW	229.25	"	"
Steidler, Dr. C., 62 Normanby Rd, Kew	917.00	"	"
Storz, Dr. H., 70 Eleanor St, Footscray	458.50	"	"
Swift Investments Pty Ltd, c/- Lloyd & Partners, 345 King William St, Adelaide SA	458.50	"	"
The Manager, Toad Facilities Pty Ltd, c/- 90 Mt Pleasant Rd, Eltham	458.50	"	"
Tremian, J., 57 Gurney Cres, Seaforth NSW	183.40	"	"
Valkama, Aarne M., Harbour Tce, Sanctuary Cove QLD	458.50	"	"
Wang, L., 9A/516 Toorak Rd, Toorak	320.95	"	"
Wedlick, Dr. Phyllis T., 51 Seymour Gve, Camberwell	458.50	"	"
Wharton, P., 20 Collins St, Melbourne	458.50	"	"
Williams, P.T., 10 Wagga Ct, Howrah Heights TAS	229.25	"	"
Wojcick, E., c/- G.J. Anderson, 3rd Floor, 44 Caroline St, South Yarra	458.50	"	"
Woodbank Pty Ltd, c/- Peat Marwick Hungerfords, 80 Collins St, Melbourne	3,438.75	"	"
Woods, R., c/- A G Severino & Associates, PO Box 197, Camberwell	2,292.50	"	"
Young, S., 21 Treetop Cres, Port Macquarie NSW	320.95	"	"

97026

CONTACT: BRIAN MITCHAM, PHONE: (03) 9672 5733



VICTORIAN ACTS AND REGULATIONS ON CD-ROM

Anstat is proud to announce the availability of its new CD-ROM service covering all Victorian Acts and Regulations.

ANSTAT'S SERVICE IS GENUINELY DIFFERENT

Key Features

- Same appearance as the paper version
- Monthly or quarterly updates
- Powerful search facility across the entire database or within each item
- Ability to copy and paste text to other applications and print extracts
- Unlimited use of Legislation Hotline and Electronic Help Desk
- Service will be Internet linked

Price

- \$250 p.a. for quarterly updates
- \$500 p.a. for monthly updates

Act Now

To find out more about our service, please contact Customer Services on telephone (03) 9645 1111 or facsimile (03) 9645 1926

Anstat Pty Ltd ACN 005 446 748
224-226 Normanby Road Southbank Vic 3006

**GOVERNMENT AND OUTER BUDGET SECTOR
AGENCIES NOTICES**

**MAROONDAH CITY COUNCIL
Road Discontinuance**

Pursuant to Section 206 and Clause 3 of Schedule 10 to the Local Government Act 1989, Maroondah City Council at its meeting on 11 March 1997 formed the opinion that the part of Miles Avenue and Adelaide Street, Ringwood, shown on the plan below, are not reasonably required as roads for public use and resolved to discontinue the roads.

The roads are to be sold subject to the right, power or interest held by Maroondah City Council, State Electricity Commission of Victoria, Gas & Fuel Corporation and Melbourne Water Corporation, in the roads in connection with any sewers, drains, pipes, wires or cables under the control of those authorities in or near the roads, as detailed in the plan below.

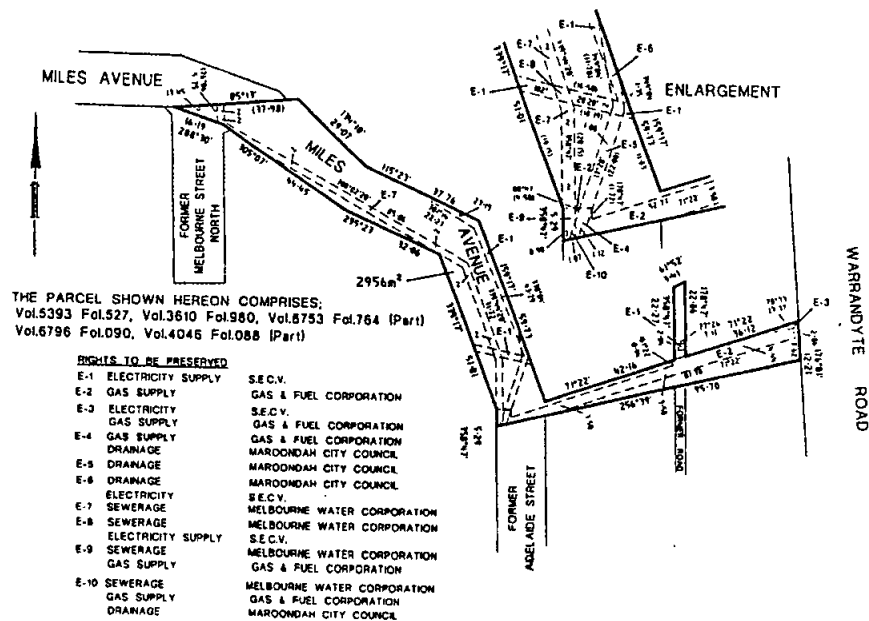

MICHAEL MARASCO
Chief Executive Officer

**LODDON SHIRE COUNCIL
Road Closure/Road Exchange**

Under Clause 2 (2) of Schedule 10 of the Local Government Act 1989, the Loddon Shire Council after consultation with all relevant statutory authorities, having advertised its intention in the Loddon Times and having received no submissions pursuant to Section 223 of the Local Government Act 1989, resolved at a meeting held on 14 March 1997:

- (a) that the land to be closed on the plan reproduced below is not reasonably required as a road for public use and that it be discontinued upon publication of a resolution to that effect in the Government Gazette; and
- (b) that the land shown as a new road be exchanged for the land shown to be closed.

HORSHAM RURAL CITY COUNCIL
Discontinuance of Road

Under Section 206 and Schedule 10, Clause 3 of the **Local Government Act 1989**, the Horsham Rural City Council at its ordinary meeting on 12 March 1997, formed the opinion that the road shown hatched on the plan below is not reasonably required as a road for public use and resolved to discontinue the road and sell it to abutting owners free of encumbrances.

protect against behaviour which is a nuisance or causes detriment to the amenity and environment of the municipality.

Council further resolved in accordance with Section 224 (A) of the **Local Government Act 1989** that any Police Officer may enforce the provisions of Local Law No. 8.

A copy of the Local Law may be inspected at City Hall, 30 Gheringhap Street, Geelong, during office hours 8.00 a.m.—5.00 p.m.

MICHAEL K. MALOUF
Chief Executive

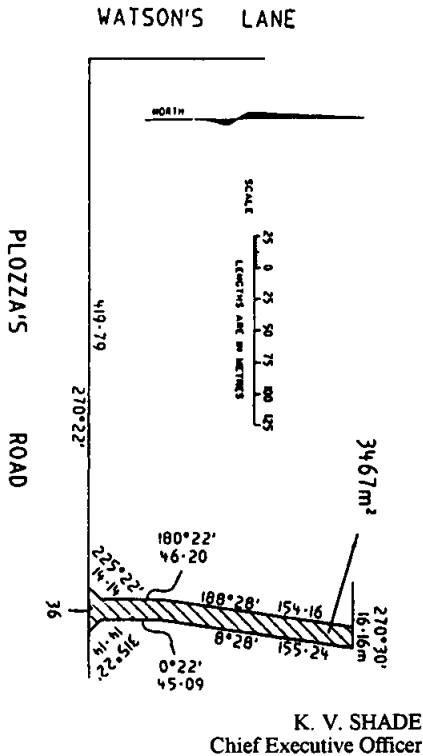

GREATER GEELONG CITY COUNCIL
Local Law No. 8
Liquor Consumption and Behaviour in Public Places

At a special meeting of Council held on 26 March 1997, the Council resolved to adopt and to make Local Law No. 8—Liquor Consumption and Behaviour in Public Places, the purpose of which is to prohibit, regulate and control the consumption of liquor and to

MONASH CITY COUNCIL
Road Discontinuance

Pursuant to Section 206 and Clause 3 of Schedule 10 to the **Local Government Act 1989**, Monash City Council at its meeting on 11 March 1997 formed the opinion that the part of the road at the rear of Nos 18 to 28 Shaw Street, Ashwood, shown by hatching on the plan below is not reasonably required as a road for public use and resolved to discontinue the road.

The road is to be sold subject to the right, power or interest held by Monash City Council and Yarra Valley Water Limited in the road in connection with any sewers, drains or pipes under the control of those authorities in or near the road.

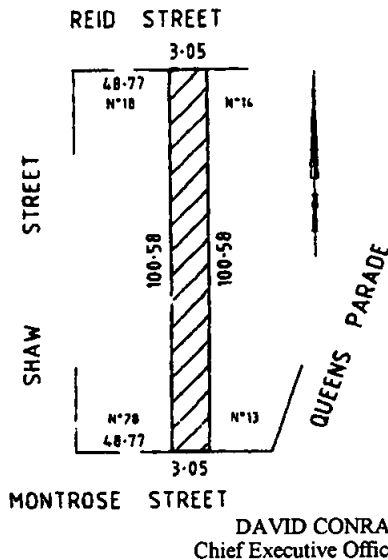

CITY OF DAREBIN
Local Law No. 18
Streets and Roads General Regulations
Local Law No. 19
Charitable Collection Bins
(Now "Recycled Charitable Collections")

Notice is hereby given that the Council of the City of Darebin resolved on 17 March 1997 to:

- (1) Revoke Local Law No. 10 of 1995.
- (2) Make Local Laws No. 18—Streets and Roads General Regulations and Local Law No. 19—Recycling Charitable Collections.

LOCAL LAW NO. 18

The purpose of the Local Law is to:

- (a) regulate the exhibition of merchandise on pavements;
- (b) regulate the exhibition of advertising signs on pavements;
- (c) regulate the placement of seats, tables, chairs and other furniture on pavements;
- (d) regulate the exhibition of merchandise and advertising signs on vehicles left standing near premises;
- (e) regulate the protrusion of verandahs and awnings into the airspace about pavements;
- (f) regulate the deposit of shopping trolleys in streets, car parks and other public places;
- (g) regulate the use of skateboards on pavements;
- (h) prohibit the dismantling and painting of vehicles on roads;
- (i) regulate the dismantling of vehicles on roads;
- (j) prohibit the destruction or removal of, or damage to, street furniture;
- (k) regulate the identification of premises;
- (l) regulate the growth of trees and plants so as to prevent accidents;
- (m) prohibit obstruction;
- (n) provide for the construction and maintenance of permanent and temporary vehicle crossings; and
- (o) regulate the placement of bulk rubbish containers on roads.

The purport of Local Law No. 18 is to:

- (i) regulate the exhibition of merchandise on pavements;
- (ii) regulate the exhibition of advertising signs on pavements;
- (iii) regulate the placement of seats, tables, chairs and other furniture on pavements;
- (iv) regulate the exhibition of merchandise and advertising signs on vehicles left standing near premises;
- (v) regulate the protrusion;
- (vi) regulate the deposit of shopping trolleys in streets, car parks and other public places;
- (vii) regulate the use of skateboards on pavements;
- (viii) prohibit the dismantling and painting of vehicles on roads;
- (ix) prohibit the destruction or removal of, or damage to, street furniture;
- (x) regulate the identification of premises;
- (xi) regulate the growth of trees and plants so as to prevent accidents;
- (xii) prohibit obstructions;
- (xiii) regulate the placement of bulk rubbish containers on roads;
- (xiv) provide for the construction and maintenance of permanent and temporary vehicle crossings;
- (xv) provide for the granting, revocation and registering of permits;
- (xvi) provide for enforcement including Infringement Notices, offences and penalties.

LOCAL LAW NO. 19

The purpose of the Local Law is to provide for the regulation of the collection of used clothing and other goods in charitable bins, and to ensure that residents and other persons who wish to make clothing and other goods available for the purposes of charities are able to do so and for that purpose to minimise or eliminate the possibility that such persons might be deceived as to the purposes for which donated clothing and goods are to be put.

The purport of the Local Law is to establish a system of control for the location in the municipal district of charitable collection bins used by certain charities. This includes rules governing the issuing of permits and fees and provides avenues for appeals against this Local Law to ensure:

- (i) that recycling charitable collection bins are located on sites which are easily accessible and visible to the public;
- (ii) that the sites on which the bins are located are kept in a clean condition and that the amenity of the area is not affected by their presence;
- (iii) that the bins are located in a way that they do not cause an obstruction or a potentially dangerous situation.

OTHER INFORMATION

The aims of the Local Laws are clearly outlined in the purpose of the Local Laws.

Local Laws No. 18 and 19 were advertised on Saturday, 15 February 1997 in *The Age* newspaper on Wednesday, 19 February 1997 in the *Northcote Leader*, on Wednesday, 19 February 1997 in the *Preston Post* and on Thursday, 20 February 1997 in the *Victoria Government Gazette*.

Council considered one submission on Local Law No. 18 at its meeting held on 17 March 1997 and resolved to adopt the Local Law without modification.

Council considered two submissions on Local Law No. 19 at its meeting held on 17 March 1997 and resolved to adopt the Local Law by deleting "Charitable Collection Bins" and inserting the description "Recycling Charitable Collections" wherever occurring.

Both Local Laws operate from Tuesday, 18 March 1997.

A copy of the Local Laws can be obtained from the Municipal Offices, 350 High Street, Preston, during office hours.

ADOPTION OF FEES AND CHARGES— LOCAL LAW NO. 19—RECYCLING CHARITABLE COLLECTIONS

Notice is hereby given that the Council of the City of Darebin at its meeting held on 17 March 1997 set the following fees and charges for Recycling Charitable Collections:

Schedule of Fees

1. Permit Fees (per bin)	\$100
2. Administration Charge*	\$25
3. Release Fee	\$100
4. Infringements against the Local Law	\$200

* A once only charge. Will only apply in subsequent years if Council is required to act on legitimate complaints against the permit holder.

KELVIN SPILLER
Chief Executive Officer

Planning and Environment Act 1987 PAKENHAM PLANNING SCHEME Notice of Amendment Amendment L140

The Cardinia Shire Council has prepared Amendment L140 to the Pakenham Planning Scheme.

The amendment affects the land at Lot 1 LP 110128, No. 84 Splitrock Road (corner Kitchen Road), Upper Beaconsfield.

The amendment proposes to change the Planning Scheme by inserting a site specific control within the Landscape Zone under Clause 6.6.5 to allow the land to be subdivided into two lots subject to the granting of a Planning Permit.

In order to protect the heritage qualities of the property, it is proposed that the site be made subject to the requirements of Clause 32 of the Local Section of the Pakenham Planning Scheme (Heritage Buildings and Places) which requires that all buildings and works, except routine maintenance where the external appearance is not changed, are subject to a permit.

The amendment can be inspected at Cardinia Shire Council, Municipal Offices, Henty Way, Pakenham, Victoria 3810 and the Department of Infrastructure, Plan Inspection Section, Olderfleet Buildings, 477 Collins Street, Melbourne, Victoria 3000.

Any person who is affected by the amendment may make a submission about the amendment. Submissions about the amendment must be sent to Cardinia Shire Council, P.O. Box 7, Pakenham, Victoria 3810, by 5 May 1997.

PHILIP WALTON
Manager Development

Planning and Environment Act 1987
BAYSIDE PLANNING SCHEME
 Notice of Amendment to a Planning Scheme
 Amendment L5

Bayside City Council has prepared Amendment L5 to the Bayside Planning Scheme, Local Section.

This amendment affects a parcel of land located along the north and west property boundaries of the property described as Certificate of Title Volume 8462, Folio 3231, Reserve Road, Cheltenham.

The amendment proposes to change the Planning Scheme by rezoning this parcel of land from General Industrial (Sandringham) to Reserved Land Local Government—Existing.

The amendment is similar to Amendment L4 to the Bayside Planning Scheme which applies to a separate parcel of land which fronts Reserve Road, Cheltenham. The amendment also rezones the land from General Industrial to Reserved Land Local Government—Existing so that it can be compulsorily acquired by Council and disposed of and used for industrial purposes.

The amendment can be inspected during office hours at Bayside City Council, Corporate Centre, Royal Avenue, Sandringham, Victoria 3191 or Department of Planning and Development, Olderfleet Buildings, 477 Collins Street, Melbourne, Victoria 3000.

Submissions about the amendment must be sent to Bayside City Council, Planning Department, P.O. Box 27, Sandringham, Victoria 3191, by 5.00 p.m. Thursday, 7 May 1997.

P. A. AKERS
 Chief Executive Officer

Planning and Environment Act 1987
NARRACAN PLANNING SCHEME
 Notice of Amendment
 Amendment L46

The Baw Baw Shire Council has agreed to exhibit Amendment L46 to the Narracan Planning Scheme.

The amendment affects land on the south east corner of Rankins Road and Princes Highway, Trafalgar West, known as the "Spud Shed" site.

The amendment proposes to amend the Narracan Planning Scheme to provide for a site at Trafalgar West adjoining the Princes Highway to be utilised as a service centre providing facilities for refuelling, refreshments, take-away food, accommodation and recreation.

A copy of the amendment can be inspected at Baw Baw Shire Council: Warragul Customer Service Centre, Shop 1, 61 Smith Street, Warragul; Drouin Customer Service Centre, 22-26 Princes Way, Drouin; Trafalgar Customer Service Centre, Princes Highway, Trafalgar and The Department of Infrastructure: Regional Office, 4/29 Breed Street, Traralgon; Olderfleet Buildings, 477 Collins Street, Melbourne.

Inspection of the amendment during office hours will be free of charge to any person.

Submissions about the amendment must be made in writing and sent to The Chief Executive Officer, Baw Baw Shire Council, P.O. Box 304, Warragul, Victoria 3820, or delivered to Warragul, Drouin or Trafalgar Customer Service Centres.

The date for the close of exhibition and receipt of submissions is 5 May 1997.

JOHN F. DYER
 Chief Executive Officer

Planning and Environment Act 1987
Planning and Environment (Planning Schemes) Act 1996

ALPINE PLANNING SCHEME
 Notice of Preparation of Planning Scheme

The Alpine Shire Council has prepared a new Alpine Planning Scheme.

The Planning Schemes affect all of the area of the municipal district of the Alpine Shire Council and the alpine resort areas of Falls Creek and Mt Hotham.

The Planning Scheme introduces a new Alpine Planning Scheme as required by the **Planning and Environment (Planning Schemes) Act 1996**, including a new format containing selected State standard provisions from the Victoria Planning Provisions, a municipal strategic statement, state and local policy frameworks, standardised zones, overlays, particular provisions relating to use and development, and a number of administrative provisions and definitions.

The new Planning Scheme also incorporates a number of documents specified in the Planning Scheme, and contains new maps applying the standardised zones and overlays to land within the area covered by the scheme.

The Planning Scheme, including incorporated documents and maps, can be inspected during office hours at Alpine Shire: Shire Offices, Churchill Avenue, Bright; Myrtleford Library, 156 Myrtle Street, Myrtleford; Mt Beauty Library, Lakeside Avenue, Mt Beauty, from 3 April 1997; Department of Infrastructure: Ground Floor, Olderfleet Buildings, 477 Collins Street, Melbourne; North Eastern Office, 1 McKoy Street, Wodonga and Alpine Resorts Commission, 36 Rutland Road, Box Hill.

Submissions about the Planning Scheme must be sent to Kirsten McDonald, Shire Planner, Alpine Shire, P.O. Box 139, Bright 3741, by Monday, 12 May 1997.

A submission may include a request that a State standard provision be included in or deleted from the Planning Scheme, but cannot request a change to the terms of any State standard provision.

Note: This notice is published in lieu of the Notice of Preparation of Planning Scheme published on 13 March 1997.

Alpine Shire, Churchill Avenue, Bright 3741, telephone 03 5755 0555, fax 03 5755 1811.

Creditors, next of kin and others having claims against the estate of any of the under-mentioned deceased persons are required to send particulars of their claims to State Trustees Limited A.C.N. 064 593 148, 168 Exhibition Street, Melbourne, Victoria 3000, the personal representative, on or before 3 June 1997, after which date State Trustees Limited may convey or distribute the assets having regard only to the claims of which State Trustees Limited then has notice.

Alderson, Mabel Jane, late of 18 Brentani Avenue, Elsternwick, pensioner, who died 3 February 1997.

Benson, James Samuel, late of Unit 8, 47 Middle Road, Maribyrnong, retired, who died 18 November 1996.

Chandler, Ellen, late of 23 Sixth Street, Parkdale, home duties, who died 28 September 1996.

Hackney, Samuel Vernon, late of Grace McKellar Centre, 95 Ballarat Road, North Geelong, pensioner, who died 14 August 1995.

Jack, Marjorie, late of Dromana Nursing Home, 77 Nepean Highway, Dromana, pensioner, who died 25 February 1997.

Seeley, Raymond John, late of Boyanda, 20 Lefoes Road, Bli Bli, Queensland, retired, who died 7 February 1997.

Dated at Melbourne 25 March 1997

J. L. OWEN
Manager, Estate Management
State Trustees Limited

EXEMPTION FROM NOTIFICATION OF
VACANCIES UNDER SECTION 29 (2) OF
THE PUBLIC SECTOR MANAGEMENT
ACT 1992

Position No. 48/25/9466/4, Clerk of Courts, Class VPS-2, Courts, Tribunals and Registries Division, Magistrates' Court Victoria, Department of Justice.

Reasons for exemption

The position has been reclassified from Trainee Clerk of Courts, Class VPS-1, to Clerk of Courts, Class VPS-2, in recognition of the incumbent attaining the qualification requirements for appointment to Clerk of Courts, Class VPS-2.

ALAN THOMPSON
Secretary to the Department of Justice

EXEMPTION FROM NOTIFICATION OF
VACANCY UNDER SECTION 29 (2) OF THE
PUBLIC SECTOR MANAGEMENT ACT
1992

The Secretary to the Department of Justice exempts the following position from the requirement to notify a vacancy:

Position No. 10/50/0104/1, Manager, Media/Public Relations, VPS-5, Victoria State Emergency Service, Department of Justice.

Reasons for exemption

The vacancy has duties and qualifications that are of a specialised nature peculiar to the Department and the proposed appointee is a staff member considered to be the only staff member possessing the specialised qualifications.

ALAN THOMPSON
Secretary to the Department of Justice

EXEMPTION FROM NOTIFICATION OF
VACANCY UNDER SECTION 29 (2) OF THE
PUBLIC SECTOR MANAGEMENT ACT
1992

The Secretary to the Department of Justice exempts the following position from the requirement to notify a vacancy:

Position No. 10/50/0118/7, Regional Officer, VPS-3, Victoria State Emergency Service, Department of Justice.

Reasons for exemption

The position has duties and qualifications identical to another vacancy that has been recently advertised and the person was an applicant for the other vacancy and was assessed as clearly meeting all the requirements of the position. The position should generally have been advertised in the last 3 months or in exceptional cases up to 6 months ago.

ALAN THOMPSON
Secretary to the Department of Justice

EXEMPTION FROM NOTIFICATION OF
VACANCY UNDER SECTION 29 (2) OF THE
PUBLIC SECTOR MANAGEMENT ACT
1992

Position No. 70/66/1983/7, Acute Health Division, Department of Human Services.

Reasons for exemption

The position has identical duties and qualifications to a position that was recently advertised and the person applied for the vacancy and was assessed as meeting the requirements of the position.

WARREN J. McCANN
Secretary
Department of Human Services

EXEMPTION FROM NOTIFICATION OF
VACANCY UNDER SECTION 29 (2) OF THE
PUBLIC SECTOR MANAGEMENT ACT
1992

Position No. 30/01/0483/5, Acute Health Division, Department of Human Services.

Reasons for exemption

The position has identical duties and qualifications to a position that was recently advertised and the person applied for the vacancy and was assessed as meeting the requirements of the position.

WARREN J. McCANN
Secretary
Department of Human Services

EXEMPTION FROM NOTIFICATION OF
VACANCY UNDER SECTION 29 (2) OF THE
PUBLIC SECTOR MANAGEMENT ACT
1992

Position No. 35/01/5329/7, Senior Business Analyst, VPS-5, Housing Division, Department of Human Services.

Reasons for exemption

The position has been reclassified in a specialised area of work and the officer is recognised as satisfactorily discharging all the requirements of the position and it is considered unlikely that advertising the position would attract a more suitable candidate.

WARREN J. McCANN
Secretary
Department of Human Services

Department of Treasury and Finance
SALE OF CROWN LAND BY PUBLIC
AUCTION

On Saturday, 26 April 1997 at 3.00 p.m. on site.

Address of Property: 7 Spensley Street, Clifton Hill.

Crown Description: Crown Allotments 1^A, Section 13, Parish of Jika Jika.

Terms of Sale: Deposit 10%, Balance 60 days.

Area: 532 m².

Officer Co-ordinating Sale: Andrew Martin, Victorian Government Property Group, Department of Treasury and Finance, 10/1 Macarthur Street, Melbourne, Victoria 3002.

Selling Agent: Nelson Alexander Pty Ltd, 205 Brunswick Street, Fitzroy, Victoria 3065.

ROGER M. HALLAM
Minister for Finance

Department of Treasury and Finance
SALE OF CROWN LAND BY PUBLIC
AUCTION

On Thursday, 24 April 1997 at 2.00 p.m., Leongatha Memorial Hall, Meeting Room 1, McCartin Street, Leongatha.

Address of Property: Hughes Street, Leongatha.

Crown Description: Crown Allotment 12^M, Parish of Leongatha.

Terms of Sale: Deposit 10%, balance 60 days.

Area: 1981 m².

Officer Co-ordinating Sale: Jenny Millett, Project Manager, Victorian Government Property Group, Department of Treasury and Finance, Level 10, 1 Macarthur Street, Melbourne, Victoria 3002.

Selling Agent: Shaun Cross Real Estate, 18 McCartin Street, Leongatha, Victoria 3953.

ROGER M. HALLAM
Minister for Finance

Department of Treasury and Finance
SALE OF CROWN LAND BY PUBLIC
AUCTION

On Thursday, 24 April 1997 at 2.00 p.m.,
Leongatha Memorial Hall, Meeting Room 1,
McCartin Street, Leongatha.

Address of Property: Hughes Street,
Leongatha.

Crown Description: Crown Allotment
12^N, Parish of Leongatha.

Terms of Sale: Deposit 10%, balance 60 days.

Area: 1399 m².

Officer Co-ordinating Sale: Jenny Millett, Project Manager, Victorian Government Property Group, Department of Treasury and Finance, Level 10, 1 Macarthur Street, Melbourne, Victoria 3002.

Selling Agent: Shaun Cross Real Estate, 18 McCartin Street, Leongatha, Victoria 3953.

ROGER M. HALLAM
Minister for Finance

Department of Treasury and Finance
SALE OF CROWN LAND BY PUBLIC
AUCTION

On Thursday, 24 April 1997 at 2.00 p.m.,
Leongatha Memorial Hall, Meeting Room 1,
McCartin Street, Leongatha.

Address of Property: Hughes Street,
Leongatha.

Crown Description: Crown Allotment
12^R, Parish of Leongatha.

Terms of Sale: Deposit 10%, balance 60 days.

Area: 1586 m².

Officer Co-ordinating Sale: Jenny Millett, Project Manager, Victorian Government Property Group, Department of Treasury and Finance, Level 10, 1 Macarthur Street, Melbourne, Victoria 3002.

Selling Agent: Shaun Cross Real Estate, 18 McCartin Street, Leongatha, Victoria 3953.

ROGER M. HALLAM
Minister for Finance

Department of Treasury and Finance
SALE OF CROWN LAND BY PUBLIC
AUCTION

Reference No.: 97/02397.

Auction Date: 29 April 1997 at 3.00 p.m.
on site.

Address of Property: Corner Laurens and
Ardens Streets, North Melbourne.

Crown Description: CA 3, Section 75B,
Parish of Jika Jika.

Area: 1.414 hectares.

Terms of Sale: 10% Deposit, Settlement
60 Days.

Agent: CVA Property Consultants, 175
Collins Street, Melbourne, Victoria 3000,
telephone 9654 2311.

Officer Co-ordinating Sale: Anna Brockhurst, Project Manager, Victorian Government Property Group, Department of Treasury and Finance.

ROGER M. HALLAM
Minister for Finance

Department of Treasury and Finance
SALE OF CROWN LAND BY PUBLIC
AUCTION

Lot 1: At 12.00 (noon), Saturday, 31 May
1997 on site.

Property Address: Corner Windle and
Steiglitz Street, Ballan.

Crown Description: Allotment 1A,
Section 16, Township of Ballan.

Area: 1014 square metres.

Reference: P140410.

Lot 2: At 12.30 p.m., Saturday, 31 May
1997 on site.

Property Address: Steiglitz Street, Ballan.

Crown Description: Allotment 1B, Section 16, Township of Ballan.

Area: 1018 square metres.

Reference: P144401.

Terms of Sale: 10% deposit—balance 60 days.

Co-ordinating Officer: Cclin Rogers, Land Sales Officer, Department of Natural Resources and Environment, 3/240 Victoria Parade, East Melbourne 3002.

Selling Agent: Greenwoods Marketing and Property, 111 Inglis Street, Ballan 3342, telephone (053) 681 706.

ROGER M. HALLAM
Minister for Finance

County Court Act 1958
ADDITIONAL COUNTY COURT SITTING
1997

Notice is given that the additional sittings of the County Court of Victoria will be held at Warrnambool to commence on Tuesday, 15 April 1997.

G. R. D. WALDRON
Chief Judge of the County Court of Victoria

Transport Act 1983
VICTORIAN TAXI DIRECTORATE
Department of Infrastructure
Commercial Passenger Vehicle Applications

Notice is hereby given that the following applications will be considered by the Victorian Taxi Directorate, a division of the Department of Infrastructure after 7 May 1997.

Notice of any objection to the granting of an application should be forwarded to reach the Manager, Licensing and Certification, Victorian Taxi Directorate, 598 Lygon Street, Carlton (P.O. Box 666, Carlton South 3053), not later than 1 May 1997.

Copies of objections are forwarded to the applicants.

It will not be necessary for interested parties to appear on the date specified, unless advised in writing by the Department.

P. S. Admiraal, Seaford. Application to license one commercial passenger vehicle in respect of a 1980 Mercedes sedan with seating capacity for 4 passengers to operate a service

from 3A Park Street, Seaford, for the carriage of passengers for wedding parties on the Mornington Peninsula.

Note: Applicant will operate in conjunction with E. Townsing, 13 Chicquita Avenue, Seaford.

B. S. Anderson and D. Hardiman, Eltham. Application to license one commercial passenger vehicle to be purchased in respect of a 1994 Toyota Tarago with seating capacity for 8 passengers to operate a service for the carriage of Japanese tourists on various tours to recognised tourist places of interest throughout the State of Victoria, where a Japanese driver/tour guide is an essential feature of the hiring.

Note: Passengers on various tours will be picked up/set down from hotels/motels throughout the State of Victoria.

Executive Limousine & Taxi Service Pty Ltd, Melbourne. Application to license three commercial passenger vehicles to be purchased in respect of any vehicle that meets the standards approved by the Victorian Taxi Directorate to operate as metropolitan hire cars from Suite 11, Albert Square, 37-39 Albert Road, Melbourne.

V. E. Mantel, Tooradin. Application to license one commercial passenger vehicle to be purchased in respect of a 1990-94 Mazda or Toyota bus with seating capacity for 18-22 passengers to operate a service from 65 Langtree Road, Tooradin, for the carriage of passengers on various tours to recognised tourist places of interest throughout the State of Victoria.

Note: Passengers on various tours will be picked up/set down throughout the State of Victoria.

B. Troise, Fawkner. Application to license one commercial passenger vehicle in respect of 1965 Ford Mustang coupe with seating capacity for 4 passengers to operate a service from 195 McBryde Street, Fawkner, for the carriage of models for photographic shoots/modelling work throughout the State of Victoria under contract to Edge Clothing, Highpoint Shopping Centre, Maribyrnong.

Dated 3 April 1997

ROBERT STONEHAM
Manager—Licensing and Certification
Victorian Taxi Directorate

Melbourne and Metropolitan Board of Works Act 1958
NOTICE OF DETERMINATION

In accordance with Section 239B (1AA)—(1AC) of the **Melbourne and Metropolitan Board of Works Act 1958** and with Section 139 (3A)—(3C) of the **Water Industry Act 1994** inserted by the **Water Industry (Amendment) Act 1995** the Valuer General has determined the following valuation equalisation factors. These factors, by which in the opinion of the Valuer General, the net annual value of land within the specified area or postcode determined, as at a particular date, ought to be multiplied if the net annual value of the land is to accord with levels of value generally prevailing in that area as at 30 June 1990.

<i>Postcode</i>	<i>Suburb or Area</i>	<i>Residential Equalisation Factor</i>	<i>Commercial Equalisation Factor</i>	<i>Industrial Equalisation Factor</i>
3067	ABBOTSFORD	0.95	1.13	1.14
3042	AIRPORT WEST	1.09	1.09	1.14
3147	ALAMEIN	0.93	1.03	1.09
3206	ALBERT PARK	0.86	1.51	1.39
3020	ALBION	1.11	1.09	1.15
3078	ALPHINGTON	0.93	1.13	1.21
3018	ALTONA	1.03	1.06	1.14
3028	ALTONA BAY	1.05	1.06	1.14
3025	ALTONA EAST	1.09	1.06	1.14
3028	ALTONA GREEN	1.05	1.06	1.14
3028	ALTONA MEADOWS	1.05	1.06	1.14
3025	ALTONA NORTH	1.09	1.06	1.14
3056	ANSTEY	0.96	1.06	1.21
3022	ARDEER	1.13	1.07	1.15
3143	ARMADALE	0.93	1.13	1.18
3143	ARMADALE NORTH	0.93	1.13	1.18
3099	ARTHURS CREEK	1.00	1.04	1.06
3936	ARTHURS SEAT	1.09	1.12	1.17
3032	ASCOT VALE	1.00	1.08	1.13
3147	ASHBURTON	0.93	1.03	1.09
3147	ASHWOOD	0.93	1.03	1.09
3195	ASPENDALE	1.04	1.04	1.19
3195	ASPENDALE GARDENS	1.04	1.04	1.19
3818	ATHLONE	0.98	1.00	1.00
3049	ATTWOOD	1.12	1.07	1.12
3123	AUBURN	0.94	1.03	1.09
3122	AUBURN SOUTH	0.95	1.03	1.09
3159	AURA	1.06	1.00	1.00
3084	AUSTIN HOSPITAL	0.96	1.07	1.13
3034	AVONDALE HEIGHTS	1.00	1.10	1.13
3340	BACCHUS MARSH	1.05	1.00	1.00
3777	BADGER CREEK	1.00	1.04	1.06
3183	BALACLAVA	0.92	1.13	1.19
3934	BALCOMBE	1.08	1.12	1.17
3340	BALLIANG	1.05	1.00	1.00
3340	BALLIANG EAST	1.05	1.00	1.00

<i>Postcode Suburb or Area</i>	<i>Residential Equalisation Factor</i>	<i>Commercial Equalisation Factor</i>	<i>Industrial Equalisation Factor</i>	
3926	BALNARRING	1.06	1.12	1.17
3926	BALNARRING BEACH	1.06	1.12	1.17
3927	BALNARRING EAST	1.07	1.12	1.17
3103	BALWYN	0.94	1.03	1.09
3129	BALWYN EAST	0.93	1.03	1.09
3104	BALWYN NORTH	0.95	1.03	1.09
3101	BALWYN WEST	0.96	1.03	1.09
3175	BANGHOLME	1.07	1.18	1.21
3084	BANYULE	0.96	1.07	1.13
3101	BARKER	0.96	1.03	1.09
3058	BATMAN	0.96	1.06	1.21
3911	BAXTER	1.04	1.06	1.11
3981	BAYLES	1.00	1.04	1.07
3153	BAYSWATER	1.05	1.06	1.19
3149	BAYVIEW	1.03	1.12	1.18
3807	BEACONSFIELD	1.03	1.04	1.07
3808	BEACONSFIELD UPPER	1.03	1.04	1.07
3193	BEAUMARIS	0.90	1.00	1.19
3139	BEENAK	1.04	1.00	1.00
3160	BELGRAVE	1.07	1.00	1.00
3072	BELL	1.03	1.13	1.21
3104	BELLEVUE	0.95	1.03	1.09
3081	BELFIELD	1.13	1.07	1.13
3037	BELLVUE	1.00	1.10	1.13
3125	BENNETSWOOD	0.92	1.03	1.09
3204	BENTLEIGH	0.93	1.13	1.19
3165	BENTLEIGH EAST	0.92	1.13	1.19
3806	BERWICK	1.06	1.06	1.11
3799	BIG PATS CREEK	1.06	1.00	1.00
3918	BITTERN	1.10	1.12	1.17
3150	BLACK FLAT	1.03	1.12	1.18
3193	BLACK ROCK	0.90	1.00	1.19
3193	BLACK ROCK NORTH	0.90	1.00	1.19
3797	BLACK SANDS	1.05	1.00	1.00
3140	BLACK SPRINGS	1.06	1.00	1.00
3130	BLACKBURN	1.06	1.12	1.15
3942	BLAIRGOWRIE	1.07	1.12	1.17
3980	BLIND BIGHT	1.00	1.06	1.11
3196	BONBEACH	1.06	1.04	1.19
3939	BONEO	1.11	1.12	1.17
3155	BORONIA	1.07	1.06	1.19
3128	BOX HILL	0.94	1.12	1.15
3129	BOX HILL NORTH	0.93	1.03	1.09
3919	BP WESTERN PORT	N/A	1.12	1.17

<i>Postcode</i>	<i>Suburb or Area</i>	<i>Residential Equalisation Factor</i>	<i>Commercial Equalisation Factor</i>	<i>Industrial Equalisation Factor</i>
3195	BRAESIDE	1.04	1.04	1.19
3170	BRANDON PARK	1.06	1.12	1.18
3821	BRANDY CREEK	0.98	1.00	1.00
3019	BRAYBROOK	1.19	1.11	1.15
3088	BRIAR HILL	1.02	1.04	1.06
3186	BRIGHTON	0.91	1.00	1.19
3186	BRIGHTON BEACH	0.91	1.00	1.19
3187	BRIGHTON EAST	0.90	1.00	1.19
3186	BRIGHTON NORTH	0.91	1.00	1.19
3797	BRITANNIA CREEK	1.05	1.00	1.00
3047	BROADMEADOWS	1.11	1.07	1.12
3025	BROOKLYN	1.14	1.11	1.15
3757	BRUCES CREEK	1.06	1.11	1.19
3056	BRUNSWICK	0.96	1.06	1.21
3057	BRUNSWICK EAST	0.96	1.06	1.21
3055	BRUNSWICK SOUTH	0.97	1.06	1.21
3055	BRUNSWICK WEST	0.97	1.06	1.21
3821	BULL SWAMP	0.98	1.00	1.00
3428	BULLA	1.08	1.07	1.12
3105	BULLEEN	1.06	1.03	1.12
3821	BULN BULN	0.98	1.00	1.00
3083	BUNDOORA	1.04	1.13	1.21
3815	BUNYIP	1.05	1.04	1.07
3795	BURLEIGH	1.03	1.00	1.00
3121	BURNLEY	0.89	1.06	1.14
3023	BURNSIDE	1.13	1.13	1.15
3136	BURNT BRIDGE	1.07	1.04	1.09
3125	BURWOOD	0.92	1.03	1.09
3151	BURWOOD EAST	0.95	1.12	1.15
3770	CAHILLTON	1.04	1.00	1.00
3984	CALDERMEADE	1.04	1.04	1.07
3124	CAMBERWELL	0.92	1.03	1.09
3061	CAMPBELLFIELD	1.11	1.07	1.12
3977	CANNONS CREEK	1.06	1.06	1.11
3126	CANTERBURY	0.95	1.03	1.09
3939	CAPE SCHANCK	1.12	1.12	1.17
3978	CARDINIA	1.06	1.04	1.07
3053	CARLTON (City of Melbourne)	0.97	1.14	1.09
3054	CARLTON NORTH (City of Melbourne)	0.95	1.18	1.12
3053	CARLTON SOUTH (City of Melbourne)	0.97	1.14	1.09
3163	CARNEGIE	0.98	1.13	1.19
3197	CARRUM	1.08	1.04	1.19
3201	CARRUM DOWNS	1.04	1.06	1.11

<i>Postcode Suburb or Area</i>	<i>Residential Equalisation Factor</i>	<i>Commercial Equalisation Factor</i>	<i>Industrial Equalisation Factor</i>
3777 CASTELLA	1.00	1.04	1.06
3981 CATANI	1.00	1.04	1.07
3162 CAULFIELD	0.97	1.13	1.19
3145 CAULFIELD EAST	0.97	1.13	1.18
3161 CAULFIELD NORTH	0.94	1.13	1.19
3162 CAULFIELD SOUTH	0.94	1.13	1.19
3145 CENTRAL PARK	0.97	1.13	1.18
3148 CHADMYR	1.06	1.12	1.18
3148 CHADSTONE	1.06	1.12	1.18
3030 CHARTWELL	1.00	1.00	1.00
3196 CHELSEA	1.06	1.04	1.19
3196 CHELSEA HEIGHTS	1.04	1.04	1.19
3192 CHELTENHAM	1.02	1.04	1.19
3192 CHELTENHAM EAST	1.02	1.04	1.19
3192 CHELTENHAM NORTH	1.02	1.04	1.19
3134 CHERRYDENE	1.06	1.03	1.12
3116 CHIRNSIDE PARK	1.05	1.00	1.00
3775 CHRISTMAS HILLS	1.00	1.04	1.06
3777 CHUM CREEK	1.00	1.04	1.06
3169 CLARINDA	1.04	1.04	1.19
3168 CLAYTON	1.04	1.12	1.18
3169 CLAYTON SOUTH	1.04	1.04	1.19
3175 CLEELAND	1.07	1.18	1.21
3782 CLEMATIS	1.04	1.04	1.07
3136 CLIFFORD PARK	1.07	1.04	1.09
3068 CLIFTON HILL	0.90	1.10	1.13
3978 CLYDE	1.03	1.06	1.11
3165 COATESVILLE	0.92	1.13	1.19
3058 COBURG	0.96	1.06	1.21
3781 COCKATOO	1.07	1.04	1.07
3770 COLDSTREAM	1.04	1.00	1.00
3066 COLLINGWOOD	0.95	1.09	1.16
3011 COODE ISLAND	N/A	N/A	1.20
3048 COOLAROO	1.12	1.07	1.12
3044 COONANS HILL	1.05	1.06	1.21
3814 CORA LYNN	1.05	1.04	1.07
3101 COTHAM	0.96	1.03	1.09
3099 COTTLES BRIDGE	1.00	1.04	1.06
3064 CRAIGIEBURN	1.09	1.07	1.12
3977 CRANBOURNE	1.06	1.06	1.11
3919 CRIB POINT	1.10	1.12	1.17
3193 CROMER	0.90	1.00	1.19
3821 CROSSEVER	0.98	1.00	1.00
3070 CROXTON	0.96	1.13	1.21
3136 CROYDON	1.07	1.04	1.09

<i>Postcode</i>	<i>Suburb or Area</i>	<i>Residential Equalisation Factor</i>	<i>Commercial Equalisation Factor</i>	<i>Industrial Equalisation Factor</i>
3047	DALLAS	1.11	1.07	1.12
3981	DALMORE	1.00	1.04	1.07
3175	DANDENONG	1.07	1.18	1.21
3175	DANDENONG EAST	1.07	1.18	1.21
3175	DANDENONG NORTH	1.07	1.18	1.21
3079	DAREBIN	0.91	1.07	1.13
3072	DAREBIN PARK ESTATE	1.06	1.13	1.21
3145	DARLING	0.97	1.13	1.18
3145	DARLING SOUTH	0.97	1.13	1.18
3103	DEEPDENE	0.94	1.03	1.09
3023	DEER PARK	1.17	1.13	1.15
3038	DELAHEY	1.00	1.10	1.13
3186	DENDY	0.91	1.00	1.19
3070	DENNIS	0.96	1.13	1.21
3030	DERRIMUT	1.06	1.09	1.16
3977	DEVON MEADOWS	1.06	1.06	1.11
3089	DIAMOND CREEK	1.07	1.07	1.13
3096	DIAMOND CREEK UPPER	1.03	1.04	1.06
3427	DIGGERS REST	1.08	1.06	1.14
3172	DINGLEY	1.00	1.04	1.19
3775	DIXONS CREEK	1.00	1.04	1.06
3141	DOMAIN	0.94	1.13	1.18
3108	DONCASTER	1.04	1.03	1.12
3109	DONCASTER EAST	1.03	1.03	1.12
3064	DONNYBROOK	1.09	1.07	1.12
3111	DONVALE	1.05	1.03	1.12
3139	DONVALLEY	1.04	1.00	1.00
3754	DOREEN	1.04	1.11	1.19
3177	DOVETON	1.11	1.06	1.11
3099	DREAMVILLE	1.00	1.04	1.06
3936	DROMANA	1.09	1.12	1.17
3818	DROUIN	0.98	1.00	1.00
3175	DUNEARN	1.07	1.18	1.21
3084	EAGLEMONT	0.96	1.07	1.13
3135	EASTWOOD	1.06	1.04	1.09
3757	EDEN PARK	1.06	1.11	1.19
3196	EDITHVALE	1.06	1.04	1.19
3127	ELGAR PARK	0.94	1.03	1.09
3821	ELLINBANK	0.98	1.00	1.00
3185	ELSTERNWICK	0.92	1.00	1.19
3095	ELTHAM	1.05	1.04	1.06
3184	ELWOOD	0.86	1.51	1.39
3782	EMERALD	1.05	1.04	1.07
3802	ENDEAVOUR HILLS	1.04	1.06	1.11
3076	EPPING	1.07	1.11	1.19

<i>Postcode Suburb or Area</i>	<i>Residential Equalisation Factor</i>	<i>Commercial Equalisation Factor</i>	<i>Industrial Equalisation Factor</i>
3797 ERREYS	1.05	1.00	1.00
3040 ESSENDON	0.96	1.08	1.12
3041 ESSENDON NORTH	0.96	1.08	1.12
3177 EUMEMMERRING	1.11	1.06	1.11
3078 FAIRFIELD	0.93	1.13	1.21
3079 FAIRY HILLS	0.91	1.07	1.13
3043 FARM RIDGE	1.08	1.07	1.12
3127 FAVERSHAM	0.94	1.03	1.09
3060 FAWKNER	1.08	1.07	1.12
3046 FAWKNER WEST	1.08	1.06	1.21
3047 FENTONA	1.11	1.07	1.12
3156 FERNTREE GULLY	1.03	1.06	1.19
3156 FERNTREE GULLY UPPER	1.03	1.06	1.19
3786 FERNY CREEK	1.05	1.00	1.00
3207 FISHERMENS BEND (City of Melbourne)	N/A	2.32	1.57
3065 FITZROY	0.93	1.06	1.12
3068 FITZROY NORTH	0.90	1.10	1.13
3977 FIVE WAYS	1.06	1.06	1.11
3031 FLEMINGTON (City of Melbourne)	0.93	1.35	1.16
3031 FLEMINGTON (City of Moonee Valley)	1.00	1.08	1.13
3929 FLINDERS	1.04	1.12	1.17
3920 FLINDERS NAVAL YARD	N/A	N/A	1.17
3012 FOOTSCRAY WEST	1.00	1.07	1.00
3011 FOOTSCRAY (Melbourne)	N/A	1.07	1.20
3011 FOOTSCRAY (Maribyrnong)	0.98	1.07	1.00
3131 FOREST HILL	1.00	1.03	1.12
3104 FORTUNA	0.95	1.03	1.09
3805 FOUNTAIN GATE	1.03	1.06	1.11
3199 FRANKSTON	1.11	1.10	1.17
3199 FRANKSTON EAST	1.11	1.10	1.17
3200 FRANKSTON NORTH	1.12	1.10	1.17
3199 FRANKSTON SOUTH	1.11	1.10	1.17
3126 FROGNALL RAAF	0.95	1.03	1.09
3207 GARDEN CITY	0.88	1.51	1.39
3185 GARDENVALE	0.92	1.00	1.19
3146 GARDINER	0.94	1.03	1.09
3814 GARFIELD	1.05	1.04	1.07
3783 GEMBROOK	1.02	1.04	1.07
3073 GILBANK	1.06	1.13	1.21
3072 GILBERTON	1.06	1.13	1.21
3797 GILDEROY	1.05	1.00	1.00
3043 GLADSTONE PARK	1.08	1.07	1.12

<i>Postcode Suburb or Area</i>	<i>Residential Equalisation Factor</i>	<i>Commercial Equalisation Factor</i>	<i>Industrial Equalisation Factor</i>
3797 GLADYSDALE	1.05	1.00	1.00
3146 GLEN IRIS	0.94	1.03	1.09
3146 GLEN IRIS UPPER	0.94	1.03	1.09
3095 GLEN PARK (ELTHAM)	1.05	1.04	1.06
3150 GLEN WAVERLEY	1.03	1.12	1.18
3122 GLENFERRIE	0.95	1.03	1.09
3163 GLENHUNTLY	0.99	1.13	1.19
3046 GLENROY	1.08	1.06	1.21
3757 GLENVALE	1.06	1.11	1.19
3060 GOWRIE	1.08	1.07	1.12
3088 GRACE PARK	1.02	1.07	1.13
3207 GRAHAM	0.88	1.51	1.39
3088 GREEN HILLS (GREENSBOROUGH)	1.02	1.07	1.13
3088 GREENSBOROUGH	1.02	1.07	1.13
3059 GREENVALE	1.04	1.07	1.12
3083 GREENWOOD VILLAGE	1.04	1.13	1.21
3104 GREYTHORN	0.95	1.03	1.09
3770 GRUYERE	1.04	1.00	1.00
3807 GUYS HILL	1.05	1.04	1.07
3046 HADFIELD	1.08	1.06	1.21
3803 HALLAM	1.00	1.06	1.11
3188 HAMPTON	0.93	1.00	1.19
3188 HAMPTON EAST	0.93	1.00	1.19
3188 HAMPTON NORTH	0.93	1.00	1.19
3976 HAMPTON PARK	1.02	1.06	1.11
3806 HARKAWAY	1.06	1.06	1.11
3174 HARRISFIELD	1.12	1.18	1.21
3125 HARTWELL VIA BURWOOD	0.92	1.03	1.09
3124 HARTWELL VIA CAMBERWELL	0.92	1.03	1.09
3915 HASTINGS	1.07	1.12	1.17
3142 HAWKSBURN	0.96	1.13	1.18
3122 HAWTHORN	0.95	1.03	1.09
3123 HAWTHORN EAST	0.94	1.03	1.09
3123 HAWTHORN UPPER	0.94	1.03	1.09
3754 HAZEL GLEN	1.04	1.11	1.19
3777 HEALESVILLE	1.00	1.04	1.06
3202 HEATHERTON	1.02	1.04	1.19
3135 HEATHMONT	1.06	1.04	1.09
3084 HEIDELBERG	0.96	1.07	1.13
3081 HEIDELBERG HEIGHTS	1.13	1.07	1.13
3081 HEIDELBERG NORTH	1.13	1.07	1.13
3081 HEIDELBERG REPAT. HOSPITAL	1.13	1.07	1.13
3081 HEIDELBERG WEST	1.13	1.07	1.13
3142 HEYINGTON	0.96	1.13	1.18

<i>Postcode Suburb or Area</i>	<i>Residential Equalisation Factor</i>	<i>Commercial Equalisation Factor</i>	<i>Industrial Equalisation Factor</i>
3149 HIGHBURY VIEW	1.03	1.12	1.18
3190 HIGHETT	0.99	1.04	1.19
3124 HIGHFIELD PARK	0.92	1.03	1.09
3037 HILLSIDE	1.00	1.10	1.13
3920 HMAS CERBERUS	N/A	N/A	1.17
3139 HODDLES CREEK	1.04	1.00	1.00
3148 HOLMESGLEN	1.06	1.12	1.18
3185 HOPETOUN GARDENS	0.92	1.00	1.19
3029 HOPPERS CROSSING	1.03	1.09	1.16
3128 HOUSTON	0.94	1.12	1.15
3166 HUGHESDALE VIA OAKLEIGH	1.04	1.12	1.18
3757 HUMEVALE	1.06	1.11	1.19
3166 HUNTINGDALE	1.04	1.12	1.18
3099 HURSTBRIDGE	1.00	1.04	1.06
3815 IONA	1.04	1.04	1.07
3079 IVANHOE	0.91	1.07	1.13
3047 JACANA	1.11	1.07	1.12
3083 JANEFIELD	1.04	1.13	1.21
3056 JEWELL	0.96	1.06	1.21
3818 JINDIVICK	0.98	1.00	1.00
3002 JOLIMONT	1.06	1.40	1.40
3148 JORDANVILLE	1.06	1.12	1.18
3148 JORDANVILLE SOUTH	1.06	1.12	1.18
3198 KAKAKOOK	1.12	1.10	1.17
3064 KALKALLO	1.09	1.07	1.12
3791 KALLISTA	1.05	1.00	1.00
3766 KALORAMA	1.04	1.00	1.00
3097 KANGAROO GROUND	0.97	1.04	1.06
3199 KARINGAL	1.11	1.10	1.17
3021 KEALBA	1.07	1.10	1.13
3036 KEILOR	1.03	1.10	1.13
3038 KEILOR DOWNS	1.03	1.10	1.13
3033 KEILOR EAST	1.02	1.10	1.13
3038 KEILOR LODGE	1.00	1.06	1.11
3036 KEILOR NORTH	1.04	1.10	1.13
3042 KEILOR PARK	1.03	1.10	1.13
3031 KENSINGTON (City of Melbourne)	0.93	1.35	1.16
3073 KEON PARK	1.06	1.13	1.21
3129 KERRIMUIR	0.93	1.03	1.09
3101 KEW	0.96	1.03	1.09
3102 KEW EAST	0.96	1.03	1.09
3101 KEW NORTH	0.96	1.03	1.09
3173 KEYSBOROUGH	1.09	1.18	1.21
3139 KILLARA	1.04	1.00	1.00

<i>Postcode</i>	<i>Suburb or Area</i>	<i>Residential Equalisation Factor</i>	<i>Commercial Equalisation Factor</i>	<i>Industrial Equalisation Factor</i>
3137	KILSYTH	1.06	1.04	1.09
3757	KINGLAKE CENTRAL	1.06	1.11	1.19
3757	KINGLAKE WEST	1.06	1.11	1.19
3021	KINGS PARK	1.11	1.10	1.13
3083	KINGSBURY	1.04	1.13	1.21
3130	KINKUNA	1.06	1.12	1.15
3180	KNOX PARK	1.05	1.06	1.19
3180	KNOXFIELD	1.05	1.06	1.19
3981	KOO WEE RUP	1.00	1.04	1.07
3129	KOONUNG	0.93	1.03	1.09
3144	KOONYONG	0.94	1.13	1.18
3816	LABERTOUCHE	0.98	1.00	1.00
3130	LABURNUM	1.06	1.12	1.15
3075	LALOR	1.09	1.11	1.19
3984	LANG LANG	1.04	1.04	1.07
3910	LANGWARRIN	1.04	1.06	1.11
3821	LARDNER	0.98	1.00	1.00
3083	LARUNDEL	1.04	1.13	1.21
3083	LATROBE UNIVERSITY	1.04	1.13	1.21
3139	LAUNCHING PLACE	1.04	1.00	1.00
3028	LAVERTON	1.13	1.08	1.16
3026	LAVERTON NORTH	1.13	1.08	1.16
3027	LAVERTON RAAF	1.00	1.00	1.00
3028	LAVERTON SOUTH	1.13	1.08	1.16
3199	LEAWARRA	1.11	1.10	1.17
3140	LILYDALE	1.06	1.00	1.00
3754	LINTON GRANGE	1.04	1.11	1.19
3211	LITTLE RIVER	1.08	1.09	1.16
3816	LONGWARRY	0.98	1.00	1.00
3816	LONGWARRY EAST	0.98	1.00	1.00
3816	LONGWARRY SOUTH	0.98	1.00	1.00
3093	LOWER PLENTY	1.00	1.07	1.13
3107	LOWER TEMPLESTOWE	1.02	1.03	1.12
3175	LYNDALE	1.07	1.18	1.21
3975	LYNDHURST	1.02	1.06	1.11
3777	LYNTORS	1.00	1.04	1.06
3156	LYSTERFIELD	1.03	1.06	1.19
3085	MACLEOD	1.00	1.07	1.13
3012	MAIDSTONE	1.04	1.08	1.12
3928	MAIN RIDGE	1.14	1.12	1.17
3144	MALVERN	0.94	1.13	1.18
3145	MALVERN EAST	0.97	1.13	1.18
3032	MARIBYRNONG	1.05	1.08	1.12
3777	MAROONDAH RESERVOIR	1.00	1.04	1.06

<i>Postcode</i>	<i>Suburb or Area</i>	<i>Residential Equalisation Factor</i>	<i>Commercial Equalisation Factor</i>	<i>Industrial Equalisation Factor</i>
3812	MARYKNOLL	1.06	1.04	1.07
3938	MCCRAE	1.09	1.12	1.17
3796	MCKILLOP	1.05	1.00	1.00
3204	MCKINNON	0.97	1.13	1.19
3799	MCMAHONS CREEK	1.06	1.00	1.00
3047	MEADOW FAIR	1.11	1.07	1.12
3000	MELBOURNE	1.06	2.32	1.57
3004	MELBOURNE	1.06	2.32	1.57
3045	MELBOURNE AIRPORT	N/A	1.07	1.12
3002	MELBOURNE EAST	1.06	1.40	1.40
3051	MELBOURNE NORTH (City of Melbourne)	1.03	1.57	1.30
3051	MELBOURNE NORTH (Moonee Valley)	1.00	1.08	1.12
3205	MELBOURNE SOUTH	0.89	1.51	1.39
3003	MELBOURNE WEST	1.02	1.93	1.69
3337	MELTON	1.13	1.06	1.16
3338	MELTON SOUTH	1.13	1.06	1.16
3337	MELTON WEST	1.10	1.06	1.16
3194	MENTONE	1.00	1.04	1.19
3194	MENTONE EAST	1.00	1.04	1.19
3159	MENZIES CREEK	1.06	1.00	1.00
3058	MERLYNSTON	0.96	1.06	1.21
3754	MERNDA	1.04	1.11	1.19
3068	MERRI	0.90	1.10	1.13
3916	MERRICKS	1.06	1.12	1.17
3926	MERRICKS NORTH	1.06	1.12	1.17
3064	MICKLEHAM	1.09	1.07	1.12
3124	MIDDLE CAMBERWELL	0.92	1.03	1.09
3206	MIDDLE PARK	0.86	1.51	1.39
3099	MIDHURST	1.00	1.04	1.06
3082	MILL PARK	1.05	1.11	1.19
3799	MILLGROVE	1.06	1.00	1.00
3132	MITCHAM	1.05	1.03	1.12
3816	MODELLA	0.98	1.00	1.00
3168	MONASH UNIVERSITY	1.04	1.12	1.18
3170	MONASHVILLE	1.06	1.12	1.18
3793	MONBULK	1.03	1.00	1.00
3984	MONOMEITH	1.04	1.04	1.07
3127	MONT ALBERT	0.94	1.03	1.09
3085	MONT PARK	1.00	1.07	1.13
3205	MONTAGUE (City of Melbourne)	0.89	2.32	1.57
3094	MONTMORENCY	1.03	1.07	1.13
3765	MONTROSE	1.04	1.00	1.00

<i>Postcode</i>	<i>Suburb or Area</i>	<i>Residential Equalisation Factor</i>	<i>Commercial Equalisation Factor</i>	<i>Industrial Equalisation Factor</i>
3060	MOOMBA PARK	1.08	1.07	1.12
3039	MOONEE PONDS	0.89	1.11	1.14
3189	MOORABBIN	0.98	1.04	1.19
3194	MOORABBIN AIRPORT	N/A	1.04	1.19
3189	MOORABBIN EAST	0.98	1.04	1.19
3933	MOOROODUC	1.09	1.10	1.17
3138	MOOROOLBARK	1.06	1.04	1.09
3195	MORDIALLOC	1.04	1.04	1.19
3195	MORDIALLOC NORTH	1.04	1.04	1.19
3058	MORELAND	0.96	1.06	1.21
3057	MORELAND EAST	0.96	1.06	1.21
3058	MORELAND WEST	0.96	1.06	1.21
3037	MORETON	1.00	1.10	1.13
3931	MORNINGTON	1.06	1.12	1.17
3799	MOUNT DONNA BUANG	1.06	1.00	1.00
3156	MOUNTAIN GATE	1.03	1.06	1.19
3988	MOUNTAIN VIEW	1.00	1.00	1.00
3767	MT DANDENONG	1.07	1.00	1.00
3930	MT ELIZA	1.11	1.12	1.17
3796	MT EVELYN	1.05	1.00	1.00
3934	MT MARTHA	1.08	1.12	1.17
3149	MT WAVERLEY	1.03	1.12	1.18
3170	MULGRAVE	1.06	1.12	1.18
3163	MURRUMBEENA	0.98	1.13	1.19
3777	MYERS CREEK	1.00	1.04	1.06
3812	NAR NAR GOON	1.06	1.04	1.07
3805	NARRE WARREN	1.03	1.06	1.11
3804	NARRE WARREN EAST	1.06	1.06	1.11
3804	NARRE WARREN NORTH	1.06	1.06	1.11
3804	NARRE WARREN SOUTH	1.06	1.06	1.11
3793	NATHANIA SPRINGS	1.03	1.00	1.00
3821	NAYOOK	0.98	1.00	1.00
3797	NAYOOK WEST	1.05	1.00	1.00
3831	NEERIM	0.98	1.00	1.00
3821	NEERIM JUNCTION	0.98	1.00	1.00
3831	NEERIM SOUTH	0.98	1.00	1.00
3136	NELSONS HILL	1.07	1.04	1.09
3058	NEWLANDS ESTATE	0.96	1.06	1.21
3015	NEWPORT	0.93	1.09	1.14
3042	NIDDRIE	1.00	1.09	1.12
3174	NOBLE PARK	1.12	1.18	1.21
3174	NOBLE PARK EAST	1.12	1.18	1.21
3070	NORTHCOTE	0.96	1.13	1.21
3072	NORTHLAND CENTRE	1.06	1.13	1.21

<i>Postcode</i>	<i>Suburb or Area</i>	<i>Residential Equalisation Factor</i>	<i>Commercial Equalisation Factor</i>	<i>Industrial Equalisation Factor</i>
3134	NORWOOD	1.06	1.03	1.12
3168	NOTTING HILL VIA CLAYTON	1.04	1.12	1.18
3149	NOTTING HILL VIA MT WAVERLEY	1.04	1.12	1.18
3175	NOVAR	1.07	1.18	1.21
3131	NUNAWADING	1.00	1.03	1.12
3099	NUTFIELD	1.00	1.04	1.06
3987	NYORA	1.00	1.00	1.00
3799	O'SHANNESYS WEIR	1.06	1.00	1.00
3046	OAK PARK	1.08	1.07	1.12
3166	OAKLEIGH	1.04	1.12	1.18
3166	OAKLEIGH EAST	1.04	1.12	1.18
3167	OAKLEIGH SOUTH	1.04	1.12	1.18
3175	OAKWOOD PARK	1.07	1.18	1.21
3809	OFFICER	1.06	1.04	1.07
3788	OLINDA	1.06	1.00	1.00
3786	ONE TREE HILL	1.05	1.00	1.00
3204	ORMOND	0.95	1.13	1.19
3204	ORMOND EAST	0.95	1.13	1.19
3934	OSBORNE	1.08	1.12	1.17
3810	PAKENHAM	1.03	1.04	1.07
3810	PAKENHAM UPPER	1.03	1.04	1.07
3759	PANTON HILL	1.02	1.04	1.06
3114	PARK ORCHARDS	1.04	1.03	1.12
3195	PARKDALE	1.04	1.04	1.19
3131	PARKMORE	1.00	1.03	1.12
3052	PARKVILLE	1.00	1.13	1.03
3139	PARSLOW	1.04	1.00	1.00
3044	PASCOE VALE	1.05	1.06	1.21
3189	PATTERSON	0.98	1.04	1.19
3197	PATTERSON LAKES	1.00	1.04	1.19
3912	PEARCEDALE	1.04	1.06	1.11
3071	PENDER	1.03	1.13	1.21
3192	PENNYDALE	1.02	1.04	1.19
3168	PETERSVILLE	1.04	1.12	1.18
3757	PHEASANT CREEK	1.06	1.11	1.19
3149	PINEWOOD	1.03	1.12	1.18
3090	PLENTY	1.00	1.04	1.06
3030	POINT COOK	1.06	1.09	1.16
3030	POINT COOK RAAF	1.06	1.09	1.16
3916	POINT LEO	1.06	1.12	1.17
3944	POINT NEPEAN	1.13	1.12	1.17
3988	POOWONG	1.00	1.00	1.00
3207	PORT MELBOURNE	0.88	1.51	1.39

<i>Postcode</i>	<i>Suburb or Area</i>	<i>Residential Equalisation Factor</i>	<i>Commercial Equalisation Factor</i>	<i>Industrial Equalisation Factor</i>
	PORT OF MELBOURNE	N/A	N/A	1.20
3944	PORTSEA	1.13	1.12	1.17
3797	POWELLTOWN	1.05	1.00	1.00
3181	PRAHRAN	0.94	1.13	1.18
3181	PRAHRAN EAST	0.94	1.13	1.18
3072	PRESTON	1.06	1.13	1.21
3797	QUONGUP	1.05	1.00	1.00
3951	RANCEBY	0.97	1.00	1.00
3132	RANGEVIEW	1.05	1.03	1.12
3023	RAVENHALL	1.17	1.13	1.15
3937	RED HILL	1.10	1.12	1.17
3937	RED HILL SOUTH	1.10	1.12	1.17
3799	REEFTON	1.06	1.00	1.00
3073	REGENT	1.06	1.13	1.21
3095	RESEARCH	1.05	1.04	1.06
3073	RESERVOIR	1.06	1.13	1.21
3799	RICHARDS MILL	1.06	1.00	1.00
3121	RICHMOND	0.89	1.06	1.13
3134	RINGWOOD	1.06	1.03	1.12
3135	RINGWOOD EAST	1.06	1.04	1.09
3818	RIPPLEBROOK	0.98	1.00	1.00
3183	RIPPONLEA	0.92	1.13	1.19
3124	RIVERSDALE	0.92	1.03	1.09
3139	ROBERTSONS CAMP	1.04	1.00	1.00
3818	ROBIN HOOD	0.98	1.00	1.00
3335	ROCKBANK	1.13	1.00	1.00
3818	ROKEBY	0.98	1.00	1.00
3084	ROSANNA	0.96	1.07	1.13
3939	ROSEBUD	1.15	1.12	1.17
3940	ROSEBUD WEST	1.15	1.12	1.17
3178	ROWVILLE	1.06	1.06	1.19
3050	ROYAL MELBOURNE HOSPITAL	1.00	1.13	1.03
3068	RUSHALL	0.90	1.10	1.13
3073	RUTHVEN	1.06	1.13	1.21
3941	RYE	1.13	1.12	1.17
3810	RYTHDALE	1.03	1.04	1.07
3936	SAFETY BEACH	1.11	1.12	1.17
3171	SANDOWN VILLAGE	1.09	1.18	1.21
3191	SANDRINGHAM	0.90	1.00	1.19
3787	SASSAFRAS	1.07	1.00	1.00
3787	SASSAFRAS GULLY	1.07	1.00	1.00
3791	SASSAFRAS SOUTH	1.05	1.00	1.00
3799	SAWMILL SETTLEMENT	1.06	1.00	1.00
3179	SCORESBY	1.04	1.06	1.19

<i>Postcode Suburb or Area</i>	<i>Residential Equalisation Factor</i>	<i>Commercial Equalisation Factor</i>	<i>Industrial Equalisation Factor</i>
3799 SCOTCHMANS CREEK	1.06	1.00	1.00
3198 SEAFORD	1.12	1.10	1.17
3011 SEDDON	0.98	1.07	1.00
3159 SELBY	1.06	1.00	1.00
3139 SEVILLE	1.04	1.00	1.00
3126 SHENLEY	0.95	1.03	1.09
3789 SHERBROOKE	1.05	1.00	1.00
3916 SHOREHAM	1.06	1.12	1.17
3795 SILVAN	1.03	1.00	1.00
3977 SKYE	1.06	1.10	1.17
3147 SOLWAY	0.93	1.03	1.09
3927 SOMERS	1.07	1.12	1.17
3062 SOMERTON	1.07	1.07	1.12
3912 SOMERVILLE	1.04	1.12	1.17
3943 SORRENTO	1.11	1.12	1.17
3752 SOUTH MORANG	1.04	1.11	1.19
3141 SOUTH YARRA (City of Melbourne)	1.07	2.32	1.57
3141 SOUTH YARRA (City of Stonnington)	0.94	1.13	1.18
3205 SOUTH BANK (City of Melbourne)	1.01	1.54	1.41
3015 SPOTSWOOD	1.00	1.08	1.15
3171 SPRINGVALE	1.09	1.18	1.21
3172 SPRINGVALE SOUTH	1.09	1.18	1.21
3021 ST ALBANS	1.11	1.10	1.13
3021 ST ALBANS EAST	1.11	1.10	1.13
3088 ST HELENA	1.02	1.07	1.13
3182 ST KILDA	0.88	1.51	1.39
3183 ST KILDA EAST	0.87	1.51	1.39
3004 ST KILDA RD (City of Melbourne)	1.05	2.06	N/A
3205 ST KILDA RD (City of Port Phillip)	1.16	1.80	N/A
3182 ST KILDA SOUTH	0.88	1.51	1.39
3182 ST KILDA WEST	0.89	1.51	1.39
3799 STARVATION CREEK	1.06	1.00	1.00
3775 STEELS CREEK	1.00	1.04	1.06
3147 STOCKSVILLE	0.93	1.03	1.09
3919 STONEY POINT	1.10	1.12	1.17
3102 STRADBROKE PARK	0.96	1.03	1.09
3099 STRATHEWEN	1.00	1.04	1.06
3041 STRATHMORE	0.94	1.08	1.15
3041 STRATHMORE HEIGHTS	0.94	1.08	1.15
3152 STUDFIELD	1.06	1.06	1.19
3101 STUDLEY PARK	0.96	1.03	1.09
3057 SUMNER	0.96	1.06	1.21
3429 SUNBURY	1.09	1.07	1.12
3020 SUNSHINE	1.11	1.09	1.15

<i>Postcode</i>	<i>Suburb or Area</i>	<i>Residential Equalisation Factor</i>	<i>Commercial Equalisation Factor</i>	<i>Industrial Equalisation Factor</i>
3020	SUNSHINE NORTH	1.12	1.09	1.15
3127	SURREY HILLS	0.94	1.03	1.09
3038	SYDENHAM	1.00	1.06	1.11
3072	SYLVESTER	1.06	1.13	1.21
3150	SYNDAL	1.03	1.12	1.18
3150	SYNDAL EAST	1.03	1.12	1.18
3150	SYNDAL VIA GLEN WAVERLEY	1.03	1.12	1.18
3149	SYNDAL VIA MT WAVERLEY	1.03	1.12	1.18
3149	TALLY HO	1.03	1.12	1.18
3775	TANANA	1.00	1.04	1.06
3089	TANKS CORNER	1.07	1.07	1.13
3931	TANTI PARK	1.06	1.12	1.17
3818	TARAGO	0.98	1.00	1.00
3029	TARNEIT	1.03	1.09	1.16
3775	TARRAWARRA	1.00	1.04	1.06
3038	TAYLORS LAKES	1.05	1.06	1.11
3160	TECOMA	1.07	1.00	1.00
3106	TEMPLESTOWE	1.04	1.03	1.12
3107	TEMPLESTOWE HEIGHTS	1.02	1.03	1.12
3107	TEMPLESTOWE WEST	1.02	1.03	1.12
3154	THE BASIN	1.05	1.06	1.19
3777	THE LANDING	1.00	1.04	1.06
3792	THE PATCH	1.04	1.00	1.00
3074	THOMASTOWN	1.07	1.11	1.19
3799	THOMSON UPPER	1.06	1.00	1.00
3071	THORNBURY	1.03	1.13	1.21
3797	THREE BRIDGES	1.05	1.00	1.00
3757	TOMMYS HUT	1.06	1.11	1.19
3815	TONIMBUK	1.05	1.04	1.07
3777	TOOLANGI	1.00	1.04	1.06
3810	TOOMUC VALLEY	1.03	1.04	1.07
3980	TOORADIN	1.10	1.06	1.11
3977	TOORADIN NORTH	1.06	1.10	1.17
3142	TOORAK	0.96	1.13	1.18
3146	TOORONGA VIA GLEN IRIS	0.94	1.03	1.09
3144	TOORONGA VIA MALVERN	0.94	1.13	1.18
3941	TOOTGAROOK	1.14	1.12	1.17
3988	TOPIRAM	1.00	1.00	1.00
3012	TOTTENHAM	1.19	1.08	1.15
3785	TREMONT	1.04	1.00	1.00
3104	TRENTWOOD	0.95	1.03	1.09
3030	TRUGANINA	1.06	1.09	1.16
3043	TULLAMARINE	1.08	1.07	1.12
3131	TUNSTALL	1.00	1.03	1.12

<i>Postcode</i>	<i>Suburb or Area</i>	<i>Residential Equalisation Factor</i>	<i>Commercial Equalisation Factor</i>	<i>Industrial Equalisation Factor</i>
3109	TUNSTALL SQUARE	1.03	1.03	1.12
3913	TYABB	1.07	1.12	1.17
3813	TYNONG	1.05	1.04	1.07
3047	UPFIELD	1.11	1.07	1.12
3158	UPWEY	1.04	1.00	1.00
3133	VERMONT	1.06	1.04	1.09
3814	VERVALE	1.05	1.04	1.07
3084	VIEW BANK	0.96	1.07	1.13
3757	WALLABY CREEK	1.06	1.11	1.19
3799	WALSHS CREEK	1.06	1.00	1.00
3139	WANDIN	1.04	1.00	1.00
3139	WANDIN YALLOCK	1.04	1.00	1.00
3152	WANTIRNA	1.07	1.06	1.19
3152	WANTIRNA SOUTH	1.07	1.06	1.19
3799	WARBURTON	1.06	1.00	1.00
3139	WARBURTON WEST	1.04	1.00	1.00
3980	WARNEET	1.10	1.06	1.11
3820	WARRAGUL	0.98	1.00	1.00
3139	WARRAMATE	1.04	1.00	1.00
3113	WARRANTDYTE	1.04	1.03	1.12
3134	WARRANTDYTE SOUTH	1.06	1.03	1.12
3134	WARRANWOOD	1.06	1.03	1.12
3087	WATSONIA	1.05	1.07	1.13
3085	WATSONIA MILITARY CAMP	1.00	1.07	1.13
3097	WATSONS CREEK	0.97	1.04	1.06
3096	WATTLE GLEN	1.03	1.04	1.06
3127	WATTLE PARK VIA SURREY HILLS	0.94	1.03	1.09
3030	WERRIBEE	1.06	1.09	1.16
3030	WERRIBEE SOUTH	1.06	1.09	1.16
3799	WESBURN	1.06	1.00	1.00
3169	WESTALL	1.04	1.04	1.19
3044	WESTBREEN	1.05	1.06	1.21
3168	WESTERFIELD	1.04	1.12	1.18
3028	WESTERN GARDENS	1.00	1.09	1.16
3070	WESTGARTH	0.96	1.13	1.21
3049	WESTMEADOWS	1.12	1.07	1.12
3150	WHEELERS HILL	1.03	1.12	1.18
3757	WHITTLESEA	1.06	1.11	1.19
3016	WILLIAMSTOWN	0.88	1.06	1.07
3016	WILLIAMSTOWN NORTH	0.92	1.06	1.07
3181	WINDSOR	0.85	1.13	1.18
3189	WISHART	0.98	1.04	1.19
3115	WONGA PARK	1.03	1.03	1.12
3139	WOORI YALLOCK	1.04	1.00	1.00

<i>Postcode Suburb or Area</i>	<i>Residential Equalisation Factor</i>	<i>Commercial Equalisation Factor</i>	<i>Industrial Equalisation Factor</i>
3005 WORLD TRADE CENTRE	N/A	1.18	N/A
3024 WYNDHAM VALE	1.08	1.09	1.16
3085 YALLAMBIE	1.00	1.07	1.13
3755 YAN YEAN	1.04	1.11	1.19
3754 YAN YEAN SOUTH	1.04	1.11	1.19
3981 YANNATHAN	1.00	1.04	1.07
3068 YARRA BEND	0.90	1.10	1.13
3799 YARRA DAM UPPER	1.06	1.00	1.00
3775 YARRA GLEN	1.00	1.04	1.06
3797 YARRA JUNCTION	1.05	1.00	1.00
3091 YARRAMBAT	1.00	1.04	1.06
3013 YARRAVILLE	0.97	1.06	1.12
3139 YELLINGBO	1.04	1.00	1.00
3770 YERING	1.04	1.00	1.00
3770 YERINGBERG	1.04	1.00	1.00
3103 YOORALLA	0.94	1.03	1.09

Subordinate Legislation Act 1994
REGULATORY IMPACT STATEMENT
Lotteries Gaming and Betting (Fees) Regulations 1997

Notice is given in accordance with Section 11 of the **Subordinate Legislation Act 1994**, that a Regulatory Impact Statement (RIS) has been prepared in relation to the Lotteries Gaming and Betting (Fees) Regulations 1997.

The purpose of these regulations is to prescribe fees that will enable the Government to recover the cost of processing applications for approvals to conduct Calcutta sweepstakes and authority to provide pre-recorded betting information.

The only alternatives to the proposed Regulations would be to prescribe fees higher or lower than the actual cost of administering the applications for approvals and authorities. As the Government policy requires full cost recovery it is considered to be inappropriate to prescribe higher or lower fees.

The RIS concluded that the application fees should be—

<i>Type of Application</i>	<i>Proposed Fee</i>
Approval to conduct Calcutta sweepstakes	\$100
Authority to provide pre recorded betting information	\$150

Public comments are invited on the RIS and accompanying Regulations. Copies may be obtained by contacting Mr Jesse Malone of the Office of Racing on telephone (03) 9666 4255.

Written submissions will be received at the following address up to 5.00 p.m. on Friday, 2 May 1997: Mr Jesse Malone, Office of Racing, Level 3, 55 Collins Street, Melbourne 3000 (or G.P.O. Box 2392V, Melbourne 3001).

All submissions will be treated as public documents.

Dated 3 April 1997

TOM REYNOLDS
Minister for Sport

Co-operation Act 1981

G. W. B. C. CO-OPERATIVE LIMITED
 HEYWOOD HIGH SCHOOL AND
 DISTRICT CO-OPERATIVE LIMITED
 MOOROOPNA PRIMARY SCHOOL
 CO-OPERATIVE LTD
 OFFICE PRODUCTS PROMOTIONS
 CO-OPERATIVE LTD

Notice is hereby given in pursuance of Section 192 (8) of the **Co-operation Act 1981** and Section 572 (2) of the **Corporations Act 1989** that, at the expiration of three months from the date hereof, the names of the aforementioned societies will, unless cause is shown to the contrary, be struck off the register and the societies will be dissolved.

Dated at Melbourne 20 March 1997

PAUL HOPKINS
 Deputy Register of Co-operative Societies

The Constitution Act Amendment Act 1958
 CHANGE TO REGISTER OF POLITICAL
 PARTIES

In accordance with Section 148M of **The Constitution Act Amendment Act 1958**, I hereby give notice of the following change to the Register of Political Parties.

Party: Australian Democrats—Victorian Division.

New Address: G2 Eastbourne House, 62 Wellington Parade, East Melbourne, Victoria 3002.

Dated 25 March 1997

DR G. P. LYONS
 Electoral Commissioner

Adoption Act 1984

Under the functions and powers assigned to me by the Secretary to the Department of Human Services under Section 10 (2) of the **Community Services Act 1970** in relation to Section 5 of the **Adoption Act 1984**, I, Joanna Birdseye approve the following person under Section 5 (1) and Section 5 (2) (a) of the **Adoption Act** as an approved counsellor for the purposes of Section 87 of the **Adoption Act**.

Gatliff, Lisa

Dated 21 March 1997

JOANNA BIRDSEYE
 Acting Manager
 Youth and Family Services

Country Fire Authority Act 1958
 VARIATION OF FIRE DANGER PERIOD

In pursuance of the powers conferred by Section 4 of the **Country Fire Authority Act 1958**, I, Leonard Raymond Foster, Chairman of the Country Fire Authority, after consultation with the Secretary of Natural Resources and Environment, hereby vary the declaration of the Fire Danger Periods previously published in the Government Gazette by declaring that such Fire Danger Periods shall end in respect of the undermentioned Municipal Districts of Municipalities or parts of Municipalities specified.

To terminate from 0100 hours on Monday, 7 April 1997.

Bass Coast Shire Council.
 Baw Baw Shire Council.
 La Trobe Shire Council.
 South Gippsland Shire Council.
 Delatite Shire Council.

Rural City of Wangaratta (Part). That part north and west of the Hume Freeway.

LEN FOSTER
 Chairman

State Electricity Commission Act 1958
 NOTICE OF DECLARATION THAT
 CERTAIN ELECTRICAL EQUIPMENT TO
 BE PRESCRIBED ELECTRICAL
 EQUIPMENT

Equipment to be Submitted for Approval

Notice is given under Section 51 of the **State Electricity Commission Act 1958** (as amended by the **Electricity Industry Act 1993**) that the Chief Electrical Inspector declares the following type of electrical equipment to be prescribed electrical equipment from 1 July 1997:

"Television Receiver"—an electrical appliance which—

- (a) is for household use;
- (b) is for the display of public or subscription television broadcasts; and
- (c) incorporates a single cathode ray picture tube.

A person must not, after 1 July 1997, sell, exhibit, hire, expose for sale or hire, or advertise for sale or hire, television receivers

as defined above unless they have been approved by the Chief Electrical Inspector or by the regulatory authority in another State or Territory.

I. K. GRAHAM
Chief Electrical Inspector

Planning and Environment Act 1987
PAKENHAM PLANNING SCHEME
Notice of Lapsing of Amendment
Amendment L79

Pursuant to Section 30 (1) (a) of the **Planning and Environment Act 1987**, Amendment L79 to the Pakenham Planning Scheme has lapsed.

The amendment proposed to rezone part Lot 2, LP 89718, Kennedy Road, Pakenham, from Landscape to Residential 2 Zone.

The amendment lapsed on 18 March 1995.

ADRIAN SALMON
Co-ordinator, Amendment Services
Local Government, Planning and
Market Information Services Division
Department of Infrastructure

Planning and Environment Act 1987
BAIRNSDALE (SHIRE) PLANNING
SCHEME
Notice of Approval of Amendment
Amendment L57

The Minister for Planning and Local Government has approved Amendment L57 to the Bairnsdale (Shire) Planning Scheme.

The amendment comes into operation on the date this notice is published in the Government Gazette.

The amendment deletes "Education centre" as a prohibited use in the Residential Farm Zone.

A copy of the amendment can be inspected free of charge during office hours at the Department of Infrastructure, Ground Floor, 477 Collins Street, Melbourne and at the offices of the East Gippsland Shire Council, 55 Palmers Road, Lakes Entrance, and the East Gippsland Shire Council, Bairnsdale Business Centre, 273 Main Street, Bairnsdale.

ADRIAN SALMON
Co-ordinator, Amendment Services
Local Government, Planning and
Market Information Services Division
Department of Infrastructure

Planning and Environment Act 1987
BERWICK PLANNING SCHEME
Notice of Approval of Amendment
Amendment L90 Part 2

The Minister for Planning and Local Government has approved Amendment L90 Part 2 to the Berwick Planning Scheme.

The amendment comes into operation on the date this notice is published in the Government Gazette.

The changes to the Scheme are:

- to include part of the land in a Berwick Residential—Low Density Zone and part in a Stream and Floodway Zone and to implement provisions of the Cardinia Strategy (dated 21 March 1997);
- to reserve part of the land for Open Space—Public Proposed and part for Public Purposes—Existing—Melbourne Water to be developed as part of the Proposed Cardinia Creek Parklands.

The amendment will allow the land to be developed in accordance with the provisions of the zone and subdivided into lots of generally between 0.7 and 1.2 hectares.

A copy of the amendment can be inspected free of charge during office hours at the Department of Infrastructure, Ground Floor, 477 Collins Street, Melbourne and at the offices of the Casey City Council, Princes Highway, Narre Warren and Sladen Street, Cranbourne.

ADRIAN SALMON
Co-ordinator, Amendment Services
Local Government, Planning and
Market Information Services Division
Department of Infrastructure

Planning and Environment Act 1987
BULOKE PLANNING SCHEME
Notice of Approval of Amendment
Amendment L3

The Minister for Planning and Local Government has approved Amendment L3 to the Buloke Planning Scheme.

The amendment comes into operation on the date this notice is published in the Government Gazette.

The amendment rezones the portion of the former Charlton Primary School site now zoned Public Use ED-S to Residential Zone.

and extends the Heritage Area in the Chapter to cover the historic main former school building in Learmonth Street, Charlton.

A copy of the amendment can be inspected free of charge during office hours at the Department of Infrastructure, Ground Floor, 477 Collins Street, Melbourne and at the offices of the Buloke Shire Council, 22 Cumming Avenue, Birchip and 1 High Street, Charlton.

ADRIAN SALMON
Co-ordinator, Amendment Services
Local Government, Planning and
Market Information Services Division
Department of Infrastructure

Planning and Environment Act 1987
MELBOURNE PLANNING SCHEME
Notice of Approval of Amendment
Amendment L242

The Minister for Planning and Local Government has approved Amendment L242 to the Melbourne Planning Scheme.

The amendment comes into operation on the date this notice is published in the Government Gazette.

The amendment rezones land at 880 Lorimer Street, Port Melbourne, from a General Industrial Zone to a Business 3 Zone to facilitate the development of a business park for a range of office, manufacturing and warehouse uses.

A copy of the amendment can be inspected free of charge during office hours at the Department of Infrastructure, Ground Floor, 477 Collins Street, Melbourne and at the offices of the Melbourne City Council, Development Planning Branch, 6th Floor, Council House, 200 Little Collins Street, Melbourne.

ADRIAN SALMON
Co-ordinator, Amendment Services
Local Government, Planning and
Market Information Services Division
Department of Infrastructure

Planning and Environment Act 1987
MELBOURNE PLANNING SCHEME
Notice of Approval of Amendment
Amendment L243

The Minister for Planning and Local Government has approved Amendment L243 to the Melbourne Planning Scheme.

The amendment comes into operation on the date this notice is published in the Government Gazette.

The amendment introduces a site specific control over land at 11-37 Exhibition Street, Melbourne, to enable the land to be developed and used for a public parking facility and residential accommodation.

A copy of the amendment can be inspected free of charge during office hours at the Department of Infrastructure, Ground Floor, 477 Collins Street, Melbourne and at the offices of the Melbourne City Council, Council House, 7th Floor, 200 Little Collins Street, Melbourne.

ADRIAN SALMON
Co-ordinator, Amendment Services
Local Government, Planning and
Market Information Services Division
Department of Infrastructure

Planning and Environment Act 1987
MELBOURNE PLANNING SCHEME
Notice of Approval of Amendment
Amendment L247

The Minister for Planning and Local Government has approved Amendment L247 to the Melbourne Planning Scheme.

The amendment comes into operation on the date this notice is published in the Government Gazette.

The amendment deletes the Floodway Management Area overlay control from land to be developed as Stage 3 of the Kensington Banks Project, Smithfield Road, Kensington, City of Melbourne.

A copy of the amendment can be inspected free of charge during office hours at the Department of Infrastructure, Ground Floor, 477 Collins Street, Melbourne and at the offices of the Melbourne City Council, Council House, Level 6, 200 Little Collins Street, Melbourne 3000.

ADRIAN SALMON
Co-ordinator, Amendment Services
Local Government, Planning and
Market Information Services Division
Department of Infrastructure

Planning and Environment Act 1987
PHILLIP ISLAND PLANNING SCHEME
Notice of Approval of Amendment
Amendment L69

The Minister for Planning and Local Government has approved Amendment L69 to the Phillip Island Planning Scheme.

The amendment comes into operation on the date this notice is published in the Government Gazette.

The amendment:

- Allows, without a planning permit, Lot 2, LP 203229B, Part Crown Allotments 12 and 13, Parish of Phillip Island, known as "Trenavin Park", Ventnor Road, Ventnor, to be used and developed as a Guest house for up to 15 persons and a Reception rooms and Restaurant to seat up to 80 persons.
- Allows Reception rooms and Restaurant with a planning permit if the above requirements are not complied with.
- Allows Guest house with a planning permit subject to: (1) the number of visitors accommodated not exceeding 15 persons; and (2) the site for the Guest house has an area of at least 8 hectares, and buildings are set back at least 40 metres from any side or rear boundary.

A copy of the amendment can be inspected free of charge during office hours at the Department of Infrastructure, Ground Floor, 477 Collins Street, Melbourne and at the offices of the Bass Coast Shire Council, 67-69 McBride Avenue, Wonthaggi, and 91-97 Thompson Avenue, Cowes.

ADRIAN SALMON
Co-ordinator, Amendment Services
Local Government, Planning and
Market Information Services Division
Department of Infrastructure

Planning and Environment Act 1987
SWAN HILL CITY PLANNING SCHEME
Notice of Approval of Amendment
Amendment L23

The Minister for Planning and Local Government has approved Amendment L23 to the Swan Hill City Planning Scheme.

The amendment comes into operation on the date this notice is published in the Government Gazette.

The amendment rezones about 21.4 hectares of land in Memorial Drive/Dead Horse Lane, Swan Hill, from Public Open Space B—Recreation Reserve to Public Purposes 3—Cemetery to provide an additional cemetery site for Swan Hill.

A copy of the amendment can be inspected free of charge during office hours at the Department of Infrastructure, Ground Floor, 477 Collins Street, Melbourne and at the offices of the Swan Hill Rural City Council, 45 Splatt Street, Swan Hill.

ADRIAN SALMON
Co-ordinator, Amendment Services
Local Government, Planning and
Market Information Services Division
Department of Infrastructure

Planning and Environment Act 1987
TAMBO PLANNING SCHEME
Notice of Approval of Amendment
Amendment L71

The Minister for Planning and Local Government has approved Amendment L71 to Chapter One of the Tambo Planning Scheme.

The amendment comes into operation on the date this notice is published in the Government Gazette.

The amendment rezones part Crown Allotments 26 and 26A, part of PS 330680H and LP 222011X, Parish of Colquhoun, known as "Kinkuna Country Fun and Fauna Park" from "Rural" to part "Urban Residential 1" Zone and part "Business 1" Zone, and removes the site specific planning provisions relating to Kinkuna Country which requires the use and development to comply with concept plans detailing the location and number of holiday units, motel rooms, restaurant and tennis courts.

A copy of the amendment can be inspected free of charge during office hours at the Department of Infrastructure, Ground Floor, 477 Collins Street, Melbourne and at the offices of the East Gippsland Shire Council, 55 Palmers Road, Lakes Entrance.

ADRIAN SALMON
Co-ordinator, Amendment Services
Local Government, Planning and
Market Information Services Division
Department of Infrastructure

Planning and Environment Act 1987
WERRIBEE PLANNING SCHEME
Notice of Approval of Amendment
Amendment L79

The Minister for Planning and Local Government has approved Amendment L79 to the Werribee Planning Scheme.

The amendment comes into operation on the date this notice is published in the Government Gazette.

The amendment incorporates the Werribee River Policy and Management Manual and introduces Streamside Environment Area provisions to land located within 200 metres of the Werribee River between the Maltby Bypass, Werribee and Boundary Road, Tarneit.

A copy of the amendment can be inspected free of charge during office hours at the Department of Infrastructure, Ground Floor, 477 Collins Street, Melbourne and at the offices of the Wyndham City Council, 45 Princes Highway, Werribee 3030.

ADRIAN SALMON
Co-ordinator, Amendment Services
Local Government, Planning and
Market Information Services Division
Department of Infrastructure

Planning and Environment Act 1987
WODONGA RURAL CITY PLANNING
SCHEME

Notice of Approval of Amendment
Amendment L16

The Minister for Planning and Local Government has approved Amendment L16 to the Wodonga Rural City Planning Scheme.

The amendment comes into operation on the date this notice is published in the Government Gazette.

The amendment changes the "Rural A" Zone provisions to include "any purpose not specified or included in any other column of the table" under Column 2 of the Table of Uses and Development and nominate prohibited uses under Column 3.

A copy of the amendment can be inspected free of charge during office hours at the Department of Infrastructure, Ground Floor, 477 Collins Street, Melbourne and at the offices of the Wodonga Rural City Council, Hovell Street, Wodonga.

ADRIAN SALMON
Co-ordinator, Amendment Services
Local Government, Planning and
Market Information Services Division
Department of Infrastructure

Planning and Environment Act 1987
YEA PLANNING SCHEME
Notice of Approval of Amendment
Amendment L14

The Minister for Planning and Local Government has approved Amendment L14 to the Yea Planning Scheme.

The amendment comes into operation on the date this notice is published in the Government Gazette.

The amendment rezones the former Woodbourne Primary School site at the intersection of Myles and Murrindindi Roads, Woodbourne, from "Public Use—Ministry of Education Primary School" to "Rural".

A copy of the amendment can be inspected free of charge during office hours at the Department of Infrastructure, Ground Floor, 477 Collins Street, Melbourne and at the offices of the Murrindindi Shire Council, Civic Centre, Semi Circle, Yea.

ADRIAN SALMON
Co-ordinator, Amendment Services
Local Government, Planning and
Market Information Services Division
Department of Infrastructure

ORDERS IN COUNCIL

**Control of Weapons Act 1990
EXEMPTION UNDER THE CONTROL OF
WEAPONS ACT 1990**

The Governor in Council hereby grants the following exemption under Section 5 (2) of the **Control of Weapons Act 1990** with respect to the provisions of Section 5 (1) of the **Control of Weapons Act 1990**:

Members of the Correctional Emergency Response Team trained to use tear gas at Fulham Correctional Centre, from the operation of Section 5 (1) of the **Control of Weapons Act 1990**, for the purpose of carriage and operational use of tear gas. All storage and handling requirements are to be adhered to as per the Fulham Correctional Centre Operating Manual, as endorsed by the Commissioner for Correctional Services.

Dated 25 March 1997

Responsible Minister:

BILL McGRATH
Minister for Police and
Emergency Services

ANNETTE WILTSHIRE
Acting Clerk of the Executive Council

**Electricity Industry Act 1993
EXEMPTION IN RELATION TO
VENDOR'S STATEMENT**

The Governor in Council acting under Section 84 AB of the **Electricity Industry Act 1993**, hereby makes the following Order:

Loy Yang Power Ltd A.C.N. 065 381 240, being a generation company under the **Electricity Industry Act 1993**, is not required in respect of any sale of land entered into by it under a contract executed by the parties thereto between the date on which this Order is published in the Government Gazette and 31 May 1997 to include in the vendor's statement under Section 32 of the **Sale of Land Act 1962** any of the particulars referred to in Section 32 (2) (e) of the **Sale of Land Act 1962**.

Dated 2 April 1997

Responsible Minister:

ALAN R. STOCKDALE
Treasurer

NICOLE WHITE
Acting Clerk of the Executive Council

**Country Fire Authority Act 1958
FIXING THE RATE OF INTEREST FOR
THE PURPOSES OF SECTION 78 (4) (b)
AND (5) (e) OF THE COUNTRY FIRE
AUTHORITY ACT 1958**

The Governor in Council, under Section 78 (4) (b) and (5) (e) of the **Country Fire Authority Act 1958**, fixes the rate of interest for the purposes of Section 78 (4) (b) and (5) (e) at 9.50 per cent per annum to apply to amounts which first become due and payable under Section 78 (4) (a) and Section 78 (5) (d), respectively, on or after 2 April 1997.

Dated 2 April 1997

Responsible Minister:

BILL McGRATH
Minister for Police and
Emergency Services

NICOLE WHITE
Acting Clerk of the Executive Council

**Country Fire Authority Act 1958
FIXING THE RATE OF INTEREST FOR
THE PURPOSES OF SECTION 80 (1) (d)
OF THE COUNTRY FIRE AUTHORITY
ACT 1958**

The Governor in Council, under Section 80 (1) (d) of the **Country Fire Authority Act 1958**, fixes the rate of interest for the purposes of Section 80 (1) (d) at 9.50 per cent per annum to apply to amounts which first become due and payable on or after 2 April 1997.

Dated 2 April 1997

Responsible Minister:

BILL McGRATH
Minister for Police and
Emergency Services

NICOLE WHITE
Acting Clerk of the Executive Council

**Country Fire Authority Act 1958
FIXING THE RATE OF INTEREST FOR
THE PURPOSES OF SECTION 81 (c) OF
THE COUNTRY FIRE AUTHORITY ACT
1958**

The Governor in Council, under Section 81 (c) of the **Country Fire Authority Act 1958**, fixes the rate of interest for the purposes of Section 81 (c) at 9.50 per cent per annum to

apply to amounts which first become due and payable under Section 81 (b) on or after 2 April 1997.

Dated 2 April 1997

Responsible Minister:
BILL McGRATH
Minister for Police and
Emergency Services

NICOLE WHITE
Acting Clerk of the Executive Council

Metropolitan Fire Brigades Act 1958
FIXING THE RATE OF INTEREST FOR
THE PURPOSES OF SECTION 41 (4) (b)
AND (5) (e) OF THE METROPOLITAN
FIRE BRIGADES ACT 1958

The Governor in Council, under Section 41 (4) (b) and (5) (e) of the **Metropolitan Fire Brigades Act 1958**, fixes the rate of interest for the purposes of Section 41 (4) (b) and (5) (e) at 9.50 per cent per annum to apply to amounts which first become due and payable under Section 41 (4) (a) and Section 41 (5) (d), respectively, on or after 2 April 1997.

Dated 2 April 1997

Responsible Minister:
BILL McGRATH
Minister for Police and
Emergency Services

NICOLE WHITE
Acting Clerk of the Executive Council

Metropolitan Fire Brigades Act 1958
FIXING THE RATE OF INTEREST FOR
THE PURPOSES OF SECTION 43 (1) (e) OF
THE METROPOLITAN FIRE BRIGADES
ACT 1958

The Governor in Council, under Section 43 (1) (e) of the **Metropolitan Fire Brigades Act 1958**, fixes the rate of interest for the purposes of Section 43 (1) (e) at 9.50 per cent per annum to apply to amounts which first become due and payable on or after 2 April 1997.

Dated 2 April 1997

Responsible Minister:
BILL McGRATH
Minister for Police and
Emergency Services

NICOLE WHITE
Acting Clerk of the Executive Council

Metropolitan Fire Brigades Act 1958
FIXING THE RATE OF INTEREST FOR
THE PURPOSES OF SECTION 45 (c) OF
THE METROPOLITAN FIRE BRIGADES
ACT 1958

The Governor in Council, under Section 45 (c) of the **Metropolitan Fire Brigades Act 1958**, fixes the rate of interest for the purposes of Section 45 (c) at 9.50 per cent per annum to apply to amounts which first become due and payable under Section 45 (b) on or after 2 April 1997.

Dated 2 April 1997

Responsible Minister:
BILL McGRATH
Minister for Police and
Emergency Services

NICOLE WHITE
Acting Clerk of the Executive Council

Parliamentary Committees Act 1968

The Governor in Council, acting under Section 4F (1) (a) (ii) of the **Parliamentary Committees Act 1968**, by this Order extends the reporting date for the Law Reform Committee of Parliament to report to the Parliament on Regulatory Efficiency Legislation from 30 April 1997 to 30 September 1997.

Dated 25 March 1997

Responsible Minister:
LOUISE ASHER
Minister for Small Business

ANNETTE WILTSHIRE
Acting Clerk of the Executive Council

Land Act 1958
SALE OF CROWN LAND BY PRIVATE
TREATY

The Governor in Council, pursuant to Section 99A (1) (a) of the **Land Act 1958**, approves the sale by private treaty of Crown Allotment 18Z, Parish of Cut Paw Paw located at Anderson Road, Sunshine.

Dated 2 April 1997

Responsible Minister:
ROGER M. HALLAM
Minister for Finance

NICOLE WHITE
Acting Clerk of the Executive Council

Crown Land (Reserves) Act 1978
NOTICE OF INTENTION

The Governor in Council under Section 10 of the **Crown Land (Reserves) Act 1978** gives notice of intention to revoke the following temporary reservation:

CRIB POINT—The temporary reservation by Order in Council of 10 November 1927 of an area of 97.125 hectares, more or less, of land in the Township of Crib Point (formerly Township of Mooradoo) and Parish of Bittern as a site for Public Purposes, so far only as the portion containing 500 square metres, more or less, as indicated by hatching on Plan LEGL./96-485 lodged in the Central Plan Office—(Rs 3572).

Dated 2 April 1997

Responsible Minister:

MARIE TEHAN
Minister for Conservation and
Land Management

NICOLE WHITE
Acting Clerk of the Executive Council

**SUBORDINATE LEGISLATION ACT 1994
NOTICE OF MAKING OF STATUTORY
RULES**

Notice is given under Section 17 (2) of the Subordinate Legislation Act 1994 of the making of the following Statutory Rules:

23. *Statutory Rule:* Second-Hand Dealers and Pawnbrokers (Exemption) (No. 2) Regulations 1997

Authorising Act: Second-Hand Dealers and Pawnbrokers Act 1989

Date of Making: 2 April 1997

24. *Statutory Rule:* Equipment (Public Safety) (Incident Notification) Regulations 1997

Authorising Act: Equipment (Public Safety) Act 1994

Date of Making: 2 April 1997

25. *Statutory Rule:* Occupational Health and Safety (Incident Notification) Regulations 1997

Authorising Act: Occupational Health and Safety Act 1985

Date of Making: 2 April 1997

26. *Statutory Rule:* Drugs, Poisons and Controlled Substances (Fees) Regulations 1997

Authorising Act: Drugs, Poisons and Controlled Substances Act 1981

Date of Making: 2 April 1997

**SUBORDINATE LEGISLATION ACT 1994
NOTICE THAT STATUTORY RULES ARE
OBTAINABLE**

Notice is given under Section 17 (3) of the Subordinate Legislation Act 1994 that the following Statutory Rules were first obtainable from Information Victoria, 318 Little Bourke Street, Melbourne on the date specified:

18. *Statutory Rule:* Fisheries (Fees) (Amendment) Regulations 1997

Authorising Act: Fisheries Act 1968

Date first obtainable: 27 March 1997

Code A

19. *Statutory Rule:* Tobacco (Victorian Health Promotion Foundation) (Amendment) Regulations 1997

Authorising Act: Tobacco Act 1987

Date first obtainable: 27 March 1997

Code A

20. *Statutory Rule:* Plumbers Gasfitters and Drainers Registration Board (Amendment) Regulations 1997

Authorising Act: Building Act 1993

Date first obtainable: 27 March 1997

Code A

21. *Statutory Rule:* Road Safety (Procedures) (Preliminary Breath Test Devices) Regulations 1997

Authorising Act: Road Safety Act 1986

Date first obtainable: 27 March 1997

Code A

22. *Statutory Rule:* Gas and Fuel Corporation (Gas Installation) (Amendment) Regulations 1997

Authorising Act: Gas Industry Act 1994

Date first obtainable: 27 March 1997

Code A

Retail price will vary according to the number of pages in each special or periodical gazette. The table below sets out the prices that apply.

<i>Price Code</i>	<i>No. of Pages (Including cover and blank pages)</i>	<i>Price</i>
A	1-16	\$2.70
B	17-32	\$4.00
C	33-48	\$5.50
D	49-96	\$8.50
E	97-144	\$11.00
F	145-192	\$13.00
G	193-240	\$15.00
H	241-288	\$16.00
I	289-352	\$18.00
J	353-416	\$21.00
K	417-480	\$24.00
L	481-544	\$28.00

ADVERTISERS PLEASE NOTE

As from 3 April 1997

The last Special Gazette was No. 32
Dated 2 April 1997

The last Periodical Gazette was No. 2
Dated 2 September 1996

774 G 13 3 April 1997

Victoria Government Gazette





CONTENTS

	Page
Estates of Deceased Persons	731
Government and Outer Budget Sector Agencies Notices	737
Notice of Making of Statutory Rules	772
Orders in Council—	
Acts— Control of Weapons; Electricity Industry; Country Fire Authority; Metropolitan Fire Brigades; Parliamentary Committees; Land; Crown Land (Reserves)	769
Private Advertisements	731

The Victoria Government Gazette is published by the Australian Government Publishing Service with the authority of the Government Printer for the State of Victoria
© State of Victoria 1997
ISSN 0819-5471

This publication is copyright. No parts may be reproduced by any process except in accordance with the provisions of the Copyright Act.

Products and services advertised in this publication are not endorsed by AGPS or the State of Victoria and neither of them accepts any responsibility for the content or the quality of reproduction. AGPS reserves the right to reject any advertising material it considers unsuitable for government publication.

Address all inquiries to the Government Printer for the State of Victoria

1 Macarthur Street
Melbourne 3002 Victoria Australia

Subscriptions

AGPS Victorian Operations

PO Box 263

Brunswick 3056

Telephone enquiries (03) 9387 8135

Fax (03) 9387 3404

Retail Sales

Information Victoria Bookshop

356 Collins Street Melbourne 3000

Telephone enquiries 1300 366 356

Recommended Retail Price \$1.65



9 780644 457330