



# VICTORIA GOVERNMENT GAZETTE

Published by Authority.

[Registered at the General Post Office, Melbourne, for transmission by post as a newspaper.]

No. 196.]

TUESDAY, DECEMBER 14.

[1915.]

## NOTICE OF INTENTION TO DEDICATE AREAS OF CROWN LANDS AS PERMANENT FORESTS AND TIMBER RESERVES.

NOTICE is hereby given that, after the expiration of one month following the first publication of this notice in the Victorian *Government Gazette*, it is intended, in pursuance of Section 20 of the *Forests Act 1915*, to move His Excellency the Governor in Council to dedicate as Permanent Forests and Timber Reserves the areas of Crown lands described in the accompanying Schedule (No. 18).

T. LIVINGSTON,  
Minister of Forests.

State Forests Department,  
Melbourne, 21st November, 1915.

W. HUTCHINSON,  
Minister of Lands.

### SCHEDULE No. 18.

NOTE.—The areas given in the columns and on the diagrams are approximate.

Diagram.	Correspondence Numbers.		Parish.	Plan.	County.	Area in Acres.	
						Permanent Forest.	Timber Reserve.
194	77108	5109	Gobur .. .. .	209A	Anglesey .. .. .	..	657
195	550	1840	Steavenson .. .. .	R1	" .. .. .	1,175	
196	795	1841	Taggerty .. .. .	419	" .. .. .	320	
197-8	70321	135	Eppalock .. .. .	185	Bendigo .. .. .	720	
199	77351	608	Ellinging .. .. .	N2	Buln Buln .. .. .	396	
200	77346	606	Noojee .. .. .	N2	" .. .. .	2,571	
202	77228	5851	Dean .. .. .	158	Grant .. .. .	66	
203-4	70283	6689	St. Arnaud .. .. .	400A	Kara Kara .. .. .	229	117
208	77069	4876	Kontbruck .. .. .	247B	Normanby .. .. .	7,258	
207	77414	1149	Napier .. .. .	346	" .. .. .	..	412
205-6	70664	2244	Narrawong .. .. .	349	" .. .. .	2,360	
209	77413	1147	Weecurra .. .. .	486	" .. .. .	..	743
210	76915	3803	Drik Drik .. .. .	166	" .. .. .	475	
202	77228	5851	Dean .. .. .	158	Talbot .. .. .	544	
201	77228	5851	Bullarook .. .. .	80	" .. .. .	60	
						16,174	1,929

Permanent Forest .. .. .	Acres.
Timber Reserve .. .. .	16,174
	1,929
Total Area .. .. .	18,103

PROPOSED ADDITIONS TO STATE FORESTS.—DIAGRAMS TO ACCOMPANY SCHEDULE No. 18.

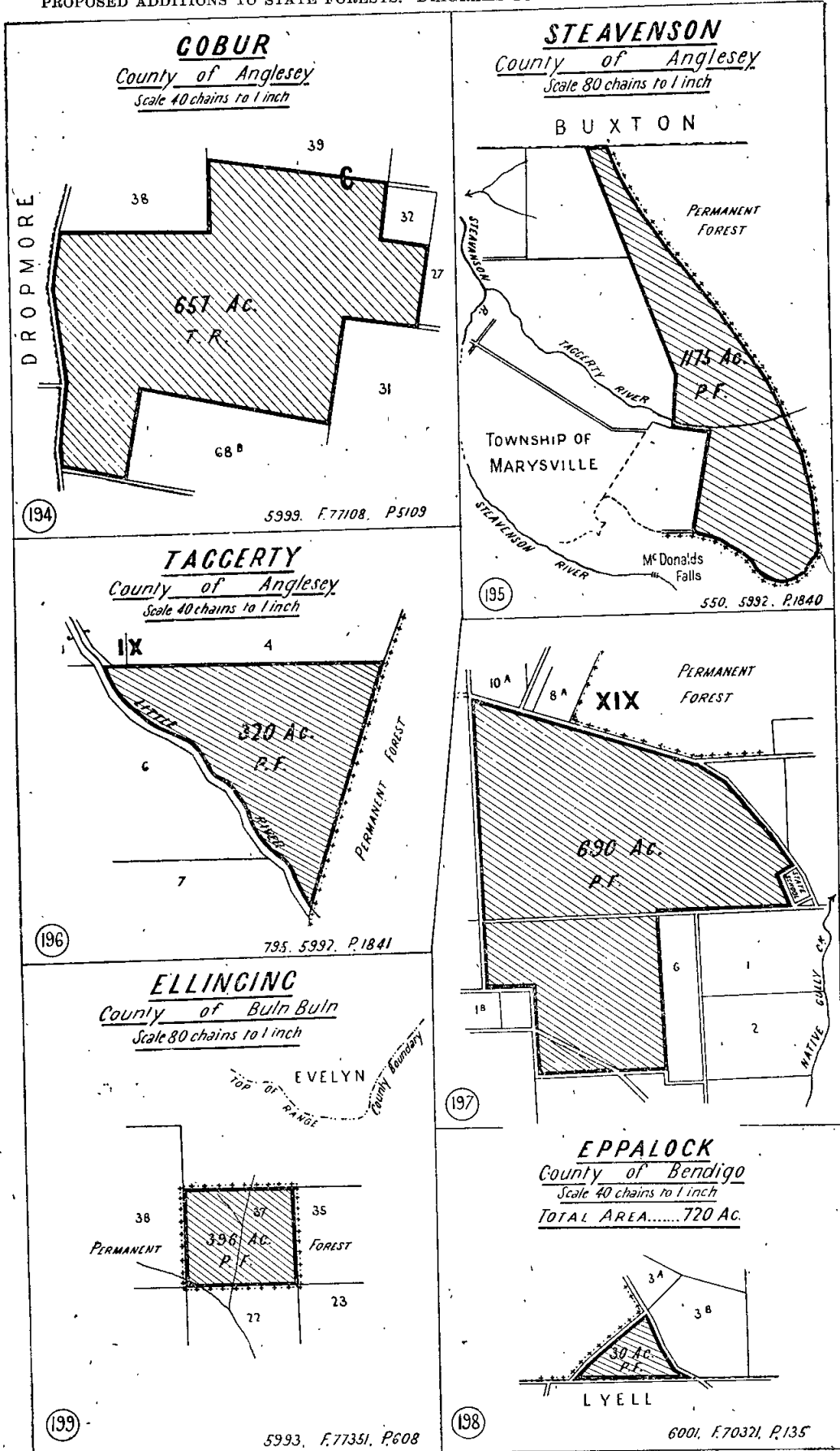

PROPOSED ADDITIONS TO STATE FORESTS.—DIAGRAMS TO ACCOMPANY SCHEDULE NO. 18.—continued.

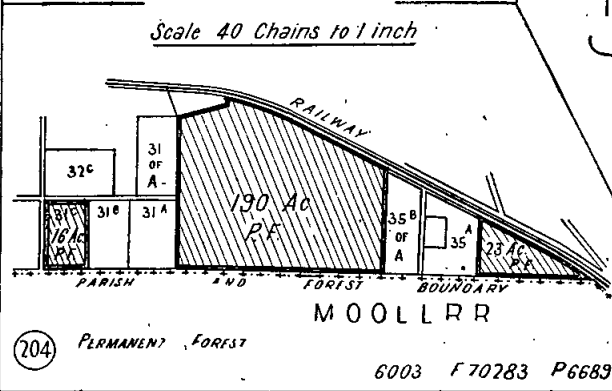
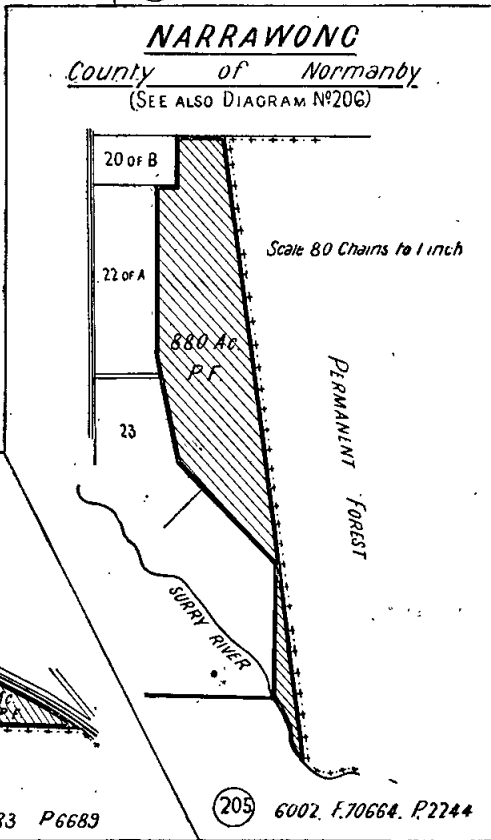
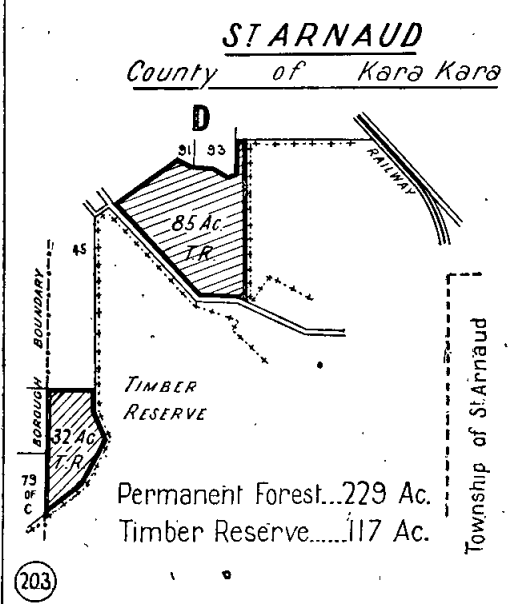
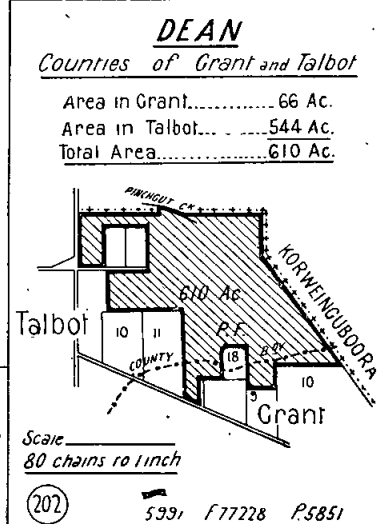
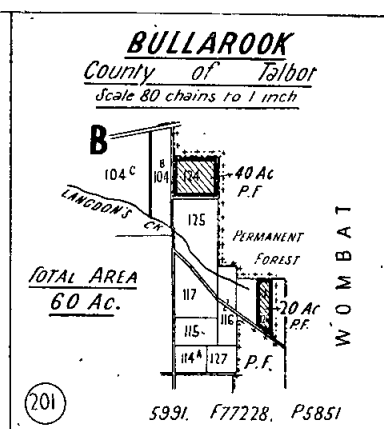
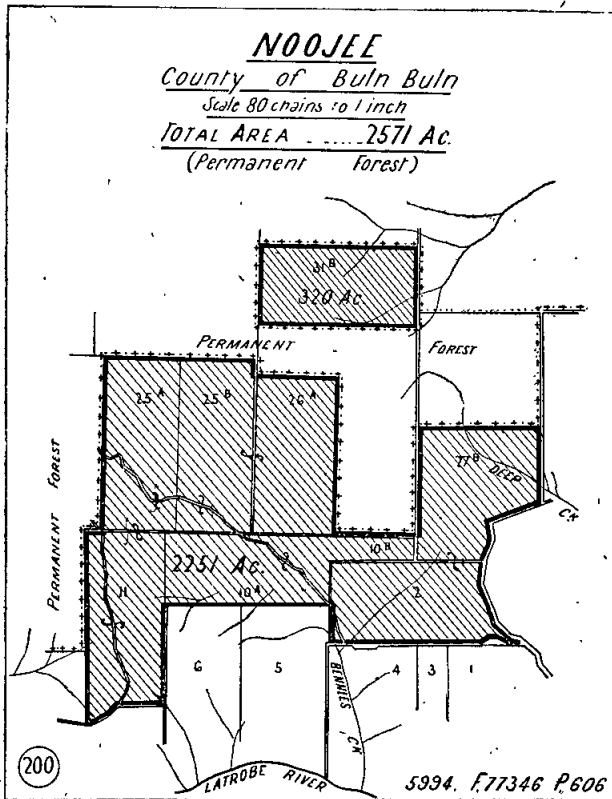

PROPOSED ADDITIONS TO STATE FORESTS.—DIAGRAMS TO ACCOMPANY SCHEDULE NO. 18.—continued.

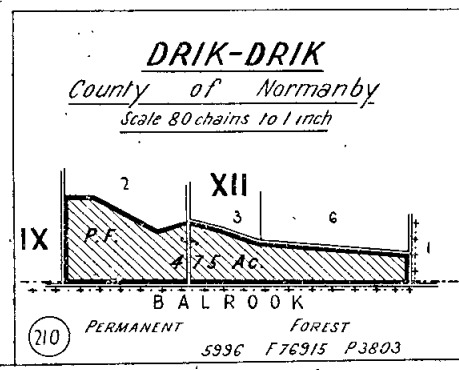
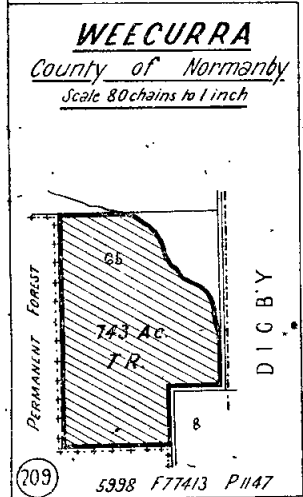
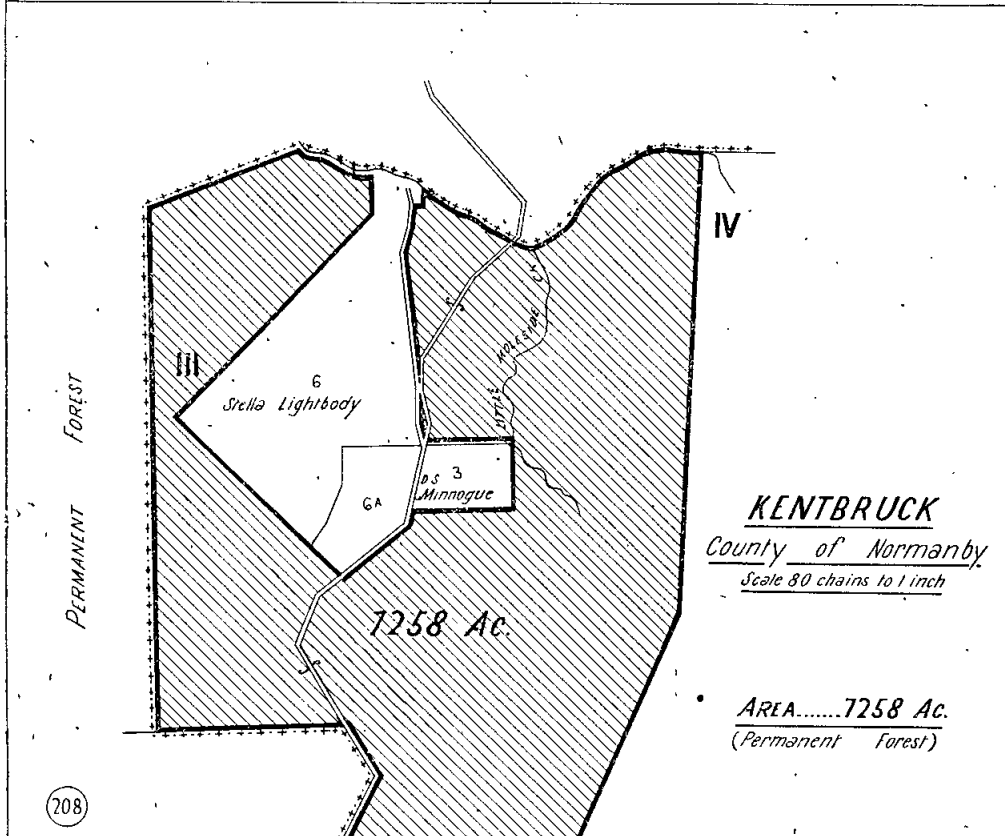
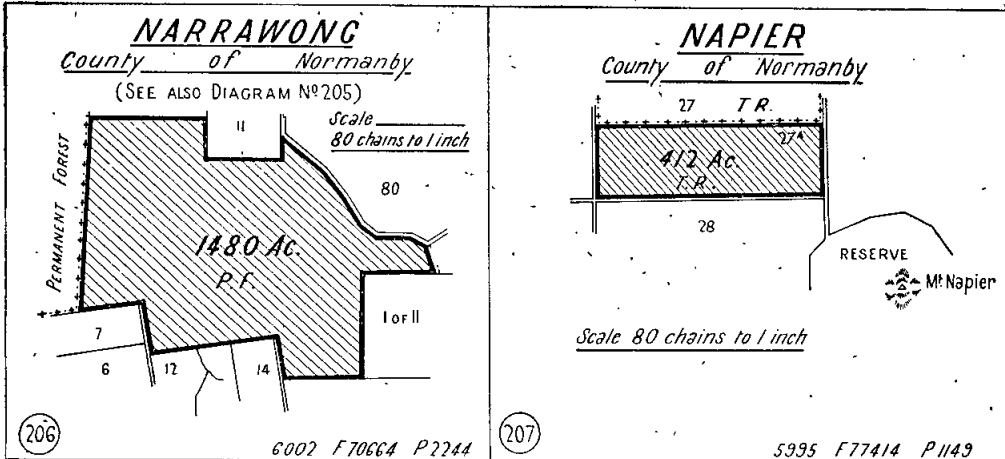

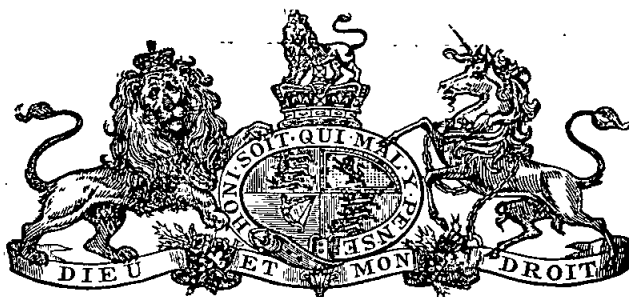

# VICTORIA GOVERNMENT GAZETTE

Published by Authority

[Registered at the General Post Office, Melbourne, for transmission by post as a newspaper.]

No. 197.]

WEDNESDAY, DECEMBER 15.

[1915.

*Factories and Shops Act 1915.*

## DETERMINATION OF THE GOLD MINERS BOARD.

IN accordance with the provisions of the *Factories and Shops Act 1915*, the Special Board appointed to determine the lowest prices or rates which may be paid to any person or persons or classes of persons whosoever employed in the business or occupation (other than firemen, boiler attendants, or engine-drivers) of mining for gold, has made the following Determination, namely:—

(1) That this Determination shall come into force and be operative on and after the 3rd day of January, 1916.

The Determination and amendments are printed hereunder.

### WAGES.

(2) That the lowest rates of wages to be paid to the following persons shall be:—

	Mining District of Gippsland; and the Dry Creek, Gaf- ney's Creek, Wood's Point, Big River, Jamieson, Mitta Mitta, Bethanga, Harrietville, and Corryong Divisions of the Mining Dis- trict of Beechworth.	All other parts of Victoria.
	Per week of 48 hours. £ s. d.	Per week of 48 hours. £ s. d.
QUARTZ.		
Shift bosses .. .. .	3 8 9	3 4 0
Miners putting up rises where the angle is not more than 40 degrees from the vertical, or sinking shafts or winzes—		
Machine labour .. .. .	3 8 9	3 4 0
Hand labour .. .. .	3 6 6	3 2 0
Other miners—		
Machine labour .. .. .	3 4 6	3 0 0
Hand labour .. .. .	3 2 0	2 18 0
Timbermen repairing shafts .. .. .	3 9 10	3 5 0
Other timber repairers .. .. .	3 5 6	3 1 0
Blacksmiths .. .. .	3 8 9	3 4 0
Blacksmiths' strikers .. .. .	2 15 10	2 12 0
Carpenters .. .. .	3 7 9	3 3 0
Rough carpenters, timber dressers, and tool-sharpener	3 1 0	2 17 0
Pitmen and lift installers and drawers .. .. .	3 4 6	3 0 0
Platmen, bracemen, and winch drivers .. .. .	2 19 0	2 15 0

WAGES—continued.

	Mining District of Gippsland; and the Dry Creek, Gafney's Creek, Wood's Point, Big River, Jamieson, Mitta, Mitta, Bethanga, Harrietville, and Corryong Divisions of the Mining District of Beechworth.	All other parts of Victoria.
	Per week of 48 hours. £ s. d.	Per week of 48 hours. £ s. d.
<b>QUARTZ—continued.</b>		
Batterymen, retortmen, and boiler and flue cleaners..	2 18 0	2 14 0
Motor or horse-drivers (underground), tailings dam men, and horse drivers at whims or whips ..	2 15 0	2 11 0
Battery feeders .. .. .	2 11 6	2 8 0
All other underground workers .. .. .	2 15 10	2 12 0
All others .. .. .	2 12 8	2 9 0
<b>CYANIDE.</b>		
Overseer in charge of one plant .. .. .	3 4 6	3 0 0
Men in charge of one horse .. .. .	2 13 9	2 10 0
Men in charge of two horses .. .. .	2 14 9	2 11 0
Men in charge of three horses .. .. .	2 15 10	2 12 0
Mixers .. .. .	2 14 9	2 11 0
All others .. .. .	2 12 8	2 9 0
<b>DREDGING AND SLUICING.</b>		
Puntmen on dredge or in charge of barge and nozzle-men .. .. .	3 4 6	3 0 0
Pumpholemen .. .. .	3 1 0	2 17 0
Winch drivers .. .. .	2 19 0	2 15 0
All others .. .. .	2 14 9	2 11 0
<b>PYRITES.</b>		
Furnacemen .. .. .	2 14 9	2 11 0
All others .. .. .	2 12 8	2 9 0

	Mining District of Ararat.	Mining District of Gippsland; and the Dry Creek, Gafney's Creek, Wood's Point, Big River, Jamieson, Mitta, Mitta, Bethanga, Harrietville, and Corryong Divisions of the Mining District of Beechworth.	All other parts of Victoria.
	Per week of 48 hours. £ s. d.	Per week of 48 hours. £ s. d.	Per week of 48 hours. £ s. d.
<b>ALLUVIAL.</b>			
Miners, rising or shaft or winze sinkers—			
Machine labour .. .. .	3 9 0	3 14 0	3 9 0
Hand labour .. .. .	3 7 0	3 12 0	3 7 0
Reef drivers—			
Machine labour .. .. .	3 7 6	3 6 6	3 2 0
Hand labour .. .. .	3 7 6	3 4 6	3 0 0
Rock drillmen .. .. .	3 6 0		
Other miners—			
Machine labour .. .. .	3 5 0	3 6 6	3 2 0
Hand labour .. .. .	3 5 0	3 4 6	3 0 0
Sluicemen in charge .. .. .	3 10 0	3 11 0	3 6 0
Shift bosses .. .. .	3 10 0	3 9 0	3 4 0
Blacksmiths .. .. .	3 4 0	3 8 9	3 4 0
Pitmen .. .. .	3 10 0	3 7 9	3 3 0
Carpenters or timber repairers .. .. .	3 3 0	3 7 9	3 3 0
Timber cutters .. .. .	2 19 0	3 3 0	2 19 0
Platmen or bracedmen .. .. .	2 15 0	2 19 0	2 15 0
Truckers .. .. .	2 14 0	2 18 0	2 14 0
Puddling machine men .. .. .	2 12 0	2 15 10	2 12 0
Motor and horse drivers (underground), puddlers, tailings dam men, and horse drivers at whims or whips .. .. .	2 11 0	2 14 9	2 11 0
All others .. .. .	2 9 0	2 12 8	2 9 0

Any employee with the exception of shaftmen working in wet ground, that is ground where a man working therein underground under ordinary and usual conditions, must in the performance of his work—

- (i) be wetted continuously from the feet to the knees; or  
 (ii) be wetted above the waist in the course of a shift through working clothes other than oilskins or other waterproof clothing, by water settling in or falling or dripping from the mine,

shall be paid in addition to the above rates an extra wages rate of 6s. per week of 48 hours,

and

shaftmen working in any such ground shall be paid at the rate of time and a quarter.

#### JUVENILE WORKERS.

3. That the lowest rates to be paid to males under 16 years of age employed as blanket boys shall be :—

20s. per week of 48 hours.

#### APPRENTICES AND IMPROVERS.

“Apprentice” means any person under 21 years of age bound by indentures of apprenticeship, or any person over 21 years of age who, with the sanction of the Minister, is bound by indentures of apprenticeship. (Act 2650, Section 3.)

“Improver” means any person (other than an apprentice) who does not receive a piece-work price or a wages rate fixed by any Special Board for persons other than apprentices or improvers, and who is not over 21 years of age, or who, being over 21 years of age, holds a licence from the Minister to be paid as an improver. (Act 2650, Section 3.)

4. That—

- (a) the lowest rates which may be paid to an apprentice or an improver, and  
 (b) the proportionate number of apprentices and improvers who may be employed in any place

shall be as shown in the following table :—

Wages per week of 48 hours.				Proportionate Number in any Place.		
During—				Apprentices.	Improvers.	
				s. d.	s. d.	
1st year	..	..	..	35 0	35 0	<i>Apprentices.</i> One apprentice to every three or fraction of three workers receiving not less than 48s. per week of 48 hours.
2nd	..	..	..	40 0	40 0	
3rd	..	..	..	45 0	48 0	
						<i>Improvers.</i> One improver to every six or fraction of six workers receiving not less than 48s. per week of 48 hours.

#### OVERTIME.

5. That any employee who in any week works for any time in excess of 48 hours shall be paid for such extra time at the rate of time and a half.

#### CASUAL LABOUR.

6. That casual employees, *i.e.*, persons who are employed during any week for not more than 24 hours, shall be paid at the rate of time and a half.

#### SPECIAL RATES FOR SUNDAY AND PUBLIC HOLIDAYS.

7. That time and a half shall be the special rate for all work done on—

- Sunday;  
 New Year's Day;  
 21st April (Eight Hours Day);  
 Christmas Day;  
 Boxing Day;

but if any other day be by Act of Parliament or Proclamation substituted for any of the above-named holidays, the special rates shall only be payable for work done on the day so substituted.

E. NOTLEY MOORE, P.M.,

Chairman.

Dated at Melbourne, this 2nd day of December, 1915.

