

VICTORIA GOVERNMENT G A Z E T T E

No. G 50 Wednesday 23 December 1987
By Authority Jean Gordon Government Printer Melbourne

GENERAL

Gazette Services

The *Victoria Government Gazette* (VGG) is published by VGPO for the State of Victoria and is produced in three editions.

VGG General is published each Wednesday and provides information regarding Acts of Parliament and their effective date of operation; Government notices; requests for tenders; as well as contracts and contracts accepted. Private notices are also published.

VGG Special is published any day when required for urgent or special Government notices. VGG Special is made available automatically to subscribers of VGG General.

VGG Periodical is published on Monday when required and includes specialised information eg. Medical, Dental, Pharmacist's Registers, etc.

Government Advertising

Publishing Details

The following Guidelines should be followed to ensure publication of Government material in the *Victoria Government Gazette*.

- Duplicate copies should be submitted for use by the Gazette Officer.
- Material submitted to the Executive Council for gazettal will normally be published in the following week's issue.
- Where urgent gazettal is required, contact:
Gerd Gaspars
Gazette Officer
Department of the Premier and Cabinet
2nd Floor 1 Treasury Place
Melbourne 3000
Telephone Inquiries (03) 651 5153
- Government advertising other than material for the consideration of the Executive Council should be forwarded to the Gazette Office no later than 9.30 am on Tuesday.
- Lengthy or complicated notices should be forwarded several days before publication.
- Proofs will be supplied only when requested or at the direction of the Gazette Officer.
- No additions or amendments to material for publication will be accepted by telephone.
- Double rates for advertising in the Special Gazette will apply.

Private Advertising

Publishing Details. Send copy to:

VGG Coordinator
Gazette Advertising
VGPO
66-112 Macaulay Road
North Melbourne
(PO Box 203 North Melbourne 3051)
Telephone inquiries (03) 320 0100
Fax No. (03) 329 2696

Advertising Rates and Payment

Single column × cm/part cm \$3.85
Double column × cm/part cm \$7.70
Full page \$161.70

All private advertising **MUST** be paid for in advance, prior to any gazettal. Cheques should be made payable to 'VGPO'.

Advertisers should note:

- There are approximately 20 words to each column centimetre depth.
- Signatures (in particular) and proper names must also be in block letters.
- All material should be double spaced.
- Advertisements can be faxed, and a cover sheet should be used, marked to the attention of the Gazette Coordinator.
- Documents not clearly prepared and in the exact format for gazettal will be returned to the sender unpublished.
- Late copy received at VGPO after 3.30 pm Tuesday will be placed in the following issue of VGG, irrespective of any date/s mentioned in the copy (unless otherwise advised).

Copy Deadline

11.00 am Tuesday (Normal Rates)
3.30 pm Tuesday (Double Rates)

Subscriptions

VGG is available by three subscription services:

General and Special—\$100 each year
General, Special and Periodical—\$115 each year
Periodical—\$60 each year

Subscriptions are payable in advance and accepted for a period of one year. All subscriptions are on a firm basis and refunds for cancellations will not be given.

All payments should be made payable to VGPO.

Subscription inquiries: (03) 320 0217
VGPO Bookshop Inquiries: (03) 663 3760

PROCLAMATIONS*Agricultural Acts (Further Amendment) Act 1987***PROCLAMATION OF COMMENCEMENT OF SECTION 41**

I, J. Davis McCaughey, Governor of Victoria, acting with the advice of the Executive Council and under section 2 of the *Agricultural Acts (Further Amendment) Act 1987*, fix 23 December 1987, as the day on which section 41 of that Act comes into operation.

Given under my hand and the seal of Victoria on 22 December 1987.

(L.S.) J. DAVIS McCAUGHEY

By His Excellency's Command

EVAN WALKER

Minister for Agriculture and Rural Affairs

Residential Tenancies (Amendment) Act 1987
PROCLAMATION OF COMMENCEMENT

I, J. Davis McCaughey, Governor of Victoria, acting with the advice of the Executive Council and under section 2 of the *Residential Tenancies (Amendment) Act 1987*, fix 1 February 1988 as the day on which that Act comes into operation.

Given under my hand and the seal of Victoria on 15 December 1987.

(L.S.) J. DAVIS McCAUGHEY

By His Excellency's Command

F. N. WILKES

Minister for Housing

*Land Act 1958***PROCLAMATION OF ROAD**

I, J. Davis McCaughey, Governor of Victoria, acting with the advice of the Executive Council and under section 25 (3) (c) of the *Land Act 1958* proclaim as road the following land:

Municipal District of the Shire of Daylesford and Glenlyon

WOMBAT—Crown Allotment 7A1, section 28A, Parish of Wombat as shown on Certified Plan No. 108672 lodged in the Central Plan Office—(L1-3270).

Given under my hand and the seal of Victoria on 15 December 1987.

(L.S.) J. DAVIS McCAUGHEY

By His Excellency's Command

J. E. KIRNER

Minister for Conservation, Forests and Lands

GOVERNMENT NOTICES*Industrial Relations Act 1979***INDUSTRIAL RELATIONS COMMISSION OF VICTORIA****Long Service Leave Declarations**

Notice is hereby given that applications have been lodged by the Victorian Colleges Staff Association for declarations from the Commission that it is satisfied that the entitlements under Post Secondary Education Remuneration Tribunal Determinations No. 4 of 1983 [TAFE Leave] and No. 17 of 1985 [Advanced Education Leave], pertaining to long service leave are on a basis more favourable to workers than that prescribed by Part VII of the *Industrial Relations Act 1979*.

Pursuant to section 10 (2) (b) of the *Industrial Relations Act 1979* Commissioner Lane of the Industrial Relations Commission of Victoria will carry out an investigation in relation to these matters and report back to the Commission in Full Session.

Notice is also given that these matters are listed for hearing before Commissioner Lane at 10.00 a.m. on Monday, 11 January 1988 in Hearing Room No. 6, Level 17, Nauru House, 80 Collins Street, Melbourne.

A. S. DOWLING

Deputy Registrar

Industrial Relations Commission of Victoria

*Local Government Act 1958***VESTING OF LAND IN THE CROWN SHIRE OF KORONG**

I, James Lionel Simmonds, Minister for Local Government, being satisfied that the land hereunder has been vacant for not less than three years and that default has been made in the payment of rates on the land to the Shire of Korong for not less than five years and in pursuance of the powers vested in me by Division 7, do, by this Order, vest in the Crown the whole of the land described as Crown Allotments 22, 24, 25, 26, 27, 30, 31 and 32, section A, Township of Wehla.

Dated 11 December 1987

J. L. SIMMONDS

Minister for Local Government

Local Government Department

Melbourne (87/1621)

**MELBOURNE AND METROPOLITAN
BOARD OF WORKS**

Notice to the owners of tenements in the undermentioned streets and the private streets, lanes, courts and alleys opening thereto. The main pipe in the said streets being laid down, the owners of all tenements situated as under are hereby required on or before 25 January 1988 to cause a proper pipe and stop cocks to be laid so as to supply water within such tenements from the main pipe.

Berwick

Berwick-Cranbourne Road, from Enterprise Avenue northwards 550 metres.

Enterprise Avenue, from Berwick-Cranbourne Road north-westwards 310 metres.

Intrepid Street, from Enterprise Avenue south-westwards 146 metres.

Melverton Drive, from 66 metres east of Hallam South Road further eastwards and northwards 275 metres.

Warren Park Place, from Halcyon Way south-eastwards 40 metres.

Halcyon Way, from 240 metres south of Shrikes Road further southwards 163 metres.

Gordonia Crescent, the total street from Song Street westwards, southwards and south-eastwards.

Song Street, from 44 metres south of Cathie Court further southwards 294 metres.

Abelia Rise, the total street from Song Street eastwards and southwards.

Cornus Court, the total street from Song Street eastwards.

Chelsea

Argyle Avenue, from 108 metres north-east of Scotch Parade further north-eastwards 15 metres.

Cranbourne

Kensington Court, the total street from Willow Drive southwards.

Garfield Court, the total street from Willow Drive southwards.

Munro Close, the total street from Willow Drive southwards.

Darling Court, the total street from Willow Drive southwards.

Caroline Place, the total street from Willow Drive south-westwards.

Croydon

Jacob Court, the total street from Cecil Circuit north-eastwards.

Glenwood Drive, from 6 metres southwest of Inverness Court further south-westwards 68 metres.

Justin Court, the total street from Nangathan Way south-westwards.

Lanier Crescent, from Nangathan Way south-westwards 130 metres.

Nangathan Way, from Holloway Road southwards and south-eastwards 285 metres.

Holloway Road, from Nangathan Way westwards and south-westwards 520 metres.

Dandenong

Stephen Road, from 56 metres north of Rhur Street further northwards and westwards 248 metres.

Diamond Valley

Main Road, from 20 metres south-west of Edmonds Street further south-westwards 106 metres.

Happy Valley Rise, the total street from Main Road northwards.

Doncaster and Templestowe

Pygmalion Rise, the total street from Oakland Drive south-westwards and southwards.

Annan Place, the total street from Glendarragh Road eastwards.

Paisley Close, the total street from Glendarragh Road south-westwards.

Dundee Court, the total street from Glendarragh Road north-eastwards.

Helmsdale Retreat, from Glendarragh Road south-westwards 60 metres.

Wagon Road, from Glendarragh Road north-westwards 59 metres.

Glendarragh Road, from Reynolds Road northwards, north-westwards, north-eastwards, and eastwards 363 metres.

Eltham

Woodridge Court, the total street from Eucalyptus Road eastwards.

Knox

Waradgery Drive, from Drummond Crescent westwards 174 metres.

Lakeview Avenue, from Waradgery Drive northwards and north-eastwards 250 metres.

Ridby Mews, the total street from Waradgery Drive south-eastwards.

Waradgery Drive, from Stud Road westwards and south-westwards 226 metres.

Bickerton Court, from Waradgery Drive northwards and westwards 146 metres.

Nunawading

John Holland Court, the total street from Springfield Road southwards.

Risson Street, the total street from John Holland Court eastwards.

Meyer Close, the total street from Risson Street northwards and southwards.

Springvale

Lobelia Court, from 38 metres east of Kingstone Drive further eastwards 133 metres.

Upper Yarra

Lusatia Park Road, from southern boundary of Schoolhouse Road southwards 44 metres.

Lusatia Park Road, from southern boundary of Schoolhouse Road northwards 516 metres.

McOwan Crescent, from western boundary of Outlook Avenue westwards 70 metres.

McOwan Crescent, from western boundary of Outlook Avenue eastwards 240 metres.

Outlook Avenue, from McOwan Crescent southwards 20 metres.

Whittlesea

Maybury Drive, from Pensbury Avenue westwards 156 metres.

Glencairn Place, the total street from Maybury Drive northwards.

Pensbury Avenue, from Maybury Drive southwards 93 metres.

Norbroke Court, the total street from Pensbury Avenue eastwards.

Royston Close, the total street from Maybury Drive north-eastwards.

Hurlstone Crescent, from 30 metres north-east of Christie Avenue further north-eastwards and northwards 230 metres.

Calwell Court, the total street from Hurlstone Crescent north-westwards.

Walsh Court, the total street from Calwell Court northwards.

Pindari Avenue, from Morang Drive westwards 180 metres.

Arthur Phillip Way, from Pindari Avenue south-westwards 149 metres.

Golden Grove, the total street from Arthur Phillip Way north-westwards.

Borrowdale Court, the total street from Arthur Phillip Way eastwards.

Meadow Glen Drive, from Horseshoe Crescent southwards 178 metres.

Meadow Glen Drive, from Horseshoe Crescent northwards 22 metres.

Dressage Place, the total street from Horseshoe Crescent westwards, northwards and eastwards.

Derby Drive, from Meadow Glen Drive westwards 200 metres.

Athena Place, the total street from Merrill Drive to Derby Drive.

Horseshoe Crescent, from Meadow Glen Drive north-westwards, northwards and eastwards 359 metres.

Steeple Court, the total street from Horseshoe Crescent south-westwards.

Trotting Place, the total street from Horseshoe Crescent westwards.

Fetlock Place, the total street from Horseshoe Crescent westwards.

Dated 15 December 1987

H. G. FORD

Director of Administration and Services

Cemeteries Act 1958

SCALE OF FEES OF THE SWAN HILL MEMORIAL PARK PUBLIC CEMETERY

In pursuance of the powers conferred upon them by the Cemeteries Act the trustees of the Swan Hill Memorial Park Public Cemetery hereby make the following scale of fees, which shall come into operation upon publication in the *Government Gazette*, and from and after such publication every scale of fees heretofore made by the said trustees shall be and is hereby rescinded to the extent to which it conflicts with this scale.

	\$
<i>Private Graves</i>	
Sinking grave 2·13 m deep for interment of an adult	200.00
Sinking grave for interment of child over six years	150.00
Re-opening grave for interment of child over six years	75.00
Re-opening grave—child under 12 years	Delete
<i>Miscellaneous Charges</i>	
Bronze plaque designs/emblems or excess wording	40.00
<i>Lawn Sections (Undenominational)</i>	
Land 2·44 m × 1·22 m including first interment, granite plaque, desk and five lines of wording	700.00
Subsequent interments including plaque etc.	450.00

R. V. LOCK, Trustee

G. E. FOX, Trustee

G. C. OWERS, Trustee

H. N. FRENCH, Secretary

Approved by the Governor in Council 15 December 1987—LAWRENCE A. FISHER, Clerk of the Executive Council

*Cemeteries Act 1958***SCALE OF FEES OF THE LEOPOLD,
PORTARLINGTON AND THE DRYSDALE
PUBLIC CEMETERIES**

In pursuance of the powers conferred upon them by the Cemeteries Act the Trustees of the Leopold Public Cemetery, the Portarlington Public Cemetery and the Drysdale Public Cemetery hereby make the following scale of fees, which shall come into operation upon publication in the *Government Gazette*, and from and after such publication every scale of fees heretofore made by the said Trustees shall be and is hereby rescinded to the extent to which it conflicts with this scale.

	\$
Land—Lawn Section	300.00
Land—Monumental Section	150.00
Sinking—any depth to 2.13 m	320.00
Sinking oversize grave (extra)	50.00
Ledgers, removal	40.00
Interment of ashes in private grave	50.00
Interment of ashes in Native or Rose Garden (including supply and installation of plaque with three lines of inscription)	130.00
Additional lines of inscription to a maximum of two lines—per line	5.00
Permission to erect monument, headstone—5% of cost with a minimum of \$10	
Exhumation (when authorised)	650.00
Extra fees for a Saturday, Sunday or Public Holiday burial	
(a) Sinking	80.00
(b) Ledger removal	50.00

In witness whereof, the Common Seal of the President, Councillors and Ratepayers of the Shire of Bellarine was hereto affixed, 18 November 1987 in the presence of:

L. K. JOHNSON, President
V. F. ROBINSON, Councillor
P. L. WIGNALL, Shire Secretary

Approved by the Governor in Council, 15 December 1987—LAWRENCE A. FISHER,
Clerk of the Executive Council

*Cemeteries Act 1958***RULES AND REGULATIONS**

In pursuance of the powers conferred upon them by the Cemeteries Act the Trustees of Williamstown Public Cemetery hereby make the following Regulation which shall come into operation upon publication in the *Government Gazette*:

General Information:

The Trust has developed a Section within the Cemetery which is referred to as a Monumental Lawn area. This Section has reinforced concrete beams which have been installed by the Trust. Beam size per allotment is:

Single Beam 600 mm wide × 1220 mm long
Double Beam 1050 mm wide × 1220 mm long

Material to be used:

All monuments and markers should be of first quality natural stone, attached ornaments or symbols to be of ceramic, brass, copper, fibre glass or stainless steel.

Memorial Specifications:

Base Stone 1070 mm long × 380 mm wide × 150 mm high

(Single Beam)—Base stone to be positioned centre of beam

(Double Beam)—Base stone to be positioned with rear of stone to centre of beam.

Back of each base stone to be fixed on a common line. Rear of base stones on double beam to be sawn, butt joined and grouted. It is the Masons responsibility to make sure the dimensions of the base stones are the same in this instance. The bottom of every base stone should be dressed to an even bed so that it will stand plumb, resting firmly and level on the beam.

Provision for Floral Tributes:

Base stone to provide for at least one flower container, minimum size (circular) 75 mm diameter × 100 mm deep—(rectangular) 200 mm long × 75 mm wide × 75 mm deep.

Headstone Height and Thickness Ratio:

Height including base stone to 760 mm minimum thickness 75 mm.

Height including base stone to 920 mm minimum thickness 100 mm.

Height including base stone to 1200 mm minimum thickness 150 mm.

When a religious figure or similar item is to be mounted on H/S the H/S thickness to be not less than base size of said item.

All Headstones mounted to show a 50 mm margin from rear of base, and a 50 mm minimum margin from the ends of the base stone.

All rear faces of headstones to be fixed on a common line.

Tolerance in Dimension:

10 mm variation allowed on all dimensions, except on headstone thickness where 70 mm

minimum is for specified 75 mm and 95 mm minimum for specified 100 mm and 145 mm minimum for specified 150 mm and on lengths of base stone which must match on double beam.

Dowel Holes:

Two dowels of 10 mm or 15 mm diam. in each H/S and base combination.

Dowels to be of approved material e.g., Copper, Bronze or Stainless Steel.

Dowel Hole Positions (Base to Beam)

(1) Follow on to H/S dowel holes, in which case the dowels would be 300 mm long.

(2) Or on different centres to H/S dowels, in which case the dowels would be 150 mm long (75 into each stone).

Application for Monumental Work:

Monumental work shall not be commenced until plans and specifications have been approved by the Trustees. All applications must be in writing and shall include:

- (a) Detailed drawing of the proposed monument which clearly indicates style, size of all material and any inscription to be placed thereon.
- (b) The written consent of the Holder of the Right of Burial or other person authorised on his or her behalf.
- (c) The appropriate fees as prescribed by the Trustees.

Written approval shall be presented to the Cemetery Foreman prior to commencement of site works.

Height of Memorial:

Minimum height of a memorial, 760 mm including base stone.

Maximum height of memorial, 1200 mm including base stone.

Numbering:

All monuments must include a grave number on the front left hand corner of the base stone.

Letters to be approximately 15 mm in size.

Trade Marks:

If a Trade Name is to be included on a memorial it must be fixed to the base stone on the right front corner.

Letters to be approximately 15 mm in size.

Prohibited Material:

Memorials of cement, artificial stone, brick, composition wood, tin or iron will not be permitted.

H. B. WHITTAKER, Trustee
B. R. MOORE, Trustee
W. L. J. CROFTS, Trustee
G. J. MACGILL, Manager and Secretary

Approved by the Governor in Council, 15 December 1987—LAWRENCE A. FISHER, Clerk of the Executive Council

Cemeteries Act 1958

SCALE OF FEES OF THE BALLAN NEW PUBLIC CEMETERY

In pursuance of the powers conferred upon them by the Cemeteries Act the trustees of the Ballan New Public Cemetery hereby make the following scale of fees, which shall come into operation upon publication in the *Government Gazette*, and from and after such publication every scale of fees heretofore made by the said trustees shall be and is hereby rescinded to the extent to which it conflicts with this scale.

	\$
For inspection of Plans and Registers	10.00
Search fees for each enquiry and Extract issued	10.00
To affix/and or remove any Plaque	20.00

L. V. BURVILL, Trustee
R. J. MEADOWS, Trustee
M. J. TRICKEY, Trustee

Approved by the Governor in Council, 15 December 1987—LAWRENCE A. FISHER, Clerk of the Executive Council

Cemeteries Act 1958

RULES AND REGULATIONS

In pursuance of the powers conferred upon them by the Cemeteries Act the Trustees of Swan Hill Memorial Park hereby make the following amendments to their Regulations which shall come into operation upon publication in the *Government Gazette*:

Item 1. Wholly delete and insert in lieu thereof the following—

“Cemetery” means Swan Hill Memorial Park.

“Trustees” means the Trustees of the Swan Hill Memorial Park.

“Lawn Section” means those portions of the Swan Hill Memorial Park planted to lawn.

Item 7. Wholly delete and insert in lieu thereof the following—

In the section denominated Lawn “A” only bronze plaques 380 × 280 mm which are approved by the Trustees may be permitted as memorials. In the case of a second interment another bronze plaque of similar size may be placed immediately below and abutting the first plaque or alternatively a new plaque with appropriate inscription may replace the first plaque.

In the section denominated Lawn "B" only granite memorials as approved by the Trustees and erected by a contractor nominated by the Trustees are permitted.

R. V. LOCK, Trustee
G. E. FOX, Trustee
G. C. OWERS, Trustee
H. N. FRENCH, Secretary

Approved by the Governor in Council, 15 December 1987—LAWRENCE A. FISHER, Clerk of the Executive Council

Transport Act 1983

ROAD TRAFFIC AUTHORITY

Commercial Passenger Vehicle and Tow Truck Applications

Notice is hereby given that the following applications will be considered by the Road Traffic Authority on 27 January 1988.

Notice of any objections should be forwarded to reach the Manager, Vehicle Licensing Branch or any Regional Office of the Road Traffic Authority not later than 20 January 1988.

It will not be necessary for interested parties to appear on the hearing date specified, unless advised in writing by the Authority.

Notification of the date for consideration of applications which are objected to and which require determination by the Road Transport Licensing Tribunal will be published by further notice in this Gazette.

Azgold Pty. Ltd., Diamond Creek. Application to license one restricted class 1 tow truck, to be purchased, to operate throughout the State of Victoria from a depot situated at 73 Main Hurstbridge Road, Diamond Creek for the purpose of lifting and carrying or towing damaged or disabled motor cars in the course of business as an RACV contractor, but excluding the ability to attend the scene of a motor car accident.

N. J. Bull, Ormond. Application to license one commercial passenger vehicle with seating capacity for 7 passengers to operate a service as and when required for the carriage of children attending the applicant's Wilmar Day Centre between the centre and schools and kindergartens in the South Caulfield area.

Fares: Included in the overall cost of child care fees.

F. Burnham, Cheltenham. Application for variation of the conditions of tow truck licence number 504 which authorises the licensed vehicle to be managed, controlled and operated from the depot situated at 63 Grange Road, Cheltenham to change the depot address to 18-20 Balcombe Road, Mentone.

Note:

- (i) The licensed vehicle is a class 1 conventional tow truck.
- (ii) The licensed vehicle is currently under consideration for transfer to Spruce Body Works Pty. Ltd. of 18-20 Balcombe Road, Mentone.

Application for variation of the conditions of tow truck licence number 505 which authorises the licensed vehicle to be managed, controlled and operated from the depot situated at 63 Grange Road, Cheltenham to change the depot address to 411 Bay Road, Cheltenham.

Note:

- (i) The licensed vehicle is a class 1 conventional tow truck.
- (ii) The licensed vehicle is currently under consideration for transfer to Coastline Towing Pty Ltd of 411 Bay Road, Cheltenham.

Farrow Pines Pty. Ltd., Blackburn. Application to license two commercial passenger vehicles in respect of Toyota Troop Carriers to be purchased each with seating capacity for 12 passengers to operate a service for the carriage of passengers in connection with "The Outdoor Activities Group Inc." from base camps on half day, day, 3, 5, 7 and 10 day courses conducted within the following areas: Eildon; Macalister River; McKillops Bridge Snowy River; Howqua River; King River; Bogong High Plains; Omeo; The Grampians; Mt Arapiles; Big River; Mt Stirling; Lake Mountain; Mt Baw Baw; Mt St Gwinneer; Dargo High Plains; Bemm River; Wilsons Promontory; Lorne; Cumberland River; Ballarat; Mt Cole State Forest; Shoreham; Daylesford; Warburton.

Timetable: As and when required.

Fares: Included in the overall cost of the course provided.

Note:

The only passengers to be carried will be students participating in outdoor education courses provided by "The Outdoor Activities Group Inc."

J. Maniatis, Chadstone. Application to license one commercial passenger vehicle in respect of a 1981 Statesman Caprice sedan with seating capacity for 5 passengers to operate as a special purpose vehicle from 1 Burton Street Chadstone for the carriage of passengers for wedding parties.

R. I. Thomas, Thomastown. Application for variation of the conditions of tow truck licence number 856 which authorises the licensed vehicle to be:

- (i) Managed, controlled and operated from the depot situated at Lot 2 Brock Street, Thomastown.
- (ii) Used in the course of the licence holders business as "Motor Wrecker" for the purpose of collecting damaged or disabled motor vehicles throughout the State of Victoria for return to the licence holders premises at Thomastown—damaged and disabled motor vehicles owned by the licence holder only.

To include the ability to pick up damaged, disabled and undamaged motor cars belonging to clients of the applicant to and from the applicant's premises for mechanical repair and return but excluding the ability to attend the scene of a motor car accident.

Dated 23 December 1987

M. McQUILLEN
Group Manager

Vehicle Licensing and Regulation Strategies

Town and Country Planning Act 1961
SHIRE OF BACCHUS MARSH PLANNING
SCHEME

Amendment No. 49
Notice of Approval

In pursuance of the powers conferred by the *Town and Country Planning Act 1961*, the Governor in Council on 15 December 1987, approved the abovementioned scheme in respect of the municipal district of the Shire of Bacchus Marsh and for which the Shire of Bacchus Marsh is the responsible authority.

The scheme comes into operation on the date this notice is published in the *Government Gazette*.

The scheme includes an ordinance variation to include "fuel depot" as a Column 4 or discretionary use in the Commercial Central zone, Commercial General zone and Commercial Local zone.

A copy of the documents may be inspected free of charge, during office hours, at the office of the Ministry for Planning and Environment, The Olderfleet Buildings, 477 Collins Street, Melbourne and at the office of the responsible authority, the Shire of Bacchus Marsh, Shire Offices, Bacchus Marsh.

DAVID YENCKEN
Secretary for Planning and Environment

Town and Country Planning Act 1961
CITY OF BENALLA PLANNING SCHEME
Amendment No. 45
Notice of Approval

In pursuance of the powers conferred by the *Town and Country Planning Act 1961*, the

Governor in Council on 15 December 1987 approved the abovementioned scheme in respect of the municipal district of the City of Benalla and for which the Council of the City of Benalla is the responsible authority.

The scheme comes into operation on the date this notice is published in the *Government Gazette*.

The scheme includes the rezoning of land described as part crown allotments 2 and 3, section 16, City of Benalla, located at the rear of Number 42 Boger Street, Benalla to Residential A zone and the variation of the minimum building set-back provisions in the Planning Scheme Ordinance is so far as they relate to the Residential zones.

A copy of the documents may be inspected free of charge, during office hours, at the office of the Ministry for Planning and Environment, The Olderfleet Buildings, 477 Collins Street, Melbourne and at the office of the responsible authority, the City of Benalla, Civic Centre, Fawckner Drive, Benalla.

DAVID YENCKEN
Secretary for Planning and Environment

Town and Country Planning Act 1961
SHIRE OF SHEPPARTON PLANNING
SCHEME 1983

Amendment No. 3, 1985
Notice of Approval

In pursuance of the powers conferred by the *Town and Country Planning Act 1961*, the Governor in Council on 15 December 1987 approved the abovementioned scheme in respect of the municipal district of the Shire of Shepparton and for which the Council of the Shire of Shepparton is the responsible authority.

The scheme comes into operation on the date this notice is published in the *Government Gazette*.

The scheme includes the rezoning of land described as Crown allotment 79H, Parish of Kialla from Existing Public Purpose Reserve to Residential zone.

A copy of the documents may be inspected free of charge, during office hours, at the office of the Ministry for Planning and Environment, The Olderfleet Buildings, 477 Collins Street, Melbourne and at the office of the responsible authority, the Shire of Shepparton, 21 Nixon Street, Shepparton.

DAVID YENCKEN
Secretary for Planning and Environment

Town and Country Planning Act 1961
**THE UNITED SHIRE OF BEECHWORTH
(TOWNSHIP OF BEECHWORTH)
PLANNING SCHEME**

Amendment No. 6, 1985

Notice of Approval

In pursuance of the powers conferred by the *Town and Country Planning Act 1961*, the Governor in Council on 15 December 1987 approved the abovementioned scheme in respect of the municipal district of the United Shire of Beechworth and for which the Council of the United Shire of Beechworth is the responsible authority.

The scheme comes into operation on the date this notice is published in the *Government Gazette*.

The scheme prohibits the development of Adult Sex Book, Sex Aid Shops and Brothels in all zones within the Township of Beechworth.

A copy of the documents may be inspected free of charge, during office hours, at the office of the Ministry for Planning and Environment, The Olderfleet Buildings, 477 Collins Street, Melbourne and at the office of the responsible authority, The United Shire of Beechworth, Shire Offices, Ford Street, Beechworth.

DAVID YENCKEN
Secretary for Planning and Environment

Town and Country Planning Act 1961
**CITY OF SHEPPARTON PLANNING
SCHEME**

Amendment No. 110, 1986

Notice of Approval

In pursuance of the powers conferred by the *Town and Country Planning Act 1961*, the Governor in Council on 15 December 1987 approved the abovementioned scheme in respect of the municipal district of the City of Shepparton and for which the City of Shepparton is the responsible authority.

The scheme comes into operation on the date this notice is published in the *Government Gazette*.

The scheme allows the rezoning and relocation of a 1 hectare Public Open Space Reservation off Parkside Drive, Shepparton, to allow the redesign of a residential subdivision due to the location of a floodway.

A copy of the documents may be inspected free of charge, during office hours, at the office of the Ministry for Planning and Environment, The Olderfleet Buildings, 477 Collins Street,

Melbourne, and at the office of the responsible authority, Civic Centre, Shepparton.

DAVID YENCKEN
Secretary for Planning and Environment

Town and Country Planning Act 1961
PORTLAND PLANNING SCHEME

Amendment No. 55A

Notice of Approval

In pursuance of the powers conferred by the *Town and Country Planning Act 1961*, the Governor in Council on 15 December 1987 approved the abovementioned scheme in respect of the municipal district of the City of Portland for which the City of Portland is the responsible authority.

The scheme comes into operation on the date this notice is published in the *Government Gazette*.

The scheme includes the rezoning of approximately 10 hectares of land at West Portland to Residential D (low density residential).

A copy of the documents may be inspected free of charge, during office hours, at the office of the Ministry for Planning and Environment, The Olderfleet Buildings, 477 Collins Street, Melbourne, and at the City of Portland, Municipal Offices, Charles Street, Portland.

DAVID YENCKEN
Secretary for Planning and Environment

Town and Country Planning Act 1961
**SHIRE OF TAMBO (BALANCE OF SHIRE)
PLANNING SCHEME**

Interim Development Order

Amendment No. 26

Notice of Amendment

In pursuance of the powers conferred by the *Town and Country Planning Act 1961*, the Governor in Council on 15 December 1987 amended the abovementioned Order in respect of the municipal district of the Shire of Tambo and for which the Shire of Tambo is the responsible authority.

The amendment comes into operation on the date this notice is published in the *Government Gazette*.

The amendment includes the rezoning of land fronting Stirling Road, Metung, from Existing Public Open Space to Residential.

A copy of the documents may be inspected free of charge, during office hours, at the office of the Ministry for Planning and Environment, The Olderfleet Buildings, 477 Collins Street,

Melbourne, and at the office of the Shire of Tambo, Shire Offices, 51 Main Street, Bruthen.

DAVID YENCKEN
Secretary for Planning and Environment

Town and Country Planning Act 1961
CITY OF SHEPPARTON PLANNING
SCHEME 1953

Amendment No. 117, 1987

Notice of Approval

In pursuance of the powers conferred by the *Town and Country Planning Act 1961*, the Governor in Council on 15 December 1987 approved the abovementioned scheme in respect of the municipal district of the City of Shepparton and for which the Council of the City of Shepparton is the responsible authority.

The scheme comes into operation on the date this notice is published in the *Government Gazette*.

The scheme allows the rezoning of land known as Nos 46 to 54 Macintosh Street, Shepparton from Residential C to Commercial C zoning to enable the establishment of local shops in a residential area of Shepparton.

A copy of the documents may be inspected free of charge, during office hours, at the office of the Ministry for Planning and Environment, The Olderfleet Buildings, 477 Collins Street, Melbourne, and at the office of the responsible authority, the City of Shepparton, Civic Centre, Shepparton.

DAVID YENCKEN
Secretary for Planning and Environment

Town and Country Planning Act 1961
GISBORNE SHIRE PLANNING SCHEME

Amendment No. 32

Notice of Amendment

In pursuance of the powers conferred by the *Town and Country Planning Act 1961*, the Governor in Council, on 15 December 1987, amended the abovementioned scheme in respect of the municipal district of the Shire of Gisborne and for which the Shire of Gisborne is the responsible authority.

The amendment comes into operation on the date this notice is published in the *Government Gazette*.

The amendment is for the use and development of Lot 22 and Part Lot 21, LP 5477, Nolan Road, Riddells Creek, for the purpose of a Time Share Resort subject to the grant of a permit by Council.

A copy of the documents may be inspected free of charge, during office hours, at the office of the Ministry for Planning and Environment, The Olderfleet Buildings, 477 Collins Street, Melbourne and at the office of the responsible authority, Shire of Gisborne, Robertson Street, Gisborne.

DAVID YENCKEN
Secretary for Planning and Environment

Town and Country Planning Act 1961
MELBOURNE METROPOLITAN
PLANNING SCHEME

Amendment No. 430, Part 1

Notice of Approval

In pursuance of the powers conferred by the *Town and Country Planning Act 1961*, the Governor in Council, on 15 December 1987, approved the abovementioned scheme for which the Minister for Planning and Environment is the responsible authority.

The scheme comes into operation on the date this notice is published in the *Government Gazette*.

The scheme includes various routine rezonings which affect various pieces of land throughout the metropolitan area.

A copy of the documents may be inspected free of charge, during office hours, at the office of the Ministry for Planning and Environment, The Olderfleet Buildings, 477 Collins Street, Melbourne.

DAVID YENCKEN
Secretary for Planning and Environment

Town and Country Planning Act 1961
MELBOURNE METROPOLITAN
PLANNING SCHEME

Amendment No. 515

Notice of Amendment

In pursuance of the powers conferred by the *Town and Country Planning Act 1961*, the Governor in Council, on 15 December 1987, amended the abovementioned scheme for which the Minister for Planning and Environment is the responsible authority.

The amendment comes into operation on the date this notice is published in the *Government Gazette*.

The amendment includes several minor changes to the Ordinance to correct various minor errors.

A copy of the documents may be inspected free of charge, during office hours, at the office of the Ministry for Planning and Environment, The

Olderfleet Buildings, 477 Collins Street,
Melbourne.

DAVID YENCKEN
Secretary for Planning and Environment

Pipelines Act 1967, No. 7541
**DEPARTMENT OF INDUSTRY,
TECHNOLOGY AND RESOURCES**
Variation to the Route of a Pipeline

I, Robert Clive Fordham, Minister for Industry, Technology and Resources for the State of Victoria, hereby give notice in accordance with the provisions of section 12 of the *Pipelines Act 1967, No. 7541*, that the route of the pipeline for which Permit No. 14 to own and use, has been granted by me to the Gas and Fuel Corporation of Victoria, is varied as follows:

DELETION of the expression—"and extending in a northerly and westerly direction to enter the Gas and Fuel Corporation of Victoria's gas manufacturing works at West Melbourne situated at the corner of Cowper and Pigott Streets;"; and

SUBSTITUTING in lieu the expression—"and extending in a northerly and westerly direction to terminate at a point in Spencer Street, Melbourne, adjacent to the northern abutment of the Spencer Street Bridge, on its western side," and as more particularly shown on the Gas and Fuel Corporation's Plan No. T3-1-1, a copy of which is held in the office of the Department of Industry, Technology and Resources.
Dated 18 December 1987

R. C. FORDHAM
Minister for Industry, Technology and Resources

Pipelines Act 1967, No. 7541
**DEPARTMENT OF INDUSTRY,
TECHNOLOGY AND RESOURCES**
Variation to the Route of a Pipeline

I, Robert Clive Fordham, Minister for Industry, Technology and Resources for the State of Victoria, hereby give notice in accordance with the provisions of section 12 of the *Pipelines Act 1967, No. 7541*, that the route of the pipeline for which Permit No. 36 to own and use, has been granted by me to the Gas and Fuel Corporation of Victoria, is varied as follows:

DELETION of the expression—"thence continuing in a generally westerly direction via Queens Wharf Road, Spencer Street, Siddeley Street, North Wharf Road and Footscray Road to terminate at the Gas and Fuel Corporation of Victoria's manufacturing works in Blyth Street, West Melbourne;"; and

SUBSTITUTING in lieu the expression—"thence continuing in a generally westerly direction via Queens Wharf Road, Spencer Street, Flinders Street, North Wharf Road and Footscray Road to terminate at the Gas and Fuel Corporation of Victoria's regulating station in Blyth Street, West Melbourne," and as more particularly shown on the Gas and Fuel Corporation's Plan No. T16-1-1, a copy of which is held in the office of the Department of Industry, Technology and Resources.
Dated 18 December 1987

R. C. FORDHAM
Minister for Industry, Technology and Resources

Pipelines Act 1967, No. 7541
**DEPARTMENT OF INDUSTRY,
TECHNOLOGY AND RESOURCES**
Variation to the Route of a Pipeline

I, Robert Clive Fordham, Minister for Industry, Technology and Resources for the State of Victoria, hereby give notice in accordance with the provisions of section 12 of the *Pipelines Act 1967, No. 7541*, that the route of the pipeline for which Permit No. 56 to own and use, has been granted by me to the Gas and Fuel Corporation of Victoria, is varied as follows:

DELETION of the expression—"thence turning to enter and continue in a north-north-westerly direction along Clarendon Street to the River Yarra, thence crossing such river to enter Spencer Street, City of Melbourne, and continue in a north-north-westerly direction to Little Dock Road, thence turning to enter and continue in a west-south-westerly direction along such road to Siddeley Street, thence entering and continuing in a west-south-westerly direction along Siddeley Street to North Wharf Road, thence turning to enter and continue in a westerly direction along North Wharf Road to Footscray Road, thence turning to enter and continue in a north-westerly direction along such road to terminate at a valve inside the Corporation's West Melbourne regulator station situated on Allotments B, B1, B2, B3, B4, B44, and B45, City of Melbourne, Parish of Melbourne North."; and

SUBSTITUTING in lieu the expression—"thence turning to enter and continue in a north-north westerly direction along Clarendon Street to the River Yarra, thence crossing such river to enter Spencer Street, City of Melbourne, to terminate at a point in such Street, adjacent to the northern abutment of the Spencer Street Bridge, on its western side," and as more particularly shown on the Gas and Fuel Corporation's Plan No. T17-1-1, a copy of which is held in the office of the Department of Industry,

Technology and Resources.
Dated 18 December 1987

R. C. FORDHAM
Minister for Industry, Technology and Resources

I, Joan Elizabeth Kirner, Minister for Conservation, Forests and Lands under Section 13(1) of the *Crown Land (Reserves) Act 1978* have made the following Regulations for the land in the Township of Nariel temporarily reserved by Order in Council dated 14 September 1936, as a site for camping purposes, from now on referred to as the "Reserve".

The Reserve has, under the provisions of section 14 of the *Crown Land (Reserves) Act 1978*, been placed under the control of a Committee of Management (from now on referred to as the "Committee"), with power and authority to enforce the following Regulations.

REGULATIONS

1. The Reserve shall be open to the public at all times subject to such terms and conditions and the payment of such fees as may be determined by the Committee from time to time.

2. The Committee may from time to time set aside such portion or portions of the Reserve as may be required for the holding of any public entertainment, games, sports, camping or the parking of vehicles and no person shall use any such portion or portions other than for the purpose or purposes for which it has been set apart and then only subject to such terms and conditions and on payment of such fees as may be prescribed by the Committee.

3. No person shall—

- (a) enter or remain in the Reserve who may offend against decency as regards dress, language or conduct;
- (b) commit any nuisance in the Reserve;
- (c) climb or jump over the gates or fences in or around the Reserve, stick bills thereon, or cut names on or in any way damage or injure any of the buildings, gates, fences or seats in the Reserve, nor leave or deposit any glass, paper, rubbish or other unwanted material or thing in the Reserve except in receptacles provided for the purpose;
- (d) light any fires in the Reserve except in any place or places which may be provided for the purpose by the Committee;
- (e) remove any sand, soil, gravel or rock from the Reserve;
- (f) damage any vegetation or interfere with or disturb any sand, stone, gravel, rock, clay or other earth by driving any vehicle or by any other means;

- (g) drive any vehicle in a manner dangerous to the public;
- (h) drive any vehicle so as to cause noise which is unreasonable in the circumstances.

4. No person, unless authorised in writing and then only subject to such terms, fees and conditions as may be prescribed by the Committee, shall—

- (a) set up or occupy within the Reserve a camp or caravan;
- (b) bring into the Reserve any dog unless such dog is and continues to be at all times controlled by a chain or leash and any dog found in the Reserve except as provided shall be seized and disposed of by the Committee;
- (c) bring into the Reserve any horses, cattle, sheep, pigs, goats or other animals;
- (d) sell or offer for sale in the Reserve any article or any commodity whatsoever;
- (e) organise or take part in any public entertainment, game or sport in the Reserve;
- (f) in the Reserve carry a firearm of any description or any weapon or instrument capable of discharging a missile, shoot at, or kill or injure any animal, bird or other wildlife; provided that subject to the provisions of the *Game Act 1958*, the holder of a current game licence legally in pursuit of wild ducks during the open season for such ducks may—
 - (i) use a shot gun as defined under the *Game Act 1958*; and
 - (ii) carry a shot gun during the twenty-four (24) hour period immediately prior to said open season.

Given under my hand at Melbourne on 14 December 1987

J. E. KIRNER
Minister for Conservation, Forests and Lands

Every person who contravenes or fails to comply with these regulations shall be liable to the penalties prescribed in section 13 of the *Crown Land (Reserves) Act 1978*.

Education Act 1958

NOTICE OF THE MAKING OF AN ORDER UNDER SECTION 13 (1) OF THE ACT

Pursuant to section 13 of the *Education Act 1958*, I hereby give notice that an Order of the Governor in Council was made on 15 December 1987 under sub-section (1) of the said Act

constituting a council for the 5135 Kingsley Park Primary School.

CAROLINE HOGG
Minister for Education

Education Act 1958

NOTICE OF THE MAKING OF AN ORDER UNDER SECTIONS 13 (1), (4) AND (5) OF THE ACT

Under section 13 of the *Education Act 1958*, I hereby give notice that an Order of the Governor in Council was made on 15 December 1987 under sub-section (1) constituting a council for:

- 5271 Richmond Community Primary School
 - 8737 Richmond Secondary College
 - 8732 Caulfield Secondary College
 - 8738 Western Heights Secondary College
 - 7503 Albert Park High School and 7335 South Melbourne Technical School;
- and under sub-section (4) dissolving the council for:
- 2798 Richmond North Primary School and 1567 Richmond Primary School
 - 7305 Richmond Technical School and 8269 Richmond High School
 - 7705 Caulfield High School and 7709 Caulfield Technical School
 - 7580 Bell Park High School and 7170 Geelong West Technical School
 - 7503 Albert Park High School

7335 South Melbourne Technical School and under sub-section (5) directing the disposal of any assets of the council for the:

- 2798 Richmond North Primary School and 1567 Richmond Primary School
- 7305 Richmond Technical School and 8269 Richmond High School
- 7705 Caulfield High School and 7709 Caulfield Technical School
- 7580 Bell Park High School and 7170 Geelong West Technical School
- 7503 Albert Park High School
- 7335 South Melbourne Technical School

CAROLINE HOGG
Minister for Education

Police Regulation Act 1958

SALE OF UNCLAIMED PROPERTY

Section 122

An owner is required for a black Honda motor cycle, Registered No. NT 751, Engine No. CB 750E2528655, Chassis No. CB750F1016185, which came into the possession of Police on 4 December 1986.

Should this vehicle not be claimed it will be sold by public auction at 10.00 a.m. on Thursday, 28 January 1988, at the Seymour Police Station, 34 Tallarook Street, Seymour.

K. GLARE
Chief Commissioner of Police

Private Agents Act 1966

NOTICE OF RECEIPT OF APPLICATIONS FOR LICENCES UNDER THE PROVISIONS OF THE PRIVATE AGENTS ACT 1966

The Clerk(s) of the Magistrates' Court(s) as listed hereunder hereby give notice that applications, as under, have been lodged for hearing by the said Court(s) on the date(s) specified.

Any person desiring to object to any of such applications must—

- (a) lodge with the respective Clerk of the Magistrates' Court a notice in the prescribed form of his objection and of the grounds thereof;
- (b) cause a copy of such notice to be served personally or by post upon the applicant at least three days before the hearing of the application; and
- (c) send or deliver—
 - (i) where the objection is not made by the officer in charge of the police district in which the Court is situated—a copy of the notice to such officer; and
 - (ii) where the objection is not made by the Registrar or Deputy Registrar—a copy to the Registrar.

Full Name of Applicant*	Place of Abode of Applicant or Nominee	Name of Firm or Corporation	Address for Registration	Type of Licence	Date of Hearing
-------------------------	--	-----------------------------	--------------------------	-----------------	-----------------

MAGISTRATES' COURT, SPRINGVALE

Laird, Mark Alexander	65 Albany Cres, Aspendale		41 Fairview St, Springvale	Watchman	11.1.88
-----------------------	---------------------------	--	----------------------------	----------	---------

Dated at Springvale, 8 December 1987
M. J. BOURKE, Clerk of the Magistrates' Court

PRIVATE AGENTS—continued

Full Name of Applicant*	Place of Abode of Applicant or Nominee	Name of Firm or Corporation	Address for Registration	Type of Licence	Date of Hearing
MAGISTRATES' COURT, RINGWOOD					
Klebanowski, Pawel	1A Cluney Crt, South Blackburn		634 Graham St, Port Melbourne	Watchman	18.1.88
Dated at Ringwood, 11 December 1987 D. REES, Clerk of the Magistrates' Court					
MAGISTRATES' COURT, MILDURA					
Meredith, Terrance David	16th Street, Irymple		18 De Garis Dve, Mildura	Watchman	11.1.88
Dated at Mildura, 1 December 1987 K. CROTTY, Clerk of the Magistrates' Court					
MAGISTRATES' COURT, HEIDELBERG					
Hayward, Peter George	7 Dempster Crt, Donvale		7 Dempster Crt, Donvale	Inquiry Agent (Individual)	11.1.88
Dated at Heidelberg, 1 December 1987 R. W. COOK, Clerk of the Magistrates' Court					
MAGISTRATES' COURT, HEIDELBERG					
Davernaris, Harry	22 Richardson St, Thomastown		13 Bainbridge Dve, Eltham	Watchman	18.1.88
Fraunfelder, Robert	74 Blake St, Preston		" "	" "	" "
McDonald, Scott Adrian	46 Templestowe Rd, Bulleen		" "	" "	" "
Dated at Heidelberg, 9 December 1987 R. W. COOK, Clerk of the Magistrates' Court					
MAGISTRATES' COURT, HEIDELBERG					
Cronin, James Patrick	5 Hermann Crt, Templestowe		5 Hermann Crt, Templestowe	Process Server (Individual)	15.1.88
Dated at Heidelberg, 14 December 1987 R. W. COOK, Clerk of the Magistrates' Court					
MAGISTRATES' COURT, MILDURA					
Christian, Peter Francis	28 Christie Pde, Mildura	S.P.I. Investigations	28 Christie Pde, Mildura	Inquiry Agent (Firm)	21.12.87
Dated at Mildura, 30 November 1987 K. CROTTY, Clerk of the Magistrates' Court					

*Or in the case of a firm or corporation, of the Nominee

PRIVATE AGENTS—continued

Full Name of Applicant*	Place of Abode of Applicant or Nominee	Name of Firm or Corporation	Address for Registration	Type of Licence	Date of Hearing
MAGISTRATES' COURT, BENDIGO					
Abley, Christopher Grant	2/10 Lawson St, Spring Gully	Moore Data Management Services	2/10 Lawson St, Spring Gully	Commercial Sub-Agents	11.1.88
Dated at Bendigo, 15 December 1987 T. J. NIHILL, Clerk of the Magistrates' Court					
MAGISTRATES' COURT, PORT MELBOURNE					
Abbey, Wayne Richard	8 Lawley St, Reservoir	Armaguard	152 Turner St, Port Melbourne	Watchman	28.1.88
Halamboulis, Steven	83 Dundas St, Preston	"	"	"	"
Dated at Port Melbourne, 15 December 1987 B. THIELE, Clerk of the Magistrates' Court					
MAGISTRATES' COURT, HELDELBERG					
Robertson, Mark Leonard	39 Marie Ave, West Heidelberg		15 Tarakan St, West Heidelberg	Watchman	15.1.88
Dated at Heidelberg, 15 December 1987 R. W. COOK, Clerk of the Magistrates' Court					
MAGISTRATES' COURT, BROADMEADOWS					
Mulquiney, Wayne Francis	114 Longana Ave, Glenroy		114 Longana Ave, Glenroy	Watchman	22.12.87
Dated at Brownmeadows, 14 December 1987 J. ISAACS, Clerk of the Magistrates' Court					
MAGISTRATES' COURT, WODONGA					
Roberts, Michael David Arthur	1/458 Kemp St, Lavington, NSW		14 Weeks Cres, Wodonga	Watchman	19.1.88
Dated at Wodonga, 11 December 1987 P. G. DODGSON, Clerk of the Magistrates' Court					
MAGISTRATES' COURT, MANSFIELD					
Bruce, Iain Robert Sutherland	Rifle Butts Rd, Piries		Rifle Butts Rd, Piries	Guard Agent Process Server	7.1.88
" "	" "		" "	"	"
Holzapfer, Leonard David Graham	" "		" "	Guard Agent Process Server	"
" "	" "		" "	"	"
Dated at Mansfield, 7 December 1987 W. F. FROUDE, Clerk of the Magistrates' Court					

*Or in the case of a firm or corporation, of the Nominee

PRIVATE AGENTS—continued

<i>Full Name of Applicant*</i>	<i>Place of Abode of Applicant or Nominee</i>	<i>Name of Firm or Corporation</i>	<i>Address for Registration</i>	<i>Type of Licence</i>	<i>Date of Hearing</i>
MAGISTRATES' COURT, PRESTON					
Kirkopoulos, Nick	36 Edmason St, Lalor		45 Talbot Ave, Thomastown	Watchman	11.1.88
Peterson, Wayne	12 Gillespie Pl, Epping		" "	"	"
Temouskos, Tom	45B Talbot Ave, Thomastown		" "	"	"
Dated at Preston, 10 December 1987 R. McHUGH, Clerk of the Magistrates' Court					
MAGISTRATES' COURT, HEIDELBERG					
West, Susan Elizabeth	42 Kantiki Dve, Epping		8 Rooney St, Templestowe	Inquiry Agent	11.1.88
" "	" "		" "	Process Server	"
Cattell, Terence James	1 Mayling Crt, Watsonia		1 Huston Crt, Reservoir	Watchman	"
Dated at Heidelberg, 4 December 1987 R. W. COOK, Clerk of the Magistrates' Court					
MAGISTRATES' COURT, TRARALGON					
Clough, Gail Gloria	62 Stockdale Rd, Traralgon		62 Stockdale Rd, Traralgon	Watchman	15.1.88
Dated at Traralgon, 14 December 1987 Clerk of the Magistrates' Court					
MAGISTRATES' COURT, RINGWOOD					
Clark, Matthew Jason	37/3 Albert St, Ringwood		37/3 Albert St, Ringwood	Watchman	14.1.88
Bryan, Russell Richard	159 Lincoln Rd, Croydon		159 Lincoln Rd, Croydon	Inquiry Agent	11.1.88
Dated at Ringwood, 7 December 1987 D. REES, Clerk of the Magistrates' Court					
MAGISTRATES' COURT, LILYDALE					
Hughes, Ian Arthur	35 Middleton Dve, Woori Yallock		35 Middleton Dve, Woori Yallock	Inquiry Agent	11.1.88
Dated at Lilydale, 9 December 1987 S. PARSONS, Clerk of the Magistrates' Court					
MAGISTRATES' COURT, LILYDALE					
Bernsten, Darren Carl	56 The Boulevard, Montrose		56 The Boulevard, Montrose	Inquiry Agent	11.1.88
Dated at Lilydale, 4 December 1987 S. PARSONS, Clerk of the Magistrates' Court					

*Or in the case of a firm or corporation, of the Nominee

APPOINTMENTS

APPOINTMENTS

His Excellency the Governor of the State of Victoria by and with the advice of the Executive Council thereof has by Order made on 15 December 1987 been pleased to make the undermentioned appointments viz:

Department of Health

Dental Technicians Licensing Committee

Robert HILL,
Terry WORT,
John GODFREY,
Trevor KNIGHT,
Laurie DOUPE,
Donald OAKES, and
Gordon LOVEL

to be Members, Dental Technicians Licensing Committee, pursuant to section 3 of the *Dental Technicians Act 1972* for the period ending 29 October 1991.

Trustees of Public Cemeteries

John Charles DANIEL,
to be a Trustee of the Cape Clear Public Cemetery, pursuant to section 3 (1) of the *Cemeteries Act 1958*

Gerard MORRISEY and
Robert GREIG

to be Trustees of the Caramut Public Cemetery, pursuant to section 3 (1) of the *Cemeteries Act 1958*.

Attorney General's Department

Acting Director of Public Prosecutions

Leonard William FLANAGAN, Q.C. to be Acting Director of Public Prosecutions pursuant to section 7 (1) of the *Director of Public Prosecutions Act 1982*, from 3 January 1988 to 31 January 1988, inclusive.

Magistrates

Jillian Mary CROWE, a Barrister and Solicitor of the Supreme Court of Victoria, to be a Magistrate pursuant to section 7 of the *Magistrates' Courts Act 1971* for a period of office from 1 February 1988.

Wendy Anne WILMOTH, a Barrister and Solicitor of the Supreme Court of Victoria, to be a Magistrate pursuant to section 7 of the *Magistrates' Courts Act 1971* for a period of office from 1 February 1988.

LAWRENCE A. FISHER
Clerk of the Executive Council

At the Executive Council Chamber
Melbourne, 15 December 1987

ORDERS IN COUNCIL

Local Government Act 1958

RETENTION OF LAND FOR MUNICIPAL PURPOSES

City of Nunawading

The Governor in Council acting under section 526 of the *Local Government Act 1958* approves of the Council of the City of Nunawading retaining the land shown by cross-hatching on the plan hereunder for municipal purposes.

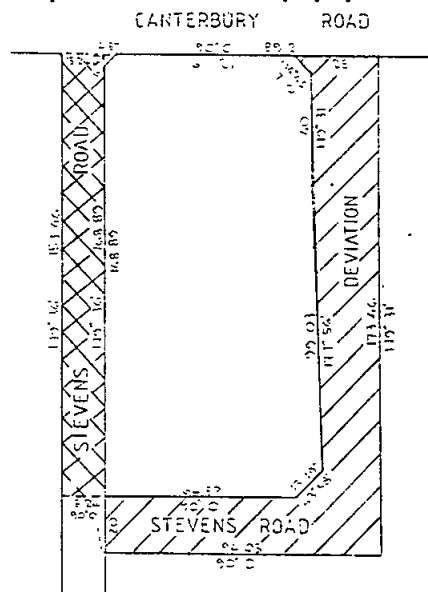

Dated 15 December 1987

Responsible Minister:

J. L. SIMMONDS
Minister for Local Government

LAWRENCE A. FISHER
Clerk of the Executive Council

Local Government Act 1958

RESUBDIVISION OF THE MUNICIPAL DISTRICT OF THE SHIRE OF VIOLET TOWN

The Governor in Council, acting under Part II of the *Local Government Act 1958*, orders—

1. that on and from 1 April 1988 the municipal district of the Shire of Violet Town shall be resubdivided into three ridings whose names and boundaries are described hereunder;
2. that the number of councillors shall be nine.

North Riding
Enlarged and Re-defined
Previous Gazettal 1895.1467

Commencing on the western boundary of the Shire at Fishers Lane, thence easterly by that lane and the road forming the southern boundary of allotment 81, Parish of Tamleugh to the south-eastern angle of that allotment, thence northerly by the road forming the eastern boundary of allotment 81 to the south-western angle of allotment 83, thence easterly by the road forming the southern boundaries of allotments 83 and 84, and by Fishers Lane to the Violet Town-Dookie Road, thence southerly and south-westerly by that road to Shiffner Street, thence north-westerly by that street to Mitchell Street, thence south-westerly by that street, the western boundary of allotment 1, section 25, Township of Violet Town and a line in continuation thereof to Honeysuckle Creek, thence generally south-easterly by Honeysuckle Creek to the North Eastern Railway, thence north-easterly by that railway to the Shire boundary and thence generally north-westerly, northerly, generally westerly and southerly by the Shire boundary to the point of commencement.

Central Riding
Reduced and Re-defined
Previous Gazettal 1895.1467

Commencing on the western boundary of the Shire at Fishers Lane, thence easterly by that lane and the road forming the southern boundary of allotment 81, Parish of Tamleugh to the south-eastern angle of that allotment, thence northerly by the road forming the eastern boundary of allotment 81 to the south-western angle of allotment 83, thence easterly by the road forming the southern boundaries of allotments 83 and 84, and by Fishers Lane to the Violet Town-Dookie Road, thence southerly and south-westerly by that road to Shiffner Street, thence north-westerly by that street to Mitchell Street, thence south-westerly by that street, the western boundary of allotment 1, section 25, Township of Violet Town and a line in continuation thereof to Honeysuckle Creek, thence generally south-easterly by Honeysuckle Creek to High Street, thence south-westerly by that street, McDiarmid Road and the Hume Highway to the Shire boundary and thence north-westerly, generally northerly, westerly and further northerly by the Shire boundary to the point of commencement.

South Riding
Re-defined
Previous Gazettal 1895.1467

Commencing on the eastern boundary of the Shire where it is intersected by the North Eastern

Railway, thence south-westerly by that railway to Honeysuckle Creek, thence generally south-easterly by Honeysuckle Creek to High Street, thence south-westerly by High Street, McDiarmid Road and the Hume Highway to the Shire boundary and thence generally southerly, easterly and generally northerly by the Shire boundary to the point of commencement.

Dated 15 December 1987

Responsible Minister:

J. L. SIMMONDS

Minister for Local Government

LAWRENCE A. FISHER
Clerk of the Executive Council

Local Government Act 1958

RESUBDIVISION OF THE MUNICIPAL
DISTRICT OF THE SHIRE OF MELTON

The Governor in Council, acting under Part II of the *Local Government Act 1958*, orders—

1. that on and from 1 April 1988 the municipal district of the Shire of Melton shall be resubdivided into four ridings whose names and boundaries are described hereunder;
2. that all councillors shall go out of office on the day appointed for the election of councillors next after this Order takes effect; and
3. that the number of councillors shall be twelve.

North West Riding
Constituted

Commencing on the northern boundary of the Shire at its intersection with Black Hills Road; thence south-easterly by that road to the Diggers Rest-Coimadai Road; thence south-westerly and north-westerly by that road to the Gisborne-Melton Road, thence south-easterly by that road to Minns Road; thence westerly by that road to Coburns Road; thence southerly by that road to Centenary Avenue; thence easterly by that avenue to O'Neills Road, thence southerly by that road to the Western Highway; thence westerly by that highway to the western boundary of the Shire; and thence northerly and easterly by the Shire boundary to the point of commencement.

South Riding
Constituted

Commencing on the eastern boundary of the Shire where it is intersected by the Keilor-Melton Road; thence generally westerly by that road to the Western Highway; thence north-westerly by that highway to Toolern Creek; thence generally southerly by that creek to the Melbourne-Ballarat Railway; thence generally westerly by that railway to Rees Road; thence southerly by that road and

a line in continuation thereof to the south-western boundary of the Shire, and thence generally south-easterly, easterly and northerly by the Shire boundary to the point of commencement.

Central Riding
Constituted

Commencing on the western boundary of the Shire where the Djerriwarrh Creek is intersected by the Western Highway; thence easterly by that highway to Toolern Creek; thence southerly by that creek to the Melbourne-Ballarat Railway; thence westerly by that railway to Rees Road; thence southerly by that road and a line in continuation thereof to the south-western boundary of the Shire; and thence north-westerly by the Shire boundary to the point of commencement.

North East Riding
Constituted

Commencing on the northern boundary of the Shire at its intersection with Black Hills Road; thence south-easterly by that road to the Diggers Rest-Coimadai Road; thence south-westerly and north-westerly by that road to the Gisborne-Melton Road, thence south-easterly by that road to Mians Road; thence westerly by that road to Coburns Road; thence southerly by that road to Centenary Avenue; thence easterly by that avenue to O'Neills Road; thence southerly by that road to the Western Highway; thence easterly and south-easterly by that highway to the Keilor-Melton Road, thence generally easterly by that road to the eastern boundary of the Shire; and thence generally north-westerly and westerly by the Shire boundary to the point of commencement.

Dated 15 December 1987

Responsible Minister:

J. L. SIMMONDS

Minister for Local Government

LAWRENCE A. FISHER

Clerk of the Executive Council

Local Government Act 1958

RESUBDIVISION OF THE MUNICIPAL DISTRICT OF THE SHIRE OF HAMPDEN

The Governor in Council, acting under Part II of the *Local Government Act 1958*, orders—

1. that on and from 1 April 1988 the municipal district of the Shire of Hampden shall be resubdivided into three ridings whose names and boundaries are described hereunder;

2. that all councillors shall go out of office on the day appointed for the election of councillors next after this Order takes effect; and

3. that the number of councillors shall be nine.

West Riding

Reduced and Re-defined

Previous Gazettal 1967.1777

Commencing on the southern boundary of the Shire where it is intersected by Cross Forest Road; thence northerly by that road to the Princes Highway; thence generally westerly by that highway to the McKinnons Bridge-Noorat Road; thence north-westerly by that road to the southern boundary of the Parish of Glenormiston; thence westerly by that boundary to the eastern boundary of allotment 5, section 23; thence northerly by that boundary to the Noorat-Framlingham Road; thence generally south-westerly by that road to the western boundary of the Shire; and thence generally southerly and north-easterly by the Shire boundary to the point of commencement.

North Riding

Enlarged and Re-defined

Previous Gazettal 1979.1068

Commencing at a point on the western boundary of the Shire where Mount Emu Creek is intersected by the Hamilton Highway; thence north-easterly by that highway to Lloyds Road; thence southerly by that road to the south-western angle of allotment 56C, Parish of Geelengla; thence north-easterly by the southern boundary of that allotment to the south-western angle of allotment 2A, section 30, Parish of Tooliorook; thence easterly by the southern boundaries of allotments 2A, 2B and 3 and northerly by the western boundary of section 24 to the Hamilton Highway; thence generally easterly by that highway to the Camperdown-Ballarat Road; thence southerly by that road to Smiths Road; thence further southerly by that road to its junction with Lower Darlington Road being a point on the western boundary of the Parish of Struan; thence further southerly and easterly by the parish boundary to the shore of Lake Gnarpurt; thence generally south-easterly and north-easterly by that shore to a point in line with a road forming the north-eastern boundary of allotment 109A, Parish of Corangamite; thence south-easterly by a line, that road and a line in continuation thereof to the shore of Lake Corangamite; thence generally north-easterly and south-easterly by that shore to the south-eastern boundary of the Shire; and thence generally north-easterly, northerly, westerly, northerly and south-westerly by the Shire boundary to the point of commencement.

South Riding

Constituted

Commencing at a point on the western

boundary of the Shire where Mount Emu Creek is intersected by the Hamilton Highway; thence north-easterly by that highway to Lloyds Road; thence southerly by that road to the south-western angle of allotment 56^c, Parish of Geelong; thence north-easterly by the southern boundary of that allotment to the south-western angle of allotment 2A, Section 30, Parish of Tooliorook; thence easterly by the southern boundaries of allotments 2A, 2B and 3 and northerly by the western boundary of section 24 to the Hamilton Highway; thence generally easterly by that highway to the Camperdown-Ballararat Road; thence southerly by that road to Smiths Road; thence further southerly by that road to its junction with Lower Darlington Road being a point on the western boundary of the Parish of Struan; thence further southerly and easterly by the parish boundary to the shore of Lake Gnarpurt; thence generally south-easterly and north-easterly by that shore to a point in line with a road forming the north-eastern boundary of allotment 109A, Parish of Corangamite; thence south-easterly by a line, that road and a line in continuation thereof to the shore of Lake Corangamite; thence generally north-easterly and south-easterly by that shore to the south-eastern boundary of the Shire; thence generally southerly and westerly by the Shire boundary to Cross Forest Road; thence northerly by that road to the Princes Highway; thence generally westerly by that highway to the McKinnons Bridge-Noorat Road; thence north-westerly by that road to the southern boundary of the Parish of Glenormiston; thence westerly by that boundary to the eastern boundary of allotment 5, section 23; thence northerly by that boundary to the Noorat-Framlingham Road; thence generally south-westerly by that road to the western boundary of the Shire; and thence northerly, easterly and generally northerly by the Shire boundary to the point of commencement.

Excluding the municipal district of the Town of Camperdown.

Dated 15 December 1987

Responsible Minister:

J. L. SIMMONDS

Minister for Local Government

LAWRENCE A. FISHER
Clerk of the Executive Council

Local Government Act 1958
RESUBDIVISION OF THE MUNICIPAL
DISTRICT OF THE CITY OF COBURG
The Governor in Council, acting under Part II
of the *Local Government Act 1958*, orders—

1. that on and from 1 April 1988 the municipal

district of the City of Coburg shall be resubdivided into four wards whose names and boundaries are described hereunder;

2. that the number of councillors shall be twelve.

North Ward

Enlarged and Re-defined

Previous Gazettal 1974.1897

Commencing on the northern boundary of the City where it is intersected by Edgars Creek, thence generally southerly by Edgars Creek and Merri Creek to Murray Road, thence westerly by that road and Gaffney Street to Northumberland Road being a point on the western boundary of the City, and thence northerly and generally easterly by the City boundary to the point of commencement.

West Ward

Constituted

Commencing on the southern boundary of the City at Gordon Street, thence northerly by that street to Bell Street, thence westerly by that street to Sussex Street, thence northerly by that street to Gaffney Street, thence westerly by that street and a line in continuation thereof to Moonee Ponds Creek, being a point on the western boundary of the City and thence generally southerly and easterly by the City boundary to the point of commencement.

Centre Ward

Re-defined

Previous Gazettal 1974.1897

Commencing on the southern boundary of the City at Gordon Street, thence northerly by that street to Bell Street, thence westerly by that street to Sussex Street, thence northerly by that street to Gaffney Street, thence easterly by that street to Sydney Road, thence generally southerly by that road to Bell Street, thence westerly by that street to the Melbourne and Upfield Railway, thence southerly by that railway to the southern boundary of the City, and thence westerly by the City boundary to the point of commencement.

East Ward

Reduced and Re-defined

Previous Gazettal 1974.1897

Commencing on the northern boundary of the City, where it is intersected by Edgars Creek, thence generally southerly by Edgars Creek and Merri Creek to Murray Road, thence generally westerly by that road to Sydney Road, thence generally southerly by that road to Bell Street, thence westerly by that street to the Melbourne and Upfield Railway, thence southerly by that railway to the southern boundary of the City and

thence easterly, generally northerly, further easterly, further northerly and westerly by the City boundary to the point of commencement.

Dated 15 December 1987

Responsible Minister:

J. L. SIMMONDS
Minister for Local Government

LAWRENCE A. FISHER
Clerk of the Executive Council

Local Government Act 1958

RESUBDIVISION OF THE MUNICIPAL DISTRICT OF THE SHIRE OF NATHALIA

The Governor in Council, acting under Part II of the *Local Government Act 1958*, orders—

1. that on and from 1 April 1988 the municipal district of the Shire of Nathalia shall be resubdivided into four ridings whose names and boundaries are described hereunder.

2. that the number of councillors shall be twelve.

**Murray Riding
Constituted**

Commencing on the western boundary of the Shire at Broken Creek, thence generally south-easterly by that creek to the Murray Valley Highway, thence northerly by that highway to Yielima North Road, thence northerly by that road, Darlows Lane and a line in continuation thereof to the Shire boundary, and thence generally westerly and southerly by the Shire boundary to the point of commencement.

**Goulburn Riding
Constituted**

Commencing on the western boundary of the Shire at Broken Creek, thence generally south-easterly by that creek to the Murray Valley Highway, thence southerly and south-westerly by that highway to Booths Road, thence southerly by that road and a line in continuation thereof to the Shire boundary, and thence generally north-westerly, generally north-easterly and again north-westerly and north-easterly by the Shire boundary to the point of commencement.

**Broken Riding
Constituted**

Commencing on the eastern boundary of the Shire at the south-western angle of allotment 31, section B, Parish of Baulkamaugh, being a point on the Waaia-Bearii Road, thence northerly by that road to the Nathalia-Waaia Road, thence westerly by that road to Lancaster Avenue, thence further westerly by a line being the prolongation of the Nathalia-Waaia Road to Broken Creek, thence north-westerly and south-westerly by that

creek to the Murray Valley Highway, thence southerly and south-westerly by that highway to Booths Road, thence southerly by that road and a line in continuation thereof to the Shire boundary, and thence generally north-easterly, generally south-easterly, easterly and northerly by the Shire boundary to the point of commencement.

**Yalca Riding
Constituted**

Commencing on the eastern boundary of the Shire at the south-western angle of allotment 31, section B, parish of Baulkamaugh, being a point on the Waaia-Bearii Road, thence northerly by that road to the Nathalia-Waaia Road, thence westerly by that road to Lancaster Avenue, thence further westerly by a line being the prolongation of the Nathalia-Waaia Road to Broken Creek, thence north-westerly and south-westerly by that creek to the Murray Valley Highway, thence northerly by that highway to the Yielima North Road, thence northerly by that road, Darlows Lane and a line in continuation thereof to the Shire boundary, and thence generally easterly and southerly by the Shire boundary to the point of commencement.

Dated 15 December 1987

Responsible Minister:

J. L. SIMMONDS
Minister for Local Government

LAWRENCE A. FISHER
Clerk of the Executive Council

Local Government Act 1958

RESUBDIVISION OF THE MUNICIPAL DISTRICT OF THE SHIRE OF DONALD

The Governor in Council, acting under Part II of the *Local Government Act 1958* orders—

1. that on and from 1 April 1988 the municipal district of the Shire of Donald shall be resubdivided into three ridings whose names and boundaries are described hereunder;

2. that the number of councillors shall be nine.

**Rich Avon Riding
Constituted**

Commencing on the western boundary of the Shire at the south-western angle of allotment 1, section B, Parish of Laen, being a point on the Donald-Minyip Road, thence north-easterly and easterly by that road to the Donald-Stawell Road, thence north-easterly by that road to Camp Street, thence easterly and north-easterly by that street to Woods Street, thence south-easterly by that street to Campbell Street, thence north-easterly by that street and Tower Road to Racecourse Road, thence northerly by that road to Jeffcott

Road, thence easterly, northerly and again easterly by that road to the Shire boundary, and thence southerly, generally south-westerly, north-easterly and generally north-westerly by the Shire boundary to the point of commencement.

Jeffcott Riding

Constituted

Commencing on the northern boundary of the Shire where it is intersected by Single Tree Road, thence south-easterly by that road to Fallas Road, thence westerly and southerly by that road to the Sunraysia Highway, thence south-easterly by that highway to the Donald and Birchip Railway, thence south-easterly by that railway to Sproats Lane, thence south-westerly by that lane to the Sunraysia Highway, thence south-easterly by that highway and Woods Street to Campbell Street, thence north-easterly by that street and Tower Road to Racecourse Road, thence northerly by that road to Jeffcott Road, thence easterly, northerly and again easterly by that road to the Shire boundary, and thence generally northerly and westerly by the Shire boundary to the point of commencement.

Watchem Riding

Constituted

Commencing on the western boundary of the Shire at the south-western angle of allotment 1, section B, Parish of Laen, being a point on the Donald-Minyip Road, thence north-easterly and easterly by that road to the Donald-Stawell Road, thence north-easterly by that road to Camp Street, thence easterly and north-easterly by that street to the Sunraysia Highway, thence north-westerly by that highway to Sproats Lane, thence north-easterly by that lane to the Donald and Birchip Railway, thence north-westerly by that railway to the Sunraysia Highway, thence north-westerly by that highway to Fallas Road, thence northerly and easterly by that road to Single Tree Road, thence north-westerly by that road to the Shire boundary, and thence westerly and southerly by the Shire boundary to the point of commencement.

Dated 15 December 1987

Responsible Minister:

J. L. SIMMONDS

Minister for Local Government

LAWRENCE A. FISHER
Clerk of the Executive Council

Crown Land (Reserves) Act 1978

NOTICE OF INTENTION

The Governor in Council under section 10 of the *Crown Land (Reserves) Act 1978* gives notice of intention to revoke the following temporary reservations:

DROUIN EAST—The temporary reservation by Order in Council of 5 November 1986 of 692 square metres of land being Crown Allotment 8A, section A, Parish of Drouin East as a site for Public Purposes (Departmental Residence)—(Rs 13016).

MELBOURNE EAST—The temporary reservation by Order in Council of 8 June 1874 of 3136 square metres of land in section 19A, at East Melbourne, City of Melbourne, Parish of Melbourne South as a site for State School so far only as the portion containing 33.7 square metres as indicated by hatching on plan hereunder—(Rs 13616).

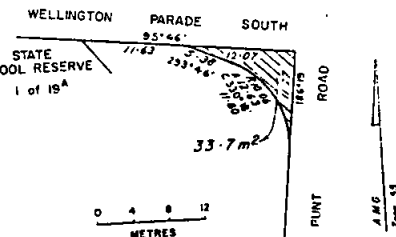

Dated 15 December 1987

Responsible Minister:

JOAN E. KIRNER

Minister for Conservation, Forests and Lands

LAWRENCE A. FISHER
Clerk of the Executive Council

Crown Land (Reserves) Act 1978

REVOCATION OF TEMPORARY
RESERVATIONS

The Governor in Council under section 10 of the *Crown Land (Reserves) Act 1978* revokes the following temporary reservations:

ELLIMINYT—The temporary reservation by Order in Council of 3 August 1971 of 809 square metres of land in section B, Parish of Elliminyt as a site for Public Purposes (Departmental Residence)—(Rs 9500).

SANDHURST—The temporary reservation by Order in Council of 8 May 1973 of 700 square metres of land in the Parish of Sandhurst as a site for Public Purposes (Departmental Residence)—(Rs 9738).

SANDHURST—The temporary reservation by Order in Council of 6 February 1968 of 600 square metres of land in section H2, Parish of Sandhurst as a site for Public Purposes (Public Buildings)—(Rs 8932).

SANDHURST—The temporary reservation by Order in Council of 11 February 1975 of 786 square metres of land being Crown Allotment 166A, Parish of Sandhurst as a site for Public Purposes (Departmental Residence)—(Rs 10022).

SANDHURST—The temporary reservation by Order in Council of 18 February 1969 of 589 square metres of land in section H, Parish of Sandhurst as a site for Public Purposes (Public Buildings)—(Rs 9129).

Dated 15 December 1987

Responsible Minister:

JOAN E. KIRNER

Minister for Conservation, Forests and Lands

LAWRENCE A. FISHER

Clerk of the Executive Council

Crown Land (Reserves) Act 1978
**REVOCATION OF TEMPORARY
 RESERVATIONS**

The Governor in Council under section 10 of the *Crown Land (Reserves) Act 1978* revokes the following temporary reservations:

ALEXANDRA—The temporary reservation by Order in Council of 16 January 1962 of 40.47 hectares, more or less, of land in the Parish of Alexandra as a site for Public Recreation revoked as to part by Order of 18 September 1973 so far as the balance remaining of 24.67 hectares, more or less—(Rs. 8116).

ALEXANDRA—The temporary reservation by Order in Council of 30 June 1964 of 3.327 hectares, more or less, of land in the Parish of Alexandra as a site for Public Recreation in addition to and adjoining the site temporarily reserved therefor by Order in Council of 16 January 1962 revoked as to part by Order of 18 September 1973, so far as the balance remaining of 1.787 hectares, more or less—(Rs. 8116).

ALEXANDRA—The temporary reservation by Order in Council of 16 January 1962 of 8600 square metres, more or less, of land in the Parish of Alexandra as a site for the Preservation of Native Flora—(Rs. 8117).

ALEXANDRA—The temporary reservation by Order in Council of 20 November 1973 of 16.34 hectares of land being Crown allotment 19C, Parish of Alexandra as a site for Public Purposes (Picnic and Protection of Flora and Fauna)—(Rs. 9834).

BENDOC—The temporary reservation by Order in Council of 12 November 1889 of 1953 square metres of land being Crown allotment 10, section E, Township of Bendoc as a site for Mechanics' Institute—(Rs. 13534).

CANN RIVER—The temporary reservation by Order in Council of 25 January 1972 of 8473 square metres of land in section 10, Township of Cann River, Parish of Noorinbee as a site for Public Purposes (Purposes of the Forests Acts)—(Rs. 9580).

DEREEL—The temporary reservation by Order in Council of 5 April 1966 of 6.07 hectares of land adjoining Crown allotment 10, section 6, Township of Dereel, Parish of Dereel as a site for Public Purposes (removal of sand)—(Rs. 8631).

KEWELL EAST—The temporary reservation by Order in Council of 14 September 1885 of 4047 square metres of land adjoining Crown allotment 76, Parish of Kewell East as a site for a State School—(LA-4696).

LAWLOIT WEST—The temporary reservation by Order in Council of 20 December 1900 of 8094 square metres of land adjoining Crown allotment 34, Parish of Lawloit West as a site for a State School—(Rs. 10317).

NULLAN—The temporary reservation by Order in Council of 16 October 1890 of 8094 square metres of land in the Parish of Nullan as a site for a State School—(LA-4695).

SEBASTOPOL—The temporary reservation by Order in Council of 4 October 1966 of 6.93 hectares of land in section 70, Township of Sebastopol, Parish of Ballarat as a site for State School Purposes—(Rs. 8710).

Dated 15 December 1987

Responsible Minister:

JOAN E. KIRNER

Minister for Conservation, Forests and Lands

LAWRENCE A. FISHER

Clerk of the Executive Council

Crown Land (Reserves) Act 1978
NOTICE OF INTENTION

The Governor in Council under section 10 of the *Crown Land (Reserves) Act 1978* gives notice of intention to revoke the following temporary reservations:

BANYARAMBITE AND THORNTON—The temporary reservation by Order in Council of 17 October 1885 of 194.2 hectares (more or less) of land in the Parishes of Banyarambite and Thornton as a site for Public purposes—(Rs 6680).

CAMPERDOWN—The temporary reservation by Order in Council of 3 January 1872 of 1.619 hectares, more or less of land in section 6, Parish of Colongulac as a site for a Cemetery in addition to and adjoining the site temporarily reserved therefor by Order of 28

September 1863 so far only as the area of 1.494 hectares being Allotment 20D, section 6, Parish of Colongulac as shown on Certified Plan No. 108680 lodged in the Central Plan Office—(Rs 8147).

DOLLAR—The temporary reservation by Order in Council of 22 June 1903 of 8372 square metres of land adjoining Crown Allotment 3, section 2, Township of Dollar as a site for a State School, revoked as to part by Order of 14 October 1913 so far as the balance remaining of 5488 square metres—(14/87/1373).

DOLLAR—The temporary reservation by Order in Council of 9 December 1913 of 2883 square metres of land in the Township of Dollar as a site for a State School in addition to and adjoining the site temporarily reserved therefor by Order in Council of 22 June 1903—(14/87/1373).

HORSHAM—The temporary reservation by Order in Council of 23 November 1976 of 733 square metres of land being Crown Allotment 15, section 4, Parish of Horsham as a site for Public Purposes (Departmental Residence)—(Rs 10299).

THORNTON—The temporary reservation by Order in Council of 30 November 1976 of 53.15 hectares of land being Crown Allotment 19E, Parish of Thornton as a site for Public Purposes (Fish Hatchery and Research purposes)—(Rs 5940).

THORNTON—The temporary reservation by Order in Council of 11 July 1978 of 2.028 hectares of land being Crown Allotment 23F, Parish of Thornton as a site for Public Purposes (Fish Hatchery and Research purposes)—(Rs 5940).

THORNTON—The temporary reservation under section 5 of the *Crown Land (Reserves) Act 1978* of 5.757 hectares of land being part of Crown Allotment 23C, Parish of Thornton transferred to the Crown by transfer No. L 496418M registered in the Office of Titles on 6 February 1985, as a site for the propagation or management of wildlife or the preservation of wildlife habitat—(L7-2450A).

Dated 15 December 1987

Responsible Minister:

JOAN E. KIRNER

Minister for Conservation, Forests and Lands

LAWRENCE A. FISHER

Clerk of the Executive Council

Historic Buildings Act 1981 (No. 9667)

AMENDMENT OF REGISTER OF
HISTORIC BUILDINGS

Under section 14 of the *Historic Buildings Act*

1981 the Governor in Council amends the Register by adding Historic Buildings No. 677.

Craiglee, Sunbury Road, Sunbury

to the extent of the bluestone building and land entered in the register book per Volume 9493 Folio 896 to the extent of land around the building marked on the map held by the Ministry for Planning and Environment which comprises a curtilage limited to five metres on the east, south and west elevations and to the north by a line near the rear wall of the house, approximately two metres.

Dated 15 December 1987

Responsible Minister:

T. W. ROPER

Minister for Planning and Environment

LAWRENCE A. FISHER

Clerk of the Executive Council

Historic Buildings Act 1981 (No. 9667)

AMENDMENT OF REGISTER OF
HISTORIC BUILDINGS

Under section 14 of the *Historic Buildings Act 1981* the Governor in Council amends the Register by adding Historic Building No. 681.

Former Greiffenhangen's Winery and Homestead Patons Road, Emu Creek, to the extent of the homestead, the winery and its associated outbuilding (known as the smokehouse), and the land contained (a) within the homestead garden block and (b) around the winery bounded by a rectangle of dimensions 30 metres wide (being 15 m to the east and west of the centreline of the winery) and 117 m long (being 70 m to the south of the southern wall and 15 m to the north of the northern wall, all being in crown allotment eight section six of Strathfieldsaye, County of Bendigo on Certificate of Title Volume 4243 Folio 848550).

Dated 15 December 1987

Responsible Minister:

T. W. ROPER

Minister for Planning and Environment

LAWRENCE A. FISHER

Clerk of the Executive Council

Historic Buildings Act 1981 (No. 9667)

AMENDMENT OF REGISTER OF
HISTORIC BUILDINGS

Under section 14 of the *Historic Buildings Act 1981* the Governor in Council amends the register by adding Historic Buildings No. 668.

Former Kellow Falkiner Showrooms 379 St. Kilda Road, Melbourne, to the extent of the whole of the building and the whole of the land

as described in Certificate of Title (Volume 1731 Folio 088 and Volume 5216 Folio 125).

Dated 15 December 1987

Responsible Minister:

T. W. ROPER

Minister for Planning and Environment

LAWRENCE A. FISHER

Clerk of the Executive Council

land as shown on the plan held by the Ministry for Planning and Environment.

Dated 15 December 1987

Responsible Minister:

T. W. ROPER

Minister for Planning and Environment

LAWRENCE A. FISHER

Clerk of the Executive Council

• *Historic Buildings Act 1981 (No. 9667)*

AMENDMENT OF REGISTER OF
HISTORIC BUILDINGS

Under section 14 of the *Historic Buildings Act 1981* the Governor in Council amends the Register by adding Historic Building No. 679

Sun Theatre, 8 Ballarat Street, Yarraville to the extent of the whole of the land and buildings contained in Certificate of Title Volume 4335, Folio 997.

Dated 15 December 1987

Responsible Minister:

T. W. ROPER

Minister for Planning and Environment

LAWRENCE A. FISHER

Clerk of the Executive Council

Historic Buildings Act 1981 (No. 9667)

AMENDMENT OF REGISTER OF
HISTORIC BUILDINGS

Under section 14 of the *Historic Buildings Act 1981* the Governor in Council amends the Register by adding Historic Building No. 673

Lunan House, Lunan Avenue, Drumcondra to the extent of all the buildings including the prefabricated iron classroom and all of the land in Volume 9681, Folio 698 but excluding the land and buildings north of a line drawn east west across the site 15 metres north of the northern elevation of Lunan House.

Dated 15 December 1987

Responsible Minister:

T. W. ROPER

Minister for Planning and Environment

LAWRENCE A. FISHER

Clerk of the Executive Council

Historic Buildings Act 1981 (No. 9667)

AMENDMENT OF REGISTER OF
HISTORIC BUILDINGS

Under section 14 of the *Historic Buildings Act 1981* the Governor in Council amends the Register by adding Historic Building No. 678

House, 167 Mostyn Street, Castlemaine to the extent of the whole of the land described in Certificate of Title Volume 9116, Folio 679 and buildings thereon excluding the weatherboard additions.

Dated 15 December 1987

Responsible Minister:

T. W. ROPER

Minister for Planning and Environment

LAWRENCE A. FISHER

Clerk of the Executive Council

Water and Sewerage Authorities (Restructuring) Act 1983

Water Act 1958

ROMSEY-LANCEFIELD WATER BOARD

Extension of Lancefield Waterworks District

Approved

The Governor in Council, under the provisions of the *Water and Sewerage Authorities (Restructuring) Act 1983* and the *Water Act 1958*, approves of the extension to the Lancefield Waterworks District as shown by red border on the accompanying plan (Corr. No. 84/0377/38).

Dated 8 December 1987

Responsible Minister:

ANDREW McCUTCHEON

Minister for Water Resources

LAWRENCE A. FISHER

Clerk of the Executive Council

Historic Buildings Act 1981 (No. 9667)

AMENDMENT OF REGISTER OF
HISTORIC BUILDINGS

Under section 14 of the *Historic Buildings Act 1981* the Governor in Council amends the Register by adding Historic Building No. 675

Former Gas Valve House, 617 St Kilda Road, Melbourne to the extent of the whole of the building and

Water and Sewerage Authorities (Restructuring) Act 1983

Sewerage Districts Act 1958

BACCHUS MARSH SHIRE COUNCIL

Extension of Sewerage District Approved

The Governor in Council, under the provisions of the *Water and Sewerage Authorities (Restructuring) Act 1983* and the *Sewerage Districts Act 1958*, approves of the extension to the Bacchus Marsh Sewerage District as shown in red on the accompanying plan (Corr. No. 80/4626/63).

Dated 8 December 1987

Responsible Minister:

ANDREW McCUTCHEON
Minister for Water Resources

LAWRENCE A. FISHER
Clerk of the Executive Council

Water and Sewerage Authorities (Restructuring) Act 1983

Water Act 1958

SUNBURY WATER BOARD

Extension of Sunbury Urban District Approved

The Governor in Council, under the provisions of the *Water and Sewerage Authorities (Restructuring) Act 1983* and the *Water Act 1958*, approves of the extension to the Sunbury Urban District as shown by red border on the accompanying plan (Corr. No. 80/4657/103).

Dated 8 December 1987

Responsible Minister:

ANDREW McCUTCHEON
Minister for Water Resources

LAWRENCE A. FISHER
Clerk of the Executive Council

Water and Sewerage Authorities (Restructuring) Act 1983

Sewerage Districts Act 1958

SHIRE OF BACCHUS MARSH

Extension of Bacchus Marsh Sewerage District
Extension of Site of Treatment Works and
Acquisition of Land

The Governor in Council, under the provisions of the *Water and Sewerage Authorities (Restructuring) Act 1983* and the *Sewerage Districts Act 1958*, approves of the extension to the Bacchus Marsh Sewerage District, extension to the site of treatment works and acquisition of land shown by red border on the accompanying plan (Corr. No. 80/4626/63).

Dated 8 December 1987

Responsible Minister:

ANDREW McCUTCHEON
Minister for Water Resources

LAWRENCE A. FISHER
Clerk of the Executive Council

Hospitals and Charities Act 1958

APPROVAL OF AGREEMENT

The Governor in Council under section 43B of the *Hospitals and Charities Act 1958* approves the Agreement entered into between Penshurst and District Memorial Hospital and the Trustees of the Penshurst Nursing Home Society for the transfer of assets.

Dated 15 December 1987

Responsible Minister:

DAVID WHITE
Minister for Health

LAWRENCE A. FISHER
Clerk of the Executive Council

ANNUAL REPORTING ACT 1983

The Governor in Council under section 4 of the *Annual Reporting Act 1983* ("the Act") and on the recommendation of the Treasurer:

- (i) deletes the name "Local Authorities Provident Fund established under section 14 of the *Local Authorities Superannuation Act 1958*" specified in column 2 of Schedule 3 of the Act by Order published in the *Government Gazette* on 11 February 1987; and
- (ii) adds the funds and accounts shown in the Schedule below to column 2 of Schedule 3 of the Act in place of the deleted name.

Schedule

Local Authorities (Employés) Insurance Account maintained under section 8 (1) of the *Local Authorities Superannuation Act 1958*;

Local Authorities Benefit Contracts Account established under section 11F (1) of the *Local Authorities Superannuation Act 1958*;

Authorities' Fund established under section 11ix of the *Local Authorities Superannuation Act 1958*;

Employees' Fund established under section 11iw of the *Local Authorities Superannuation Act 1958*;

Pensions Fund established under section 11iy of the *Local Authorities Superannuation Act 1958*;

Local Authorities (Superannuation) Management Account maintained under section 11jc, 22 (2), 22 (3), 22 (4) and 22 (5) of the *Local Authorities Superannuation Act 1958*; and

Contingent Account established under section 22 (6) of the *Local Authorities Superannuation Act 1958*.

Dated 15 December 1987

Responsible Minister:

R. A. JOLLY
Treasurer

LAWRENCE A. FISHER
Clerk of the Executive Council

**MELBOURNE AND METROPOLITAN
BOARD OF WORKS ACT 1958**

*At the Executive Council Chamber, Melbourne,
the fifteenth day of December 1987*

PRESENT:

His Excellency the Governor of Victoria
Mr Jolly | Mr Wilkes

Dated: 15 December 1987

Responsible Minister:

FRANK WILKES
Minister for Water Resources

LAWRENCE A. FISHER
Clerk of the Executive Council

**THE INCLUSION OF PART OF THE SHIRE
OF MELTON IN THE METROPOLIS FOR
WATER SUPPLY PURPOSES**

The Governor in Council under the provisions
of the *Melbourne and Metropolitan Board of
Works Act 1958* ("the Act") directs that:

1. Operative Date

This Order shall come into force on 1 January
1988 ("the operative date").

**2. Inclusion in Metropolis for Water Supply
Purposes**

As on and from the operative date the land
described in the schedule hereto shall be included
in the metropolis for water supply purposes
within the area of control of the Melbourne and
Metropolitan Board of Works and Parts I, II, IV,
V, VIII, IX, of the Act shall apply to such lands.

Schedule

All that piece of land in the Shire of Melton
commencing at the south-western corner of
Crown Allotment 20 section B, Parish of
Maribyrnong, and being a point on the eastern
boundary of the aforesaid Shire of Melton; thence
westerly along the southern boundary of Crown
Allotment 19, a line across Gourlay Road, and
the southern boundary of Crown Allotment 14;
to the eastern boundary of Crown Allotment 13;
thence south easterly, south westerly and north
westerly along the eastern, southern and western
boundary of the last mentioned Crown Allotment
and a line in continuation to the centreline of
Rockbank Road; thence north easterly along the
last mentioned centreline to the centreline of
Keilor-Melton Road; thence easterly along the
last mentioned centreline to a point in line with
the eastern boundary of Lot 4 on Lodged Plan
No. 51229; thence northerly by a line to the south-
eastern corner of the last mentioned Lot; thence
by a line in a north-easterly direction to the
southern-most angle of Crown Allotment 2A,
section 26, being also a point on the
aforementioned eastern boundary of the Shire of
Melton; thence southerly, westerly and further
southerly along the last mentioned boundary to
the point of commencement.

PRIVATE ADVERTISEMENTS

CITY OF BERWICK
Allocation of Road Name

The Council of the City of Berwick in accordance with the provisions of the *Local Government Act 1958* (as amended) resolved on Tuesday, 15 December 1987, to allocate the following name:

Old Name: Unnamed

New Name: Patrick Northeast Drive

Description: Unnamed road on the south side of the Civic Centre complex extending in an easterly direction from Magid Drive, Narre Warren to Overland Drive (proposed) Narre Warren.

P. J. NORTHEAST
City Manager

9758

CITY OF ESSENDON
Part Closure Pratt Street, Moonee Ponds
Ref: 89/10/15

Whereas it is provided in section 528 (2) (a) of the *Local Government Act 1958*, that where a road (whether or not a public highway but not being a road set out on land of the Crown) or any part thereof is not required for public use of the Council of the municipality in which such road is situated made not less than one month after publishing in a newspaper generally circulating in the district and posting to the registered proprietor (if any) of the land and to the owners and occupiers (if any) of lands abutting or immediately adjacent to the road notice of intention to pass such a resolution may by resolution published in the *Government Gazette*, direct that such a road or part shall be discontinued and thereupon such road or part shall be discontinued accordingly.

And whereas the Council of the City of Essendon on 27 April 1987 resolved that the road be discontinued and not less than one month previously has published in a newspaper generally circulating in the district and posted to the registered proprietors of the land in the roads and to the owners and occupiers of lands abutting or immediately adjacent to the roads notice of intention to make such a resolution.

Now therefore the Mayor, Councillors and Citizens of the City of Essendon by resolution dated 28 September 1987 hereby directs:

That the said part of the road which is shown by hatching on Plan No. C-3940 shall be

discontinued pursuant to section 528 (2) (a) of the *Local Government Act 1958* (as amended).

That notwithstanding such discontinuance the Melbourne and Metropolitan Board of Works, Gas and Fuel Corporation, Telecom Australia and the Mayor, Councillors and Citizens of the City of Essendon shall continue to have and possess the same rights, title, power, authority or interest in or in relation to the whole of the land shown by hatching on the said plan as they had possessed prior to such discontinuance with respect to or in connection with any drains, pipes or works erected in, on or over such land.

That subject to any such right, title, power authority or interest the land in the said part of the road is to be sold by public tender.

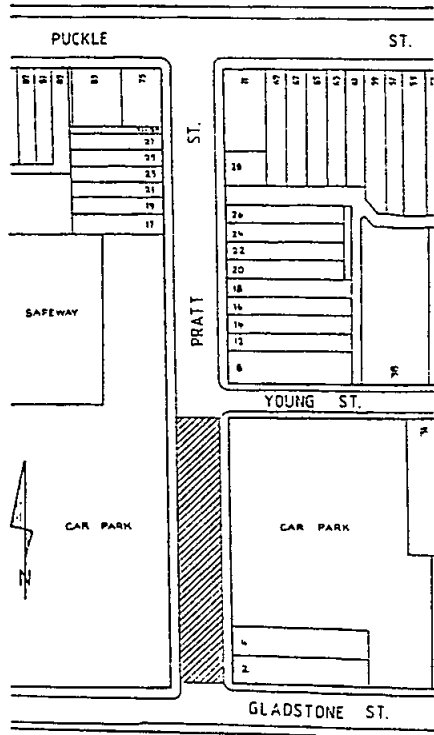

SECTION OF ROAD TO BE CLOSED. C-3940

PETER SEAMER
City Manager

9740

CITY OF HEIDELBERG
Road Discontinuance

Pursuant to section 528 (2) of the *Local Government Act 1958*, the Council of the City of Heidelberg, after consultation with Public Authorities and the advertising of its intention and notification to the registered proprietor of the land and owners and occupiers of any land abutting or immediately adjacent to the road, has by resolution of its Ordinary Meeting held on 7 December 1987, resolved that such part of the road known as Orient Place at the rear of the property known as 98 Mount Street, as shown, hatched on the plan is:

- (a) in the opinion of Council not reasonably required for public use, and shall be discontinued;
- (b) that the land in the discontinued road be sold and transferred to the abutting owners by private treaty.

CITY OF HEIDELBERG.
ROAD TO BE DISCONTINUED

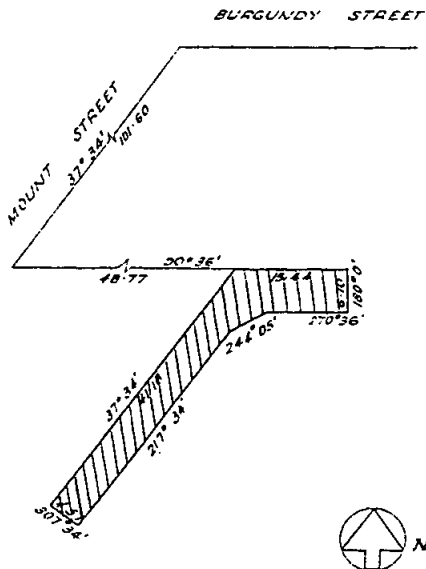

OCTOBER 1987

Civic Centre
Ivanhoe, 3079

9753

G. BRENNAN
Chief Executive Officer

9777

CITY OF KEILOR
Vesting of a Drainage Reserve

The Council of the City of Keilor in accordance with the provisions of section 569BA (1) of the *Local Government Act 1958* (as amended), the provisions of such section having been complied with at Council's meeting held on 6 October 1987, resolved, in part, that the Drainage Reserve located in the parcel of land bounded by Moore Road, Louis Street, Rodd Road and Howes Street, Airport West, and shown on Lodged Plan of Subdivision No. 12958, Parish of Dousta Galla, County of Bourke and indicated as shaded on the attached plan, be vested in the name of the Mayor, Councillors and Citizens of the City of Keilor and by this notice such land in the Drainage Reserve shall so vest free and discharged of any mortgage, charge, lease or sub lease.

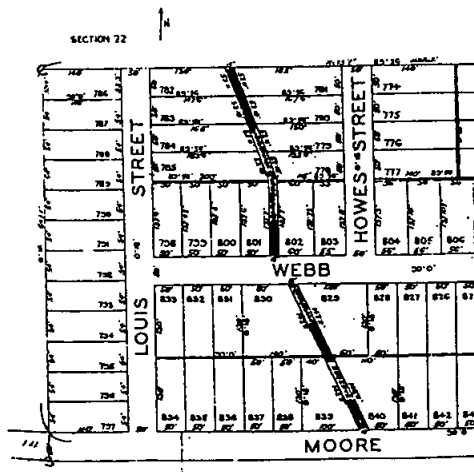

J. R. CASTLE
Town Clerk

**CITY OF MELBOURNE
Partial Street Closures**

Barkly Street and Carlton Street, Carlton

Notice is hereby given that the Council of the City of Melbourne, pursuant to the provisions of section 539C of the *Local Government Act 1958*, on 15 December 1987, adopted by Order a proposal for the partial closures of Barkly Street and Carlton Street, Carlton to through traffic at their intersection with Rathdowne Street.

The Council has resolved that the Order as adopted shall come into operation on 9 January 1988. The location of the partial closures is shown in the diagram below.

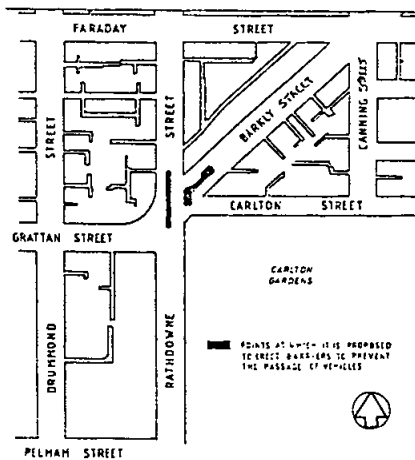

**CITY OF MELBOURNE
Tree Reserves—Batman Avenue and Swan
Street, Melbourne
(National Tennis Centre)**

Notice is hereby given, pursuant to the provisions of section 557 of the *Local Government Act 1958*, that the Council of the City of Melbourne, in exercise of the power conferred upon it under the Act, has by Order directed that the portions of the nature strips in Batman Avenue and Swan Street, Melbourne, adjacent to the National Tennis Centre, as shown hatched on the plan hereunder shall be tree reserves.

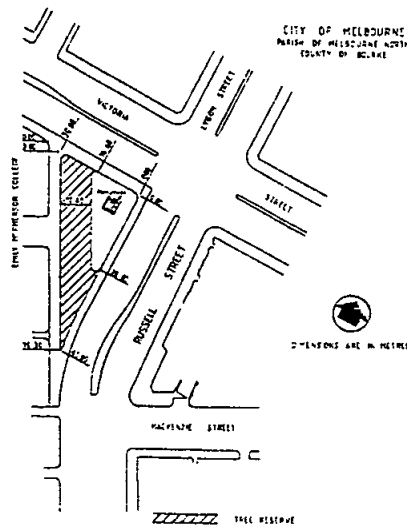

CITY OF MELBOURNE

Tree Reserve—Russell Street, Melbourne

Notice is hereby given, pursuant to the provisions of section 557 of the *Local Government Act 1958*, that the Council of the City of Melbourne, in exercise of the powers conferred upon it under the Act, has by Order directed that the portion of Russell Street, Melbourne, adjacent to the Emily MacPherson College, as shown hatched on the plan hereunder shall be a tree reserve.

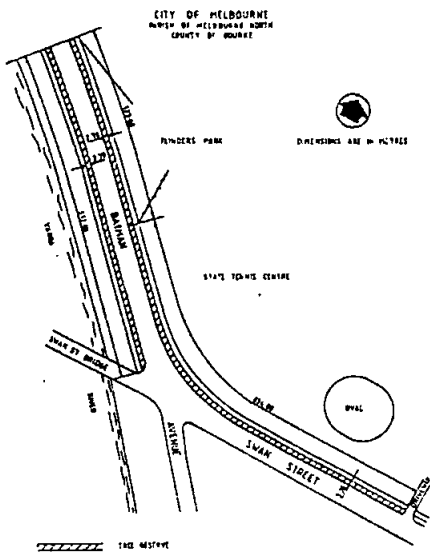

CITY OF RICHMOND

Road Discontinuance

Pursuant to section 528 (2) of the *Local Government Act 1958*, the Council of the City of Richmond, after consultation with Public Authorities, the advertising of its intention, and notification to the registered proprietor of the land owners and occupiers of any land abutting or immediately adjacent to the road, has resolved at an Ordinary Meeting held on 14 December 1987:

1. That Council discontinue the Right-of-Way at the rear of the South/West corner of Church and Swan Streets, Richmond (more accurately described by hachure on the plan below), such Right-of-Way being in the opinion of Council not reasonably required for public use;

2. That notwithstanding such discontinuance, the Melbourne and Metropolitan Board of Works and the Council shall continue to have and possess the same right, title, power, authority or interest in or in relation to the whole of the land as it had, or possessed prior to such discontinuance with respect to or in connection with any drains or pipes laid in on or over such land;

3. That such lands resulting from the discontinued Right-of-Way be sold by private treaty.

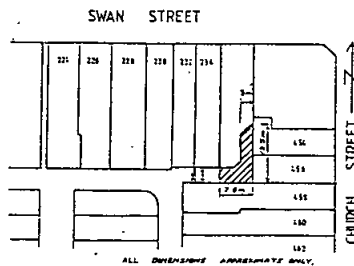

Form 2.1
Town and Country Planning Act 1961
CITY OF SHEPPARTON PLANNING
SCHEME 1953

Notice that a Planning Scheme has been Prepared and is Available for Inspection
 Amendment No. 120, 1987

Notice is hereby given that the Council of the City of Shepparton, in pursuance of its powers under the *Town and Country Planning Act 1961*, has prepared a Scheme for the purpose of:

clarifying interpretation of specific provisions of the City of Shepparton Planning Scheme relating to residential unit (flats and group houses) development and to reduce the minimum frontage on blocks for unit development from 18 to 15 metres.

A copy of the Scheme has been deposited at the office, of the Council, Municipal Offices, Welsford Street, Shepparton, and at the office of the Ministry for Planning and Environment (Plan Inspection Section), Ground Floor, The Olderfleet Buildings, 477 Collins Street, Melbourne and will be open for inspection during office hours by any person free of charge. Any persons affected by the Scheme are required to set forth, in writing, any submission they may wish to make, with respect to the scheme, addressed to the City Manager, City of Shepparton, P.O. Box 989, Shepparton, 3630, by 27 January 1988, and state whether you wish to be heard in respect of the submission.

9741

I. L. GILBERT
 City Manager

CITY OF WERRIBEE
Allocation of Street Names

Notice is hereby given in accordance with the provisions of section 535 (4) of the *Local Government Act 1958*, that after having advertised its intention by public notice and having notified its intention to every occupier of every premise abutting the streets shown on the plan hereunder, the Council of the City of Werribee at its meeting held on 7 December 1987 passed the following resolution:

To rename the portions of roadway previously named Aviation Road, Laverton to Lunn Court and Fitzpatrick Drive, Laverton as shown on the plan hereunder.

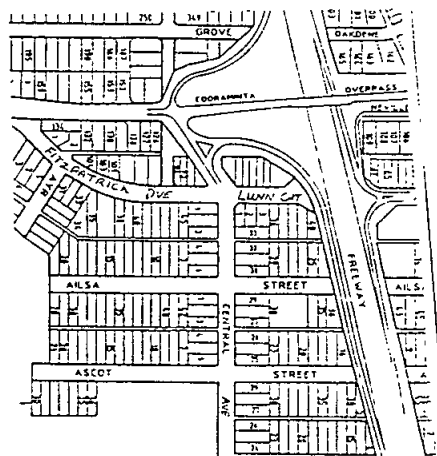

9738

J. T. KERR
 Town Clerk

CITY OF SOUTH MELBOURNE
Street Closure

Notice is hereby given that the Council of the City of South Melbourne, pursuant to the provisions of section 539C of the *Local Government Act 1958*, on 14 December 1987, adopted by Order a proposal for the closure of Ferrars Place, South Melbourne, to through traffic for the length abutting the reservation on which the R.S.L. Hall has been erected. The Council has resolved that the Order as adopted shall come into operation on 7 January 1988. The location of the closure is shown in the diagram below.

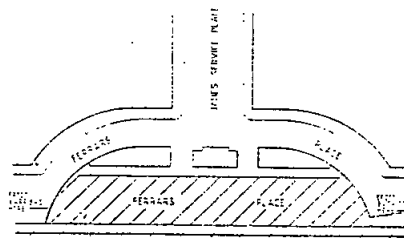

9759

CITY OF WERRIBEE
Allocation of Street Names

Notice is hereby given in accordance with the provisions of section 535 (4) of the *Local Government Act 1958*, that after having advertised its intention by public notice and having notified its intention to every occupier of every premise abutting the streets shown on the plan hereunder, the Council of the City of Werribee at its meeting held on 7 December 1987 passed the following resolution:

To rename the portions of roadway previously named Balaclava Avenue, Trafalgar Avenue, Nelson Avenue, Crown Street, Donald Street, Epsom Street, Fitzroy Street, Grace Street, High Street, Jamison Street, Kiara Street and Linden Street, all south of Central Avenue, Laverton, to be known as shown on the plan hereunder.

SHIRE OF ALEXANDRA
Road Discontinuance

Pursuant to section 528 (2) of the *Local Government Act 1958*, the Council of the Shire of Alexandra, after consultation with Public Authorities, and advertising its intention, and notification to the registered proprietor of the land, owners and occupiers of any land abutting or immediately adjacent to the road has resolved at an Ordinary Meeting held on 9 December 1987:

- (a) That Council discontinue part of road shown on section 19, Township and Parish of Alexandra, such road being of the opinion of Council not reasonably required for public use;
- (b) That such lands resulting from the discontinued road be incorporated in the abutting reserve.

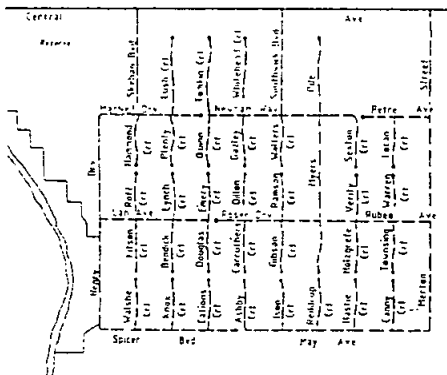

SHIRE OF ALEXANDRA
TOWNSHIP OF ALEXANDRA
ROAD CLOSURE

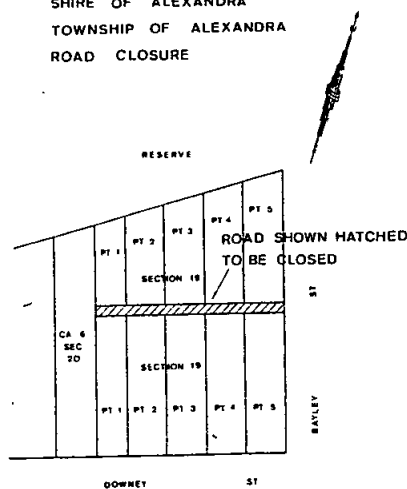

SHIRE OF BAIRNSDALE
Street Closure

Notice is hereby given that the Council of the Shire of Bairnsdale, pursuant to the provisions of section 539c of the *Local Government Act 1958* (as amended) adopted by order on 9 December 1987, a proposal for the closure of Slip Road and Fort King Road, Paynesville to through traffic. The proposal involves closing Slip Road approximately 500 metres east of Main Road and Fort King Road immediately north of Slip Road.

Council has resolved that the order as adopted shall come into operation on 9 February 1988. The location of the closure is shown in the diagram below.

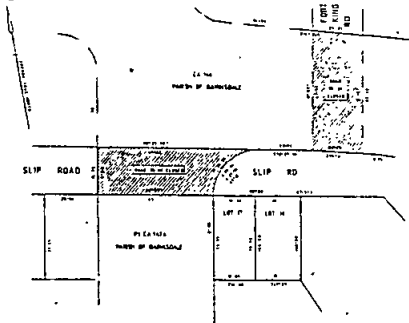

9744

T. J. NEWTOWN
Shire Secretary

SHIRE OF BAIRNSDALE

Street and Itinerant Traders By-Law

Residents are advised that, in accordance with the *Local Government Act*, Council has prepared a By-Law for regulation of street hawkers and itinerant traders in the sale of goods from—

- (a) Any vehicle or receptacle placed on a street, road or public place.
- (b) Any tent or temporary structure erected on any land in the municipality.
- (c) Any vehicle or receptacle placed in vacant land.

Council confirmed the making of the By-Law at the Ordinary meeting of Council held on 9 December 1987.

The By-Law will require persons wishing to sell goods as specified above to obtain a permit from Council and to pay a fee of \$10.00 per day. Council may at its discretion grant a permit with or without conditions.

Copies of the By-Law may be inspected at the Shire Offices, McCulloch Street, Bairnsdale.

9743

T. J. NEWTON
Shire Secretary

SHIRE OF CORIO
By-Law No. 66

Notice is hereby given that the Council of the Shire of Corio has made a by-law called the *Reserves and Recreational Facilities By-Law*.

The by-law was made for the purposes of:

- (a) suppressing nuisances;
- (b) preserving public decency;
- (c) preserving good order and decency in any building belonging to the municipality or under the control and management of the Council and preventing damage to such building or to the furniture or fittings thereof and regulating any meeting or gathering held therein;
- (d) controlling and managing and preserving commons and public reserves of which the management is vested in the Council;
- (e) imposing collecting and receiving charges or entrance fees for clubs associations or persons using or entering in or upon any grounds or places or land purchased or rented or otherwise provided or granted or given by any person to the Council or the municipality of the Shire of Corio for the providing of pleasure grounds or places of public resort or public recreation and also for regulating the conduct of persons using or being upon or in such grounds or places;
- (f) providing for the car protection management and use of any building and use of any building structure accommodation for bathers or sanitary or other convenience erected or provided by Council;
- (g) controlling and managing any building or land or building used for the purposes set out in section 799A (1) of the *Local Government Act 1958* and regulating the conduct of persons using or being upon or in any such land or building and requiring such persons to comply with directions on any signs which Council has caused to be displayed in any such land or building;

and repeals by-laws numbered 2, 19B, 19C, 56 and 57.

The resolution for passing this by-law was agreed to by the Council at its meeting on 28 October 1987 and confirmed on 25 November 1987.

A copy of this by-law is open for inspection free of charge during office hours at the office of the Council, Osborne House, Swinburne Street, North Geelong.

9781

R. P. METCALF
Shire Secretary

SHIRE OF CORIO

By-Law No. 67

Notice is hereby given that the Council of the Shire of Corio has made a by-law called a By-Law to Control Trees and Shrubs at Street Corners and numbered 67.

The by-law was made for the purposes of prohibiting and regulating the use of private property at the junction of streets and roads for the growing of trees shrubs hedges or other vegetation, provides for the removal or lopping of such trees shrubs hedges or other vegetation and repeals by-law numbered 42.

The resolution for passing this by-law was agreed to by the Council at its meeting on 28 October 1987 and confirmed on 25 November 1987.

A copy of this by-law is open for inspection free of charge during office hours at the office of the Council, Osborne House, Swinburne Street, North Geelong.

R. P. METCALF
Shire Secretary

9782

SHIRE OF CORIO

By-Law No. 68

Notice is hereby given that the Council of the Shire of Corio has made a by-law called Incinerator and Nuisance By-law.

The by-law was made for the purposes of:

- (a) preventing and extinguishing fires;
- (b) suppressing nuisances; and
- (c) regulating:
 - (i) the lighting of fires in the open air; or
 - (ii) the method of construction of incinerators and the use of incinerators—

on property used wholly or partly for residential purposes or on vacant residential land, including the siting of fires and incinerators and the times during which the days on which fires may be lit or incinerators used and prohibiting or regulating the burning or particular substances;

and repeals by-law numbered 62.

The resolution for passing this by-law was agreed to by the Council at its meeting on 28 October 1987 and confirmed on 25 November 1987.

A copy of this by-law is open for inspection free of charge during office hours at the office of the Council, Osborne House, Swinburne Street, North Geelong.

R. P. METCALF
Shire Secretary

9783

SHIRE OF CORIO

By-Law No. 69

Notice is hereby given that the Council of the Shire of Corio has made a by-law called the Amendment (Penalties) By-Law.

The by-law amends provisions of by-laws numbered 32, 41, 53, 54 and 55 imposing penalties for offences against those by-laws.

The resolution for passing this by-law was agreed to by the Council at its meeting on 28 October 1987 and confirmed on 25 November 1987.

A copy of this by-law is open for inspection free of charge during office hours at the office of the Council, Osborne House, Swinburne Street, North Geelong.

R. P. METCALF
Shire Secretary

9784

SHIRE OF CORIO

By-Law No. 65

Notice is hereby given that the Council of the Shire of Corio has made a by-law called a by-law for the Repeal of Certain by-laws and numbered 65.

The by-law repeals by-laws numbered 1, 2, 4, 5, 6, 7, 8, 9, 10, 11, 14, 16, 17, 19, 19A, 20, 21, 22, 23, 25, 26, 27, 30, 31, 34, 35, 36, 39, 40, 44, 45, 47, 51 and 59.

The resolution for passing this by-law was agreed to by the Council at its meeting on 28 October 1987 and confirmed on 25 November 1987.

A copy of this by-law is open for inspection free of charge during office hours at the office of the Council, Osborne House, Swinburne Street, North Geelong.

R. P. METCALF
Shire Secretary

9780

Form 2.1

**Town and Country Planning Act 1961
SHIRE OF GRENVILLE PLANNING
SCHEME 1987**

Notice that a Planning Scheme has been Prepared and is Available for Inspection
Amendment No. 2

Notice is hereby given that the Shire of Grenville in pursuance of its powers under the *Town and Country Planning Act 1961* has prepared a scheme for the following area:

Part of Crown Allotment 4 Section 5, Parish of Cardigan generally bounded by the Glenelg Highway and Tait Street.

A copy of the Scheme has been deposited at Shire Office Sussex Street Linton; The Central Highlands Regional Office Ministry for Planning and Environment, State Offices, cnr. Mair and Doveton Streets, Ballarat; Ministry for Planning and Environment, The Olderfleet Buildings, 477 Collins Street, Melbourne and will be open for inspection during office hours to any person free of charge.

Persons affected by the scheme are required to be set forth in writing addressed to the Shire Secretary, Shire of Grenville, P.O. Box 21, Linton, 3360 by 29 January 1988 and state whether you wish to be heard in respect of the submission.

R. W. HAYLES
9766 Shire Engineer/Planning Officer

Form 2.1
Town and Country Planning Act 1961
SHIRE OF FLINDERS PLANNING SCHEME
1962

Notice that a Planning Scheme has been Prepared and is Available for Inspection
Amendment No. 238, 1987

Notice is hereby given that the Council of the Shire of Flinders in pursuance of its powers under the *Town and Country Planning Act 1961* has prepared a scheme for the land described as:

Lot 69, LP 6543, 2 McCombe Street
Lot 68, LP 6543, 4 McCombe Street
Part Lot 67/66, LP 6543, 6-8 McCombe Street
Part Lot 65 and Part Lot 64, LP 6543, 10-12 McCombe Street
Lot 1, LP E253, 14 McCombe Street
Lot 4, LP 24770, 16 McCombe Street
CP 163922, 18-28 McCombe Street
Lot 55, LP 6543, 30 McCombe Street
Part CP 164612, 32-34 McCombe Street and Part Road Reservations Rose Avenue and McCombe Street, Rosebud to rezone it from Future Commercial Zone to Bayside Commercial Zone.

A copy of the amendment has been deposited at the office of the Shire of Flinders, Boneo Road, Rosebud, and at the office of the Ministry for Planning and Environment, The Olderfleet Buildings, 477 Collins Street, Melbourne and will be open for inspection during office hours by any person free of charge.

Any persons affected by the amendment are required to set forth in writing any submission they may wish to make with respect to the amendment addressed to: the Chief Executive, Shire of Flinders, PO Box 1000, Rosebud 3939

by 25 January 1988 and state whether you wish to be heard in respect of your submission.

Dated 23 December 1987

LARRY M. JONES
9746 Shire Secretary

Form 2.1
Town and Country Planning Act 1961
SHIRE OF FLINDERS PLANNING
SCHEME, 1962

Notice that a Planning Scheme has been Prepared and is Available for Inspection
Amendment No. 239, 1987

Notice is hereby given that the Council of the Shire of Flinders in pursuance of its powers under the *Town and Country Planning Act 1961* has prepared a scheme for land described as Part Lot 7, LP. 4916, Nepean Highway, Dromana to allow the development and use of the existing Drive-In site as a Trash and Treasure Market.

A copy of the amendment has been deposited at the office of the Shire of Flinders, Boneo Road, Rosebud, and at the office of the Ministry for Planning and Environment, The Olderfleet Buildings, 477 Collins Street, Melbourne, and will be open for inspection during office hours by any person free of charge.

Any persons affected by the amendment are required to set forth in writing any submission they may wish to make with respect to the amendment addressed to The Chief Executive, Shire of Flinders, P.O. Box 1000, Rosebud 3939 by 25 January 1988 and state whether you wish to be heard in respect of your submission.
Dated 16 December 1987

LARRY M. JONES
9769 Shire Secretary

Town and Country Planning Act 1961
SHIRE OF HUNTLY INTERIM
DEVELOPMENT ORDER 1983

Notice that an Interim Development Order Amendment has been Prepared and is Available for Inspection
Amendment No. 11

Special Building Control Area

Notice is hereby given that the Council of the Shire of Huntly in pursuance of its powers under the *Town and Country Planning Act 1961*, has prepared an Amendment to its existing Interim Development Order in order to declare a "Special Building Control Area" over the area designated on the map herewith.

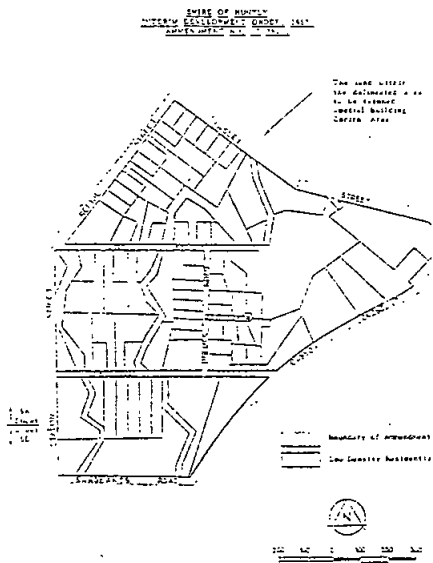

Such amendment will in effect, provide a "brick zone" over the designated area requiring all new houses to be constructed of masonry.

A copy of the Amendment has been deposited at the Municipal Offices, Midland Highway, Huntly, the office of the Ministry for Planning and Environment, 391 Hargreaves Street, Bendigo and at office of the Ministry for Planning and Environment (Plan Inspection Section), The Olderfleet Buildings, 477 Collins Street, Melbourne, and will be open for inspection during office hours to any person free of charge.

Any persons affected by the Amendment are required to set forth in writing any submission they may wish to make with respect to the Amendment, addressed to the Shire Secretary, Shire of Huntly, Municipal Offices, Midland Highway 3551, Huntly by Monday, 8 February 1988, and is required to state whether you wish to be heard in respect of the submission.

DARYL GRIFFITHS
Shire Secretary

9745

Town and Country Planning Act 1961
SHIRE OF HUNTLY INTERIM
DEVELOPMENT ORDER 1983

Notice that an Interim Development Order
Amendment has been Prepared and is Available
for Inspection

Amendment No. 10

Proposed Amendment—Reserved Industrial
Zone—Midland Highway, Epsom

Notice is hereby given that the Council of the Shire of Huntly in pursuance of its powers under the *Town and Country Planning Act 1961*, has prepared an amendment to land comprising Crown Allotments 2, 3, 4, 5A, 5B, 5C, 5E, 5F, 5G, 5H, 5J, 5K, 5L, 5M, 5M2, 5N, 5S, 5V, and 5X, section 2, Parish of Huntly, County of Bendigo, described as land commencing approximately 200 metres north of Howard Street on the western side of the Midland Highway (opposite "The Palms") and ending at Ironstone Road (at the "Epsom Fruit Works") and being all that land between the Midland Highway and the Bendigo Creek as described on the attached plan.

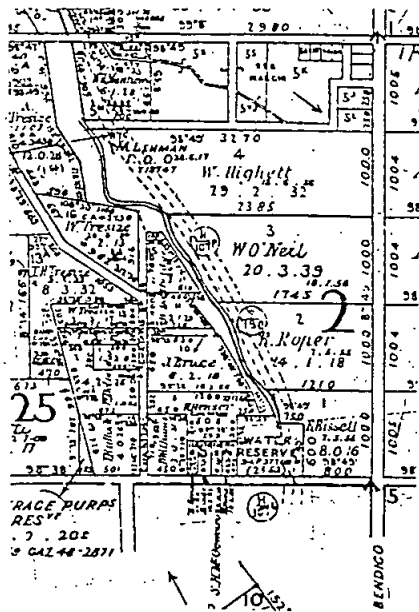

The purpose of the amendment is to allow commercial uses to develop with a Highway frontage in the existing Reserved Industrial Zone.

Such uses and developments may include:

- (i) Furniture and Appliance Sales;
- (ii) Hardware Sales;
- (iii) Industrial Sales;
- (iv) Motor Accessory Sales;
- (v) Motor Vehicles Sales Establishment;
- (vi) Petrol Filling Station;
- (vii) Restaurant;
- (viii) Service Premises;
- (ix) Take Away Food Establishment.

A copy of the Amendment has been deposited at the Municipal Offices, Midland Highway, Huntly, the office of the Ministry for Planning and Environment, 391 Hargreaves Street, Bendigo, and at the office of the Ministry for Planning and Environment (Plan Inspection Section), 4th Floor, The Olderfleet Buildings, 477 Collins Street, Melbourne and will be open for inspection during office hours to any person free of charge.

Any persons affected by the Amendment are required to set forth in writing any submission they wish to make with respect to the Amendment addressed to the Shire Secretary, Shire of Huntly, Municipal Offices, Midland Highway, Huntly 3551, by Monday, 8 February 1988, and is required to state whether you wish to be heard in respect of the submission.

DARYL GRIFFITHS
9760 Shire Secretary

Local Government Act 1958
Notice Pursuant to Section 540
SHIRE OF EAST LODDON

Pursuant to the provisions of section 540 of the *Local Government Act 1958* the Council of the Shire of East Loddon hereby gives notice that:

That portion of the Mitiamo-Elmore Road being the length from the Bendigo-Pyramid Road through to Phillips Road is hereby closed to any vehicle of gross vehicle weight in excess of 12 tonnes and that the period for such closure shall be from and including 1 January 1988 to and including 15 March 1988.

By Order of the Council
MARK W. JOHNSON
9765 Shire Secretary

Form 2.1
Town and Country Planning Act 1961
SHIRE OF LEIGH INTERIM
DEVELOPMENT ORDER

Notice that an Interim Development Order has been Prepared and is Available for Inspection
Amendment No. 5

Notice is hereby given that the Council of the Shire of Leigh in pursuance of its powers under the *Town and Country Planning Act 1961* has prepared an order for:

The rezoning of Lots 61 and 62 LP 145643 and Lot 2 LP 144394 from Rural B zone to Rural C zone.

A copy of the order has been deposited at the Office of the Shire of Leigh, Aitchison Street, Rokewood, and the Office of the Ministry for

Planning and Environment, The Olderfleet Buildings, 477 Collins Street, Melbourne, and will be open for inspection during office hours by any person free of charge.

Any persons affected by the Order are required to set forth in writing any submission they wish to make with respect to the Order addressed to the Shire Secretary, Shire of Leigh, Shire Office, Rokewood, 3330, by 30 January 1988 and state whether you wish to be heard in respect of your submission.

J. M. WILKIN
9778 Shire Engineer and Planner

Town and Country Planning Act 1961
SHIRE OF METCALFE

Notice that an Interim Development Order Amendment has been Prepared and is Available for Inspection

Shire of Metcalfe Interim Development Order
No. 2
Amendment No. 4

Notice is hereby given that the Council of the Shire of Metcalfe, in pursuance of its powers under the *Town and Country Planning Act 1961*, has prepared an amendment to enable a tailings storage dam and water reclamation pond to be constructed and used without a planning permit on a specified site in the Wattle Gully Mine area at Chewton.

A copy of the amendment has been deposited at the Shire Office, Metcalfe, the office of the Ministry for Planning and Environment, 477 Collins Street, Melbourne and the regional office of the Ministry for Planning and Environment, 391 Hargreaves Street, Bendigo and is available for inspection, free of charge, by any person during office hours.

Any submission in respect of the amendment is required to be set forth in writing, addressed to the Shire Secretary, Shire Office, Metcalfe by 25 January 1988 and should state whether the writer wishes to be heard in respect of the submission.

M. B. WATSON
9776 Shire Secretary

SHIRE OF METCALFE
Notice of Intention to Take Land Compulsorily

The Council deems it expedient to exercise its power of taking land compulsorily in order to provide the land required for the replacement, on a new alignment, of the bridge known as Todd's Bridge over the Coliban River on the Metcalfe-Taradale Road, Taradale and the construction of associated roadworks.

The land to be acquired is the whole of Crown Allotment 1, section B, Town of Taradale (Crown Grant Volume 4251 Folio 018), and those parts of Crown Allotments 9D, 9E, 9W, 9X and 9Y section 5, Township of Dalhousie (Certificate of Title Volume 9176 Folio 102 and Crown Grant Volume 8060 Folio 785) shown hatched on the plan below.

The maps and other papers prepared pursuant to section 512 (1) of the Local Government Act and approved by the Council, showing the general description of the work for which the land proposed to be taken is to be used, the description of the lands proposed to be taken, and the names of known owners, occupiers and mortgagees affected by the proposal, are open for inspection at the Shire Office, Metcalfe, during office hours.

All persons affected by the proposed taking of the land are called upon to set forth in writing addressed to the Shire Secretary, Shire Office, Metcalfe 3448 within forty clear days from the publication of this notice in the *Government Gazette*, all objections they may have to the taking of the land.

The Council at its ordinary meeting on Wednesday, 27 January 1988, commencing at 10.00 a.m., will consider any such objections, and any person so objecting may appear before the Council in support of such objections.

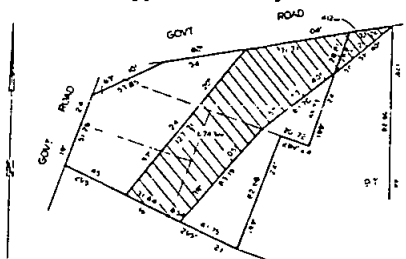

9747. **M. B. WATSON**
Shire Secretary

Form 2.1
Town and Country Planning Act 1961
SHIRE OF NARRACAN PLANNING
SCHEME 1984

Notice that a Planning Scheme has been Prepared and is Available for Inspection
Amendment No. 2—1987

Notice is hereby given that the Shire of Narracan, in pursuance of its powers under the *Town and Country Planning Act 1961*, has prepared a scheme for Lot 142 on Plan of Subdivision No. 146106 which is located between King Street and Wirraway Street, south of the City of Moe.

A copy of the scheme has been deposited at the office of the Shire of Narracan, Princes Highway, Trafalgar, the office of the Ministry for Planning and Environment, 71 Hotham Street, Traralgon, and at the office of the Ministry for Planning and Environment, The Olderfleet Buildings, 477 Collins Street, Melbourne, and will be open for inspection during office hours by any person free of charge.

Any persons affected by the scheme are required to set forth in writing any submission they may wish to make with respect to the scheme addressed to the Director, Technical Services, Shire of Narracan, P.O. Box 140, Trafalgar 3824, by 23 January 1988, and state whether they wish to be heard in respect of their submission.

Dated 18 December 1987

R. D. THEGE
Director, Technical Services

Note—This amendment proposes to rezone land from Future Urban to Residential A. 9770

Town and Country Planning Act 1961
SHIRE OF PAKENHAM PLANNING
SCHEME PART I

Notice that a Planning Scheme has been Prepared and is Available for Inspection
Amendment No. 59

Notice is hereby given that the Council of the Shire of Pakenham in pursuance of its powers under the *Town and Country Planning Act 1961* has prepared a Planning Scheme for the Municipal district of the Shire of Pakenham including land being lot 1, L.P. 98674, Parish of Pakenham, Princes Highway, Beaconsfield.

The amendment involves the rezoning of the above land from Restricted Use Zone—No. 10 to Commercial 1 together with several ordinance amendments dealing with "Home Industry," "Commercial Vehicle Storage" and changes to the provisions relating to family excisions in the non-urban zones throughout the Municipality.

A copy of the Scheme has been deposited at the Shire Offices, Henty Way, Pakenham, 3810 and at the office of the Ministry for Planning and Environment, The Olderfleet Buildings, 477 Collins Street, Melbourne, and will be open for inspection during office hours by any person free of charge.

Any persons affected by the Scheme are required to set forth in writing any submission they may wish to make with respect to the Scheme addressed to the Shire of Pakenham, P.O. Box 7, Pakenham, Vic. 3810, by 29 January 1988 and state whether you wish to be heard in respect of your submission.

Dated 11 December 1987

R. T. R. CANOBIE
Acting Shire Secretary

9767

Town and Country Planning Act 1961
**SHIRE OF TRARALGON PLANNING
 SCHEME INTERIM DEVELOPMENT
 ORDER**

Notice that a Proposed Amendment has been Prepared and is Available for Inspection
 Amendment Nos. 19, 20, 21, 22, 23, 24, 25, 26, 27, 28

Notice is hereby given that the Shire of Traralgon in pursuance of its powers under the *Town and Country Planning Act 1961* has prepared proposed amendments to:

Amendment No. 19—To rezone Part Crown Allotment 83A, section A, Parish of Traralgon, on the north east corner of Jeeralang North Road and Church Road, Hazelwood North, to Rural Residential Zone.

Amendment No. 20—To rezone Part of Crown Allotment 14A, Parish of Boola Boola, on the north east corner of Mays Road and Monaro Drive, Tyers, to Rural Residential Zone.

Amendment No. 21—To rezone Part of Crown Allotment 90A and Part Crown Allotment 91, section A, Parish of Traralgon, on Clarkes Road, Hazelwood North to Rural Residential Zone.

Amendment No. 22—To introduce a new zone within the Ordinance being Residential Zone.

Amendment No. 23—To rezone Part Crown Allotment 46, Parish of Traralgon, Banks Street, Traralgon, to Residential Zone and introduce a new zone being Residential Zone.

Amendment No. 24—To rezone Part Crown Allotment 8, section A, Parish of Loy Yang, on McNairn Road, Traralgon, to Residential Zone and to introduce a new Zone being Residential Zone.

Amendment No. 25—To rezone Part of Crown Allotment 45A, Parish of Traralgon, on Coonoc Road, to Residential Zone and to introduce a new zone being Residential Zone.

Amendment No. 26—To amend the Ordinance as a site specific amendment to allow the subdivision of Part Lot. 4, L.P. 61314, Part Crown Allotment 82, Parish of Traralgon, on Jeeralang North Road, into two allotments.

Amendment No. 27—To reserve Lots 2 and 3 on L.P. 148557, Part Crown Allotment 8v, Parish of Loy Yang in Chester Court, Traralgon South, for Education Department purposes.

Amendment No. 28—To rezone Part Crown Allotments 88 and 88A, Parish of Traralgon, on Jeeralang North Road, Hazelwood North to Rural Residential.

A copy of the proposed amendments have been deposited at the Shire of Traralgon, corner Kay and Breed Streets, Traralgon, and at the Office of

the Ministry for Planning and Environment, The Olderfleet Buildings, 477 Collins Street, Melbourne, and at the office of the Ministry for Planning and Environment Central Gippsland Office, 71 Hotham Street, Traralgon, and will be open for inspection during office hours by any person free of charge.

Any persons affected by the proposed amendment are required to set forth in writing any submission they may wish to make with respect to the proposed amendment addressed to the Shire Secretary, Shire of Traralgon, P.O. Box 180, Traralgon, 3844 by 28 January 1988, and is required to state whether you wish to be heard in respect of the submission.

Dated 16 December 1987

H. M. ALEXANDER
 Shire Secretary

9768

**SHIRE OF WOORAYL
 By-Law No. 69**

Street and Itinerant Traders By-Law

Notice is hereby given that the Council of the Shire of Woorayl has made a By-Law entitled the Street and Itinerant Traders By-Law.

This By-Law is for the purpose of:

- (a) Regulating the use of streets, roads and public places by street hawkers and itinerant traders dealing in goods with power to prohibit any such persons during particular hours from using any streets, roads or public places.

A copy of this By-Law is available for inspection free of charge during office hours at the Shire Office, Smith Street, Leongatha.

R. G. STANLEY
 Shire Secretary

9779

STAWELL WATER BOARD

Notice to the owners of tenements in the undermentioned streets, lanes, courts and alleys opening thereto.

The main pipe in the said street being laid down, the owners of all tenements, situated as under are hereby required on or before 1 January 1988 to cause a proper pipe and stop cock to be laid so as to supply water within such tenements from the main pipe.

Rose Street, Crown Allotment 22, section 110, Parish of Stawell.

N. R. ILLIG
 Secretary

9748

RUTHERGLEN WATER BOARD

(Rutherglen Sewerage District)

The Rutherglen Water Board having made provision for carrying away Sewerage from each and every property which or any part of which is within the Sewerage Area hereinafter described, hereby declare that on and after 1 January 1988, each and every property which or any part of which is within the said Sewerage Area shall be deemed to be a seweraged property within the meaning of the *Sewerage Districts Act 1958*.

The seweraged area referred to above is:

Declared Area No. 3: Being generally the area fronting Killeens Road and southern side of Moodemere Street and being area between the Sewerage District Boundary and Declared Area No. 2.

The boundaries of the said Declared Area No. 3 is delineated on a plan which may be inspected at the Boards Office, Rutherglen.

WALTER J. McQUILLEN
Secretary/Manager

9749

Water Act 1956
Eight Schedule

COLAC DISTRICT WATER BOARD

Notice to the owners of tenements Crown Allotments 26A and 26C Parish of Yaugher, Township of Gellibrand, Government Road Gellibrand.

The main pipe in the said street being laid down, the owners of all tenements situated as above are hereby required on or before 31 January 1988 next to cause a proper pipe and stop-cocks to be laid so as to supply water within such tenements from the main pipe.

Dated 16 December 1987

Board Office

42-48 Hesse Street, Colac

J. T. WILKINSON
Manager/Secretary

9771

GEE LONG AND DISTRICT WATER BOARD

Pursuant to section 60 of the *Geelong Waterworks and Sewerage Act 1958* (No. 6263) the Board has prepared plans to indicate the particulars of sewers and underground works, the construction of which the Board intends to begin at a date not less than one month after publication of the notices, in or adjacent to the following locality within the drainage area.

High Street, Belmont; City of South Barwon.

Notice is hereby given that the plans indicated are open for public inspection at the board's offices, 61-67 Ryrie Street, Geelong between the hours of 8.10 a.m. and 5.00 p.m. from Monday to Friday (public holidays excepted) by the owners or occupiers of land or premises within the drainage area.

R. A. JORDON
Secretary

9785

NOTICE OF DISSOLUTION

Notice is hereby given that the Partnership heretofore subsisting between Sinwood Pty. Ltd. and Tempe Pty. Ltd. and Paul Shane Barker carrying on business as media and commercial photographers at 167-169 Dorcas Street, South Melbourne under the style or firm of Haig & Mant Photographers has been dissolved by mutual consent as from 1 July 1987 so far as concerns the said Paul Shane Barker who retires from the said firm.

Dated 15 December 1987

Messrs WINNEKE MURRAY, solicitors for and on behalf of Sinwood Pty. Ltd. & Tempe Pty. Ltd.

9789

Companies (Victoria) Code

Companies Form 125

Regulation 84 (2)

OTALRET PTY. LTD.

(In Liquidation)

Notice to Members and Creditors of Meeting
Pursuant to section 411 of the Companies
(Victoria) Code

Notice is hereby given that a final meeting of members and creditors of the abovenamed company will be held on Thursday, 4 February 1988, at 2.30 p.m., in the office of James Romanis & Co., 2nd Floor, 270 Queen Street, Melbourne, pursuant to the provisions of section 411 of the Companies (Victoria) Code.

Agenda

1. To lay before the meeting an account of the acts and dealings of the Liquidator and of the conduct of the winding up.

2. To approve and fix Liquidator's remuneration by Special Resolution.

3. Any other business.

Dated 8 December 1987

JAMES SCOTT ROMANIS, Liquidator

James Romanis & Co., chartered accountants,
2nd Floor, 270 Queen Street, Melbourne 3000

9790

Companies (Victoria) Code
Companies Form 125
Regulation 84 (2)
**MURRAY VALLEY REFRIGERATION
PTY. LTD.**

(In Liquidation)

Notice to Members and Creditors of Meeting
Pursuant to section 411 of the Companies
(Victoria) Code

Notice is hereby given that a final meeting of members and creditors of the abovenamed company will be held on Thursday, 4 February 1988, at 10.00 a.m., in the office of James Romanis & Co., 2nd Floor, 270 Queen Street, Melbourne, pursuant to the provisions of section 411 of the Companies (Victoria) Code.

Agenda

1. To lay before the meeting an account of the acts and dealings of the Liquidator and of the conduct of the winding up.

2. To approve and fix Liquidator's remuneration by Special Resolution.

3. Any other business.

Dated 8 December 1987

JAMES SCOTT ROMANIS, Liquidator
James Romanis & Co., chartered accountants,
2nd Floor, 270 Queen Street, Melbourne 3000
9791

Unclaimed Moneys Act 1962

Register of Unclaimed Moneys held by the—

<i>Name of Owner on Books and Last Known Address</i>	<i>Total</i>		<i>Date when Amount first became Payable</i>
	<i>Amount Due to Owner</i>	<i>Description of Unclaimed Money</i>	

\$

GKN KWIKFORM SALES PTY. LTD.

Doyle, Brian S., 41 El Reno Crescent, Airport West 9665	201.00	Wages	2.12.86
---	--------	-------	---------

Creditors, next of kin and others, having claims in respect of the estate of Jean Hamilton late of Flat 7, 322 Orrong Road, North Caulfield who died on 12 November 1987 are required to send particulars of their claims to the executrix Mary Sanders of Unit 7, 235 Balaclava Road, Caulfield, in care of the undersigned solicitors on or before 2 March 1988 after which date she will distribute the assets of the estate having regard only to the claims of which she then has notice.

DOBSON & GILES, solicitors of 79 Hawthorn Road, Caulfield 3161 9786

Creditors, next of kin and others having claims in respect of the estate of Jazeps Mazgalvins (also known as Joseph Mazgalvins) late of 89 Liddiard Street, Hawthorn, deceased (who died on 8 November 1987) are requested to send particulars of their claims to the executrix of the estate Eva Tatjana Brenners care of the undermentioned solicitor by 15 March 1988 after which date she will convey and distribute the estate having regard only to the claims of which she then has notice.

E. T. BRENNERS, solicitor, of 114 Princess Street, Kew 9752

Creditors, next of kin and others having claims in respect of the estate of Lila Florence Williams late of 43 Elizabeth Street, St. Albans in the State of Victoria, widow, deceased who died on 13 November 1987 are required by the executor of the will Burt Easton of 197 Russell Street, Dennington, Warrnambool in the said State retired to send particulars of their claims to J. & S. Shatin & Bernstein, solicitors, 114 William Street, Melbourne by 6 March 1988.

J. & S. SHATIN & BERNSTEIN, solicitors, 114 William Street, Melbourne 9751

THELMA ROSE PEAD late of 13 Stutt Avenue, Doncaster, married woman, deceased

Creditors, next of kin and others having claims against the estate of the said deceased who died on 9 September 1987 are to send particulars of their claims to Allan Day Pead care of Messrs. Blake & Riggall, solicitors, 140 William Street, Melbourne by 23 March 1988 after which date he will distribute the assets having regard only to the claims of which he then has notice.

BLAKE & RIGGALL, 140 William Street, Melbourne, solicitors 9792

CHRISTOPHER ALPHONSUS BURKE, late of 20 Chisholm Street, Swan Hill in the State of Victoria, retired farmer, deceased (who died on 29 July 1987)

Creditors, next of kin and all other persons having claims against the estate of the deceased are required by the Executrices of the Will, Quita Lorene Burke, Carolyn Louise Burke and Paula Joanne Burke, to send particulars to them care of the undersigned on or before 18 February 1988, after which date they will distribute the assets having regard only to the claims of which they then have notice.

GARDEN & GREEN, solicitors, 4 McCallum Street, Swan Hill 9787

RENEE ELLIS BUCHANAN, late of Mount Street, Eaglemont in the State of Victoria, widow, deceased

Creditors, next of kin and others having claims in respect of the estate of the deceased (who died on 18 August 1987) are required by The Perpetual Executors and Trustees Association of Australia Limited of 50 Queen Street, Melbourne to send particulars of their claims to the said Company by Friday, 26 February 1988 after which date it will convey or distribute the assets, having regard only to the claims of which the Company then has notice.

BEST HOOPER, solicitors, 400 Little Collins Street, Melbourne 3000 9788

Creditors, next of kin and others having claims against the estate of Isabel Burton Hodge late of Flat 2, 19 Munro Street, Armadale in the State of Victoria, retired medical social worker, deceased who died on 17 September 1987 are required to send particulars of their claims to the executors Donald Ledingham Cooper, the senior partner at the date of death of the deceased of the firm Weigall & Crowther, and William Brind Zichy Woinarski care of the undermentioned solicitors on or before 23 February 1988 after which date they will distribute the assets having regard only to the claims of which they then have notice.

WEIGALL & CROWTHER of 385 Bourke Street, Melbourne, solicitors for the estate 9793

HELEN LOUISE ARNOLD late of Banksia Close, 391 Maroondah Highway, Croydon, widow, deceased

Creditors, next of kin and others having claims in respect of the estate of the deceased who died on 11 October 1987 are required by the executor ANZ Executors and Trustee Company Limited of 94 Queen Street, Melbourne to send particulars to it by 29 February 1988 after which date the

executor may convey or distribute the assets having regard only to claims of which it then has notice.

ARTHUR ROBINSON & HEDDERWICKS, solicitors, 535 Bourke Street, Melbourne 9794

CATHERINE MARTHA COATES (in the Will referred to as Lady Catherine Martha Coates) late of 2 Chastleton Avenue, Toorak, widow, deceased

Creditors, next of kin and others having claims in respect of the estate of the deceased (who died on 9 October 1987) are required by The Perpetual Executors and Trustees Association of Australia Limited of 50 Queen Street, Melbourne, to send particulars of their claims to the said Company by the 29 February 1988 after which date it will convey or distribute the assets, having regard only to the claims of which the Company then has notice. 9795

DOROTHY SMITH, late of "Monte Clare", Falls Road, Olinda in the State of Victoria, married woman, deceased

Creditors, next of kin and others having claims in respect of the estate of the deceased who died on 8 September 1987 are required by the Perpetual Executors and Trustees Association of Australia Limited of 50 Queen Street, Melbourne, to send particulars of their claims to the said Company by 15 February 1988 after which date it will convey or distribute the assets, having regard only to the claims of which the company then has notice. 9750

Creditors, next of kin and others having claims in respect of the estate of George Blackie Simpson late of Flat 3, 88 Normandy Avenue, Thornbury in the State of Victoria, gentleman, deceased who died on 28 September 1987, are to send particulars of their claim to The Equity Trustees Executors and Agency Company Limited of 472 Bourke Street, Melbourne, the executor appointed by the deceased's will dated 6 February 1986 by the 23 February 1988, after which date the said executor will distribute the assets having regard only to the claims of which it shall then have had notice.

WILLIAM M. SERONG, solicitors, 274 Queens Parade, Clifton Hill 9772

RONALD GOLDENBERG, late of 25 Sylvally Grove, Caulfield South, retired accountant, deceased

Creditors, next of kin and others having claims in respect of the estate of the abovenamed Ronald Goldenberg deceased who died on 1 October 1987, are required by The Union-Fidelity Trustee Company of Australia Limited of 100 Exhibition

Street, Melbourne, which Company has made application to the Supreme Court for a grant of representation, to send particulars of their claims to the said Company at its above-mentioned address by 8 March 1988, after which date the said company will convey or distribute the assets of the estate of the said deceased having regard only to the claims of which it then has notice.

BONELLA, CUTLER & CO., of 110 Hawthorn Road, Caulfield, solicitors for the said company 9773

MONICA MARY REIDY, late of 8 Milroy Street, East Brighton in the State of Victoria, retired, deceased, intestate

Creditors, next of kin and others having claims in respect of the estate of the deceased who died on 8 December 1987 are required by the administrator Patrick Leo Reidy of 28 Princess Street, Footscray in the said state, retired, to send particulars to him care of his solicitors by 31 March 1988 after which date the administrator may convey or distribute the assets having regard only to the claims of which he then has notice.

Dated 16 December 1987

JAMES KELLEHER, barristers & solicitors, 235 Tyler Street, Preston 9774

Creditors, next of kin and others having claims in respect of the estate of Ernest Alfred Simmonds late of 50 Church Street, Benalla, retired agent (who died on 31 August 1987), are requested to send particulars of their claims in writing to the undermentioned solicitors for Betty Louise Bird and Catherine Nancy Burns the executrices by 1 April 1988 after which date the executrices will distribute the assets having regard only to the claims of which they then have notice.

HAMILTON CLARKE & BALKIN, solicitors, 81-83 Nunn Street, Benalla 9775

OLIVE MAY WILLIAMSON late of 1 Pratt Court, Rushall Park in the State of Victoria, spinster, deceased

Creditors, next of kin and others having claims in respect of the estate of the deceased, who died on 29 July 1987 are required by the Trustee, The Equity Trustees Executors and Agency Company Limited of 472 Bourke Street, Melbourne in the said State to send particulars to it by 21 February 1988 after which date the Trustee may convey or distribute the assets, having regard only to the claims of which the Trustee then has notice.

HALL & WILCOX, solicitors, 140 William Street, Melbourne 3000 9796

BESSIE FRANKS formerly of Flat 9, 333 Auburn Road, Hawthorn but late of 400 Waverley Road, East Malvern, retired salvation army officer, deceased

Creditors, next of kin and others having claims in respect of the estate of the deceased who died on 12 August 1987 are required by the legal personal representative Keith Earl of 39 Park Street, South Melbourne, salvation army officer, to send particulars to him by 23 February 1988 after which date he will distribute the assets having regard only to the claims of which he then has notice.

E. P. JOHNSON & DAVIES of 257 Collins Street, Melbourne 9797

LOIS OLIVE DILLON late of 169 Cumberland Road, Pascoe Vale, married woman, deceased

Creditors, next of kin and others having claims against the estate of the said deceased who died on 26 August 1987 are to send particulars of their claims to Robert Herbert Dillon care of Messrs. Blake & Riggall solicitors 140 William Street, Melbourne by 23 March 1988 after which date he will distribute the assets having regard only to the claims of which he then has notice.

BLAKE & RIGGALL, 140 William Street, Melbourne, solicitors 9798

Creditors, next of kin and others having claims in respect of the estate of Laura Molloy late of 20 Gordon Street, Footscray in the State of Victoria, widow, deceased who died on 18 October 1987 are required to send particulars of their claims to the executor John Henry Molloy care of the undermentioned solicitors by 24 February 1988 after which date the Executor will distribute the assets of the deceased having regard only to the claims of which he then has notice.

SECOMB McDONALD SMITH JONES & KENNEDY, solicitors 59-63 Irving Street, Footscray 3011 9799

LAURANCE HARPER JEFFREY, late of Ellinbank, via Warragul, farmer deceased

Creditors, next of kin and others having claims in respect of the estate of the deceased who died on 30 April 1987 are required by the Trustee Doris Marion Jeffrey to send particulars of their claims to her care of the undersigned Solicitors by 30 January 1988 after which date the Trustee may convey or distribute the assets having regard only to the claims of which she then has notice.

GRAY, FRIEND & LONG, solicitors, Warragul 9763

GLADYS ETHEL VERRER late of 27 Shadforth Street, Kerang in the State of Victoria, married woman, deceased

Creditors, next of kin and all other persons having claims against the Estate are required by Clement Rodney Verren of R.S.D., Hickey Road, Via Bacchus Marsh, aforesaid Telecom Technician, Andrew Lindsay Verren care of 29 Ballentyne Road, Kewdale in the State of Western Australia Geologist and Lorraine Francis Armstrong of 7 Salmon Place, Cambah in the Australian Capital Territory, married woman, the Executors of the Estate to send particulars of such claims to them in care of the undermentioned Solicitors on or before 25 February 1988 after which date they will distribute the assets having regard only to the claims of which they then have notice.

BASILE & CO., barristers and solicitors, 46 Wellington Street, Kerang 9761

CLEEVE LEE NORRIS late of 4 Longstaff Street, East Kew in the State of Victoria, widow deceased

Creditors, next of kin and others having claims in respect of the Estate of the deceased who died on 27 September 1987 are required by The Perpetual Executors and Trustees Association of Australia Limited of 50 Queen Street, Melbourne in the said State to send particulars of their claims to the said Company by 25 February 1988 after which date the said company may convey or distribute the assets, having regard only to the claims of which the said Company then has notice.

COOKE & CUSSEN, solicitors, 128 Exhibition Street, Melbourne 3000 9762

THOMAS CORNELIUS PENDLEBURY late of Room 343, Greeves Drive, Walmsley Village, Kilsyth in the State of Victoria, retired, deceased

Creditors, next of kin and others having claims in respect of the estate of the deceased who died on 27 August 1987 are required by The Equity Trustees Executors and Agency Company Limited of 472 Bourke Street, Melbourne to send particulars of their claims to the said Company on or before 24 February 1988 after which date it will convey or distribute the assets having regard only to the claims of which the Company then has notice.

WISEWOULD SCHILLING, solicitors, 459 Little Collins Street, Melbourne 9800

Creditors, next of kin and others having claims in respect of the Estate of Alexander Telfer Hall, late of 60 Myrtle Street, Bendigo retired salesman, deceased, who died on 2 July 1987 are required to send particulars of their claims to the Executors National Mutual Trustees Limited of 46 Queen Street, Bendigo and Stanley William Alexander Hall of 278 McKenzie Street, Golden Square care of the said Trustee Company by 4 March 1988 after which date it and he will distribute the assets having regard only to the claims of which it and he have notice.

ROGERS & EVERY, solicitors, 71 Bull Street, Bendigo 9764

In the Supreme Court of the State of Victoria
SALE BY THE SHERIFF

On Thursday, 4 February 1988 at 2.30 p.m. at the Sheriff's Office, 287 Springvale Road, Glen Waverley (unless process be stayed or satisfied).

All the estate and interest (if any) of Carol Phyllis Sheehan of 33 Thomas Street, Hampton, Kingsley William Gerald Sheehan of 4 Inner Crescent, Brighton, and Gregory William Harold Sheehan of 23 Olinda Street, Caulfield, are proprietors as tenants in common in equal shares of an estate in fee simple described in Certificate of Title Volume 9666 Folio 943 upon which is erected a double storey brick dwelling known as 33 Thomas Street, Hampton.

Registered Mortgage Nos M15191J and M144896E affect the estate and interest.

Terms—Cash only

9802 **H. BUETTNER**
Sheriff's Officer

In the Supreme Court of the State of Victoria
SALE BY THE SHERIFF

On Thursday, 28 January 1988 at 2.30 p.m. at the Sheriff's Office, 287 Springvale Road, Glen Waverley (unless process be stayed or satisfied).

All the estate and interest (if any) of Yavous Moustafa (also known as John Moustafa) shown on Certificate of Title as Yavouz Moustafa of 35 Octatis Street, East Doncaster, as joint proprietor with Jale Moustafa of an estate in fee simple in the land described in Certificate of Title Volume 9061 Folio 115 upon which is erected a brick veneer dwelling known as 35 Octatis Street, East Doncaster.

Registered Mortgage Nos G751349, and K239677 affect the said estate and interest.

Terms—Cash only

9803 **H. BUETTNER**
Sheriff's Officer

In the Supreme Court of the State of Victoria
SALE BY THE SHERIFF

On Thursday, 28 January 1988 at 2.30 p.m. at the Sheriff's Office, 287 Springvale Road, Glen Waverley (unless process be stayed or satisfied).

All the estate and interest (if any) of Ann M. Driver of 17 Denison Grove, Launceston, Tasmania, shown on Certificate of Titles as Ann Mardi Driver proprietor of an estate in fee simple in the land described in the Certificate of Title.

Firstly: Volume 8845 Folio 458 upon which is erected a Strata Title Unit and known as Unit 51, No. 422 Cardigan Street, Carlton.

Secondly: Volume 8845 Folio 513 which is an accessory Car Park Unit and known as Unit 106, No. 422 Cardigan Street, Carlton.

Registered Mortgage D851113 affects the estate and interest on both titles.

Terms—Cash only

Sold to the highest bidder. No reserve set.

H. BUETTNER
 Sheriff's Officer

9801

LATE NOTICES

Local Government Act 1958
PROCLAMATION OF PUBLIC HIGHWAY
SHIRE OF HEALESVILLE

I, J. Davis McCaughey, Governor of Victoria, acting with the advice of the Executive Council and under section 519 of the *Local Government Act 1958*, proclaim that part of Forest Street, Yarra Glen, shown by hatching on the plan hereunder to be public highway.

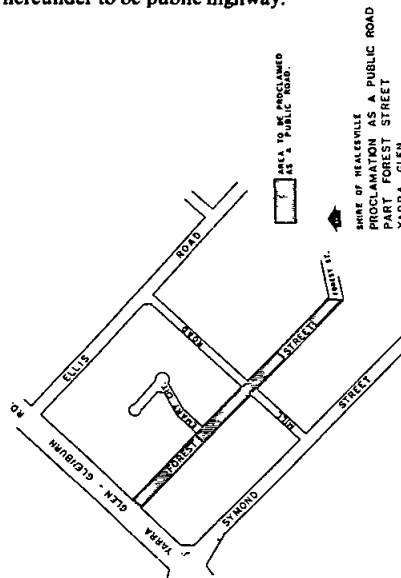

Given under my hand and the seal of
 Victoria on 22 December 1987.

(L.S.) J. DAVIS McCAUGHEY

By His Excellency's Command

J. L. SIMMONDS

Minister for Local Government

Land Act 1958

PROCLAMATION OF ROAD

I, J. Davis McCaughey, Governor of Victoria, acting with the advice of the Executive Council and under section 25 (3) (c) of the *Land Act 1958*, proclaim as road the following land:

Municipal District of the Shire of Cranbourne

SHERWOOD—The land in the Parish of Sherwood as indicated by hatching on plan hereunder (L12-0155).

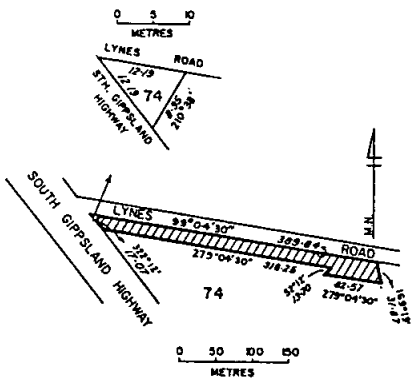

Given under my hand and the seal of Victoria on 22 December 1987.

(L.S.) J. DAVIS McCaughey

By His Excellency's Command

J. E. Kirner

Minister for Conservation, Forests and Lands

STATE TENDER BOARD
CONTRACTS ACCEPTED
Amendments

Schedule Number	Item Number	New Rate	Effective Date
-----------------	-------------	----------	----------------

\$

Paints and Painters Sundries

1/13	81	0.7155	14.12.87
	82	0.7115	
	83	0.6335	

Motor Spirit, Fuel, Oils, Kerosene and Lubricants

1/53B	1	0.4904	14.12.87
	2	0.5003	
	5	0.4948	
	6	0.5047	
	7	0.5574	
	8	0.5474	
	10	0.5280	
	12	0.5335	
	14	0.5252	
	16	0.5302	
	17	0.5254	
	18	0.5254	
	26	0.4857	
	27	0.4932	
	28	0.5509	

29	0.5459
23	0.6213
24	0.5583
25	0.5792
32	0.4445
33	0.9305
34b	0.9264
35	1.0543
36	0.8591
37	2.9360
38a	1.0744
38b	1.1004
40	1.6372

Light Commercial Motor Vehicles

1/59A (4)	4A	11 874.00	22.12.87
	4C	13 002.00	
1/59B (2)		10 384.00	22.12.87
1/59B (3)	3B Manual	12 009.00	
	Auto	13 032.00	
	3C Manual	13 495.00	
	Auto	14 420.00	
1/59B (4)	4A Manual	13 181.00	
	Auto	14 114.00	
	4D Manual	14 456.00	
	Auto	15 380.00	
1/59C (3)	3A	14 977.00	22.12.87
	3C	15 777.00	
15/C (4)	4A		
	3 seater	19 005.00	
	6 seater	19 830.00	
	11 seater	19 389.00	
	4B		
	3 seater	21 646.00	
	6 seater	22 471.00	
	11 seater	22 030.00	
1/59C (5)	5B	20 074.00	
1/59C (6)	6B	16 905.00	
	6D	19 489.00	
1/59D (2)	2A	16 637.00	
	2C	17 968.00	
1/59D (3)	Coaster 20 seat Diesel	33 890.00	
1.59E	C		
	YH81R-MDBQ-3	10 071.00	
	LH80R-MDBQ-3	11 702.00	
	YH81R-MDPQ	12 666.00	
	LH80R-PDBQ3	12 958.00	

LY60R- MDBQ3	13 158.00
YU62R- MDBTQ3	13 335.00
BU61R- MDBTQ3	14 592.00
BU60R- MDPQ	16 249.00
BU85R- MDDHTQ3	16 888.00
BU85R- MDPHTQ3	19 511.00
WU90R- MDDTQ3	19 112.00

CONTRACTS ACCEPTED—(Series 1987-88).
Public Works

Beechworth United Sh DSP 158497/1—Staff/
Admin Upgrade, Beechworth Primary School—
\$170 218.00—F. & D. Jensen Constructions,
Beechworth.

Melton Shire DSP 150106/4—Construction
Brickwork, Kurunjang Post Primary School—
\$75 094.00—N. J. & L. J. Cartledge Pty. Ltd.,
O'Leary Road.

Melton Shire DSP 150106/5—Construction
Aluminium Windows, Kurunjang Post Primary
School—\$95 577.00—H. Troon Pty. Ltd.,
Wendouree.

Dated 18 December 1987

J. M. PAWSON
Secretary to the Tender Board

JOHN DEVENISH
Director-General of Public Works

CONTRACTS ACCEPTED—(Series 1988)

Schedule No. 1/77

TYPEWRITERS, ELECTRONIC AND MICROPROCESSOR BASED WORD PROCESSING
SYSTEM

Contracts from 1 January 1988 to 31 December 1988

1988/843—Brother Industries (Aust) Pty. Ltd., 7 Khartoum Road, North Ryde, N.S.W., 2113.
Telephone (02) 887 4344.

1988/844—Canon Australia Pty. Ltd., 10 Hall Street, Hawthorn East, Vic., 3123. Telephone
(03) 200 6200.

Item No.	Description	Unit of Measurement	Rate	Name of Contractor
			\$	
1.	Typewriter, Electronic, Heavy Duty, "Compact type" with correction facility and interchangeable daisy wheel type element:			Brother Industries Pty. Ltd.
	"CE 500"	each	380.00	
	"CE 650" (7K memory)	each	480.00	
1 (a)	Additional Daisy Wheels	each	20.00	
2.	Typewriter, Electronic, Heavy Duty "Office Machine" with correction facility and interchangeable daisy wheel, "AP 800"	each	658.00	Canon Australia Pty. Ltd.
2 (a)	Additional Daisy Wheels	each	17.00	
3.	Typewriter, Electronic, Heavy Duty "phrase play back type" with editable memory A3 carriage and interchangeable daisy wheel type element, "EM 611" (16K memory)	each	750.00	Brother Industries Pty. Ltd.
3 (a)	Additional Daisy Wheels	each	20.00	

Item No.	Description	Unit of Measurement	Rate	Name of Contractor
			\$	
4.	Typewriter, Electronic, Heavy Duty with fully editable memory and interchangeable daisy wheel type element, "AP 810" (31K memory)	each	910.00	Canon Australia Pty. Ltd.
4 (a)	Additional Daisy Wheels	each	17.00	
5.	Microprocessor Based Word Processing System, IBM compatible with disk storage, separate keyboard, screen, word processing software and printer facility: "A200II, 256 Kb RAM, 2 x 360K disk drives and Word Perfect software.	each	2140.00	Canon Australia Pty. Ltd.
	Optional Upgrades—			
	640 K RAM		286.00	
	20 Mb Hard disk, 360K disk drive		700.00	
	Optional Printers—			
	AP 800, 23 cps Typewriter with interface cable		803.00	
	LBP8II Laser Printer		3710.00	

Brother Industries Pty. Ltd.

Orders are to be sent to: 16 Thornton Crescent, Mitcham, Victoria 3132

Delivery, installation and operator training are included in the contract rates throughout the State of Victoria.

Warranty Period: 12 months.

Maintenance Charges: CE 500 \$89.00 per annum

CE 650 \$99.00 per annum

EM 611 \$115.00 per annum

The above charges cover maintenance within 40 km of an authorised "Brother" service centre. Country locations, 40 km-100 km from service centre plus \$20.00 per annum, over 100 km plus \$40.00 per annum.

Maintenance agreements should not be entered into until expiry of warranty period.

A help line service is available to operators seeking assistance in the operation of the contract typewriters. The telephone number is (008) 25 1419.

Canon Australia Pty. Ltd.

Delivery, installation and operator training are included in the contract rates.

Warranty Period: 12 months.

Maintenance charges per annum:

Model	Metro.	Country
	\$	\$
AP 800	85.00	110.00
AP 810	95.00	125.00
A200II	300.00	300.00

Maintenance Agreements should not be entered into until the expiry of the warranty period.

*Motor Car Act 1958, Section 35*NOTICE OF SPECIAL PERMITS ISSUED BY THE ROAD TRAFFIC AUTHORITY UNDER
THE COUNCIL GRAIN PERMIT SCHEME

The Road Traffic Authority has issued special permits under section 35 of the *Motor Car Act 1958* in accordance with the Council Grain Permit Scheme to enable certain vehicles to exceed the prescribed mass limits in section 33 of the Act. The conditions of the permit are as follows:

1. The permit extends from 24 November 1987 to 31 March 1988;
2. travel is limited to:
 - (a) State Highways, Main Roads and Freeways (declared in accordance with the *Transport Act 1983*); and
 - (b) other roads within the municipalities specified by the Authority by notice in the *Government Gazette* with such limitations or restrictions as are set out in the notice.
3. only bulk grain, grain legumes or oilseeds are carried;
4. travel is by the shortest reasonable route between the growers' property and the nearest practicable Grain Elevator's Board (GEB) local silo, GEB central receival point or other receival point approved by the Authority in the *Government Gazette*;
5. the vehicle does not travel on a bridge or road if the gross mass of the vehicle and load exceeds the limit shown on a notice erected on the approaches to the bridge or road;
6. the gross mass of the vehicle and load does not exceed its normal legal load limit or the manufacturer's rating for the vehicle by more than 25% or two tonnes, whichever is the lesser, or in any case—40 tonnes;
7. the mass limits for axles or axle groups specified below are not exceeded:

<i>Axle Group</i>	<i>Mass Limit</i>	<i>Axle Group</i>	<i>Mass Limit</i>
Single Axle:	Tonnes	Tri-Axle Group	Tonnes
2 Tyres	6.4	12 Tyres	20.0
2 Wide Single Tyres	7.7	6 Wide Profile Tyres	20.0
4 Tyres	9.5		
Tandem Axle Group:		Twin Steer Axle Group:	
4 Tyres	11.5	With Load Sharing	
4 Wide Profile Tyres	14.8	Suspension	11.0
6 Tyres	13.5		
8 Tyres	16.5	Without Load Sharing	
		Suspension	10.0

Councils Participating in 1987-88 Council Grain Permit Scheme

Without Restrictions

Shire of Avoca	Shire of Kerang
Shire of Bannockburn	Shire of Korong
City of Benalla	Shire of Leigh
Shire of Benalla	Shire of Lowan
Shire of Birchip	Shire of Maldon
Shire of Broadford	Shire of McIvor
Town of Camperdown	Shire of Metcalfe
Shire of Charlton	Shire of Mount Rouse
Shire of Chiltern	Shire of Numurkah
Shire of Cobram	Shire of Oxley
Shire of Cohuna	Shire of Rochester
City of Corio	Shire of Rodney
Shire of Deakin	Shire of Rosedale
Shire of Dimboola	City of Shepparton

Shire of Donald	Shire of Shepparton
Shire of Dunmunkle	Town of St. Arnaud
Shire of East Loddon	Shire of Stawell
Shire of Euroa	Shire of Tullaroop
Shire of Gisborne	Shire of Tungamah
Shire of Grenville	Shire of Walpeup
City of Horsham	City of Wangaratta
Shire of Huntly	Shire of Wangaratta
Shire of Kaniva	Shire of Waranga
Shire of Kara Kara	Shire of Wimmera
Shire of Karkaroc	Shire of Wycheproof
Borough of Kerang	

With Restrictions

Shire of Arapiles—Excluding Three Bridges Road between Horsham–Noradjuha Road and Plozza's Road, and Victoria Valley Road between Old Adelaide Road and Brimpaen–Laharum Road.

Shire of Ararat—13 tonne gross limit on the bridge over Wimmera River on Eversley–Crowlands Road.

Shire of Bacchus Marsh—Excluding Lerderberg River Road.

City of Echuca—Excluding Anstruther Street between Hovell Street and Sturt Street, Hume Street between Pakenham Street and Anstruther Street, Hovell Street between Pakenham Street and Anstruther Street, Heygarth Street between High Street and Percy Street.

Shire of Kowree—Excluding Lake Charleygrark Road–Minimay, McPheep Road–Carpolac, W. Kealys Road Patyal.

Shire of Marong—Excluding roads and bridges already sign posted accordingly.

Shire of Mildura—20 tonne gross limit on Red Cliffs–Morkalla Road, between the Calder Highway and Werrimull.

Shire of Nathalia—Excluding Yambuna Bridge and James Bridge.

Shire of Rutherglen—Excluding Campbell Street between Gooramedda Road and Culbertson Street.

City of Swan Hill—Excluding Monash Drive, Curlewis Street, Woorinen Road, Werril Street, Karinie Street.

Shire of Warracknabeal—Excluding Scott Street between Phillips and Lyle Streets.

Shire of Yarrawonga—Peechelba Main Road has a 15 Tonne Load Limit Imposed.

Note: This notice replaces a notice which appeared in the *Victoria Government Gazette*, No. G47 dated 2 December 1987.

Dated 18 December 1987

D. R. HAMILTON
General Manager
Road Transport Regulation
Road Traffic Authority

<i>Transport Act 1983</i>	<i>Applicant</i>	<i>Previous Gazette No.</i>	<i>Date</i>
ROAD TRANSPORT LICENSING TRIBUNAL	B. L. Bacon	G.20	27.5.87
Commercial Passenger Vehicle Licence Applications	V. Cartelli	G.28	22.7.87
	R. Cartelli	G.28	22.7.87
	G. Campagnolo	G.22	10.6.87
	P. Bartuccelli	G.26	8.7.87
	V. Mercuri	G.26	8.7.87
	Dated 18 December 1987		

Notice is hereby given that applications by the following parties, previously gazetted and objected to, will be considered by the Road Transport Licensing Tribunal in the Teaching Service Appeals Board Hearing Room, Level 7, 420 St Kilda Road, Melbourne on Thursday, 28 January 1988.

G. S. HUGHES
Registrar

I hereby give notice that on 2 December 1987, the State Trust Corporation of Victoria filed an Election to Administer the following deceased person's estate in accordance with section 17 of the *State Trustee's Act* 1958:

Maloney, William, but late of Flat 11, 24 Dalgety Street, St. Kilda, pensioner, died 29 June 1987.

I hereby give notice that on 3 December 1987, the State Trust Corporation of Victoria filed an Election to Administer the following deceased person's estate in accordance with section 17 of the *State Trustee's Act* 1958:

Jaksic, Ivan, also known as Ivan Jasic, late of Flat 3, 31 Loch Street, Kew, public servant, died 19 July 1987.

I hereby give notice that on 7 December 1987, the State Trust Corporation of Victoria filed an Election to Administer the following deceased persons' estates in accordance with section 17 of the *State Trustee's Act* 1958:

Macdonald, Amanda May, formerly of 6 Buna Crescent, Puckapunyal, but late of 15 Markovitch Lane, Junortoun, pensioner, died 16 August 1987.

Molyneux, Edith Millicent, formerly of 48 Batesford Road, Chadstone, but late of Clarinda Centre Accommodation House, 123 Centre Road, South Oakleigh, pensioner, died 3 September 1987.

Thomas, Lillian Amy, late of Flat 42, 150 Inkerman Street, St. Kilda, pensioner, died 3 September 1987.

I hereby give notice that on 9 December 1987, the State Trust Corporation of Victoria filed an Election to Administer the following deceased person's estate in accordance with section 17 of the *State Trustee's Act* 1958:

Bonczek, Helmut, but late of Lakeside Hospital, Ballarat, pensioner, died 11 July 1987.

I hereby give notice that on 19 November 1987, the State Trust Corporation of Victoria filed an Election to Administer the following deceased person's estate in accordance with section 17 of the *State Trustee's Act* 1958:

Payne, Robert William, but late of 7 Abercrombie Street, Balwyn, retired, 27 August 1987.

Dated 16 December 1987

W. J. KILPATRICK
Managing Director
State Trust Corporation

Creditors, next of kin, and others having claims against the estate of any of the undermentioned deceased persons are required to send particulars of their claims to the State Trust Corporation of Victoria, 168 Exhibition Street, Melbourne Victoria 3000 the personal representative, on or before 25 February 1988 after which date the State Trust Corporation may convey or distribute the assets having regard only to the claims of which the State Trust Corporation then has notice:

Bonczek, Helmut, but late of Lakeside Hospital, Ballarat, pensioner, died 11 July 1987.

Grant, Laura, formerly of 11 Brassey Avenue, Rosanna, but late of Elgar Private Nursing Home, 366 Elgar Road, Box Hill, pensioner, died 8 November 1987.

Jaksic, Ivan, also known as Ivan Jasic, late of Flat 3, 31 Loch Street, Kew, public servant, died 19 July 1987.

Macdonald, Amanda May, formerly of Buna Crescent, Puckapunyal, but late of 15 Markovitch Lane, Junortoun, pensioner, died 16 August 1987.

Maloney, William, but late of Flat 11, 24 Dalgety Street, St. Kilda, pensioner, died 29 June 1987.

Molyneux, Edith Millicent, formerly of 48 Batesford Road, Chadstone, but late of Clarinda Centre, Accommodation House, 123 Centre Road, South Oakleigh, died 3 September 1987.

Payne, Robert William, but late of 7 Abercrombie Street, Balwyn, retired, died 27 August 1987.

Thomas, Lillian Amy, late of Flat 42, 150 Inkerman Street, St. Kilda, pensioner, died 3 September 1987.

Melbourne, 16 December 1987

W. J. KILPATRICK
Managing Director
State Trust Corporation

COUNTRY FIRE AUTHORITY DECLARATION OF FIRE DANGER PERIOD

In pursuance of the powers conferred by section 4 of the *Country Fire Authority Act* 1958, I, Steven Marshall Crabb, Minister for Police and Emergency Services, after consultation with the Minister for Conservation, Forests and Lands hereby declare the following periods to be the fire danger periods in the municipalities or parts of municipalities specified, commencing on the date shown and, unless varied by subsequent declaration, ending at midnight on Saturday, 30 April 1988:

To commence from and inclusive of Saturday, 26 December 1987.

- Shire of Phillip Island—Yallourn Works Area
- City of Traralgon—Town of Bairnsdale
- Shire of Avon—Shire of Bairnsdale
- Shire of Maffra—Shire of Omeo
- Shire of Morwell—Shire of Orbost
- Shire of Traralgon—Shire of Tambo

To commence from and inclusive of Monday, 28 December 1987

- City of Portland—Shire of Portland

To commence from and inclusive of Thursday, 31 December 1987.

- Shire of South Gippsland

To commence from and inclusive of Monday, 4 January 1988.

- Shire of Kilmore—Shire of Gisborne
- Shire of Newham and Woodend—Shire of Romsey
- Shire of Whittlesea (those portions not included in the Metropolitan Fire District)
- Shire of Diamond Valley (those portions not included in the Metropolitan Fire District)
- City of Berwick—City of Frankston
- Shire of Cranbourne—Shire of Mornington
- City of Chelsea—City of Dandenong
- City of Springvale (those portions not included in the Metropolitan Fire District)
- Borough of Wonthaggi—Shire of Bass
- Shire of Flinders—Shire of Hastings
- Shire of Pakenham—French Island

S. M. CRABB

Minister for Police and Emergency Services
 Ministry for Police and Emergency Services
 Melbourne, 22 December 1987

Forests Act 1958
 No. 6254

DECLARATION OF PROHIBITED PERIOD

In pursuance of the powers conferred by section 3 of the *Forests Act 1958*, I, Joan E. Kirner, Her Majesty's Minister for Conservation, Forests and Lands in the State of Victoria, hereby declare a prohibited period in respect of any fire protected area (other than State forest, national park and protected public land) at the times, dates and in the municipalities specified in the Schedules hereunder:

Schedule 1

The prohibited period shall commence at midnight between 25 and 26 December 1987 and end between 30 April and 1 May 1988 (unless varied), in the municipalities shown hereunder:

The Shires of Buln Buln, Morwell, Narracan, Traralgon, and Warragul.

The City of Traralgon.

Schedule 2

The prohibited period shall commence at midnight between 30 and 31 December 1987 and end between 30 April and 1 May 1988 (unless varied), in the municipalities shown hereunder:

The Shires of Mirboo, South Gippsland, and Woorayl.

J. E. KIRNER

Minister for Conservation, Forests and Lands

SHIRE OF MORWELL

Road Deviation Order

Pursuant to the provisions of sections 522 and 526 of the *Local Government Act 1958*, the Council of the Shire of Morwell hereby directs that the land being Part of Crown Allotment 9a in the Parish of Mirboo indicated by hatching on the plan hereunder shall be a Public Highway on and from the date of publication of this Order in the *Victoria Government Gazette* in lieu of the land shown by cross hachure.

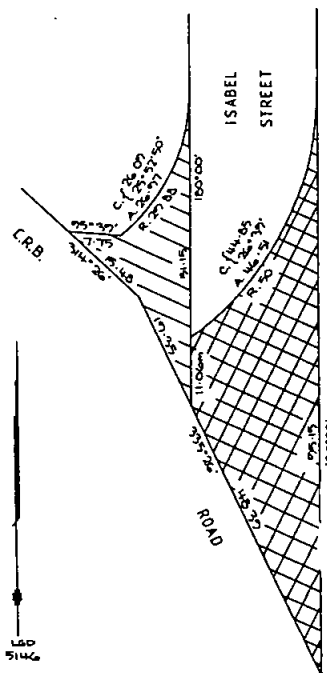

The common seal of the President, Councillors and Ratepayers of the Shire of Morwell was hereunto affixed on 29 June 1987.

W. F. RUTHERFORD, Shire President
G. J. AUCHTERLONIE, Councillor
R. H. WATERS, Secretary

Confirmed by the Governor in Council, 22 December 1987—LAWRENCE A. FISHER, Clerk of the Executive Council

Local Government Act 1958

NOTICE OF INTENTION TO MAKE AN ORDER FOR THE RESUBDIVISION OF MUNICIPAL DISTRICTS

Under the provisions of Part II of the *Local Government Act 1958*, I give notice of my intention to make a recommendation to the Governor in Council about proposals for the resubdivision of the municipal districts of the following municipalities: Shire of Alberton; Shire of Ballan; Shire of Ballarat; City of Dandenong; City of Essendon; Shire of Flinders; City of Geelong; Shire of Healesville; Shire of Kaniva; City of Knox; Shire of Korong; Shire of Lillydale; Shire of Mansfield; Shire of Marong; Shire of Ripon; Shire of Seymour; Shire of Yarrowonga

J. L. SIMMONDS
Minister for Local Government

Co-operative Housing Societies Act 1958

NOTICE OF AMALGAMATION OF SOCIETIES

Notice is hereby given that, pursuant to the provisions of the *Co-operative Housing Societies Act 1958*

Garden City No. 4 Co-operative Housing Society Limited

Garden City No. 5 Co-operative Housing Society Limited

Garden City No. 6 Co-operative Housing Society Limited

Garden City No. 7 Co-operative Housing Society Limited

and

Garden City No. 8 Co-operative Housing Society Limited

were amalgamated into one society under the name of Garden City No. 10 Co-operative Housing Society Limited on 26 November 1987. Dated at Melbourne, 26 November 1987

P. J. ROGAN
Deputy Registrar of Co-operative Housing Societies

Town and Country Planning Act 1961
GEELONG REGIONAL PLANNING SCHEME

Notice that a Planning Scheme (Amending) has been Prepared and is Available for Inspection
Amendment No. 208

Notice is hereby given that the Geelong Regional Commission in pursuance of its powers under the *Town and Country Planning Act 1961*, has prepared an amending scheme to the Geelong Regional Planning Scheme Ordinance.

This amendment proposes to include a parcel of land located at the north-west corner of the Bellarine Highway and Fines Lane, Leopold, into Schedule I of the Planning Scheme Ordinance to allow the erection of a dwelling on the property, provided a permit is granted by the responsible authority.

A copy of the amending scheme has been deposited at this office—Geelong Regional Commission, State Government Offices, corner of Little Malop and Fenwick Streets, Geelong; at the offices of the Shire of Bellarine (insofar as the municipalities are affected) and at the offices of the Ministry for Planning and Environment, The Olderfleet Buildings, 477 Collins Street, Melbourne, and will be open for inspection during office hours by any person free of charge.

Any persons affected by the amending scheme are required to set forth in writing any submissions they may wish to make with respect to the amending scheme addressed to the Secretary, Geelong Regional Commission, P.O. Box 770, Geelong, by Monday, 25 January 1988, and are required to state whether they wish to be heard in respect of their submission.

G. R. COWLING, Secretary
Geelong Regional Commission

Coal Mines (Amendment) Act 1987

NOTICE OF DATE OF CLOSURE OF THE VICTORIAN COAL MINERS' ACCIDENTS RELIEF FUND AND THE REPEAL OF SECTION 68 AND DIVISION 15 OF PART I OF THE COAL MINES ACT 1958

I, Robert Allen Jolly, Treasurer for the State of Victoria, being satisfied that all lump sums have been paid in accordance with section 4 of the *Coal Mines (Amendment) Act 1987*, hereby give notice under that section of the date of closure of the Victorian Coal Miners' Accidents Relief Fund being 23 December 1987 and of the repeal of section 68 and Division 15 of Part I of the *Coal Mines Act 1958*.

Dated 23 December 1987

R. A. JOLLY
Treasurer

Department of Management and Budget

Coal Mines (Amendment) Act 1987
**VICTORIAN COAL MINERS' ACCIDENTS
RELIEF FUND**

I, Robert Allen Jolly, being satisfied that all lump sums have been paid in accordance with section 4 of the *Coal Mines (Amendment) Act 1987*, declare the Victorian Coal Miners' Accidents Relief Fund to be closed and section 68 and Division 15 of Part I of the Act to be repealed with effect from 23 December 1987.

R. A. JOLLY
Treasurer

Department of Management and Budget

Agricultural Chemicals Act 1958

The Department of Agriculture and Rural Affairs, by decision under delegation 14.1, has appointed the following officers as Inspectors under the above Act, without additional salary:

Robert S. Belcher—Senior Officer Level 1
Donald C. Matthews—Scientist Class "SCI-3"
Melinda J. Lucarelli—Scientist Class "SCI-1"
Peter L. North-Coombes—Scientist Class "SCI-1".

J. J. WRIGHT
Chief General Manager

Stock Diseases Act 1958

The Department of Agriculture and Rural Affairs, by decision under delegation 14.1, has appointed the following officer as an Inspector under the above Act, without additional salary:

Mark A. Cooper—Animal Health Officer "SCI-1"

J. J. WRIGHT
Chief General Manager

LOCAL GOVERNMENT DEPARTMENT
Notice of Approval of Agreement
Central Highlands Valuation Group

The Governor in Council, acting under section 254 (10) of the *Local Government Act 1958*, approves the agreement between the Councils of the Shires of Bacchus Marsh, Ballan, Creswick, Gisborne, Daylesford and Glenlyon, Kyneton, Metcalfe, Newham and Woodend, and Romsey, to form a Valuation Group to be known as the Central Highlands Valuation Group.

Dated 22 December 1987

Responsible Minister:

J. L. SIMMONDS
Minister for Local Government

LAWRENCE A. FISHER
Clerk of the Executive Council

RIVER IMPROVEMENT ACT 1958

*At the Executive Council Chamber, Melbourne,
the thirtieth day of April 1980*

PRESENT:

His Excellency the Governor of Victoria

Mr Houghton | Mr Dixon
Mr Maclellan | Mr Lieberman

**SHIRE OF ALBERTON RIVER
IMPROVEMENT TRUST CONSTITUTED
AND HEDLEY DRAINAGE AREA
CONVERTED INTO A RIVER
IMPROVEMENT DISTRICT**

Under the powers conferred by the *River Improvement Act 1958* and all other powers enabling him in that behalf, His Excellency the Governor of the State of Victoria, by and with the advice of the Executive Council of the said State, doth hereby declare, order and direct as follows:

1. That all the lands comprised within the Municipal District of the Shire of Alberton as defined by Order of the Governor in Council and published on page 1112 of the *Victoria Government Gazette* of 27 April 1923, shall be and the same is hereby constituted a river improvement district to be known as the Shire of Alberton River Improvement District under the jurisdiction and control of a river improvement trust to be known as the Shire of Alberton River Improvement Trust, and as on and from the date of this order such district shall be deemed to be so constituted.

2. That the proposed works of the trust shall comprise river improvement works on Bruthen Creek, Bodmans Creek and other streams within the Shire of Alberton River Improvement District.

3. That the Councillors of the Municipal District of the Shire of Alberton for the time being shall be the Commissioners of the Shire of Alberton River Improvement Trust.

4. The Hedley Drainage Area shall be converted into a River Improvement District and the lands contained in the area shall be included in the Shire of Alberton River Improvement District.

The boundaries of the said Shire of Alberton River Improvement District are shown on a plan approved by the Governor in Council and deposited at the office of the State Rivers and Water Supply Commission, Melbourne (Corr. No. 70/3451).

And the Honourable Frederick James Granter, Her Majesty's Minister of Water Supply for the State of Victoria, shall give the necessary directions herein accordingly.

TOM FORRISTAL
Clerk of the Executive Council

Credit Act 1984

CREDIT ORDER No. 47—NATWEST
AUSTRALIA BANK LIMITED

The Governor in Council under section 19 of the *Credit Act 1984* makes the following Order:

Citation

1. This Order may be cited as the "Credit Order No. 47—Natwest Australia Bank Limited: Visa Card".

Commencement and Duration

2. This Order shall take effect on and from 23 December 1987.

Natwest Australia Bank Limited—Exemption

3. Sections 52, 54, (2), 55 (1) and 59 (1) (b) of the *Credit Act 1984* do not have effect in relation to Natwest Australia Bank Limited to the extent that it enters into continuing credit contracts under the name of Visa Card.

Dated 22 December 1987

Responsible Minister:

T. W. ROPER

Minster for Consumer Affairs

LAWRENCE A. FISHER
Clerk of the Executive Council

Form 2.1

Town and Country Planning Act 1961

CITY OF MOE PLANNING SCHEME 1966

Notice that a Planning Scheme has been Prepared and is Available to Inspection

Amendment No. 105

Notice is hereby given that the City of Moe in pursuance of its powers under the *Town and Country Planning Act 1961* has prepared a scheme for land being:

- (a) Known as Old Gippsdown, 211 Lloyd Street, Moe, being part Lot 2, LP 62586 and Part Crown Allotment 162E and 165E, Parish of Moe to be zoned to Special Uses 'Q'
- (b) Part C.A. 162E and 165E, Parish of Moe, zoned to 'New Road'
- (c) Part of Princes Freeway being part Lot 3, LP 62586, part C.A. 165C and 165E, Parish of Moe, zoned to 'New By-Pass Road (Controlled Access)'

(d) Part of Watsons Road and part Lot 31, LP 78272, part C.A. 165E, Parish of Moe, zoned to 'Existing Public Open Space'

(e) Part of Princes Freeway and west end of Lloyd Street, Moe, zoned to 'New By-Pass Road (Controlled Access)'

(f) Part Crown Allotment 162E, Parish of Moe zoned to Agricultural 'A'

A copy of the scheme has been deposited at the Municipal Offices, Albert Street, Moe and at the Regional Office of the Ministry for Planning and Environment, 71 Hotham Street, Traralgon and at the office of the Ministry for Planning and Environment, The Olderfleet Buildings, 477 Collins Street, Melbourne, and will be open for inspection during office hours by any person free of charge.

Any persons affected by the scheme are required to set forth in writing any submissions they may wish to make with respect to the scheme addressed to Economic Development and Planning Officer, City of Moe, Municipal Offices, Albert Street, Moe 3825 by 23 March 1988 and state whether you wish to be heard in respect of your submission.

Dated 17 December 1987

B. PEACH

9804 Economic Development and Planning
Officer

Form 2.1

Town and Country Planning Act 1961

CITY OF MOE PLANNING SCHEME 1966

Notice that a Planning Scheme has been Prepared and is Available to Inspection

Amendment No. 106

Notice is hereby given that the City of Moe in pursuance of its powers under the *Town and Country Planning Act 1961* has prepared a scheme.

The Amendment proposes to make variation to the City of Moe Planning Scheme Ordinance provisions to allow for the establishment of an amusement parlour at 34 Bell Street, Moe being Lot 1, LP 112955, subject to grant of a permit by the Responsible Authority and subject to any conditions that the Responsible Authority may, at its discretion, include in a permit.

A copy of the scheme has been deposited at the Municipal Offices, Albert Street, Moe and at the Regional Office of the Ministry for Planning and Environment, 71 Hotham Street, Traralgon and at the office of the Ministry for Planning and Environment, The Olderfleet Buildings, 477 Collins Street, Melbourne, and will be open for inspection during office hours by any person free of charge.

Any persons affected by the scheme are required to set forth in writing any submissions they may wish to make with respect to the scheme addressed to Economic Development and Planning Officer, City of Moe, Municipal Offices, Albert Street, Moe 3825 by 23 January 1988 and state whether you wish to be heard in respect of your submission.

Dated 17 December 1987

B. PEACH
9805 Economic Development and Planning Officer

Form 2.1

Town and Country Planning Act 1961
CITY OF MOE PLANNING SCHEME 1966
Notice that a Planning Scheme has been Prepared and is Available to Inspection
Amendment No. 107

Notice is hereby given that the City of Moe in pursuance of its powers under the *Town and Country Planning Act 1961* has prepared a scheme.

The Amendment proposes to rezone make variation to the City of Moe Planning Scheme Ordinance provisions listed under Clause 17 (a) Special Uses Zone 'Y' and associated concept plan to permit the use of timber and hardware sales.

A copy of the scheme has been deposited at the Municipal Offices, Albert Street, Moe and at the Regional Office of the Ministry for Planning and Environment, 71 Hotham Street, Traralgon and at the office of the Ministry for Planning and Environment, The Olderfleet Buildings, 477 Collins Street, Melbourne, and will be open for inspection during office hours by any person free of charge.

Any persons affected by the scheme are required to set forth in writing any submissions they may wish to make with respect to the scheme addressed to Economic Development and Planning Officer, City of Moe, Municipal Offices, Albert Street, Moe 3825 by 23 January 1988 and state whether you wish to be heard in respect of your submission.

Dated 17 December 1987

B. PEACH
9806 Economic Development and Planning Officer

CITY OF PRESTON
Road Discontinuance

Pursuant to section 528 (2) of the *Local Government Act 1958*, the Council of the City of Preston at its ordinary meeting of council held on 7 December 1987, resolved that the road shown hatched on the plan below be discontinued and sold by private treaty.

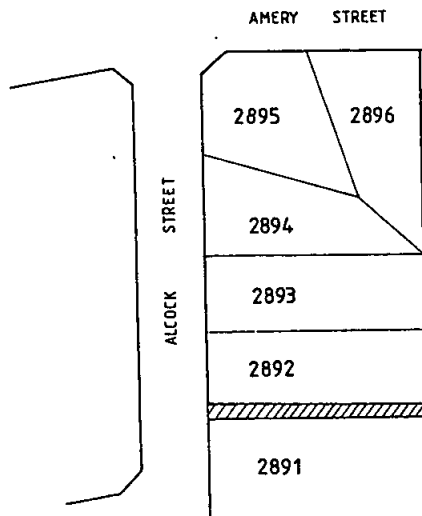

D. O. McLEAN
9808 Chief Executive Officer

CITY OF PRESTON
Road Discontinuance

Pursuant to section 528 (2) of the *Local Government Act 1958*, the Council of the City of Preston at its ordinary meeting of council held on 7 December 1987, resolved that the road shown hatched on the plan below be discontinued and sold by private treaty.

That notwithstanding such discontinuance the Council and the Melbourne and Metropolitan Board of Works shall continue to have and possess the same right, title, power, authority or interest in or in relation to the whole of the land shown by hatching on the said plan as it had or possessed prior to such discontinuance with respect to or in connection with any drains or pipes laid or erected in on or over such land for the purposes of drainage or sewerage.

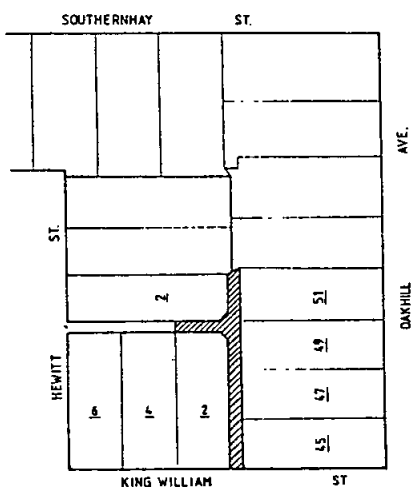

CITY OF WANGARATTA

**Notice of Making By-law No. 87
Sale of Goods Amendment By-law**

Notice is hereby given that the Council of the City of Wangaratta has made a By-law, numbered 87, under the provisions of sections 197 and 198 of the Local Government Act for the following purposes:

- (a) Amending By-law No. 79.
- (b) Altering the penalty for acting in contradiction of By-law 79 from forty dollars to two hundred dollars and from ten dollars to one hundred dollars for a continuing offence.

A copy of the By-law may be inspected at the City Office, Ovens Street, Wangaratta, during office hours.

Dated 18 December 1987

9807

D. O. McLEAN
Chief Executive Officer

9836

J. W. ELWARD
Town Clerk

SHIRE OF CHILTERN

**Special Order
Pound Fees**

Notice is hereby given that the Council of the Shire of Chiltern, by Special Order at a meeting held on 14 December 1987, confirmed a resolution passed on 16 November 1987 to fix pound, trespass and sustenance fees in accordance with the *Pounds Act* 1958 (as amended) as follows:

A. Pound Fees

Description of Cattle	New Fees
	\$
For every Sheep	.50
For every Horse	10.00
For every head of other Cattle	10.00
For writing and delivering or sending by post any notice	5.00
For inserting any notice in a newspaper (in addition to the actual cost of such insertion)	5.00

B. For Trespass

Description of Cattle Trespassing	Upon tillage land enclosed by a substantial fence	Upon land other than tillage land enclosed by a fence
	\$	\$
For every Sheep	1.00	.50
For every Goat	20.00	10.00
For every Pig	20.00	10.00
For every Horse	20.00	10.00
For every Head of other Cattle	20.00	10.00

	\$
In addition for the trespass of any entire horse	50.00
In addition for the trespass of any bull	50.00
In addition for the trespass of any ram	20.00

C. For Sustenance

<i>Description of Cattle</i>	<i>Amount to be charged daily for sustenance while impounded</i>
	\$
For every Sheep	.80
For every Goat	5.00
For every Pig	5.00
For every Horse	10.00
For every head of other Cattle	10.00

D. Other Fees

Section 19 Fee (inspection of Pound Books)	2.50
Section 21 Fee (registration of Brands)	5.00

9810

T. M. SMITH
Shire Secretary

SHIRE OF CHILTERN

Revocation of the Appointment of Pound

Notice is hereby given that the Council of the Shire of Chiltern at its meeting on 9 November 1987, resolved in accordance with section 4 of the *Pounds Act 1958* to revoke the appointment of the following place in the municipal district as a Pound:

land known as Railway stockyards, Barnawartha and more particularly described as Railway Lot 8, High Street, Barnawartha, Parish of Barnawartha South, County of Bogong.

Dated 17 December 1987

T. M. SMITH
Shire Secretary

9811

SHIRE OF CHILTERN

Appointment of Pound

Notice is hereby given that the Council of the Shire of Chiltern at its meeting on 9 November 1987, resolved in accordance with section 4 of the *Pounds Act 1958* to appoint the following place in the Municipal District as a Pound:

the stockyards located at the south-east corner of Crown Allotment 6 of section A, Parish of Chiltern, County of Bogong and located in Wedge Street, Chiltern.

Dated 17 December 1987

T. M. SMITH
Shire Secretary

9812

*Town and Country Planning Act 1961*SHIRE OF HASTINGS PLANNING
SCHEME

Notice that a Planning Scheme has been Prepared and is Available for Inspection
Amendment No. 39

Notice is hereby given that the Shire of Hastings, in pursuance of its powers under the *Town and Country Planning Act 1961*, has prepared a Scheme for the whole of the Shire of Hastings and includes the rezoning of a strip of land adjoining the existing Baxter Township from Inter Urban to Medium Density 2 (residential); the rezoning of land on the north-east corner of Mornington-Tyabb Road and Peach Grove, Tyabb from General Farming to Rural Residential 1; the introduction of a definition of Interim Occupation within the Port Related Uses Zone; a revised definition of Pre-School Centre; revised Group House provisions; revised Urban Industrial and Special Urban Industrial development provisions and modified provisions relating to the definition of Zone Boundaries.

A copy of the Scheme has been deposited at the offices of the Shire of Hastings, Marine Parade, Hastings; at the Regional Office, Ministry for Planning and Environment, 33-39 High Street, Cranbourne, and at the Office of the Ministry for Planning and Environment, The Oldfleet Buildings, 477 Collins Street, Melbourne, and will be open for inspection during office hours by any person free of charge.

Any persons affected by the Scheme are required to set forth in writing any submission they may wish to make with respect to the Scheme, addressed to the Shire Secretary, Shire of Hastings, P.O. Box 55, Hastings, 3915, by 1 February 1988, and state whether they wish to be heard in respect of their submission.

W. R. FEATHERSTON
Chief Executive Officer
Municipal Offices, P.O. Box 55, Hastings 9815

Town and Country Planning Act 1961
SHIRE OF MORNINGTON PLANNING
SCHEME 1959 (AS AMENDED)

Notice that a Planning Scheme has been Prepared and is Available for Inspection
Amendment No. 191

Notice is hereby given that the Shire of Mornington in pursuance of its powers under the *Town and Country Planning Act 1961*, has prepared a scheme for the residential land generally bounded by Hearn Road, Esplanade, Ellerina Road and Forest Drive, Mt. Martha, for the purpose of rezoning the land to Residential Landscape Protection zone and introducing a set of house design and siting guidelines within this zone.

A copy of the scheme has been deposited at the Council Offices, Queen Street, Mornington, and at the office of the Ministry for Planning and Environment, The Oldfleet Buildings, 477 Collins Street, Melbourne, and will be open for inspection during office hours by any person free of charge.

Any persons affected by the scheme are required to set forth in writing any submission they may wish to make with respect to the scheme addressed to the Chief Executive Officer, P.O. Box 78, Mornington, 3931, by 12 February 1988, and state whether you wish to be heard in respect of your submission.

Dated 16 December 1987

D. G. COLLINGS
Chief Executive Officer
9837

Form 2.1
Town and Country Planning Act 1961
SHIRE OF NARRACAN PLANNING
SCHEME 1984

Notice that a Planning Scheme has been Prepared and is Available for Inspection
Amendment No. 2—1987

Notice is hereby given that the Shire of Narracan in pursuance of its powers under the *Town and Country Planning Act 1961* has prepared a scheme for Lot 142 on Plan of

Subdivision No. 146106 which is located between King Street and Wirraway Street, south of the City of Moe.

A copy of the scheme has been deposited at the office of the Shire of Narracan, Princes Highway, Trafalgar, the office of the Ministry for Planning and Environment, 71 Hotham Street, Traralgon, and at the office of the Ministry for Planning and Environment, The Oldfleet Buildings, 477 Collins Street, Melbourne, and will be open for inspection during office hours by any person free of charge.

Any persons affected by the scheme are required to set forth in writing any submission they may wish to make with respect to the scheme addressed to the Director Technical Services, Shire of Narracan, P.O. Box 140, Trafalgar 3824, by 23 January 1988, and state whether they wish to be heard in respect of their submission.

Dated 18 December 1987

R. D. THEGE
Director-Technical Services

Note: This amendment proposes to rezone land from Future Urban to Residential A. 9814

Town and Country Planning Act 1961
PHILLIP ISLAND PLANNING SCHEME

Notice that a Planning Scheme has been Prepared and is Available for Inspection
Amendment No. 35

Notice is hereby given that the Shire of Phillip Island in pursuance of its powers under the *Town and Country Planning Act 1961* has prepared a scheme for the following area:

Crown Lots 31 and 32 at Cowes and Lots 3 and 4 and parts Lots 1 and 2 section 17, Township of Ventnor, Parish of Phillip Island (Saltwater Creek area) for the purpose of creating a Canal Based Development.

A copy of the scheme has been deposited at the office of the Ministry for Planning and Environment, The Oldfleet Buildings, 477 Collins Street, Melbourne, the State Offices, 33-39 High Street, Cranbourne and the office of the Shire of Phillip Island, Civic Centre, Thompson Avenue, Cowes and will be available for inspection free of charge during office hours.

Any persons affected by the scheme are required to set forth in writing any submissions they may wish to make with respect to the scheme, addressed to Shire Secretary, Shire of Phillip Island, P.O. Box 44, Cowes 3922, by 23 March 1988, and state whether they wish to be heard in respect of their submission.

Dated: 18 December 1987

B. D. HAYES
Chief Executive Officer
9809

SHIRE OF UPPER YARRA
Notice of Change in Street Name

Notice is hereby given, that in pursuance of powers conferred by the *Local Government Act 1958*, as amended, the Shire of Upper Yarra at a meeting held on Wednesday, 9 December 1987, resolved to make the following street name changes:

Old Name; Location; New Name
 Government Road; Hoddles Creek; Auckland Drive.

The change of name will take effect from Wednesday, 23 December 1987.

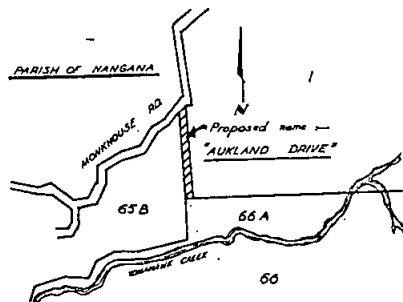

9813 **A. J. HUBBARD**
 Chief Executive Officer

Victoria Racing Club Act 1871
NEW BY-LAW 37A

Notice is hereby given that the Committee of the Victoria Racing Club under the powers conferred by section 14 of the *Victoria Racing Club Act 1871*, at a meeting held on 23 October 1987 resolved that the following By-law, to be known as By-law 37A be adopted.

37A. Except with the permission of the Stewards no person shall bring on to, have in his possession, on or use upon the said land or any division or part thereof, save for the motor parks and approaches, any portable telephone, radio transmitter, microphone or any other similar instrument or apparatus.

A copy of this By-law was sent to the Minister for Sport and Recreation on 29 October 1987 and it has been reviewed and has not been disallowed.

This By-law will come into operation on the date of publication of this notice in the *Victoria Government Gazette*.

9835 **P. C. T. ARMYTAGE** Chairman
 Victoria Racing Club

I, The Right Reverend John Hazlewood of Cathedral Buildings Ballarat, Bishop of Ballarat, in consideration of the land hereinafter referred to being within the Diocese of Ballarat and being held in trust for and on behalf of the Church of England and pursuant to the power vested in me by the *Church of England Property Trustees Act 1884* (48 Vict. No. 797) section 7 do hereby in place of Colin Campbell formerly of Raglan Street South in the City of Ballarat Clerk in Holy Orders James Richardson formerly of Gorrin Dobies Bridge Grazier George Wingfield Thomson formerly of Chalicum Buangor Grazier William Hay Dawson formerly of Ararat Storekeeper and John Little formerly of Eversleigh Sheepfarmer who are registered as proprietors of an estate in fee simple in the said land and who are dead consent to the Ballarat Diocesan Trustees being shown as the proprietors of the land described in Conveyance No. 679 Book placed in its name.
 Dated 16 December 1987

J. BALLARAT
 9820 The Right Reverend John Hazlewood

BALLARAT WATER BOARD

Pursuant to section 119 (2) of the *Sewerage Districts Act 1958* (No. 6368), notice is hereby given of the intention to construct a sewer for property situated in the vicinity of the following streets:

- City of Ballarat*
- Dana Street
- Macarthur Street
- Borough of Sebastopol*
- Yarrowee Street
- Shire of Grenville*
- Heinz Road

more particularly as shown on plans which are open for inspection at this office between the hours of 8.45 a.m. and 4.30 p.m., Monday to Friday, inclusive.

9816 **P. A. POLLARD**
 Secretary

DUNA
CO-OPERATIVE HOUSING SOCIETY
LIMITED
 (In Liquidation)

Take notice that the affairs of the above-named society are now fully wound-up and that in pursuance of section 411 (2) of the *Companies (Victoria) Code* and of the *Co-operative Housing Societies Act 1958*, a general meeting of the society will be held at 72 Hardware Street, Melbourne on Monday, 1 February 1988 at 5.30 p.m. for the purposes of:

1. Laying before it an account showing how the winding-up has been conducted and the property of the society disposed of and giving any explanations thereof; and

2. Passing a resolution that the books and papers of the said society and of the liquidator relevant to the affairs of the society be destroyed after a period of twelve months from the date of the meeting.

Dated 18 December 1987

K. E. PALMER
Liquidator
9817

Creditors, next of kin, and others having claims in respect of the estate of Marjory Beryl Edmanson late of Glenrest Private Hospital, 494 Glenhuntingly Road, Elsternwick but formerly of 4/647 Inkerman Road, Caulfield, deceased who died on 15 October 1987 are required by the executor of the estate to send particulars of their claims to the executor in the care of the undermentioned solicitors by 24 February 1988 after which date the said executor will distribute the assets having regard only to the claims of which they then have notice.

VERA FOWLER & Co., solicitors of 1
Evandale Road, Malvern 9818

Creditors, next of kin and others having claims against the estate of Hannah Theresa Crowley late of 1 Baxter Street, Elsternwick, in the State of Victoria, home duties, deceased who died on 14 September 1987 are to send particulars of their claims to Barbara Eileen McFarlane and Cecilia Isobel Crowley the executrices of the estate of the said deceased care of the undersigned solicitor before 14 March 1988 after which date they will distribute the assets of the estate having regard only to the claims for which they then have notice.

MILAN KANTOR, solicitor, of 500 Collins
Street, Melbourne 9819

Creditors, next of kin and others having claims in respect of the estate of Elizabeth Jane Ogilvie late of 104 Carrington Road, Box Hill, widow, deceased who died on 14 November 1986 are required by the executors, James Robert Ogilvie of 234 Springvale Road, Blackburn and Margaret Jean Davey of 44 Hosken Street, North Balwyn, to send particulars of their claims to the executors c/o the undersigned solicitors by 29 February 1988 after which date they will distribute the estate having regard only to the claims of which they then have notice.

MADDEN BUTLER ELDER & GRAHAM,
solicitors, 575 Bourke Street, Melbourne 9828

Creditors, next of kin and others having claims in respect of the will of Elsie May Cahill, late of 5-7 Pearse Road, Blairgowrie formerly married woman, but late widow, who died on 27 August 1987 are requested to send particulars of their claims to the executor Diane Maria Limb c/o the undermentioned solicitor by 6 March 1988 after which date she will distribute the assets having regard only as to the claims of which she then has notice.

JOHN STEWART, 290 Racecourse Road,
Newmarket, solicitor 9821

ALAN FREDERICK RUST, late of 5 Robeson
Street, West Preston, retired, deceased

Creditors, next of kin and others having claims in respect of the estate of the deceased who died on 11 June 1987 are required by the Trustees Clarice Mildred Everett and Frederick Bruce Everett to send particulars of their claims to them care of the undersigned solicitors by 6 March 1988 after which date the Trustees may convey or distribute the assets having regard only to the claims of which they then have notice.

GRAY, FRIEND & LONG, solicitors,
Warragul 9822

STEPHEN WILLIAM CURTHOYS, late of
Tampion Avenue, Lalbert in the state of
Victoria, retired, deceased

Creditors, next of kin and other persons having claims against the estate of the deceased who died on 3 August 1987 are required to send particulars of the same to the executors John Stephen Curthoys and Graeme William Curthoys in care of the undersigned care of or before 19 February 1988 after which date they will distribute the assets having regard only to the claims of which they then have notice.

DWYER, BENNETT & MAHON, barristers
and solicitors, 198-208 Beveridge Street, Swan
Hill 9823

Creditors, next of kin and others having claims in respect of the estate of Emlic Unis Sluiter late of 27 Walpole Avenue, Rosebud in the State of Victoria, divorcee deceased, who died on 28 May 1987 are required to send particulars of their claim to The Equity Trustees Executors & Agency Company Limited, 472 Bourke Street, Melbourne in the said State, by 8 April 1988 after which date it will convey or distribute the assets having regard only to the claims of which it then has notice.

TAYLOR SPLATT & PARTNERS, solicitors,
Terminus House, 40 Young Street, Frankston
9833

Creditors, next of kin and others having claims in respect of the estate of Victor Moritz Ransome, late of 15 Palmers Hill Road, Merricks Beach, retired accountant, deceased, who died on 30 September 1987, are to send the particulars of their claims to ANZ Executors and Trustee Company Limited of 94 Queen Street, Melbourne by 1 March 1988 after which date it will distribute the assets having regard only to the claims of which it then has notice. 9825

Creditors, next of kin and others having claims in respect of the estate of Silena Mabel Hammond, late of Goorambat, widow (who died on 22 September 1987) are requested to send particulars of their claims in writing to the undermentioned solicitors for Phyllis Merle Hammond the executrix by 21 April 1988 after which date the executrix will distribute the assets of the deceased having regard only to the claims of which she then has notice.

HAMILTON CLARKE & BALKIN, solicitors,
81-83 Nunn Street, Benalla 9830

PETER GIBSON SLOANE, late of "Butterfield", Rutherglen Road, Springhurst, Victoria, retired farmer, deceased

Creditors, next of kin and others having claims in respect of the estate of the deceased, who died on 23 December 1986 are required by the personal representatives, Shirley Marjorie Sloane of "Butterfield", Rutherglen Road, Springhurst, Victoria, widow, Christopher Murray Sloane of "Ravensdale", Forbes, New South Wales, farmer and Stephen Richard Chenoweth of 41 Park Road, Surrey Hills, Victoria, chartered accountant, to send particulars to them care of the said Stephen Richard Chenoweth by 26 February 1988 after which date the personal representatives may convey or distribute the assets of the estate, having regard only to the claims of which they then have notice.

ARTHUR ROBINSON & HEDDERWICKS, solicitors, 535 Bourke Street, Melbourne 9827

Creditors, next of kin and others having claims in respect of the estate of Jean Elizabeth Corboy, late of 6 Stewart Street, Benalla, retired saleswoman (who died on 23 September 1987) are requested to send particulars of their claims in writing to the undermentioned solicitors for Ellen Anne O'Neill the executrix by 21 April 1988 after which date the executrix will distribute the assets of the deceased having regard only to the claims of which she then has notice.

HAMILTON CLARKE & BALKIN, solicitors,
81-83 Nunn Street, Benalla 9831

ELLA IRENE HOWARD, late of 383 Buckley Street, Essendon who died on 20 September 1987.

Creditors, next of kin and all others having claims in respect of the said deceased are requested by the executor The Equity Trustees Executors and Agency Company Limited of 472 Bourke Street, Melbourne to send particulars of such claims addressed to the executor, The Equity Trustees Executors and Agency Company Limited of 472 Bourke Street, Melbourne by 28 February 1988 after which date the said executor will distribute the assets having regard only to the claims of which it then has notice.

RIDGEWAY CLEMENTS, solicitors, 221
Glenhuntly Road, Elsternwick 9829

Creditors, next of kin and others having claims in respect of the estate of Richard Courtney Hogg, late of 16 Mummery Street, Mount Waverley, gentleman, deceased, who died on 16 October 1987, are to send the particulars of their claims to ANZ Executors and Trustee Company Limited of 94 Queen Street, Melbourne by 1 March 1988 after which date it will distribute the assets having regard only to the claims of which it then has notice. 9825

Creditors, next of kin or others having claims in respect of the estate of Nikola Ogrizovic late of 73 Parkmore Road, East Bentleigh, retired fitter, deceased who died on 26 September 1986 are requested to send particulars of their claims to the administrator Robert Wilson Bett care of the undermentioned solicitors by 7 March 1988 after which date the administrator will distribute the assets having regard only to the claims of which he then has notice.

RIDGEWAY CLEMENTS, solicitors, 221
Glenhuntly Road, Elsternwick 9834

Creditors, next of kin and others having claims in respect of the estate of John Frame Cole, Gentleman, late of 4/10 Edgar Street, Glenroy in the State of Victoria, deceased who died on 12 December 1987 are required by the executor Kevin George Saunders, security officer of 29A Shorts Road, North Coburg in the said State to send particulars of their claims to the said executor care of the undermentioned solicitors by 24 February 1988 after which date the said executor will convey or distribute the assets of the deceased having regard only to the claims of which the said Executor then has notice.

MESSRS. MAKARUCHA & DE MARCO,
solicitors of 250 Glenroy Road, Glenroy 9832

MARY INEZ MARTHA CLARK, formerly of 116A Webster Street, Ballarat but late of "Kelaston", Howitt Street, Wendouree, widow, deceased

Creditors, next of kin and others having claims in respect of the estate of the deceased who died on 15 August 1987 are required by The Union Fidelity Trustee Company of Australia Limited of 100 Exhibition Street, Melbourne and Naomi Jean Simpson of 27 Bridge Street, Sebastapol married woman the applicants for a grant of probate to send particulars of their claims to the said applicants in the care of the said company by 18 March 1988 after which date they will convey or distribute the assets having regard only to the claims of which they then have notice.

LYNCH & MACDONALD, solicitors, 570 Bourke Street, Melbourne 9824

**PUBLIC HOLIDAYS—CLOSING OF
PUBLIC OFFICES**

Christmas-New Year 1987-88 and Bicentennial Year Celebrations

It is hereby notified that on —

Friday, 25 December 1987, Christmas Day;

Friday, 1 January 1988, New Year's Day;

Monday, 25 January 1988 (substituted day instead of Boxing Day, Saturday, 26 December 1987);

Tuesday, 26 January 1988 (substituted day instead of Monday, 1 February 1988)—

The public offices will be closed, such days having been specified or appointed under the provisions of the *Public Service Act 1974* to be observed as holidays in the public offices throughout the State of Victoria.

This notice relates only to the closing of the State Public Offices. All enquiries regarding the holidays in other offices and in shops and industry should be directed to the Department of Labour, Wage Line, 80 Collins Street, Melbourne 3000, (telephone 655 1333).

Dated 9 December 1987

PHILIP BENTLEY
Director-General

**NOTICE OF MAKING OF
STATUTORY RULES
WHICH ARE NOT YET
AVAILABLE**

Notice is given of the making of the following Statutory Rules:

- | | |
|----------|--|
| | <i>Fisheries Act 1968</i> |
| 335/1987 | Fishing (Scallop)
(Amendment No. 8)
Regulations 1987 |
| | <i>Town and Country
Planning Act 1961</i> |
| 336/1987 | Planning Procedures
(Amendment No. 7)
Regulations 1987 |
| | <i>Dental Technicians Act
1972</i> |
| 338/1987 | Advanced Dental
Technicians (Fees)
Regulations 1987 |
| | <i>Local Government Act 1958</i> |
| 339/1987 | Local Government
(Elections and Polls)
(Ballot Papers)
Regulations 1987 |
| | <i>Cattle Compensation Act
1967</i> |
| 341/1987 | Cattle Compensation
Regulation 1987 |
| | <i>Physiotherapists Act 1978</i> |
| 359/1987 | Physiotherapists (Fees)
Regulations 1987 |
| | <i>Dentists Act 1972</i> |
| 360/1987 | Dentists (Fees) Regulations
1987 |
| | <i>Health Act 1958</i> |
| 361/1987 | Health (Contraceptives)
(Fees) Regulations 1987 |
| | <i>Health Act 1958</i> |
| 362/1987 | Health (Public Buildings)
(Fees) Regulations 1987 |
| | <i>Chiropractors and
Osteopaths Act 1978</i> |
| 363/1987 | Chiropractors and
Osteopaths
(Amendment)
Regulations 1987 |

	<i>Health Act 1958</i>
364/1987	Health (Use of Waste Water) (Fees) Regulations 1987
	<i>Tobacco Act 1987</i>
365/1987	Tobacco (Victorian Health Promotion Foundation) (Amendment No. 1) Regulations 1987
	<i>Drugs, Poisons and Controlled Substances Act 1981</i>
366/1987	Proclamation
	<i>Inflammable Liquids Act 1960</i>
367/1987	Inflammable Liquids (Transport Amendment) Regulations 1987
	<i>Liquefied Gases Act 1968</i>
368/1987	Liquefied Gases (Transportation and Gas Transfer) (Amendment) Regulations 1987
	<i>Dangerous Goods Act 1985</i>
370/1987	Dangerous Goods (Liquefied Gases Transfer) Regulations 1987
	<i>Land Act 1958</i>
371/1987	Land Act (Fees) Regulations 1987
	<i>Health Act 1958</i>
372/1987	Pest Control Operators (Fees) Regulations 1987
	<i>Industrial Training Act 1975</i>
373/1987	Industrial Training (General Reimbursement of Fares) Regulations 1987
	<i>Country Fire Authority 1958</i>
375/1987	Country Fire Authority (Permits to Burn) Regulations 1987
	<i>Audit Act 1958</i>
376/1987	Treasury (Amendment) Regulations 1987
	<i>Land Tax Act 1958</i>
377/1987	Land Tax (Equalization Factors) Regulations 1987

**NOTICE OF MAKING
AND AVAILABILITY OF
STATUTORY RULES**

In pursuance of the provisions of the *Subordinate Legislation Act 1962* and the Regulations made thereunder notice is given of the making and availability of the following Statutory Rules:

Note: The date specified after each Statutory Rule is the date it was first obtainable from—

VGPO Bookshop
Information Victoria Centre
318 Lt Bourke Street, Melbourne

	<i>Swine Compensation Act 1967</i>	
342/1987	Swine Compensation Regulations 1987	
22 December 1987		70c
	<i>Printers and Newspapers Act 1958</i>	
343/1987	Printers and Newspapers (Fees) Regulations 1987	
16 December 1987		40c
	<i>Religious Successory and Charitable Trusts Act 1958</i>	
344/1987	Religious Successory and Charitable Trusts (Fees) Rules 1987	
18 December 1987		40c
	<i>Associations Incorporation Act 1981</i>	
345/1987	Associations Incorporation (Fees Amendment) Regulations 1987	
16 December 1987		40c
	<i>Business Names Act 1962</i>	
346/1987	Business Names (Fees Amendment) Regulations 1987	
18 December 1987		40c
	<i>Co-operation Act 1981</i>	
347/1987	Co-operative Societies (Fees Amendment) Regulations 1987	
18 December 1987		40c

3536 G 50 23 December 1987

Victoria Government Gazette

	<i>Co-operative Housing Societies Act 1958</i>		<i>Road Safety Act 1987</i>	
348/1987	Co-operative Housing Societies (General) (Amendment No. 2) Regulations 1987		355/1987 Road Safety (Vehicles) (Interim Amendment) Regulations 1987	
18 December 1987	40c		18 December 1987	40c
	<i>Transfer of Land Act 1958</i>		<i>Road Safety Act 1986</i>	
349/1987	Transport of Land (Fees) Regulations 1987		356/1987 Road Safety (Procedures) (Interim Amendment) Regulations 1987	
22 December 1987	70c		18 December 1987	40c
	<i>Transfer of Land Act 1958</i>		<i>Chattel Securities Act 1987</i>	
350/1987	Transfer of Land (Conversion) Regulations 1987		357/1987 Chattel Securities (Fees Amendment) Regulations 1987	
18 December 1987	40c		18 December 1987	40c
	<i>Property Law Act 1951</i>		<i>Dandenong Valley Authority Act 1963</i>	
351/1987	Property Law (Fees) Regulations 1987		358/1987 Dandenong Valley Authority (Edithvale—Seaford Wetlands' Environmental Area) (Amendment) Regulations 1987	
18 December 1987	40c		18 December 1987	40c
	<i>Strata Titles Act 1968</i>		<i>Dangerous Goods Act 1985</i>	
352/1987	Strata Titles (Registrar's Fees) Regulations 1987		369/1987 Dangerous Goods (Transport) Regulations 1987	
16 December 1987	40c		22 December 1987	\$2.40
	<i>Instruments Act 1958</i>		<i>Firearms Act 1958</i>	
353/1987	Instruments (Fees) Regulations 1987		374/1987 Firearms (Prohibited Weapons) Regulations 1987	
16 December 1987	40c		18 December 1987	40c
	<i>Cluster Titles Act 1974</i>		<i>Public Service Act 1974</i>	
354/1987	Cluster Titles (Registrar's Fees) Regulations 1987		PSD54/1987 Public Service Determinations (No. 54) 1987	
16 December 1987	40c			40c

Victoria Government Gazette

G 50 23 December 1987 3537

CONTENTS

	Page
Appointments	3487
Cemeteries—Scale of Fees	3474
Contracts	3518
Contracts Accepted—Amendments	3517
Government Notices	3472
Late Notices	3516
Melbourne and Metropolitan Board of Works	3473
Notice of Making of Statutory Rules	3534
Orders in Council—	
Acts—Local Government; Crown Land (Reserves); Historic Buildings; Water and Sewerage Authorities (Restructuring); Hospitals and Charities; Annual Reporting; Melbourne and Metropolitan Board of Works	3487
Police Sale	3483
Private Advertisements	3498
Proclamations	3472

No. G 50—General Government Gazette

A Victorian Government Publication

Published by VGPO
Melbourne Victoria Australia

© State of Victoria

This publication is copyright. No part may be reproduced by any process except in accordance with the provisions of the Copyright Act

Address all inquiries to the Government Printer
for the State of Victoria
PO Box 203 North Melbourne 3051 Victoria Australia
ISSN 0819—5471Further copies of this publication can be obtained from
VGPO BookshopInformation Victoria Centre
318 L1 Bourke Street Melbourne
(PO Box 203 North Melbourne 3051)

VGPO Bookshop Inquiries: (03) 663 3760

By Authority Jean Gordon Government Printer Melbourne

Recommended Retail Price \$1.10