



Victoria Government Gazette

No. S 111 Tuesday 16 September 1997
By Authority: Victorian Government Printer

SPECIAL

Road Safety (Vehicles) Regulations 1988

GENERAL PERMIT FOR OPERATION OF B-DOUBLES

Regulation 724 of the Road Safety (Vehicles) Regulations 1988 authorises the Roads Corporation, by notice in the Victoria Government Gazette, to allow vehicles and loads which exceed mass or dimension limits prescribed in the Regulations to be used on highways.

Regulation 819 of the Road Safety (Vehicles) Regulations 1988 authorises the Roads Corporation to approve a person to use, or cause or permit to be used, on a highway a motor vehicle which is towing more than one other vehicle.

Under the above two Regulations, I, Geoff Kloot, delegate of the Roads Corporation, approve and allow B-doubles to be used on highways as set out in Part 4 if they comply with:

- (a) the standards in Part 1; and
- (b) the mass and dimension limits in Part 2; and
- (c) the operating conditions in Part 3.

This notice is effective from 15 September 1997 until 31 December 1999. However if any of the conditions in this notice are breached, the notice is invalid in relation to the vehicle which is the subject of the breach and, depending on the nature of the breach:

- (a) the owner and the driver of the B-double, and any person who caused or permitted it to be used on a highway, may be prosecuted for exceeding normal mass or dimension limits; and
- (b) any person who used the B-double on a highway, or caused or permitted it to be used on a highway, may be prosecuted for towing more than one trailer.

Victoria Government Gazettes No S 59 of Monday 26 June 1995 and No S 89 of Thursday 31 August 1995 are hereby revoked from 15 September 1997.

Dated 15 September 1997

GEOFF KLOOT
General Manager, Traffic and Road Use Management
Roads Corporation

- INDEX -

Part 1 - Standards

Part 2 - Mass and Dimension Limits

Part 3 - Operating Conditions

Part 4 - Approved Roads

Part 5 - Definitions

air brake	anti-lock brakes	Australian Design Rule (ADR)
Australian Standard	axle	axle group
B-double	braking system	bulk container
centre of an axle group	dangerous goods	driver
D-value	emergency brake	fifth wheel coupling
gross combination mass (GCM)	gross trailer mass (GTM)	gross vehicle mass (GVM)
ground clearance	operator	owner
parking brake	prime mover	rear overhang line
retractable axle	road	road tank vehicle
semi-trailer	service brake	single axle
single axle group	spray suppression device	tandem axle group
tri-axle group	turntable	vehicle registration authority
50 millimetre kingpin	75 millimetre kingpin	90 millimetre kingpin

PART 1 - STANDARDS

Compliance with Standards

- 1.1(1) A vehicle that is part of a B-double must comply with each Australian Design Rule (ADR) that applies to it. However, for each applicable ADR, if a corresponding ADR applies to the same type of vehicle manufactured at a later date, the vehicle may comply with the later ADR instead.
- 1.1(2) The vehicle must comply with each standard in this Part unless it is inconsistent with an ADR that applies to it.

Mudguards

- 1.2 Spray suppression devices complying with British Standard AU 200-1984 "Spray Reducing Devices for Heavy Goods Vehicles" Parts 1 and 2 must be firmly fitted to all axle groups and single axles of the B-double.

Warning Sign

- 1.3(1) A warning sign that meets the requirements in sub clauses 1.3(2) to (9) must be fitted to the rearmost part of a B-double that is more than 22 metres long.
- 1.3(2) The sign must show the words "LONG VEHICLE" in black upper case letters which are:
- (a) at least 180 millimetres high, and
 - (b) in typeface Series B (N); and
 - (c) comply with Australian Standard AS 1744 "Forms of Letters and Numerals for Road Signs".
- 1.3(3) The sign must be:
- (a) durable; and
 - (b) manufactured in one or two pieces from sheet steel 0.8 millimetres thick or an alternative material of at least equivalent stiffness, unless it is designed to be fixed to the vehicle body using an adhesive.
- 1.3(4) If the sign is in two pieces, the word "LONG" must appear on one piece and the word "VEHICLE" on the other.
- 1.3(5) The sign must be at least 1020 millimetres long by 250 millimetres high.

- 1.3(6) The sign must be coated with yellow retro-reflective material (Class 1 or Class 2) which meets Australian Standard AS 1906 "Retro-reflective Materials and Devices for Road Traffic Control Purposes".
- 1.3(7) The sign must have a black border.
- 1.3(8) The sign must show in block letters not more than 10 millimetres high:
- (a) the sign manufacturer's name or logo; and
 - (b) the brand and class of retro-reflective material used.
- 1.3(9) The sign must be mounted horizontally so that no part of it is:
- (a) more than 1800 millimetres above the ground; or
 - (b) less than 500 millimetres above the ground.

Braking System for Prime Movers

- 1.4(1) A prime mover used in a B-double must comply with Second Edition ADR 35A or Third Edition ADR 35.
- 1.4(2) A prime mover used in a B-double must also have anti-lock brakes that comply with Third Edition ADR 64, if the prime mover:
- (a) was manufactured on or after 1 January 1990; or
 - (b) was first used in a B-double on or after 1 January 1994; or
 - (c) is used in a B-double that includes a road tank vehicle carrying dangerous goods.

Braking System for Semi-trailers

- 1.5(1) A semi-trailer used in a B-double that is not otherwise required to comply with an ADR relating to braking, must comply with requirements in Second or Third Edition ADR 38 for the performance of the service brake system, the emergency brake system and the parking brake system.
- 1.5(2) In spite of sub clause 1.5(1), a semi-trailer used in a B-double which includes a road tank vehicle carrying dangerous goods must have anti-lock brakes that comply with ADR 38/01, regardless of whether the semi-trailer is itself a road tank vehicle.

Air Brakes

- 1.6(1) If a B-double is fitted with brakes that operate using compressed air, the air pressure in the prime mover's braking system must meet the requirements in sub clauses (2) and (3)

when tested in the following manner:

- (a) the air pressure is measured in an 800 millilitre vessel connected by a 2 metre pipe with a bore of approximately 13 millimetres to the coupling head of the braking system; and
 - (b) the initial air pressure is not less than-
 - (i) the arithmetic average of the maximum and minimum pressures in the operating pressure range specified by the manufacturer of the prime mover; or
 - (ii) if there is no manufacturer's specification - 650 kilopascals.
- 1.6(2) The pressure must reach at least 420 kilopascals within 400 milliseconds of the rapid and complete application of the foot-operated control of the braking system.
- 1.6(3) After the brakes have been fully applied, the pressure must fall to 35 kilopascals within 500 milliseconds of the release of the foot-operated control.

Air Pressure in Least Favoured Chamber

- 1.7(1) The air pressure in the least favoured chamber of the braking system must meet the requirements in sub clauses 1.7(2) and (3) when the initial air pressure is not less than:
- (a) the arithmetic average of the maximum and minimum pressures in the operating pressure range specified by the manufacturer of the vehicle; or
 - (b) if there is no manufacturer's specification - 650 kilopascals.
- 1.7(2) The air pressure must reach at least 420 kilopascals within 1.0 second of the rapid and complete application of the foot-operated control of the braking system.
- 1.7(3) After the brakes have been fully applied, the air pressure must fall to 35 kilopascals or the pressure at which the friction surfaces cease to contact each other within 1.0 second of the release of the foot-operated control.
- 1.7(4) In sub clause 1.7(1), "least favoured chamber" means the brake chamber with the longest line to the treadle valve in the prime mover.

Air Supply for Brakes and Accessories

- 1.8 A B-double which also uses compressed air to operate accessories must have:
- (a) sufficient air compressor capacity and air receiver volume to ensure that operation of the accessories does not adversely affect brake performance; and
 - (b) a compressed air system which ensures that the brake system is preferentially charged.

Brake Line Couplings

- 1.9(1) Brake line couplings on the same part of a vehicle in a B-double must not be interchangeable.
- 1.9(2) If hoses used with the brake line couplings are used for the same purpose as the hoses described in the Australian Standard AS D8-1971 "Hose Couplings for Use with Vacuum and Air-Pressure Braking System on Prime Movers, Trailers and Semi-trailers", the couplings must be polarised in accordance with the Australian Standard.

Simultaneous Parking Brake Application

- 1.10 When the parking brake of the prime mover is applied, the parking brakes of any attached semi-trailer must also be applied automatically.

Capacity of Air Reservoirs

- 1.11(1) The capacity of the air storage tanks of the prime mover must be at least 12 times the total volume of the brake activation chambers on the prime mover.
- 1.11(2) The capacity of the air storage tanks of a semi-trailer must be at least 8 times the total volume of the brake activation chambers on the semi-trailer.

Speed Limiting

- 1.12 A prime mover which was manufactured after 31 December 1987 and has a gross vehicle mass (GVM) of more than 15 tonnes must comply with ADR 65.

Couplings

- 1.13(1) A fifth wheel coupling used to connect a semi-trailer to a towing vehicle must not be built with a pivot that allows the semi-trailer to roll relative to the towing vehicle.
- 1.13(2) Sub clause 1.14(1) does not apply to a fifth wheel coupling if:
 - (a) the semi-trailer design requires torsional stresses to be minimised; and
 - (b) the roll axis of the fifth wheel coupling is above the surface of the coupler plate; and
 - (c) the degree of rotation allowed around the roll axis of the fifth wheel coupling is restricted to prevent roll instability.

1.13(3) A turntable must be marked with:

- (a) the name or trademark of the manufacturer of the turntable; and
- (b) the D-value of the turntable.

Selection of Fifth Wheel Coupling

1.14(1) A fifth wheel coupling must have a D-value that complies with Australian Standard AS 1773-1990 "Articulated Vehicles - Fifth Wheel Assemblies".

1.14(2) A turntable must have a D-value that complies with Australian Standard AS 1773-1990 "Articulated Vehicles - Fifth Wheel Assemblies".

1.14(3) A fifth wheel coupling that is built for a 50 millimetre or 90 millimetre kingpin must:

- (a) meet the dimensional requirements in Australian Standard AS 1773-1990 "Articulated Vehicles - Fifth Wheel Assemblies"; and
- (b) not be worn away more than is recommended by that Australian Standard.

1.14(4) A fifth wheel coupling that is built for a 75 millimetre kingpin must:

- (a) be compatible with the kingpin described in sub clause 1.18(3); and
- (b) not be worn away more than is specified in clause 1.15.

Determining the D-value of a Fifth Wheel Coupling

1.15 When testing a fifth wheel coupling built for a 75 millimetre kingpin, to determine whether its D-value meets the requirements of clause 1.14:

- (a) the closed jaw diameter must not wear more than 2.6 millimetres; and
- (b) the jaw thickness must not wear more than 3.0 millimetres.

Mounting of Fifth Wheel Coupling

1.16 A fifth wheel coupling must be mounted in accordance with Australian Standard AS 1771-1987 "Installation of Fifth Wheel and Turntable Assemblies".

Branding of Fifth Wheel Coupling

1.17 A fifth wheel coupling on a vehicle manufactured on or after 1 July 1991 must be clearly and permanently marked in accordance with Australian Standard AS 1773-1990 "Articulated Vehicles - Fifth Wheel Assemblies" with:

- (a) the name or trademark of its manufacturer; and
- (b) its D-value; and
- (c) its nominal size.

Selection of Kingpin

1.18(1) A kingpin must:

- (a) be a 50 millimetre, 75 millimetre or 90 millimetre kingpin; and
- (b) have a D-value that complies with Australian Standard AS 2175-1990 "Articulated Vehicles - Kingpins".

1.18(2) A 50 millimetre or 90 millimetre kingpin must:

- (a) be built to meet the dimensional requirements in Australian Standard AS 2175-1990 "Articulated Vehicles - Kingpins"; and
- (b) not be worn away more than is recommended by that Australian Standard.

1.18(3) A 75 millimetre kingpin must:

- (a) be built to meet the dimensions in the diagram below; and
- (b) not be worn away more than is specified in sub clause 1.18(4).

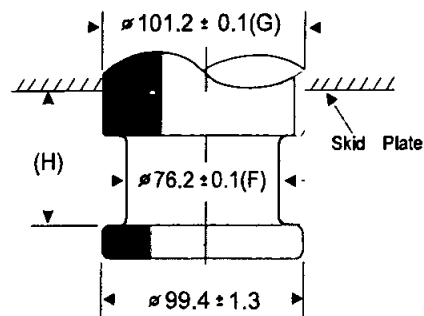

All dimensions in millimetres

1.18(4) When testing a 75 millimetre kingpin described in the diagram in sub clause 1.18(3) to determine whether its D-value meets the requirements in sub clause 1.18(1)(b):

- (a) diameter F must not wear more than 3.0 millimetres; and

- (b) diameter G must not wear more than 2.0 millimetres; and
- (c) height H must not wear more than 2.3 millimetres.

Attachment of Kingpin

1.19 A kingpin on a semi-trailer must be attached in accordance with:

- (a) the manufacturer's recommendations and instructions; or
- (b) the guidelines detailed in Australian Standard AS 2175-1990 "Articulated Vehicles - Kingpins".

Branding of Kingpin

1.20 A kingpin used in a semi-trailer which forms part of a B-double and was manufactured on or after 1 July 1991, must be clearly and permanently marked on its lower circular face in accordance with Australian Standard AS 2175-1990 "Articulated Vehicles - Kingpins" with:

- (a) the name or trademark of its manufacturer; and
- (b) its D-value; and
- (c) its nominal size.

PART 2 - MASS AND DIMENSION LIMITS

Mass Limits

- 2.1(1) The gross mass of a B-double must not exceed its mass limit which is the lowest of:
- (a) the sum of the mass limits described in clause 2.2 for the single axles and axle groups; and
 - (b) the mass limit shown in the Axle Spacing / Mass Table for the distance between the first and last axles of the B-double; and
 - (c) the sum of the mass limits of the prime mover (GVM) and the semi-trailers (GTM); and
 - (d) the gross combination mass limit (GCM) of the prime mover; and
 - (e) 62.5 tonnes.
- 2.1(2) The gross mass on a single axle or an axle group must not exceed its mass limit which is the lowest of:
- (a)

steering single axle	— 6.0 tonnes;
single axle with 4 tyres	— 9.0 tonnes;
tandem axle group with 8 tyres	— 16.5 tonnes;
tri-axle group with 12 tyres	— 20.0 tonnes;
tri-axle group with 6 tyres with section widths of at least 375 millimetres	— 20.0 tonnes; and
 - (b) the mass limit set by the manufacturer of the single axle or axle group; and
 - (c) the sum of the manufacturer's mass limits of the tyres fitted to the single axle or axle group.
- 2.1(3) The mass on each set of single axles and axle groups must not exceed the mass limit shown in the Axle Spacing / Mass Table for the distance between the centres of the outer axles of the set as shown below.

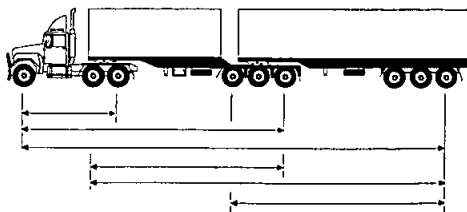

Axle Spacing / Mass Table

Distance between outer axles (metres)		Mass limit (tonnes)	Distance between outer axles (metres)		Mass limit (tonnes)
Equal to or greater than	Less than		Equal to or greater than	Less than	
0	3.7	23.0	10.0	10.2	42.5
3.7	3.8	23.5	10.2	10.3	43.0
3.8	4.0	24.0	10.3	10.5	43.5
4.0	4.2	24.5	10.5	10.7	44.0
4.2	4.3	25.0	10.7	10.8	44.5
4.3	4.5	25.5	10.8	11.0	45.0
4.5	4.7	26.0	11.0	11.2	45.5
4.7	4.8	26.5	11.2	11.3	46.0
4.8	5.0	27.0	11.3	11.7	46.5
5.0	5.2	27.5	11.7	12.0	47.0
5.2	5.3	28.0	12.0	12.3	47.5
5.3	5.5	28.5	12.3	12.7	48.0
5.5	5.7	29.0	12.7	13.0	48.5
5.7	5.8	29.5	13.0	13.3	49.0
5.8	6.0	30.0	13.3	13.7	49.5
6.0	6.2	30.5	13.7	14.0	50.0
6.2	6.3	31.0	14.0	14.3	50.5
6.3	6.5	31.5	14.3	14.7	51.0
6.5	6.7	32.0	14.7	15.0	51.5
6.7	6.8	32.5	15.0	15.3	52.0
6.8	7.0	33.0	15.3	15.7	52.5
7.0	7.2	33.5	15.7	16.0	53.0
7.2	7.3	34.0	16.0	16.3	53.5
7.3	7.5	34.5	16.3	16.7	54.0
7.5	7.7	35.0	16.7	17.0	54.5
7.7	7.8	35.5	17.0	17.3	55.0
7.8	8.0	36.0	17.3	17.7	55.5
8.0	8.2	36.5	17.7	18.0	56.0
8.2	8.3	37.0	18.0	18.3	56.5
8.3	8.5	37.5	18.3	18.7	57.0
8.5	8.7	38.0	18.7	19.0	57.5

8.7	8.8	38.5	19.0	19.3	58.0
8.8	9.0	39.0	19.3	19.7	58.5
9.0	9.2	39.5	19.7	20.0	59.0
9.2	9.3	40.0	20.0	20.3	59.5
9.3	9.5	40.5	20.3	20.7	60.0
9.5	9.7	41.0	20.7	21.0	60.5
9.7	9.8	41.5	21.0		62.5
9.8	10.0	42.0			

Dimension Limits

- 2.2(1) A prime mover and semi-trailers forming a B-double must comply with the Third Edition ADR 43/03.
- 2.2(2) A B-double must not be more than 25 metres long.
- 2.2(3) For a B-double built to carry cattle, sheep, pigs or horses:
- the two semi-trailers must not have more than 18.8 metres of their combined length available for carrying animals; and
 - the length available for carrying animals must be measured from the inside of the front wall or door of the semi-trailer to the inside of the rear wall or door of the semi-trailer (as the case may be), and any intervening partitions must be disregarded.
- 2.2(4) The distance measured at right angles between the rear overhang line of a semi-trailer carrying vehicles on more than one deck and the rearmost vehicle on the semi-trailer must not exceed 4.9 metres.
- 2.2(5) A B-double with two tri-axle groups must comply with the "balanced clear space rule" under which Y must not lie outside the range $(X - 1.0)$ and $(X + 1.3)$ where:
- X is the distance (in metres) between the centres of the last axle of the prime mover and the first axle of the first semi-trailer; and
 - Y is the distance (in metres) between the last axle of the first semi-trailer and the first axle of the second semi-trailer as shown in the diagram below.

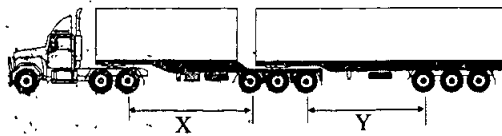

PART 3 - OPERATING CONDITIONS

- 3.1(1) Any journey is made at the absolute risk of the owner, operator and driver of the B-double. No representation is made by the Roads Corporation that any road, bridge, culvert, causeway or grid is capable of withstanding the B-double, that there is sufficient clearance under wires, structures or trees, or that there is suitable ground clearance at railway level crossings.
- 3.1(2) The owner, operator and driver of the B-double are responsible for planning each journey to ensure that:
- (a) the B-double crosses bridges and negotiates curves and intersections in a safe manner, bearing in mind that some roads and intersections may not be capable of accommodating B-doubles at the dimensions allowed by this notice; and
 - (b) the B-double does not travel-
 - (i) on a road, bridge or structure where any posted mass or dimension limit would be exceeded; or
 - (ii) beneath a bridge or overhead structure which carries a sign with the words "LOW CLEARANCE" or "CLEARANCE" if the height of the B-double is equal to or greater than the height shown on the sign; or
 - (iii) beneath any other overhead structures, cables, wires or trees unless there is at least 200 millimetres clearance to the highest point of the B-double.
- 3.1(3) B-doubles must only drive forwards when entering or exiting land abutting a highway (ie reversing is not permitted).
- 3.1(4) Deviation from the approved roads is not permitted except in emergencies:
- (a) at the direction of a Police Officer or a Roads Corporation Officer; or
 - (b) by obtaining permission during business hours from a VicRoads Permit Issuing Officer on telephone (03) 9345 4210; or
 - (c) by obtaining permission after hours from VicRoads Traffic Control and Communications Centre on telephone 13 1170.
- 3.1(5) The following documents must be carried by the driver of a B-double at all times when operating under this Notice and must be produced if requested by a Police Officer or an authorised Roads Corporation officer:
- (a) a copy of this General Permit or a VicRoads Information Bulletin pertaining to this General Permit; and

14 S 111 16 September 1997

Victoria Government Gazette

(b) in the case of a B-double registered in Victoria, a copy of the B-double Initial Inspection Certificate.

3.1(6) The driver of a B-double must have a Multi Combination driver licence.

3.1(7) Except where explicitly varied by this Notice, the provisions of the Road Safety Act 1986 and its Regulations and any other Act, Regulation or By-Law are applicable.

PART 4 - APPROVED ROADS

Declared Roads

- 4.1 Travel is allowed on a road that has been declared under Schedule 5 of the Transport Act 1983 except for the following declared roads where travel is not allowed:

Roads Corporation's North Eastern Region

DECLARED ROAD	MUNICIPALITY
Acheron Way	Murrindindi Shire
Alpine Road	Alpine Shire
Beechworth-Wodonga Road between Murray Valley Highway and Pearce Street	Rural City of Wodonga
Benalla-Tatong Road between Benalla-Winton Road and Kilfeera Road	Delatite Shire
Benalla-Winton Road between Midland Highway and Witt Street	Delatite Shire
Benambra-Corryong Road	Towong Shire
Bogong High Plains Road	Alpine Shire
Bright-Tawonga Road	Alpine Shire
Buckland Gap Road	Indigo and Milawa Shires
Dederang Road between Wodonga-Yackandandah Road and Osbornes Flat Road	Indigo Shire
Euroa-Mansfield Road between Maroondah Highway and Galls Gap Road	Strathbogie and Delatite Shires
Goulburn Valley Highway between the Broken River and Brauman Street	City of Greater Shepparton
Heidelberg-Kinglake Road from Kinglake southwards to Shire boundary	Murrindindi Shire
Hume Highway between Osburn Street and Murray Valley Highway	Rural City of Wodonga
Jamieson-Licola Road	Delatite Shire
Lake Mountain Road	Murrindindi Shire
Lockharts Gap Road	Indigo and Towong Shires

Mansfield-Woods Point Road between Jamieson and Woods Point	Delatite Shire
Maroondah Highway southwest from Saint Fillans to Shire boundary	Murrindindi Shire
Maroondah Highway between Goulburn Valley Highway and Green Street	Murrindindi Shire
Maroondah Highway between Kidston Parade and Midland Highway	Delatite Shire
Marysville-Woods Point Road	Murrindindi Shire
Midland Highway between Faithful Street and Ackerly Avenue	Delatite Shire
Mount Buffalo Road	Alpine Shire
Mount Buller Road between Midland Highway and Malcolm Street	Delatite Shire
Mount Buller Road between Mirimbah and Mount Buller Alpine Village	Delatite Shire
Murray Valley Highway between Chapple Street and Watson Street	Rural City of Wodonga
Omeo Highway south from Mitta Mitta to Shire boundary	Towong Shire
Shelley-Walwa Road between Guy's Forest Road and Murray River Road	Towong Shire
Tatong-Tolmie Road	Delatite Shire
Warburton-Woods Point Road	Delatite Shire
Wodonga-Yackandandah Road between Dederang Road and Osbornes Flat Road	Indigo Shire

Roads Corporation's Western Region

DECLARED ROAD	MUNICIPALITY
Ballarat-Burumbet Road between Princes Street and Midland Highway	City of Ballarat
Bendigo-Maryborough Road between Pyrenees Highway and Gladstone Street	Central Goldfields Shire
Hepburn Springs Road	Hepburn Shire

Nhill-Jeparit Road	Hindmarsh Shire
Nhill-Netherby Road	Hindmarsh Shire
Nhill-Yanac Road	Hindmarsh Shire
Pyrenees Highway between Ballarat-Maryborough Road and Bendigo-Maryborough Road	Central Goldfields Shire
Wartook Road	Northern Grampians Shire
Victoria Valley Road	Rural City of Ararat
Northern Grampians Road between Halls Gap and Wartook	Rural City of Horsham and Northern Grampians Shire

Roads Corporation's Eastern Region

DECLARED ROAD	MUNICIPALITY
Alpine Road	East Gippsland Shire
Benambra Road	East Gippsland Shire
Benambra-Corryong Road	East Gippsland Shire
Bonang Road	East Gippsland Shire
Boolarra-Mirboo North Road	La Trobe and South Gippsland Shires
Dargo Road north from Beverleys Road	East Gippsland and Wellington Shires
Gelantipy Road between Butchers Ridge and McKillops Road	East Gippsland Shire
Gipsy Point Road	East Gippsland Shire
Korumburra-Warragul Road between Ranceby and Tetoora Road	Baw Baw and South Gippsland Shires
Korumburra-Wonthaggi Road between Kongwak and Jumbunna	South Gippsland Shire
Lang Lang-Poowong Road between Nyora and Poowong	South Gippsland Shire
Mallacoota Road	East Gippsland Shire
McKillops Road	East Gippsland Shire
Meeniyah-Mirboo North Road between Farmers Road and Smallmans Road	South Gippsland Shire

Mount Baw Baw Road between Icy Creek and Mount Baw Baw	Baw Baw Shire
Murrungower Road north from Jirrah Track	East Gippsland Shire
Omeo Highway north from Bruthen to Shire boundary	East Gippsland Shire
Snowy River Road	East Gippsland Shire
Tarra Valley Road between Devon North and The Grand Ridge Road	Wellington Shire
The Grand Ridge Road	Wellington Shire
Traralgon-Balook Road	La Trobe and Wellington Shires
Tyers Road between Cross's Road and Moe-Glengarry Road	La Trobe Shire
Walhalla Road	Baw Baw Shire
Warburton-Woods Point Road	Baw Baw Shire

Roads Corporation's South East Metropolitan Region

DECLARED ROAD	MUNICIPALITY
Acheron Way	Yarra Ranges Shire
Arthurs Seat Road	Mornington Peninsula Shire
Beach Road	Cities of Bayside and Kingston
Don Road between Warburton Highway and Donna Buang Road	Yarra Ranges Shire
Donna Buang Road between Badger Weir Road and Acheron Way	Yarra Ranges Shire
Gembrook-Launching Place Road	Cardinia and Yarra Ranges Shires
Lysterfield Road between Napoleon Road and Wellington Road	City of Knox and Yarra Ranges Shire
Maroondah Highway northeast from Melba Highway to Shire boundary	Yarra Ranges Shire
Marysville-Woods Point Road	Yarra Ranges Shire
Melba Highway between Maroondah Highway and Healesville-Yarra Glen Road	Yarra Ranges Shire
Mornington-Tyabb Road	Mornington Peninsula Shire

Mount Dandenong Tourist Road	Yarra Ranges Shire
Ridge Road	Yarra Ranges Shire
Warburton-Woods Point Road	Yarra Ranges Shire

Roads Corporation's Northern Region

DECLARED ROAD	MUNICIPALITY
Bendigo-Eaglehawk Road between Loddon Valley Highway and Nelson Street (no northbound travel, southbound travel allowed)	City of Greater Bendigo
Bendigo-Maldon Road between Allens Road and Bridgewater-Maldon Road	Mount Alexander Shire
Bendigo-Redesdale Road between Myers-Wills Street and Sternberg Street	City of Greater Bendigo
Calder Highway between Violet Street and McIvor Highway	City of Greater Bendigo
Cameron Drive	Macedon Ranges Shire
Cohuna-Echuca Road	Campaspe Shire
Golden Square-Quarry Hill Road between Belle Vue Road and Mitchell Street	City of Greater Bendigo
Goulburn Valley Highway between High Street and Oak Street	Mitchell Shire
Kerang-Koondrook Road between Murray Valley Highway and Kerang-Murrabit Road	Gannawarra Shire
Kyabram-Rochester Road between Moore Street and Elizabeth Street	Campaspe Shire
McIvor Highway between Calder Highway and Midland Highway	City of Greater Bendigo
Midland Highway between McIvor Highway and Nolan Street	City of Greater Bendigo
Mount Macedon Road	Macedon Ranges Shire
Mount Macedon-Hanging Rock Road	Macedon Ranges Shire
Myrtle Street	City of Greater Bendigo
Myers-Wills Street	City of Greater Bendigo

Russell Street	City of Greater Bendigo
----------------	-------------------------

Roads Corporation's South Western Region

DECLARED ROAD	MUNICIPALITY
Beech Forest Road between Beech Forest and Forrest-Apollo Bay Road	Colac-Otway Shire
Bells Beach Road	Surf Coast Shire
Otway Lighthouse Road	Colac-Otway Shire
Cobden-Port Campbell Road between Great Ocean Road and Cobden-Warrnambool Road	Corangamite Shire
Colac-Lavers Hill Road between Ferguson and Lavers Hill	Colac-Otway Shire
Coleraine-Balmoral Road	Southern Grampians Shire
Coleraine-Edenhope Road between Glenelg Highway and Glenelg River	Southern Grampians Shire
Deans Marsh-Lorne Road	Surf Coast Shire
Forrest-Apollo Bay Road	Colac-Otway Shire
Gellibrand River Road	Colac-Otway Shire
Great Ocean Road between Anglesea and Nirranda South	Surf Coast, Colac-Otway, Corangamite and Moyne Shires
Hamilton Highway between Hyland Street and Minerva Road	City of Greater Geelong
High Street between Settlement Road and Barrabool Road	City of Greater Geelong
Hopkins Highway between Princes Highway and Botanic Road	City of Warrnambool
Lavers Hill-Cobden Road between Simpson and Lavers Hill	Corangamite and Colac-Otway Shires
Queens Park Road	City of Greater Geelong
Skenes Creek Road	Colac-Otway Shire
Timboon-Colac Road between Timboon-Port Campbell Road and Cobden-Port Campbell Road	Corangamite Shire

Timboon-Nullawarre Road between Timboon-Port Campbell Road and Ayresford Road	Corangamite Shire
Timboon-Port Campbell Road between Timboon-Colac Road and Cobden-Port Campbell Road	Corangamite Shire
Victoria Valley Road	Southern Grampians Shire
Vines Road between Church Street and Midland Highway (northbound travel prohibited, southbound travel allowed)	City of Greater Geelong

Roads Corporation's Metropolitan North West Region

DECLARED ROAD	MUNICIPALITY
Albert Road between Canterbury Road and Kingsway	City of Port Phillip
Beach Road	City of Port Phillip
Brunswick Street between Alexandra Parade and St Georges Road	City of Yarra
Brunton Avenue	City of Melbourne
Burke Road North	City of Banyule
Canterbury Road	City of Port Phillip
City Road between Clarendon Street and Boundary Street	Cities of Melbourne and Port Phillip
Clarendon Street between Yarra River and Albert Road	Cities of Melbourne and Port Phillip
Ferrars Street between City Road and Albert Road	City of Port Phillip
Gaffney Street between Pascoe Vale Road and Cumberland Street	City of Moreland
Heidelberg-Kinglake Road between Yan Yean Road and Kinglake	Nillumbik Shire
Jolimont Road	City of Melbourne
King Street between Flinders Street and Dudley Street	City of Melbourne
Kingsway between West Gate Freeway ramps and Flinders Street	Cities of Melbourne and Port Phillip
Kurrak Road	Nillumbik Shire
Lansdowne Street	City of Melbourne

McDonalds Road between Plenty Road and Plenty River	City of Whittlesea
Montague Street between Normanby Road and City Road	City of Port Phillip
Nicholson Street between Alexandra Parade and Park Street	City of Yarra
Settlement Road between Dalton Road and High Street	City of Whittlesea
Spencer Street between Yarra River and Dudley Street	City of Melbourne
Station Street between Heidelberg Road and Darebin Road	City of Darebin
St Georges Road between Brunswick Street and Clausen Street	City of Yarra
Victoria Street between King Street and Dryburgh Street	City of Melbourne
Wellington Parade between Hoddle Street and Lansdowne Street	City of Melbourne

Unclassified Roads

- 4.2 Travel is not allowed on roads that have not been declared under Schedule 5 of the Transport Act 1983 except for the following unclassified roads where travel is allowed subject to any specified restrictions on time or direction of travel:

Shire of Buloke

All unclassified roads.

Alexandra

Green Street between Maroondah Highway and William Street;
Station Street between William Street and Goulburn Valley Highway;
William Street.

Allansford

Ziegler Parade from Great Ocean Road for about 250 metres to Merri Transport Depot.

Altona

Ajax Road;
Buchanan Road;

Gordon Luck Avenue;
Kyle Road;
Maidstone Street;
Pinnacle Road;
Slough Road.

Ballarat

Burnbank Street;
Caravan Street;
Charlesworth Street between Fussell Street and Stawell Street South;
Coronet Street;
Dowling Street;
Fussell Street between Ballarat-Burumbet Road and Charlesworth Street;
Gregory Street between Burnbank Street and Martin Avenue;
Gregory Street West between Ring Road and railway line;
Martin Drive;
Ring Road;
Sutton Street between Ballarat-Carngham Road and Glenelg Highway;
Tait Street;
Traminer Court;
Trench Street (east of Midland Highway);
Trewin Street;
Vickers Street;
Waringa Drive;
Whitelaw Avenue;
Williamson Street.

Baranduda

Baranduda Drive;
Whytes Road between Murray Valley Highway and Baranduda Drive.

Beechworth

Masons Road;
Nursery Road.

Benalla

Old Thoona Road;
Saleyards Road between Witt Street and railway line;
Samaria Road between Benalla-Winton Road and Kilfeera Road;
Witt Street between Benalla-Winton Road and Saleyards Road.

Bendigo

Averys Road between Eaglehawk-Epsom Road and Victoria Street;
Belle Vue Road between Hattam Street and Paterson Street;
Carpenter Street between Paterson Street and Carolin Street;
Carolin Street between Carpenter Street and Retreat Road;
Charleston Road between Kennedy Street and Nolan Street;
Eaglehawk-Epsom Road between Averys Road and Goynes Road;
Howard Street between Goynes Road and Midland Highway;
Kennedy Street between McIvor Highway and Lansell Street;
Nolan Street between Charleston Road and Midland Highway;
Paterson Street between Byron Street and Carpenter Street;
Retreat Road and Somerville Street between Carolin Street and Townsend Street;
Sternberg Street between Townsend Street and McIvor Highway;
Victoria Street between Loddon Valley Highway and Averys Road.

Bolinda

Mullaly's Road - eastbound travel only, but not on schooldays 8.30 am - 9.30 am and
3.15 pm - 4.15 pm.

Briagolong

Munro Road;
Munro-Stockdale Road;
Stockdale Road;
Stockdale-Fernbank Road between Stockdale Road and Munro-Stockdale Road.

Brooklyn

Alick Road;
Amanda Road;
Cawley Road;
Export Drive;
Frederick Road;
Hardie Road.

Buffalo River

McLees Road.

Campbellfield

Ainslie Road;
Barry Road between Hume Highway and Merri Creek;
Glenbarry Road;
Killara Road;

Maffra Street;
Northbourne Road;
Rex Road.

Carboor Upper

Buffalo River Road between Lake Buffalo dam wall and Lake Buffalo-Whitfield Road;
Carboor East Road south from Lake Buffalo-Carboor Road for 1.5 km;
Lake Buffalo-Carboor Road between Lake Buffalo-Whitfield Road and Carboor East Road;
Lake Buffalo-Whitfield Road between Buffalo River Road and Lake Buffalo-Carboor Road.

Carisbrook

Chaplins Road.

Castlemaine

Downes Road;
Parker Street between Downes Road and Midland Highway.

Chiltern

Barambogie Road between Racecourse Road and Water Trust Road;
Racecourse Road.

Clayton

McNaughton Road.

Cobden

Neylon Street.

Colac

Aireys Street between Colac-Lavers Hill Road and Forest Street;
Baillie Street;
Bruce Street between Forest Street and railway line;
Douglas Street;
Forest Street between Aireys Street and Parkinson Street;
Parkinson Street between Baillie Street and Forest Street;
Warrowie Road between Princes Highway and railway line.

Connewarre

Batten Road between Boundary Road and Lake Road;
Boundary Road between Batten Road and Charlemont Road;
Charlemont Road between Boundary Road and Groves Road;
Groves Road.

Corio

Broderick Road;
Heales Road between Forest Road and Geelong-Bacchus Marsh Road;
Refinery Road;
Station Street between St Georges Road and Princes Highway;
St Georges Road between Station Street and Seabeach Parade.

Creswick

Allendale-Kingston Road.

Cullulleraine

Werrimull North Road

Dandenong

Abbotts Road;
Elliott Road;
Hammond Road between Cheltenham Road and Webster Street;
Hammond Road between Greens Road and Bangholme Road;
Healey Road;
Kitchen Road;
Monterey Road;
Nathan Road;
Park Drive;
Progress Street;
Quality Drive;
Round Tower Road between Nathan Road and railway line;
Webster Street.

Dartmoor

Ascot Street;
Lindsay Road;
Grubbed Road between Marp Road and Myaring-Pieracle Road;
Marp Road between Lindsay Road and Grubbed Road;
North Dartmoor Road.

Echuca

Hume Street between Murray Valley Highway and Service Street;
Sturt Street between Murray Valley Highway and Service Street.

Footscray

Roberts Street between Sunshine Road and Meadow Lea.

Geelong

Gheringhap Street between Mercer Street and McKillop Street;
Mercer Street.

Geelong North

Cowie Street;
Douro Street;
Edols Street;
Enmore Street between Douro Street and Mornington Street;
Freedman Street;
Furner Avenue from Thompson Street for about 100 metres to Victorian Producers Co-operative;
Mornington Street from Enmore Street for about 150 metres northwards to R Renfrey Pty Ltd;
Victor Street;
Victoria Street between Thompson Road and Douro Street.

Geelong South

Barwon Terrace between Swanston Street and Wood Street;
Crown Street;
Dowsett Street;
Fyans Street between Latrobe Terrace and Crown Street;
Swanston Street between Barwon Terrace and McKillop Street;
Wood Street from Barwon Terrace southwards for about 100 metres to McColls Transport depot;
Wood Street from Dowsett Street northwards for about 150 metres to No 6 Wood Street.

Geelong West

Church Street between Vines Road and Midland Highway, but not on schooldays between 8.30 am - 9.30 am and 3.30 pm - 5.00 pm;
Weddell Road.

Hallam

Abbott Road;
David Lee Road;
Westpool Drive;
Wedgewood Road.

Hamilton

Abbott Street (note - exit from Abbott Street to Mt Napier Road is not allowed, use Apex Drive);
Apex Drive;
Eddy Street;
Fenton Street between Eddy Street and Mt Napier Road;
Holden Street;
Mt Napier Road between Holden Street and Fenton Street.

Hastings

Barclay Crescent;
Bayview Road;
Long Island Drive;
Marine Parade between Frankston-Flinders Road and Barclay Crescent.

Kerang

Airport Road between Murray Valley Highway and Kerang-Koondrook Road;
Boundary Street;
Garvey Road between Airport Road and Mitchell Street;
Markets Road between Kerang-Koondrook Road and Mitchell Street;
Sleepy Lane.

Kyabram

Barton Road between Echuca-Kyabram Road and Crichton Road.

Lake Mundi

Border Road between Casterton-Penoia Road and Old Telegraph Road;
Byjuke Forest Road;
Shanks Road.

Lara

Avalon Road between McClelland Avenue and Princes Freeway;
Beach Road between Old Melbourne Road and main entrance to Avalon Airfield (about 2 km east of Princes Freeway);

Brownes Road between Geelong-Ballan Road and Mount Road;
Carrs Road between Geelong-Bacchus Marsh Road and Old Boundary Road;
Elcho Road between Geelong-Bacchus Marsh Road and O'Hallorans Road;
Lewton Road;
McClelland Avenue;
McIntyres Road;
Mill Road between Alkara Avenue and Station Lake Road;
Minyip Road;
Old Boundary Road from Carrs Road for about 500 metres to Featherrock Quarry;
Old Melbourne Road between Beach Road and McClelland Avenue;
Patullos Road between Elcho Road and Forest Road South;
Staceys Road;
Station Lake Road.

Laverton North

Cherry Lane;
Gilbertson Road;
Holcourt Road;
Hume Road;
Leslie Road;
Lincoln Street;
Merino Street;
Old Geelong Road between Princes Freeway and Kororoit Creek Road;
Pipe Road;
Plummer Road;
Raymond Road;
Somerleigh Road;
Stanley Road;
Thomas Road;
William Angliss Drive.

Leitchville

Bowlands Road;
Leitchville South Road.

Leopold

Melaluka Road between Geelong-Portarlington Road and Bellarine Highway.

Lower Cape Bridgewater

Knights and Parkers Road from Bridgewater Road for about 1 km to quarry.

Maldon

Allens Road;
Lowther Street between Allens Road and Bridgewater-Maldon Road.

Mansfield

Dead Horse Lane;
Highett Street between Maroondah Highway and Malcolm Street;
Kidston Parade between Maroondah Highway and Malcolm Street;
Malcolm Street between Kidston Parade and Mount Buller Road.

Maryborough

Gladstone Street;
Phelan Road;
Tullaroop Road.

Merriang South

Merriang South Road;
Slaughteryard Creek Road.

Moolap

Albert Street;
Chipperfield Drive;
Denbigh Street;
Greenside Grove;
Hays Road;
High Street between Moolap Station Road and Albert Street;
Moolap Station Road between Bellarine Highway and Geelong-Portarlington Road;
Point Henry Road;
Whitehorse Road between Geelong-Portarlington Road and Bellarine Highway.

Moorabbin

Hewitt Street.

Mooroopna

Young Street.

Mudgegonga

Carrolls Road.

Myrtleford

Chambers Street;
Duke Street;
Jubilee Street;
McGeehan Street;
O'Donnell Avenue.

Nirranda South

Callaghans Road.

Norlane

Morgan Street.

North Shore

Madden Avenue;
Seabreeze Parade between The Esplanade and Seabeach Parade;
The Esplanade between Madden Avenue and Seabreeze Parade;
Walchs Road between The Esplanade and Seabeach Parade.

Ouyen

Britt Street between Rowe Street and Nhill Street;
Nhill Street;
Rowe Street between Mallee Highway and Britt Street.

Porepunkah

Buckland Valley Road between Ovens Highway and Harris Lane.

Portarlington

Pigdon Street from Portarlington-Queenscliff Road to 100 metres east of Simson Street.

Portland

Browning Street between Garden Street and Kennedy Street;
Canal Court;
Cashmore Road;
Cliff Street between Henty Highway and Canal Court;
Darts Road;
Garden Street between Henty Highway and Browning Street;
Kennedy Street from Browning Street for about 200 metres to BP depot;
Westlakes Road between Portland-Nelson Road and Henty Highway (note - access to

Westlakes Road from Henty Highway is not allowed, use Cashmore Road and Portland-Nelson Road).

Port Melbourne

Bertie Street between Williamstown Road and Woodruff Street;
Bridge Street between Williamstown Road and Fennell Street;
Ingles Street between Lorimer Street and Williamstown Road;
Munro Street between Ingles Street and Boundary Street;
Prohasky Street.

Port of Melbourne

(a) Roads in the vicinity of Swanson and Appleton Docks

Anderson Road;
Anderson Road Extension;
Appleton Dock Road;
Coode Road;
Dahlenburg Street;
Dock Link Road;
Gibbons Street;
Kermode Street;
Mackenzie Road (excluding the section that provides access to No 1 Maribyrnong Berth);
Oliphant Street;
Phillipps Road;
Swanson Dock Road between Coode Road and Footscray Road.

(b) Roads in the vicinity of Victoria Dock

Boyd Street;
Dudley Street south of Footscray Road;
North Wharf Road;
Pigott Street;
Pitt Street;
Sudholz Street.

(c) Roads in the vicinity of Webb Dock

Mayne Road;
Swanton Street.

Rennick

Princess Margaret Rose Caves Road between Princes Highway and Caroline Road.

Robinvale

David Street;
Moore Street.

Rochester

Elizabeth Street.

Rosewhite

Havilah Road;
Kancoona Road.

Seymour

High Street;
Oak Street;
Tarcombe Road between High Street and Oak Street;
Wallis Street between Goulburn Valley Highway (Emily Street) and High Street.

Shepparton

Callister Street between Midland Highway and Keppel Street;
Central Avenue between Midland Highway and Dookie-Shepparton Road;
Drummond Road;
Hawkins Street;
Lemnos North Road;
McGill Street;
Old Dookie Road between Wheeler Street and Drummond Road;
Purcell Street between Ashenden Street and St Georges Road;
Smythe Street;
St Georges Road between Midland Highway and Vaughan Street;
Vaughan Street between St Georges Road and Purcell Street;
Wanganui Road;
Wheeler Street.

Spotswood

Burleigh Street;
Douglas Parade;
Simcock Avenue.

Swan Hill

Gray Street east from Sea Lake-Swan Hill Road for 600 metres;
Karinie Street between Murray Valley Highway and Richards Road;

McAllister Road;
Quin Drive;
Richards Road;
Shepherd Road;
Thurla Road between Karinie Street and Cobb Court;
Webster Drive.

Swanpool

Ethell Road;
Lima Road.

Tatura

Dhurringile Road between Midland Highway and MacTier Street;
Hunter Street;
Park Street;
William Street.

Traralgon

Eastern Road;
McNairn Road;
Minniedale Road North.

Tongala

Bosse Road west from Tongala Road for 400 metres.

Wahgunyah

All Saints Road;
Barkly Street;
Talbot Road.

Wangaratta

Hay Avenue between Vincent Road and Newman Street;
Newman Street between Wangaratta Road and Hay Avenue;
Shanley Street;
Vincent Road between Wangaratta Road and Hay Avenue.

Warragul

Burke Street between Howitt Street and Spring Street;
Spring Street.

Warrnambool

Albert Street;
Dickson Street;
Drummond Street (note - access to Drummond Street from Princes Highway is not allowed, use Lindsay Street);
Flaxman Street from Princes Highway to Caltex depot (about 150 m east of Kingsway Court) but not on schooldays between 8.00 am - 9.00 am and 3.00 pm - 4.00 pm;
Lindsay Street between Princes Highway and Drummond Street;
Rooneys Road between Princes Highway and Braithwaite Street;
Walsh Road;
Watson Street between Braithwaite Street and Dickson Street.

Waurin Ponds

Reservoir Road between Anglesea Road and Bogans Lane.

Whitfield

King Valley Road;
Rose River Road between King Valley Road and Smalls Lane;
Smalls Lane.

Williamstown North

Fink Street.

Winchelsea

Cape Otway Road between Princes Highway and Salt Creek Lane.

Wodonga

Bradford Street between Queen Street and railway line;
Chapple Street;
Hovell Street north of Osburn Street;
Huon Street between Hovell Street and railway line;
Kane Road;
Kelly Street;
Kendall Street between Chapple Street and Kane Road;
McKoy Street between Romet Road and Moorefield Park Road;
Melrose Drive between Murray Valley Highway and Moloney Drive;
Moloney Drive;
Moorefield Park Road between Murray Valley Highway and Romet Road;
Osburn Street between Chapple Street and Hume Highway;
Pearce Street between Beechworth-Wodonga Road and Murray Valley Highway;
Queen Street between Osburn Street and Bradford Street;

Romet Road;
Sangsters Road between Murray Valley Highway and Kelly Street;
Watson Street north of Murray Valley Highway;
Wigg Street between Osburn Street and Jack-in-the-Box Creek.

Yackandandah

Gap Flat Road;
Osbornes Flat Road.

Yarraville

Hyde Street between Douglas Parade and Francis Street;
Leek Street.

Yea

Miller Street;
Whatton Place.

Posted Mass and Dimension Limits

- 4.3 In spite of clauses 4.1 and 4.2, a B-double must not travel on a bridge, structure or road where any posted mass or dimension limit would be exceeded.

Bridges and Structures

- 4.4 In spite of clauses 4.1 and 4.2, travel is not allowed over the following bridges and structures on declared roads:

ROAD NAME	LOCATION	STRUCTURE
Ararat-Pomonal Road	Moyston	Rocky Point Creek No 1
Ararat-St Arnaud Road	Crowlands	Dog Rock Creek
Ballarat-Maryborough Road	Clunes	Kilkenny Creek
Ballarto Road	Koo-Wee-Rup North	Ararat Creek
Ballarto Road	Koo-Wee-Rup North	Bunyip River
Ballarto Road	Koo-Wee-Rup North	South Eastern Catch Drain
Barwon Heads Road	Barwon Heads	Barwon River
Beechworth-Chiltern Road	Beechworth	Wooragee Creek
Beechworth-Wangaratta Road	Beechworth	Spring Creek
Bellarine Highway	Geelong	Rail tunnel

Bendigo-Maryborough Road	Eddington	Loddon River
Bendigo-Murchison Road	Creek View	Campaspe River
Bendigo-Murchison Road	Murchison	Goulburn River
Bendigo-Redesdale Road	Bendigo	Rail
Bonang Road	South of Malinns	Sardine Creek
Boort-Wycheproof Road	Boort	Waranga Western Channel
Bright-Tawonga Road	Germantown	Ovens River
Broadford-Flowerdale Road	Strath Creek	Strath Creek
Burnley Street	Burnley	Rail
Burwood Road	Hawthorn West	Rail
Casterton-Edenhope Road	Casterton	Glenelg River
Casterton-Edenhope Road	Casterton	Glenelg River flood plain
Casterton-Edenhope Road	Chetwynd	Chetwynd River
Casterton-Edenhope Road	Kadnook	Kadnook Creek
Clunes-Creswick Road	Clunes	Creswick Creek
Cobden-Terang Road	Terang	Mt Emu Creek
Daylesford-Malmsbury Road	Glenlyon	Wallaby Creek
Daylesford-Newstead Road	Franklinford	Yandoit Creek
Don Road	Launching Place	Myrtle Creek
Donald-Swan Hill Road	Towaninny	Lalbert Creek
Donnybrook Road	Yan Yean	Barbers Creek
Dunolly-Eddington Road	Eddington	Bet Bet Creek
Gelantipy Road	Butchers Ridge	Butchers Creek
Gelantipy Road	Butchers Ridge	Gelantipy Creek
Gelantipy Road	Gelantipy	Boundary Creek
Gelantipy Road	Gelantipy	Seldom Seen Creek
Gelantipy Road	Gelantipy	Pack Bullock Creek
Gellibrand River Road	Mount MacKenzie	Sandy Creek
Glenferrie Road	Malvern	Rail
Glenferrie Road	Kooyong	Gardiniers Creek
Grange Road	Toorak	Yarra River
Hamilton-Port Fairy Road	Byaduk North	Lyne Creek

Healesville-Koo-Wee-Rup Road	Woori Yallock	Yarra River
Healesville-Koo-Wee-Rup Road	Woori Yallock	Yarra River flood plain
Heathcote-Kyneton Road	Redesdale	Campaspe River
Heidelberg-Kinglake Road	Diamond Creek	Diamond Creek
Hendy Main Road	Paraparap	Thompsons Creek
High Street	Glen Iris	Gardiniers Creek
High Street	Ashburton	Rail
High Street Road	Ashwood	Gardiniers Creek
Hotham Street	Elsternwick	Rail
Katamatite-Nathalia Road	East of Numurkah	Broken Creek (two bridges)
Kerang-Koondrook Road	Kerang	Pyramid Creek
Kerang-Murabit Road	Capels Crossing	Barr Creek
Koo-Wee-Rup-Longwarry Road	Bayles	Yallock Outfall Drain
Koo-Wee-Rup-Longwarry Road	Bayles	No 4 Yallock Drain
Korumburra-Warragul Road	Warragul	Rail (two bridges)
Kyabram-Rochester Road	Rochester	Campaspe River
Lavers Hill-Cobden Road	Carlisle River	Gellibrand River
Lavers Hill-Cobden Road	Carlisle River	Gellibrand River backwater
Licola Road	North of Cheyne Creek	Macalister River
Licola Road	Licola	Macalister River
Lindenow Road	Walpa	Mitchell River
Lysterfield Road	Lysterfield	Monbulk Creek
Malvern Road	Toorak	Rail
Mansfield-Whitfield Road	Whitfield	Unknown Creek
Mansfield-Woods Point Road	Jamieson	Goulburn River
Maroondah Highway	Coldstream	Stringybark Creek
Maryborough-Dunolly Road	Bet Bet	Bet Bet Creek
Maryborough-Dunolly Road	Bet Bet	Burnt Creek
Maryborough-St Arnaud Road	Wareek	Bet Bet Creek
Melba Highway	Yarra Glen	Yarra River
Midland Highway	Guildford	Loddon River
Moe-Glengarry Road	Moe	Narracan Creek

Murray River Road	Granya	Granya Creek
Murray River Road	Thologolong	Flaggy Creek
Murray River Road	Burrowye	Burrowye Creek
Nepean Highway	Frankston	Kananook Creek
Nepean Highway	Mount Martha	Brokil Creek
Nerrena Road	Nerrena East	Tarwin River East Branch
Omeo Highway	Omeo	Livingstone Creek
Omeo Highway	Bingo Munjie North	Bingo Munjie Creek
Omeo Highway	Anglers Rest	Cobungra River
Orrong Road	Toorak	Rail
Penshurst-Port Fairy Road	0.89 km north of Princes Highway	Unnamed watercourse
Portland-Casterton Road	Casterton	Wannon River
Princes Highway	Lakes Entrance	North Arm Lakes Entrance
Princes Highway	Windsor	Rail
Queens Park Road	Newtown	Barwon River
Rokewood-Skipton Road	Rokewood	Little Woody Yaloak Creek
Russell Street	Bendigo	Rail
South Gippsland Highway	Longford	Long Waterhole Creek
South Gippsland Highway	Longford	Latrobe River
Steiglitz Road	Steiglitz	Sutherlands Creek West Arm
Sunraysia Highway	Avoca	Number Two Creek
Swan Reach-Bruthen Road	Bumberrah	Rail
Talgarno Road	Bellbridge	Lake Hume
Talgarno Road	Talgarno	Tarrangatta Creek
Traralgon West Road	West of Traralgon	Rail
Warrnambool-Caramut Road	North of Woolsthorpe	Youl Creek
Warrnambool-Caramut Road	Mailer Flat	Manifold Creek
Wattletree Road	Eltham North	Diamond Creek
Williams Road	Hawksburn	Rail
Willowgrove Road	Trafalgar	Contour Drain
Willowgrove Road	Trafalgar	Goodings Drain
Winchelsea-Deans Marsh Road	Winchelsea	Barwon River

Winchelsea-Deans Marsh Road	Winchelsea	Barwon River flood plain
Won Wron Road	Calrossie	Tarra River
Woolsthorpe-Heywood Road	Dunmore	Kangaroo Creek
Woolsthorpe-Heywood Road	Woolsthorpe	Spring Creek

PART 5 - DEFINITIONS

5.1 In this notice -

"air brake" means an air-operated or air-assisted brake.

"anti-lock brakes" means a portion of a service brake system that automatically controls the degree of rotational wheel slip relative to the road at one or more road wheels of the vehicle during braking.

"Australian Design Rule (ADR)" means a national standard under the Motor Vehicle Standards Act 1989.

"Australian Standard" means a Standard approved for publication on behalf of the Council of the Standards Association of Australia.

"axle" means one or more shafts positioned in a line across a vehicle, on which one or more wheels intended to support the vehicle turn.

"axle group" means a single axle group, tandem axle group or tri-axle group.

"B-double" means a combination of vehicles consisting of a prime mover towing two semi-trailers.

"braking system" means all the brakes of a vehicle and all the components of the mechanisms by which they are operated.

"bulk container" means as defined in Regulation 104 of the Dangerous Goods (Transport) Regulations 1987.

"centre of an axle group" means a line located midway between the centre lines of the outermost axles of the group.

"dangerous goods" means the substances and items prescribed as dangerous goods for the purposes of the Dangerous Goods Act 1985 by the Dangerous Goods (Prescribed Listed) Regulations 1986.

"driver" means the person driving or in control of a vehicle.

"D-value" means the standard capacity of a connection device as defined in:

- (a) Australian Standard AS 1773-1990 "Articulated Vehicles - Fifth Wheel Assemblies"; or
- (b) Australian Standard AS 2213-1984 "50 mm Pin-type Couplings and Drawbar Eyes for Trailers"; or
- (c) Australian Standard AS 2175-1990 "Articulated Vehicles - King Pins".

"emergency brake" means a brake designed to be used if a service brake fails.

"fifth wheel coupling" means a device, other than the upper rotating element and the kingpin (which are parts of a semi-trailer), which are used with a prime mover, semi-trailer or a converter dolly to permit quick coupling and uncoupling and to provide for articulation.

"gross combination mass (GCM)" means in relation to a B-double, the greatest possible sum of the maximum loaded mass of the prime mover and of any semi-trailers that may lawfully be towed by it at one time:

- (a) as specified by the prime mover's manufacturer-
 - (i) on a plate fixed to the prime mover by the manufacturer, or
 - (ii) if the manufacturer has not specified the sum of the maximum loaded mass on a plate fixed to the vehicle—in another place; or
- (b) as specified by the vehicle registration authority if-
 - (i) the manufacturer has not specified the sum of the maximum loaded mass, or
 - (ii) the manufacturer cannot be identified, or
 - (iii) the vehicle has been modified to the extent that the GCM specified by the manufacturer is no longer appropriate.

"gross trailer mass (GTM)" means the mass transmitted to the ground by the axle or axles of the semi-trailer when coupled to a towing vehicle and carrying its maximum load recommended by the semi-trailer manufacturer approximately uniformly distributed over the load bearing area of the semi-trailer.

"gross vehicle mass (GVM)" means the maximum loaded mass of a vehicle:

- (a) as specified by the manufacturer; or
- (b) as specified by the vehicle registration authority if-
 - (i) the manufacturer has not specified a maximum loaded mass, or
 - (ii) the manufacturer cannot be identified, or
 - (iii) the vehicle has been modified to the extent that the GVM specified by the manufacturer is no longer appropriate.

"ground clearance" means the minimum distance to the ground from the underside of a vehicle excluding its tyres, wheels, wheel hubs, brake backing plates and flexible mudguards or mudflaps.

"operator" means a person who is responsible for or controls or directs the operations of a vehicle.

"owner" means in relation to a vehicle:

- (a) a person in whose name the vehicle is registered under a Commonwealth, State or Territory Act; or
- (b) a person who, according to the vehicle registration authority's records, has acquired the vehicle from the person in whose name the vehicle is registered under the relevant Act; or
- (c) if the vehicle is not registered, a person to whom a mark, plate, or permit has been issued to allow the vehicle to be used; or
- (d) a person who is entitled to possession of the vehicle.

"parking brake" means a brake that, through a control independent of the service brake, applies a restraining force to two or more road wheels of the vehicle to either prevent or restrict rotation of the braked wheels.

"prime mover" means a motor vehicle built to tow a semi-trailer.

"rear overhang line" means:

- (a) if there is a single axle at the rear of the vehicle, the centre line of the axle; or
- (b) if there is an axle group at the rear of the vehicle, the centre of the axle group, determined without regard to the presence of any steerable or retractable axle unless all axles in the group are steerable or retractable.

"retractable axle" means an axle with a means of adjustment enabling it to be raised or lowered relative to the other axles in the axle group.

"road" means:

- (a) an area that is open to or used by the public and is developed for, or has as one of its main uses, the driving or riding of motor vehicles;
- (b) includes "highway" as defined in the Road Safety Act 1986.

"road tank vehicle" means a road vehicle used or intended to be used to transport dangerous goods in bulk, in other than a bulk container.

"semi-trailer" means a trailer that has:

- (a) a single axle or one axle group towards the rear;
- (b) a means of attachment to a prime mover that would result in some of the load being imposed on the prime mover.

"service brake" means the brake normally used to decelerate a vehicle.

"single axle" means an axle not forming part of an axle group.

"single axle group" means a group of two or more axles, in which the horizontal distance between the centre lines of the outermost axles is less than 1.0 metre.

"spray suppression device" means a device or material designed to absorb or dissipate the energy of water thrown from a tyre.

"tandem axle group" means a group of at least two axles, in which the horizontal distance between the centre lines of the outermost axles is at least 1.0 metre, but not more than 2.0 metres.

"tri-axle group" means a group of at least three axles, in which the horizontal distance between the centre lines of the outermost axles is more than 2.0 metres, but not more than 3.2 metres.

"turntable" means a bearing that is built to carry vertical and horizontal loads, but does not

allow quick separation of its upper and lower rotating elements, and that is used to connect and allow articulation between:

- (a) a prime mover and a semi-trailer; or
- (b) a fifth wheel coupling and the vehicle to which it is mounted.

"vehicle registration authority" means in relation to a vehicle:

- (a) the authority that last registered the vehicle; or
- (b) if the vehicle has never been registered, the authority responsible for registering vehicles in the jurisdiction in which the vehicle is used or is intended to be used.

"50 millimetre kingpin" means a kingpin meeting the dimension requirements for a 50 millimetre kingpin in Australian Standard AS 2175-1990 "Articulated Vehicles - Kingpins".

"75 millimetre kingpin" means a kingpin with the dimensions specified in clause 1.20 (3).

"90 millimetre kingpin" means a kingpin meeting the dimension requirements for a 90 millimetre kingpin in Australian Standard AS 2175-1990 "Articulated Vehicles - Kingpins".





Gazette Services

The *Victoria Government Gazette* (VGG) is published by AGPS Publications for the State of Victoria and is produced in three editions.

VGG General is published each Thursday and provides information regarding Acts of Parliament and their effective date of operation; Government notices; requests for tenders; as well as contracts accepted. Private notices are also published.

VGG Special is published any day when required for urgent or special Government notices. VGG Special is made available automatically to subscribers of VGG General.

VGG Periodical is published on Monday when required and includes specialised information eg. Medical, Dental, Pharmacist's Registers, etc.

Subscriptions

VGG is available by three subscription services:

General and Special—\$165.00 each year

General, Special and Periodical—\$220.00 each year

Periodical—\$110.00 each year

Subscriptions are payable in advance and accepted for a period of one year. All subscriptions are on a firm basis and refunds for cancellations will not be given.

All payments should be made payable to AGPS Publications.

Subscription inquiries (03) 9387 8135
Fax (03) 9387 3404

An AGPS Publication

Published by AGPS Publications

Printed by AGPS Printing

a business unit of

Department of Administrative Services

Brunswick Victoria Australia

© State of Victoria 1997

ISSN 0819—548X

This publication is copyright. No parts may be reproduced by any process except in accordance with the provisions of the Copyright Act.

Address all inquiries to:

Subscriptions

AGPS Publications

PO Box 263, Brunswick 3056

Telephone inquiries (03) 9387 8135

Fax (03) 9387 3404

Retail Sales

Information Victoria Bookshop

356 Collins Street Melbourne 3000

Telephone inquiries 1300 366 356

Price Code C